

F.A.P. RTE.	SECTION	COUNTY	TOTAL SHEETS	SHEET NO.
326	•	LIVINGSTON	354	220
STA.		TO STA.		
FED. ROAD DIST. NO.		ILLINOIS		FED. AID PROJECT
1123123XIRS-3(124)RS-5		11231BR-3		

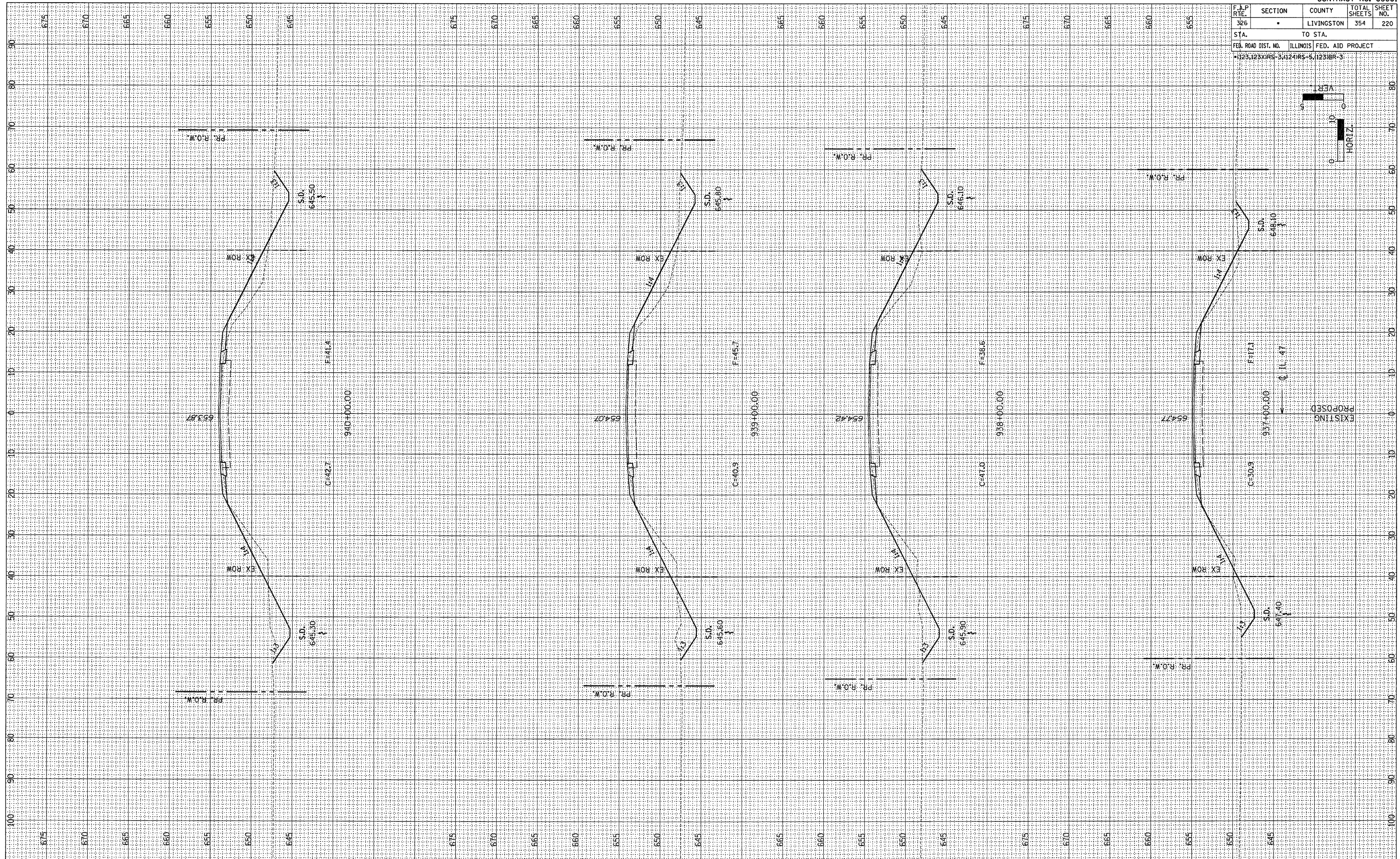
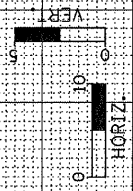

EXISTING  
PROPOSED

FINAL SURVEY	DATE
CHECKED	BY
PLOTTED	
TEMPLATE	
AREAS	
CHECKED	

ORIGINAL SURVEY	DATE
CHECKED	BY
PLOTTED	
TEMPLATE	
AREAS	
CHECKED	