

F.A.P. RTE.	SECTION	COUNTY	TOTAL SHEETS	SHEET NO.
326	*	LIVINGSTON	354	225
STA.		TO STA.		
FED. ROAD DIST. NO.		ILLINOIS	FED. AID PROJECT	
1123,123XIR-5,1124IR-5,1123IR-3				

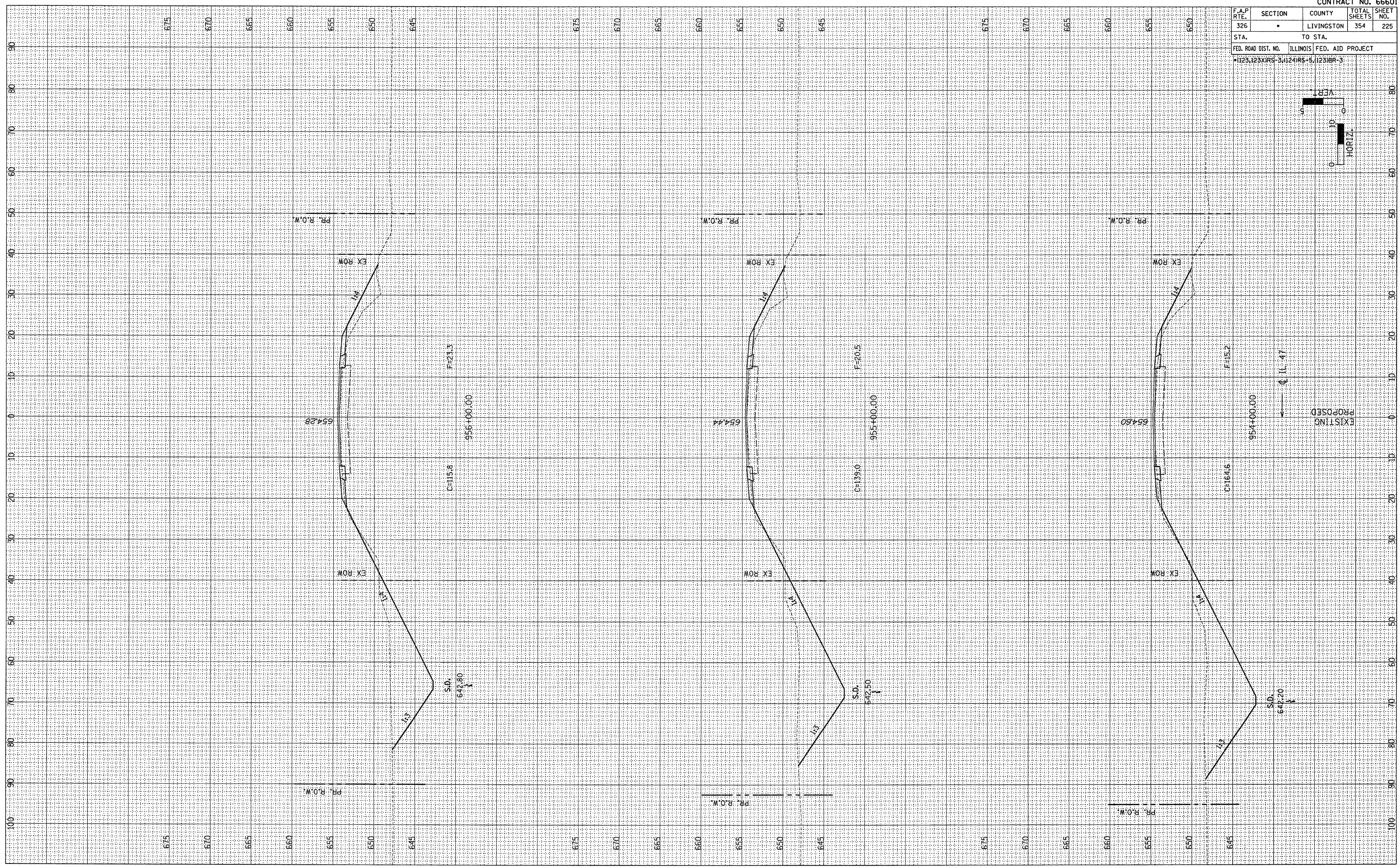
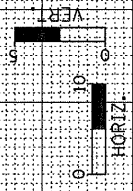

FINISHED	BY	DATE
SURVEY		
PLOTTED		
TEMPLATE		
AREAS		
CHECKED		

ORIGINAL	BY	DATE
SURVEY		
PLOTTED		
TEMPLATE		
AREAS		
CHECKED		