

F.A.P. RTE.	SECTION	COUNTY	TOTAL SHEETS	SHEET NO.
326	*	LIVINGSTON	354	233
STA. TO STA.		FED. ROAD DIST. NO. ILLINOIS FED. AID PROJECT		
1123125XJRS-3; 1124JRS-5; 1123JBR-3				

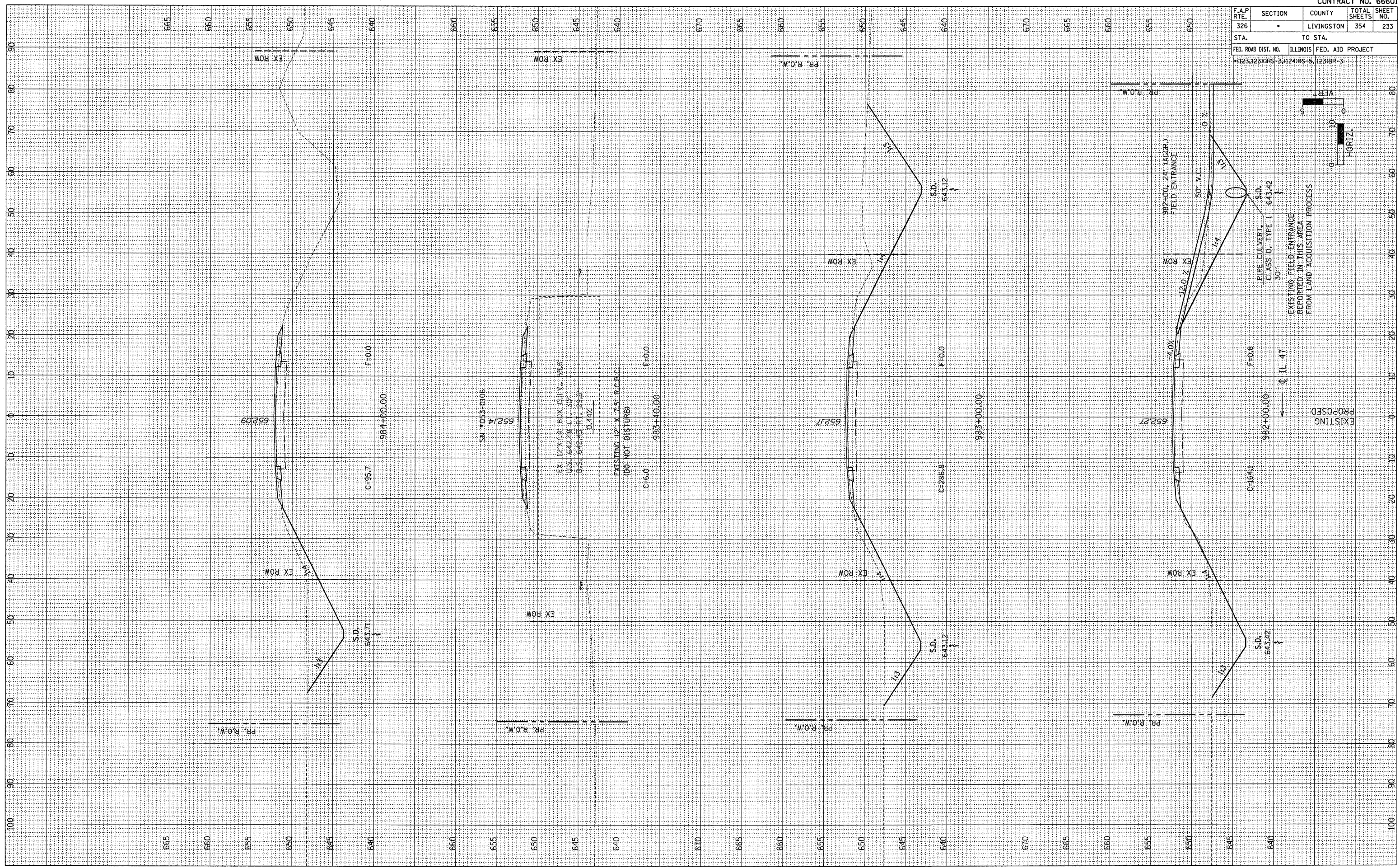
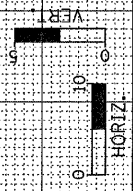

FINAL SURVEY	DATE
BY	
DATE	
NO.	

ORIGINAL SURVEY	DATE
BY	
DATE	
NO.	