

F.A.P. RTE.	SECTION	COUNTY	TOTAL SHEETS	SHEET NO.
326	*	LIVINGSTON	354	268
STA.		TO STA.		
FED. ROAD DIST. NO.		ILLINOIS FED. AID PROJECT		
*1123,123XRS-3;124RS-5,123IBR-3				

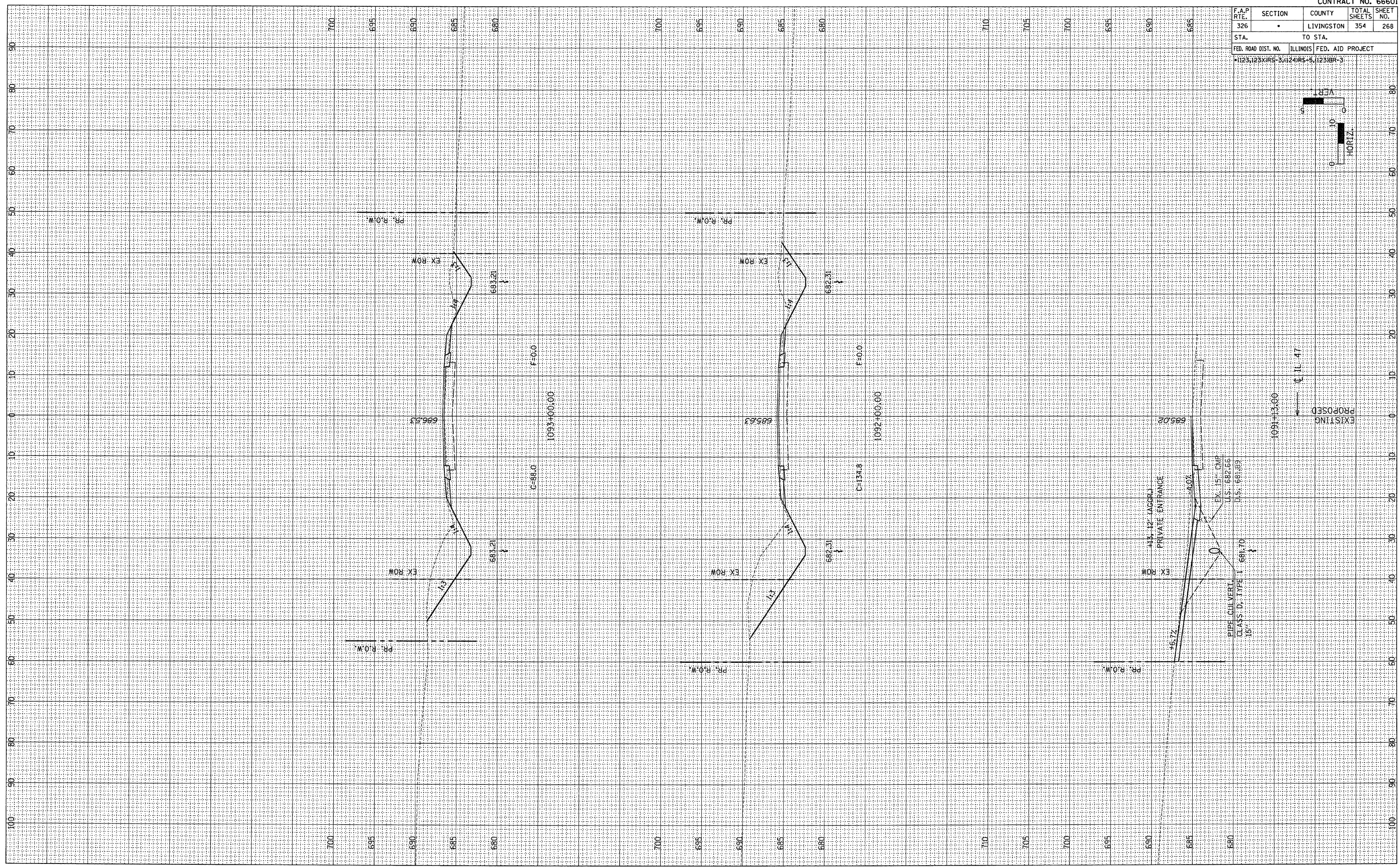
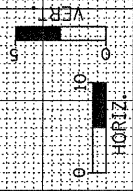

FINAL SURVEY	DATE	BY
REVISED		
NOTE BOOK		
NO.		

ORIGINAL SURVEY	DATE	BY
REVISED		
NOTE BOOK		
NO.		