

F.A.P. RTE. 326	SECTION •	COUNTY LIVINGSTON	TOTAL SHEETS 354	SHEET NO. 312
STA.		TO STA.		
FED. ROAD DIST. NO.		ILLINOIS		FED. AID PROJECT
•123123XRS-3		•124RS-5		•1231BR-3

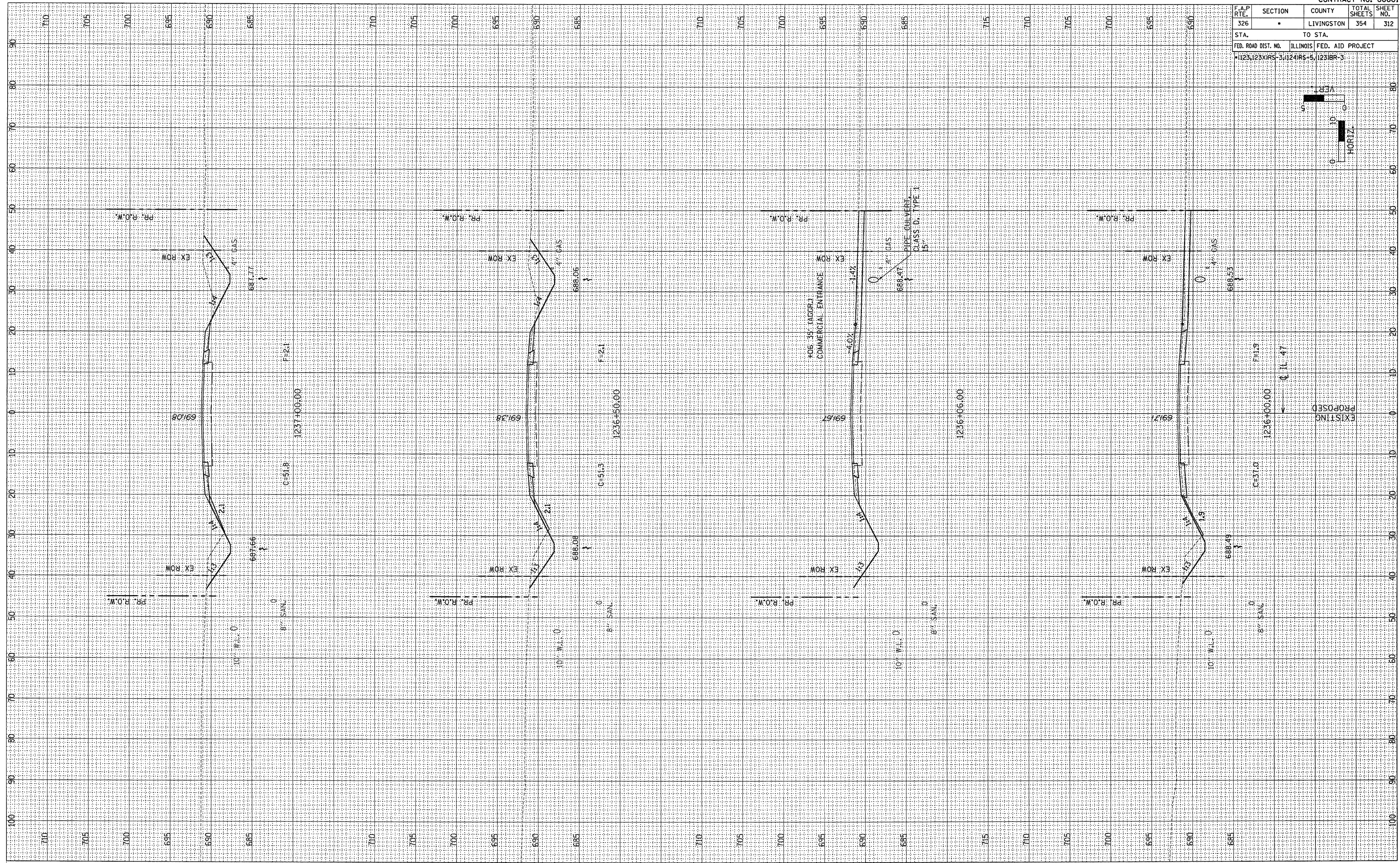
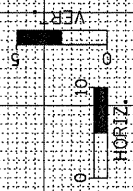

FINAL SURVEY	BY	DATE
SURVEYED		
NOTE BOOK		
NO.		

ORIGINAL SURVEY	BY	DATE
CONVISED		
NOTE BOOK		
NO.		