

F.A.P. RTE. 326	SECTION	COUNTY LIVINGSTON	TOTAL SHEETS 354	SHEET NO. 324
STA.	TO STA.			
FED. ROAD DIST. NO.	ILLINOIS FED. AID PROJECT			
*1231RS-3, 124RS-5, 1231ER-3				

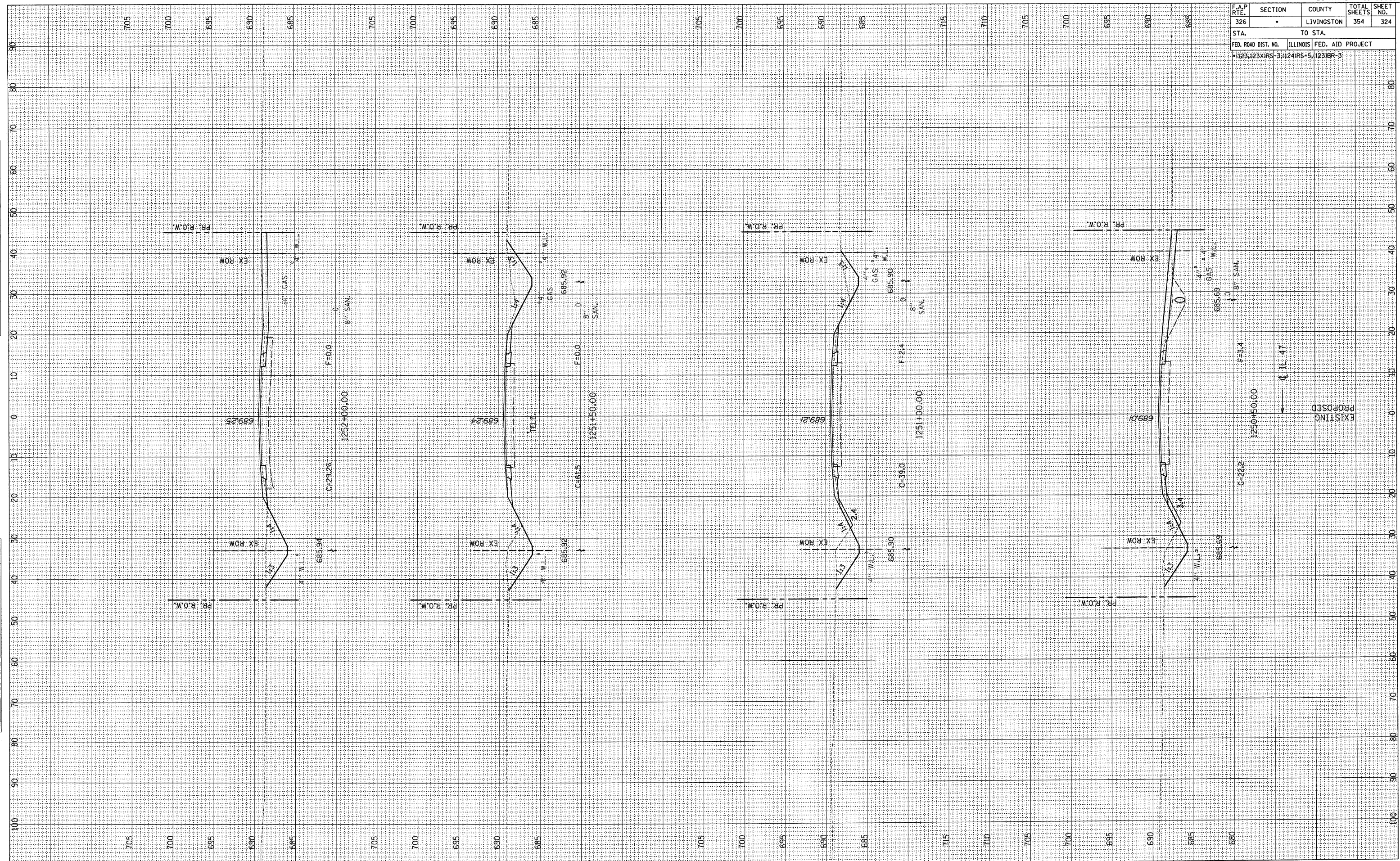

FINAL SURVEY PLOTTED BY DATE
 SURVEYED PLOTTED BY DATE
 NOTE BOOK NO. AREAS CHECKED

ORIGINAL SURVEY PLOTTED BY DATE
 SURVEYED PLOTTED BY DATE
 NOTE BOOK NO. AREAS CHECKED