

Contract # 66607

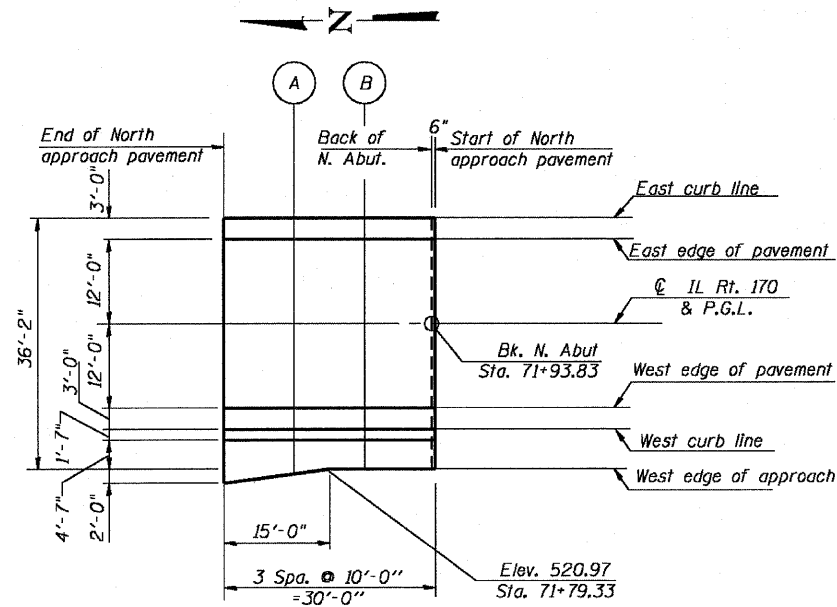

**PLAN (N. APPR. PAV'T.)**

**EAST CURB LINE**

| Location            | Station  | Offset | Theoretical Grade Elevations |
|---------------------|----------|--------|------------------------------|
| End N. Appr. Slab   | 71+64.33 | -15.00 | 520.37                       |
| A                   | 71+74.33 | -15.00 | 520.87                       |
| B                   | 71+84.33 | -15.00 | 521.37                       |
| Start N. Appr. Slab | 71+94.33 | -15.00 | 521.86                       |

**EAST EDGE OF PAVEMENT**

| Location            | Station  | Offset | Theoretical Grade Elevations |
|---------------------|----------|--------|------------------------------|
| End N. Appr. Slab   | 71+64.33 | -12.00 | 520.43                       |
| A                   | 71+74.33 | -12.00 | 520.93                       |
| B                   | 71+84.33 | -12.00 | 521.43                       |
| Start N. Appr. Slab | 71+94.33 | -12.00 | 521.93                       |

**P.G.L. & CL STAGE CONSTRUCTION JOINT**

| Location            | Station  | Offset | Theoretical Grade Elevations |
|---------------------|----------|--------|------------------------------|
| End N. Appr. Slab   | 71+64.33 | 0.00   | 520.62                       |
| A                   | 71+74.33 | 0.00   | 521.12                       |
| B                   | 71+84.33 | 0.00   | 521.62                       |
| Start N. Appr. Slab | 71+94.33 | 0.00   | 522.11                       |

**WEST EDGE OF PAVEMENT**

| Location            | Station  | Offset | Theoretical Grade Elevations |
|---------------------|----------|--------|------------------------------|
| End N. Appr. Slab   | 71+64.33 | 12.00  | 520.43                       |
| A                   | 71+74.33 | 12.00  | 520.93                       |
| B                   | 71+84.33 | 12.00  | 521.43                       |
| Start N. Appr. Slab | 71+94.33 | 12.00  | 521.93                       |

**WEST CURB LINE**

| Location            | Station  | Offset | Theoretical Grade Elevations |
|---------------------|----------|--------|------------------------------|
| End N. Appr. Slab   | 71+64.33 | 15.00  | 520.37                       |
| A                   | 71+74.33 | 15.00  | 520.87                       |
| B                   | 71+84.33 | 15.00  | 521.37                       |
| Start N. Appr. Slab | 71+94.33 | 15.00  | 521.86                       |

**WEST SIDEWALK EDGE**

| Location            | Station  | Offset | Theoretical Grade Elevations |
|---------------------|----------|--------|------------------------------|
| End N. Appr. Slab   | 71+64.33 | 23.17  | 520.20                       |
| A                   | 71+74.33 | 21.83  | 520.73                       |
| B                   | 71+84.33 | 21.17  | 521.24                       |
| Start N. Appr. Slab | 71+94.33 | 21.17  | 521.73                       |

|                |
|----------------|
| DESIGNED - DEV |
| CHECKED - RJC  |
| DRAWN - JHR    |
| CHECKED - RJC  |

**TOP OF SLAB ELEVATIONS  
NORTH APPROACH PAVEMENT  
IL. 170 F.A.P. 786 OVER  
ILLINOIS RIVER AT SENECA  
PUBLIC WATERS  
LA SALLE COUNTY, SECTION 109 BR  
STATION 79+04.42  
STRUCTURE NO. 050-0246**