

CROSS SECTION
LOOKING SOUTH

TYPE C MONODIRECTIONAL REFLECTORS ON TANGENT PORTION OF BARRIER AT 50' CTS.

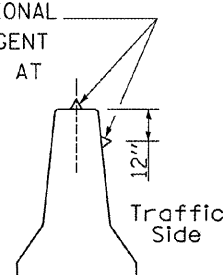

DETAIL A
(BARRIER WALL REFLECTORS)

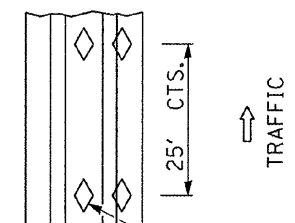

TOP VIEW
TYPE C MARKER (TYP.)

LENGEND

- Work Zone
- Temporary concrete barrier
- Impact attenuator

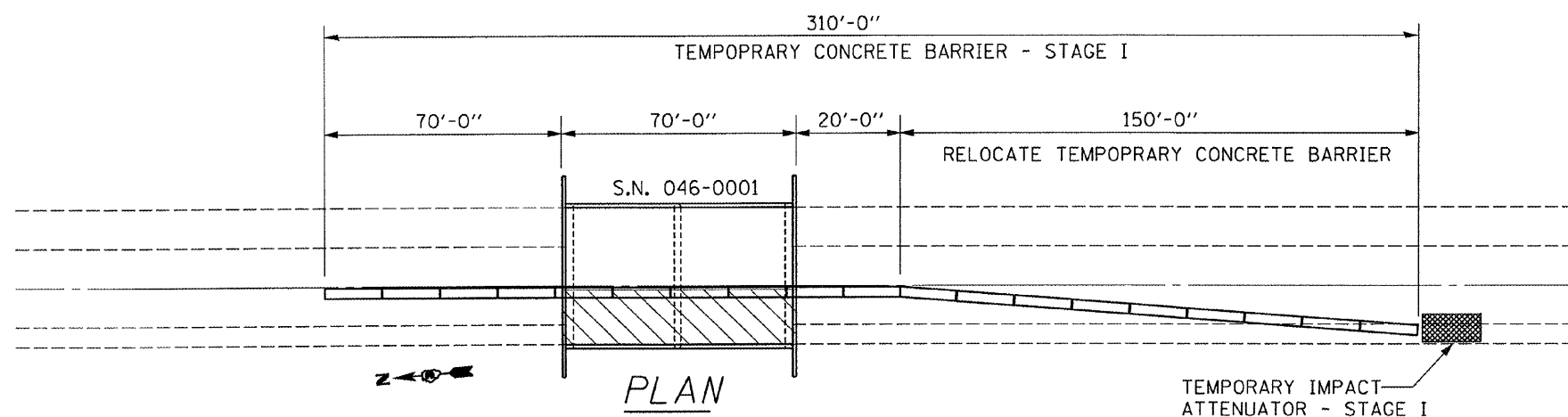

PLAN

TEMPORARY IMPACT ATTENUATOR - STAGE I

TOTAL BILL OF MATERIALS
S.N. 046-0001

ITEM		TOTAL
TEMPORARY CONCRETE BARRIER	FOOT	310
IMPACT ATTENUATOR, TEMPORARY (NON-REDIRECTIVE, TEST LEVEL 3)	EACH	1

NOTE:

THIS DETAIL SHALL BE USED IN CONJUNCTION WITH TRAFFIC CONTROL AND PROTECTION STANDARD 701402 (SPECIAL)

FILE NAME =	USER NAME = woodshankr	DESIGNED - RON WOODSHANK	REVISED -	STATE OF ILLINOIS DEPARTMENT OF TRANSPORTATION	TEMPORARY CONCRETE BARRIER DETAILS S.N. 046-0001	F.A.I. RTE.:	SECTION	COUNTY	TOTAL SHEETS	SHEET NO.
c:\projects\bridgepoint_08\046-0001 & 8	dn	DRAWN - RON WOODSHANK	REVISED -			57	4614VB,4B1BP	KANKAKEE	12	6
FLOT SCALE = 206.0058' / IN.		CHECKED -	REVISED -			SCALE:	SHEET NO. 6 OF 12 SHEETS	FED. ROAD DIST. NO.	ILLINOIS	CONTRACT NO. 66738
FLOT DATE = Dec 05, 2007 - 10:48:17 AM		DATE -	REVISED -							