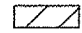
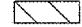

LEGEND

- TBR TO BE REMOVED
-  BUTT JOINT
-  BRIDGE DECK REM

① TRAFFIC BARRIER TERMINAL, TYPE 6A

S.N. 057-0191
 PROPOSED SINGLE SPAN PRECAST
 PRESTRESSED CONCRETE DECK
 BEAM SUPERSTRUCTURE ON
 EXISTING SUBSTRUCTURE
 53'-6" BK. TO BK. ABUTMENTS,
 32'-0" O. TO O. DECK,
 STA 1532+21, SKEW 0°.

PLAN	DESIGNED	DATE
	PLOTTED	
	CHECKED	
	BY	
	NO.	

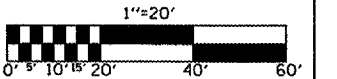
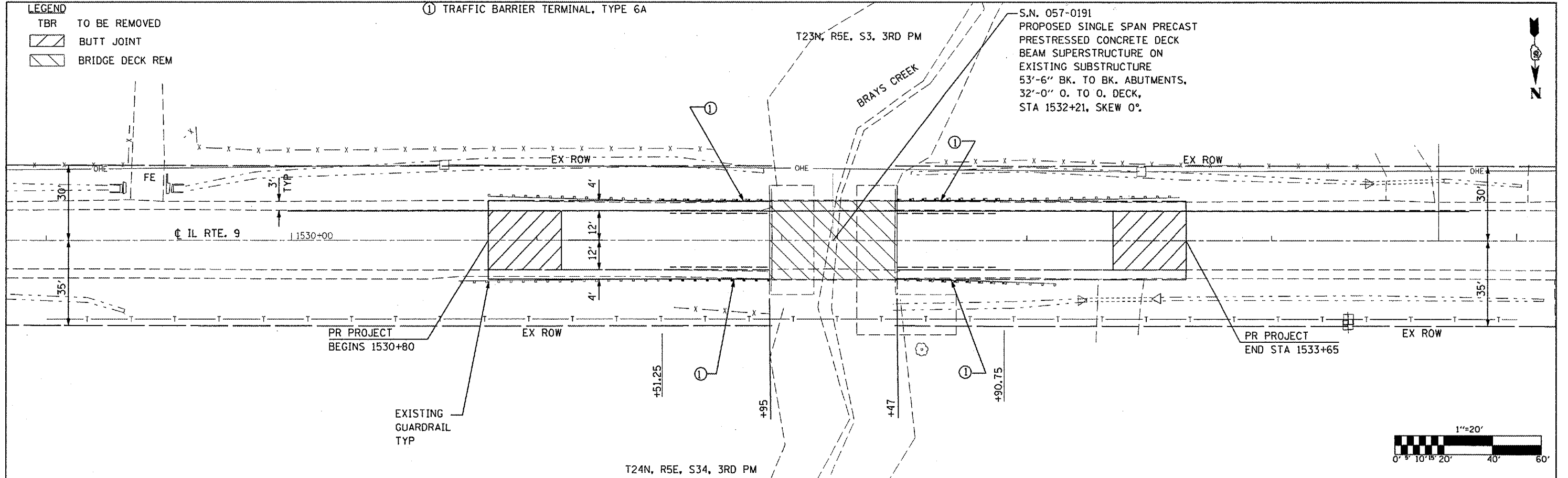

PROFILE	DESIGNED	DATE
	PLOTTED	
	CHECKED	
	BY	
	NO.	

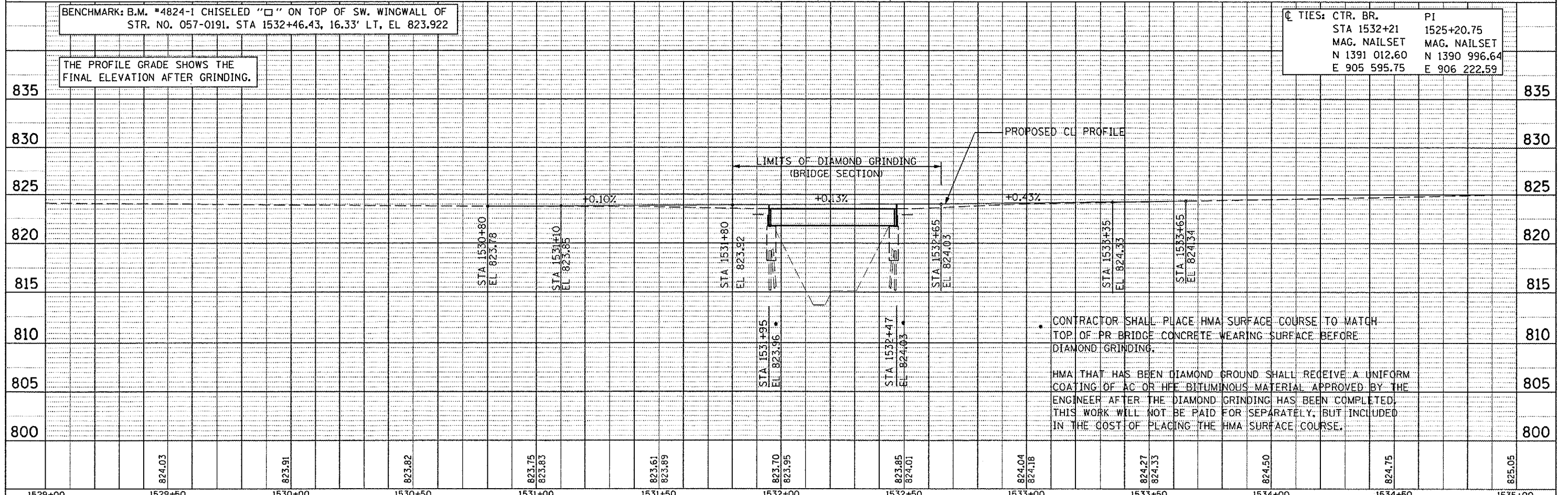

BENCHMARK: B.M. #4824-1 CHISELED "□" ON TOP OF SW. WINGWALL OF STR. NO. 057-0191. STA 1532+46.43, 16.33' LT, EL 823.922

THE PROFILE GRADE SHOWS THE FINAL ELEVATION AFTER GRINDING.

CTR. BR.	PI
STA 1532+21	1525+20.75
MAG. NAILSET	MAG. NAILSET
N 1391 012.60	N 1390 996.64
E 905 595.75	E 906 222.59

CONTRACTOR SHALL PLACE HMA SURFACE COURSE TO MATCH TOP OF PR BRIDGE CONCRETE WEARING SURFACE BEFORE DIAMOND GRINDING.
 HMA THAT HAS BEEN DIAMOND GROUND SHALL RECEIVE A UNIFORM COATING OF AC OR HFE BITUMINOUS MATERIAL APPROVED BY THE ENGINEER AFTER THE DIAMOND GRINDING HAS BEEN COMPLETED. THIS WORK WILL NOT BE PAID FOR SEPARATELY, BUT INCLUDED IN THE COST OF PLACING THE HMA SURFACE COURSE.

FILE NAME =	USER NAME = collierbw	DESIGNED -	REVISED -	STATE OF ILLINOIS DEPARTMENT OF TRANSPORTATION	PLAN AND PROFILE SHEET ILLINOIS ROUTE 9 OVER BRAYS CREEK	F.A. RTE.	SECTION	COUNTY	TOTAL SHEETS	SHEET NO.	
#FILE#BBREV#		DRAWN -	REVISED -			693	(2)BR-3)BR	McLean	23	6	
	PLOT SCALE = 40,0000' / IN.	CHECKED -	REVISED -			CONTRACT NO. 70610					
	PLOT DATE = 12/26/2007 #TIME#	DATE -	REVISED -			ILLINOIS FED. AID PROJECT					