

# SUMMARY OF QUANTITIES

LOCATION OF WORK:

FAI 74                      FAI 74  
 RURAL                      RURAL  
 STA. 1035+00  
 TO 1043+00  
 90% FED / 10% STATE    90% FED / 10% STATE  
 STR#                      STR#  
 057-0125(EB)            057-0126(WB)  
 X071-2A                      SFTY-2A

CONSTRUCTION TYPE CODE:

CODE NO	ITEM	UNIT	TOTAL QUANTITY	QUANTITY	QUANTITY
50500505	STUD SHEAR CONNECTORS	EACH	3,492.0	3,492.0	0.0
50606701	CLEANING AND PAINTING STRUCTURAL STEEL, LOCATION 1	L SUM	1.0	0.0	1.0
50800205	REINFORCEMENT BARS, EPOXY COATED	POUND	63,360	63,360	0.0
50800515	BAR SPLICERS	EACH	669	669	0.0
51100300	SLOPE WALL 6 INCH	SQ YD	56.0	56.0	0.0
51205200	TEMPORARY SHEET PILING	SQ FT	286	286	0.0
51500100	NAME PLATES	EACH	1.0	1.0	0.0
52100010	ELASTOMERIC BEARING ASSEMBLY, TYPE I	EACH	12.0	12.0	0.0
52100020	ELASTOMERIC BEARING ASSEMBLY, TYPE II	EACH	6.0	6.0	0.0
52100520	ANCHOR BOLTS, 1"	EACH	24.0	24.0	0.0
52100540	ANCHOR BOLTS, 1 1/2"	EACH	24.0	24.0	0.0
54213447	END SECTIONS 12"	EACH	1.0	1.0	0.0
54244405	FLUSH INLET BOX FOR MEDIAN, STANDARD 542546	EACH	2.0	2.0	0.0
542A0223	PIPE CULVERTS, CLASS A, TYPE 1 18"	FOOT	140.0	140.0	0.0
58700300	CONCRETE SEALER	SQ FT	806	806	0.0
59100100	GEOCOMPOSITE WALL DRAIN	SQ YD	47	47	0.0
60100945	PIPE DRAINS 12"	FOOT	50.0	50.0	0.0
60108100	PIPE UNDERDRAINS 4" (SPECIAL)	FOOT	100.0	100.0	0.0
60109580	PIPE UNDERDRAINS FOR STRUCTURES 4"	FOOT	100	100	0.0
60240235	INLETS, TYPE B, TYPE 5 FRAME, CLOSED LID	EACH	1.0	1.0	0.0
60900240	TYPE C INLET BOX, STANDARD 609006	EACH	2.0	2.0	0.0
60900515	CONCRETE THRUST BLOCKS	EACH	2.0	2.0	0.0
* 63000000	STEEL PLATE BEAM GUARD RAIL, TYPE A	FOOT	462.5	462.5	0.0
* 63100085	TRAFFIC BARRIER TERMINAL, TYPE 6	EACH	2.0	2.0	0.0
* 63100169	TRAFFIC BARRIER TERMINAL, TYPE 1(SPECIAL) FLARED	EACH	2.0	2.0	0.0
63200310	GUARDRAIL REMOVAL	FOOT	692.0	692.0	0.0
<del>63300205</del>	<del>REMOVAL AND REINSTALLATION OF EXISTING STEEL PLATE BEAM GUARD RAIL, TYPE A</del>	<del>FOOT</del>	<del>200.0</del>	<del>200.0</del>	<del>0.0</del>
<del>63300405</del>	<del>REMOVAL AND REINSTALLATION OF EXISTING TRAFFIC BARRIER TERMINAL, TYPE 1</del>	<del>EACH</del>	<del>1.0</del>	<del>1.0</del>	<del>0.0</del>
<del>63300455</del>	<del>REMOVAL AND REINSTALLATION OF EXISTING TRAFFIC BARRIER TERMINAL, TYPE 6</del>	<del>EACH</del>	<del>1.0</del>	<del>1.0</del>	<del>0.0</del>
64200105	SHOULDER RUMBLE STRIP	FOOT	2,073.0	1,073.0	1,000.0

\* DENOTES SPECIALITY ITEM

2 REVISIED 2/27/08

FILE NAME = c:\projects\d505207 (v8)\70672_text.dgn	USER NAME = collierbw	DESIGNED -	REVISED -	STATE OF ILLINOIS DEPARTMENT OF TRANSPORTATION	I-74 OVER KICKAPOO CREEK - SUMMARY OF QUANTITIES	F.A.I. RTE. 74	SECTION (57-22)BR-3	COUNTY MCLEAN	TOTAL SHEETS 42	SHEET NO. 5
PLOT SCALE = 41.5800' / IN.	CHECKED -	DATE -	REVISED -	SCALE:	SHEET NO. OF SHEETS	STA.	TO STA.	CONTRACT NO. 70672 FED. ROAD DIST. NO. ILLINOIS FED. AID PROJECT		

DATE	
BY	
REVIEWED	
DESIGNED	
CHECKED	
DATE	
NO.	
PLAN	
NOTE BOOK	
NO.	
FILE NAME	
FILE NAME	

DATE	
BY	
REVIEWED	
DESIGNED	
CHECKED	
DATE	
NO.	
PROFILE	
NOTE BOOK	
NO.	
FILE NAME	
FILE NAME	

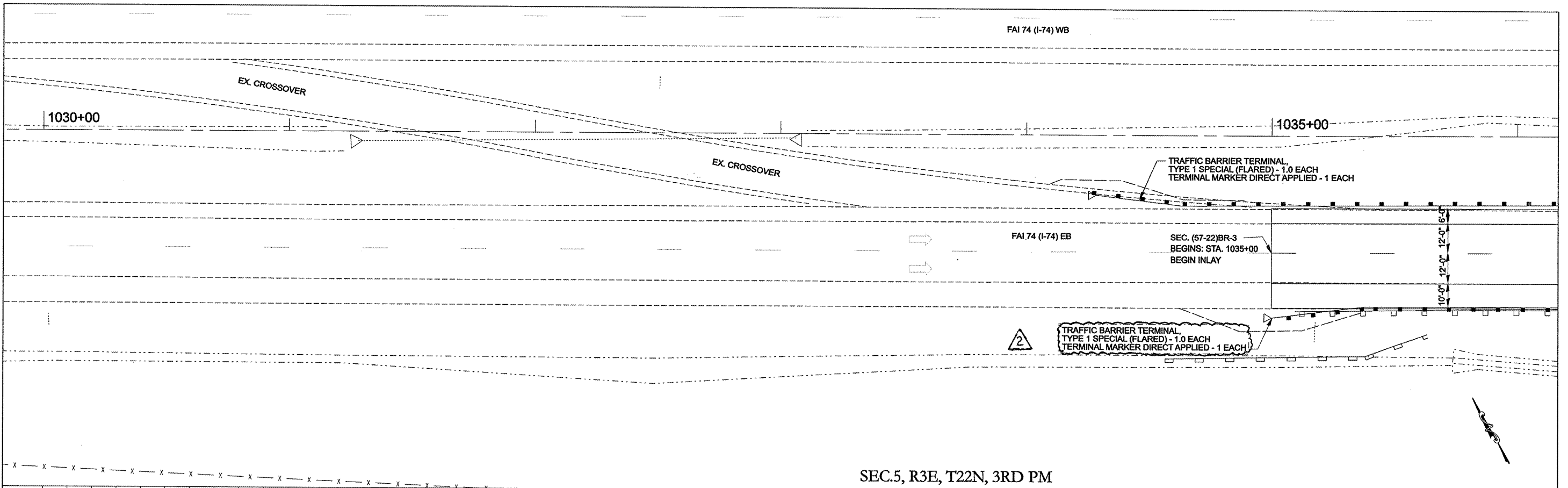

SEC.5, R3E, T22N, 3RD PM

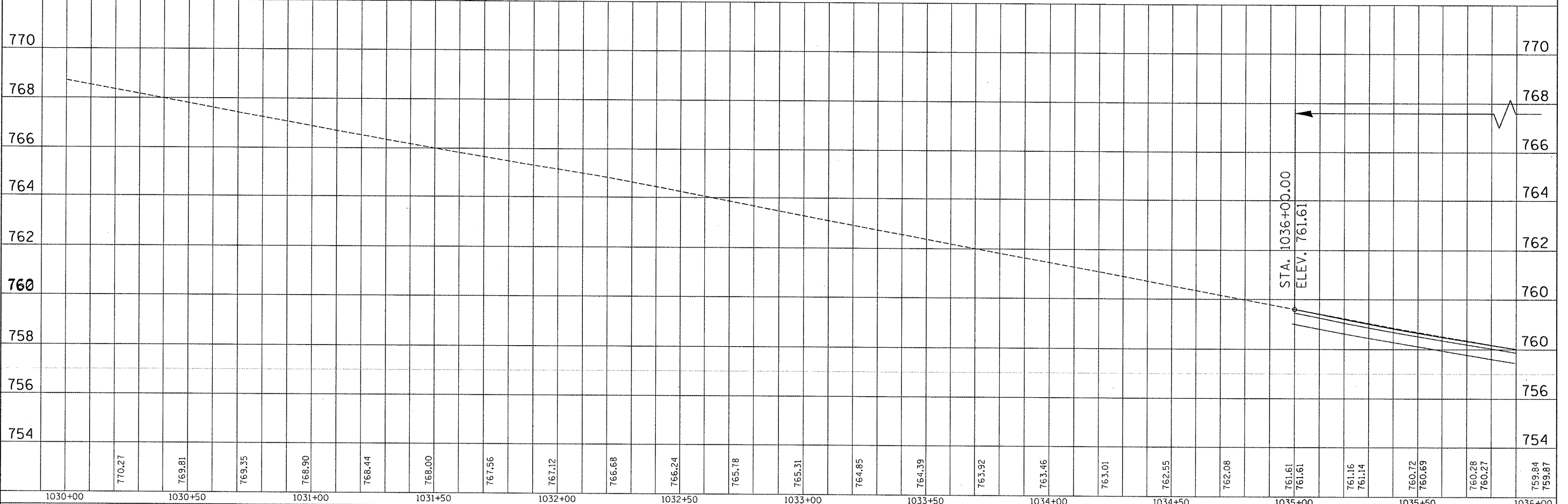

FILE NAME =	USER NAME = collierbw	DESIGNED -	REVISED -	<p align="center"><b>STATE OF ILLINOIS</b> <b>DEPARTMENT OF TRANSPORTATION</b></p>	<p align="center"><b>I-74 OVER KICKAPOO CREEK PLAN &amp; PROFILE SHEETS</b></p>	F.A.I. RTE.	SECTION	COUNTY	TOTAL SHEETS	SHEET NO.	
ci:\projects\d505207 (v8)\70672.plansheets.dgn		DRAWN -	REVISED -			74	(57-22)BR-3	MCLEAN	42	9	
PLOT SCALE = 40.0000' / IN.		CHECKED -	REVISED -			CONTRACT NO. 70672					
PLOT DATE = 2/27/2008		DATE -	REVISED -			FED. ROAD DIST. NO. ILLINOIS FED. AID PROJECT					

DATE	
BY	
REVISIONS	
PLANNED	
ALIGNED	
CHECKED	
DATE	
NO.	
PLAN	
NOTE BOOK	
NO.	

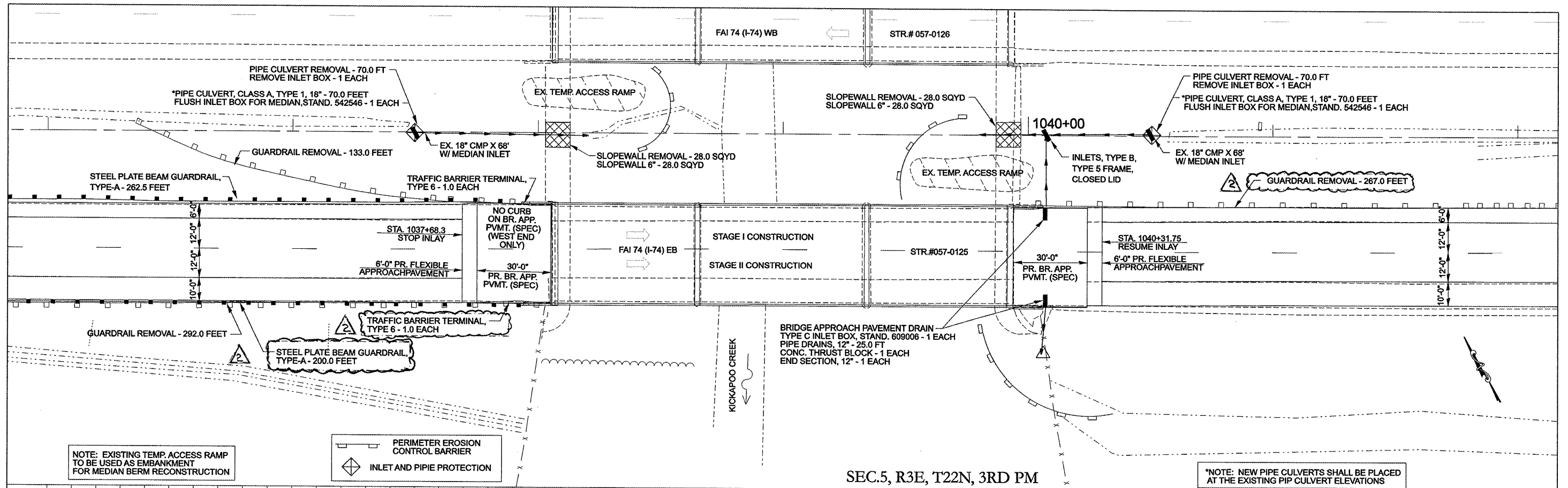

DATE	
BY	
REVISIONS	
PLANNED	
GRADES CHECKED	
STRUCTURE	
NOTATION	
CHECKED	
NO.	
PROFILE	
NOTE BOOK	
NO.	

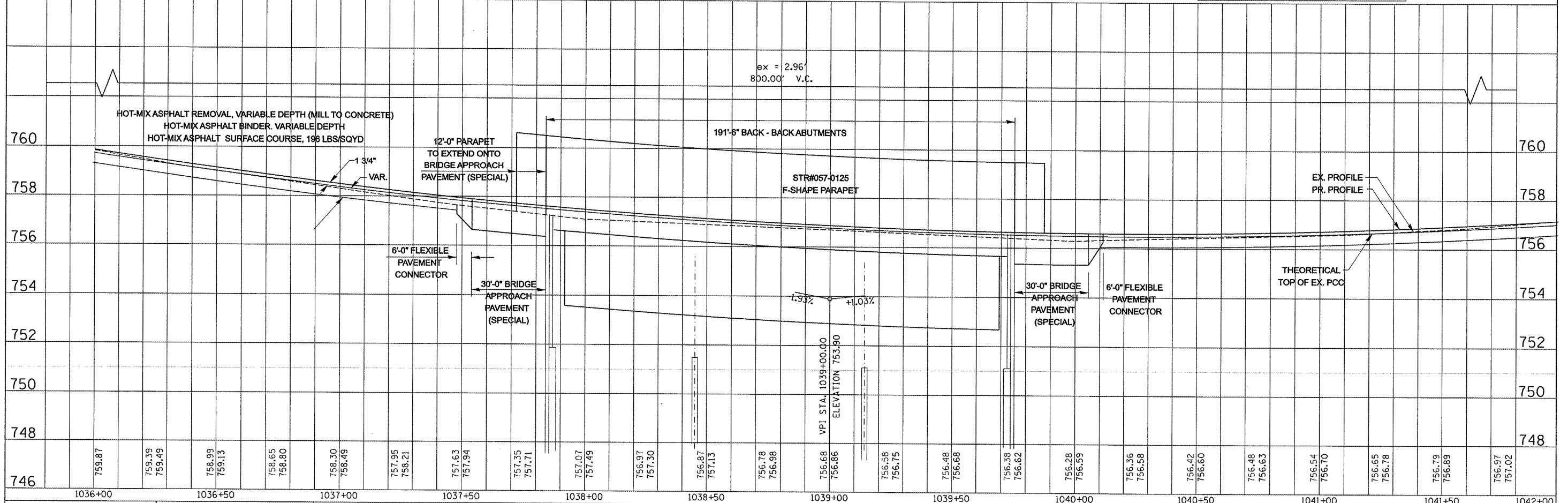

FILE NAME =	USER NAME = collierbw	DESIGNED -	REVISED -	<p align="center"><b>STATE OF ILLINOIS</b> <b>DEPARTMENT OF TRANSPORTATION</b></p> <p align="center"><b>I-74 OVER KICKAPOO CREEK PLAN &amp; PROFILE SHEETS</b></p> <p>SCALE: 20      SHEET NO.    OF    SHEETS    STA. 1036+00 TO STA. 1042+00</p>	F.A.I R.T.E.	SECTION	COUNTY	TOTAL SHEETS	SHEET NO.
744		DRAWN -	REVISED -		74	(57-22)BR-3	MCLEAN	42	10
		CHECKED -	REVISED -		CONTRACT NO. 70672				
		DATE -	REVISED -		FED. ROAD DIST. NO.    ILLINOIS FED. AID PROJECT				

REVISED 02/27/08 CMS

PLAN	DATE
BY	
DESIGNED	
CHECKED	
ALIGNED	
NOTED	
FILE NAME	

PROFILE	DATE
BY	
DESIGNED	
CHECKED	
ALIGNED	
NOTED	
FILE NAME	

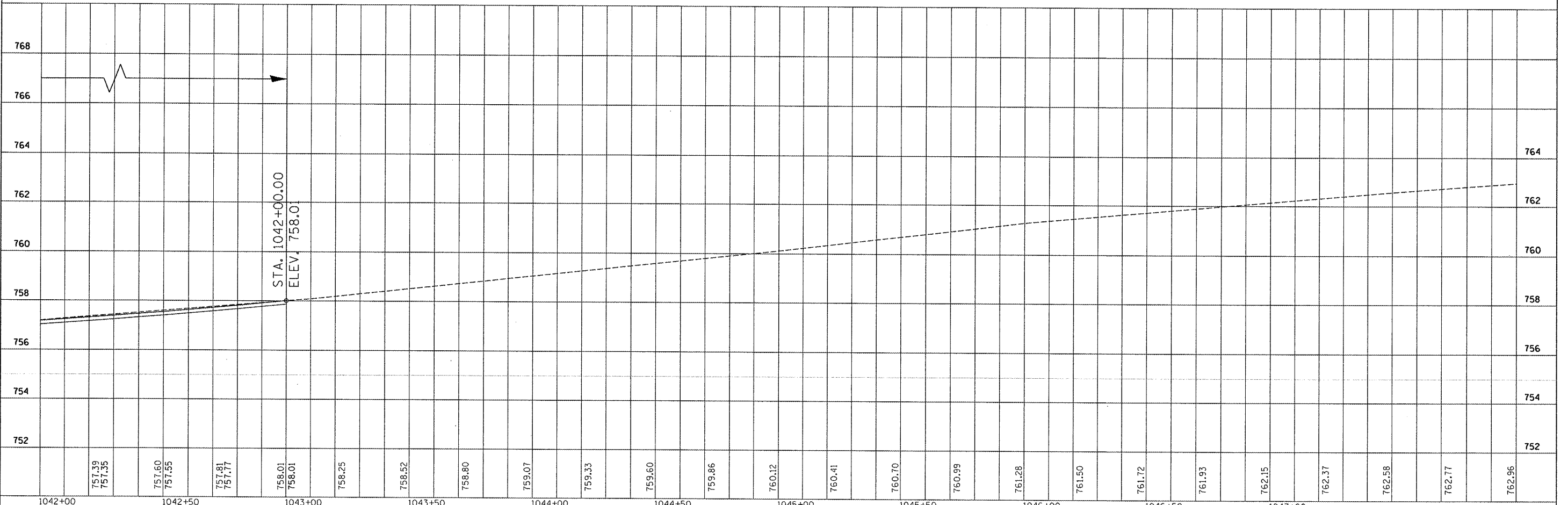
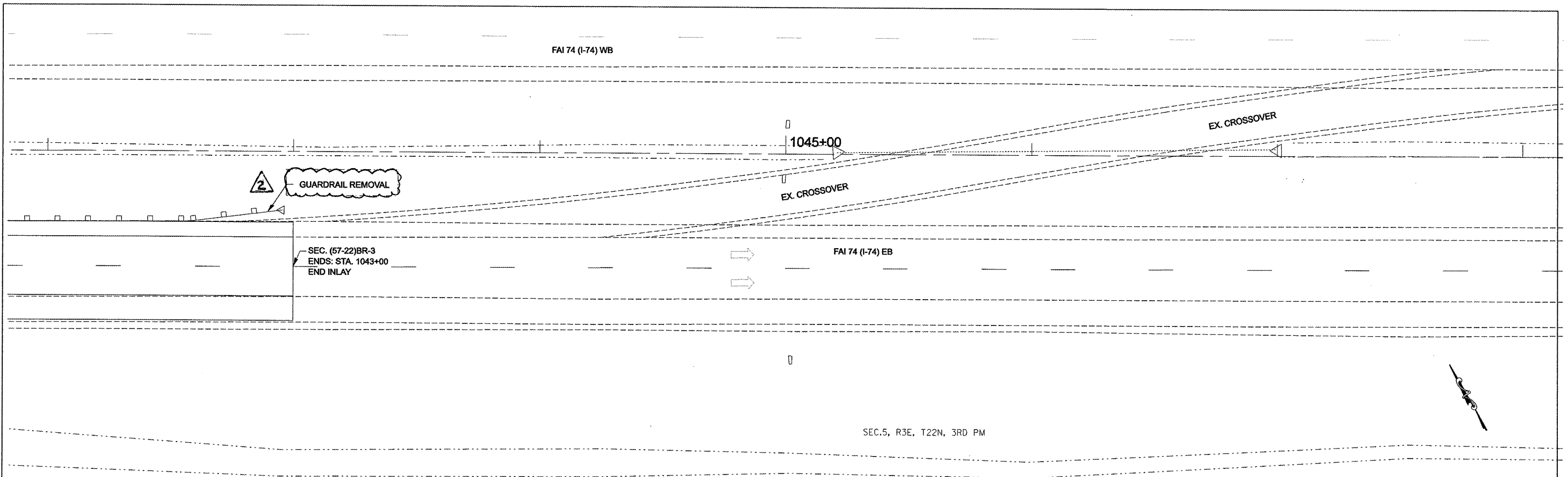

FILE NAME =	USER NAME = collierbw	DESIGNED -	REVISED -	<b>STATE OF ILLINOIS</b> <b>DEPARTMENT OF TRANSPORTATION</b>	<b>I-74 OVER KICKAPOO CREEK PLAN &amp; PROFILE SHEETS</b>	F.A.I. RTE.	SECTION	COUNTY	TOTAL SHEETS	SHEET NO.
cr:\projects\505207 (w8)\70672_plansheets.dgn		DRAWN -	REVISED -			74	(57-22)BR-3	MCLEAN	42	11
PLOT SCALE = 40.0000' / IN.		CHECKED -	REVISED -			CONTRACT NO. 70672				
PLOT DATE = 2/27/2008		DATE -	REVISED -			FED. ROAD DIST. NO. ILLINOIS FED. AID PROJECT				