

PLAN	SURVEYED	DATE
	PLOTTED	BY
	CHECKED	
	ALIGNED	
	FILE NAME	
	NO.	

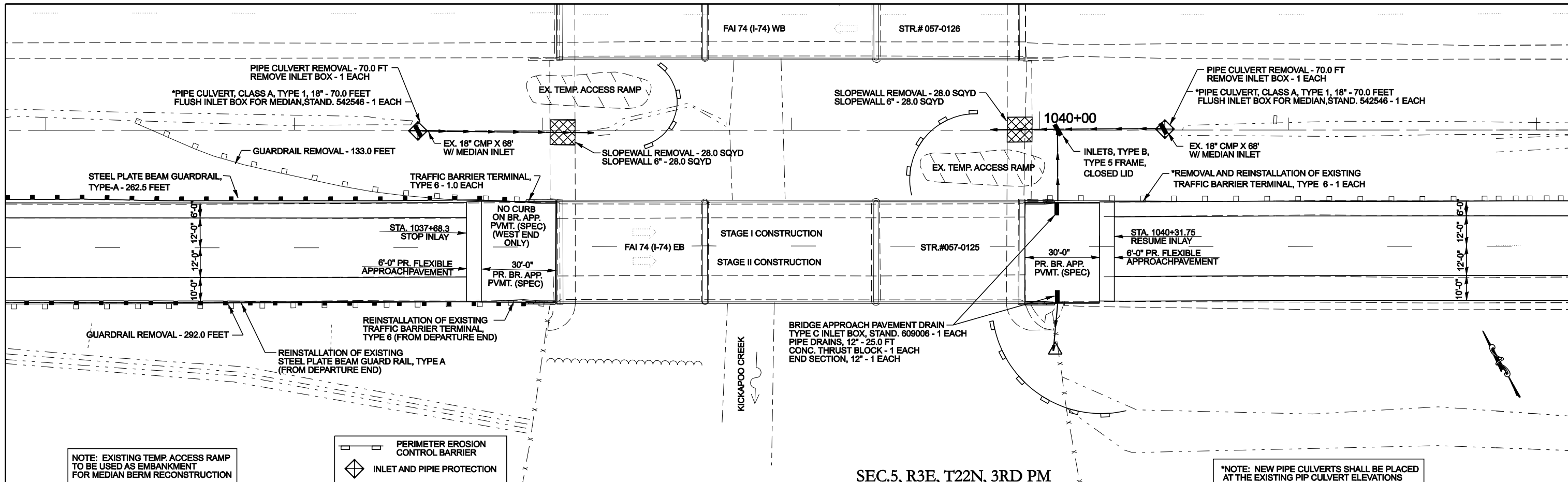

NOTE: EXISTING TEMP. ACCESS RAMP TO BE USED AS EMBANKMENT FOR MEDIAN BERM RECONSTRUCTION

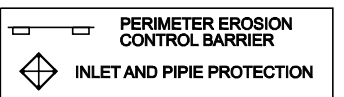

*NOTE: NEW PIPE CULVERTS SHALL BE PLACED AT THE EXISTING PIPE CULVERT ELEVATIONS

SEC.5, R3E, T22N, 3RD PM

PROFILE	SURVEYED	DATE
	PLOTTED	BY
	CHECKED	
	GRADES	
	STRUCTURE	
	NOTATIONS	
	CHRD	
	NO.	

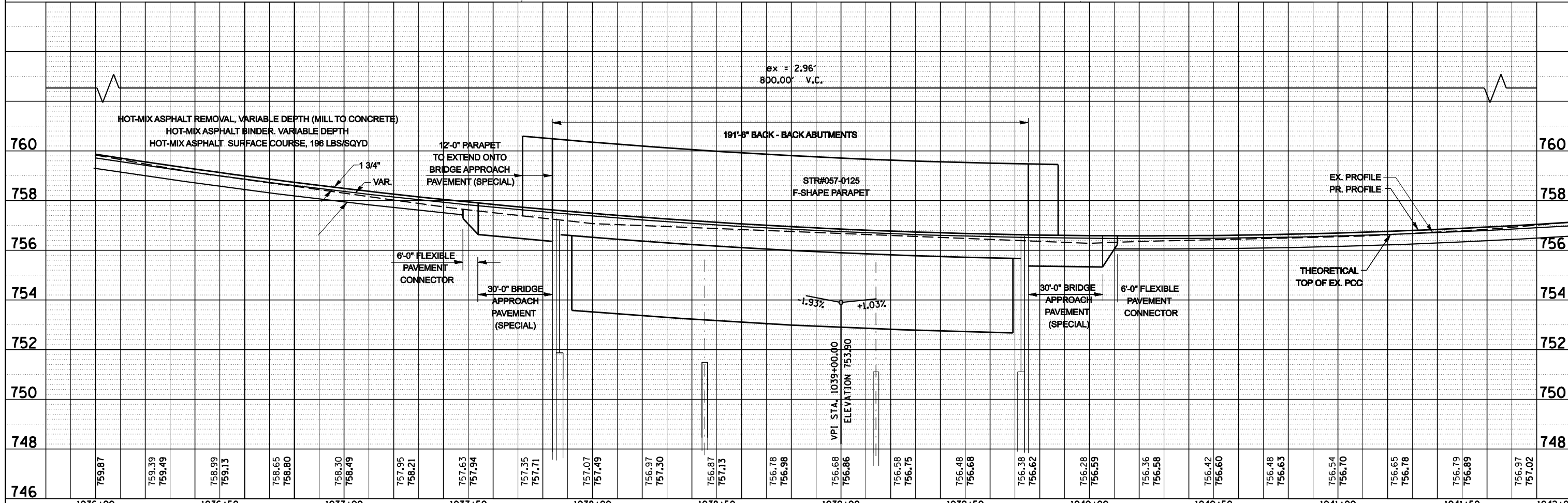

FILE NAME =	USER NAME = collierbw	DESIGNED -	REVISED -
744		DRAWN -	REVISED -
	PLOT SCALE = 40.0000' / IN.	CHECKED -	REVISED -
	PLOT DATE = 12/21/2007	DATE -	REVISED -

STATE OF ILLINOIS
DEPARTMENT OF TRANSPORTATION

I-74 OVER KICKAPOO CREEK PLAN & PROFILE SHEETS

SCALE: 20 SHEET NO. OF SHEETS STA. 1036+00 TO STA. 1042+00

F.A.I. RTE.	SECTION	COUNTY	TOTAL SHEETS	SHEET NO.
74	(57-22)BR-3	MCLEAN		
CONTRACT NO. 70672				
FED. ROAD DIST. NO. ILLINOIS FED. AID PROJECT				