

WIDTH RESTRICTION SIGNING

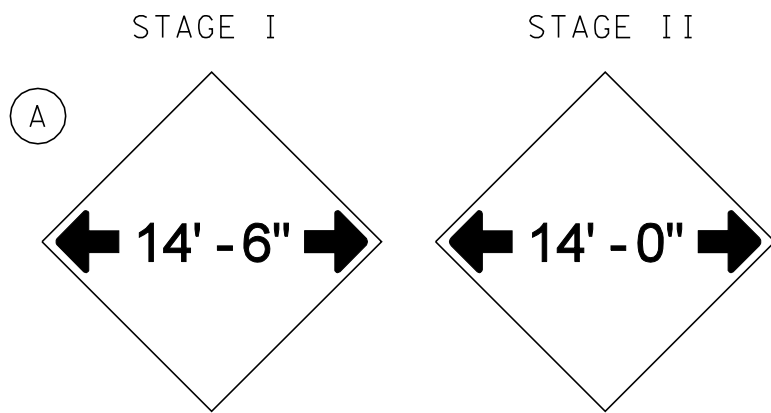

W12-I102-48"x48" - ORANGE (O)

- SIGN (A) 2 SIGNS - W12-2(O)-48"x48" - ORANGE (O)
1. TO BE PLACED 200' SOUTH OF OF US-51 NB TO I-74 EB RAMP
 2. TO BE PLACED JUST PRIOR TO I-74 BRIDGE ON US-51 BUS. SB TO I-74 EB RAMP

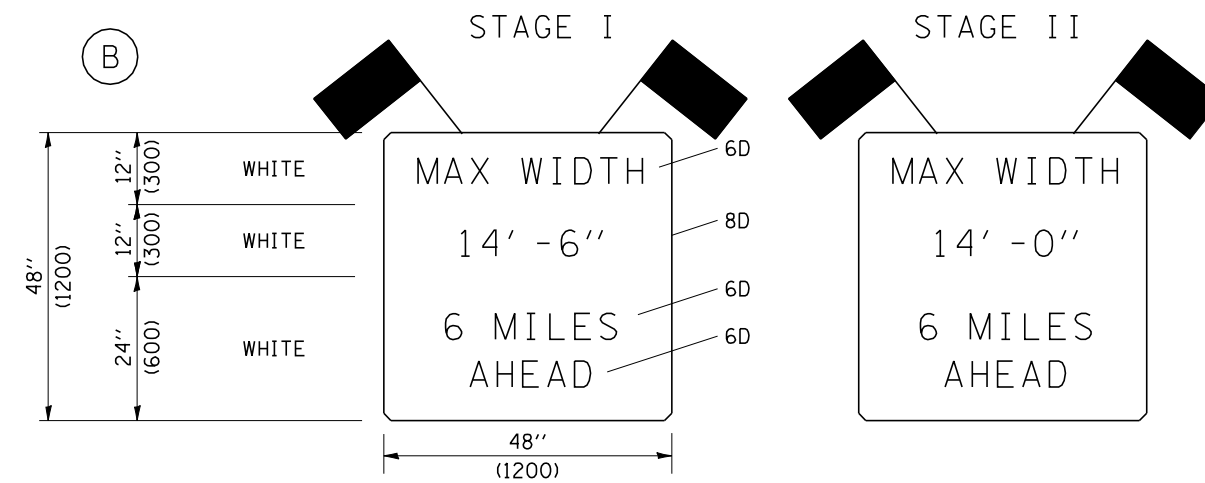

W12-I103-48"x48" - WHITE

- SIGN (B) 2 SIGNS - W12-I103 - 48" X 48" WHITE
AS SHOWN ARE TO BE PLACED
FLAGS REQUIRED
PLACED APPROXIMATELY
1/4 MILES WEST OF US-51 (DUAL DISPLAY) ON I-74EB

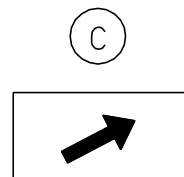

M6-2R 21" X 15" ORANGE (O)
PLACED UNDER (A) SIGNS

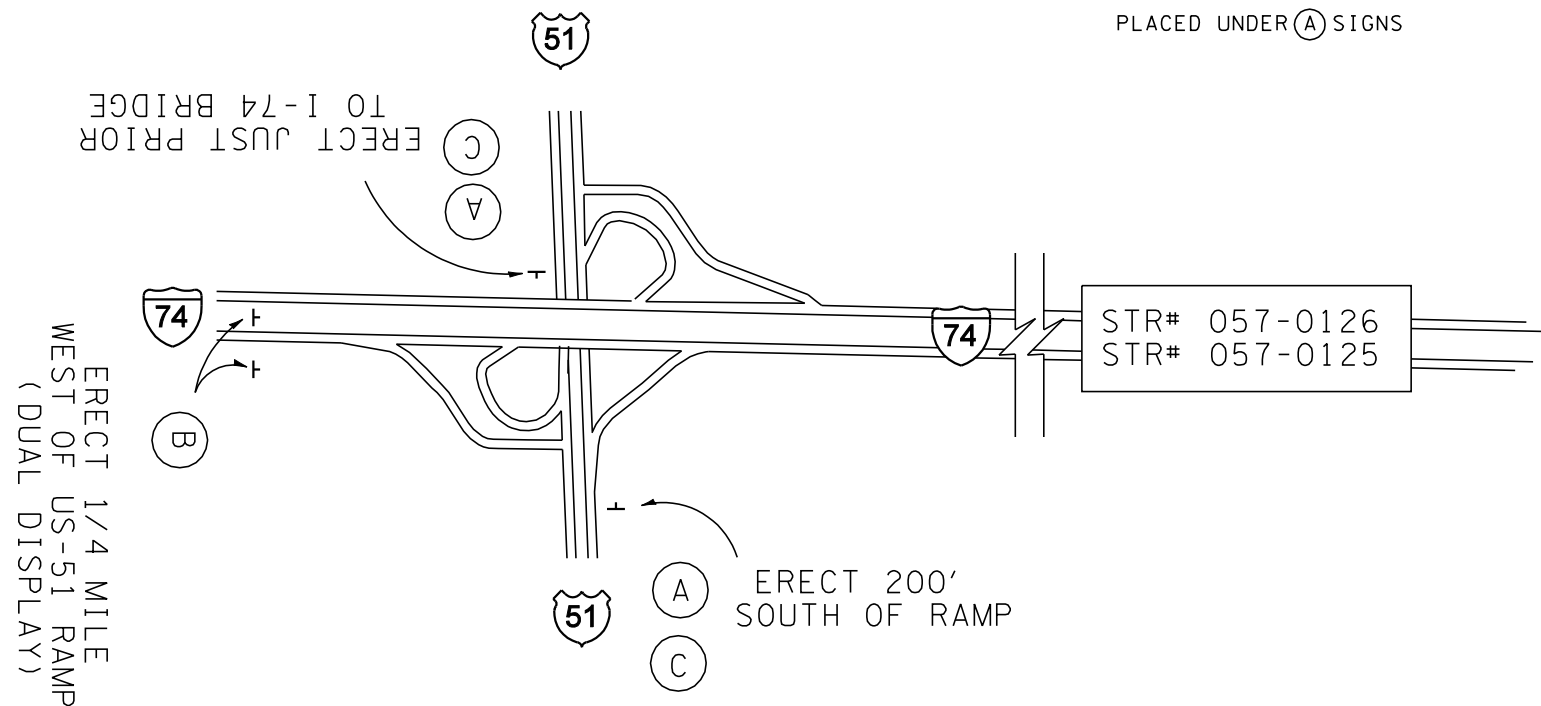

NOTE: STAGE I 14' -6"
STAGE II 14' -0"

GENERAL NOTES

NOTE: STAGE I WIDTH 14' -6" STAGE II WIDTH 14' -0"

1. ALL TRAFFIC CONTROL DEVICES SHALL BE FURNISHED, ERECTED AND MAINTAINED BY THE CONTRACTOR.
2. ALL (B) SIGNS SHALL HAVE FLAGS INSTALLED UNLESS OTHERWISE DIRECTED.
3. LOCATIONS OF TRAFFIC CONTROL DEVICES MAY BE ADJUSTED BY THE ENGINEER.
4. ALL TRAFFIC CONTROL SHOWN ON THIS SHEET SHALL BE PAID FOR AT THE CONTRACT LUMP SUM PRICE FOR WIDTH RESTRICTION SIGNING.
5. ALL SIGNS SHALL BE POST MOUNTED UNLESS OTHERWISE DIRECTED.
6. ALL SIGNS SHOWN ORANGE (O) SHALL BE FLUORESCENT ORANGE.

Note: All dimensions are in INCHES
(millimeters) unless otherwise shown.

DISTRICT 5 DETAIL NO. X7200201

FILE NAME = c:\projects\d505207 (v8)\70672-stage.dgn	USER NAME = collierbw	DESIGNED -	REVISED - 11/06	STATE OF ILLINOIS DEPARTMENT OF TRANSPORTATION	WIDTH RESTRICTION SIGNING	F.A. I RTE. 74	SECTION (57-22)BR-3	COUNTY MCLEAN	TOTAL SHEETS	SHEET NO.
	PLOT SCALE = 100.0000' / IN.	DRAWN -	REVISIED -			CONTRACT NO. 70672				
	PLOT DATE = 12/21/2007	CHECKED -	REVISIED -		SCALE:	SHEET NO. OF SHEETS		STA. TO STA.		FED. ROAD DIST. NO. ILLINOIS FED. AID PROJECT

DESIGNER NOTE: PROVIDE MAP WITH SIGN LOCATIONS (A, B, ETC.) AND COORDINATE WITH TRAFFIC OPERATIONS ENGINEER.
INCLUDE DISTRICT SPECIAL PROVISION "WIDTH RESTRICTION SIGNING"