

CONTRACT NO. 72943

F.A.U. RTE.	SECTION	COUNTY	TOTAL SHEETS	SHEET NO.
11RS-8		ADAMS	64	33

STA. **	TO STA. **
FED. ROAD DIST. NO.	ILLINOIS FED. AID PROJECT

- 7810 & 7825 (IL 96)
- IL 96 - 2350+00.00 TO 2361+50.00
- STATE ST. - 34+00.00 TO 33+00.00
- 24TH ST. - 4+00.00 TO 4+50.00

(From Pg. 32)

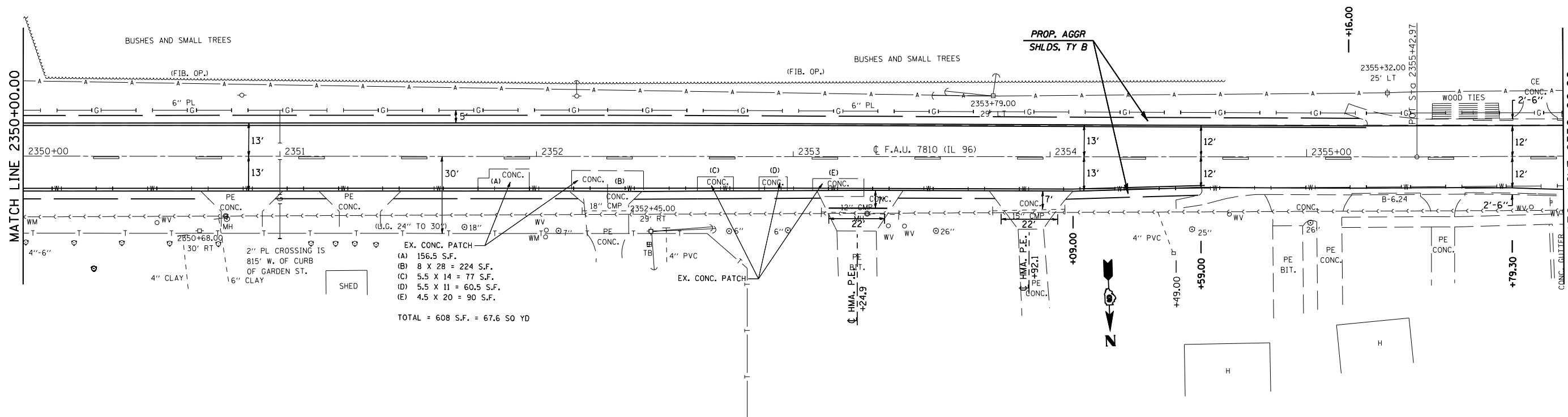

- EX. CONC. PATCH
- (A) 156.5 S.F.
 - (B) 8 X 28 = 224 S.F.
 - (C) 5.5 X 14 = 77 S.F.
 - (D) 5.5 X 11 = 60.5 S.F.
 - (E) 4.5 X 20 = 90 S.F.
- TOTAL = 608 S.F. = 67.6 SQ YD

(Cont. on Pg. 35)

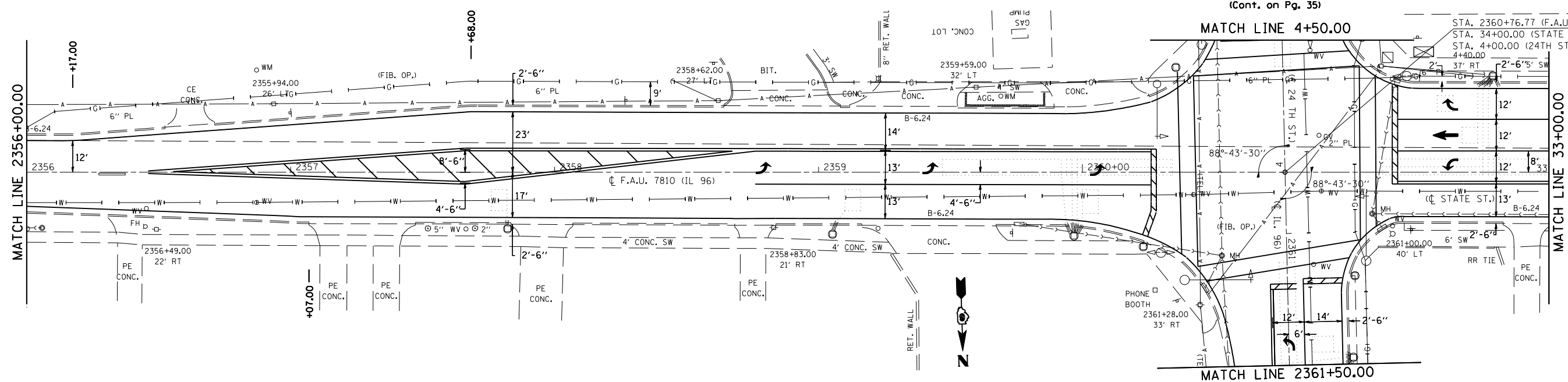

(Cont. on Pg. 34)

REVISIONS	
NAME	DATE

ILLINOIS DEPARTMENT OF TRANSPORTATION

PLAN VIEW

F.A.U. Route 7810 & 7825 (IL 96)
Section 11 RS-8
ADAMS COUNTY

SCALE: VERT. 1" = 10'
HORIZ. 1" = 40'

DATE: FEBRUARY 2, 2006

DRAWN BY: JWC
CHECKED BY: RSC

PLOT DATE = Nov-02-2007 01:14:50PM
FILE NAME = c:\p\projects\650605\sh\plan11rs.dgn
PLOT SCALE = 42.3525' / IN.
USER NAME = laughlin-1