

F.A.U. RTE.	SECTION	COUNTY	TOTAL SHEETS	SHEET NO.
11RS-8	ADAMS	64	41	
STA. ** TO STA. **		ILLINOIS FED. AID PROJECT		
FED. ROAD DIST. NO.		FED. AID PROJECT		
• 7810 & 7825 (IL 96) • IL 96 - 2350+00.00 TO 2361+50.00 • STATE ST. - 34+00.00 TO 33+00.00 • 24TH ST. - 4+00.00 TO 4+50.00				

(From Pg. 40)

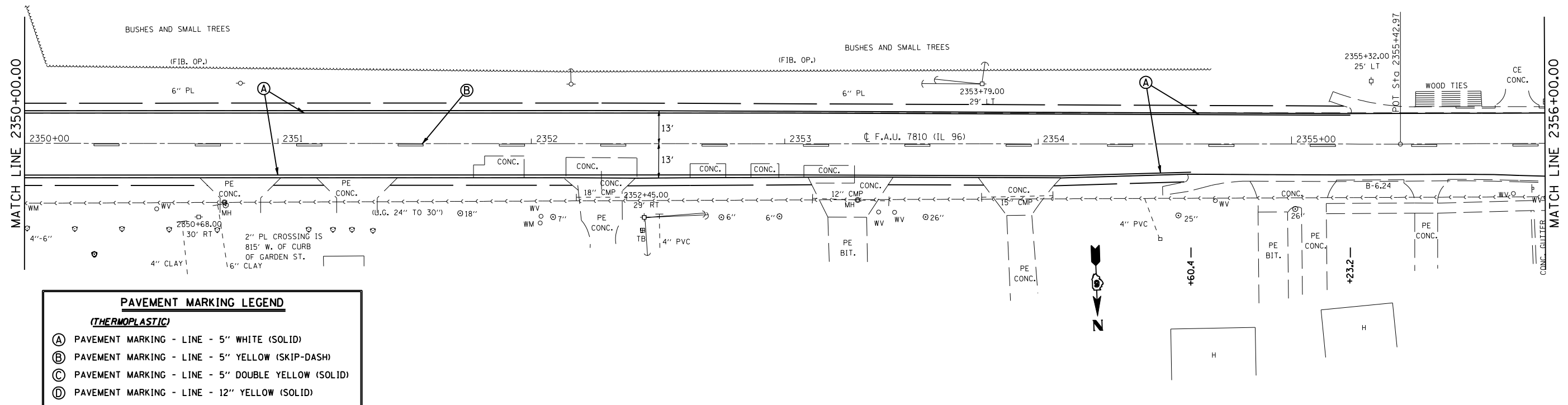

PAVEMENT MARKING LEGEND	
<i>(THERMOPLASTIC)</i>	
(A)	PAVEMENT MARKING - LINE - 5" WHITE (SOLID)
(B)	PAVEMENT MARKING - LINE - 5" YELLOW (SKIP-DASH)
(C)	PAVEMENT MARKING - LINE - 5" DOUBLE YELLOW (SOLID)
(D)	PAVEMENT MARKING - LINE - 12" YELLOW (SOLID)
<i>(PREFORMED PLASTIC, TYPE B)</i>	
(E)	PAVEMENT MARKING - LINE - 6" WHITE (SOLID)
(F)	PAVEMENT MARKING - LINE - 6" WHITE (SKIP-DASH)
(G)	PAVEMENT MARKING - LINE - 24" WHITE (SOLID)
(H)	PAVEMENT MARKING - LETTERS & SYMBOLS WHITE (SOLID)

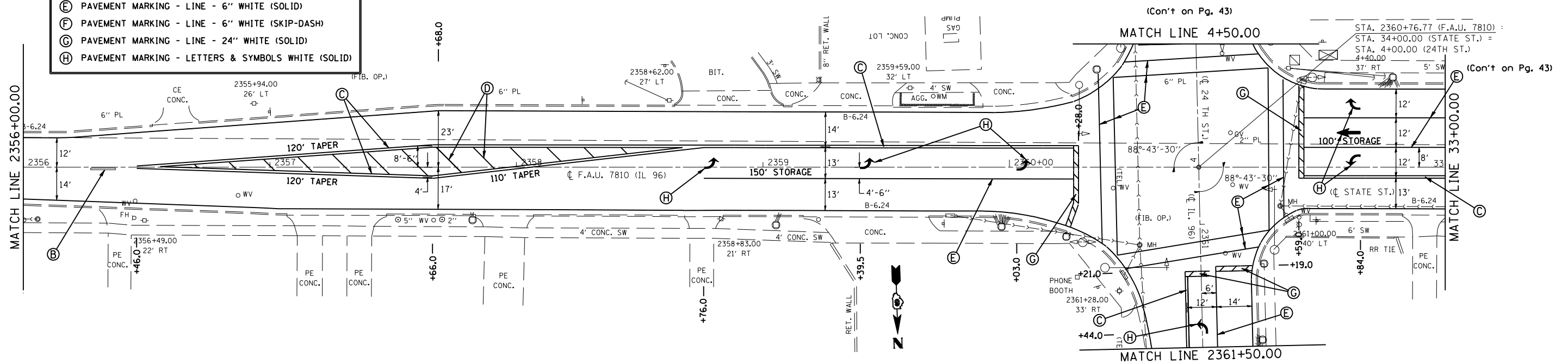

REVISIONS	
NAME	DATE

ILLINOIS DEPARTMENT OF TRANSPORTATION
PAVEMENT MARKING DETAIL
 F.A.U. Route 7810 & 7825 (IL 96)
 Section 11 RS-8
 ADAMS COUNTY
 SCALE: VERT. 1"=10'
 HORIZ. 1"=40'
 DATE: FEBRUARY 1, 2006
 DRAWN BY: JWC
 CHECKED BY: RSC

PLOT DATE = Nov-02-2007 01:14:59PM
 FILE NAME = c:\projects\650605\shpvtmrk196.dgn
 PLOT SCALE = 42.352% / IN.
 USER NAME = laughlin-1