

CONTRACT NO. 72943

F.A.U. RTE.	SECTION	COUNTY	TOTAL SHEETS	SHEET NO.
*	11RS-8	ADAMS	64	46

STA. **	TO STA. **
FED. ROAD DIST. NO.	ILLINOIS FED. AID PROJECT

* 7810 & 7825 (IL 96)
 ** IL 96 - 2358+00.00 to 2364+00.00
 STATE ST. - 31+00.00 to 34+00.00
 24TH ST. - 4+00.00 to 6+00.00

TRAFFIC SIGNAL QUANTITIES

24TH & STATE

QUANTITY	UNIT	ITEM
1,564.0	FOOT	DETECTOR LOOP, TYPE 1

THE FOLLOWING LOOPS SHALL NOT BE REPLACED

- ELV
- NLV
- SLV
- WLV

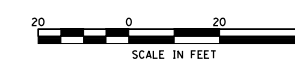
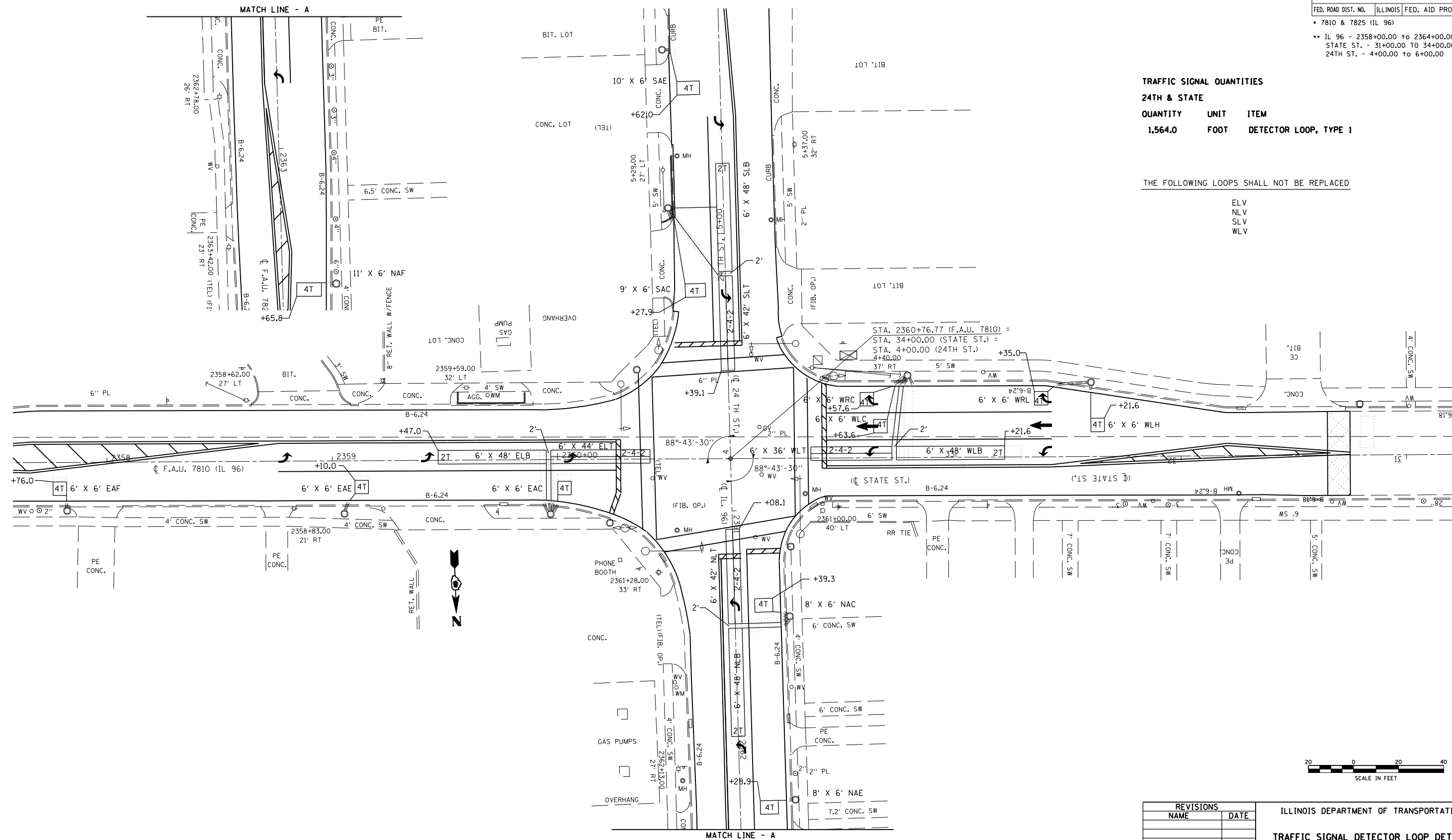

REVISIONS	
NAME	DATE

ILLINOIS DEPARTMENT OF TRANSPORTATION
TRAFFIC SIGNAL DETECTOR LOOP DETAILS
 F.A.U. Route 7810 & 7825 (IL 96)
 Section 11 RS-8
 ADAMS COUNTY
 SCALE: VERT. DRAWN BY: JWC
 HORIZ. CHECKED BY: RSC
 DATE: JULY 23, 2007

PLOT DATE = Nov-02-2007 01:15:04PM
 FILE NAME = c:\projects\650605\ts_sheets.dgn
 PLOT SCALE = 42.352% / IN.
 USER NAME = laughlin-1