

F.A.P. RTE.	SECTION	COUNTY	TOTAL SHEETS	SHEET NO.
320	-	LOGAN	12	1

D-6 SHLDR RUMBLE STRIPS 2008-4

STATE OF ILLINOIS  
DEPARTMENT OF TRANSPORTATION  
DIVISION OF HIGHWAYS

**PROPOSED  
HIGHWAY PLANS**

FAP ROUTE 320 (IL 121)  
SECTION D-6 SHLDR RUMBLE STRIPS 2008-4  
PROJECT : ACHSIP-0320(034)  
LOGAN COUNTY  
C-96-110-07

**INDEX OF SHEETS**

- 1 COVER SHEET
- 2 GENERAL NOTES
- 3 SUMMARY OF QUANTITIES
- 4-5 SCHEDULE OF QUANTITIES
- 6-7 TYPICAL SECTIONS
- 8 SHOULDER & RUMBLE STRIP DETAILS
- 9-10 LINE DIAGRAM SHEETS
- 11-12 SIGN DETAILS

**STANDARDS**

000001-05	701306-01
482011-03	701311-02
701001-01	701326-02
701006-02	701901
701011-01	720001
701201-02	720006-01
701301-02	728001
	780001-01

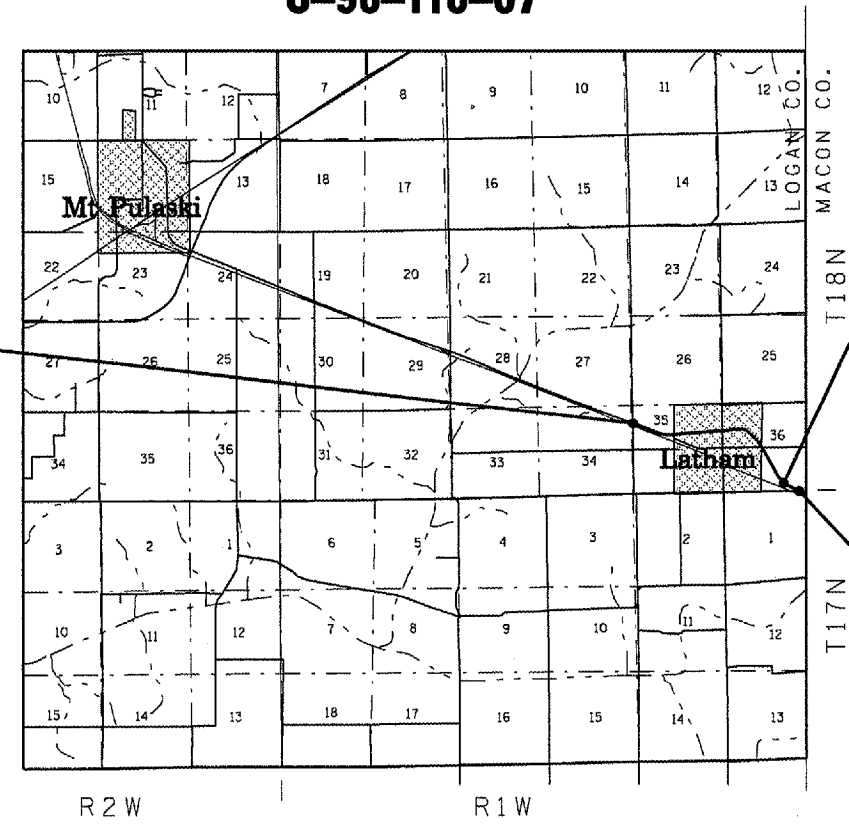
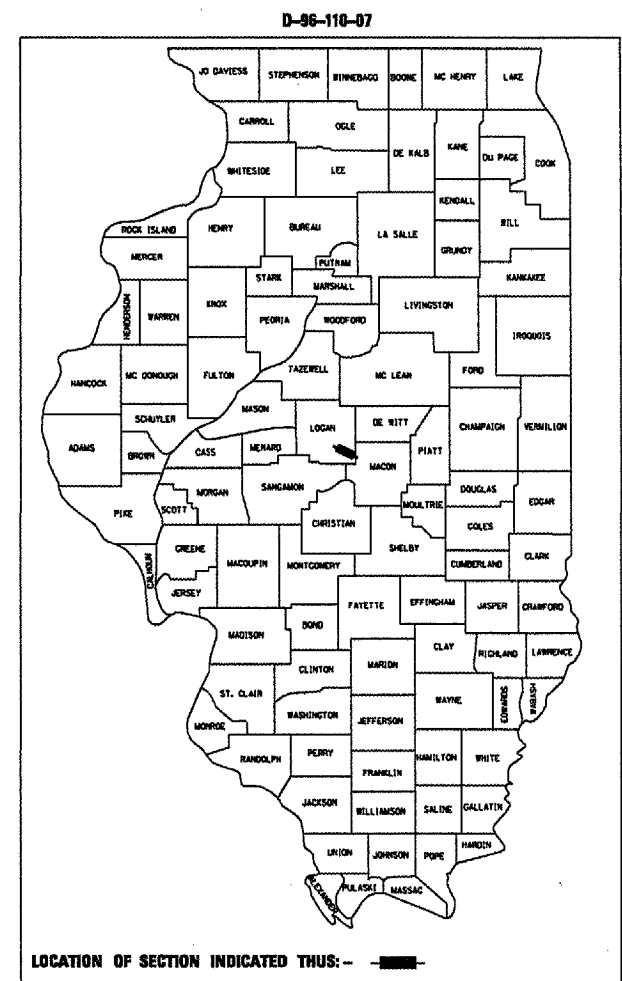

STATION EQUATION  
STA. 438+91.40 BK.  
STA. 434+30.10 AH.

END PROJECT  
STA. 443+90

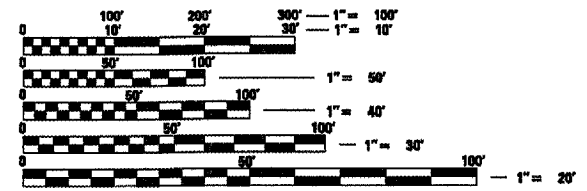

FULL SIZE PLANS HAVE BEEN PREPARED USING STANDARD ENGINEERING SCALES. REDUCED SIZED PLANS WILL NOT CONFORM TO STANDARD SCALES. IN MAKING MEASUREMENTS ON REDUCED PLANS, THE ABOVE SCALES MAY BE USED.

J.U.L.I.E.  
JOINT UTILITY LOCATION INFORMATION FOR EXCAVATION  
1-800-892-0123

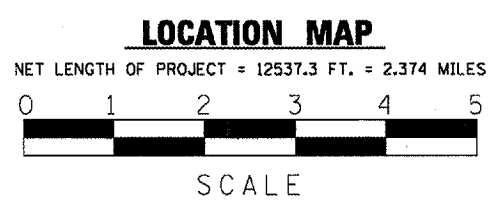

STATE OF ILLINOIS  
DEPARTMENT OF TRANSPORTATION  
DIVISION OF HIGHWAYS

SUBMITTED 10/29/07

*Christie M. Reed*  
DEPUTY DIRECTOR OF HIGHWAYS, REGION ENGINEER

February 1, 2008  
*Eric E. Harn*  
ENGINEER OF DESIGN AND ENVIRONMENT

February 1, 2008  
*Christie M. Reed*  
DIRECTOR OF HIGHWAYS, CHIEF ENGINEER

**PRINTED BY THE AUTHORITY  
OF THE STATE OF ILLINOIS**

PROJECT ENGINEER: SAL MADONIA 217-782-4761  
SQUAD LEADER: KEN ANDERSON 217-524-7546