

F.A.P. RTE.	SECTION	COUNTY	TOTAL SHEETS	SHEET NO.
328		WAYNE	140	62
STA. 406+45.25		TO STA. 414+06.00		
FED. ROAD DIST. NO.		ILLINOIS	FED. AID PROJECT	
• (8BR-2,10BR-3)B-1				

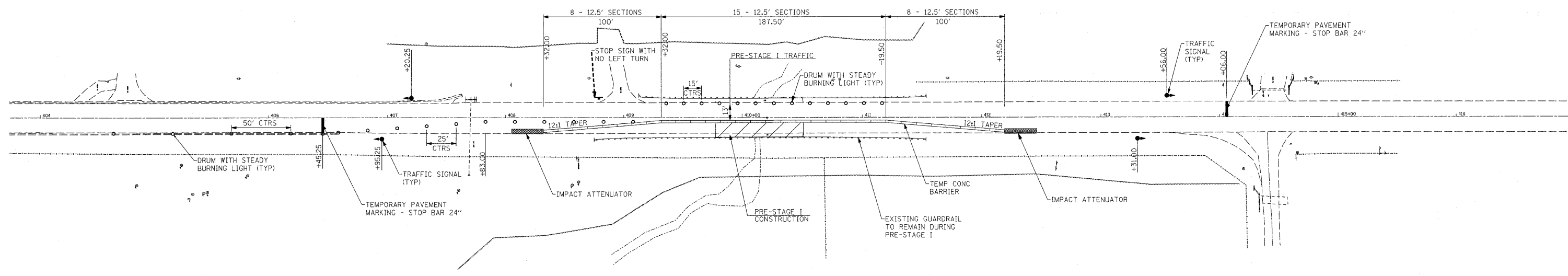

SEQUENCE OF CONSTRUCTION

1. SET-UP PRE-STAGE I TRAFFIC CONTROL.
2. INSTALL DRUMS ALONG LEFT SIDE OF STRUCTURE.
3. REMOVE AND REPLACE ONE EXTERIOR BEAM ON RIGHT SIDE OF STRUCTURE.
4. RESURFACE AREA OF BEAM REMOVAL & REPLACEMENT.
5. REMOVE PRE-STAGE I TRAFFIC CONTROL.

PRE-STAGE I

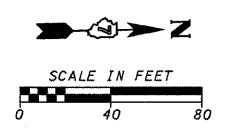

NOTES

ADVANCED WARNING SIGNS, VERTICAL PANELS, PAVEMENT MARKERS, AND BARRICADE REFLECTORS SHALL BE LOCATED IN ACCORDANCE WITH TRAFFIC CONTROL AND PROTECTION STANDARD 701321.

SEE SPECIAL PROVISIONS, STAGING TYPICAL SECTIONS, AND HIGHWAY STANDARD 701321 FOR ADDITIONAL INFORMATION.

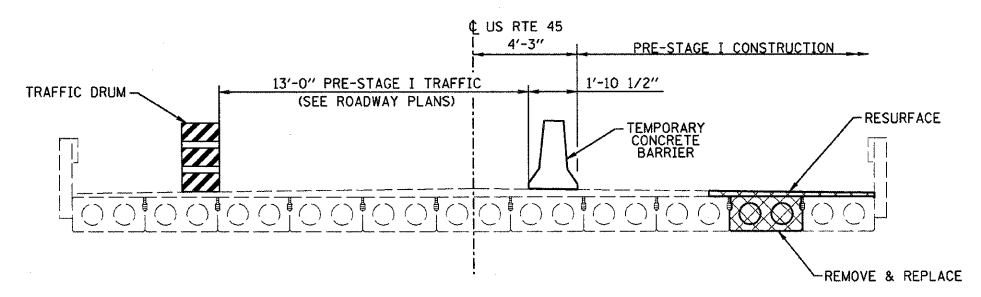

PRE-STAGE I TYPICAL

REVISIONS		ILLINOIS DEPARTMENT OF TRANSPORTATION
NAME	DATE	
		STAGING DETAILS US ROUTE 45 OVER BRANCH OF DEER CREEK SCALE: VERT. N/A HORIZ. 1" = 40' DATE 07/18/07
		DRAWN BY KMO CHECKED BY SSM

PLOT DATE = 4/24/07
 FILE NAME = STAGE1.DWG