

F.A.S. RTE.	SECTION	COUNTY	TOTAL SHEETS	SHEET NO.
1832	5BR-2	WASHINGTON	97	15
STA. 1450+00.00		TO STA. 1456+50.00		
FED. ROAD DIST. NO.	ILLINOIS	FED. AID PROJECT		

LEGEND:

- STRUCTURE REMOVAL
- PAVEMENT REMOVAL
- TEMPORARY CONCRETE BARRIER
- IMPACT ATTENUATOR
- INDUCTION LOOP DETECTOR
- DRUM WITH STEADY BURNING LIGHT
- SIGNALIZED TWO-WAY TRAFFIC LANE
- TEMPORARY BRIDGE TRAFFIC SIGNAL
- TYPE III BARRICADE

- NOTES:**
1. THE COST OF "WEIGH LIMIT 10 TONS AXLE 40 TONS GROSS" SIGN SHALL BE INCLUDED IN THE COST OF "TRAFFIC CONTROL AND PROTECTION, STANDARD 701321 (SPECIAL).
 2. THE CONTRACTOR SHALL PLACE 1 SIGN EACH SIDE OF BRIDGE, DURING STAGE I ONLY

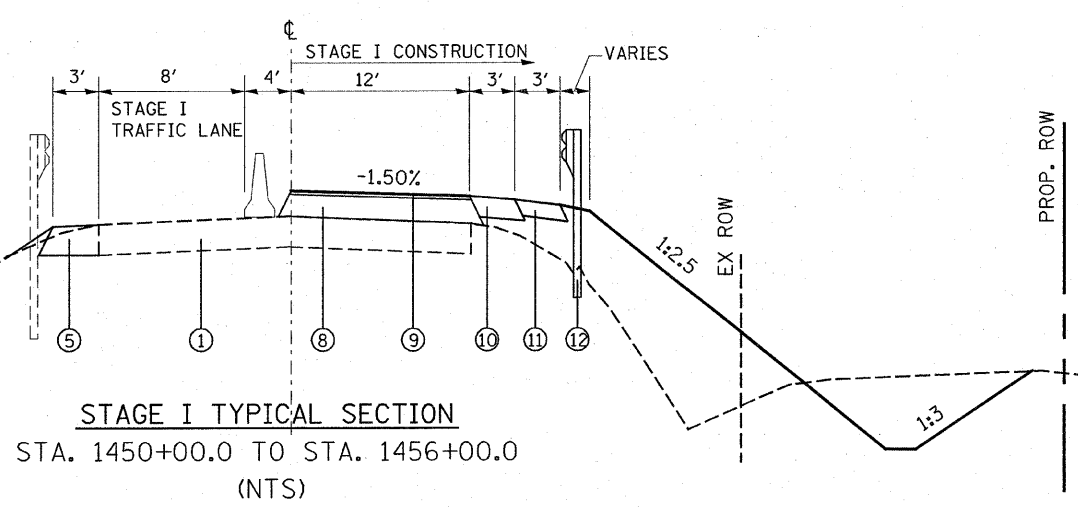
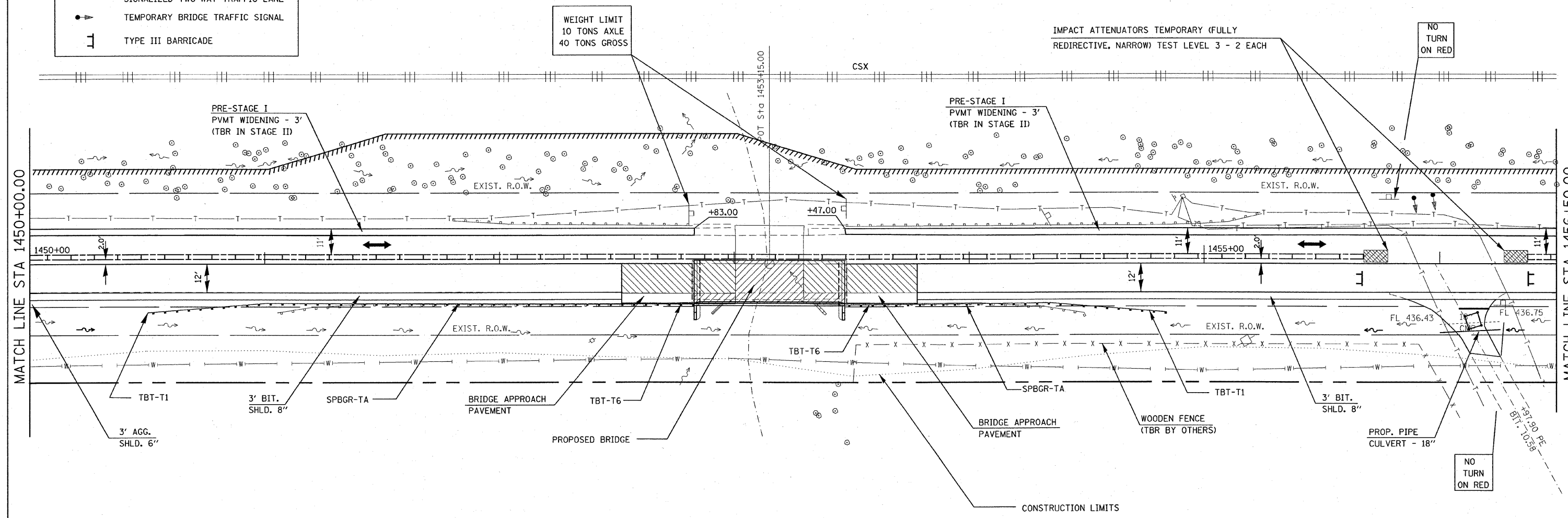
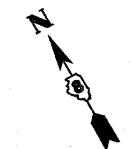

- LEGEND**
- ① EXISTING PAVEMENT
 - ⑤ PROPOSED HOT-MIX ASPHALT BASE COURSE WIDENING 9"
 - ⑧ PROPOSED HOT-MIX ASPHALT BINDER COURSE (VARIES 0.75" TO 15')
 - ⑨ PROPOSED HOT-MIX ASPHALT SURFACE COURSE 1 1/2 "
 - ⑩ PROPOSED HOT-MIX ASPHALT SHOULDERS, 8"
 - ⑪ PROPOSED AGGREGATE SHOULDER 6"
 - ⑫ PROPOSED GUARDRAIL
 -

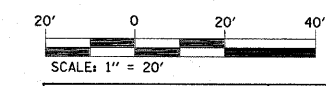

REVISIONS	
NAME	DATE

SN 095-0077

ILLINOIS DEPARTMENT OF TRANSPORTATION

SUGGESTED STAGE I CONSTRUCTION

FAS ROUTE 1832
SECTION 5BR-2
WASHINGTON COUNTY

SCALE: VERT. DATE
HORIZ. CHECKED BY

DRAWN BY

PLOT DATE: 12/7/2007
 FILE NAME: c:\projects\ed9105\plan\stage01.dwg
 PLOT SCALE: 1/8" = 1'-0"
 USER NAME: garrison