

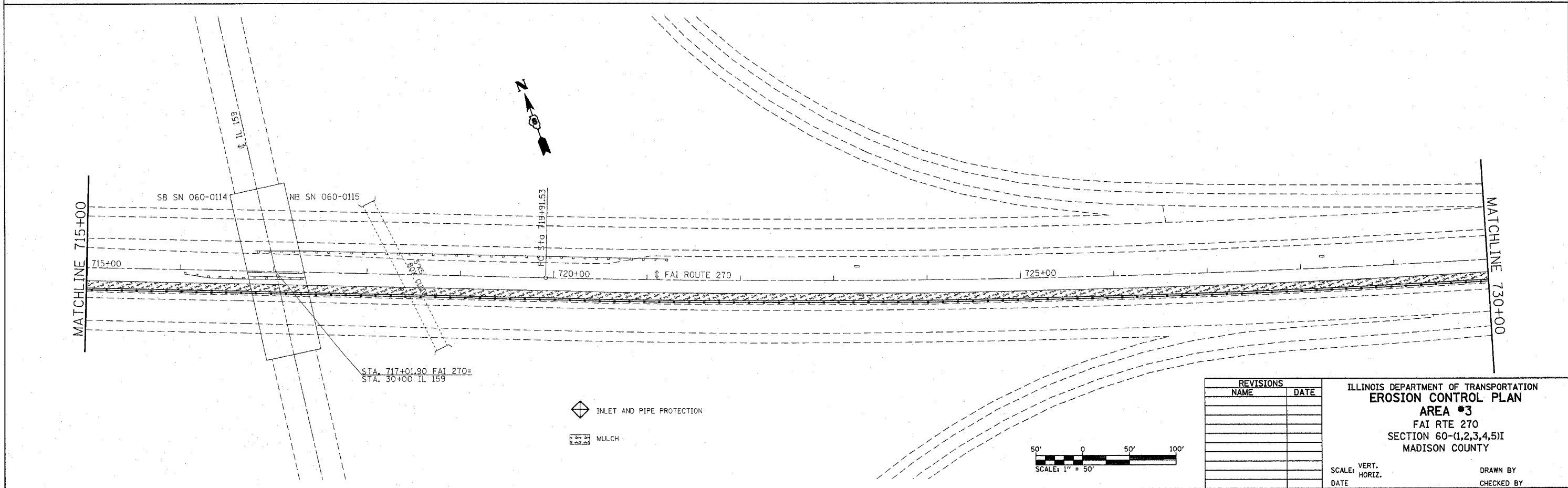

F.A.I. RTE.	SECTION	COUNTY	TOTAL SHEETS	SHEET NO.
270	60-(1,2,3,4,5)I	MADISON	46	41
STA. 700+00		TO STA. 730+00		
FED. ROAD DIST. NO. - ILLINOIS FED. AID PROJECT				

EXIST. CURVE CUR3  
 PI STA. = 706+93.47  
 $\Delta = 20^\circ 43' 53''$  (RT)  
 $D = 1^\circ 30' 00''$   
 $R = 3,819.72'$   
 $T = 698.69'$   
 $L = 1,382.09'$   
 $E = 63.37'$   
 $e =$   
 $T.R. =$   
 $S.E. RUN =$   
 P.C. STA. = 699+94.78  
 P.T. STA. = 713+76.87

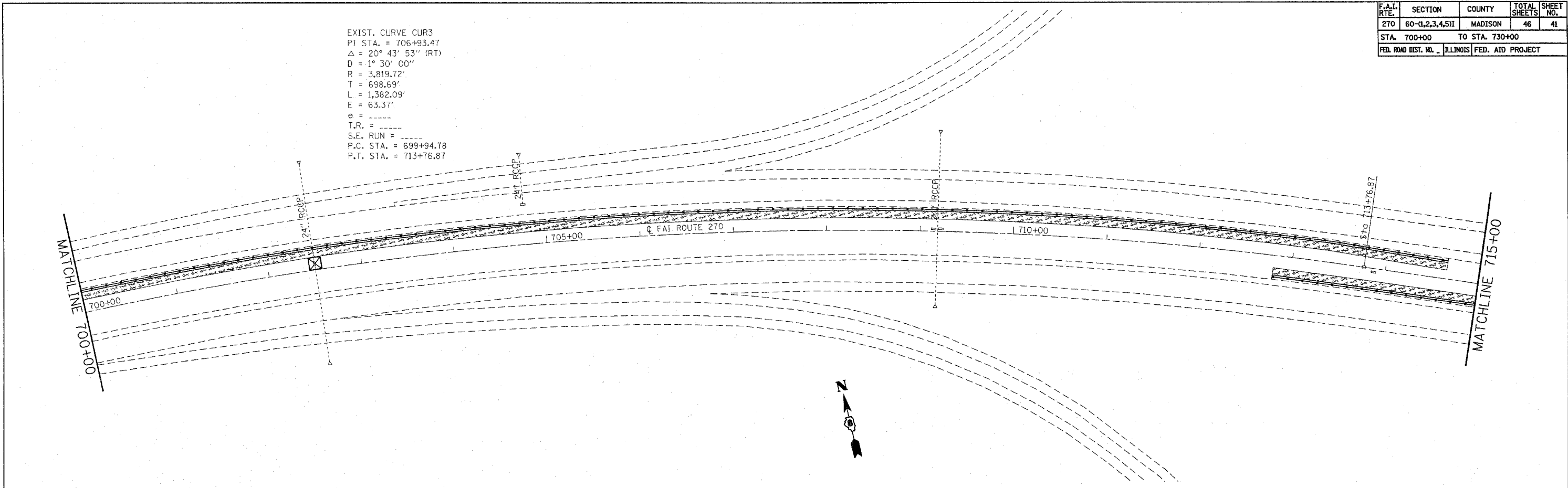

-  INLET AND PIPE PROTECTION
-  MULCH

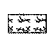
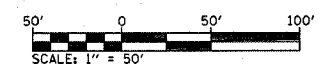

REVISIONS	
NAME	DATE

ILLINOIS DEPARTMENT OF TRANSPORTATION  
**EROSION CONTROL PLAN**  
**AREA #3**  
 FAI RTE 270  
 SECTION 60-(1,2,3,4,5)I  
 MADISON COUNTY

SCALE: VERT. \_\_\_\_\_  
 HORIZ. \_\_\_\_\_  
 DATE \_\_\_\_\_ DRAWN BY \_\_\_\_\_  
 CHECKED BY \_\_\_\_\_

PLOT DATE = 12/12/2007  
 PLOT SCALE = 1" = 50'  
 REFERENCE = #REF\*