

F.A.P. RTE.	SECTION	COUNTY	TOTAL SHEETS	SHEET NO.
885	104BR-1	UNION	37	7
STA.		TO STA.		
FED. ROAD DIST. NO.		ILLINOIS FED. AID PROJECT		

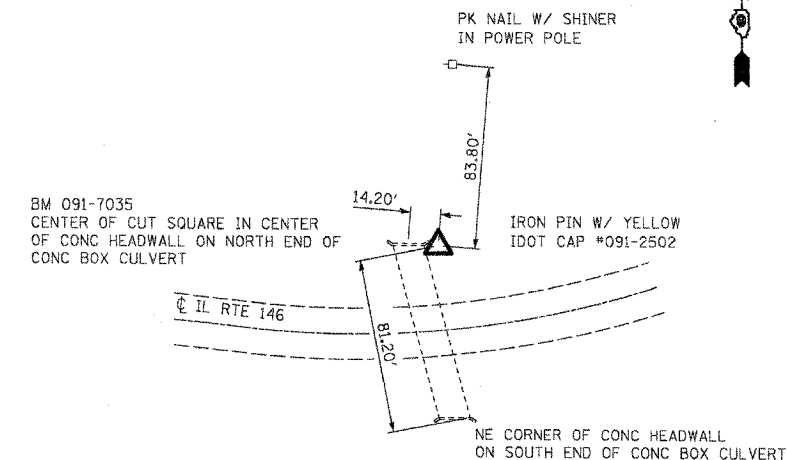
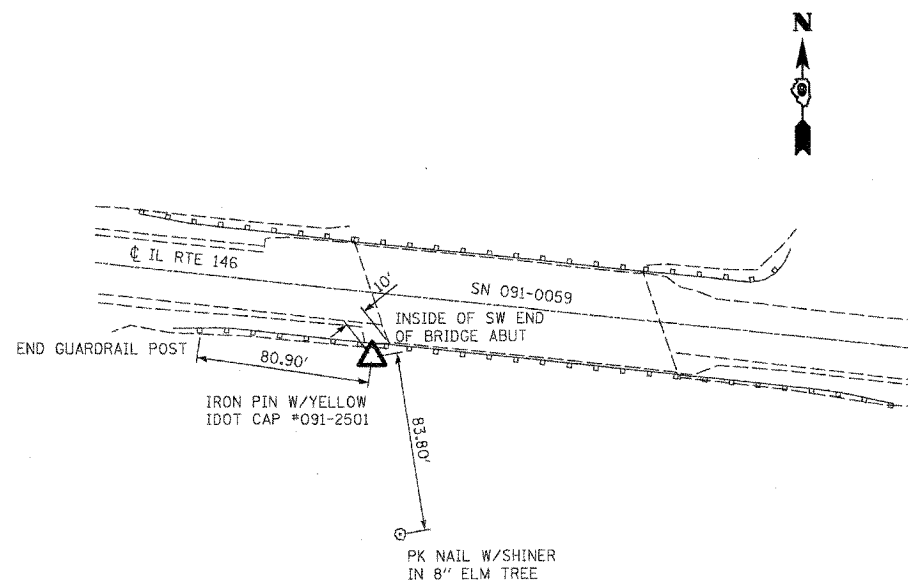
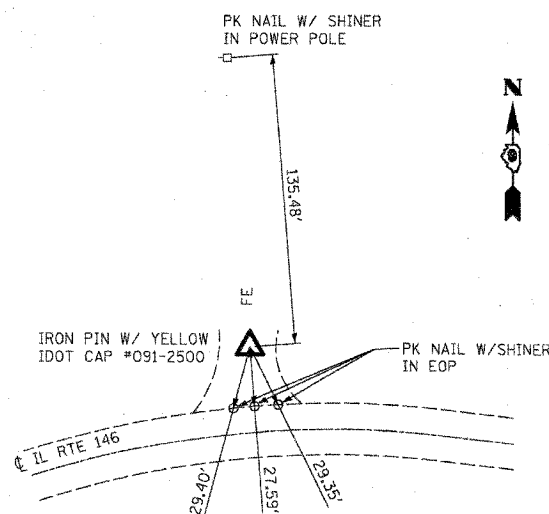

BENCHMARKS

BM 101 ELEVATION 383.587 "88" ADJUSTED
RR SPIKE IN PP APPROX 110' NORTH OF C IL 146

BM 091-7034 ELEVATION 360.372 "88" ADJUSTED
SQUARE CUT IN SW CORNER OF WINGWALL AT A 5'x7' BOX CULVERT
RUNNING UNDER IL 146 AT 42' SOUTH OF C IL 146

BM 091-0059 ELEVATION 371.279 "88" ADJUSTED
SQUARE CUT IN N CENTER OF HEADWALL OF A 6'x8' BOX CULVERT
RUNNING UNDER IL 146, 45' N OF C

BM 102 ELEVATION 373.943 "88" ADJUSTED
SQUARE CUT IN CENTER OF OLD LIGHT POLE FOUNDATION AT REST
AREA ON S SIDE OF IL 146

BM 091-7038 ELEVATION 380.400 "88" ADJUSTED
SQUARE CUT IN CENTER OF CROSS ROAD CULVERT ON SOUTH SIDE OF
IL 146 APPROX 40' SOUTH OF C

BM 091-7039 ELEVATION 396.891 "88" ADJUSTED
SQUARE CUT IN CENTER OF A CROSS ROAD CULVERT ON SOUTH SIDE
OF IL 146 APPROX 42' SOUTH OF C

PLOT DATE = 12/03/2007
 FILE NAME = ...
 PLOT SCALE = 40.0000 / IN.
 USER NAME = CFC

COOMBE-BLOXDORF P.C.
 Engineers / Land Surveyors
 Springfield, Illinois
 Design Firm License No. 184-002703

REVISIONS	
NAME	DATE

ILLINOIS DEPARTMENT OF TRANSPORTATION

BENCHMARKS AND CROSS-TIES
 IL ROUTE 146 OVER DUTCH CREEK
 FAP RT 885 SECTION 104BR-1
 UNION COUNTY

SCALE:
DATE

DRAWN BY CFC
 CHECKED BY MCB