

F.A.I. RTE.	SECTION	COUNTY	TOTAL SHEETS	SHEET NO.
0285	01-00052-00-FP	WILL	71	11
STA. BEGIN IMPROV TO STA. 125+50				
FED. ROAD DIST. NO. 1		ILLINOIS	FED. AID PROJECT	

CONTRACT NO. 83956

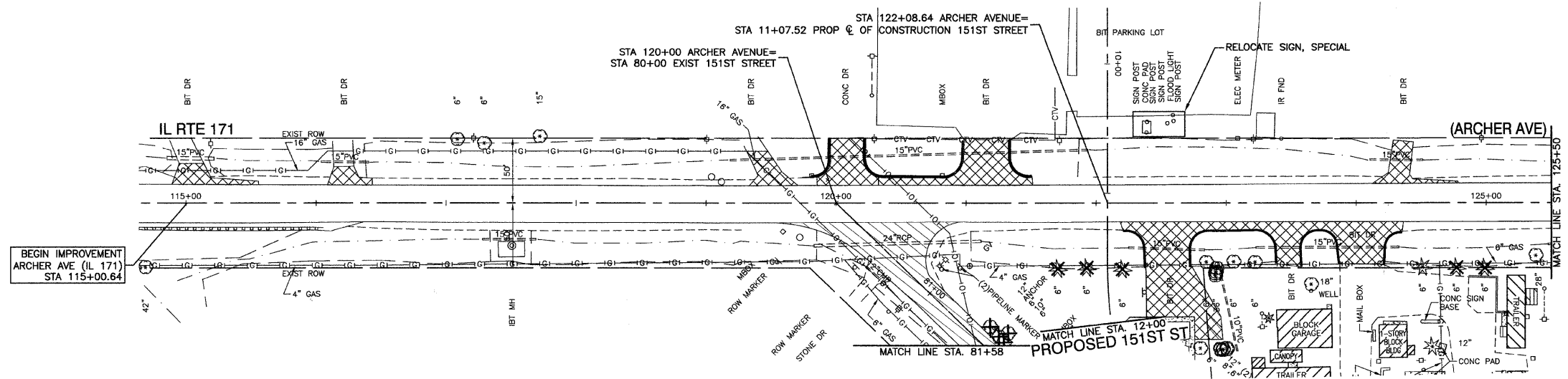

EXISTING CONDITIONS

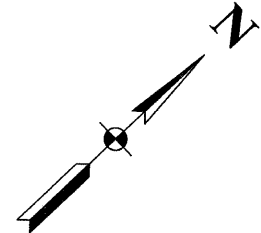
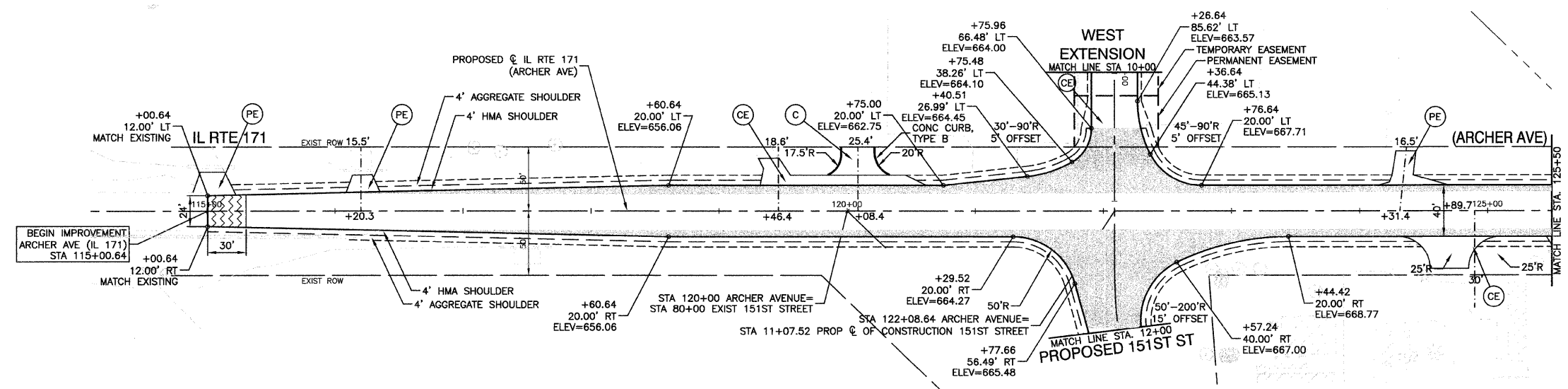

PROPOSED IMPROVEMENT

- LEGEND**
- CURB REMOVAL
 - PAVEMENT REMOVAL (PAID FOR AS EARTH EXCAVATION)
 - DRIVEWAY PAVEMENT REMOVAL
 - HMA SURFACE REMOVAL - BUTT JOINT
 - PAVEMENT WIDENING
 - HMA SURFACE COURSE, MIX "D", N70, 2"
 - HMA BINDER COURSE, IL-19.0, N70, 10"
 - AGGREGATE SUBGRADE, 12"
 - TREE REMOVAL
 - P.C.C. DRIVEWAY, 7"
 - HMA SURFACE COURSE, MIX "C", N50, 2"
HMA BASE COURSE (HMA BINDER IL-19.0), 8"
 - HMA SURFACE COURSE, MIX "C", N50, 2"
HMA BASE COURSE (HMA BINDER IL-19.0), 6"
 - C & G TYPE B-6.24
 - 10' TRANSITION FROM C&G TYPE B-6.24 TO EXISTING CURB & GUTTER
 - P.C.C. SIDEWALK, 5" (7" AT DRIVEWAYS)

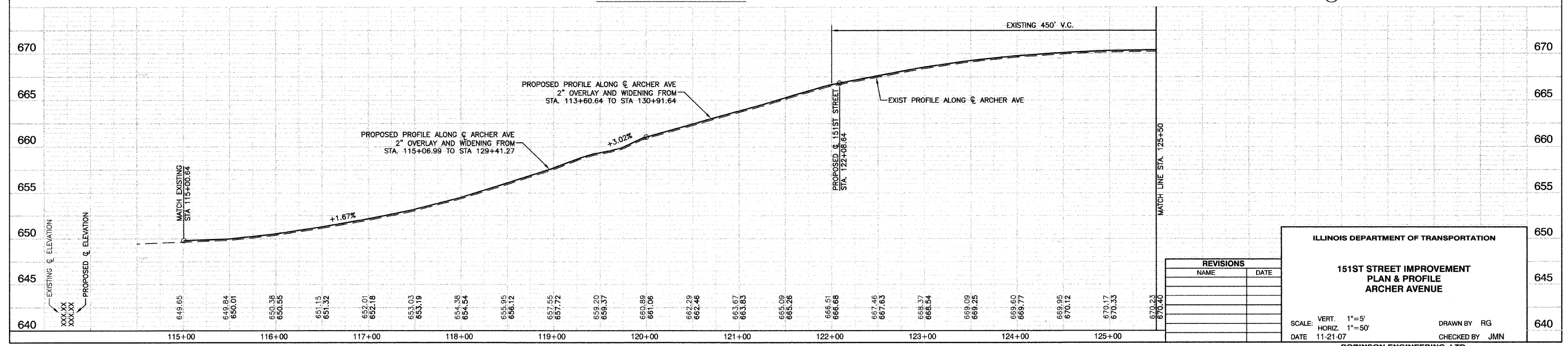

REVISIONS	
NAME	DATE

ILLINOIS DEPARTMENT OF TRANSPORTATION

**151ST STREET IMPROVEMENT
PLAN & PROFILE
ARCHER AVENUE**

SCALE: VERT. 1"=5'
HORIZ. 1"=50'

DATE 11-21-07

DRAWN BY RG
CHECKED BY JMN