

FAU. RE.	SECTION	COUNTY	TOTAL SHEETS	SHEET NO.
0285	01-00052-00-FP	WILL	71	25
STA. 20+00	TO STA. 30+00			
FED. ROAD DIST. NO. 1	ILLINOIS	FED. AID PROJECT		

CONTRACT NO. 83956

- 53 STA 28+00, 18" RT
CB TA 4" DIA T24 F&G
RIM EL=681.18
N 12" INV=674.26
- 54 STA 20+00, 18" LT
CB TA 4" DIA T24 F&G
RIM EL=681.18
S 12" INV=672.64
N 12" INV=670.64
- 55 STA 28+00, 31" LT
CB TA 5" DIA T1F+CL
RIM EL=681.50
S 12" INV=670.55
N 36" INV=677.50
E 24" INV=670.38
W 36" INV=669.28
- 56 STA 28+00, 40" LT
PRECAST RC FES, 36"
FL EL=677.89
S 36" INV=677.50
- 57 STA 26+45, 18" RT
CB TA 4" DIA T24 F&G
RIM EL=679.86
N 12" INV=673.65
N 4" UD INV=676.86
- 58 STA 26+45, 18" LT
CB TA 4" DIA T24 F&G
RIM EL=679.86
S 12" INV=672.03
N 12" INV=670.03
S 4" UD INV=676.50
- 59 STA 25+65, 18" LT
CB TA 4" DIA T24 F&G
RIM EL=680.16
N 12" INV=669.59
- 60 STA 26+45, 35.5' LT
MH TA 5" DIA T1F+CL
RIM EL=683.00
S 12" INV=669.94
E 36" INV=668.04
W 36" INV=667.94
- 62 STA 24+33, 18" RT
CB TA 4" DIA T24 F&G
RIM EL=680.81
N 12" INV=672.55
- 63 STA 24+33, 18" LT
CB TA 4" DIA T24 F&G
RIM EL=680.81
S 12" INV=670.93
N 12" INV=668.93
- 64 STA 23+30, 18" LT
CB TA 4" DIA T24 F&G
RIM EL=681.38
N 12" INV=667.48
- 65 STA 24+33, 33.5' LT
MH TA 5" DIA T1F+CL
RIM EL=682.25
S 12" INV=668.14
E 36" INV=666.24
W 36" INV=666.14
- 78 STA 22+79, 57.5' RT
CB TA 4" DIA T11 F&G
RIM EL=677.67
W 12" INV=669.55
- 79 STA 24+43, 57.8' RT
CB TA 4" DIA T11 F&G
RIM EL=667.92
W 12" INV=665.92
- 80 STA 22+34, 33.5' LT
MH TA 5" DIA T1F+CL
RIM EL=682.00
W 15" INV=665.20
E 36" INV=664.55
S 42" INV=663.95

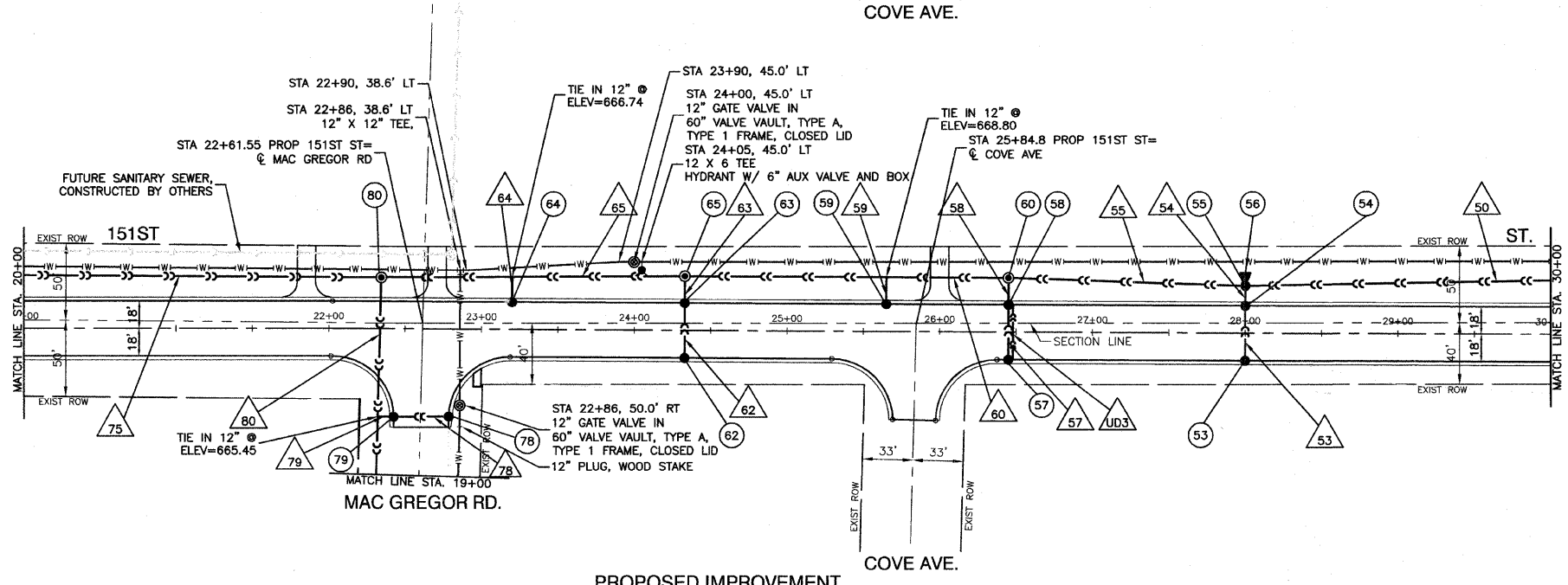
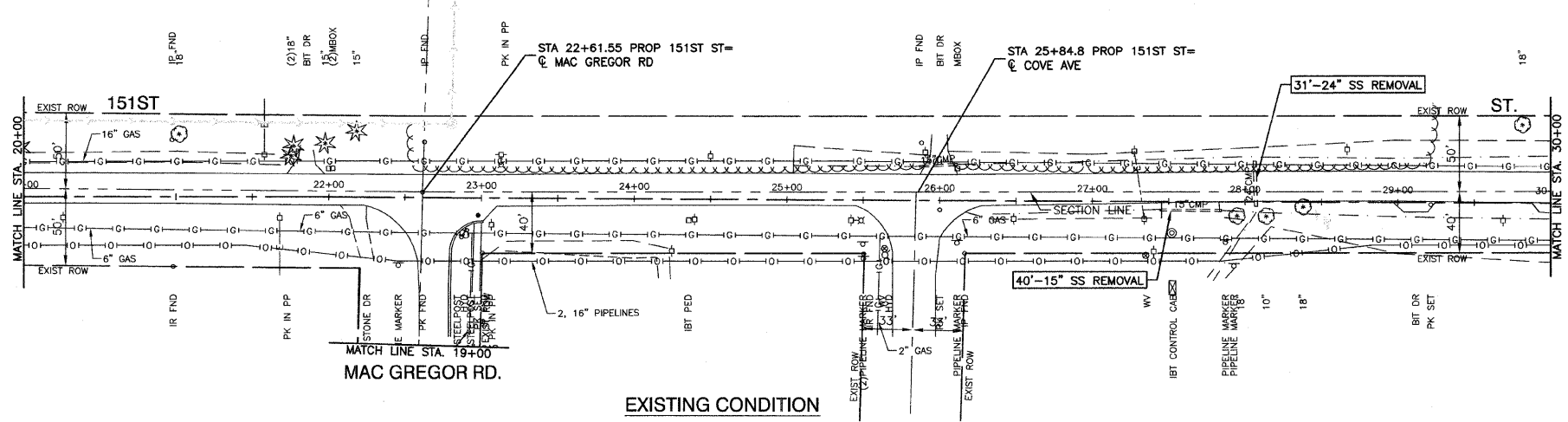

- 50 205'-24" SST3 CL IV @ 1.25% (0.0)
- 53 36'-12" SST2 CL III @ 4.50% (30.8)
- 54 18'-12" SST2 CL III @ 0.50% (4.0)
- 55 155'-36" SST3 CL IV @ 0.80% (0.0)
- 57 36'-12" SST2 CL III @ 4.50% (26.6)
- 58 18'-12" SST3 CL IV @ 0.50% (4.4)
- 59 18'-12" SST3 CL IV @ 4.50% (4.8)
- 60 212'-36" SST3 CL IV @ 0.80% (45.4)
- 62 36'-12" SST2 CL III @ 4.50% (23.2)
- 63 18'-12" SST3 CL IV @ 4.50% (1.9)
- 64 16'-12" SST3 CL IV @ 4.50% (4.9)
- 65 199'-36" SST3 CL IV @ 0.80% (0.0)
- 75 334'-15" SST3 CL IV @ 0.35% (106.5)
- 78 36'-12" SST3 CL IV @ 4.50% (37.9)
- 79 11'-12" SST3 CL IV @ 4.50% (5.7)
- 80 250'-42" SST2 CL III @ 0.28% (227.5)
- UD3 36'-4" UD @ 1.00%

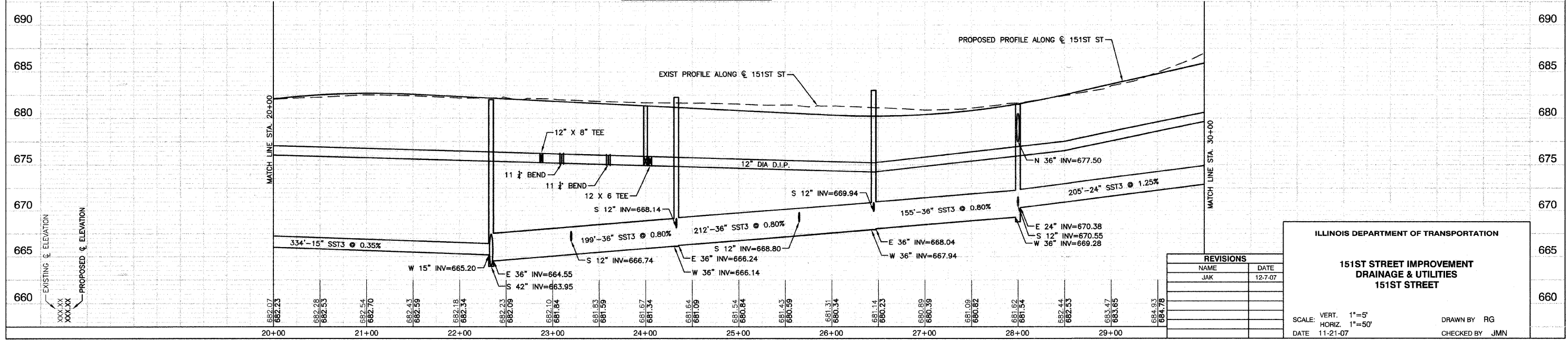

REVISIONS	
NAME	DATE
JAK	12-7-07

ILLINOIS DEPARTMENT OF TRANSPORTATION

**151ST STREET IMPROVEMENT
DRAINAGE & UTILITIES
151ST STREET**

SCALE: VERT. 1"=5'
HORIZ. 1"=50'

DATE 11-21-07 DRAWN BY RG
CHECKED BY JMN

ROBINSON ENGINEERING, LTD.
1708 SOUTH PARK AVENUE, SOUTH HAVEN, ILLINOIS 60473
(708) 381-6700 FAX (708) 381-8828
ILLINOIS DESIGN FIRM REGISTRATION NO. 18401128 01179-STRM-02