

FAU. RTE.	SECTION	COUNTY	TOTAL SHEETS	SHEET NO.
0285	01-00052-00-FP	WILL	71	32
STA.	TO STA.			
FED. ROAD DIST. NO. 1	ILLINOIS	FED. AID PROJECT		

CONTRACT NO. 83956

N

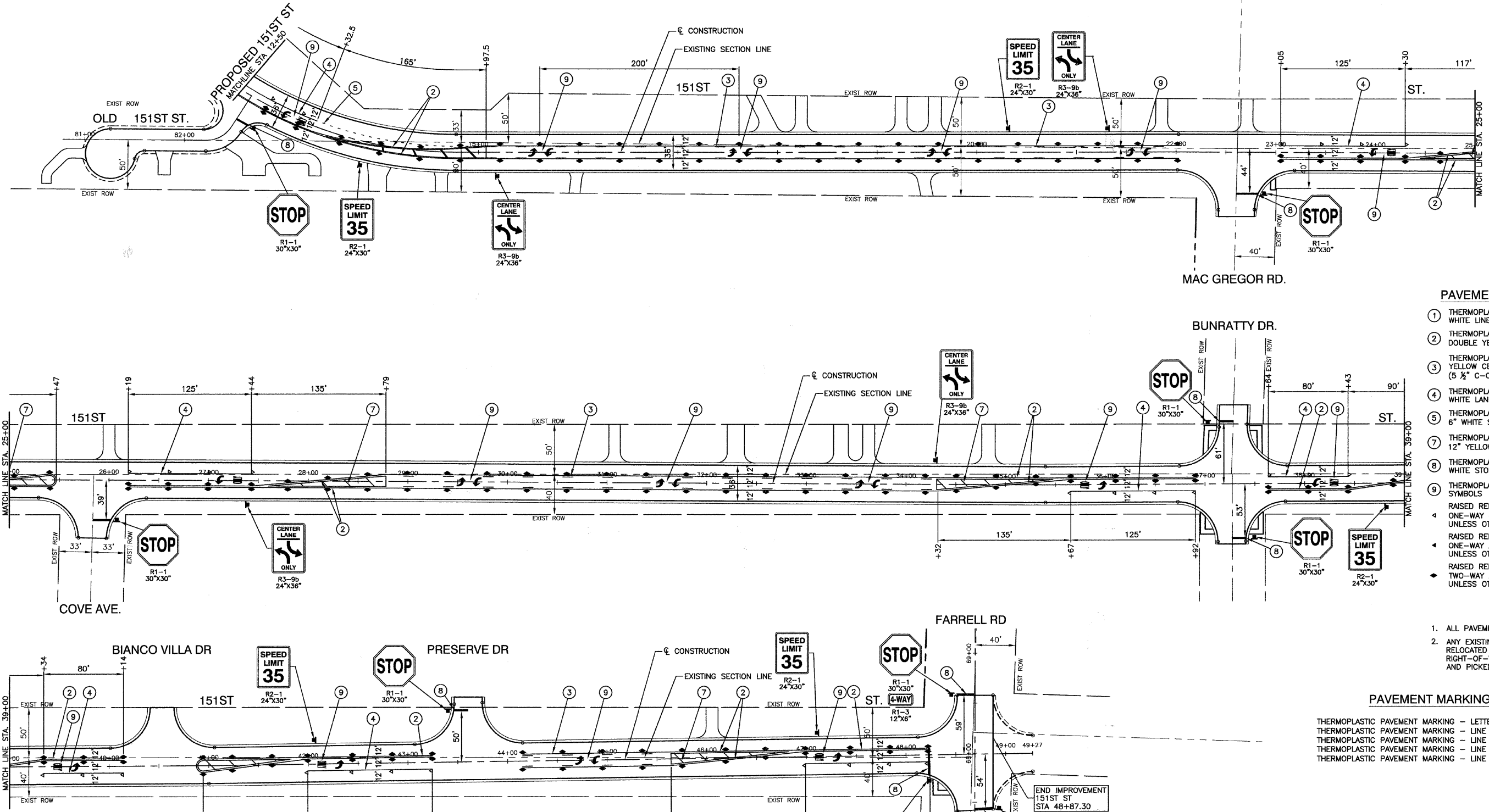

**PAVEMENT MARKING LEGEND**

- ① THERMOPLASTIC PAVEMENT MARKING LINE, 4", WHITE LINE
  - ② THERMOPLASTIC PAVEMENT MARKING LINE, 4", DOUBLE YELLOW CENTER LINE (11" C-C)
  - ③ THERMOPLASTIC PAVEMENT MARKING LINE, 4", YELLOW CENTER LINE WITH YELLOW SKIP-DASH (5 1/2" C-C), (10' DASH, 30' SPACE)
  - ④ THERMOPLASTIC PAVEMENT MARKING LINE, 6", WHITE LANE LINE
  - ⑤ THERMOPLASTIC PAVEMENT MARKING LINE, 6", 6" WHITE SKIP-DASH (2' DASH, 6' SPACE)
  - ⑦ THERMOPLASTIC PAVEMENT MARKING LINE, 12", 12" YELLOW DIAGONAL (20' C-C)
  - ⑧ THERMOPLASTIC PAVEMENT MARKING LINE, 24", WHITE STOP BAR
  - ⑨ THERMOPLASTIC PAVEMENT MARKING-LETTERS & SYMBOLS
- ◀ RAISED REFLECTIVE PAVEMENT MARKER ONE-WAY CRYSTAL MARKER 40' C/C UNLESS OTHERWISE NOTED
  - ◀ RAISED REFLECTIVE PAVEMENT MARKER ONE-WAY AMBER MARKER 40' C/C UNLESS OTHERWISE NOTED
  - ◀ RAISED REFLECTIVE PAVEMENT MARKER TWO-WAY AMBER MARKER 40' C/C UNLESS OTHERWISE NOTED

**NOTES**

1. ALL PAVEMENT MARKING SHALL BE THERMOPLASTIC.
2. ANY EXISTING SIGNS THAT ARE NOT TO BE RELOCATED SHALL BE STOCKPILED IN THE RIGHT-OF-WAY AS DIRECTED BY THE ENGINEER AND PICKED UP BY THE VILLAGE OF LOCKPORT.

**PAVEMENT MARKING SCHEDULE**

THERMOPLASTIC PAVEMENT MARKING - LETTERS & SYMBOLS	-	474 SQ FT
THERMOPLASTIC PAVEMENT MARKING - LINE 4"	-	9088 FT
THERMOPLASTIC PAVEMENT MARKING - LINE 6"	-	830 FT
THERMOPLASTIC PAVEMENT MARKING - LINE 12"	-	219 FT
THERMOPLASTIC PAVEMENT MARKING - LINE 24"	-	167 FT

REVISIONS	
NAME	DATE

ILLINOIS DEPARTMENT OF TRANSPORTATION

**151ST STREET IMPROVEMENT PAVEMENT MARKING PLAN 151ST STREET**

SCALE: VERT. N/A  
 HORIZ. 1"=50'  
 DATE 11-21-07  
 DRAWN BY RG  
 CHECKED BY JMN