

Contract #83989

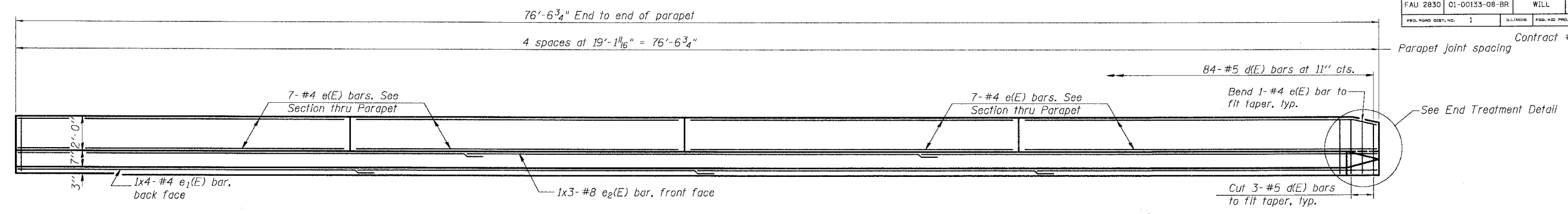

**MINIMUM BAR LAP**  
(Parapet)  
#4 bar = 1'-4"  
#8 bar = 3'-5"

**INSIDE ELEVATION OF WEST PARAPET**

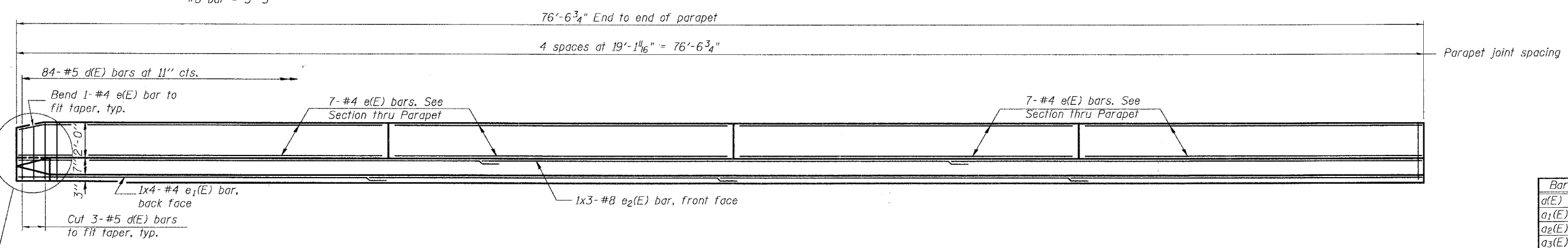

**INSIDE ELEVATION OF EAST PARAPET**

**SUPERSTRUCTURE BILL OF MATERIAL**

Bar	No.	Size	Length	Shape
d(E)	129	#5	42'-6"	—
a1(E)	97	#5	40'-1"	—
a2(E)	128	#6	6'-0"	—
a3(E)	8	#5	26'-0"	—
b(E)	184	#5	21'-6"	—
b1(E)	123	#5	27'-11"	—
d(E)	168	#5	5'-7"	┌
d1(E)	168	#5	8'-1"	┌
e(E)	56	#4	18'-9"	—
e1(E)	8	#4	20'-2"	—
e2(E)	6	#8	27'-9"	—
m(E)	2	#6	45'-10"	—
m1(E)	3	#6	45'-10"	—
m2(E)	20	#6	11'-3"	—
m3(E)	10	#6	8'-1"	—
m4(E)	2	#6	1'-9"	—
m5(E)	2	#6	49'-6"	—
m6(E)	3	#6	49'-6"	—
m7(E)	4	#6	9'-0"	—
m8(E)	2	#6	3'-5"	—
s(E)	88	#5	6'-5"	┌
s1(E)	78	#4	10'-6"	┌
v(E)	48	#5	3'-4"	┌
Reinforcement Bars, Epoxy Coated		Pound	25,040	
Concrete Superstructure		Cu. Yds.	141.7	

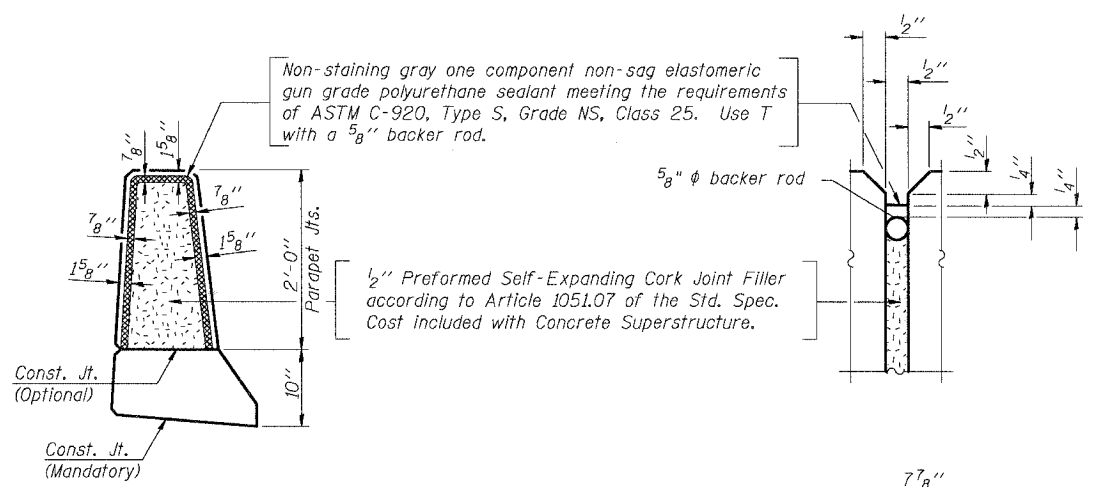

**PARAPET JOINT DETAILS**

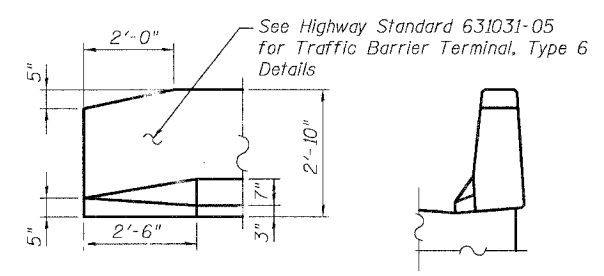

**ELEVATION**      **END VIEW**

**END TREATMENT DETAIL**  
(Northwest and Northeast corners)

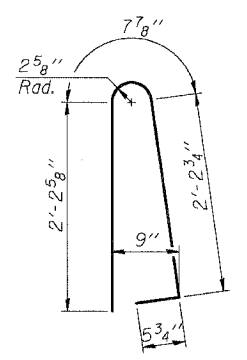

**BAR d(E)**

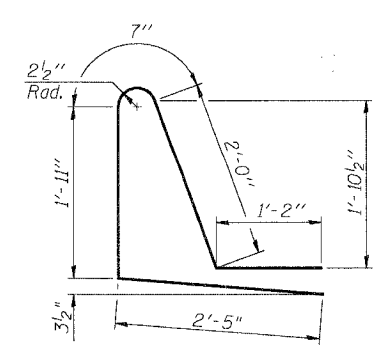

**BAR d1(E)**

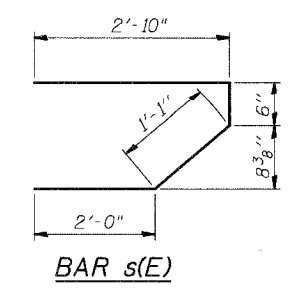

**BAR s(E)**

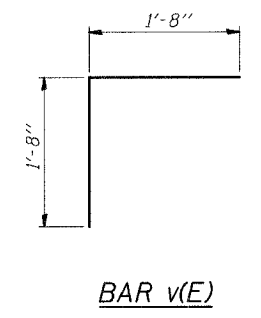

**BAR v(E)**

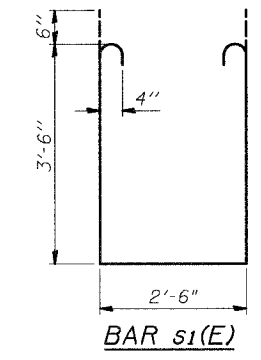

**BAR s1(E)**

DESIGNED	AEU
CHECKED	RGD
DRAWN	WJH
CHECKED	AEU

Illinois Professional Design Firm # 184-000108  
**SEC GROUP, INC.**  
Smith Engineering Consultants • SEC Automation • SEC Planning  
4500 Prime Parkway, McHenry, IL 60050  
L 815.385.1778 • F 815.385.1781  
www.secgroupinc.com

ILLINOIS DEPARTMENT OF TRANSPORTATION  
**SUPERSTRUCTURE DETAILS**  
**OLD MONEE ROAD (COUNTY HIGHWAY 48)**  
**OVER THORN CREEK**  
**WILL COUNTY**  
**SECTION NO. 01-00133-08-BR**  
**STRUCTURE NO. 099-3379**  
DATE: 11-26-2007