

FA.U. ROUTE NO.	SECTION	COUNTY	TOTAL SHEETS	SHEET NO.
2619	06-00096-00-RS	DUPAGE	24	1

ILLINOIS PROJECT
C-91-100-07 M-8003 (736)
CONTRACT NO.: 83990

24-1-23

FOR INDEX OF SHEETS, SEE SHEET NO. 2
FOR HIGHWAY STANDARDS, SEE SHEET NO. 2

STATE OF ILLINOIS
DEPARTMENT OF TRANSPORTATION
DIVISION OF HIGHWAYS

PLANS FOR PROPOSED FEDERAL AID HIGHWAY

F.A.U. ROUTE 2619 (GRACE STREET)
FROM FAU 1380 (FULLERTON AVENUE) TO
FAP 308 (ILLINOIS ROUTE 64 NORTH AVENUE)

PROJECT NO. M-8003(736)
SECTION NO.: 06-00096-00-RS
DUPAGE COUNTY
JOB NO.: C-91-100-07

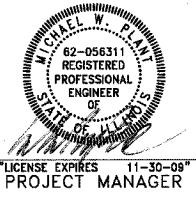

DATE: 7-27-07

STATE OF ILLINOIS
DEPARTMENT OF TRANSPORTATION
DIVISION OF HIGHWAYS

APPROVED: 12-17-07
[Signature]
VILLAGE OF ADDISON
VILLAGE ENGINEER

PASSED: 17-2007
[Signature]
DECEMBER 17, 2007
DISTRICT 1 ENGINEER OF
LOCAL ROADS & STREETS

RELEASING FOR BID
BASED ON LIMITED
REVIEW

Dec. 17, 2007
[Signature]
DEPUTY DIRECTOR OF
HIGHWAYS, REGION 1 ENGINEER

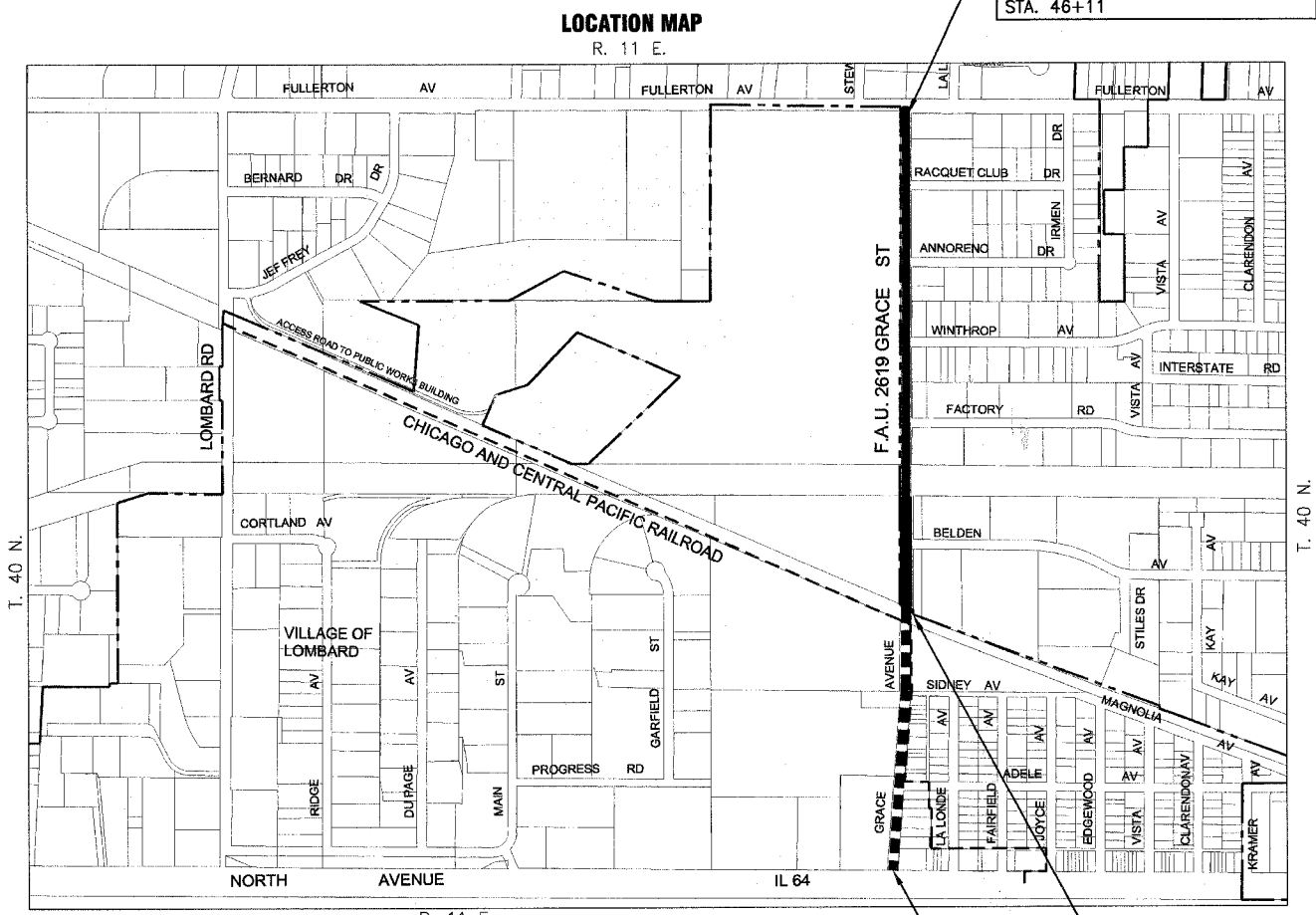

GROSS LENGTH OF IMPROVEMENT = 5,375 LIN. FT. OR 1.018 MILES
NET LENGTH OF IMPROVEMENT = 3,506 LIN. FT. OR 0.664 MILES
NET LENGTH OF OMISSION = 1,869 LIN. FT. OR 0.354 MILES

TRAFFIC DATA
POSTED & DESIGN SPEED LIMIT = 30 MPH
2007 ADT = 11,500

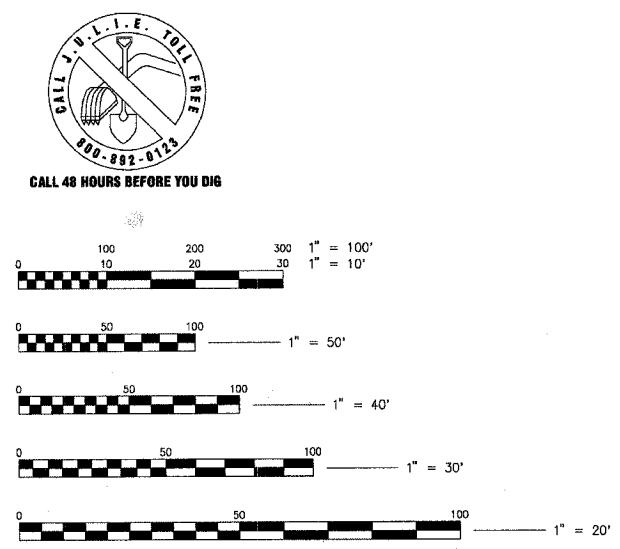

BAXTER & WOODMAN, INC.
STATE OF ILLINOIS - PROFESSIONAL DESIGN FIRM
LICENSE NO. - 184-001121 - EXPIRES 4/30/2009

Crystal Lake, Illinois
815.459.1260
(OFFICE WHICH PREPARED PLANS)

Burlington, Wisconsin
262.763.7834



Grayslake, Illinois
847.223.5088

Plainfield, Illinois
815.609.7425

Rockford, Illinois
815.489.1551

Itasca, Illinois
630.773.1870

Madison, Wisconsin
608.347.1542

Mokena, Illinois
708.478.2090

DeKalb, Illinois
815.787.3111

CONTRACT NO.: 83990

COUNTY: DUPAGE SECTION NUMBER: 06-00096-00-RS

PRINTED BY THE AUTHORITY OF THE STATE OF ILLINOIS PROJECT NO.: 060486.40

BUREAU OF LOCAL ROADS AND STREETS: MARILYN D. SOLOMON, P.E. 847-705-4407 SCHAUMBURG, IL.