

FILE NO.	SECTION	COUNTY	TOTAL SHEETS	SHEET NO.
1380	00-0084-00-PV	DUPAGE	93	18
STA. 203+50	TO STA. 209+00			
ILLINOIS		SURFACE TRANSPORTATION FUNDING		

CONTRACT NUMBER 83993

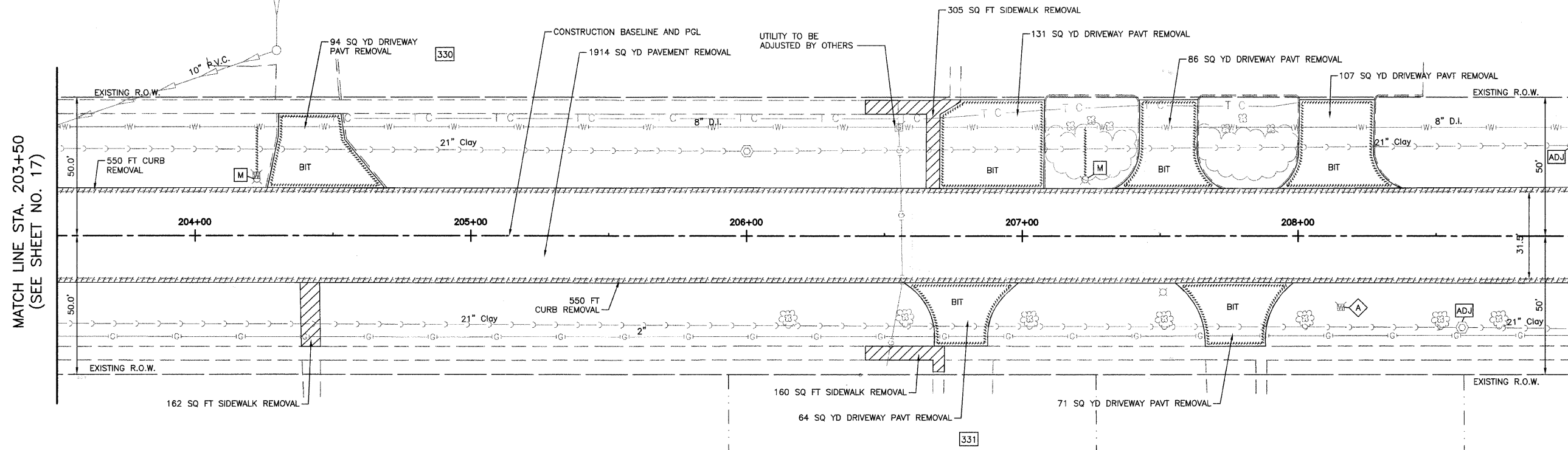

FULLERTON AVENUE
EXISTING TOPOGRAPHY

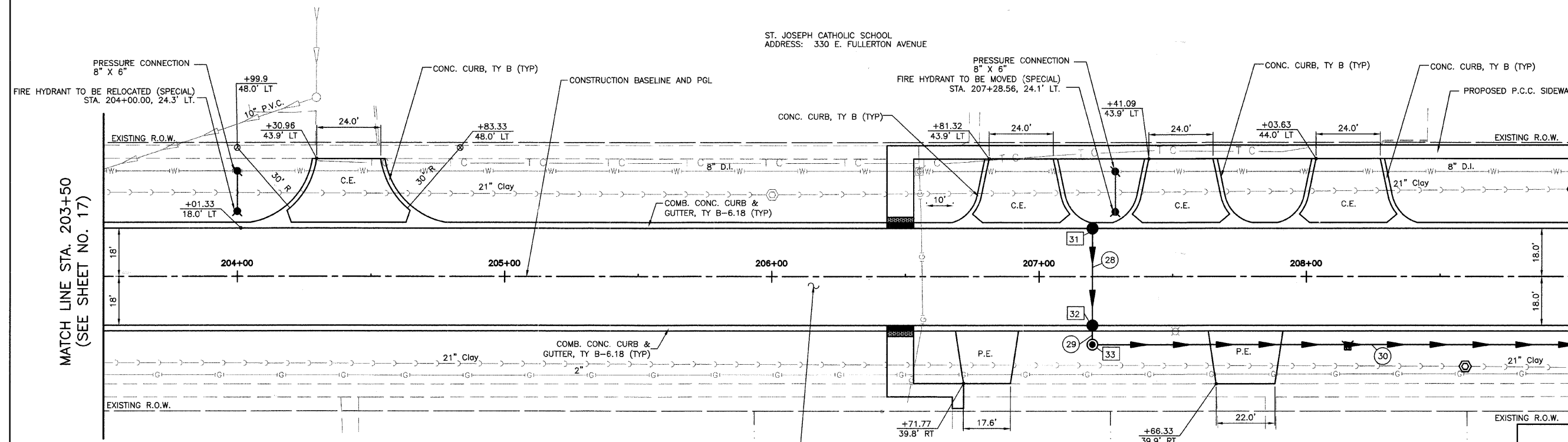

FULLERTON AVENUE
PROPOSED IMPROVEMENTS

NOTE:
1. THE WATER MAINS SHALL BE RELOCATED IF A CONFLICT EXISTS WITH THE PROPOSED STORM SEWER. PAID FOR AS "REMOVE AND RELOCATE WATER MAIN."

HOT-MIX ASPHALT PAVEMENT (FULL DEPTH), 9"
HOT-MIX ASPHALT SURFACE COURSE, MIX "D", N70, 2"
HOT-MIX ASPHALT BINDER COURSE, IL-19.0, N70, 7"
AGGREGATE SUBGRADE, 12"

REVISIONS	
NAME	DATE

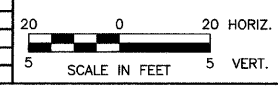

DATE: 11/26/2007
DESIGNED BY: RTM
TECHNICIAN: JRR
CHECKED BY: JRV