

FILE NO.	SECTION	COUNTY	TOTAL SHEETS	SHEET NO.
1380	00-00084-00-PV	DUPAGE	93	20
STA. 214+50 TO STA. 220+00		ILLINOIS SURFACE TRANSPORTATION FUNDING		

CONTRACT NUMBER 83993

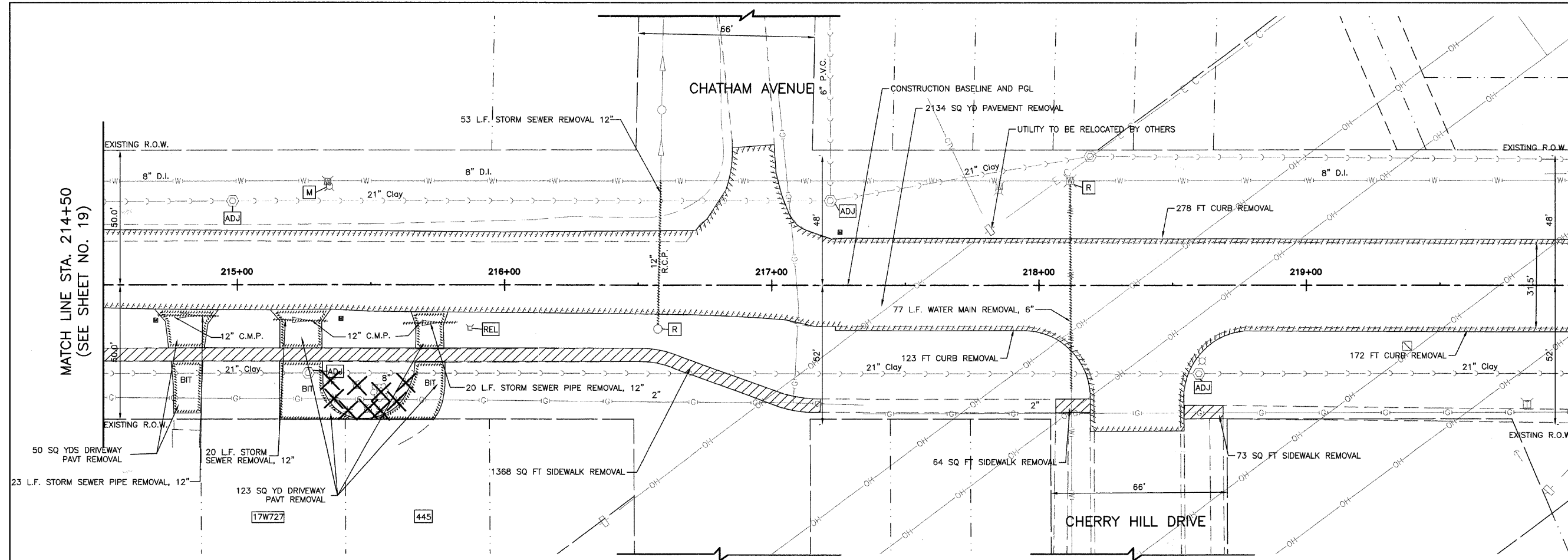

MATCH LINE STA. 220+00  
(SEE SHEET NO. 21)

MATCH LINE STA. 214+50  
(SEE SHEET NO. 19)

FULLERTON AVENUE  
EXISTING TOPOGRAPHY

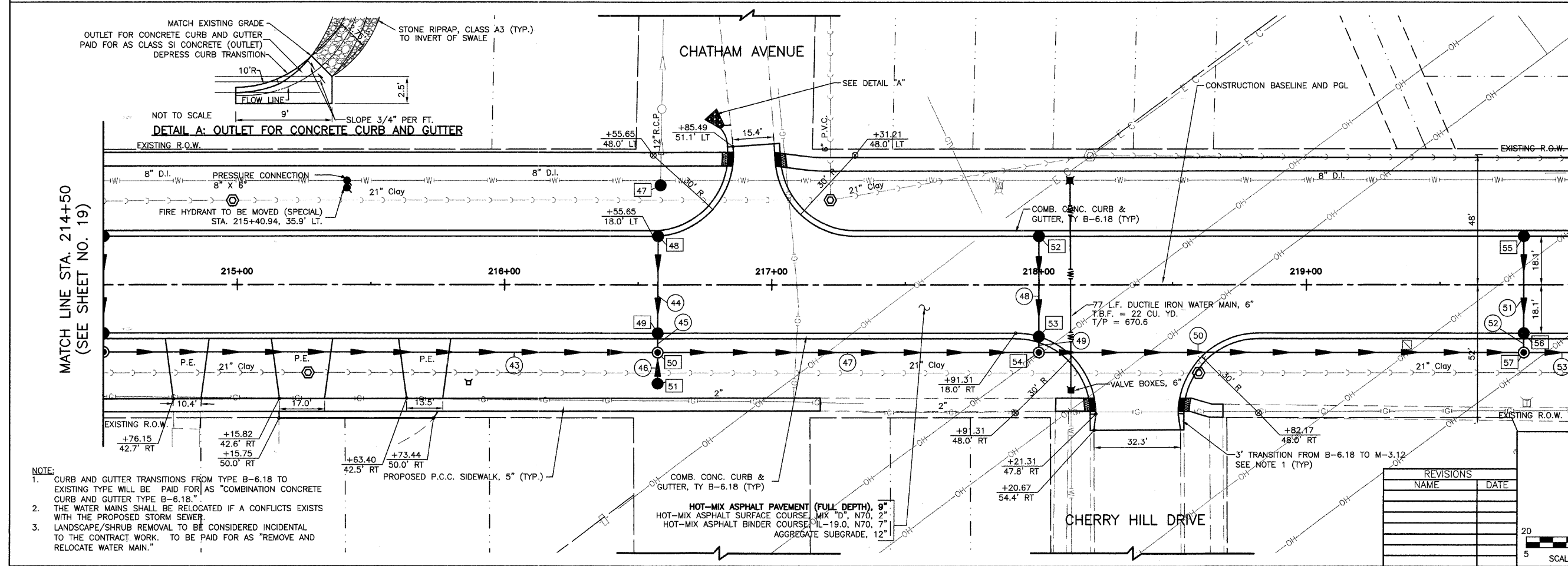

MATCH LINE STA. 220+00  
(SEE SHEET NO. 21)

MATCH LINE STA. 214+50  
(SEE SHEET NO. 19)

FULLERTON AVENUE  
PROPOSED IMPROVEMENTS

VILLAGE OF ADDISON  
**ROADWAY PLAN**  
FULLERTON AVENUE  
STA. 214+50 TO 220+00

REVISIONS	
NAME	DATE

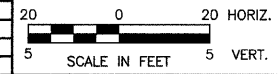

DATE: 11/26/2007  
DESIGNED BY: RTM  
TECHNICIAN: JRR  
CHECKED BY: JRV

- NOTE:**
- CURB AND GUTTER TRANSITIONS FROM TYPE B-6.18 TO EXISTING TYPE WILL BE PAID FOR AS "COMBINATION CONCRETE CURB AND GUTTER TYPE B-6.18."
  - THE WATER MAINS SHALL BE RELOCATED IF A CONFLICTS EXISTS WITH THE PROPOSED STORM SEWER.
  - LANDSCAPE/SHRUB REMOVAL TO BE CONSIDERED INCIDENTAL TO THE CONTRACT WORK. TO BE PAID FOR AS "REMOVE AND RELOCATE WATER MAIN."