

FAH. REC.	SECTION	COUNTY	TOTAL SHEETS	SHEET NO.
1380	00-00084-00-PV	DUPAGE	93	23
STA. 514+00		TO STA. 517+00		
LINE		SURFACE TRANSPORTATION FUNDING		

CONTRACT NUMBER 83993

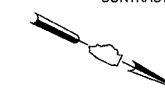

MATCH LINE STA. 514+00
(SEE SHEET NO. 21)

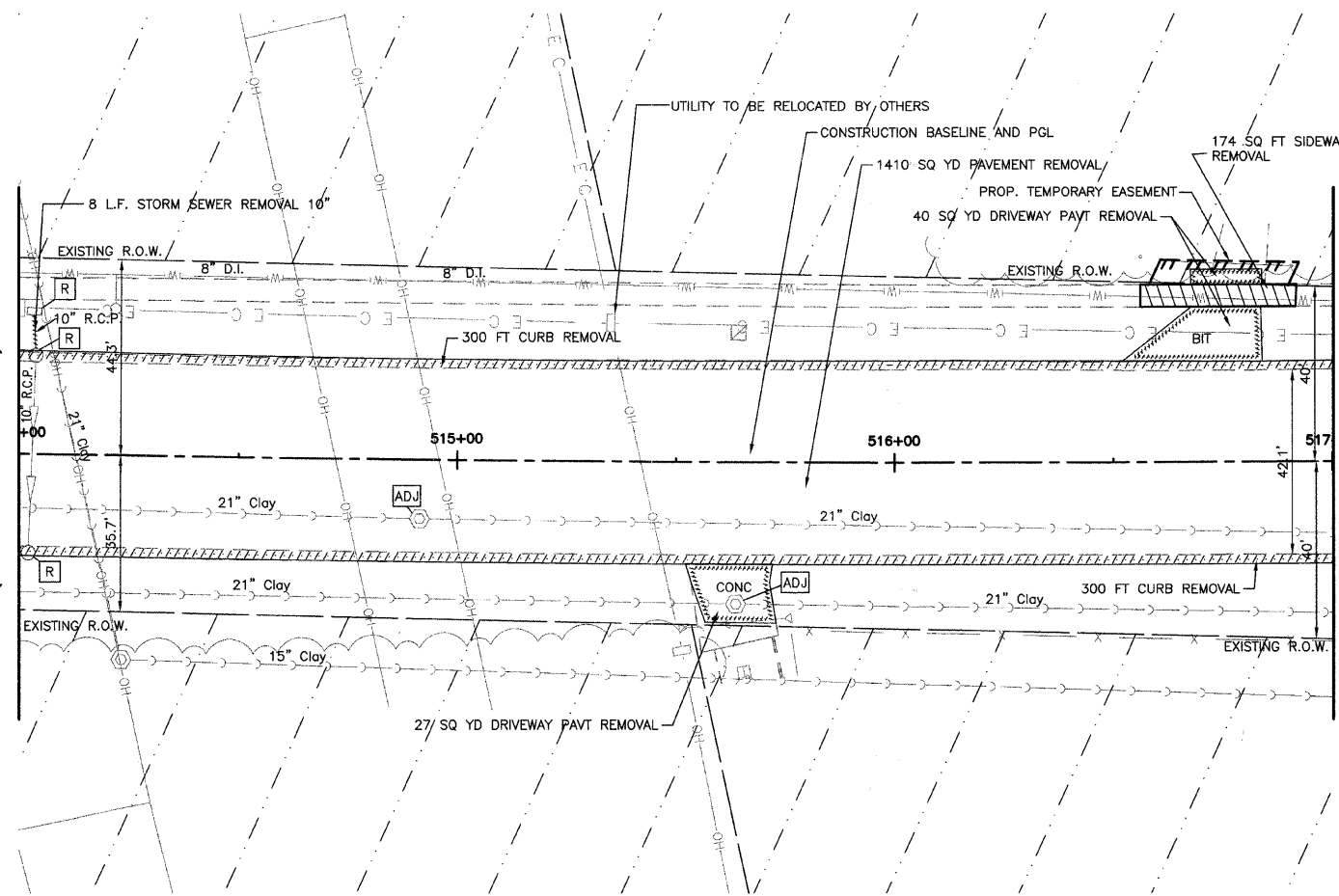

MATCH LINE STA. 517+00
(SEE SHEET NO. 24)

VILLA AVENUE
EXISTING TOPOGRAPHY

MATCH LINE STA. 514+00
(SEE SHEET NO. 21)

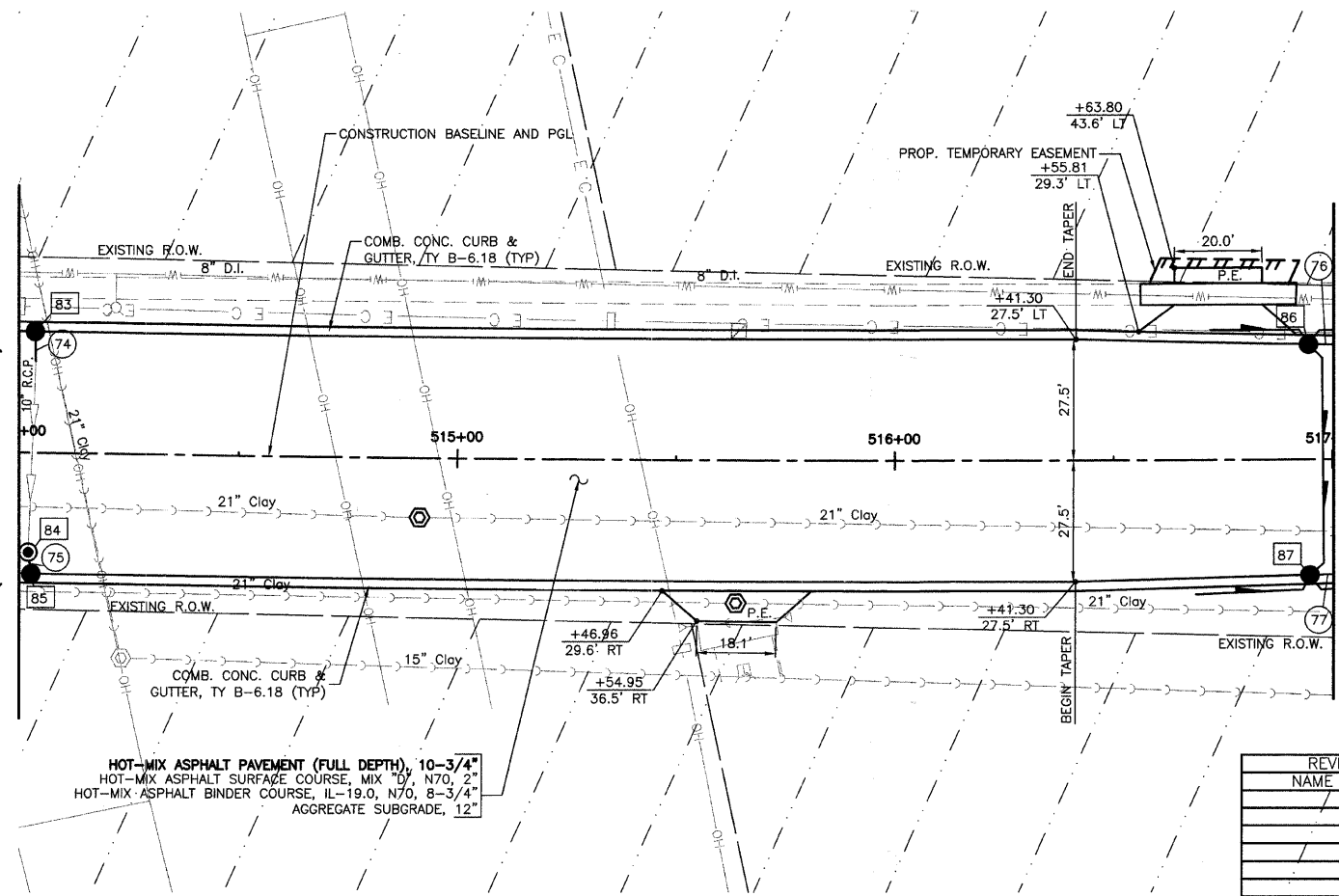

MATCH LINE STA. 517+00
(SEE SHEET NO. 24)

VILLA AVENUE
PROPOSED IMPROVEMENTS

VILLAGE OF ADDISON
ROADWAY PLAN
VILLA AVENUE
STA. 514+00 TO 517+00

REVISIONS	
NAME	DATE

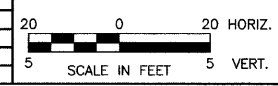

DATE: 11/26/2007
DESIGNED BY: RTM
TECHNICIAN: JRR
CHECKED BY: JRV

NOTE:
1. THE WATER MAIN SHALL BE RELOCATED IF A CONFLICT EXISTS WITH THE PROPOSED STORM SEWER.
TO BE PAID FOR AS "REMOVE AND RELOCATE WATER MAIN."

HOT-MIX ASPHALT PAVEMENT (FULL DEPTH), 10-3/4"
HOT-MIX ASPHALT SURFACE COURSE, MIX D7, N70, 2"
HOT-MIX ASPHALT BINDER COURSE, IL-19.0, N70, 8-3/4"
AGGREGATE SUBGRADE, 12"