

CONSTRUCTION PHASING:

PROPOSED ROAD WORK WILL BE PERFORMED IN FOUR (4) CONSTRUCTION PHASES AS FOLLOWS:

- PHASE 1 - SAWCUT MEDIAN SEGMENTS ALONG JANES AVENUE. REMOVE AND REPLACE CONCRETE SIDEWALKS AND CURB AND GUTTER. AS SHOWN ON PLANS AND AS DIRECTED BY THE ENGINEER.
- PHASE 2 - REMOVE EXISTING PAVEMENT ON JANES AVENUE BETWEEN KILDEER STREET AND LORRAINE AVENUE AND AT PROPOSED BARRIER MEDIANS. COLDMILL PAVEMENT ALONG JANES AVENUE FROM KILDEER STREET TO 71ST STREET AND REMOVE CORRUGATED MEDIAN. CONSTRUCT CORRUGATED MEDIAN AND BARRIER CURB FOR LANDSCAPED MEDIANS ON JANES AVENUE. PLACE AGGREGATE BASE COURSE. INSTALL IRRIGATION SYSTEM IN MEDIANS AND RESTORE LANDSCAPE.
- PHASE 3 - PLACE HOT-MIX ASPHALT BINDER COURSE ON JANES AVENUE.
- PHASE 4 - PLACE HOT-MIX ASPHALT SURFACE COURSE ON JANES AVENUE.

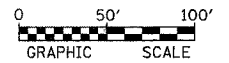
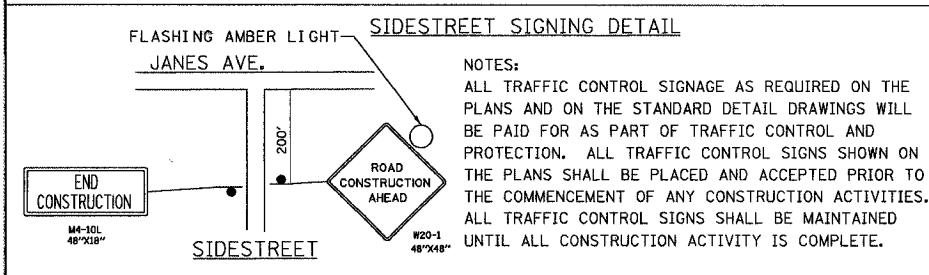
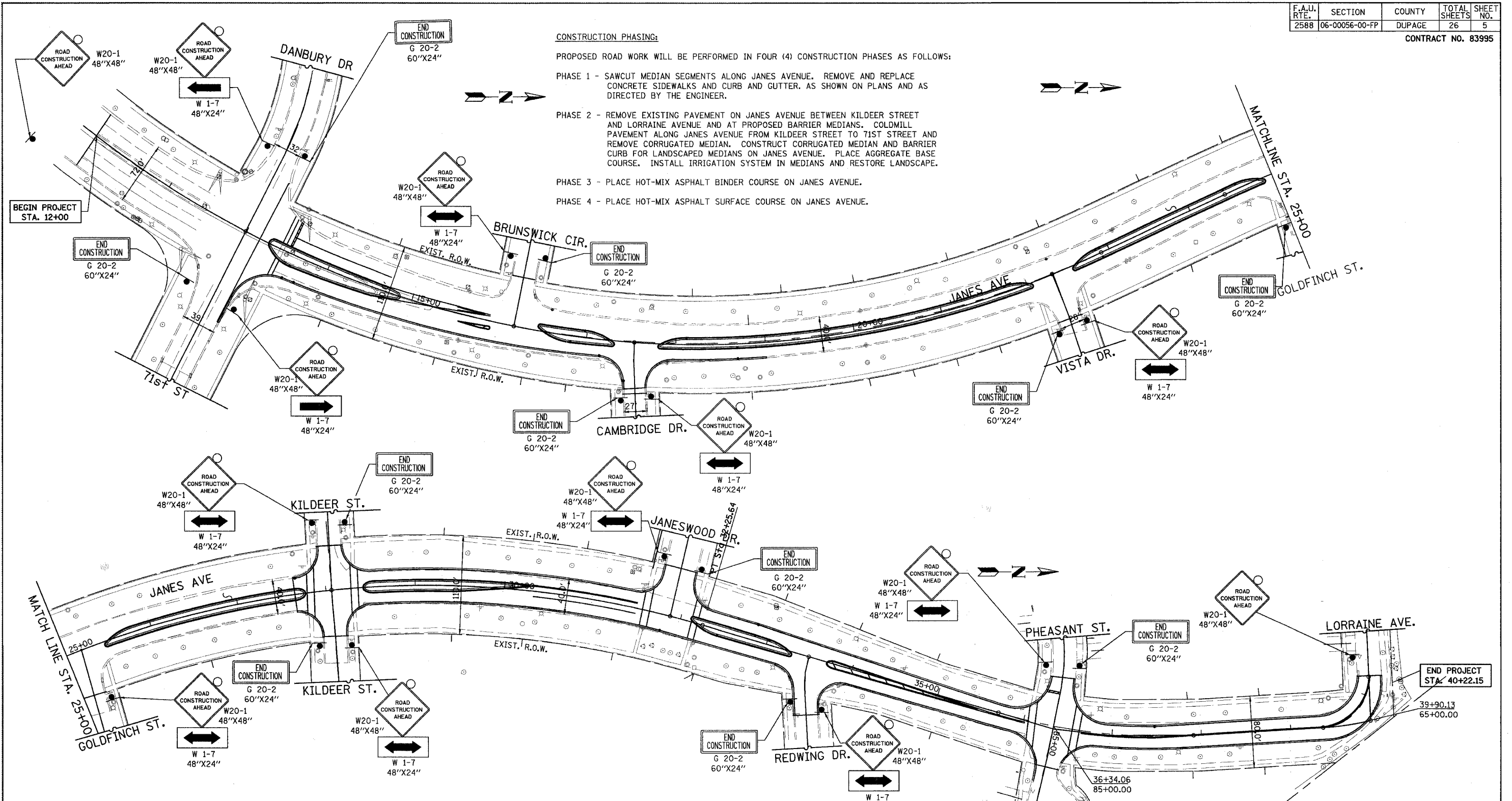

REVISIONS	
NAME	DATE

URS 100 S. WACKER DR., SUITE 500 TEL (312)-939-1000
CHICAGO, IL 60606 FAX (312)-939-4198

VILLAGE OF WOODRIDGE
JANES AVENUE
71ST STREET TO LORRAINE AVENUE
MAINTENANCE OF TRAFFIC PLAN
STA. 12+00 TO STA. 40+22.15

SCALE: 1" = 50'
DATE: 11/30/2007

DRAWN BY: VAP
CHECKED BY: DDL