

LOCATION MAP
(NOT TO SCALE)

NOTES:

- CONTRACTOR SHALL RELOCATE MAILBOXES TO A LOCATION APPROVED BY THE POSTAL SERVICE. THIS WORK SHALL BE INCLUDED IN MOT WORK.
- CHANGEABLE MESSAGE SIGNS SHALL BE PLACED ON BOTH ENDS OF JANES AVENUE A MINIMUM OF TWO WEEKS PRIOR TO THE START OF CONSTRUCTION
- TRAFFIC CONTROL FOR JANES AVENUE SHALL CONSIST OF THE INSTALLATION OF TYPE 3 BARRICADES WITH "ROAD CLOSED TO THROUGH TRAFFIC" SIGNS LOCATED AT EITHER END OF THE STREET AND AT ALL INTERSECTING SIDE STREETS.

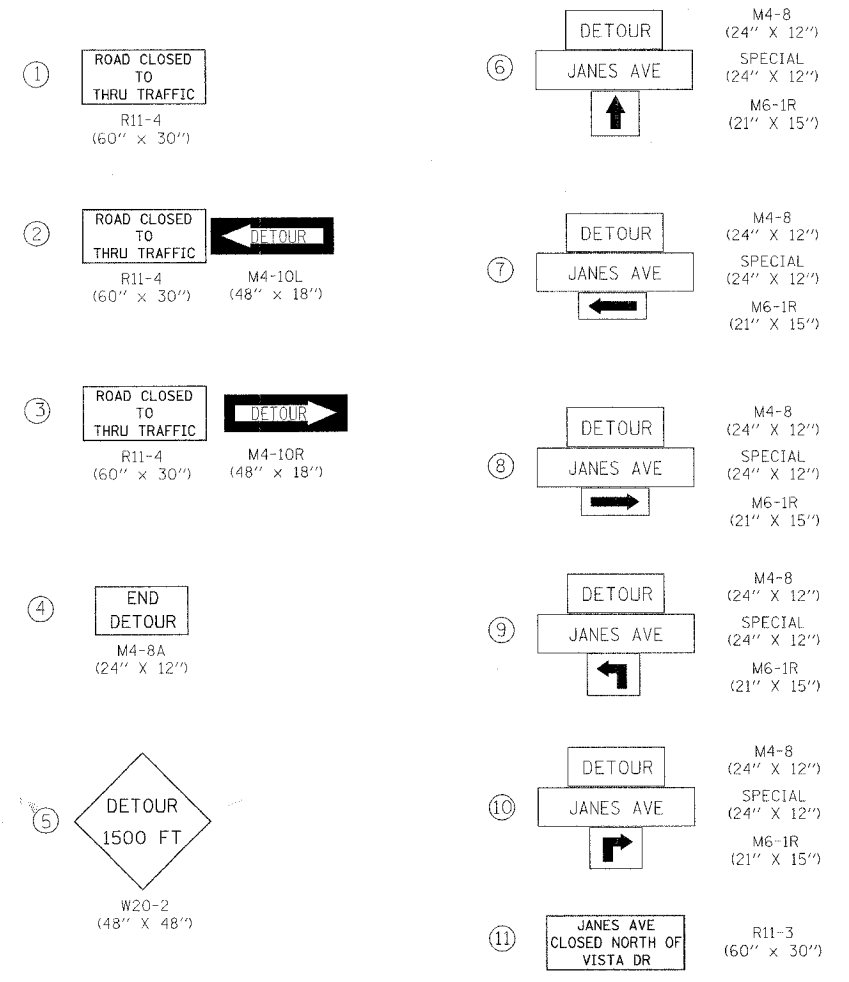

MAINTENANCE OF TRAFFIC - DETOUR ROUTE
 DURING CONSTRUCTION, A DETOUR PLAN WILL BE IMPLEMENTED. SOUTHBOUND TRAFFIC ON JANES AVENUE WILL USE JANESWOOD DRIVE TO DANBURY/71ST STREET AND NORTHBOUND TRAFFIC WILL USE THE REVERSE DIRECTION. ALL DETOUR ROUTES ARE UNDER LOCAL JURISDICTION. LOCAL ACCESS SHALL BE PROVIDED AT ALL TIMES. ALL SIGNS, BARRICADES AND TEMPORARY STRIPING SHALL CONFORM TO THE ILLINOIS MANUAL ON UNIFORM TRAFFIC CONTROL DEVICES (MUTCD) SUPPLEMENT, THE ILLINOIS STANDARD SPECIFICATIONS, AND THE MUTCD, PAID FOR AS TRAFFIC CONTROL AND PROTECTION FOR TEMPORARY DETOUR

URS 100 S. WACKER DR., SUITE 500 TEL (312)-939-1000
 CHICAGO IL, 60606 FAX (312)-939-4198

REVISIONS	
NAME	DATE

VILLAGE OF WOODRIDGE
 JANES AVENUE
 71ST STREET TO LORRAINE AVENUE
 MAINTENANCE OF TRAFFIC PLAN
 STA. 12+00 TO 40+22.15
 SCALE: 1" = 50'
 DATE: 11/30/2007
 DRAWN BY: VAP
 CHECKED BY: BDL