

F.A.U. RTE.	SECTION	COUNTY	TOTAL SHEETS	SHEET NO.
2588	06-00056-00-FP	DUPAGE	26	10

CONTRACT NO. 83995

STRUCTURE	△	△	△	△	△
STA.	13+18.1	13+23.6	15+60.7	15+60.9	17+89.9
OFFSET	64.9' RT	67.0' RT	22.65' RT	29.1' RT	19.8' RT
TYPE	INLET TY. A	ADJ. INLET	CB, TY.-A*	ADJ. CB	CB, TY.-A
F & G	TYPE 11	TY. 1 F & CL	TY. 11	TY. 1 F & CL	TY. 11
RIM EL.	756.18	756.60	758.61	759.20	760.25
INV. EL.	752.45	752.35 (EX.)	755.20	755.10 (EX.)	756.10
STORM SEWER	6 LF, TYPE 1, 12"		* TO BE INSTALLED ON EXISTING SEWER		6 LF, TYPE 1, 12"

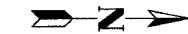
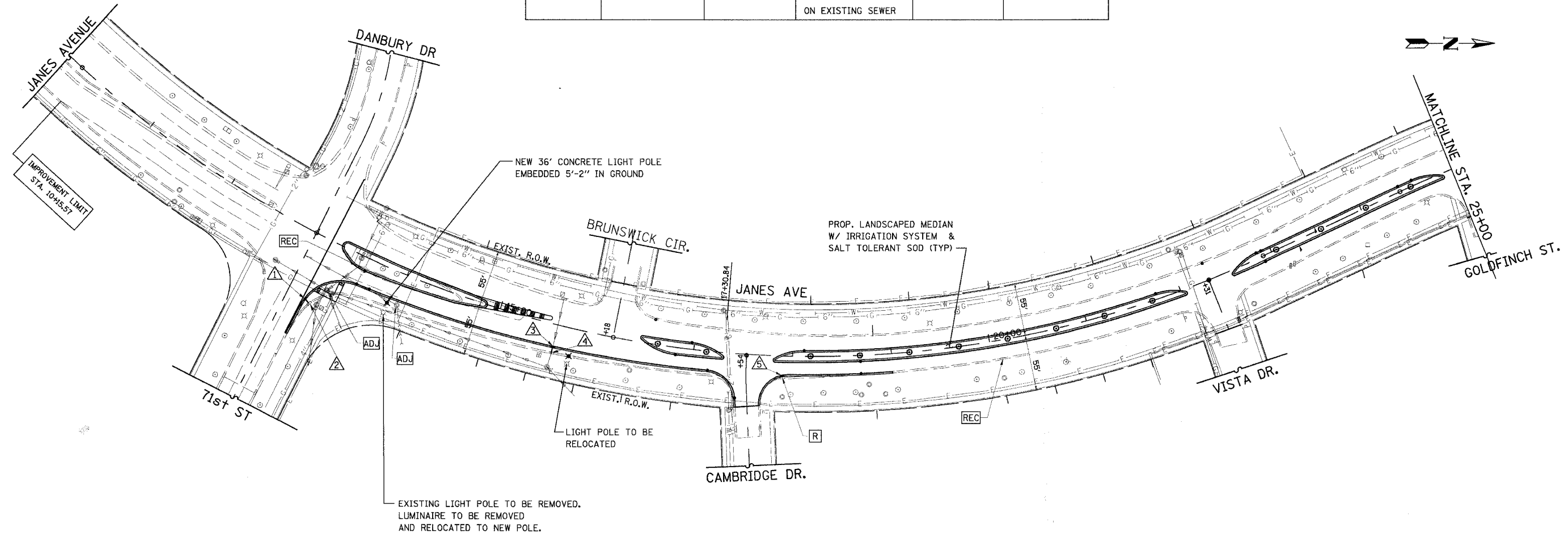

LEGEND

- R STRUCTURE REMOVAL
- REC STRUCTURE TO BE RECONSTRUCTED
- ADJ STRUCTURE TO BE ADJUSTED
- ✕ LIGHT POLE TO BE RELOCATED/REPLACED
- EXIST. UNDERGROUND SEWER
- EXIST. SANITARY SEWER
- PROP. 12" RCP

NOTE:
CONTRACTOR SHALL AUGER CONDUIT & PIPING FOR
SPRINKLER SYSTEM UNDER PAVEMENT TO REMAIN.

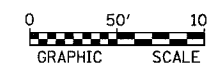

REVISIONS	
NAME	DATE

URS 100 S. WACKER DR., SUITE 500 TEL (312) 939-1000
CHICAGO IL, 60606 FAX (312) 939-4198

VILLAGE OF WOODRIDGE
JANES AVENUE
71ST STREET TO LORRAINE AVENUE
REHABILITATION AND RESURFACING
DRAINAGE AND UTILITY PLAN
STA. 10+15.57 TO STA. 25+00

SCALE: 1" = 50'
DATE: 11/30/2007

DRAWN BY: VAP
CHECKED BY: DDL