

STATE OF ILLINOIS  
DEPARTMENT OF TRANSPORTATION

ROUTE NO.	SECTION	COUNTY	TOTAL SHEETS	SHEET NO.	SHEET NO. 14 14 SHEETS
FAS 204	*	ROCK ISLAND	31	22	
FED. ROAD DIST. NO. 7		ILLINOIS	FED. AID PROJECT		

\* 92-00297-00-BR

When cantilever forming brackets are used, the work shall be done according to Article 503.06, except as modified below and in the details shown on this sheet.  
The finishing machine rails shall be placed on the top flange of the exterior beams.  
The beams or girders supporting cantilever forming brackets shall be tied together at 1.2 m intervals.  
For Standard construction, or Stage Construction the Hardwood bracing materials shall be placed as shown between webs of beams in each bay.

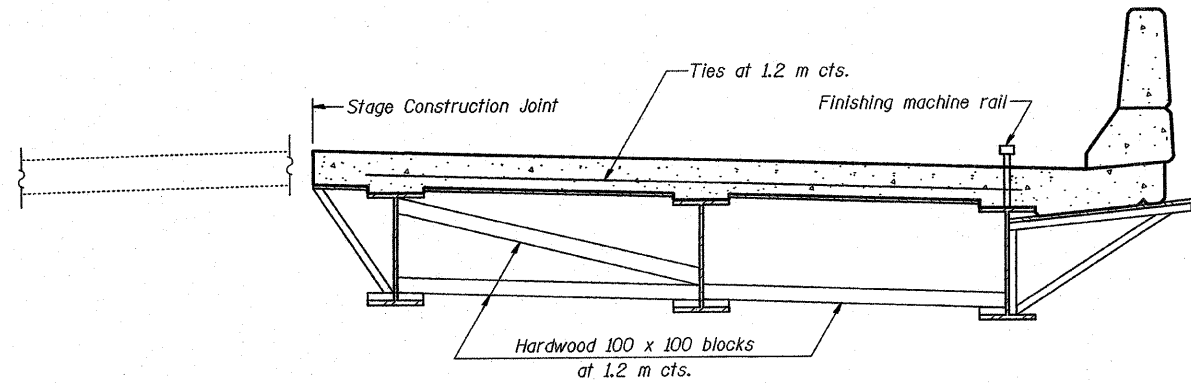

**FORM BRACES FOR  
STAGE CONSTRUCTION**

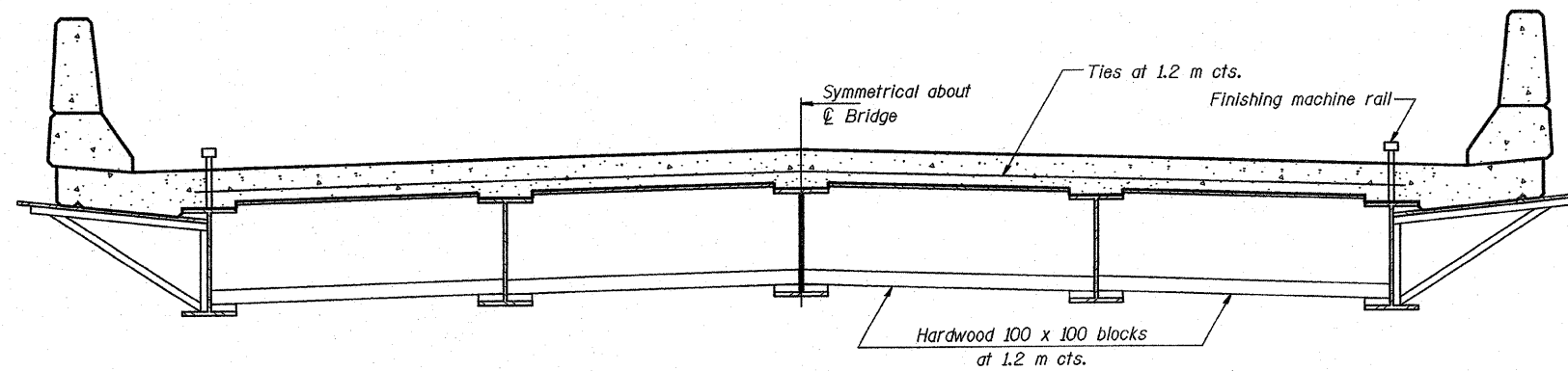

**FORM BRACES FOR  
STANDARD CONSTRUCTION**

DESIGNED	SPN
CHECKED	TWH
DRAWN	R. Doty
CHECKED	SPN/TWH

Aug. 24, 2007  
EXAMINED *Thomas J. Donagale*  
ENGINEER OF BRIDGE DESIGN  
PASSED *Ralph E. Anderson*  
ENGINEER OF BRIDGES AND STRUCTURES

SB-1 (M) 4-30-97

**CANTILEVER FORMING BRACKETS**  
**F.A.S. RT. 204 SEC. 92-00297-00-BR**  
**ROCK ISLAND COUNTY**  
**STA. 0+304.801**