

F.A. RTE.	SECTION	COUNTY	TOTAL SHEETS	SHEET NO.
204	92-00297-00-BR	ROCK ISLAND	31	27
STA. 0+270		TO STA. 0+340		
FED. ROAD DIST. NO. 7 ILLINOIS FED. AID PROJECT				

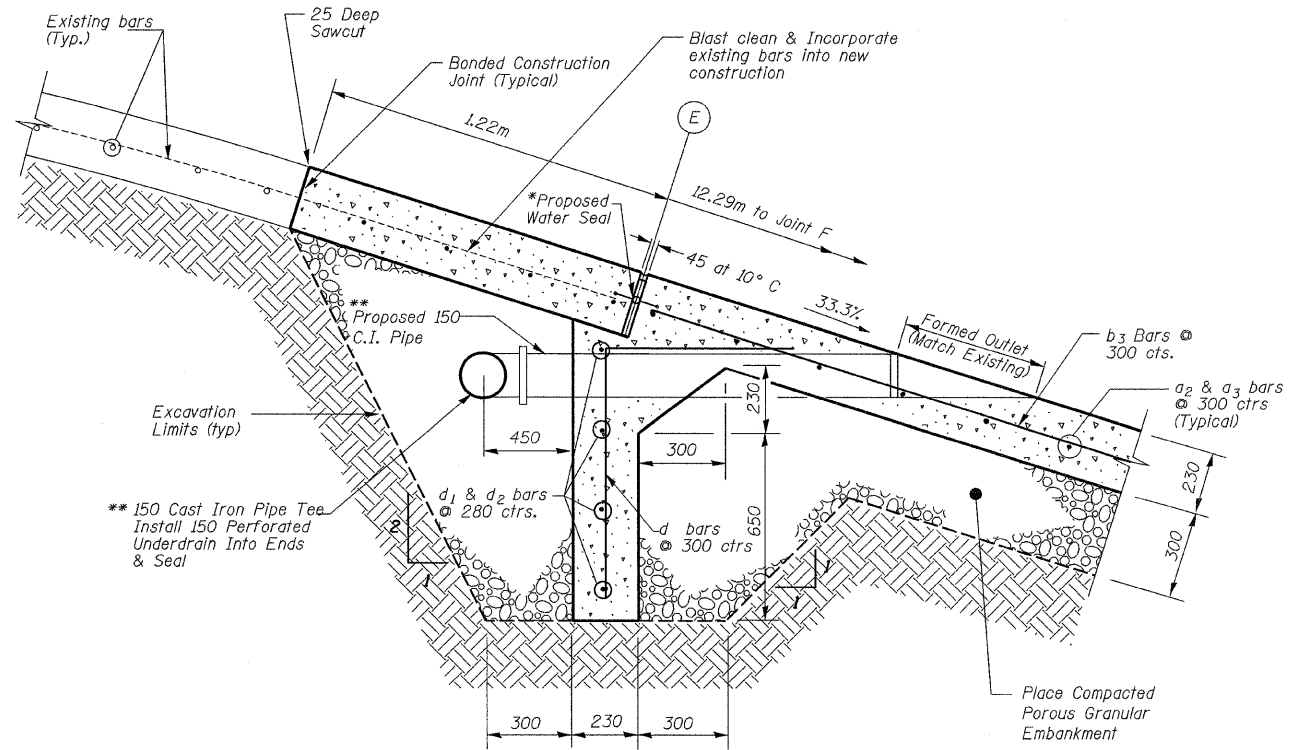

DETAIL 1  
27

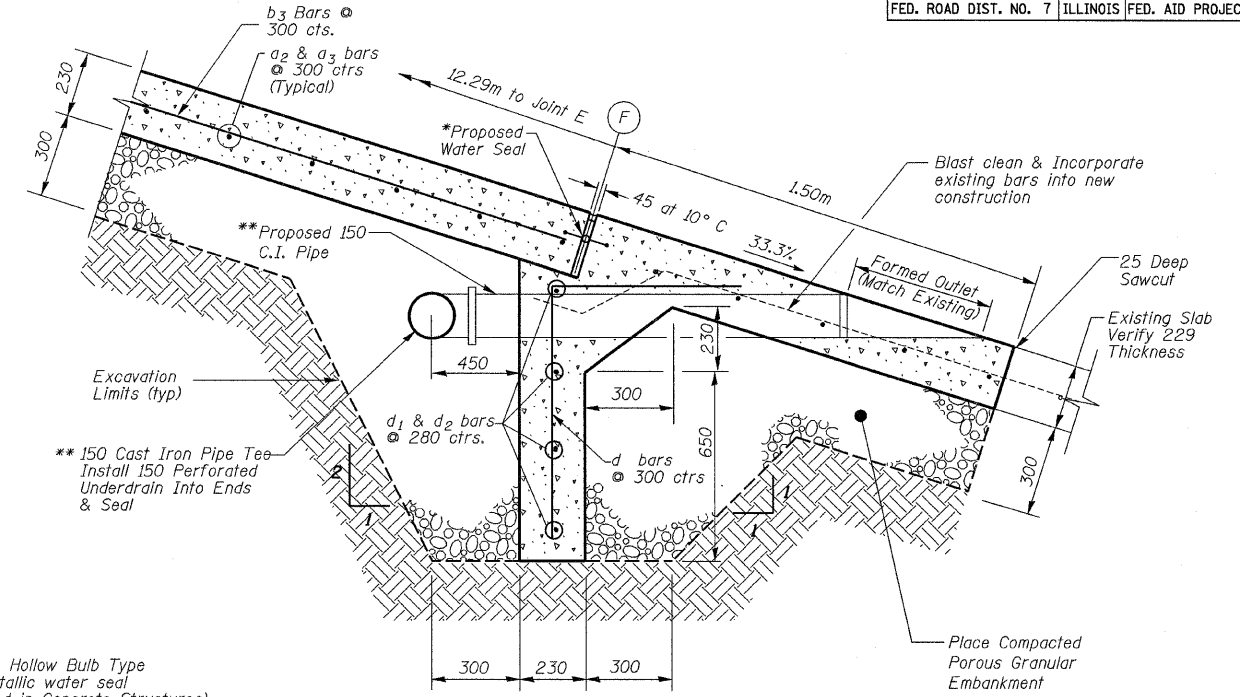

DETAIL 2  
27

Notes:  
 \* 150 mm Hollow Bulb Type non-metallic water seal (Included in Concrete Structures)  
 \*\* The Cast Iron Pipe, fittings, & Installation shall be Included in Cost of Pipe Underdrains

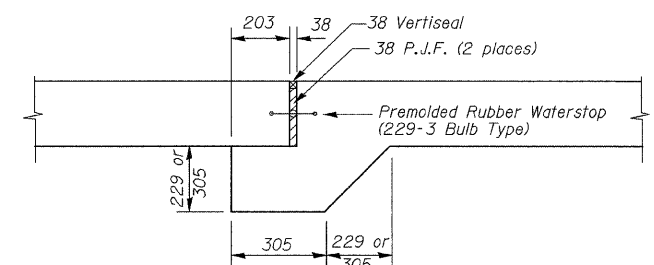

ORIGINAL JOINT DETAIL  
For All Vertical & Horizontal Joints

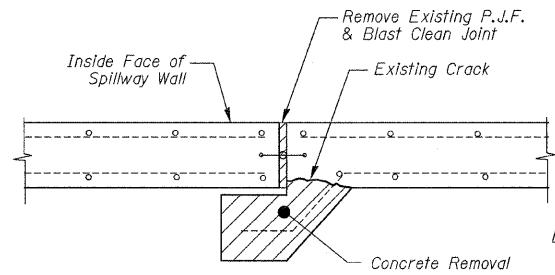

TYPE II EXISTING JOINT  
(Concrete Removal)

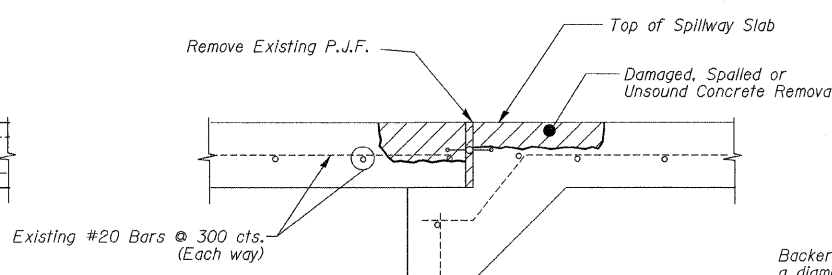

TYPE III EXISTING JOINT  
(Repair Concrete Structures)

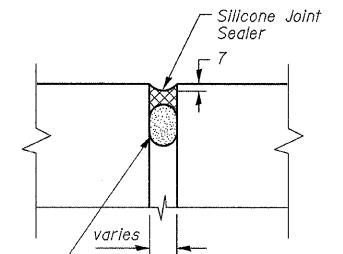

SILICONE JOINT SEALER DETAIL

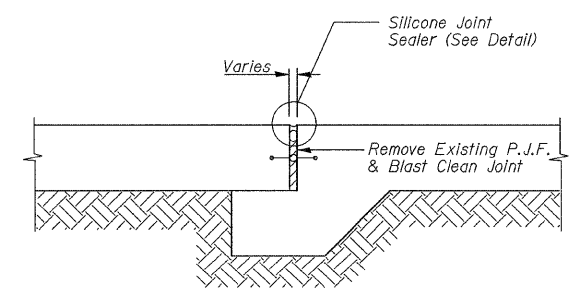

TYPE I REPAIR  
For Horizontal Slab Joints A-H & Pier Stem

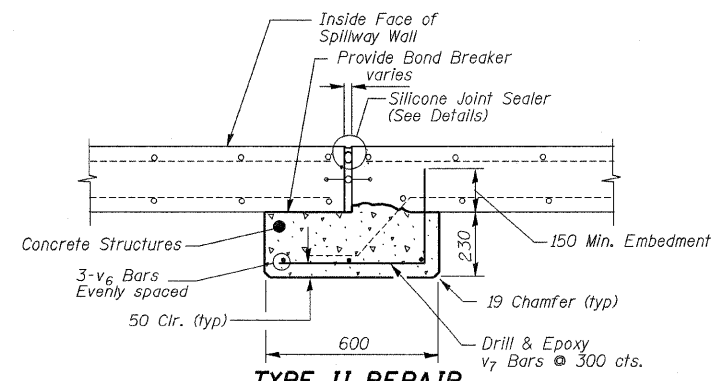

TYPE II REPAIR  
(Concrete Structures)

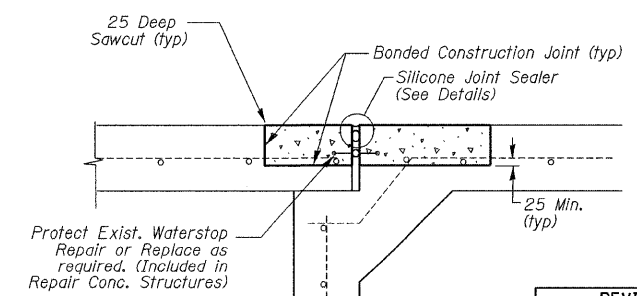

TYPE III REPAIR  
(Repair Concrete Structures)

REVISIONS	
NAME	DATE

ILLINOIS DEPARTMENT OF TRANSPORTATION  
**TYPICAL JOINT DETAILS & REPAIRS**  
 C.H. 59 OVER LAKE GEORGE SPILLWAY  
 ROCK ISLAND, COUNTY  
 DRAWN BY RAP  
 CHECKED BY JBF  
 DATE NOV. 2007