

F.A.S. RTE.	SECTION	COUNTY	TOTAL SHEETS	SHEET NO.
1274	05-00627-00-BR	LASALLE	45	8
STA. 18+80.00	TO STA. 27+00.00			
FED. ROAD DIST. NO.	ILLINOIS	FED. AID PROJECT	87351	

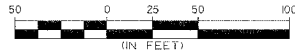

PLAN	SURVEYED	DATE
	BY	
	NOTED	
	BY	
	DATE	

PROFILE	SURVEYED	DATE
	BY	
	NOTED	
	BY	
	DATE	

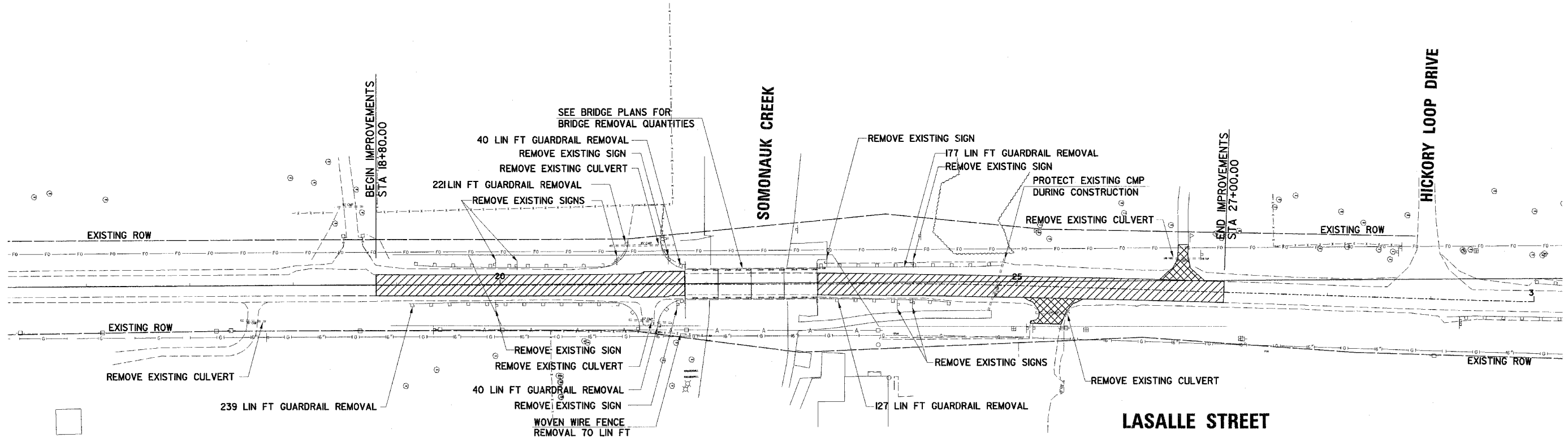

NOTE:
EXISTING ENTRANCES AT STA. 21+40 LT AND 21+45 RT TO BE CLOSED AND REMOVED (SEE CROSS-SECTIONS FOR PROPOSED GRADING).

REMOVAL PLAN LEGEND	
	PAVEMENT REMOVAL
	DRIVEWAY PAVEMENT REMOVAL

REVISIONS	
NAME	DATE

ILLINOIS DEPARTMENT OF TRANSPORTATION
LASALLE STREET BRIDGE REPLACEMENT

REMOVAL PLAN

SCALE: VERT. DRAWN BY
HORIZ. CHECKED BY
DATE 11/16/07

I:\Projects\111607\111607.dwg
 11/16/07