

F.A. RTE.	SECTION	COUNTY	TOTAL SHEETS	SHEET NO.
MS 7660	05-00104-00-RS	TAZEWELL	36	9
STA.		TO STA.		
FED. ROAD DIST. NO.		ILLINOIS FED. AID PROJECT		

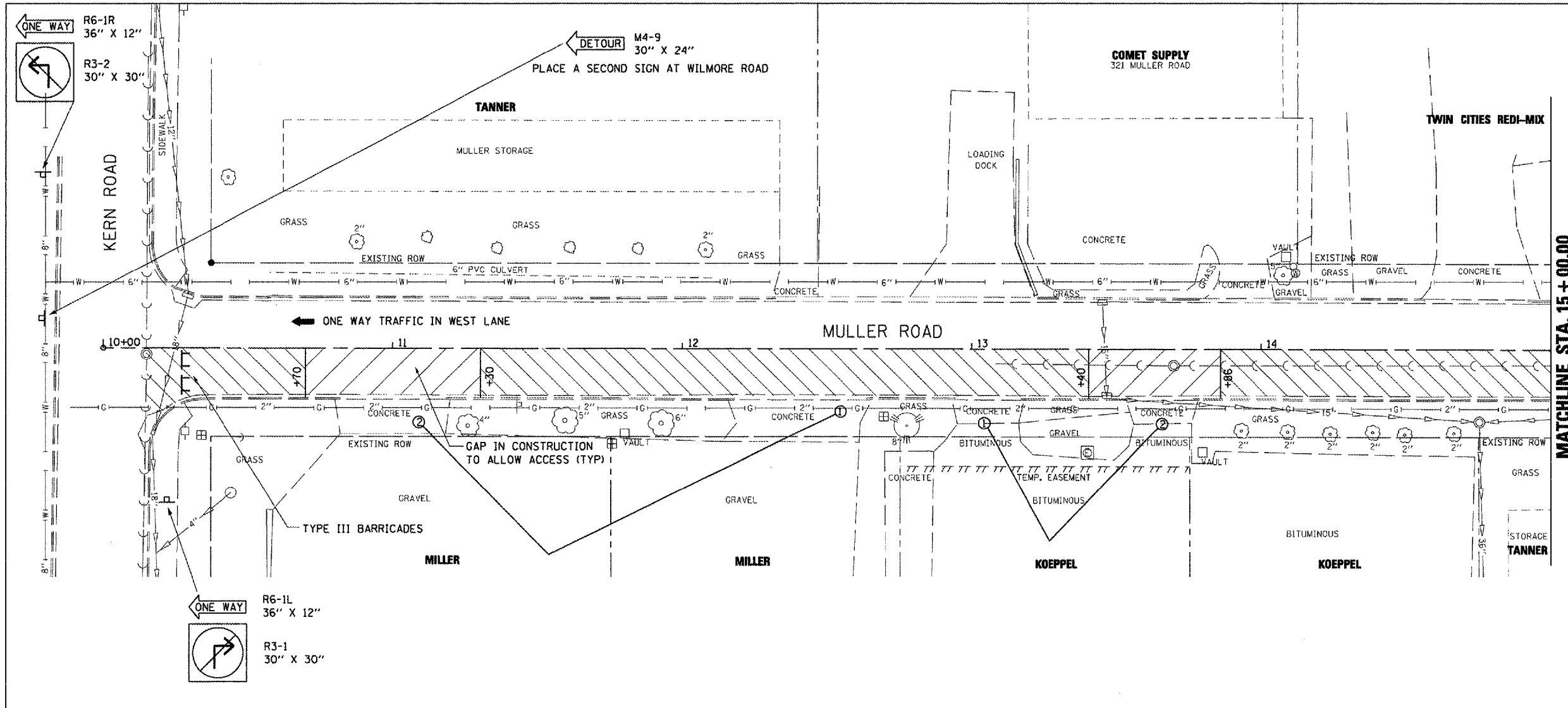

- PRE-STAGE A WORK**
- ① ② DRIVEWAYS CANNOT BE CLOSED CONCURRENTLY- CONSTRUCT ①, REOPEN ①, THEN CONSTRUCT ②
 - ③ DRIVEWAYS TO BE CONSTRUCTED ONE HALF AT A TIME ALLOWING DRIVEWAY USE AT ALL TIMES

- STAGE 1A WORK**
- ACCESS TO REMAIN OPEN DURING STAGE 1A
 - PAVEMENT REMOVAL AND REPLACEMENT PER PLANS IN STAGE 1A

- STAGE 1B WORK**
- PAVEMENT WORK TO BE COMPLETED IN STAGE 1B

MATCHLINE STA. 15 + 00.00

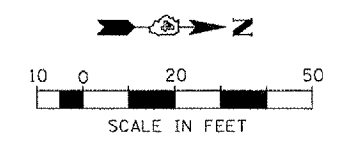
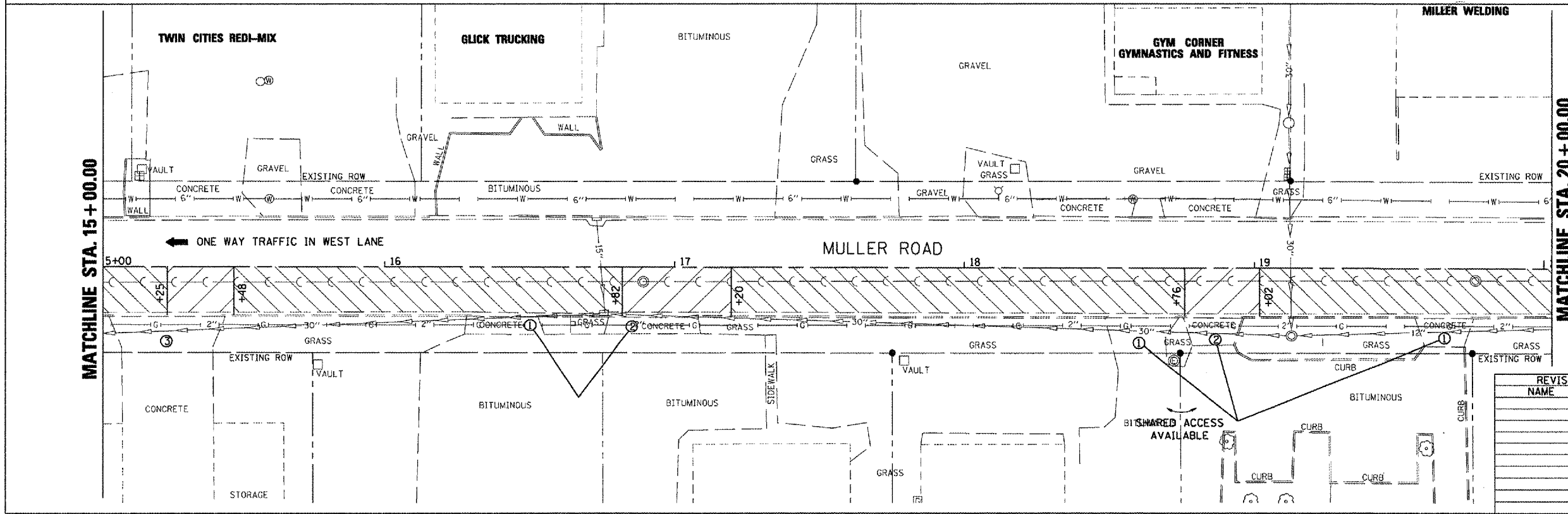

REVISIONS	
NAME	DATE

ILLINOIS DEPARTMENT OF TRANSPORTATION
MULLER ROAD IMPROVEMENTS
MAINTENANCE OF TRAFFIC
STAGE 1

SCALE: AS SHOWN
 DATE 11-14-07
 DRAWN BY DLC
 CHECKED BY KMC

MULLER - MAINTENANCE OF TRAFFIC STAGE 1 - STA. 10+00 TO STA. 20+00

PLOT DATE = 8/16/08
 PLOT SCALE = AS SHOWN
 USER NAME = BUSER