

DESCRIPTION OF INTENDED SEQUENCE OF MAJOR CONSTRUCTION ACTIVITIES WHICH WILL DISTURB EARTH AND LEAD TO POSSIBLE EROSION FOR MAJOR PORTIONS OF THE CONSTRUCTION SITE:

SHELBY COUNTY
SECTION 04-07120-00-BR
ROUTE TR-437
SHEET 4 OF 17 SHEETS
CONTRACT NO. 95528

1. REMOVAL OF THE EXISTING STRUCTURE.
2. CONSTRUCTION OF THE REPLACEMENT STRUCTURE
3. PLACEMENT OF ROADWAY EMBANKMENT TO RAISE THE ROADWAY TO PROPOSED GRADE.
4. DRAINAGE STRUCTURES, INCLUDING DITCHES, WILL BE INSTALLED BEFORE AND/OR DURING THE COMPLETION OF THE EMBANKMENT.
5. PLACEMENT AND MAINTENANCE OF TEMPORARY EROSION CONTROL.
6. PLACEMENT OF PERMANENT EROSION CONTROL.
7. REMOVAL AND PROPER CLEAN UP OF TEMPORARY EROSION CONTROL.
8. FINAL GRADING, PLACING AGGREGATE AND OTHER MISCELLANEOUS ITEMS.

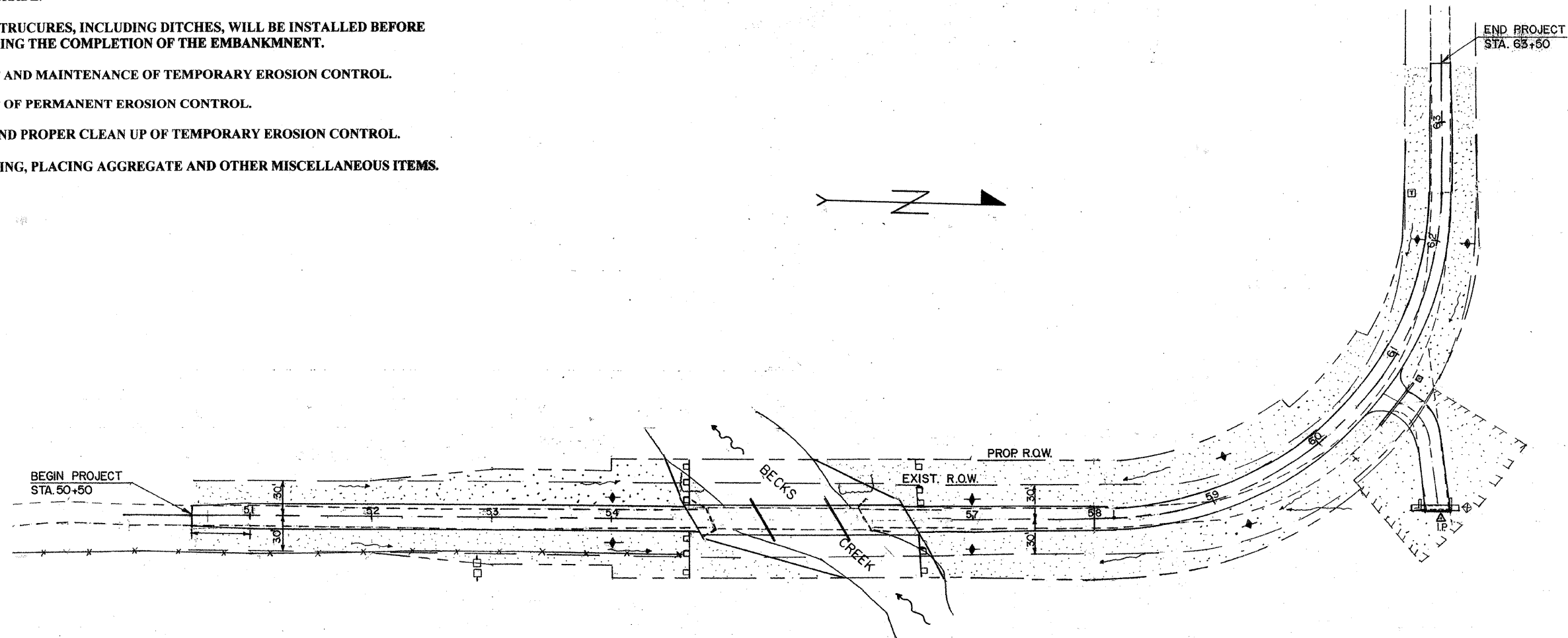

BILL OF MATERIALS

ITEM	UNIT	QUANTITY
TEMPORARY EROSION CONTROL SEEDING	POUND	800
TEMPORARY DITCH CHECKS	EACH	8
INLET AND PIPE PROTECTION	EACH	2
PERIMETER EROSION BARRIER	FEET	200

THE ABOVE QUANTITIES ARE ESTIMATES ONLY. ACTUAL QUANTITIES FOR EROSION CONTROL WILL BE DETERMINED BY THE ENGINEER IN THE FIELD AND THERE WILL BE NO ADJUSTMENT IN ANY UNIT PRICE DUE TO A CHANGE IN PLAN QUANTITY.

TEMPORARY EROSION CONTROL:

- PERIMETER EROSION BARRIER
- ◆ TEMPORARY DITCH CHECK
- ⊕ INLET AND PIPE PROTECTION

PERMANENT EROSION CONTROL:

- SEEDING CLASS 2, FERTILIZERS, & MULCH, METHOD 2

TEMPORARY DITCH CHECKS

LT. & RT. STA. 54+00 = 2 EACH
 LT. & RT. STA. 57+00 = 2 EACH
 LT. & RT. STA. 59+25 = 2 EACH
 LT. & RT. STA. 62+00 = 2 EACH
 TOTAL = 8 EACH

PERIMETER EROSION BARRIER

STA. 54+67 (50'LT. - 50'RT.) = 100 Ft.
 STA. 56+49 (50'LT. - 50'RT.) = 100 Ft.
 TOTAL = 200 Ft.

INLET AND PIPE PROTECTION

RT. STA. 60+45 = 1 EACH
 RT. STA. 60+85 = 1 EACH
 TOTAL = 2 EACH

EROSION CONTROL PLAN
TR-437 OVER BECK'S CREEK
SECTION 04-07120-00-BR
SHELBY COUNTY