

Benchmark #2
NW corner of lightpole base at 917 4th Street
Elevation - 677.54

Benchmark #3
NW corner sidewalk (top step) at 851 4th Street
Elevation - 668.97

- Surface Removal, 2 1/2"
- PCC Driveway Pavement
- Detectable Warning
- Pavement Patch
- Incidental Hot Mix Asphalt Surfacing
- Aggregate Surface

See sheets 50-53 for waterline notes

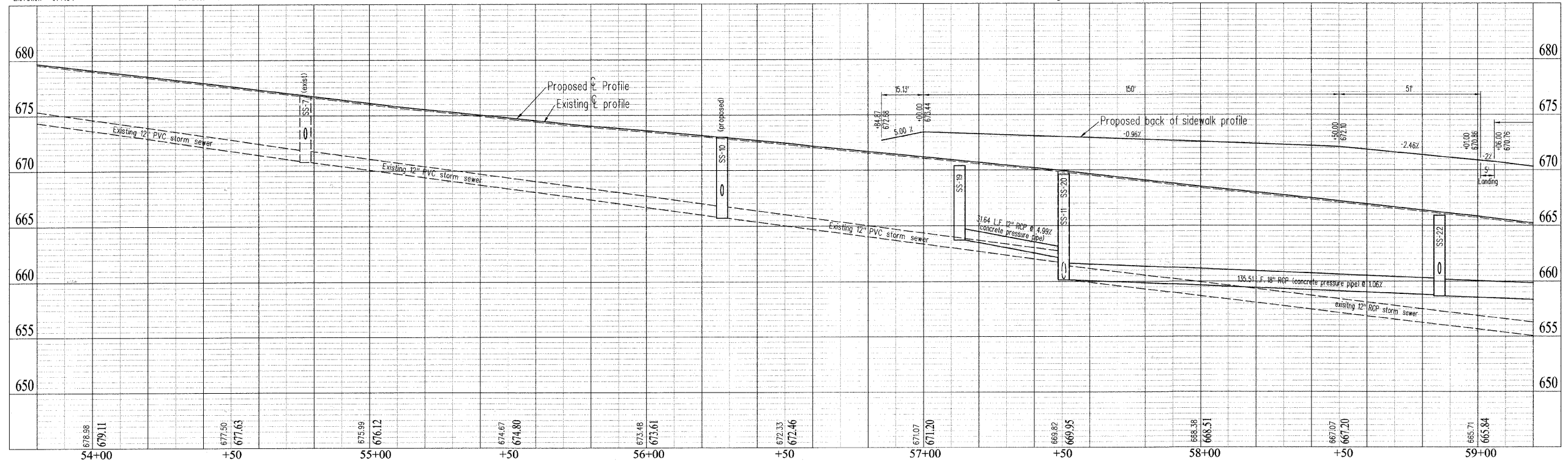

SCALE	DATE	BY
DRAWN	DATE	BY
CHECKED	DATE	BY
APPROVED	DATE	BY
REVISID	DATE	BY

PLAN: 1" = 20'
PROFILE: 1" = 20'
HORIZONTAL: 1" = 20'
VERTICAL: 1" = 2'

4th Street

Plan and Profile

Sheet No.
11
of 57 Sheets