

**CSI CONSOLIDATED SERVICES INC.**  
of Coles County

ENGINEERING - SURVEYING - CONSTRUCTION MANAGEMENT  
520 Jackson Avenue - P.O. Box 644 - Charleston, Illinois - 61920 - (217) 345-9511

CSI File #0319-06-06

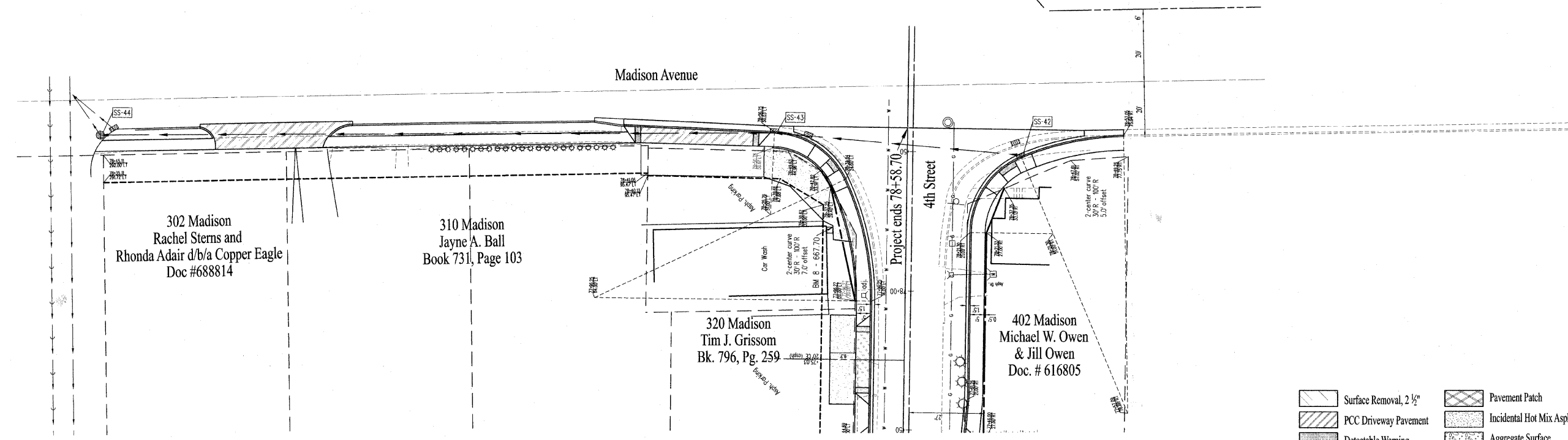

- Surface Removal, 2 1/2"
- PCC Driveway Pavement
- Detectable Warning
- Pavement Patch
- Incidental Hot Mix Asphalt Surfacing
- Aggregate Surface

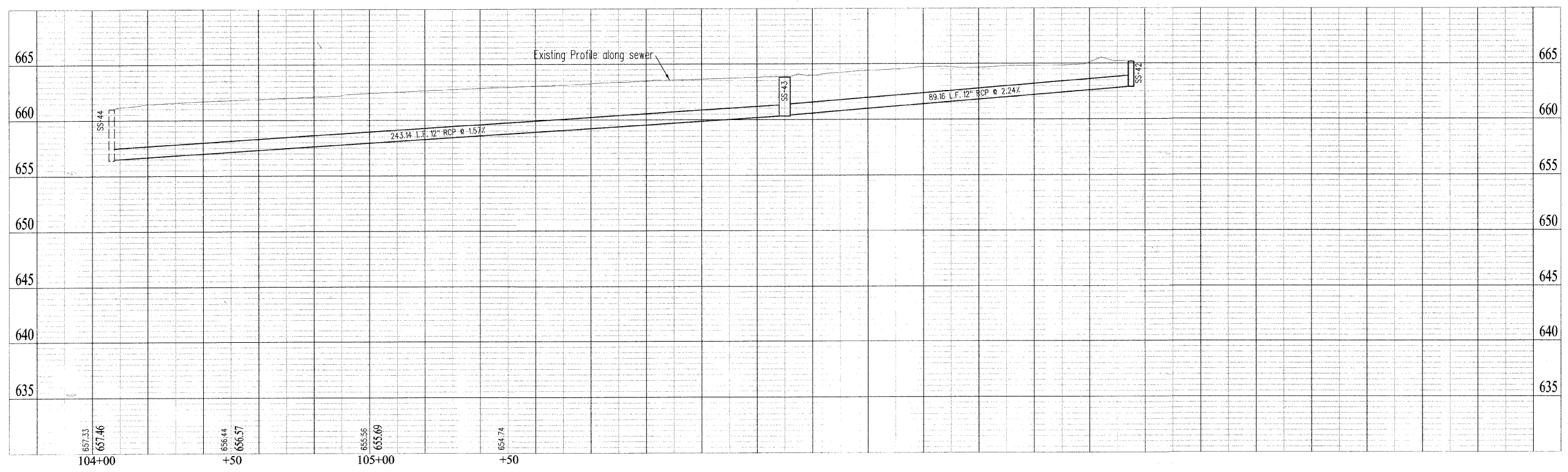

SCALE	DCR
Plan: 1" = 20'	DRAWN
Profile: 1" = 20'	CHECKED
Vertical: 1" = 2"	DATE
	DATE
	DATE
	DATE

# 4th Street

## Plan and Profile

Sheet No.  
**25**  
of 57 Sheets