

ROUTE	SECTION	CITY	TOTAL SHEETS	SHEET NO.
HOLLY ROAD	05-00076-00-PV	OLNEY	14	1
CONTRACT NO. 95541		ILLINOIS		

STATE OF ILLINOIS  
DEPARTMENT OF TRANSPORTATION  
DIVISION OF HIGHWAYS  
PLANS FOR PROPOSED  
HIGH PRIORITY PROJECT  
SECTION 05-00076-00-PV CITY OF OLNEY  
JOB NO. C-97-015-08  
PROJECT NO. HPP-1712(001)  
HOLLY ROAD

Joint Utility Locating Information for Excavators  
JULIE 1-800-892-0123

INDEX OF SHEETS

SHEET	ITEM
1	COVER SHEET
2	TYPICAL SECTIONS
3	SUMMARY OF QUANTITIES
4	DRAINAGE STRUCTURES / STORM SEWER
5-7	PLAN & PROFILE
8	INTERSECTION DETAILS
9	EROSION CONTROL
10-14	CROSS SECTIONS
	STANDARD 000001-05
	STANDARD 280001-04
	STANDARD 420001-07
	STANDARD 424001-05
	STANDARD 542301-01
	STANDARD 542311
	STANDARD 602301-01
	STANDARD 602306-01
	STANDARD 604001-02
	STANDARD 604036-01
	STANDARD 604051-02
	STANDARD 604066-01
	STANDARD 604086-01
	STANDARD 606001-03
	STANDARD 606301-03
	STANDARD 701006-02
	STANDARD 701201-02
	STANDARD 701301-02
	STANDARD 701311-02
	STANDARD 701326-02
	STANDARD 701501-04
	STANDARD 701901
	STANDARD 720001
	STANDARD 720006-01
	STANDARD 780001-01
	STANDARD 880001
	STANDARD BLR 10-5
	STANDARD BLR 21-7
	STANDARD BLR 22-5

PLAN	0' 20' 40'
PROFILE HOR.	0' 20' 40'
PROFILE VERT.	0' 5' 10'
CROSS SECTIONS	
HOR.	0' 5' 10'
VERT.	0' 5' 10'

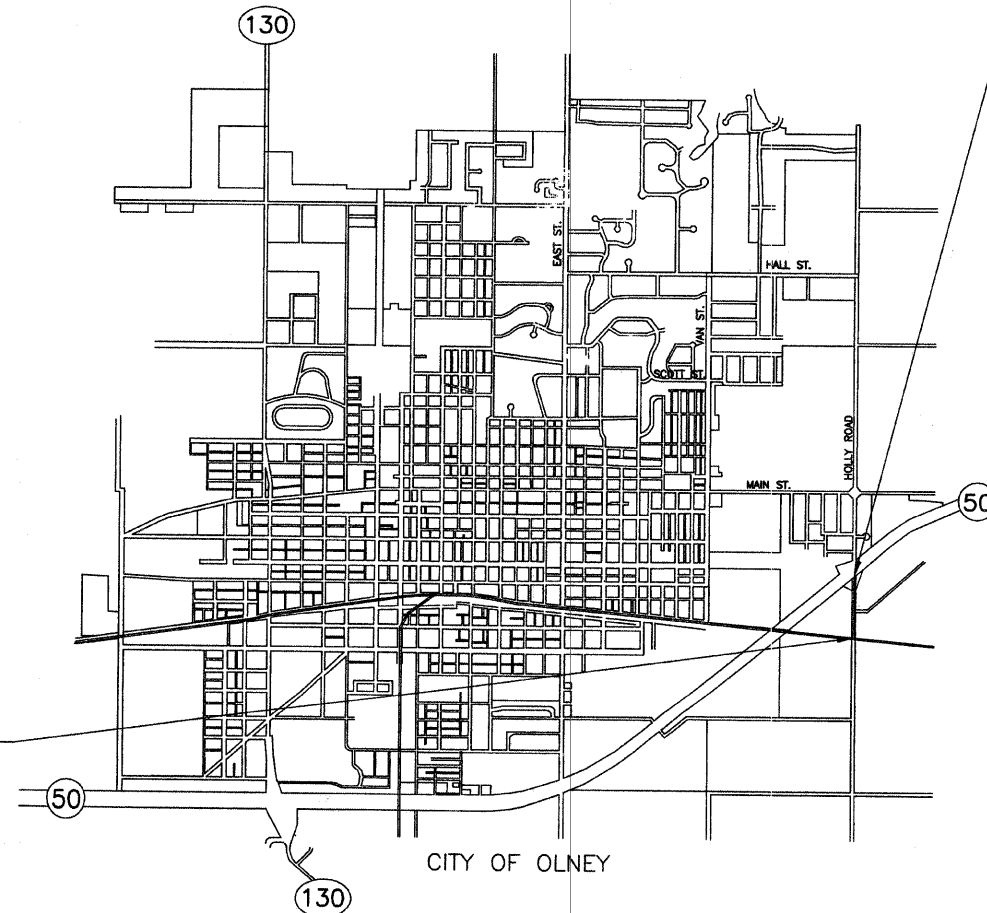

SECTION 05-00076-00-PV ENDS STA. 17+93.70

SECTION 05-00076-00-PV BEGINS STA. 5+30.00

CONTRACT NO. 95541

URBAN LOCAL ROAD  
ADT = 542  
DESIGN SPEED = 30 M.P.H.

NET LENGTH SECTION 05-00076-00-PV = 1263.70 FEET = 0.239 MILE

*Boyan A. Charlton*  
Lic. Reg. Engr. #29785  
12/18/07  
Lic. Expires 11/30/08

25186 REGISTERED PROFESSIONAL ENGINEER OF ILLINOIS

CHARLESTON ENGINEERING INC.  
105 N. KITCHELL  
P.O. BOX 397  
OLNEY, ILLINOIS 62450  
PH. 618-392-0736

APPROVED December 20, 2007  
*Tommy D. DeBorja*  
MAYOR - CITY OF OLNEY

PASSED 1-2, 2008  
*Manuel E. Kasal*  
DISTRICT SEVEN ENGINEER OF LOCAL ROADS AND STREETS

Releasing For Bid Based on Limited Review  
1-2, 2008  
*Christina M. Redden*  
DEPUTY DIRECTOR OF HIGHWAYS REGION FOUR ENGINEER

STATE OF ILLINOIS  
DEPARTMENT OF TRANSPORTATION

ROUTE	SECTION	CITY	TOTAL SHEETS	SHEET NO.
HOLLY ROAD	05-00076-00-PV	OLNEY	14	2
CONTRACT NO. 95541		ILLINOIS		

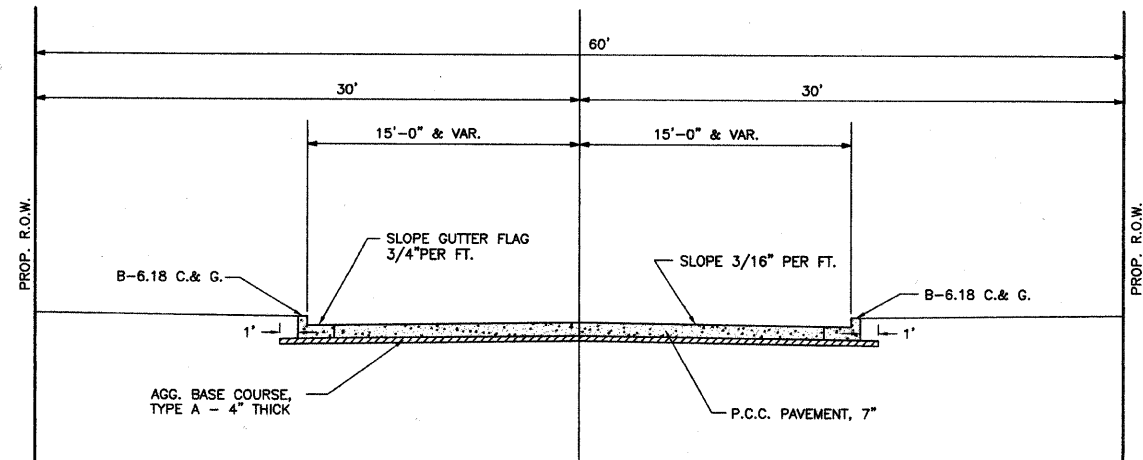

PROPOSED TYPICAL CROSS SECTION

STA. 5+30.00 TO 17+93.70

PAVEMENT DESIGN DATA

ADT = 2500 CLASS II  
P = 475  
SU = 33  
MU = 33  
IBR = 3.0  
T.F. = 0.50  
URBAN LOCAL ROAD  
PAVEMENT TYPE: P.C.C. PAVEMENT, 7"

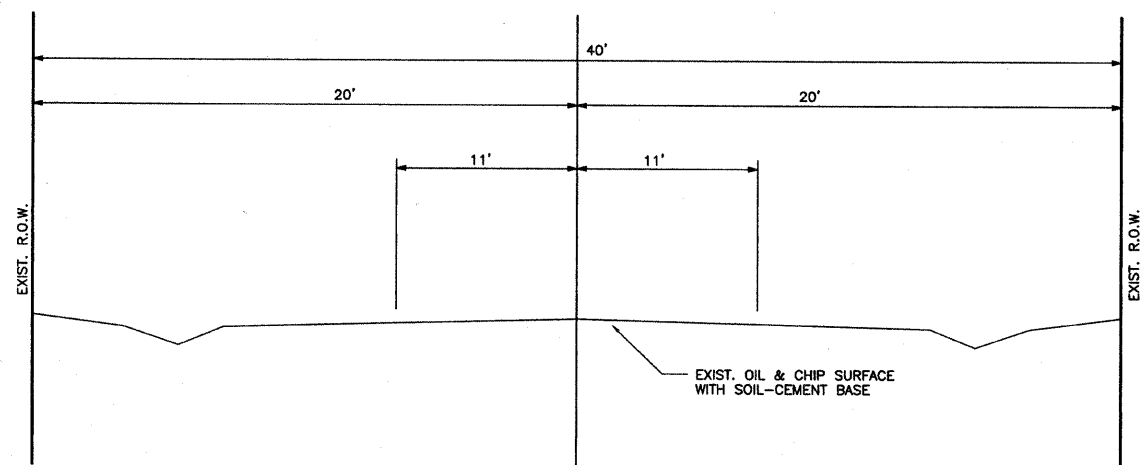

EXISTING TYPICAL CROSS SECTION

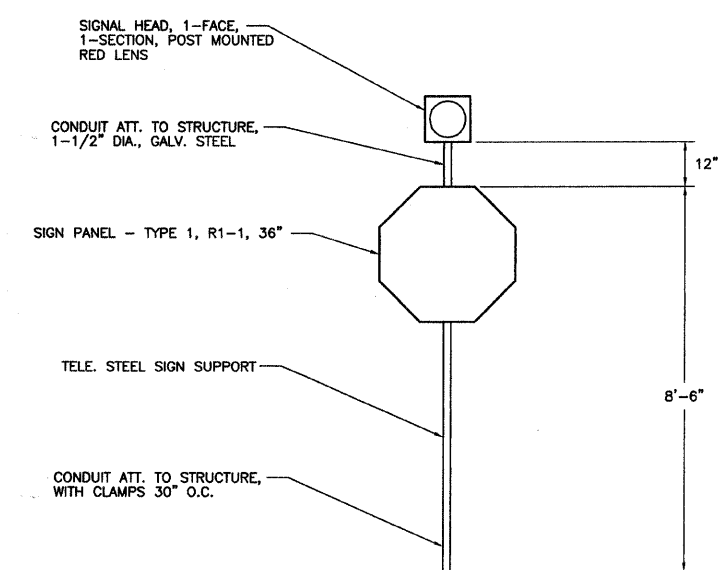

FLASHING BEACON DETAIL

SUMMARY OF QUANTITIES				SUMMARY OF QUANTITIES				ROUTE	SECTION	CITY	TOTAL SHEETS	SHEET NO.	
								HOLLY ROAD	05-00076-00-PV	OLNEY	14	3	
								CONTRACT NO. 95541		ILLINOIS			
ITEM	UNIT	QUANT.	J000	ITEM	UNIT	QUANT.	J000						
20100110	TREE REMOVAL (6 TO 15 UNITS DIAMETER)	UNIT	46	60603800	COMBINATION CONCRETE CURB AND GUTTER, TYPE B-6.12	FOOT	92						
20200100	EARTH EXCAVATION	CU.YD.	850	60604400	COMBINATION CONCRETE CURB AND GUTTER, TYPE B-6.18	FOOT	96						
20800150	TRENCH BACKFILL	CU.YD.	156	60609800	COMBINATION CONCRETE CURB AND GUTTER, TYPE M-6.18	FOOT	82						
25000900	SEEDING, CLASS 1 (SPECIAL)	ACRE	0.95	60625600	ISLAND PAVEMENT (6")	SQ.YD.	21						
28000250	TEMPORARY EROSION CONTROL SEEDING	POUND	400	67100100	MOBILIZATION	L SUM	1						
28000300	TEMPORARY DITCH CHECKS	EACH	4	70100450	TRAFFIC CONTROL AND PROTECTION, STANDARD 701201	L SUM	1						
28000500	INLET AND PIPE PROTECTION	EACH	20	70102620	TRAFFIC CONTROL AND PROTECTION, STANDARD 701501	L SUM	1						
28100805	STONE DUMPED RIPRAP, CLASS A3	TON	31	70103700	TRAFFIC CONTROL COMPLETE	L SUM	1						
35100100	AGGREGATE BASE COURSE, TYPE A	TON	1,240	70103815	TRAFFIC CONTROL SURVEILLANCE	CAL DAY	30						
40200800	AGGREGATE SURFACE COURSE, TYPE B	TON	50	72000100	SIGN PANEL - TYPE 1	SQ.FT.	9.0						
40800050	INCIDENTAL HOT-MIX ASPHALT SURFACING	TON	15	72800100	TELESCOPING STEEL SIGN SUPPORT	FOOT	16						
42300200	PORTLAND CEMENT CONCRETE DRIVEWAY PAVEMENT, 6 INCH	SQ.YD.	669	* 78001100	PAINT PAVEMENT MARKING - LETTERS AND SYMBOLS	SQ.FT.	61.2						
42400100	PORTLAND CEMENT CONCRETE SIDEWALK 4 INCH	SQ.FT.	70	* 78001110	PAINT PAVEMENT MARKING - LINE 4"	FOOT	325						
44000200	DRIVEWAY PAVEMENT REMOVAL	SQ.YD.	228	* 78001180	PAINT PAVEMENT MARKING - LINE 24"	FOOT	63						
44000600	SIDEWALK REMOVAL	SQ.FT.	70	* 81000400	CONDUIT IN TRENCH, 1 1/4" DIA., Δ GALVANIZED STEEL	FOOT	64						
44004400	PAVEMENT REMOVAL (SPECIAL)	SQ.YD.	2991	* 81100500	CONDUIT ATTACHED TO STRUCTURE, 1 1/2" DIA., Δ GALVANIZED STEEL	FOOT	18						
50104400	CONCRETE HEADWALL REMOVAL	EACH	1	* 81700205	ELECTRIC CABLE IN CONDUIT, 600 V (EPR-TYPE RHW) Δ 2-1/C NO. 12	FOOT	100						
50105220	PIPE CULVERT REMOVAL	FOOT	325	* 88000110	SIGNAL HEAD, 1-FACE, I-SECTION, POST MOUNTED Δ	EACH	1						
54213657	PRECAST REINFORCED CONCRETE FLARED END SECTIONS 12"	EACH	4	* 89501510	RELOCATE EXISTING FLASHING BEACON Δ	EACH	1						
54213663	PRECAST REINFORCED CONCRETE FLARED END SECTIONS 18"	EACH	2	LR420125	PORTLAND CEMENT CONCRETE PAVEMENT 7" (SPECIAL) WITH INTEGRAL CURB	SQ.YD.	5105						
54213669	PRECAST REINFORCED CONCRETE FLARED END SECTIONS 24"	EACH	2	X0321583	PIPE ELBOW 18"	EACH	2						
54247110	GRATING FOR CONCRETE FLARED END SECTION 18"	EACH	2	XX003474	PIPE TEE, 18" PIPE WITH 12" RISER	EACH	2						
54247130	GRATING FOR CONCRETE FLARED END SECTION 24"	EACH	2	XX005239	PIPE TEE, 15" PIPE WITH 12" RISER	EACH	1						
550B0050	STORM SEWERS, CLASS B, TYPE 1 12"	FOOT	1140	XX007267	PIPE TEE, 12" PIPE WITH 12" RISER	EACH	3						
550B0070	STORM SEWERS, CLASS B, TYPE 1 15"	FOOT	131	XX007268	PIPE TEE, 18" PIPE WITH 18" RISER	EACH	1						
550B0090	STORM SEWERS, CLASS B, TYPE 1 18"	FOOT	234	XX007269	PIPE TEE, 24" PIPE WITH 12" RISER	EACH	1						
550B0120	STORM SEWERS, CLASS B, TYPE 1 24"	FOOT	214	Z0022800	FENCE REMOVAL	FOOT	190						
60218400	MANHOLES, TYPE A, 4'-DIAMETER, TYPE 1 FRAME, CLOSED LID	EACH	1	Z0048665	Railroad Protective Liability Insurance	L SUM	1						
60235300	INLETS, TYPE A, TYPE 1 FRAME, CLOSED LID	EACH	2	Z0051500	REMOVING AND RESETTNG STREET SIGNS	EACH	2						
60236200	INLETS, TYPE A, TYPE 8 GRATE	EACH	11										
60236800	INLETS, TYPE A, TYPE 11 FRAME AND GRATE	EACH	3										
60237460	INLETS, TYPE A, TYPE 23 FRAME AND GRATE	EACH	25										
60243800	INLETS, SPECIAL, WITH TYPE 1 FRAME, OPEN LID	EACH	1										
60243900	INLETS, SPECIAL, WITH TYPE 1 FRAME, CLOSED LID	EACH	2										
60244130	INLETS, SPECIAL, WITH TYPE 11 FRAME AND GRATE	EACH	1										
60244213	INLETS, SPECIAL, WITH TYPE 23 FRAME AND GRATE	EACH	2										

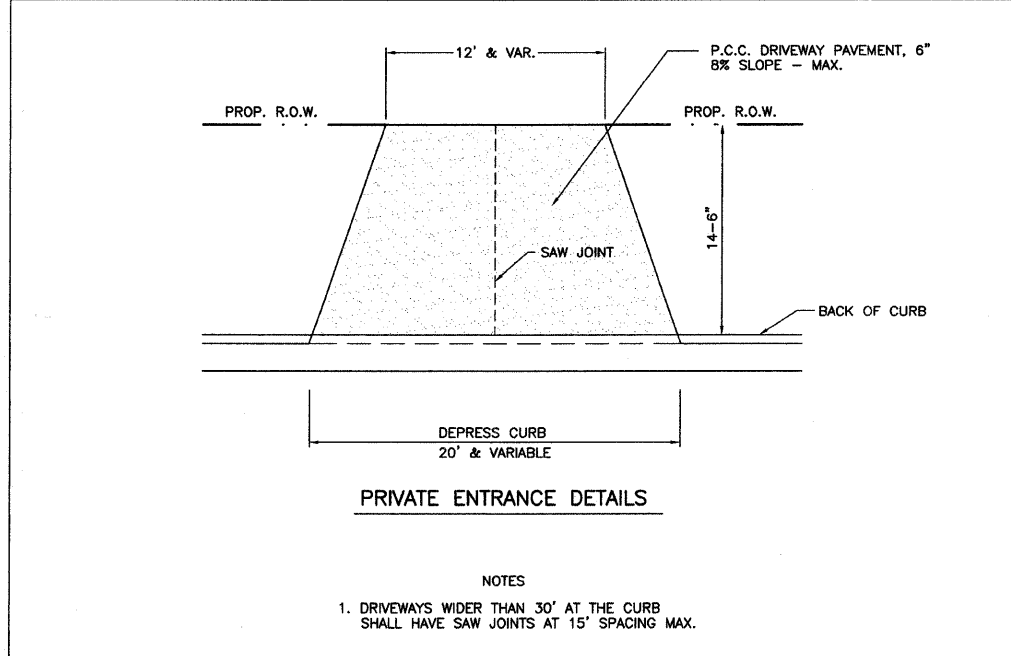
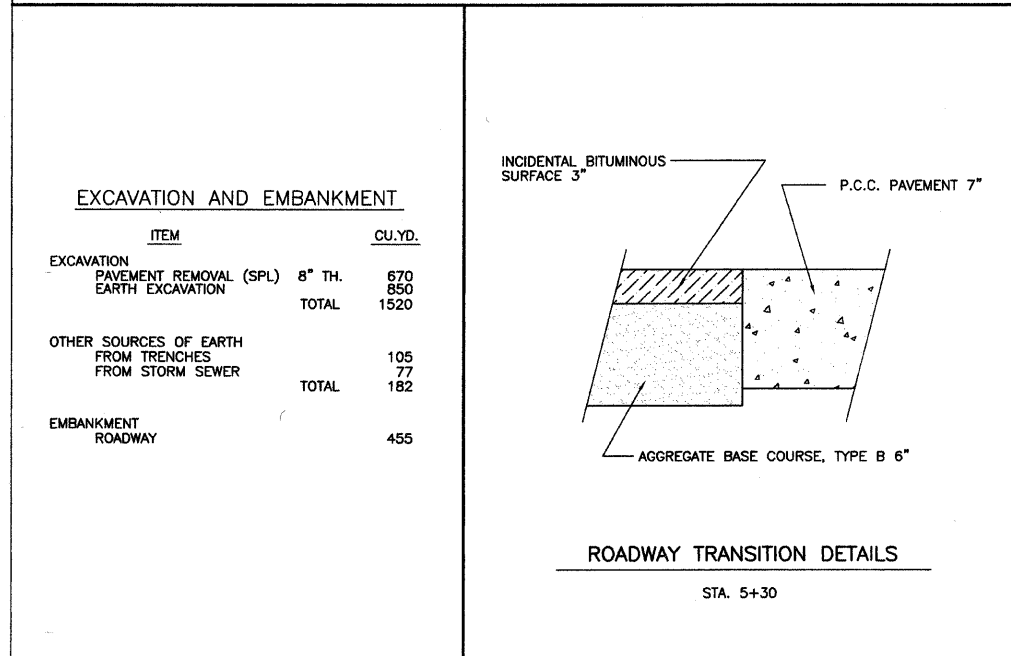

Δ Y031-1F  
\* SPECIALTY ITEMS

ROUTE	SECTION	CITY	TOTAL SHEETS	SHEET NO.
HOLLY ROAD	05-00076-00-PV	OLNEY	14	4
CONTRACT NO. 95541		ILLINOIS		

### DRAINAGE STRUCTURES

NO.	DIST.	STA.	ITEM	GRATE	INV.
1	20' LT.	5+15	P.R.C.F.E.S. 12"	-	499.08
2	20' LT.	5+50	PIPE TEE, 12" P. 12" R.	-	500.13
3	15' LT.	5+50	INLET TY-A, W/TY-23 F&G	502.55	500.16
4	15' RT.	5+50	INLET TY-A, W/TY-23 F&G	502.55	500.30
5	22.5' RT.	5+50	INLET TY-A, W/TY-8 GR	502.45	500.35
6	22.5' RT.	6+05	INLET TY-A, W/TY-8 GR	504.30	502.00
7	20' LT.	6+60	PIPE TEE, 12" P. 12" R.	-	503.42
8	15' LT.	6+60	INLET TY-A, W/TY-23 F&G	505.84	503.45
9	15' RT.	6+60	INLET TY-A, W/TY-23 F&G	505.84	503.59
10	22.5' RT.	6+60	INLET TY-A, W/TY-8 GR	505.74	503.64
11	22.5' RT.	7+15	INLET TY-A, W/TY-8 GR	506.46	504.10
12	20' LT.	7+70	INLET TY-A, W/TY-1 FR&CL L	506.70	504.33
13	15' LT.	7+70	INLET TY-A, W/TY-23 F&G	506.75	504.36
14	15' RT.	7+70	INLET TY-A, W/TY-23 F&G	506.75	504.50
15	22.5' RT.	7+70	INLET TY-A, W/TY-8 GR	506.65	504.55
16	26' LT.	8+37	P.R.C.F.E.S. 18" W/GRATE	-	504.58
17	20' LT.	8+37	PIPE TEE, 18" P. 18" R.	-	504.61
18	15' LT.	8+37	INLET TY-A, W/TY-23 F&G	506.95	504.64
19	15' RT.	8+37	INLET TY-A, W/TY-23 F&G	506.95	504.79
20	25' RT.	8+37	P.R.C.F.E.S. 12"	-	504.84
21	20' LT.	8+80	PIPE TEE, 18" P. 12" R.	-	504.84
22	15' LT.	8+80	INLET TY-A, W/TY-23 F&G	507.11	504.87
23	15' RT.	8+80	INLET TY-A, W/TY-23 F&G	507.11	505.01
24	22.5' RT.	8+80	INLET TY-A, W/TY-8 GR	507.00	505.06
25	20' LT.	9+70	INLET, SPL, W/TY-1 FR&CL L	507.90	505.33
26	15' LT.	9+70	INLET TY-A, W/TY-23 F&G	507.75	505.36
27	15' RT.	9+70	INLET TY-A, W/TY-23 F&G	507.75	505.50
28	22.5' RT.	9+70	INLET TY-A, W/TY-8 GR	507.65	505.55
29	20' LT.	10+68	INLET, SPL, W/TY-1 FR&CL L	508.70	506.52
30	15' LT.	10+68	INLET TY-A, W/TY-23 F&G	508.95	506.55
31	15' RT.	10+68	INLET TY-A, W/TY-23 F&G	508.95	506.70
32	22.5' RT.	10+68	INLET TY-A, W/TY-8 GR	508.85	506.75
33	25' LT.	13+90	INLET TY-A, W/TY-1 FR&CL L	509.20	506.10
34	18.5' RT.	13+90	INLET TY-A, W/TY-23 F&G	508.88	506.12
35	27' RT.	13+90	INLET TY-A, W/TY-23 F&G	508.88	506.22
36	25' LT.	14+60	PIPE TEE, 12" P. 12" R.	-	505.70
37	15' LT.	14+60	INLET TY-A, W/TY-23 F&G	508.14	505.72
38	15' RT.	14+60	INLET TY-A, W/TY-23 F&G	508.14	505.82
39	27' RT.	14+67	P.R.C.F.E.S. 12"	-	507.50
40	25' LT.	15+33	INLET, SPL, W/TY-1 FR&CL L	508.20	505.28
41	15' LT.	15+33	INLET TY-A, W/TY-23 F&G	507.58	505.30
42	15' RT.	15+33	INLET TY-A, W/TY-23 F&G	507.58	505.40
43	27' RT.	15+24	P.R.C.F.E.S. 12"	-	507.00
44	25' LT.	16+00	PIPE TEE, 15" P. 12" R.	-	504.90
45	15' LT.	16+00	INLET TY-A, W/TY-23 F&G	507.18	504.92
46	15' RT.	16+00	INLET TY-A, W/TY-23 F&G	507.18	505.02
47	25' RT.	16+00	INLET TY-A, W/TY-8 GR	507.10	505.05
48	28' LT.	16+70	M.H. TY-A, 4' DIA., W/TY-1 FR&CL L	507.30	504.50
49	23' LT.	16+70	INLET TY-A, W/TY-23 F&G	506.64	504.52
50	15' RT.	16+70	INLET TY-A, W/TY-23 F&G	506.77	504.60
51	25' RT.	16+70	INLET TY-A, W/TY-8 GR	506.70	504.63
52	40' LT.	16+87	PIPE TEE, 18" P. 12" R.	-	504.42
53	29' LT.	16+94	INLET, SPL, W/TY-11 F&G	506.48	504.48
54	29' LT.	16+91	INLET TY-A, W/TY-11 F&G	506.48	506.50
55	15' RT.	16+94	INLET TY-A, W/TY-11 F&G	506.71	504.70
56	15' RT.	16+90	INLET TY-A, W/TY-11 F&G	506.71	504.72
57	55' LT.	17+11	PIPE ELBOW 18"	-	504.31
58	72' LT.	17+11	PIPE ELBOW 18"	-	504.26
59	104' LT.	16+98	P.R.C.F.E.S. 18" W/GRATE	-	504.15
60	109' RT.	17+93	P.R.C.F.E.S. 24" W/GRATE	-	505.50
61	61' RT.	17+84	INLET, SPL, W/TY-23 F&G	507.80	505.41
62	25' RT.	17+74	PIPE TEE, 24" P. 12" R.	-	504.98
63	31' RT.	17+54	INLET TY-A, W/TY-23 F&G	507.22	505.19
64	38' RT.	17+40	INLET TY-A, W/TY-8 GR	506.50	505.37
65	62' LT.	17+48	INLET, SPL, W/TY-23 F&G	507.76	504.49
66	106' LT.	17+20	P.R.C.F.E.S. 24" W/GRATE	-	504.25

### STORM SEWERS - CLASS B

LOCATION	TY-1,12"	TY-1,15"	TY-1,18"	TY-1,24"	TR.B'FILL
1 TO 2	34				
2 TO 3	5				0.7
3 TO 4	27				3.6
4 TO 5	6				0.8
5 TO 6	53				
6 TO 7	108				
7 TO 8	5				0.7
8 TO 9	27				3.6
9 TO 10	6				0.8
10 TO 11	53				
11 TO 12	106				
12 TO 13	5				0.7
13 TO 14	27				3.6
14 TO 15	6				0.8
16 TO 17			1		
17 TO 18			4		0.4
18 TO 19	27				3.6
19 TO 20	5				0.7
20 TO 21			41		
21 TO 22	4				0.5
22 TO 23	27				3.6
23 TO 24	6				0.8
24 TO 25			88		
25 TO 26	4				0.5
26 TO 27	27				3.6
27 TO 28	6				0.8
28 TO 29	96				
29 TO 30	4				0.5
30 TO 31	27				3.6
31 TO 32	6				0.8
32 TO 33	9				1.2
33 TO 34	6				1.2
34 TO 35	27				3.6
35 TO 36	68				
36 TO 37	9				1.2
37 TO 38	27				3.6
38 TO 39	9				1.2
39 TO 40	72				
40 TO 41	9				1.2
41 TO 42	27				3.6
42 TO 43	9				1.2
43 TO 44		65			
44 TO 45	7				1.2
45 TO 46	27				3.6
46 TO 47	9				1.2
47 TO 48		66			
48 TO 49	2				1.2
49 TO 50	35				4.9
50 TO 51	9				1.2
51 TO 52			20		
52 TO 53	8				1.2
53 TO 54	2				1.2
54 TO 55	44				5.9
55 TO 56	2				1.2
56 TO 57			50		
57 TO 58			8		
58 TO 59			22		
59 TO 60				62	0.5
60 TO 61				28	5.8
61 TO 62					2.9
62 TO 63	20				1.6
63 TO 64	16				14.0
64 TO 65				84	0.9
65 TO 66				40	
TOTALS	1154	131	234	214	100

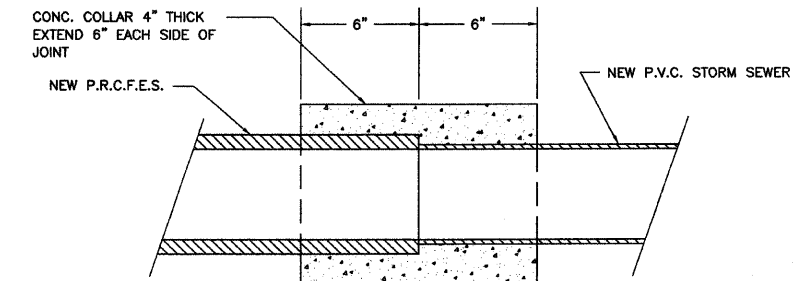
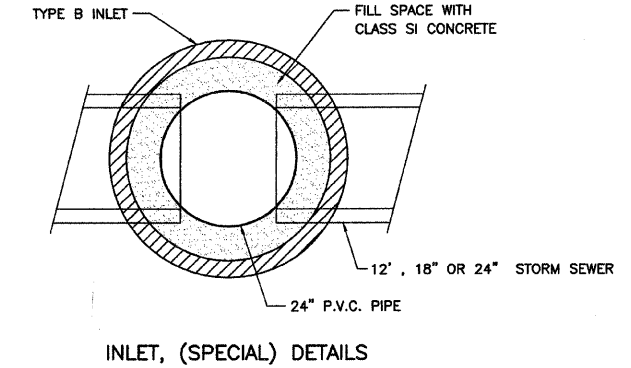

P.R.C.F.E.S. TO STORM SEWER - JOINT DETAIL

COST INCLUDED IN THE P.R.C.F.E.S. OF EACH SIZE INDICATED

ROUTE	SECTION	CITY	TOTAL SHEETS	SHEET NO.
HOLLY ROAD	05-00076-01-PV	OLNEY	14	5
CONTRACT NO. 95541		ILLINOIS		

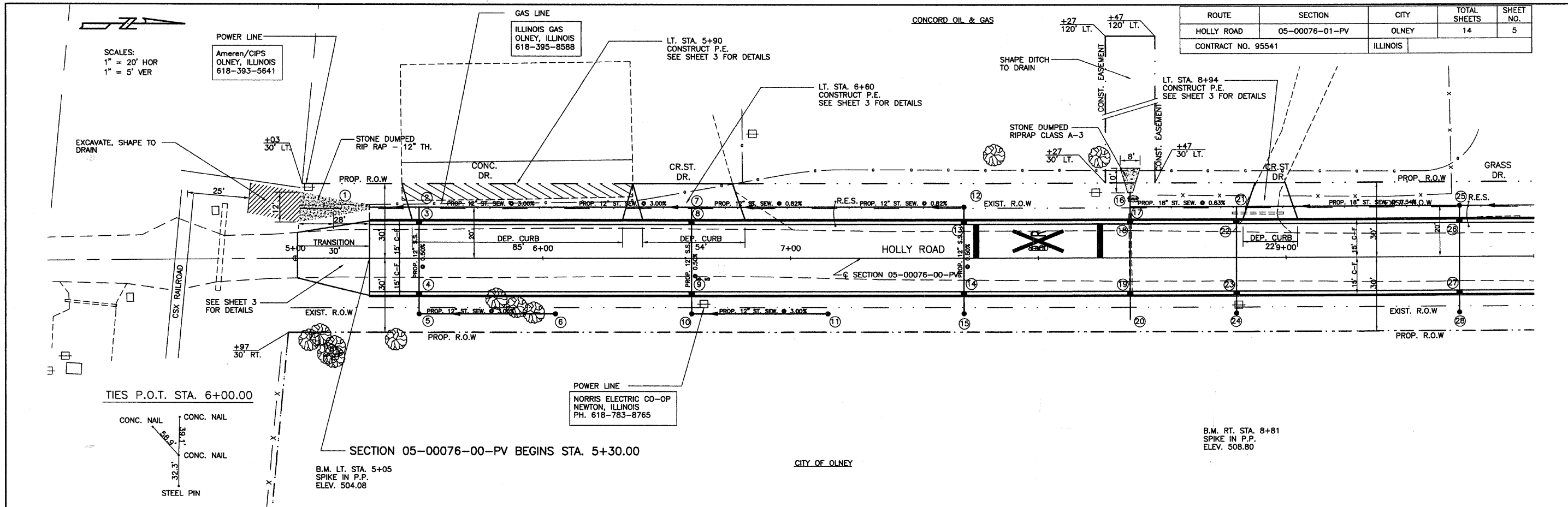

STATION	DESCRIPTION	UNIT	QUANTITY	STATION	DESCRIPTION	UNIT	QUANTITY	STATION	DESCRIPTION	UNIT	QUANTITY
520	PAINT PAV'T. MARKING LINE 4"	FOOT	120	520	PAVEMENT REMOVAL (SPECIAL)	SQ. YD.	1081	520	P.C.C. DRIVEWAY PAV'T. 6"	SQ. YD.	144
515	PAINT PAV'T. MARKING LINE 24"	FOOT	27	515				515			66
510	PAINT PAV'T. MARKING LETTERS AND SYMBOLS	SQ. FT.	612	510				510			28
505				505				505			238
500				500				500			
495				495	PIPE CULVERT REMOVAL	FOOT	72	495	AGG. SURF. CSE., TY.-B	TON	10
490	DRIVEWAY PAVEMENT REMOVAL	SQ. YD.	64	490				490	SEEDING CLASS 1 (SPL.)	ACRE	0.35
485	INCLD. BIT SURFACING	TON	15	485	P.C.C. PAVEMENT 7" (SPL.) W/I.C.	SQ. YD.	1627	485	TRENCH BACKFILL	CU. YD.	4
480				480				480			3
475				475				475			7

ROUTE	SECTION	CITY	TOTAL SHEETS	SHEET NO.
HOLLY ROAD	05-00076-01-PV	OLNEY	14	6
CONTRACT NO. 95541		ILLINOIS		

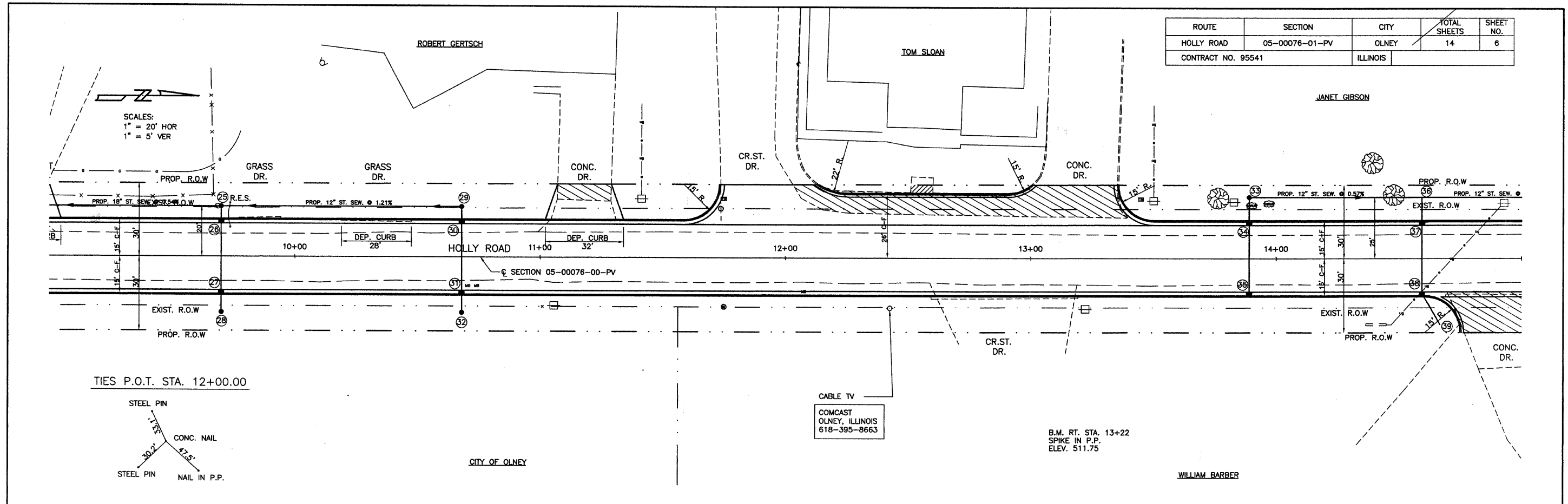

STATION	DESCRIPTION	QUANTITY	UNIT	STATION	DESCRIPTION	QUANTITY	UNIT	STATION	DESCRIPTION	QUANTITY	UNIT						
525	P.C.C. DRIVEWAY PAV'T. 6"	44	SQ. YD.	525	COMB. CONC. CURB & GUTTER TYPE B-6.12	92	FOOT										
	LT. STA. 11+86	258															
	LT. STA. 12+00 TO 13+40	73															
	RT. STA. 14+97																
	TOTAL 375 SQ. YD.																
520				520	SEEDING CLASS 1 (SPL.)	0.27	ACRE										
					STA. 10+00 TO 15+00												
515	PAINT PAV'T. MARKING LINE 4"	125	FOOT	515	PIPE CULVERT REMOVAL	30	FOOT										
	STA. 10+00 TO 15+00				LT. STA. 10+34	80											
					RT. STA. 13+00	82											
					RT. STA. 14+97												
					TOTAL 142 FOOT												
510	EXIST. & PROFILE			510	EXIST. & PROFILE												
505	0.30%			505	-0.59%												
500	VPI STA = 9+75.00 VPI EL = 507.58 CURVE LEN = 250.00			500	DRIVEWAY PAVEMENT REMOVAL	16	SQ. YD.										
					LT. STA. 11+86	148											
					LT. STA. 12+00 TO 13+40												
					TOTAL 164 SQ YD												
495	COMB. CONC. CURB & GUTTER TYPE B-6.18	24	FOOT	495	PAVEMENT REMOVAL (SPECIAL)	1114	SQ. YD.										
	LT. STA. 11+68	24			STA. 10+00 TO 15+00												
	LT. STA. 13+42	24															
	RT. STA. 14+72																
	TOTAL 72 SQ. FT.																
490	TREE REMOVAL (6 TO 15 UNITS DIA.)	14	UNIT DIA.	490	P.C.C. PAVEMENT 7" (SPL.) W/I.C.	1733	SQ. YD.										
	LT. STA. 10+00 TO 15+00				STA. 10+00 TO 15+00												
485				485	TRENCH BACKFILL	5	CU YD										
					LT. STA. 10+34	10											
					RT. STA. 13+00	10											
					RT. STA. 14+97												
					TOTAL 23 CU YD												
480	507.2 507.42	507.5 507.78	507.9 508.27	480	508.6 508.90	508.4 508.67	510.3 510.36	510.8 510.72	510.8 510.88	510.2 510.27	508.5 508.99	508.9 508.97	508.6 508.45	508.2 508.02			
9+00			10+00				11+00			12+00			13+00		14+00		15+00



ROUTE	SECTION	CITY	TOTAL SHEETS	SHEET NO.
HOLLY ROAD	05-00076-00-PV	OLNEY	14	8
CONTRACT NO. 95541		ILLINOIS		

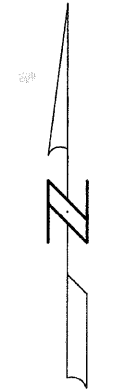

SCALE 1" = 10'

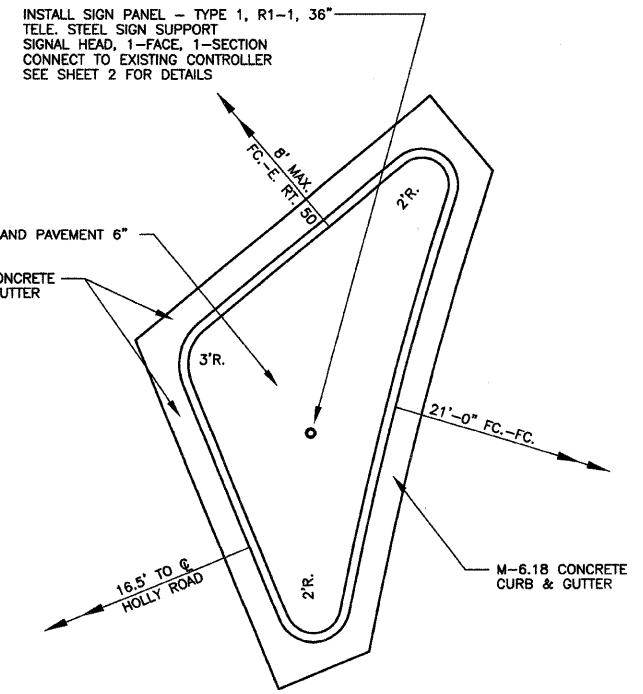
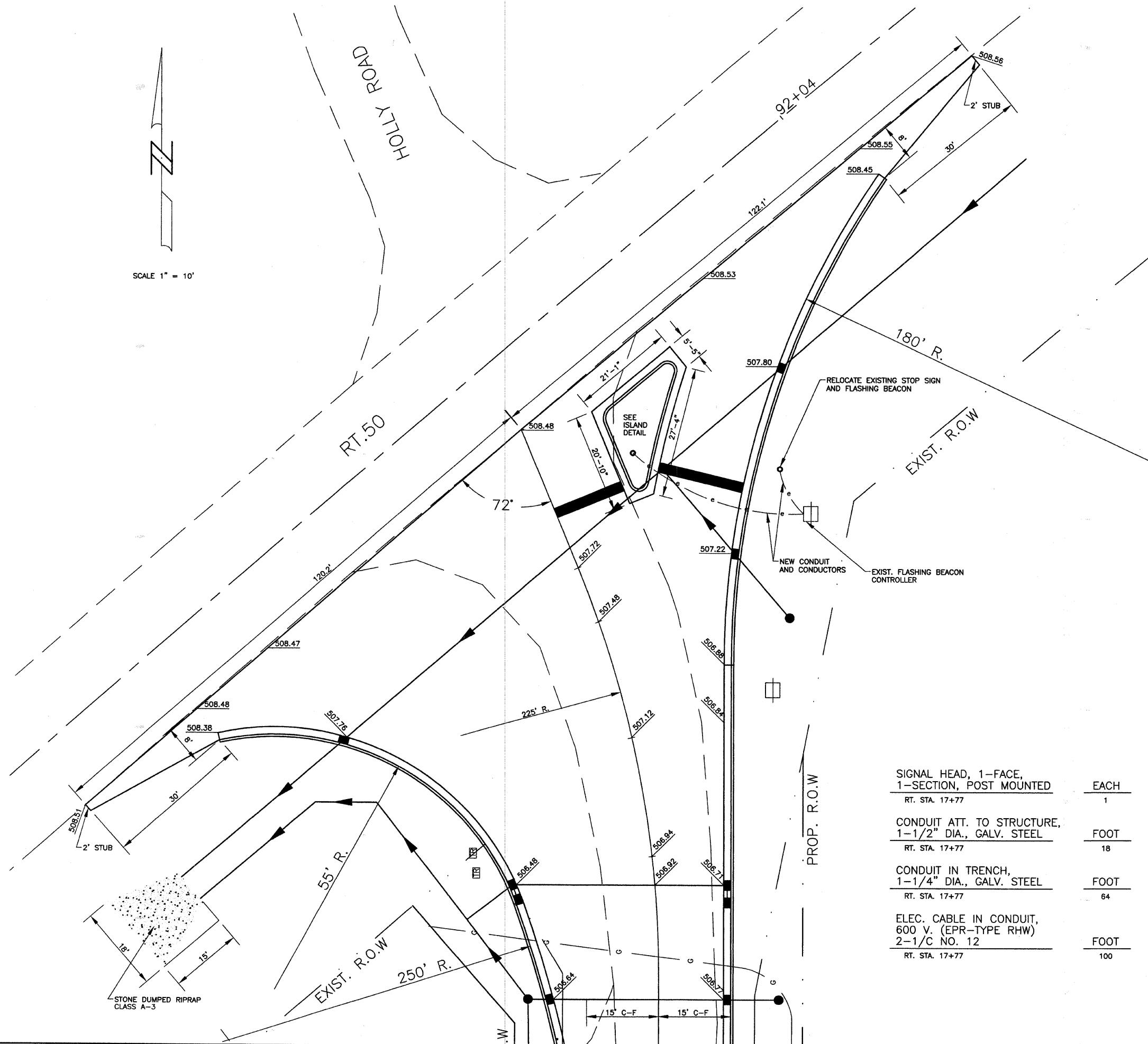

ISLAND DETAIL

SIGNAL HEAD, 1-FACE, 1-SECTION, POST MOUNTED RT. STA. 17+77	EACH	1
CONDUIT ATT. TO STRUCTURE, 1-1/2" DIA., GALV. STEEL RT. STA. 17+77	FOOT	18
CONDUIT IN TRENCH, 1-1/4" DIA., GALV. STEEL RT. STA. 17+77	FOOT	64
ELEC. CABLE IN CONDUIT, 600 V. (EPR-TYPE RHW) 2-1/C NO. 12 RT. STA. 17+77	FOOT	100

RELOCATE EXISTING FLASHING BEACON RT. STA. 17+77	EACH	1
PAINT PAV'T. MK. - LINE 24" RT. STA. 17+77	FOOT	35
SIGN PANEL - TYPE 1 RT. STA. 17+77	SQ. FT.	9.0
TELE. STEEL SIGN SUPPORTS RT. STA. 17+77	FOOT	16
ISLAND PAVEMENT RT. STA. 17+77	SQ. YD.	21
COMB. CONC. CURB & GUTTER, TYPE M- 6.18 RT. STA. 17+77	FOOT	82

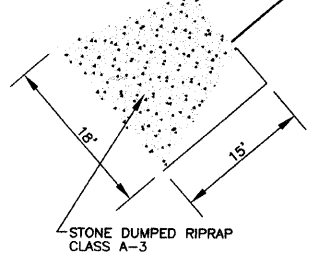

STONE DUMPED RIPRAP  
CLASS A-3



ROUTE	SECTION	CITY	TOTAL SHEETS	SHEET NO.
HOLLY ROAD	05-00076-00-PV	OLNEY	14	9
CONTRACT NO. 95541		ILLINOIS		

STONE DUMPED RIPRAP, CLASS A3	TON	INLET AND PIPE PROTECTION	EACH
LT. STA. 5+05	15	LT. STA. 5+00 TO 17+93	5
LT. STA. 8+37	6	RT. STA. 5+00 TO 17+93	15
LT. STA. 17+00	10		
	TOTAL 31 TON		TOTAL 20 EACH

TEMPORARY EROSION CONTROL SEEDING	POUND	TEMPORARY DITCH CHECKS	EACH
STA. 5+00 TO 17+93	400	RT. STA. 5+00 TO 17+93	4

TEMPORARY EROSION CONTROL SEEDING SHALL BE USED AS DIRECTED BY THE ENGINEER THROUGHOUT THE LIFE OF THIS PROJECT

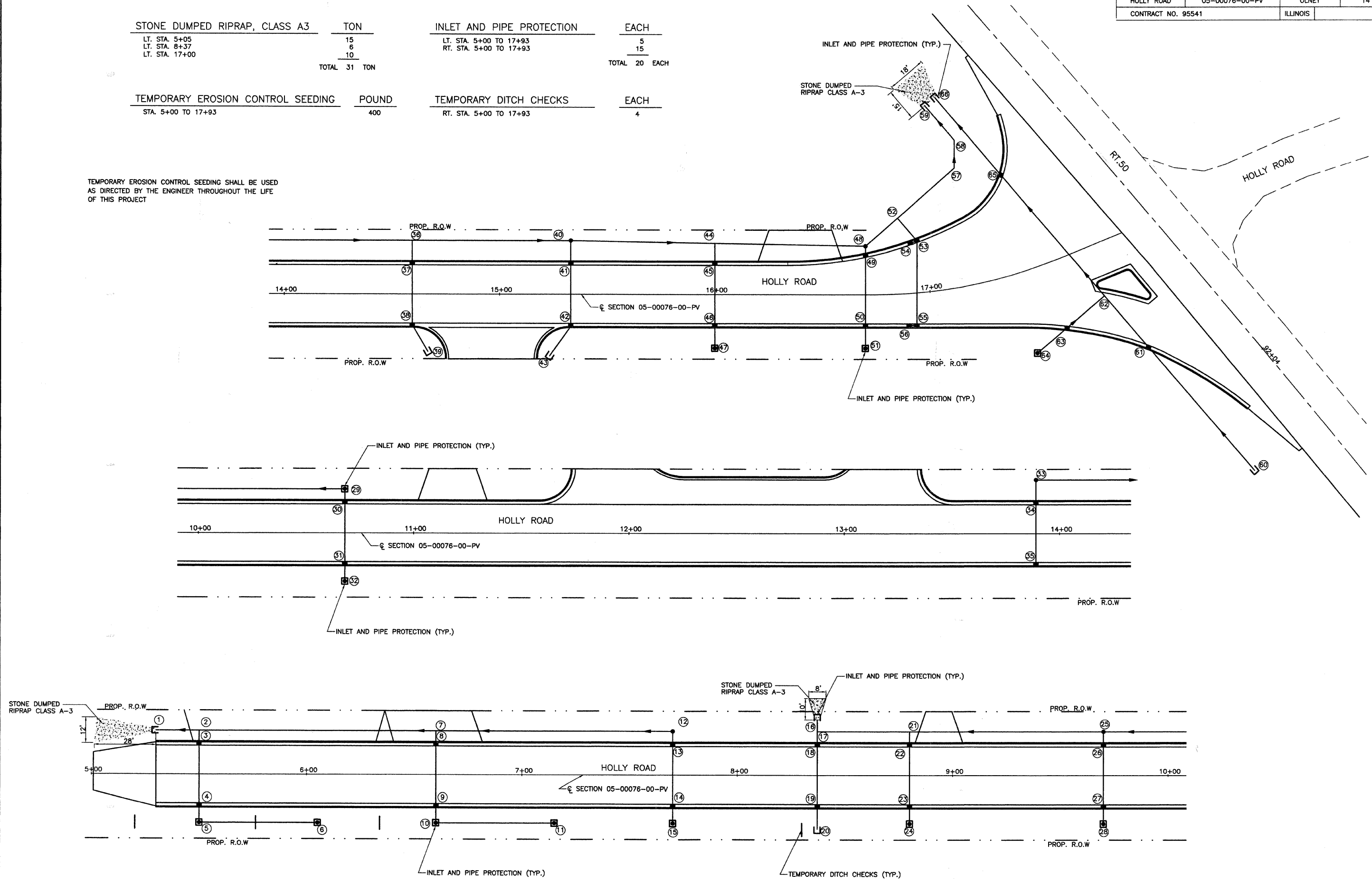

EROSION CONTROL DETAILS

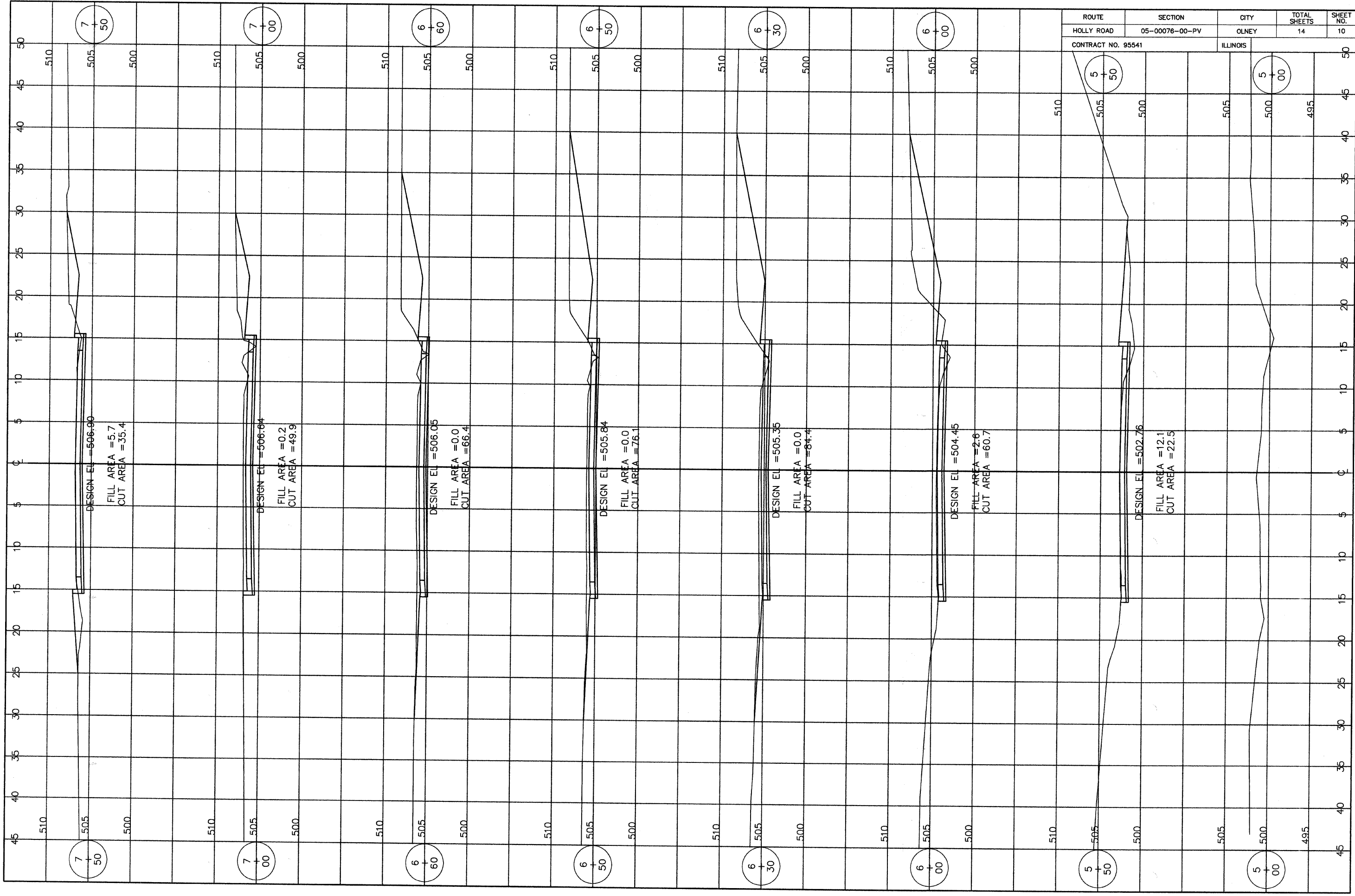

ROUTE	SECTION	CITY	TOTAL SHEETS	SHEET NO.
HOLLY ROAD	05-00076-00-PV	OLNEY	14	10
CONTRACT NO. 95541		ILLINOIS		

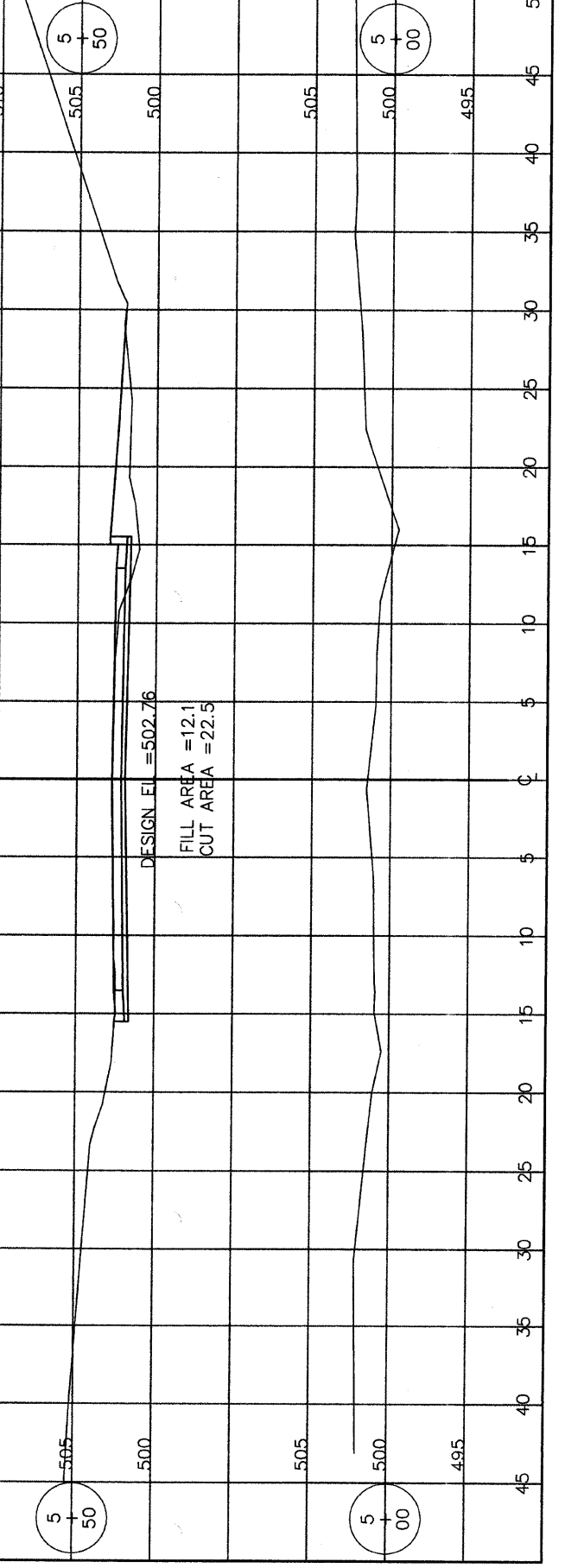

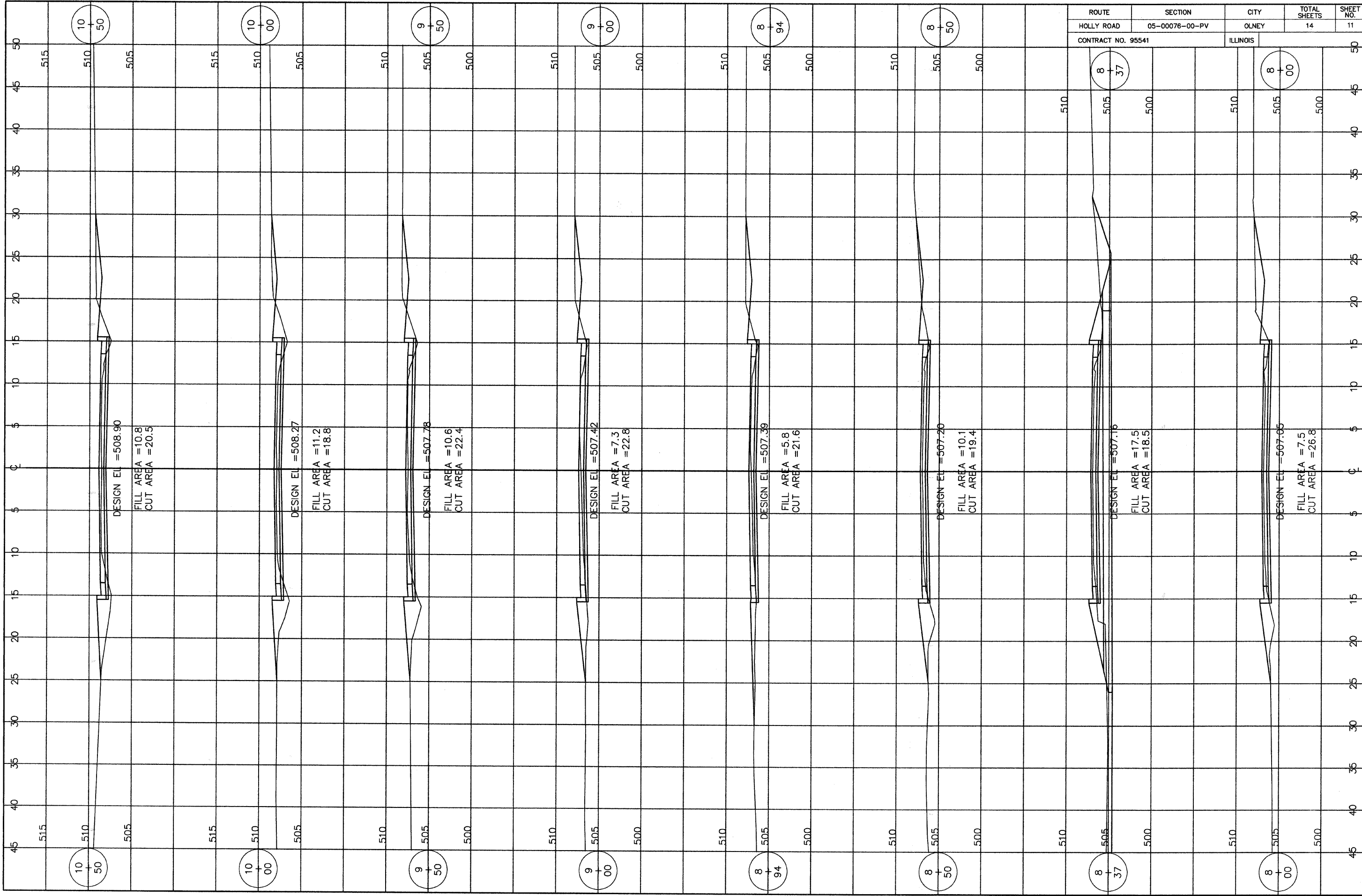

ROUTE	SECTION	CITY	TOTAL SHEETS	SHEET NO.
HOLLY ROAD	05-00076-00-PV	OLNEY	14	11
CONTRACT NO. 95541		ILLINOIS		

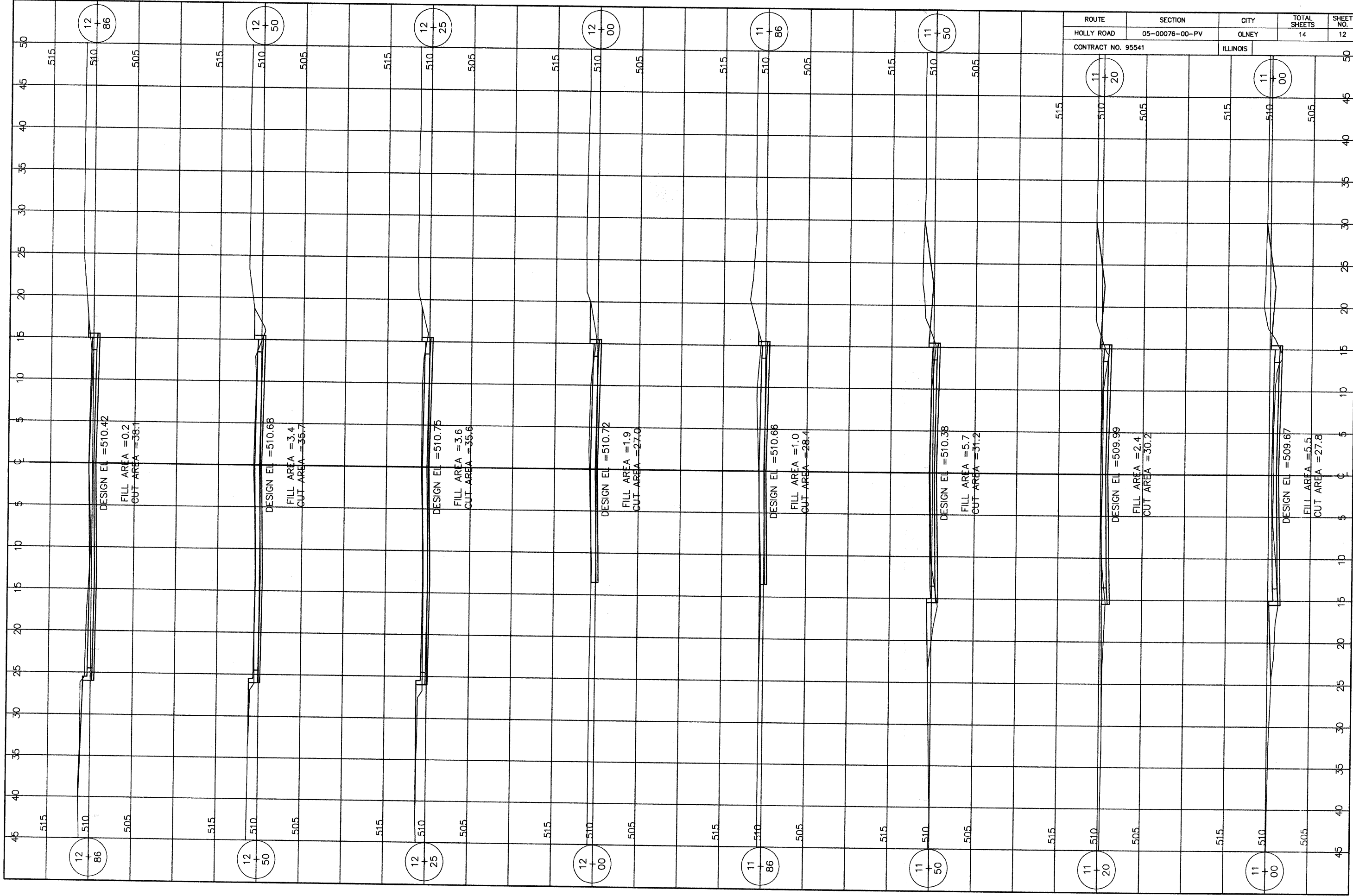

ROUTE	SECTION	CITY	TOTAL SHEETS	SHEET NO.
HOLLY ROAD	05-00076-00-PV	OLNEY	14	12
CONTRACT NO. 95541		ILLINOIS		

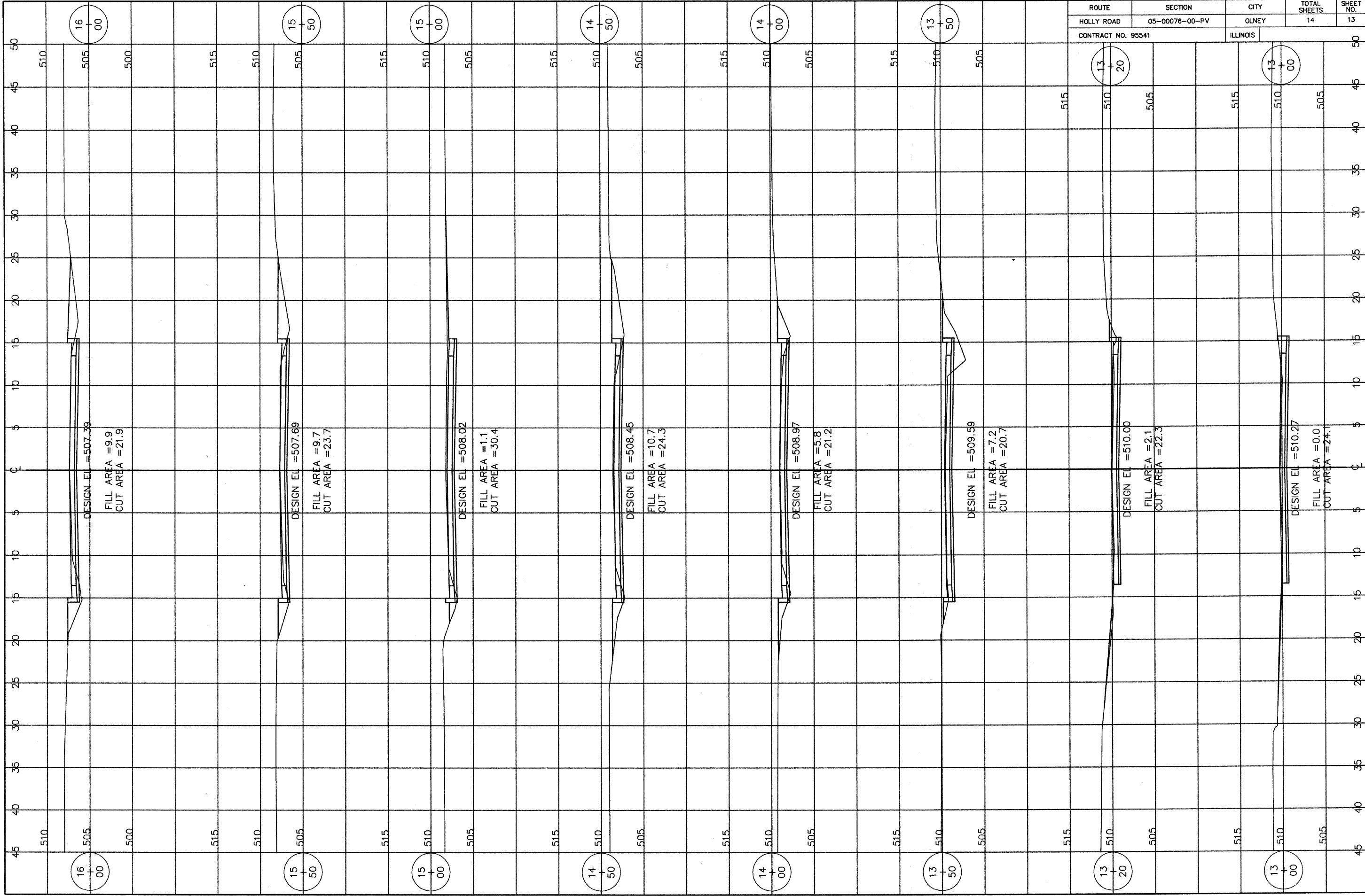

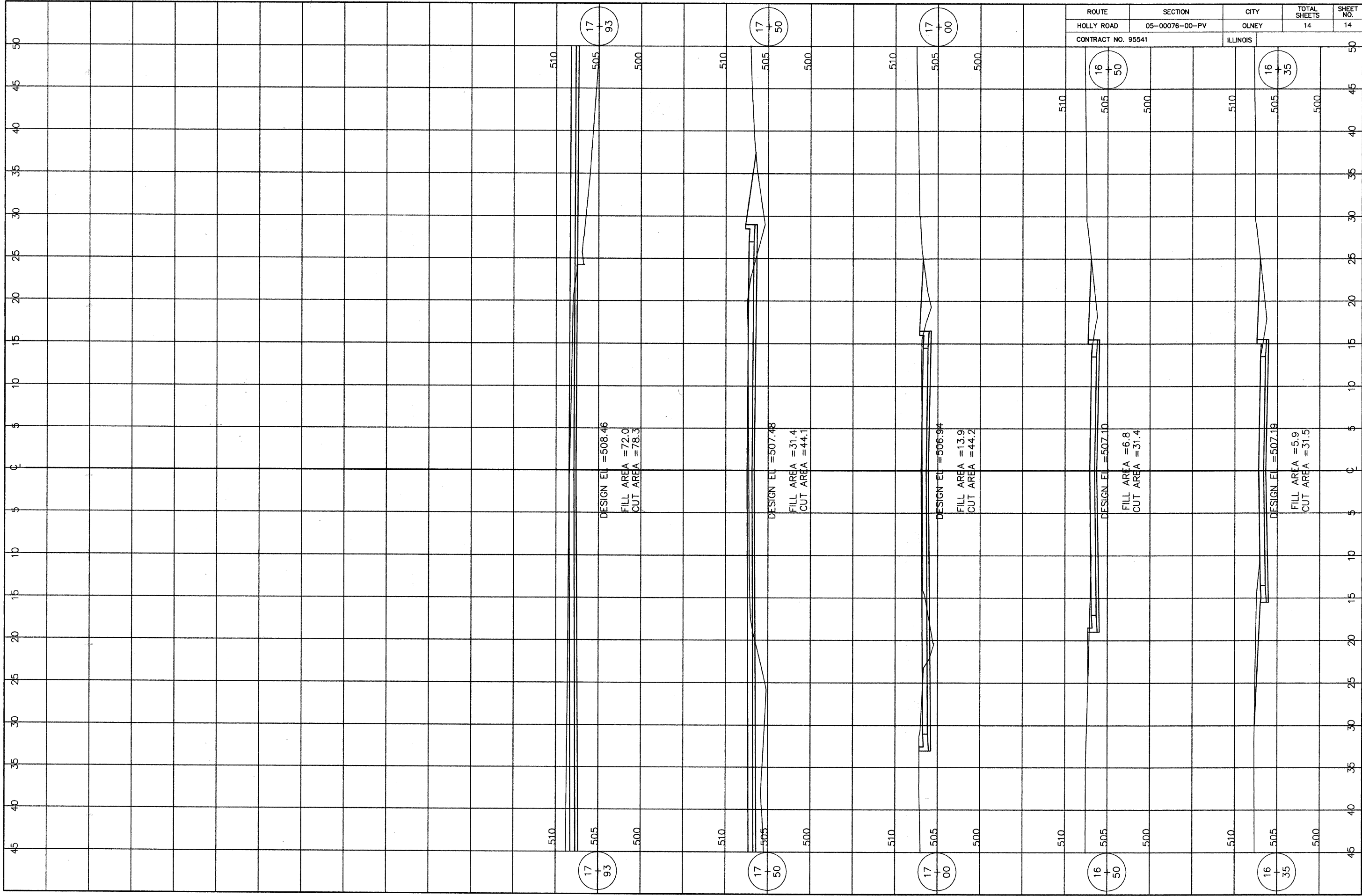

ROUTE	SECTION	CITY	TOTAL SHEETS	SHEET NO.
HOLLY ROAD	05-00076-00-PV	OLNEY	14	14
CONTRACT NO. 95541		ILLINOIS		