

F.A. RTE.	SECTION	COUNTY	TOTAL SHEETS	SHEET NO.
	03-00026-00-PK	MADISON	51	39
	06-00026-01-MS	97331		

FEDERAL AID PROJECT

211 N. Broadway
Suite 1900
St. Louis, MO 63102
(314) 241-8188
FAX (314) 241-0125



LEWIS AND CLARK MEMORIAL TOWER
VILLAGE OF HARTFORD, ILLINOIS
HARTFORD, ILLINOIS 62049

SHEET TITLE
ELECTRICAL SITE PLAN

REV. NO.	REMARKS	DATE

KENNEDY PROJECT NO
KAI# 10-02048

ISSUE DATE
12-JULY-05

SHEET NO

E2-01

© 2005 KENNEDY ASSOCIATES INCORPORATED

KEYED NOTES

- 1 CONDUIT SHALL BE EXTENDED TO PROPERTY LINE, CAPPED AND LABELED TELEPHONE, AND STAKED FOR LOCATION.
- 2 DIMENSION DENOTES HEIGHT OF CONCRETE BASE ABOVE GRADE. TYPICAL FOR ALL POLES. SEE DETAILS ON SHEET E6-02 FOR ADDITIONAL INFORMATION.
- 3 E.C. SHALL FURNISH AND INSTALL TRANSFORMER PAD. SEE DETAIL B, SHEET E6-02.
- 4 EXTEND AND CONNECT TO PANEL VIA CONTACTOR C1. SEE SHEET E4-01 FOR CONTACTOR LOCATION.
- 5 (2) 5" UNDERGROUND PVC CONDUITS FOR PRIMARY SERVICE ENTRANCE. EXTEND TO PROPERTY LINE AND CAP OFF BELOW GRADE. PROVIDE IN ACCORDANCE WITH AMEREN UE REQUIREMENTS.
- 6 EXTEND AND CONNECT TO PANEL VIA CONTACTOR. SEE SHEET E4-01 FOR LOCATION OF CONTACTOR C2.
- 7 DIMENSION DENOTES HEIGHT OF CONCRETE BASE ABOVE GRADE. TYPICAL FOR ALL POLES. SEE DETAIL A ON SHEET E6-02 AND DETAIL E ON SHEET E6-01 FOR ADDITIONAL INFORMATION.

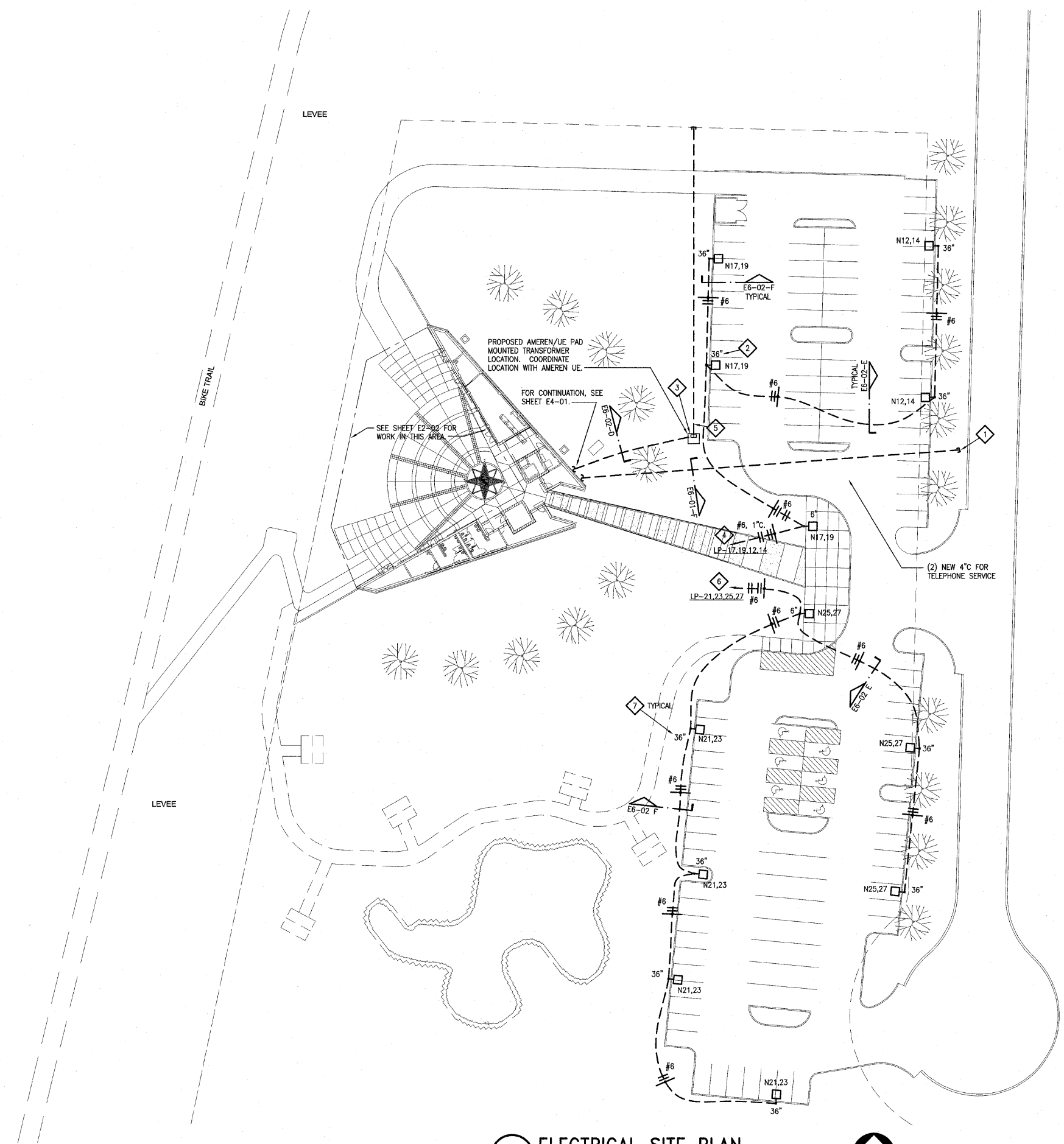

A ELECTRICAL SITE PLAN
1"=30'

