

C.H.	SECTION	COUNTY	TOTAL SHEETS	SHEET NO.
13	06-00100-00-BR	WHITE	13	1
FED. ROAD DIST. NO. 9 ILLINOIS		FED. AID PROJECT		
PROJECT # BROS-193(25)		CONTRACT # 99305		
JOB # C-99-537-06		LIMEKILN CREEK		
LEC JOB # H061025WH				

323 W. 3RD ST.  
P.O. BOX 160  
MT. CARMEL, IL  
62863  
PHONE:  
(618)-262-8651  
FAX:  
(618)-263-3327

405 W. STATE ST.  
SUITE 1  
PRINCETON, IN  
47670  
PHONE:  
(812)-386-7611  
FAX:  
(812)-385-2812

PROFESSIONAL DESIGN FIRM  
LAND SURVEY & PROFESSIONAL ENGINEERING CORPORATION  
184-000887  
(62-032435)(35-002769)

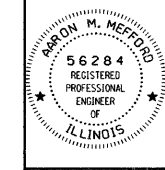

AARON M. MEFFORD  
NAME  
SIGNATURE  
9-27-07  
DATE  
11-30-09  
EXPIRES

COUNTY HIGHWAY 13  
OVER LIMEKILN CREEK  
WHITE COUNTY, ILLINOIS

SHEET TITLE:  
TITLE SHEET  
SCALE: VARIES  
BY: AMM  
DATE: 9/20/07  
REV:  
1 OF 13  
SHEETS  
SHEET NO.  
1

### INDEX OF SHEETS

SHEET NO.	DESCRIPTION
1	TITLE SHEET & SUMMARY OF QUANTITIES
2	PLAN & PROFILE, TYPICAL SECTIONS & GENERAL NOTES
3-4	ROADWAY CROSS SECTIONS
5-12	BRIDGE DESIGN
13	CURLED END SECTIONS & STONE RIPRAP DITCH DESIGN

**THE FOLLOWING STANDARDS ARE A PART OF THESE PLANS AND ARE INCLUDED IN THE PROPOSAL:**

000001-05	STANDARD SYMBOLS, ABBREVIATIONS & PATTERNS
280001-04	TEMPORARY EROSION CONTROL SYSTEMS
701001	TRAFFIC CONTROL DEVICES
B.L.R. 21-7	TYPICAL APPLICATION OF TRAFFIC CONTROL DEVICES FOR CONSTRUCTION ON RURAL LOCAL HIGHWAYS
B.L.R. 22-5	TYPICAL APPLICATION OF TRAFFIC CONTROL DEVICES FOR CONSTRUCTION ON RURAL LOCAL HIGHWAYS (TWO-LANE TWO-WAY RURAL TRAFFIC) (ROAD CLOSED TO THRU TRAFFIC)
B.L.R. 23-2	TRAFFIC BARRIER TERMINAL TYPE 1
B.L.R. 27	TRAFFIC BARRIER TERMINAL TYPE 5A

### SUMMARY OF QUANTITIES

CODE NO.	ITEM	UNIT	QUANTITY X0.50-2A
20100110	TREE REMOVAL (6 TO 15 UNITS DIAMETER)	UNIT	12.00
20100210	TREE REMOVAL (OVER 15 UNITS DIAMETER)	UNIT	18.00
20200100	EARTH EXCAVATION	CU YD	162.00
20300100	CHANNEL EXCAVATION	CU YD	102.00
20400800	FURNISHED EXCAVATION	CU YD	700.00
25001000	SEEDING, CLASS 2 (SPECIAL)	ACRE	0.50
28000300	TEMPORARY DITCH CHECKS	EACH	5.00
28001000	AGGREGATE (EROSION CONTROL)	TON	13.00
28100807	STONE DUMPED RIPRAP, CLASS A4	TON	215.00
40200800	AGGREGATE SURFACE COURSE, TYPE B	TON	450.00
50100100	REMOVAL OF EXISTING STRUCTURES	EACH	1.00
50300225	CONCRETE STRUCTURES	CU YD	17.20
50300280	CONCRETE ENCASEMENT	CU YD	2.10
50400405	PRECAST PRESTRESSED CONCRETE DECK BEAMS (21" DEPTH)	SO FT	1080.00
50800105	REINFORCEMENT BARS	POUND	2240.00
50900205	STEEL RAILING, TYPE S1	FOOT	90.00
51201400	FURNISHING STEEL PILES HP10X42	FOOT	464.00
51202305	DRIVING PILES	FOOT	464.00
51204650	PILE SHOES	EACH	8.00
51500100	NAME PLATES	EACH	1.00
* 63100075	TRAFFIC BARRIER TERMINAL, TYPE 5A	EACH	2.00
66600105	FURNISHING AND ERECTING RIGHT-OF-WAY MARKERS	EACH	7.00
67100100	MOBILIZATION	L SUM	1.00
* LR631020	TRAFFIC BARRIER TERMINAL, TYPE 1	EACH	2.00

\* SPECIALTY ITEMS

DESIGN DESIGNATION:  
DESIGN SPEED: 40 MPH  
HIGHWAY CLASS - MINOR COLLECTOR  
EXISTING STRUCTURE NO.: 097-3021  
PROPOSED STRUCTURE NO.: 097-3251  
CURRENT A.D.T. = 150  
CONTRACT NO. 99305

J.U.L.I.E.  
JOINT UTILITY LOCATION INFORMATION FOR EXCAVATION  
1-800-892-0123

# STATE OF ILLINOIS DEPARTMENT OF TRANSPORTATION PLANS FOR PROPOSED FEDERAL AID - H.B.P. PROJECT

C.H. 13 WHITE COUNTY SECTION 06-00100-00-BR

PROJECT NO. BROS-193(25) JOB NO. C-99-537-06

CONTRACT # 99305 LIMEKILN CREEK

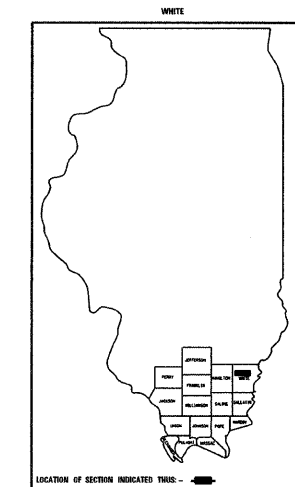

PLAN	1" = 50'	0 50' 100'
PROFILE	1" = 50'	0 50' 100'
PROFILE VERT.	1" = 5'	0 5' 10'
CROSS SECTION	1" = 5'	0 5' 10'

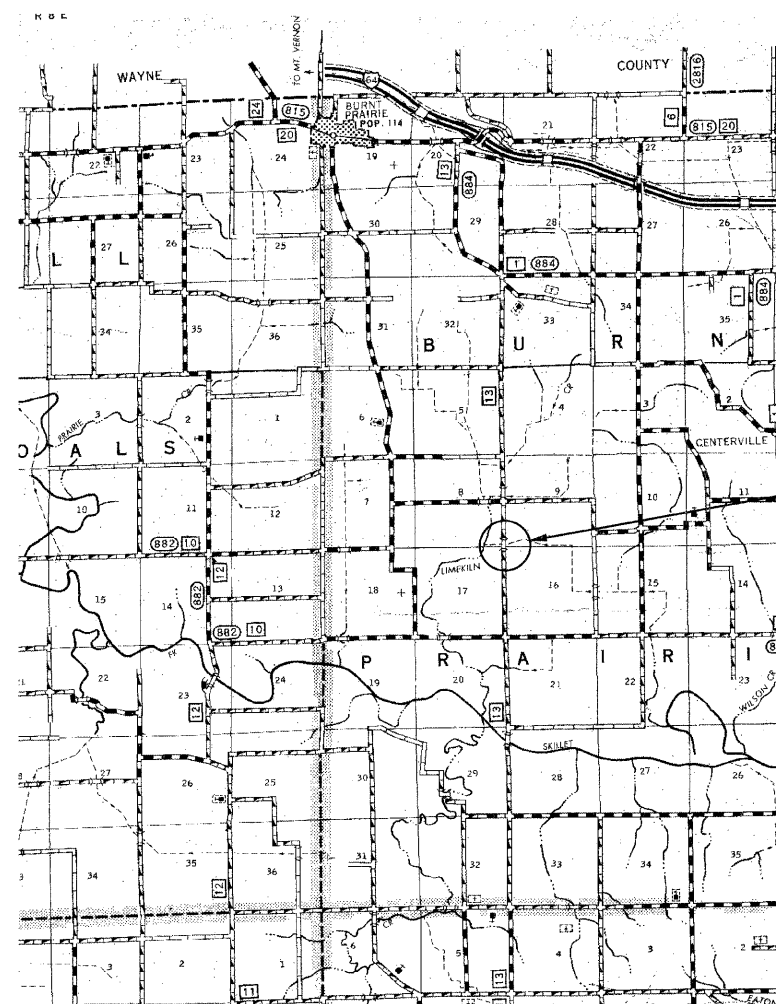

SECTION 06-00100-00-BR  
BEGINS STATION 1+65

STATION 5+00, STRUCTURE NO. 097-3251  
A 45' LONG SINGLE SPAN PRECAST  
PRESTRESSED CONCRETE DECK BEAM  
BRIDGE (21" DEPTH), 24' ROADWAY, 0.00%  
GRADE, 10° RT FWD SKEW.

SECTION 06-00100-00-BR  
ENDS STATION 7+90

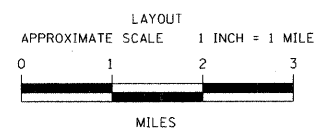

	FEET	MILES
GROSS LENGTH	609.00 FT	0.12 MILES
OMISSIONS	0.00 FT	0.00 MILES
NET LENGTH	609.00 FT	0.12 MILES

STATE OF ILLINOIS  
DEPARTMENT OF TRANSPORTATION

APPROVED 9/21/2007  
Brian A. Lay  
COUNTY ENGINEER

PASSED 10/11/07  
Dennis W. Hillebrand  
ENGINEER OF LOCAL ROADS AND STREETS

RELEASING FOR BID  
BASED ON LIMITED  
REVIEW: 10-2-07  
Mary C. Lamie  
MARY C. LAMIE, P.E.  
DEPUTY DIRECTOR OF HIGHWAY  
REGION FIVE ENGINEER