





LEGEND

-  EXISTING PAVEMENT TO BE GROUND & OVERLAID
-  EXISTING PAVEMENT TO BE OVERLAID
-  EXISTING PAVEMENT STRUCTURE TO BE REMOVED & REPLACED
-  BERM LT/RT

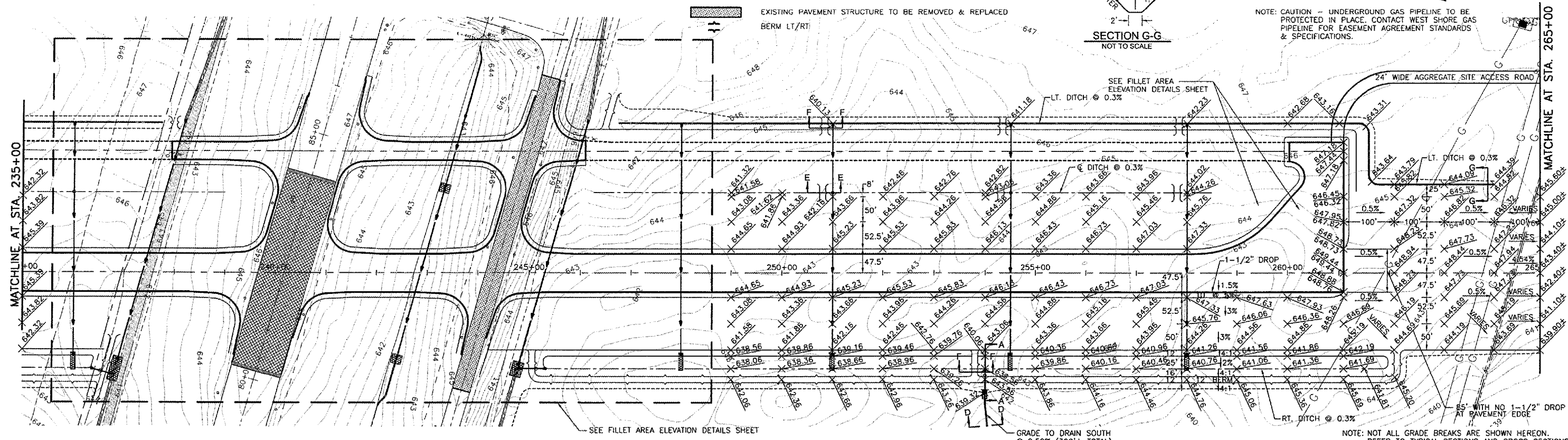
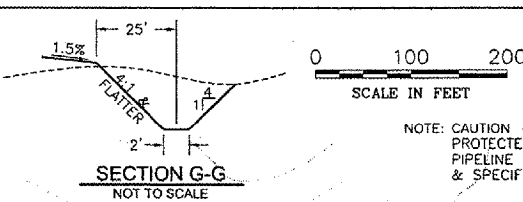

SEE FILLET AREA ELEVATION DETAILS SHEET

GRADE TO DRAIN SOUTH @ 0.50% (300' ± TOTAL)

NOTE: NOT ALL GRADE BREAKS ARE SHOWN HEREON. REFER TO TYPICAL SECTIONS AND CROSS SECTIONS.

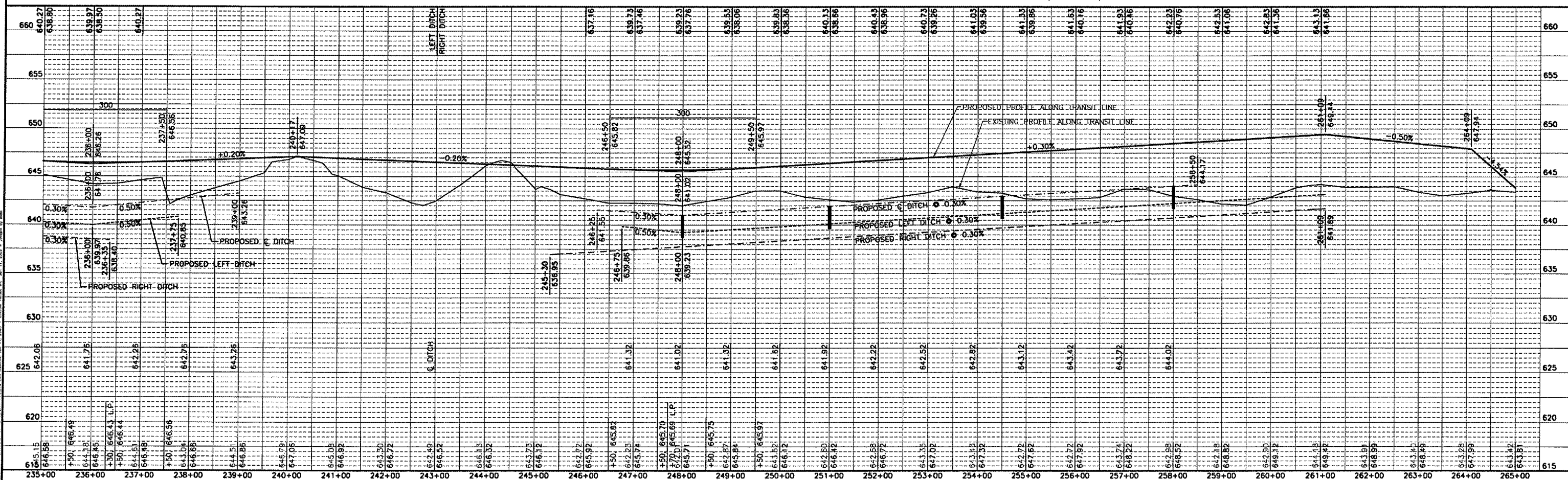

DRAWN BY: NET CHECKED BY: KWH DATE: 1/08	REVISIONS DATE BY	CHAMLIN ASSOCIATES PERU MORRIS ILLINOIS	ILLINOIS VALLEY REGIONAL AIRPORT ILLINOIS PROJECT NO. VYS-3594 A.I.P. PROJECT NO. 3-17-0060-B17	RUNWAY PLAN AND PROFILE (STA. 235+00 TO STA. 265+00)	SCALE: AS NOTED SHEET 17 OF 31
--	----------------------	---	---	--	-----------------------------------