

ASBESTOS SURVEY REPORT

PTB 196-032

Asbestos Survey for Building Demolition (I-80)

224 Duncan Street, Joliet, Illinois

Region One/District One

Prepared for:



**Illinois Department of Transportation
District 1**

Submitted to:

**WSP USA
30 N. LaSalle Street
Chicago, IL, 60602**

Prepared by:



February 17, 2025



February 17, 2025

David Skaleski, P.E.
Project Manager
WSP USA
30 N. LaSalle Street, Suite 4200
Chicago, Illinois 60602

Asbestos Survey Report
PTB 198-003
FAI-80 (I-80) over Des Plaines River Bridge
Job N. D-91-204-19
224 Duncan Street, Joliet, IL
Parcel No. 1P10167

Dear Mr. Skaleski:

GSG Consultants Inc has conducted an Asbestos Survey for the above referenced property in accordance with our contractual agreement. The report provides a description of the site, survey methodology, analytical results, abatement cost estimates, and recommendations.

Should you have any questions or require additional information, please call us at 630-994-2600.

Prepared by: 
Erin Pahomi
Asbestos Building Inspector
Inspector License No: 100-20674

February 17, 2025
Date

Reviewed By: 
Thaddeus Cagney, LPG
Senior Project Manager

February 17, 2025
Date

QA Manager: 
Ala E Sassila, Ph.D., PE

February 17, 2025
Date



TABLE OF CONTENTS

1.0	INTRODUCTION	4
2.0	SURVEY METHODOLOGY	5
2.1	VISUAL INSPECTION	5
2.2	SAMPLING PROCEDURES	6
2.3	QUANTIFICATION.....	7
3.0	ANALYTICAL RESULTS.....	8
3.1	TESTING PROCEDURES	8
3.2	FINDINGS.....	8
4.0	RECOMMENDATIONS.....	9
5.0	LIMITATIONS	11
6.0	CERTIFICATION	12

TABLES

Table 1	Materials Sampled for ACM.....	2
----------------	---------------------------------------	----------

EXHIBITS

Figure 1	Asbestos Bulk Sampling Locations
-----------------	-----------------------------------------

APPENDICES

Appendix A	Analytical Testing Results
Appendix B	Reference Photographs
Appendix C	Inspector Licenses and Training Certificates
Appendix D	Laboratory Accreditations

ACRONYMS AND ABBREVIATIONS

ACM	Asbestos-Containing Materials
ACBM	Asbestos-Containing Building Materials
AHERA	Asbestos Hazard Emergency Response Act
CFR	Code of Federal Regulations
COC	Chain of Custody
GSG	GSG Consultants, Inc.
IDOT	Illinois Department of Transportation
IDPH	Illinois Department of Public Health
NESHAP	National Emissions Standards for Hazardous Air Pollutant
NVLAP	National Voluntary Laboratory Accreditation Program
OSHA	Occupational Safety and Health Administration
PLM	Polarized Light Microscopy
RACM	Regulated Asbestos-Containing Material
TSI	Thermal System Insulation
USEPA	United States Environmental Protection Agency

SURVEY SUMMARY

SITE INFORMATION			
FAP Route:	FAI-80 (I-80)	Address:	224 Duncan Street
County:	Will	City, State, Zip	Joliet, IL 60433
Section:	N/A	Property Type:	Single-Family Residential
IDOT Job No.	D-91-204-19	Construction Date:	1960
Parcel No.	1P10167	Building Size:	800 SF

ASBESTOS CONTAINING MATERIALS	
Survey Date:	January 30, 2025
Weather Conditions:	50°F, Sunny
By Whom:	
Firm:	GSG Consultants, Inc
Inspector:	Safdar Azeem
IDPH License No.	100-10351
Results:	
	Number of Material Types Sampled <u>17</u>
	Number of Samples Collected: <u>51</u>
	Number of Materials Tested Positive: <u>0</u>
	Was Friable ACM Found? <u>No</u>
	Were Roofing Materials Sampled? <u>Yes</u>
	Are There Unique State or Local Requirements? <u>No</u>
Laboratory Used:	Name: Sterling Labs Address: 2242 W. Harrison Street, Chicago, Illinois NVLAP: 101202-0
Building Access Limitations:	None

ASBESTOS-CONTAINING MATERIALS (ACM) SURVEY RESULTS:

Parcel No. 1P10167
Residential Property
224 Duncan Street, Joliet, Illinois

Table 1 provides a list of the homogeneous building material types that were sampled as part of the asbestos survey and the laboratory testing results.

HA No.	Material Description	Location	Type ⁽¹⁾	Condition	Friable	% Asbestos*	# of Samples	Estimated Quantity ⁽²⁾
1	12"X12" Vinyl Floor Tile, Grey W/White Spots, Black Adhesive	Living Room	Misc.	Good	No	ND	3	N/A
2	Drywall System, White	Living Room	Misc.	Good	No	ND	3	N/A
3	Window Glazing, White	Interior	Misc.	Good	No	ND	3	N/A
4	Wall Glue, Beige	Bathroom	Misc.	Good	No	ND	3	N/A
5	Textured Ceiling, White	Bedroom	Misc.	Good	No	ND	3	N/A
6	Window Glazing, Grey	Exterior	Misc.	Good	No	ND	3	N/A
7	Siding, Brown	Detached Garage	Misc.	Good	No	ND	3	N/A
8	Tar Paper, Black	Roof, House	Misc.	Good	No	ND	3	N/A
9	Shingle #1, Red/Black	Roof, House	Misc.	Good	No	ND	3	N/A
10	Shingle #2, Red/Black	Roof, House	Misc.	Good	No	ND	3	N/A
11	Shingle #3, Black	Roof, House	Misc.	Good	No	ND	3	N/A
12	Shingle #4, Red/Black	Roof, House	Misc.	Good	No	ND	3	N/A
13	Tar Layer, Black	Roof, Detached Garage	Misc.	Good	No	ND	3	N/A
14	Roof Shingle "Old Layer"	Roof, Detached Garage	Misc.	Good	No	ND	3	N/A
15	Shingle #1	Roof Detached Garage	Misc.	Good	No	ND	3	N/A
16	Shingle #2	Roof, Detached Garage	Misc.	Good	No	ND	3	N/A



HA No.	Material Description	Location	Type ⁽¹⁾	Condition	Friable	% Asbestos*	# of Samples	Estimated Quantity ⁽²⁾
17	Shingle #3	Roof, Detached Garage	Misc.	Good	No	ND	3	N/A
Total Estimated Quantity of ACM								N/A

(1) TSI= Thermal System Insulation, Surf. = Surfacing Material, and Misc. = Miscellaneous.

(2) Quantities are estimates only, all quantities must be field verified.

1.0 INTRODUCTION

GSG Consultants Inc. (GSG) conducted an Asbestos Survey at Parcel No. 1P10167 located at 224 Duncan Street in Joliet, Illinois. The site is improved with a one-story single-family house with an attic, a detached garage and an asphalt single roof. The house was constructed in 1960 and is approximately 800 square feet in size. The interior walls and ceilings are drywall and the floors are wood, floor tile, and linoleum. The building exterior is masonry siding.

GSG conducted the asbestos survey to satisfy requirements of the United States Environmental Protection Agency (USEPA) regulations under 40 CFR Part 61, Subpart M of the National Emission Standards for Hazardous Air Pollutants (NESHAP) and applicable state and local regulations. This was accomplished by conducting a visual inspection of the structures to be impacted by the planned demolition and collecting samples of suspect ACM based on these observations.

The results, findings, conclusions, and recommendations expressed in this report are based on conditions observed during GSG's survey of the project area. The information contained in this report represents conditions at the time of the survey and may not accurately represent conditions at a later date. The conclusions in this report are based on conditions observed in accessible areas of the project area. The possibility exists that suspect hazardous building materials or conditions may exist within wall cavities, voids, or other areas hidden from view which were not observed and cannot be ruled out. Any additional potential hazardous building materials encountered that will be disturbed during the demolition activities and that differ from the materials assessed during this survey, were hidden from view, or were located in an area not accessible will require further sampling and analysis prior to disturbance. The estimated quantities provided herein should be considered approximate and are accurate to the extent allowable under the terms and conditions of our contract. This report has been prepared with generally accepted industry practices and procedures. No other warranty, either expressed or implied, is made.

The investigation did not include access or inspection of confined spaces, underground piping, conduits, and building footings, if any. Materials associated with electrical components and energized equipment were not safely accessible and were not sampled.

2.0 SURVEY METHODOLOGY

The asbestos survey was conducted in compliance with the United States Environmental Protection Agency (USEPA) National Emissions Standards for Hazardous Air Pollutants (NESHAPs), applicable State of Illinois and local asbestos regulations. NESHAP regulations defined regulated asbestos-containing material (RACM) as a friable asbestos material, a Category I non-friable ACM that has become friable, a Category I non-friable ACM that will be or has been subjected to sanding, grinding, cutting or abrading, or Category II non-friable ACM that has a high probability of becoming or has become crumbled, pulverized, or reduced to powder by the forces acting on it during demolition or renovation. The materials were then classified with regard to whether they are friable or non-friable and classified as Class I or Class II non-friable materials, using the following definitions.

- **Friable:** NESHAP defines a friable ACM as any material containing more than one percent (1%) asbestos, which, when dry, may be crumbled, pulverized, or reduced to powder by hand pressure, and includes previously non-friable material where previously non-friable material becomes damaged to the extent that it may be crumbled, pulverized, or reduced to powder by hand pressure.
- **Category I Non-friable ACM:** NESHAP defines a Category I non-friable ACM as packing, gaskets, resilient floor covering (except vinyl sheet flooring products that are considered friable), and asphalt roofing products that contain more than one (1) percent asbestos as determined using the method specified in **Appendix A**, Subpart F, 40 CFR Part 763, Section 1, Polarized Light Microscopy
- **Category II Non-friable ACM:** means any material, excluding Category I non-friable ACM, containing more than 1 percent asbestos as determined using the methods specified in **Appendix A**, Subpart F, 40 CFR Part 763, Section 1, Polarized Light Microscopy that, when dry, cannot be crumbled, pulverized, or reduced to powder by hand pressure.

The survey consisted of three major activities: visual inspection, sampling, and quantification of building materials. A brief description of each of the above elements is provided in the following sections.

2.1 Visual Inspection

The inspector conducted an initial building walkthrough to determine the presence and condition of suspect asbestos-containing materials (ACMs) that were accessible and/or exposed. The survey consisted of accessing accessible areas of the buildings to identify and quantify regulated RACM. The inspector identified homogeneous areas (HA) comprised of building materials that appear similar throughout in terms of color and texture and assumed date of installation. Materials that were similar in general appearance were grouped into homogeneous sampling areas. Following the EPA inspection protocol, each identified suspect homogeneous material was placed in one of the following EPA classifications:

1. Surfacing Materials (spray or trowel applied to building members)
2. Thermal System Insulation (materials generally applied to various mechanical systems)
3. Miscellaneous Materials (any materials which do not fit either of the above categories)

Each identified suspect homogeneous material was placed in one of the following EPA classifications:

2.2 Sampling procedures

The asbestos inspector collected a representative number of samples from each HA. Building materials identified as concrete (not including cement panels or pipe and soft concrete), glass (including fiberglass), wood, masonry, metal, and plastic are not considered suspect ACM and were not sampled. The survey included destructive, intrusive, and/or exploratory testing unless specifically prohibited by IDOT. Destructive sampling is performed to identify materials that are concealed or obstructed. Concealed or obstructed areas include but are not limited to wall cavities, pipe chases, spaces above fixed ceilings, materials located under carpeting or subfloors, and ceramic tile grout/adhesive. Bulk samples of suspect ACM were collected in general accordance with Asbestos Hazard Emergency Response Act (AHERA) sampling protocols, based on the results of the visual observation. Random samples of suspect materials were collected of each HA.

A total of 51 bulk samples of suspect ACM, three (3) samples for each of the 17 homogeneous areas, were collected from various homogeneous areas of the buildings. Bulk samples were collected from the following materials/homogeneous area(s):

- 12"X12" Vinyl Floor Tile, Grey/White Spots, Black Adhesive
- Drywall System, White
- Window Glazing, Grey, Interior
- Wall Glue, Beige
- Textured Ceiling, White
- Window Glazing, Exterior
- Siding Exterior, Brown, Detached Garage
- Tar Paper, Roof, House
- Shingle #1, Roof House
- Shingle #2, Roof House
- Shingle #3, Roof House
- Shingle #4, Roof House
- Tar Paper, Roof, Detached Garage
- Shingle "Old Layer" Roof, Detached Garage
- Shingle #1, Roof, Detached Garage
- Shingle #2, Roof, Detached Garage
- Shingle #3, Roof, Detached Garage

Exhibit 1, Suspect ACM Sample Locations, shows the approximate locations of the suspect ACM collected during the field survey. Samples were placed in new sealable containers and labeled with unique sample numbers using an indelible marker. All non-disposable sampling equipment was wet-wiped and cleaned before and after each use. Bulk material samples were collected in 4-milliliter plastic bags, and tightly sealed for transport to the laboratory. Bulk samples were submitted under a chain-of-custody (COC) protocol to Sterling Labs in Chicago, Illinois.

2.3 Quantification

The inspector estimated the quantities of accessible and/or exposed materials that were suspected of containing asbestos using a measuring wheel and/or visual estimation. Actual quantities may differ between visually estimated values and physical measurements. The asbestos abatement contractor is responsible for verifying reported quantities of ACM.

3.0 ANALYTICAL RESULTS

3.1 Testing Procedures

Sterling Lab analyzed the bulk samples using polarized light microscopy (PLM) method with dispersion staining techniques per USEPA methodology “Method for the Determination of Asbestos in Bulk Building Materials, EPA/600/R-93/116, July 1993”. This is a standard method of analysis in optical mineralogy and the currently accepted method for the determination of asbestos in bulk samples. A suspect material is immersed in a solution of known refractive index and subjected to illumination by polarized light. The characteristic color displays which enable mineral identification. It should be noted that some ACM may not be accurately identified and/or quantified by PLM. The percentage of asbestos applicable was determined by microscopic visual estimation. Sterling analyzed each layer of each sample, which means if multiple layers are detected in the same sample (i.e., roof field), each layer was analyzed, and a separate result was provided for each layer. If any of the sample results from a homogeneous group had a positive result, that homogeneous group was considered to be ACM. Sterling Labs is accredited under the National Voluntary Laboratory Accreditation Program (NVLAP Accreditation Number 101202-0). Refer to **Appendix D** for laboratory accreditations.

It should be noted that some ACMs might not be accurately identified and/or quantified by PLM. As an example, the original fabrication of vinyl floor tiles routinely involved milling of asbestos fibers to extremely small sizes. As a result, these fibers may go undetected under the standard PLM methods. Transmission Electron Microscopy (TEM) is required for a more definitive analysis of these materials. This survey revealed the presence of floor tiles with less than 1% asbestos via PLM analysis. GSG recommends additional analysis by TEM as described above and recommended by the Illinois Department of Public Health.

3.2 Findings

GSG identified a total of 17 HAs from which 51 samples were collected and analyzed. Results are summarized in **Table 1** and include a description of each material, location, material type, test results, and estimated quantity. Materials indicated to have a “negative” result were confirmed by PLM analysis to be non-asbestos-containing. The laboratory results are provided in **Appendix A** and reference photographs are included in **Appendix B**. The USEPA defines ACM as a material containing greater than 1% asbestos. Materials containing less than 1% asbestos are not regulated by the USEPA or the State of Illinois, but their disturbance is regulated by OSHA.

The laboratory reported that asbestos was Not Detected (ND) in the bulk samples collected by GSG.

4.0 RECOMMENDATIONS

GSG understands that the residential property will be demolished as part of the I-80 improvement project. ACMs identified at the site must be removed/managed in accordance with all federal, state, and local regulations governing asbestos. ACMs abatement and management are subject to the US Environmental Protection Agency (USEPA), the Occupational and Health Administration (OSHA), Illinois Department of Public Health (IDPH), the Illinois Environmental Protection Agency (Illinois EPA), and other applicable Federal, State, and Local Government regulations. The following regulations governing asbestos removal and disposal:

1. U.S. Environmental Protection Agency Regional National Emissions Standards for Hazardous Air Pollutants (NESHAP) (40 CFR Part 61 Subpart A and M).
2. U.S. Department of Transportation "Hazardous Substances Final Rule" 49 CFR 171 and 172, November 21, 1986, February 17, 1987.
3. U.S. Department of Labor Occupational Safety and Health Administration (OSHA) Asbestos Regulations (Code of Federal Regulations Title 29, Part 1910, Section 1910.1001 and Part 1926, Section 1926.1101).
4. State of Illinois, Commercial and Public Building Asbestos Abatement Act. Illinois Department of Public Health, Rules for Asbestos Abatement for Public and Private Schools and Commercial and Public Buildings in Illinois (77 IL Admin. Code 855).

All friable asbestos-containing building materials (ACBMs) identified shall be removed from any building(s) or other structures before demolition. Non-friable ACMs may be left in place, unless during demolition, the ACMs may become friable. If other suspect materials not referenced in this survey report, within or on the outside of the buildings, are identified, not listed in **Table 1**, such materials shall be assumed ACMs until the materials are inspected by a licensed asbestos inspector, sampled, and submitted for laboratory analysis. As the floor tile identified as asbestos containing is a Category I non-friable material which is not likely to become friable during demolition, it does not need to be removed prior to demolition.

GSG recommends the preparation of an asbestos abatement project design before any demolition. An asbestos abatement design plan and specifications should include information regarding the location of containments and barriers, type of sealant, and air sampling requirements and clearance during the asbestos abatement activities. The asbestos design plan and specifications shall be prepared and signed by an IDPH licensed asbestos project designer following Illinois regulations. Before starting any abatement activities, an Asbestos Abatement notification is required for all asbestos projects and must be applied for at least ten (10) working days before the start of the project. A building demolition notification is required for all demolition projects and must be applied for at least ten (10) working days before the start of the project.

Abatement and Emergency Response shall be conducted only by IDPH licensed asbestos abatement contractor(s) under the supervision of a licensed asbestos project manager in accordance with all applicable federal, state, and local regulations. Workers who abate or manage asbestos must receive the proper training and licensing. OSHA prescribes required personnel monitoring including air monitoring and medical monitoring (ref 29 CFR 1926.1101). Personnel protective equipment and procedures are also required.

All asbestos waste generated from the required pre-demolition removal activities during the project must be wetted before it is double bagged in 6-millimeter plastic bags and enclosed in a plastic, leak-tight container with a lid and proper labeling. Discharge no visible emissions to the outside air during the collection, processing, packaging, or transporting of any asbestos-containing waste material. Asbestos waste is a “special waste” in Illinois. Asbestos-containing waste can only be disposed of in Subtitle D landfills that are designated to receive asbestos waste.

5.0 LIMITATIONS

This report has been prepared for the exclusive use of the Illinois Department of Transportation (IDOT) and its Design Section Engineer consultant. GSG warrants that the investigations and methodology reflect our best efforts based upon the prevailing standard of care in the environmental field. This assessment was limited to those materials which were readily visible and with limited demolition and removal of building components. Additional suspect materials may be located behind walls and ceilings. The survey is subject to the following limitations.

- The investigation did not include sampling on any system which may present a hazard to the inspection team such as energized electrical systems or within confined spaces
- Materials associated with electrical components and energized equipment were not safely accessible and were not sampled.
- Estimated quantities of the ACMs are based on observations during the field survey and additional materials may be concealed or were not accessible. Therefore, all estimated quantities shall be field verified by the abatement contractor.

6.0 CERTIFICATION

The undersigned hereby affirm that the conditions described herein are accurate to the best of our knowledge and belief and are subject to the limitations inherent in the investigative techniques used and any expressed limitations of this survey. Applicable licensing to perform the described survey activities was valid at the time of performance of services in accordance with applicable federal, state and local laws, rules, and regulations.

Inspection Performed By:

Safdar Azeem

Asbestos Inspector's Name

100-10351

IDPH License Number



Asbestos Inspector's Signature

02.05.2025

Date

EXHIBITS

Exhibit 1

Suspect ACM Sample Location Plans

EXHIBIT 1

SL-1, SL-2 Suspect ACM Sample Location Plans

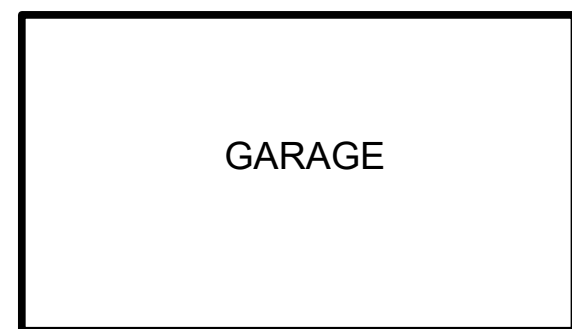
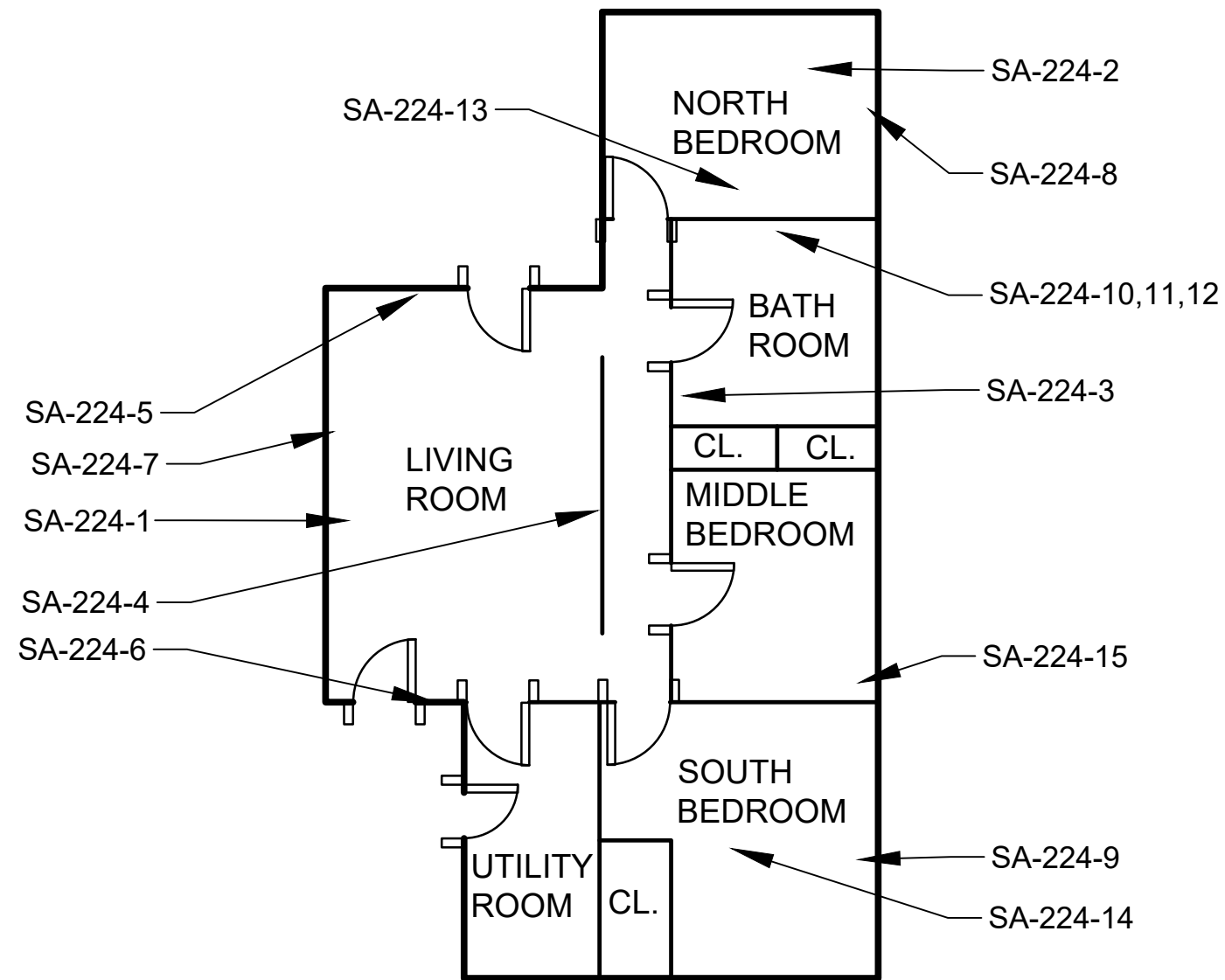

FIRST FLOOR
SCALE = N.T.S.



LEGEND

SUSPECT ACM SAMPLE LOCATIONS: SA-224-XX
BATCH NUMBER: 373730

SUSPECT ASBESTOS-CONTAINING MATERIALS SAMPLE LOCATION PLAN

ASBESTOS SURVEY FOR BUILDING DEMOLITION (I-80)
224 DUNCAN STREET
JOLIET, IL, 60433



DRAWN BY:	PROJECT:
EP	21-2007
CHECKED BY:	SCALE:
TC	NTS
DATE:	SHEET #:
2/10/2025	1 OF 2
SHEET NAME:	

SL-1

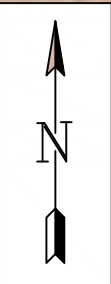

LEGEND

SUSPECT ACM SAMPLE LOCATIONS: SA-224-XX

BATCH NUMBER: 373730

SUSPECT ASBESTOS-CONTAINING MATERIALS SAMPLE LOCATION PLAN

ASBESTOS SURVEY FOR BUILDING DEMOLITION (I-80)
224 DUNCAN STREET
JOLIET, IL, 60433

GSG CONSULTANTS, INC.
232 E REMINGTON RD, SCHWARTZBURG, IL 60193
TEL: 815.398.1100 FAX: 815.398.1101
WWW.GSGCONSULTANTS.COM
ILLINOIS PROFESSIONAL DESIGN FRANK BAPOZZESE

DRAWN BY:	PROJECT:
EP	21-2007
CHECKED BY:	SCALE:
TC	NTS
DATE:	SHEET #:
2/10/2025	2 OF 2
SHEET NAME:	
SL-2	

APPENDIX A

Analytical Testing Results

ASBESTOS ANALYSIS BY POLARIZED LIGHT MICROSCOPY

Method: EPA/600/R-93/116

GSG Consultants, Inc.
 735 Remington Road
 Schaumburg, IL 60173
 Phone: (630) 994-2600
 Fax: (312) 733-5612

Reference:	21-2007	Date Received:	02/03/2025
Location:	IDOT; I-80 Improvement 224 Duncan St	Date Analyzed:	02/05/2025
Batch No.:	373730	Date Reported:	02/05/2025
Customer No.:	4651	Turn Around Time:	2 Days

Laboratory Sample	Customer Sample Number	Asbestos Components (%)	Non-Asbestos Components (%)
373730001	SA-224-1	ND	Binder 99-100%
373730002	SA-224-2	ND	Binder 99-100%
373730003	SA-224-3	ND	Binder 99-100%
373730004	SA-224-1M	ND	Cellulose 1-5% Binder 95-99%
373730005	SA-224-2M	ND	Cellulose 1-5% Binder 95-99%
373730006	SA-224-3M	ND	Cellulose 1-5% Binder 95-99%
373730007	SA-224-4	ND	Cellulose 5-10% Binder 90-95%
373730008	SA-224-5	ND	Cellulose 5-10% Binder 90-95%
373730009	SA-224-6	ND	Cellulose 5-10% Binder 90-95%
373730010	SA-224-7	ND	Cellulose 1-5% Binder 95-99%
373730011	SA-224-8	ND	Cellulose 1-5% Binder 95-99%

ND = Asbestos Not Detected (Not Present) NA = Not Analyzed NS = Not Submitted

Components of inhomogeneous samples are analyzed per our Standard Operating Procedure, or per customer request.

The use of the NVLAP logo does not imply endorsement by NVLAP or any agency of the US Government.

The information contained in this report and any attachments is confidential information intended only for the use of the individual or entities named above. The results of this report relate only to the samples tested. If you have received this report in error, please notify us immediately by phone. This report shall not be reproduced, except in its entirety, unless written approval has been obtained from the laboratory. This report remains property of STAT Analysis until payment is received in full (see invoice).

Analyzed by Name :

 Zineb Nasri / Microscopist

ASBESTOS ANALYSIS BY POLARIZED LIGHT MICROSCOPY

Method: EPA/600/R-93/116

GSG Consultants, Inc.
 735 Remington Road
 Schaumburg, IL 60173
 Phone: (630) 994-2600
 Fax: (312) 733-5612

Reference:	21-2007	Date Received:	02/03/2025
Location:	IDOT; I-80 Improvement 224 Duncan St	Date Analyzed:	02/05/2025
Batch No.:	373730	Date Reported:	02/05/2025
Customer No.:	4651	Turn Around Time:	2 Days

Laboratory Sample	Customer Sample Number	Asbestos Components (%)	Non-Asbestos Components (%)
373730012	SA-224-9	ND	Cellulose 1-5% Binder 95-99%
373730013	SA-224-10	ND	Cellulose 1-5% Binder 95-99%
373730014	SA-224-11	ND	Cellulose 1-5% Binder 95-99%
373730015	SA-224-12	ND	Cellulose 1-5% Binder 95-99%
373730016	SA-224-10M	ND	Cellulose 1-5% Binder 95-99%
373730017	SA-224-11M	ND	Cellulose 1-5% Binder 95-99%
373730018	SA-224-12M	ND	Cellulose 1-5% Binder 95-99%
373730019	SA-224-13	ND	Cellulose 1-5% Binder 95-99%
373730020	SA-224-14	ND	Cellulose 1-5% Binder 95-99%
373730021	SA-224-15	ND	Cellulose 1-5% Binder 95-99%

ND = Asbestos Not Detected (Not Present) NA = Not Analyzed NS = Not Submitted

Components of inhomogeneous samples are analyzed per our Standard Operating Procedure, or per customer request.

The use of the NVLAP logo does not imply endorsement by NVLAP or any agency of the US Government.

The information contained in this report and any attachments is confidential information intended only for the use of the individual or entities named above. The results of this report relate only to the samples tested. If you have received this report in error, please notify us immediately by phone. This report shall not be reproduced, except in its entirety, unless written approval has been obtained from the laboratory. This report remains property of STAT Analysis until payment is received in full (see invoice).

Analyzed by Name :

Zineb Nasri / Microscopist

ASBESTOS ANALYSIS BY POLARIZED LIGHT MICROSCOPY

Method: EPA/600/R-93/116

GSG Consultants, Inc.
735 Remington Road
Schaumburg, IL 60173
Phone: (630) 994-2600
Fax: (312) 733-5612

Reference: 21-2007

Location: IDOT; I-80 Improvement 224 Duncan St

Batch No.: 373730

Customer No.: 4651

Date Received: 02/03/2025

Date Analyzed: 02/05/2025

Date Reported: 02/05/2025

Turn Around Time: 2 Days

Laboratory Sample	Customer Sample Number	Asbestos Components (%)	Non-Asbestos Components (%)
373730022	SA-224-16	ND	Cellulose 1-5% Binder 95-99%
373730023	SA-224-17	ND	Cellulose 1-5% Binder 95-99%
373730024	SA-224-18	ND	Cellulose 1-5% Binder 95-99%
373730025	SA-224-19	ND	Cellulose 15-20% Binder 80-85%
373730026	SA-224-20	ND	Cellulose 15-20% Binder 80-85%
373730027	SA-224-21	ND	Cellulose 15-20% Binder 80-85%
373730028	SA-224-22	ND	Cellulose 80-85% Binder 15-20%
373730029	SA-224-23	ND	Cellulose 80-85% Binder 15-20%
373730030	SA-224-24	ND	Cellulose 80-85% Binder 15-20%
373730031	SA-224-25	ND	Binder 85-90% Glass 10-15%

ND = Asbestos Not Detected (Not Present) NA = Not Analyzed NS = Not Submitted

Components of inhomogeneous samples are analyzed per our Standard Operating Procedure, or per customer request.

The use of the NVLAP logo does not imply endorsement by NVLAP or any agency of the US Government.

The information contained in this report and any attachments is confidential information intended only for the use of the individual or entities named above. The results of this report relate only to the samples tested. If you have received this report in error, please notify us immediately by phone. This report shall not be reproduced, except in its entirety, unless written approval has been obtained from the laboratory. This report remains property of STAT Analysis until payment is received in full (see invoice).

Analyzed by Name : 

ASBESTOS ANALYSIS BY POLARIZED LIGHT MICROSCOPY

Method: EPA/600/R-93/116

GSG Consultants, Inc.
735 Remington Road
Schaumburg, IL 60173
Phone: (630) 994-2600
Fax: (312) 733-5612

Reference: 21-2007

Location: IDOT; I-80 Improvement 224 Duncan St

Batch No.: 373730

Customer No.: 4651

Date Received: 02/03/2025

Date Analyzed: 02/05/2025

Date Reported: 02/05/2025

Turn Around Time: 2 Days

Laboratory Sample	Customer Sample Number	Asbestos Components (%)	Non-Asbestos Components (%)
373730032	SA-224-26	ND	Binder 85-90% Glass 10-15%
373730033	SA-224-27	ND	Binder 85-90% Glass 10-15%
373730034	SA-224-28	ND	Binder 85-90% Glass 10-15%
373730035	SA-224-29	ND	Binder 85-90% Glass 10-15%
373730036	SA-224-30	ND	Binder 85-90% Glass 10-15%
373730037	SA-224-31	ND	Binder 85-90% Glass 10-15%
373730038	SA-224-32	ND	Binder 85-90% Glass 10-15%
373730039	SA-224-33	ND	Binder 85-90% Glass 10-15%
373730040	SA-224-34	ND	Binder 85-90% Glass 10-15%
373730041	SA-224-35	ND	Binder 85-90% Glass 10-15%

ND = Asbestos Not Detected (Not Present) NA = Not Analyzed NS = Not Submitted

Components of inhomogeneous samples are analyzed per our Standard Operating Procedure, or per customer request.

The use of the NVLAP logo does not imply endorsement by NVLAP or any agency of the US Government.

The information contained in this report and any attachments is confidential information intended only for the use of the individual or entities named above. The results of this report relate only to the samples tested. If you have received this report in error, please notify us immediately by phone. This report shall not be reproduced, except in its entirety, unless written approval has been obtained from the laboratory. This report remains property of STAT Analysis until payment is received in full (see invoice).

Analyzed by Name :

Zineb Nasri / Microscopist

ASBESTOS ANALYSIS BY POLARIZED LIGHT MICROSCOPY

Method: EPA/600/R-93/116

GSG Consultants, Inc.
 735 Remington Road
 Schaumburg, IL 60173
 Phone: (630) 994-2600
 Fax: (312) 733-5612

Reference:	21-2007	Date Received:	02/03/2025
Location:	IDOT; I-80 Improvement 224 Duncan St	Date Analyzed:	02/05/2025
Batch No.:	373730	Date Reported:	02/05/2025
Customer No.:	4651	Turn Around Time:	2 Days

Laboratory Sample	Customer Sample Number	Asbestos Components (%)	Non-Asbestos Components (%)
373730042	SA-224-36	ND	Binder 85-90% Glass 10-15%
373730043	SA-224-37	ND	Cellulose 10-15% Binder 85-90%
373730044	SA-224-38	ND	Cellulose 10-15% Binder 85-90%
373730045	SA-224-39	ND	Cellulose 10-15% Binder 85-90%
373730046	SA-224-40	ND	Cellulose 10-15% Binder 85-90%
373730047	SA-224-41	ND	Cellulose 10-15% Binder 85-90%
373730048	SA-224-42	ND	Cellulose 10-15% Binder 85-90%
373730049	SA-224-43	ND	Binder 85-90% Glass 10-15%
373730050	SA-224-44	ND	Binder 85-90% Glass 10-15%
373730051	SA-224-45	ND	Binder 85-90% Glass 10-15%

ND = Asbestos Not Detected (Not Present) NA = Not Analyzed NS = Not Submitted

Components of inhomogeneous samples are analyzed per our Standard Operating Procedure, or per customer request.

The use of the NVLAP logo does not imply endorsement by NVLAP or any agency of the US Government.

The information contained in this report and any attachments is confidential information intended only for the use of the individual or entities named above. The results of this report relate only to the samples tested. If you have received this report in error, please notify us immediately by phone. This report shall not be reproduced, except in its entirety, unless written approval has been obtained from the laboratory. This report remains property of STAT Analysis until payment is received in full (see invoice).

Analyzed by Name : 

ASBESTOS ANALYSIS BY POLARIZED LIGHT MICROSCOPY

Method: EPA/600/R-93/116

GSG Consultants, Inc.
735 Remington Road
Schaumburg, IL 60173
Phone: (630) 994-2600
Fax: (312) 733-5612

Reference: 21-2007

Location: IDOT; I-80 Improvement 224 Duncan St

Batch No.: 373730

Customer No.: 4651

Date Received: 02/03/2025

Date Analyzed: 02/05/2025

Date Reported: 02/05/2025

Turn Around Time: 2 Days

Laboratory Sample	Customer Sample Number	Asbestos Components (%)	Non-Asbestos Components (%)
373730052	SA-224-46	ND	Binder 85-90% Glass 10-15%
373730053	SA-224-47	ND	Binder 85-90% Glass 10-15%
373730054	SA-224-48	ND	Binder 85-90% Glass 10-15%
373730055	SA-224-49	ND	Binder 85-90% Glass 10-15%
373730056	SA-224-50	ND	Binder 85-90% Glass 10-15%
373730057	SA-224-51	ND	Binder 85-90% Glass 10-15%

ND = Asbestos Not Detected (Not Present) NA = Not Analyzed NS = Not Submitted

Components of inhomogeneous samples are analyzed per our Standard Operating Procedure, or per customer request.

The use of the NVLAP logo does not imply endorsement by NVLAP or any agency of the US Government.

The information contained in this report and any attachments is confidential information intended only for the use of the individual or entities named above. The results of this report relate only to the samples tested. If you have received this report in error, please notify us immediately by phone. This report shall not be reproduced, except in its entirety, unless written approval has been obtained from the laboratory. This report remains property of STAT Analysis until payment is received in full (see invoice).

Analyzed by Name : 



GSG CONSULTANTS, INC.

Engineering and Industrial Hygiene Services

735 Remington Road

Schaumburg, IL 60173

(630) 994-2600 Fax: (312) 733-5612

www.gsg-consultants.com

37380

Page 1 of 4

PLM BULK LABORATORY ANALYSIS FORM

Project Name: IDOT; I-80 IMPROVEMENT	Project Manager: Ted Cagney
Project Number: 21-2007	Building Inspector: Safdar Azeem
Project Address: 224 DUNCAN ST.	IDPH Number: 100-10351
City/ State: Joliet, IL -	Work Day: S M T W TH <u>FR</u> S
Client: WSP - USA	Analyze by Method:
Date: 01/30/2025	EPA/600/R-93-116

Field Number	HA Number	Type of material, specific sample location (i.e. Room Number, Building Construction Date)
SA-224-1	HA#1	12" x 12" W-F-T Grey / White Spots
2	↓	↓ Adhesive - Black Self stick
3	↓	↓
4	2	Day wall system, white
5	↓	↓ Living Room
6	↓	↓
7	3	Window Glazing, Grey
8	↓	↓ Interior
9	↓	↓
10	4	Wall-Glue - Berge -
11	↓	↓ Bathroom
12	↓	↓
13	5	Textured Ceiling, white
14	↓	↓ Bedroom
15	↓	↓

TURN AROUND TIME:

2-Day TAT

(5 Day) Other

1 Day
2 Days
3 Days

COMMENTS: E-mail Results to:

epahomi@gsg-consultants.com sazeem@gsg-consultants.com

STOP AT FIRST POSITIVE

CHAIN OF CUSTODY RECORD

Collected By (Signature) <u>Safdar Azeem</u>	Date: <u>01/30/25</u>	Time:	Relinquished by (Signature) <u>Safdar Azeem</u>	Date: <u>02/03/25</u>	Time: <u>9:00</u>
Received by: (Signature) <u>Jul 7 K</u>	Date: <u>2-3-25</u>	Time: <u>12:00</u>	Relinquished by: (signature) <u>Jul 7 K</u>	Date: <u>2-3-25</u>	Time: <u>12:36</u>
Dispatched by: (Signature, if mailed)	Date:	Time:	Received for Laboratory by: <u>[Signature]</u>	Date: <u>2/3/25</u>	Time: <u>12:35</u>

Definitions: BLK-Bulk Sample, PLM-Polarized Light Microscopy, TEM-Transmission Electron Microscope.



GSG CONSULTANTS, INC.

Engineering and Industrial Hygiene Services

735 Remington Road

Schaumburg, IL 60173

(630) 994-2600 Fax: (312) 733-5612

www.gsg-consultants.com

373730

Page 2 of 4

PLM BULK LABORATORY ANALYSIS FORM

Project Name: IDOT; I-80 IMPROVEMENT	Project Manager: Ted Cagney
Project Number: 21-2007	Building Inspector: Safdar Azeem
Project Address: 224 DUNCAN ST.	IDPH Number: 100-10351
City/ State: Joliet, IL -	Work Day: S M T W TH <u>FR</u> S
Client: WSP - USA	Analyze by Method:
Date: 01/30/2025	EPA/600/R-93-116

Field Number	HA Number	Type of material, specific sample location (i.e. Room Number, Building Construction Date)
SA-224-16	HA#6	Window Glazing
17	↓	↓ Exterior
18	↓	↓
19	7	Exterior Siding, Brown
20	↓	↓ Detached Garage
21	↓	↓ Under Al.
22	8	Roof - Tar Paper - House
23	↓	↓ Black
24	↓	↓
25	9	Roof - Shingle #1 House
26	↓	↓ Red/Black
27	↓	↓
28	10	Roof - Shingle #2 - House
29	↓	↓ Red/Black
30	↓	↓

TURN AROUND TIME:

1 Day
2 Days
3 Days

(5 Day) Other

COMMENTS: E-mail Results to:

epahomi@gsg-consultants.com sazeem@gsg-consultants.com

STOP AT FIRST POSITIVE

CHAIN OF CUSTODY RECORD

Collected By (Signature) <u>Safdar Azeem</u>	Date: <u>01/30/25</u>	Time:	Relinquished by (Signature) <u>Safdar Azeem</u>	Date: <u>02/03/25</u>	Time: <u>9:00</u>
Received by: (Signature) <u>Jul 72</u>	Date: <u>2-3-25</u>	Time: <u>12:00</u>	Relinquished by: (signature) <u>Jul 72</u>	Date: <u>2-3-25</u>	Time: <u>12:36</u>
Dispatched by: (Signature, if mailed)	Date:	Time:	Received for Laboratory by: <u>Jul 72</u>	Date: <u>2/3/25</u>	Time: <u>12:36</u>

Definitions: BLK-Bulk Sample, PLM-Polarized Light Microscopy, TEM-Transmission Electron Microscope.



GSG CONSULTANTS, INC.

Engineering and Industrial Hygiene Services

735 Remington Road

Schaumburg, IL 60173

(630) 994-2600 Fax: (312) 733-5612

www.gsg-consultants.com

373730

Page 3 of 4

PLM BULK LABORATORY ANALYSIS FORM

Project Name: IDOT; I-80 IMPROVEMENT	Project Manager: Ted Cagney
Project Number: 21-2007	Building Inspector: Safdar Azeem
Project Address: 224 DUNCAN ST.	IDPH Number: 100-10351
City/State: Joliet, IL -	Work Day: S M T W TH <u>FR</u> S
Client: WSP - USA	Analyze by Method:
Date: 01/30/2025	EPA/600/R-93-116

Field Number	HA Number	Type of material, specific sample location (i.e. Room Number, Building Construction Date)
SA-224-31	HA # 11	Roof - shingle # 3 - House
32	↓	↓ Black
33	↓	↓
34	12	Roof - shingle # 4 - House
35	↓	↓ Red/Black
36	↓	↓
37	13	Roof - Tar layer - Det. Garage
38	↓	↓
39	↓	↓
40	14	Roof - shingle - Det. Garage
41	↓	↓ 'old-layer'
42	↓	↓
43	15	Roof - shingle # 1 - Det. Garage
44	↓	↓
45	↓	↓

TURN AROUND TIME:

1 Day

2 Days

3 Days

2-Day TAT

(5 Day) Other

COMMENTS: E-mail Results to:

epahomi@gsg-consultants.com sazeem@gsg-consultants.com

STOP AT FIRST POSITIVE

CHAIN OF CUSTODY RECORD

Collected By (Signature) <u>Safdar Azeem</u>	Date: <u>01/30/25</u>	Time:	Relinquished by (Signature) <u>Safdar Azeem</u>	Date: <u>02/03/25</u>	Time: <u>9:00</u>
Received by: (Signature) <u>MD 77</u>	Date: <u>2-3-25</u>	Time: <u>12:00</u>	Relinquished by: (signature) <u>MD 77</u>	Date: <u>2-3-25</u>	Time: <u>12:36</u>
Dispatched by: (Signature, if mailed)	Date:	Time:	Received for Laboratory by: <u>MD 77</u>	Date: <u>2/3/25</u>	Time: <u>12:36</u>

Definitions: BLK-Bulk Sample, PLM-Polarized Light Microscopy, TEM-Transmission Electron Microscope.

PLM BULK LABORATORY ANALYSIS FORM

Project Name: IDOT; I-80 IMPROVEMENT	Project Manager: Ted Cagney
Project Number: 21-2007	Building Inspector: Safdar Azeem
Project Address: 224 DUNCAN ST.	IDPH Number: 100-10351
City/State: Joliet, IL -	Work Day: S M T W TH FR S
Client: WSP - USA	Analyze by Method:
Date: 01/30/2025	EPA/600/R-93-116

[illegible]

TURN AROUND TIME:

1 Day

2 Days

3 Days

2-Day TA4

(5 Day) Other

COMMENTS: E-mail Results to:

epahomi@gsg-consultants.com sazeem@gsg-consultants.com

STOP AT FIRST POSITIVE

CHAIN OF CUSTODY RECORD

Collected By (Signature) <i>Saidur Azam</i>	Date: <i>01/30/25</i>	Time:	Relinquished by (Signature) <i>Saidur Azam</i>	Date: <i>02/03/25</i>	Time: <i>9:00</i>
Received by: (Signature) <i>Md 77</i>	Date: <i>2-3-25</i>	Time: <i>12:00</i>	Relinquished by: (signature) <i>Md 77</i>	Date: <i>2-3-25</i>	Time: <i>12:36</i>
Dispatched by: (Signature, if mailed)	Date:	Time:	Received for Laboratory by: <i>Gi</i>	Date: <i>2/3/25</i>	Time: <i>12:36</i>

● Definitions: BLK-Bulk Sample, PLM-Polarized Light Microscopy, TEM-Transmission Electron Microscope.

APPENDIX B

Reference Photographs



Material Description:
Suspect ACM 12"X12"
Floor Tile (grey w/white
spots), Black Adhesive

Photo Location:
Living Room

**ILLINOIS DEPARTMENT OF
TRANSPORTATION
I-80 OVER DES PLAINES RIVER BRIDGE
IMPROVEMENTS**



GSG Consultants, Inc.
735 Remington Road
Schaumburg, Illinois 60173

Date: 1/30/25



Material Description:
Suspect ACM Drywall
System, White

Photo Location:
Living Room

**ILLINOIS DEPARTMENT OF
TRANSPORTATION
I-80 OVER DES PLAINES RIVER BRIDGE
IMPROVEMENTS**



GSG Consultants, Inc.
735 Remington Road
Schaumburg, Illinois 60173

Date: 1/30/25



Material Description:
Suspect ACM Window
Glazing, Grey

Photo Location:
Interior

**ILLINOIS DEPARTMENT OF
TRANSPORTATION
I-80 OVER DES PLAINES RIVER BRIDGE
IMPROVEMENTS**



GSG Consultants, Inc.
735 Remington Road
Schaumburg, Illinois 60173

Date: 1/30/25

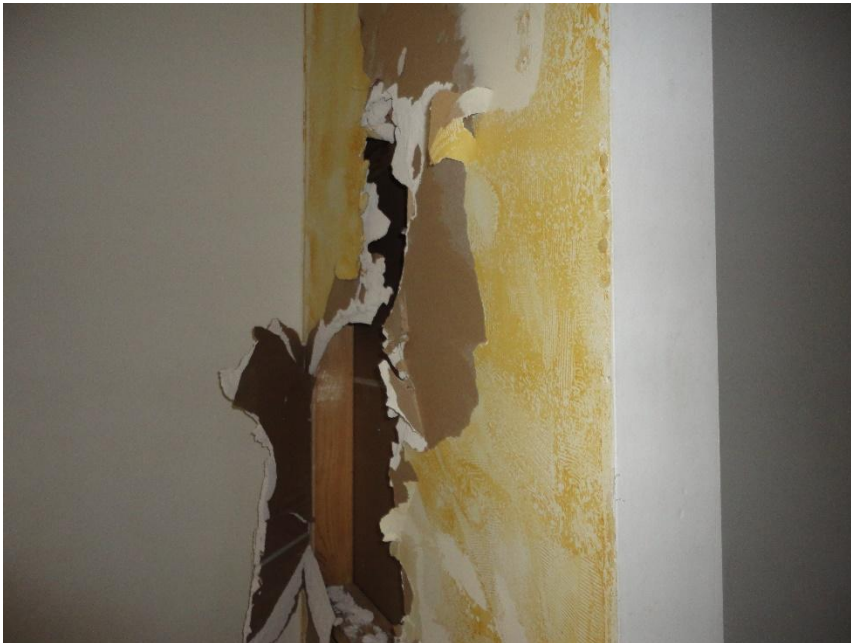

Material Description:
Suspect ACM Wall Glue,
Beige

Photo Location:
Bathroom

**ILLINOIS DEPARTMENT OF
TRANSPORTATION
I-80 OVER DES PLAINES RIVER BRIDGE
IMPROVEMENTS**



GSG Consultants, Inc.
735 Remington Road
Schaumburg, Illinois 60173

Date: 1/30/25



Material Description:
Suspect ACM Textured
Ceiling, White

Photo Location:
Bedroom

**ILLINOIS DEPARTMENT OF
TRANSPORTATION
I-80 OVER DES PLAINES RIVER BRIDGE
IMPROVEMENTS**



GSG Consultants, Inc.
735 Remington Road
Schaumburg, Illinois 60173

Date: 1/30/25



Material Description:
Suspect ACM Window
Glazing

Photo Location:
Exterior

**ILLINOIS DEPARTMENT OF
TRANSPORTATION
I-80 OVER DES PLAINES RIVER BRIDGE
IMPROVEMENTS**



GSG Consultants, Inc.
735 Remington Road
Schaumburg, Illinois 60173

Date: 1/30/25



Material Description:
Suspect ACM Exterior
Siding

Photo Location:
Detached Garage

**ILLINOIS DEPARTMENT OF
TRANSPORTATION
I-80 OVER DES PLAINES RIVER BRIDGE
IMPROVEMENTS**



GSG Consultants, Inc.
735 Remington Road
Schaumburg, Illinois 60173

Date: 1/30/25



Material Description:
Suspect ACM Tar
Paper/Layer

Photo Location:
Roof - House

**ILLINOIS DEPARTMENT OF
TRANSPORTATION
I-80 OVER DES PLAINES RIVER BRIDGE
IMPROVEMENTS**



GSG Consultants, Inc.
735 Remington Road
Schaumburg, Illinois 60173

Date: 1/30/25

		Material Description: Suspect ACM Shingle Layers
		Photo Location: Roof - House
ILLINOIS DEPARTMENT OF TRANSPORTATION I-80 OVER DES PLAINES RIVER BRIDGE IMPROVEMENTS	 GSG Consultants, Inc. 735 Remington Road Schaumburg, Illinois 60173	Date: 1/30/25
		Material Description: Suspect ACM Tar Paper/Layer
		Photo Location: Roof – Detached Garage
ILLINOIS DEPARTMENT OF TRANSPORTATION I-80 OVER DES PLAINES RIVER BRIDGE IMPROVEMENTS	 GSG Consultants, Inc. 735 Remington Road Schaumburg, Illinois 60173	Date: 1/30/25



Material Description:
Suspect ACM Shingle
Layers

Photo Location:
Roof – Detached Garage

**ILLINOIS DEPARTMENT OF
TRANSPORTATION
I-80 OVER DES PLAINES RIVER BRIDGE
IMPROVEMENTS**



GSG Consultants, Inc.
735 Remington Road
Schaumburg, Illinois 60173

Date: 1/30/25

APPENDIX C

Inspector Licenses and Training Certifications



525-535 West Jefferson Street • Springfield, Illinois 62761-0001 • www.dph.illinois.gov

SAFDAR AZEEM
1 South 285 Ingersoll Lane
Villa Park, IL 60181

4/22/2024



ASBESTOS PROFESSIONAL LICENSE ID NUMBER: 10351

Enclosed is your Asbestos Professional License. Please note the expiration date on the card and in the image depicted below.

COPY OF THE ASBESTOS PROFESSIONAL LICENSE

Front of License

Back of License

		ASBESTOS PROFESSIONAL LICENSE		ENDORSEMENTS	TC EXPIRES
ID NUMBER 100 - 10351		ISSUED 4/22/2024	EXPIRES 05/15/2025	INSPECTOR	1/27/2025
SAFDAR AZEEM 1 South 285 Ingersoll Lane Villa Park, IL 60181 Environmental Health				PROJECT MANAGER AIR SAMPLING PROFESSIONAL	3/1/2025
Alteration of this license shall result in legal action This license issued under authority of the State of Illinois Department of Public Health This license is valid only when accompanied by a valid training course certificate.					

If you have any questions or need further assistance, contact the Asbestos Program at (217)782-3517 or fax (217)785-5897.

Our WEB address is: dph.illinois.gov/topics-services/environmental-health-protection/asbestos
EMAIL Address: dph.asbestos@illinois.gov

APPENDIX D

Laboratory Accreditations

United States Department of Commerce
National Institute of Standards and Technology

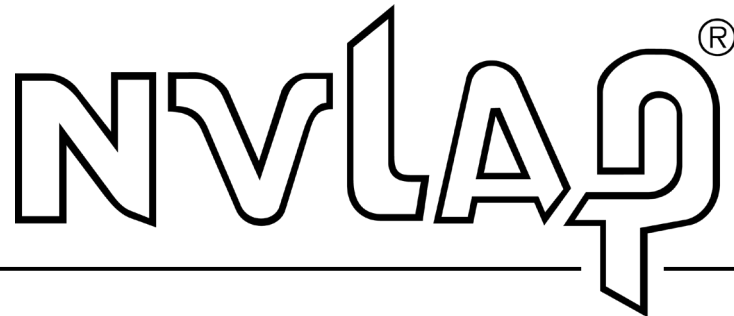

Certificate of Accreditation to ISO/IEC 17025:2017

NVLAP LAB CODE: 101202-0

STAT Analysis Corporation
Chicago, IL

*is accredited by the National Voluntary Laboratory Accreditation Program for specific services,
listed on the Scope of Accreditation, for:*

Asbestos Fiber Analysis

*This laboratory is accredited in accordance with the recognized International Standard ISO/IEC 17025:2017.
This accreditation demonstrates technical competence for a defined scope and the operation of a laboratory quality
management system (refer to joint ISO-ILAC-IAF Communiqué on ISO/IEC 17025).*

2024-07-01 through 2025-06-30

Effective Dates



For the National Voluntary Laboratory Accreditation Program

SCOPE OF ACCREDITATION TO ISO/IEC 17025:2017

STAT Analysis Corporation

Sterling Labs
2242 W. Harrison St. Suite 200
Chicago, IL 60612
Carolyn Mazzuca
Phone: 312-733-0551
Email: cmazzuca@statanalysis.com

ASBESTOS FIBER ANALYSIS

NVLAP LAB CODE 101202-0

Bulk Asbestos Analysis

<u>Code</u>	<u>Description</u>
18/A01	EPA -- 40 CFR Appendix E to Subpart E of Part 763, Interim Method of the Determination of Asbestos in Bulk Insulation Samples
18/A03	EPA 600/R-93/116: Method for the Determination of Asbestos in Bulk Building Materials

Airborne Asbestos Analysis

<u>Code</u>	<u>Description</u>
18/A02	U.S. EPA's "Interim Transmission Electron Microscopy Analytical Methods-Mandatory and Nonmandatory-and Mandatory Section to Determine Completion of Response Actions" as found in 40 CFR, Part 763, Subpart E, Appendix A.

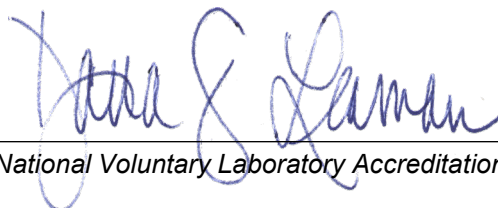

For the National Voluntary Laboratory Accreditation Program