

STATE OF ILLINOIS
DEPARTMENT OF TRANSPORTATION

F.A.P. RTE.	SECTION	COUNTY	TOTAL SHEETS	SHEET NO.
400	FAP 400 23 OVERLAY	LAKE	24	1
ILLINOIS CONTRACT NO. 62U91				

D-91-124-23

FOR INDEX OF SHEETS, SEE SHEET NO. 2

PROPOSED
HIGHWAY PLANS

F.A.P. ROUTE 400 (OLD SKOKIE ROAD)
US 41 (SKOKIE HWY.) TO WISCONSIN STATE LINE
SECTION: FAP 400 23 OVERLAY
PROJECT: STP-EKC7(738)
STANDARD OVERLAY AND NEW SHOULDERS
LAKE COUNTY

THE IMPROVEMENT IS LOCATED IN THE
VILLAGE OF WADSWORTH

TRAFFIC DATA:

2023 ADT - 1300 TO 2750 VPD
SPEED LIMIT - 45 MPH

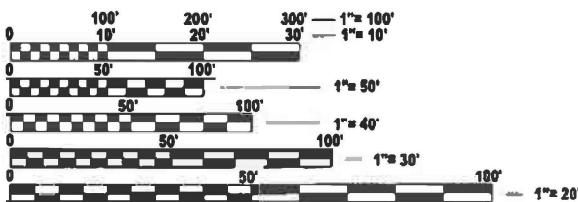

FULL SIZE PLANS HAVE BEEN PREPARED USING STANDARD
ENGINEERING SCALES. REDUCED SIZED PLANS WILL NOT
CONFORM TO STANDARD SCALES. IN MAKING MEASUREMENTS
ON REDUCED PLANS, THE ABOVE SCALES MAY BE USED.

J.U.L.I.E.
JOINT UTILITY LOCATION INFORMATION FOR EXCAVATION
1-800-892-0123
OR 811

PROJECT ENGINEER: VESELIN VELICHKOV (847) 705-4432
PROJECT MANAGER: FAWAD AQUEEL

CONTRACT NO. 62U91

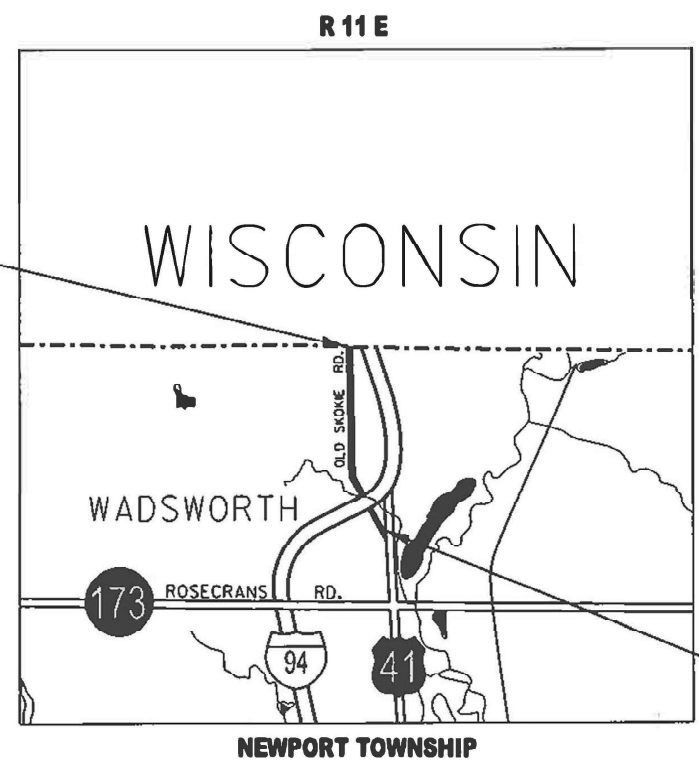

PROJECT ENDS
STA 101+22

PROJECT BEGINS
STA 17+05

GROSS AND NET LENGTH OF PROJECT - 8417 FEET - 1.59 MILES



LOCATION OF SECTION INDICATED THUS: -

STATE OF ILLINOIS
DEPARTMENT OF TRANSPORTATION

SUBMITTED December 6, 2024

REGIONAL ENGINEER

January 31, 2025

ENGINEER OF DESIGN AND ENVIRONMENT

January 31, 2025

DIRECTOR OF HIGHWAYS PROJECT IMPLEMENTATION

PRINTED BY THE AUTHORITY
OF THE STATE OF ILLINOIS

INDEX OF SHEETS

STATE STANDARDS

GENERAL NOTES

NO.	DESCRIPTION	000001-08 001006 442201-03	STANDARD SYMBOLS, ABBREVIATIONS AND PATTERNS DECIMAL OF AN INCH AND OF A FOOT CLASS C AND D PATCHES	1) BEFORE STARTING ANY EXCAVATION, THE CONTRACTOR SHALL CALL "JULIE AT (800) 892-0123 OR 811 FOR FIELD LOCATIONS OF BURIED ELECTRIC, TELEPHONE AND GAS FACILITIES, (48 HOURS NOTIFICATION IS REQUIRED).
1	COVER SHEET			2) TEN (10) FOOT TRANSITION SHALL BE USED TO MATCH PROPOSED CURB AND GUTTER AND MEDIAN ITEMS OF WORK TO EXISTING CURBS AND GUTTERS AND MEDIANS IN THE FIELD, UNLESS OTHERWISE SHOWN. THE TRANSITION SHALL BE PAID FOR AT THE CONTRACT UNIT PRICE FOR THE PROPOSED ITEMS OF WORK SPECIFIED.
2	INDEX OF SHEETS, STATE STANDARDS AND GENERAL NOTES	482001-02	HMA SHOULDER ADJACENT TO FLEXIBLE PAVEMENT	3) THE CONTRACTOR SHALL COORDINATE CONSTRUCTION ACTIVITIES WITH THE UTILITY COMPAINES AND THE VILLAGE OF WADSWORTH.
3-5	SUMMARY OF QUANTITIES			4) THE CONTRACTOR WILL NOT BE ALLOWED TO SET UP A YARD OR FIELD OFFICE ON STATE PROPERTY WITHOUT WRITTEN PERMISSION FROM THE DEPARTMENT.
6-7	EXISTING AND PROPOSED TYPICAL SECTIONS	606001-08	CONCRETE CURB TYPE B AND COMBINATION CONCRETE CURB AND GUTTER	5) ANY PAVEMENT MARKINGS AND RAISED REFLECTIVE PAVEMENT MARKERS OBLITERATED BY MILLING AND RESURFACING OPERATIONS ON SIDE STREETS AND ENTRANCES SHALL BE REPLACED AND PAID FOR IN KIND.
8-11	ROADWAY AND PAVEMENT MARKING PLANS	630001-13	STEEL PLATE BEAM GUARDRAIL	6) ALL DAMAGE TO EXISTING PAVEMENT MARKINGS OR RAISED REFLECTIVE PAVEMENT MARKERS OUTSIDE THE REMOVAL LINE SHOWN ON THE PLANS SHALL BE REPLACED AT NO ADDITIONAL COST TO THE DEPARTMENT.
12	DETAILS FOR FRAMES AND LIDS TO BE ADJUSTED WITH MILLING (BD-08)	630301-09	SHOULDER WIDENING FOR TYPE 1 GUARDRAIL TERMINALS	7) ALL PAVEMENT PATCHING LOCATIONS WILL BE DETERMINED IN THE FIELD BY THE ENGINEER.
13	PAVEMENT PATCHING FOR HMA SURFACED PAVEMENT (BD-22)	642006-01	SHOULDER RUMBLE STRIPS, 8 IN.	8) LOCATION OF COMBINATION CONCRETE CURB AND GUTTER REMOVAL AND REPLACEMENT [OR COMBINATION CURB AND AND GUTTER (THE TYPE SPECIFIED ON THE PLANS)], WILL BE DETERMINED IN THE FIELD BY THE ENGINEER.
14	CURB AND CURB AND GUTTER REMOVAL AND REPLACEMENT (BD-24)	701006-05	OFF-ROAD OPERATIONS, 2L, 2W, 15' (4.5m) TO 24" (600mm) FROM PAVEMENT EDGE	9) DRAINAGE ADJUSTMENT OR RECONSTRUCTION LOCATIONS WILL BE DETERMINED IN THE FIELD BY THE ENGINEER.
15	BUTT JOINT AND HMA TAPER DETAILS (BD-32)	701101-05	OFF-ROAD OPERATIONS, MULTILANE, 15' (4.5m) TO 24" (600mm) FROM PAVEMENT EDGE	10) IT SHALL BE THE CONTRACTORS RESPONSIBILITY TO VERIFY ALL DIMENSIONS AND EXISTING CONDITIONS IN THE FIELD PRIOR TO CONSTRUCTION AND ORDERING OF MATERIALS.
16	RUMBLE STRIPS FOR CENTERLINE, NON-FREEWAY (BD-55)	701201-05	LANE CLOSURE, 2L, 2W, DAY ONLY FOR SPEEDS GREATER THAN OR EQUAL TO 45 MPH	11) FRAMES AND GRATES ADJUSTMENTS OF PRIVATE UTILITIES WITHIN THE LIMITS OF THE IMPROVEMENT SHALL BE DONE BY THEIR RESPECTIVE OWNERS AND ARE NOT IN PART OF THIS CONTRACT.
17	TRAFFIC CONTROL AND PROTECTION FOR SIDE ROADS, INTERSECTIONS AND DRIVEWAYS (TC-10)	701301-04	LANE CLOSURE, 2L, 2W, SHORT TIME OPERATIONS	12) BEFORE BEGINNING ANY WORK, THE CONTRACTOR SHALL RETAIN AND RECORD FOR FUTURE REFERENCE, ALL EXISTING PAVEMENT MARKING LINES (RAISED REFLECTIVE PAVEMENT MARKERS) IN ORDER THAT THESE LOCATIONS CAN BE RE-ESTABLISHED FOR STRIPING. EXACT LOCATIONS OF ALL PAVEMENT MARKINGS SHALL BE AS SHOWN ON THE PLANS OR AS DIRECTED BY THE ENGINEER.
18	TYPICAL APPLICATION FOR RAISED REFLECTIVE PAVEMENT MARKERS (SNOW-PLOW RESISTANT) (TC-11)	701306-04	LANE CLOSURE, 2L, 2W, SLOW MOVING OPERATIONS DAY ONLY, FOR GREATER THAN OR OR EQUAL TO 45 MPH	13) WHEN THE MILLED PAVEMENT IS OPEN TO TRAFFIC THE MAXIMUM GRADE DIFERENTIAL BETWEEN PASSES OF THE MILLING MACHINE SHALL NOT EXCEED 1 1/2 INCH (40 mm) WHERE THE SPEED LIMIT IS 40 MPH (80 km/ h) OR LESS AND 1 INCH (25 mm) WHERE THEN SPEED LIMIT IS GREATER THAN 40 MPH (80 km/ h), WITH WRITTEN APPROVAL OF THE ENGINEER, A MAXIMUM GRADE DIFFERENTIAL 3 INCHES (75 mm) MAY BE ALLOWED IF THE EDGE OF THE MILLING MACHINE IS SLOPED A MINIMUM OF (1:3).
19-20	MULTI-LANE FREEWAY PAVEMENT MARKING DETAILS (TC-12)	701311-03	LANE CLOSURE, 2L, 2W, MOVING OPERATIONS - DAY ONLY	14) THE CONTRACTOR SHALL CONTACT THE DISTRICT ONE TRAFFIC CONTROL SUPERVISOR FOR ARTERIALS AT KALPANA,KANNAN-HOUSADURGA@ILLINOIS.GOV A MINIMUM OF 72 HOURS IN ADVANCE OF BEGINNING WORK.
21	DISTRICT ONE TYPICAL PAVEMENT MARKING (TC-13)	701426-09	LANE CLOSURE, MULTILANE, INTERMITTENT OR MOVING OPERATIONS, FOR SPEEDS GREATER THAN OR EQUAL TO 45 MPH	15) PERMANENT PAVEMENT MARKINGS SHALL BE THERMOPLASTIC (OF THE EXTRUDED TYPE) AND SHOULD BE PLACED IN ACCORDANCE WITH THE "DISTRICT ONE TYPICAL PAVEMENT MARKINGS" DETAIL. (TC-13)
22	TRAFFIC CONTROL AND PROTECTION AT TURN BAYS (TC-14)	701601-09	URBAN LANE CLOSURE, MULTILANE, 1W OR 2W WITH NONTRANSVERSABLE MEDIAN	16) THE RESIDENT ENGINEER SHALL CONTACT MR. FADI SULTAN, AREA TRAFFIC ENGINEER, FADI.SULTAN@ILLINOIS.GOV, A MINIMUM OF TWO (2) WEEKS PRIOR TO THE PLACEMENT OF PERMANENT PAVEMENT MARKINGS.
23	SHORT-TERM PAVEMENT MARKING—LETTERS AND SYMBOLS (TC-16)	701701-10	URBAN LANE CLOSURE, MULTILANE INTERSECTION	17) THE CONTRACTOR SHALL MAINTAIN PEDESTRIAN ACCESS AT ALL TIMES DURING CONSTRUCTION.
24	ARTERIAL ROAD INFORMATION SIGNING (TC-22)	701801-06	SIDEWALK OR SIDEWALK CLOSURE CORNER	18) THE CONTRACTOR SHALL CONTACT THE ROADSIDE DEVELOPMENT UNIT AT (847) 705-4171 AT LEAST TWO WEEKS PRIOR TO BEGINNING LANDSCAPE AND FORESTRY WORK FOR LAYOUT.
		701901-10	TRAFFIC CONTROL DEVICES	19) PAVEMENT MARKING TAPE, TYPE IV SHALL BE USED FOR SHORT-TERM PAVEMENT MARKING ON ALL FINAL SURFACES.
		780001-05	TYPICAL PAVEMENT MARKINGS	20) ALL MILLED SURFACES SHALL BE AT A UNIFORM CROSS SLOPE PER LANE AND FREE OF RIDGES BETWEEN PASSES. ANY DEVIATIONS SHALL BE CORRECTED AT NO COST TO THE DEPARTMENT.
		781001-04	TYPICAL APPLICATION FOR RAISED REFLECTIVE PAVEMENT MARKERS	21) EXISTING VEGETATED AREAS (TREES, SHRUBS, VEGETATIVE BUFFERS, TURF AREAS, ETC.) WHERE DISTURBANCE IS NOT OCCURRING (INCLUDING AREAS OUTSIDE THE PROJECT LIMITS) SHALL NOT BE DISTURBED TO ENSURE THAT EXISTING VEGETATION IS PRESERVED TO MINIMIZED SOIL EROSION AND TO ELIMINATE SOIL COMPACTION. NO MATERIALS ARE TO BE STORED OR VEHICLES DRIVEN OR PARKED WITHIN THESE UNDISTURBED AREAS AT ANY TIME.
		782006-01	GUARDRAIL AND BARRIER WALL REFLECTOR MOUNTING DETAILS	22) SAW CUTTING PRIOR TO ANY REMOVAL ITEMS NOTED ON THE PLANS OR DIRECTED BY THE ENGINEER SHALL BE CONSIDERED INCLUDED IN THE COST OF THE ITEMS BEING REMOVED.
				23) OVERNIGHT LANE CLOSURES SHALL NOT BE ALLOWED FOR REHABILITATION PROJECTS INVOLVING DAYTIME MILLING AND RESURFACING OPERATIONS AND CLASS D PATCHING UNLESS OTHER CONDITIONS WARRANT EXTENDED LANE CLOSURES AS DETERMINED AND APPROVED IN WRITING BY THE ENGINEER OR AS PROVIDED FOR IN THE CONTRACT SPECIFICATIONS.
				24) THE CONTRACTORS ATTENTION IS CALLED TO THE FACT THAT THE PRESERVATION OF EXISTING TREES IS OF UTMOST IMPORTANCE TO THE VILLAGE OF WADSWORTH AND THE FOREST PRESERVE OF LAKE COUNTY

	USER NAME	= Philip.Steed	DESIGNED	-	REVISED	-	STATE OF ILLINOIS DEPARTMENT OF TRANSPORTATION	INDEX OF SHEETS, STATE STANDARDS AND GENERAL NOTES FAP 400 (OLD SKOKIE RD.)—US 41 TO WISCONSIN STATE LINE	F.A.P. RTE.	SECTION	COUNTY	TOTAL SHEETS	SHEET NO.
			DRAWN	-	REVISED	-			400	FAP 400 23 OVERLAY	LAKE	24	2
	PLOT SCALE	= \$\$CALE\$	CHECKED	-	REVISED	-			CONTRACT NO. 62U91				
	PLOT DATE	= 1/24/2025	DATE	-	REVISED	-			ILLINOIS FED. AID PROJECT				

Model: Default
File Name: p:\w\ldot-sw-bentley.com\FWIDOT\Documents\DOT 0 cas\District 1\ORSD Projects\Old Skokie Rd\CADDData\CADsheets\Old Skokie Rd-sh-SQ.dgn

SUMMARY OF QUANTITIES				TOTAL QUANTITIES	CONSTRUCTION TYPE CODE					
CODE NO	ITEM	UNIT	80% FEDERAL 20% STATE							
			0005							
20200100	EARTH EXCAVATION	CU YD	3370	3370						
21101615	TOPSOIL FURNISH AND PLACE, 4"	SQ YD	24	24						
25200110	SODDING, SALT TOLERANT	SQ YD	24	24						
31101200	SUBBASE GRANULAR MATERIAL, TYPE B 4"	SQ YD	9529	9529						
40600290	BITUMINOUS MATERIALS (TACK COAT)	POUND	25553	25553						
40600370	LONGITUDINAL JOINT SEALANT	FOOT	14019	14019						
40600400	MIXTURE FOR CRACKS, JOINTS, AND	TON	57	57						
	FLANGEWAYS									
40600982	HOT-MIX ASPHALT SURFACE REMOVAL - BUTT	SQ YD	224	224						
	JOINT									
40603200	POLYMERIZED HOT-MIX ASPHALT BINDER	TON	1599	1599						
	COURSE, IL-4.75, N50									
40604062	HOT-MIX ASPHALT SURFACE COURSE, IL-9.5,	TON	3180	3180						
	MIX "D", N70									
42001300	PROTECTIVE COAT	SQ YD	28	28						
44000158	HOT-MIX ASPHALT SURFACE REMOVAL, 2	SQ YD	37853	37853						
	1/4"									
44201827	CLASS D PATCHES, TYPE II, 15 INCH	SQ YD	969	969						

SUMMARY OF QUANTITIES				TOTAL QUANTITIES	CONSTRUCTION TYPE CODE					
CODE NO	ITEM	UNIT	80% FEDERAL 20% STATE							
			0005							
44201831	CLASS D PATCHES, TYPE III, 15 INCH	SQ YD	582	582						
44201833	CLASS D PATCHES, TYPE IV, 15 INCH	SQ YD	388	388						
48102100	AGGREGATE WEDGE SHOULDER, TYPE B	TON	424	424						
48203029	HOT-MIX ASPHALT SHOULDERS, 8"	SQ YD	9529	9529						
★ 64200108	SHOULDER RUMBLE STRIPS, 8 INCH	FOOT	12268	12268						
★ 66900200	NON-SPECIAL WASTE DISPOSAL	CU YD	3370	3370						
★ 66900530	SOIL DISPOSAL ANALYSIS	EACH	5	5						
★ 66901001	REGULATED SUBSTANCES PRE-CONSTRUCTION	L SUM	1	1						
	PLAN									
★ 66901003	REGULATED SUBSTANCES FINAL CONSTRUCTION	L SUM	1	1						
	REPORT									
★ 66901005	ENGINEERED BARRIER	SQ YD	590	590						
★ 66901006	REGULATED SUBSTANCES MONITORING	CAL DA	15	15						
67100100	MOBILIZATION	L SUM	1	1						
70100450	TRAFFIC CONTROL AND PROTECTION,	L SUM	1	1						
	STANDARD 701201									
70100460	TRAFFIC CONTROL AND PROTECTION,	L SUM	1	1						
	STANDARD 701306									

STATE OF ILLINOIS DEPARTMENT OF TRANSPORTATION		SUMMARY OF QUANTITIES				FAP 400 (OLD SKOKIE RD.)--US 41 TO WISCONSIN STATE LINE		F.A.P. RTE.		SECTION		COUNTY	TOTAL SHEETS	SHEET NO.	
		SCALE: NONE		SHEET	OF	SHEETS	STA.	TO STA.		400	FAP 400 23 OVERLAY		LAKE	24	3
												CONTRACT NO. 62U91			
												ILLINOIS FED. AID PROJECT			

MODEL: Default
FILE: \\ntmfe-pro\lidesw-bentley.com\FW\DOT\Documents\DOT 0 cas\DistHt-1\ORD Projects\Old Skokie Rd\CADDData\CAD Sheets\04_Skokie Rd-sh-500.dgn

SUMMARY OF QUANTITIES				TOTAL QUANTITIES	CONSTRUCTION TYPE CODE					
CODE NO	ITEM	UNIT	80% FEDERAL 20% STATE							
			0005							
70102630	TRAFFIC CONTROL AND PROTECTION,	L SUM	1	1						
	STANDARD 701601									
70102635	TRAFFIC CONTROL AND PROTECTION,	L SUM	1	1						
	STANDARD 701701									
70102640	TRAFFIC CONTROL AND PROTECTION,	L SUM	1	1						
	STANDARD 701801									
70300100	SHORT TERM PAVEMENT MARKING	FOOT	3742	3742						
70300150	SHORT TERM PAVEMENT MARKING REMOVAL	SQ FT	623	623						
70300211	TEMPORARY PAVEMENT MARKING LETTERS AND	SQ FT	73	73						
	SYMBOLS - PAINT									
70300221	TEMPORARY PAVEMENT MARKING - LINE 4"-	FOOT	25773	25773						
	PAINT									
70300241	TEMPORARY PAVEMENT MARKING - LINE 6"-	FOOT	756	756						
	PAINT									
70300251	TEMPORARY PAVEMENT MARKING - LINE 8"-	FOOT	595	595						
	PAINT									
70300261	TEMPORARY PAVEMENT MARKING - LINE 12"-	FOOT	190	190						
	PAINT									
70300281	TEMPORARY PAVEMENT MARKING - LINE 24"-	FOOT	23	23						
	PAINT									

SUMMARY OF QUANTITIES				TOTAL QUANTITIES	CONSTRUCTION TYPE CODE					
CODE NO	ITEM	UNIT	80% FEDERAL 20% STATE							
			0005							
★ 78000100	THERMOPLASTIC PAVEMENT MARKING -	SQ FT	73	73						
	LETTERS AND SYMBOLS									
★ 78000200	THERMOPLASTIC PAVEMENT MARKING - LINE	FOOT	25773	25773						
	4"									
★ 78000400	THERMOPLASTIC PAVEMENT MARKING - LINE	FOOT	756	756						
	6"									
★ 78000500	THERMOPLASTIC PAVEMENT MARKING - LINE	FOOT	595	595						
	8"									
★ 78000600	THERMOPLASTIC PAVEMENT MARKING - LINE	FOOT	190	190						
	12"									
★ 78000650	THERMOPLASTIC PAVEMENT MARKING - LINE	FOOT	23	23						
	24"									
★ 78100100	RAISED REFLECTIVE PAVEMENT MARKER	EACH	537	537						
78300200	RAISED REFLECTIVE PAVEMENT MARKER	EACH	456	456						
	REMOVAL									
X2020110	GRADING AND SHAPING SHOULDERS	UNIT	106	106						
X4400501	COMBINATION CURB AND GUTTER REMOVAL AND	FOOT	144	144						
	REPLACEMENT LESS THAN OR EQUAL TO 10									
	FEET									
X6420114	CENTER LINE - RUMBLE STRIP - 16"	FOOT	2735	2735						

STATE OF ILLINOIS DEPARTMENT OF TRANSPORTATION		SUMMARY OF QUANTITIES				F.A.P. RTE.		SECTION		COUNTY	TOTAL SHEETS	SHEET NO.
		FAP 400 (OLD SKOKIE RD.)-US 41 TO WISCONSIN STATE LINE				400	FAP 400 23 OVERLAY		LAKE	24	4	
								CONTRACT NO. 62U91				
		SCALE: NONE		SHEET	OF	SHEETS	STA.	TO STA.		ILLINOIS		FED. AID PROJECT

MODEL Default
FILE Name: p:\111det-pw-bentley.com\PNW\DOT\Documents\DOT 0 - esp\District 1\ORD Projects\Old Skokie Rd\CADDData\CADsheets\Old Skokie Rd-shit-SQ.dgn

SUMMARY OF QUANTITIES			TOTAL QUANTITIES	CONSTRUCTION TYPE CODE					
CODE NO	ITEM	UNIT		80% FEDERAL 20% STATE					
				0005					
X6700407	ENGINEER'S FIELD OFFICE, TYPE A (D1)	CAL MO	12	12					
★X7800815	HOT SPRAY THERMOPLASTIC PAVEMENT	FOOT	5028	5028					
	MARKING LINE - 4 INCH								
Z0013798	CONSTRUCTION LAYOUT	L SUM	1	1					
Z0030850	TEMPORARY INFORMATION SIGNING	SQ FT	51.4	51.4					
60300305	FRAMES AND LIDS TO BE ADJUSTED	EACH	2	2					
63000001	STEEL PLATE BEAM GUARDRAIL TYPE A, 6 FOOT POST	FOOT	740	740					
63100167	TRAFFIC BARRIER TERMINAL, TYPE 1 (SPECIAL) TANGENT	EACH	2	2					
63200310	GUARDRAIL REMOVAL	FOOT	740	740					
72501000	TERMINAL MARKER - DIRECT APPLIED	EACH	2	2					
78200005	GUARDRAIL REFLECTORS, TYPE A	EACH	15	15					
Z0018600	DRAINAGE STRUCTURES TO BE RECONSTRUCTED	EACH	1	1					
70307120	TEMPORARY PAVEMENT MARKING - LINE 4" - TYPE IV TAPE	FOOT	1871	1871					
X5537800	STORM SEWERS TO BE CLEANED, 12"	FOOT	45	45					
Z0018500	DRAINAGE STRUCTURE TO BE CLEANED	EACH	3	3					

SUMMARY OF QUANTITIES			TOTAL QUANTITIES	CONSTRUCTION TYPE CODE					
CODE NO	ITEM	UNIT							

LEGEND:

- 1

EXISTING P.C.C. PAVEMENT, PLUS OR MINUS 9"
- 2

EXISTING HOT-MIX ASPHALT SURFACE, PLUS OR MINUS 6" (AFTER MILLING)
- 3

EXISTING COMBINATION CONCRETE CURB AND GUTTER
- 4

EXISTING LANDSCAPE MEDIAN
- 5

EXISTING AGGREGATE SHOULDER
- 6

EXISTING STABILIZED SUB-BASE
- 7

EXISTING GUARDRAIL
- 8

PROPOSED HOT-MIX ASPHALT SURFACE REMOVAL, 2 1/4"
- 9

PROPOSED POLYMERIZED HOT-MIX ASPHALT BINDER COURSE, IL-4.75, N50, 3/4"
- 10

PROPOSED HOT-MIX ASPHALT SURFACE COURSE, MIX 'D', IL-9.5, N70, 1 1/2"
- 11

PROPOSED EARTH EXCAVATION
- 12

PROPOSED SUBBASE GRANULAR MATERIAL, TYPE B, 4"
- 13

PROPOSED HOT-MIX ASPHALT SHOULDER, 8"
- 14

PROPOSED GRADING AND SHAPING SHOULDERS
- 15

PROPOSED AGGREGATE WEDGE SHOULDERS, TYPE B
- 16

PROPOSED SHOULDER RUMBLE STRIPS (8" WIDE)
- 17

PROPOSED CENTERLINE RUMBLE STRIPS (16" WIDE)
- 18

PROP. STEEL PLATE BEAM GUARDRAIL
- R

CURB AND GUTTER REMOVAL AND REPLACEMENT
(AS DIRECTED BY THE ENGINEER)

/// DENOTES ITEMS TO BE REMOVED

MIXTURE REQUIREMENTS

MIXTURE TYPE	AIR VOIDS @ Ndes	QMP
PATCHING		
CLASS "D" PATCHES (HMA BINDER, IL-19MM)	4% @ 70 GYR.	QC / QA
PAVEMENT RESURFACING (STANDARD OVERLAY)		
POLYMERIZED HOT-MIX ASPHALT BINDER COURSE, IL-4.75, N50, 3/4"	3.5% @ 50 GYR.	QCP
HOT-MIX ASPHALT SURFACE COURSE, MIX 'D', IL-9.5, N70, 1 1/2"	4% @ 70 GYR.	QCP
HOT-MIX ASPHALT SHOULDERS, 8"		
HOT-MIX ASPHALT BINDER COURSE, IL-19.0, N70, 6 1/2"	4% @ 70 GYR.	QC / QA
HOT-MIX ASPHALT SURFACE COURSE, MIX 'D', IL-9.5, N70, 1 1/2"	4% @ 70 GYR.	QC / QA
QMP DESIGNATION: QUALITY CONTROL FOR PERFORMANCE (QCP); QUALITY CONTROL / QUALITY ASSURANCE (QC / QA); PAY FOR PERFORMANCE (PFP)		

NOTES:

THE UNIT WEIGHT USED TO CALCULATE ALL HOT-MIX ASPHALT SURFACE QUANTITIES IS 112 LBS./SQ. YD./ IN.

THE "AC TYPE" FOR POLYMERIZED HMA MIXES SHALL BE "SBS/SBR PG 76 -22" AND FOR NON-POLYMERIZED HMA THE "AC TYPE" SHALL BE "PG 64 -22" UNLESS MODIFIED BY RECLAIMED MATERIAL SPECIFICATIONS.

THE MILLING SHALL BE DONE PRIOR TO PATCHING

THE LONGITUDINAL JOINT SEALANT SHALL BE PLACED OVER THE POLYMERIZED HOT-MIX ASPHALT BINDER COURSE, IL-4.75, N50.

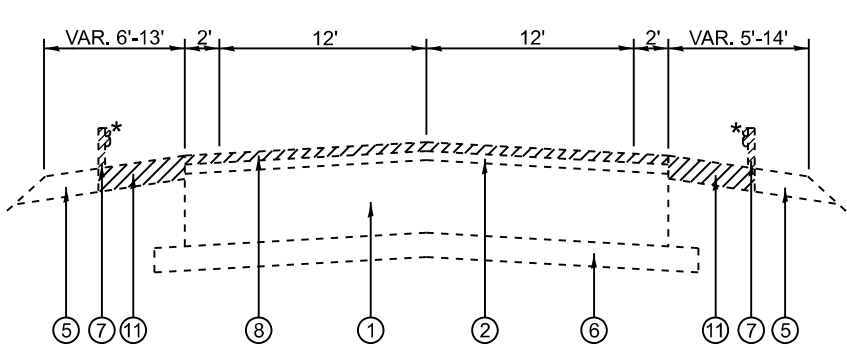

EXISTING TYPICAL SECTION
STA. 17+04 TO 52+79

NOTE:

★ EXISTING GUARDRAIL
NORTHBOUND
STA. 35+44 TO 39+56
SOUTHBOUND
STA. 36+09 TO 39+37

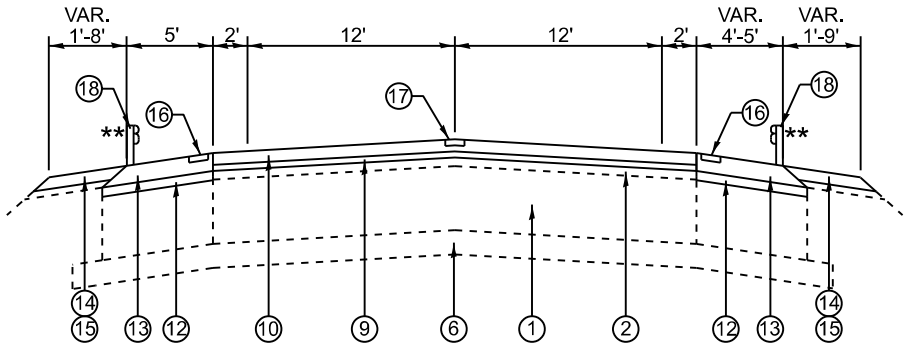

PROPOSED TYPICAL SECTION
STA. 17+04 TO 52+79

NOTE:

★★ PROPOSED GUARDRAIL
NORTHBOUND
STA. 35+44 TO 39+56
SOUTHBOUND
STA. 36+09 TO 39+37

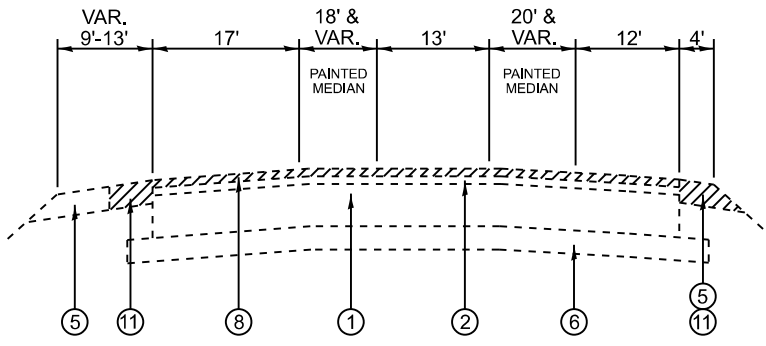

EXISTING TYPICAL SECTION
STA. 52+79 TO 54+10

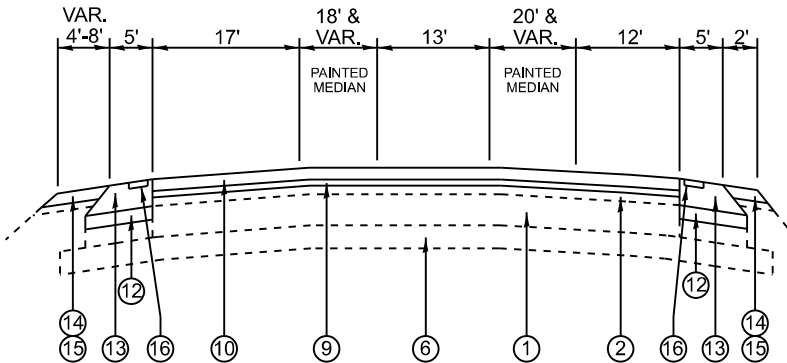

PROPOSED TYPICAL SECTION
STA. 52+79 TO 54+10

MODEL: Default
FILE NAME: c:\pwwork\pwwork\skokie\std\p0870428\Old Skokie Rd-sh-typical.dgn

	USER NAME = Phillip.Steed	DESIGNED -	REVISED -	STATE OF ILLINOIS DEPARTMENT OF TRANSPORTATION	EXISTING AND PROPOSED TYPICAL SECTIONS FAP 400 (OLD SKOKIE RD.)-US 41 TO WISCONSIN STATE LINE			F.A.P. RTE.	SECTION	COUNTY	TOTAL SHEETS	SHEET NO.
		DRAWN -	REVISED -					400	FAP 400 23 OVERLAY	LAKE	24	6
		CHECKED -	REVISED -					CONTRACT NO. 62U91				
	PLOT DATE = 1/23/2025	DATE -	REVISED -		SCALE:	SHEET	OF	SHEETS	STA.	TO STA.	ILLINOIS FED. AID PROJECT	

LEGEND:

- ① EXISTING P.C.C. PAVEMENT, PLUS OR MINUS 9"
- ② EXISTING HOT-MIX ASPHALT SURFACE, PLUS OR MINUS 6" (AFTER MILLING)
- ③ EXISTING COMBINATION CONCRETE CURB AND GUTTER
- ④ EXISTING LANDSCAPE MEDIAN
- ⑤ EXISTING AGGREGATE SHOULDER
- ⑥ EXISTING STABILIZED SUB-BASE
- ⑦ EXISTING GUARDRAIL
- ⑧ PROPOSED HOT-MIX ASPHALT SURFACE REMOVAL, 2 1/4"
- ⑨ PROPOSED POLYMERIZED HOT-MIX ASPHALT BINDER COURSE, IL-4.75, N50, 3/4"
- ⑩ PROPOSED HOT-MIX ASPHALT SURFACE COURSE, MIX 'D', IL-9.5, N70, 1 1/2"
- ⑪ PROPOSED EARTH EXCAVATION
- ⑫ PROPOSED SUBBASE GRANULAR MATERIAL, TYPE B, 4"
- ⑬ PROPOSED HOT-MIX ASPHALT SHOULDER, 8"
- ⑭ PROPOSED GRADING AND SHAPING SHOULDERS
- ⑮ PROPOSED AGGREGATE WEDGE SHOULDERS, TYPE B
- ⑯ PROPOSED SHOULDER RUMBLE STRIPS (8" WIDE)
- ⑰ PROPOSED CENTERLINE RUMBLE STRIPS (16" WIDE)
- ⑱ PROP. STEEL PLATE BEAM GUARDRAIL
- R CURB AND GUTTER REMOVAL AND REPLACEMENT (AS DIRECTED BY THE ENGINEER)

/// DENOTES ITEMS TO BE REMOVED

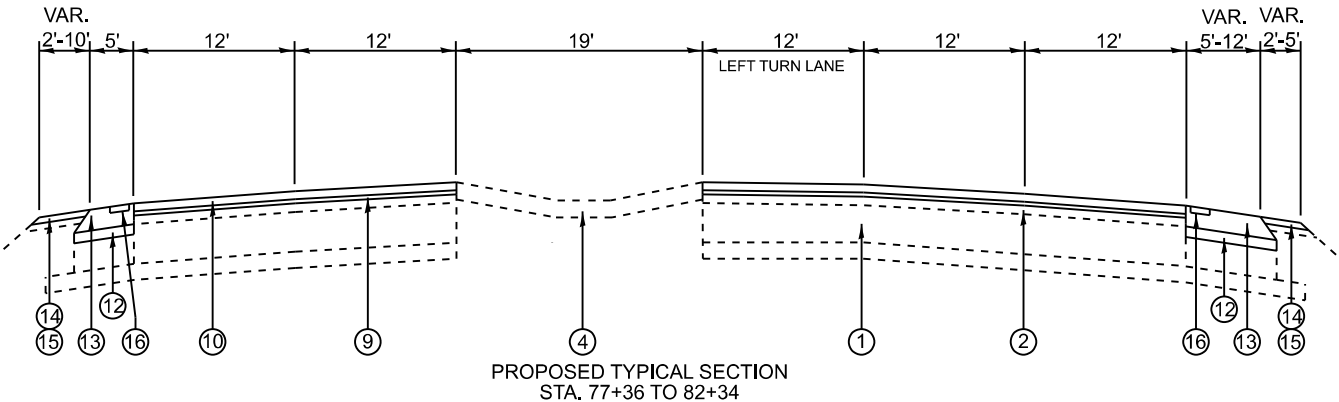
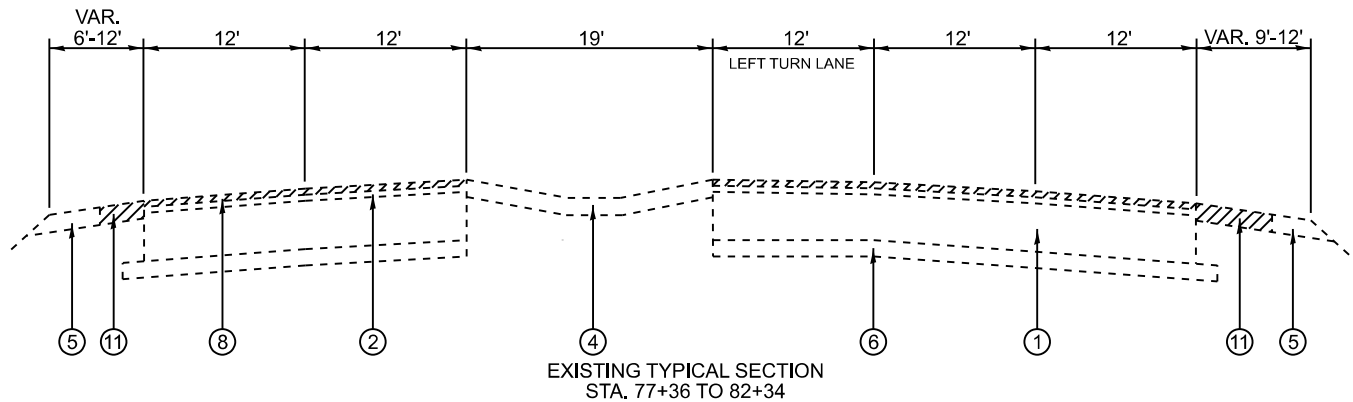
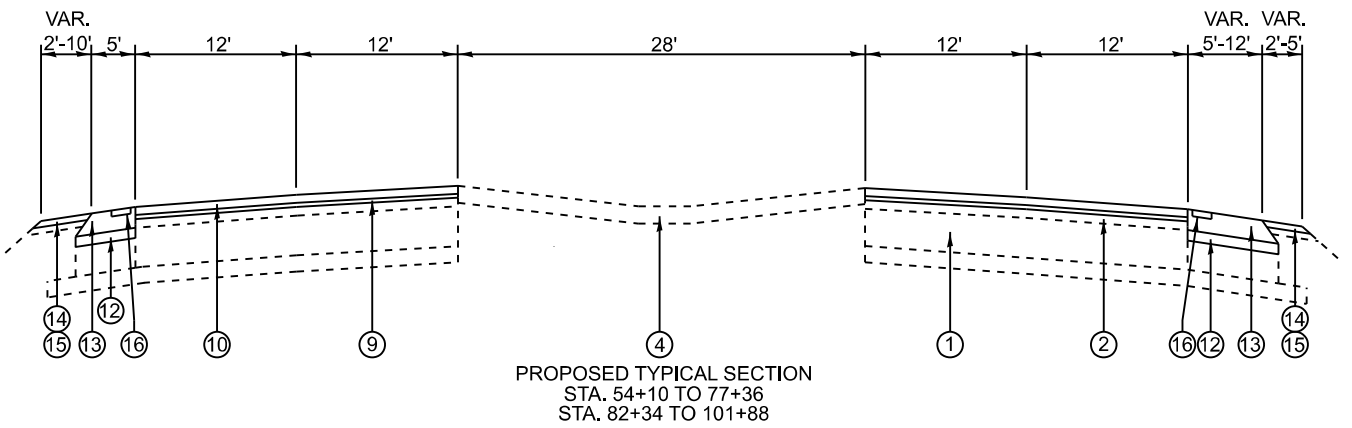
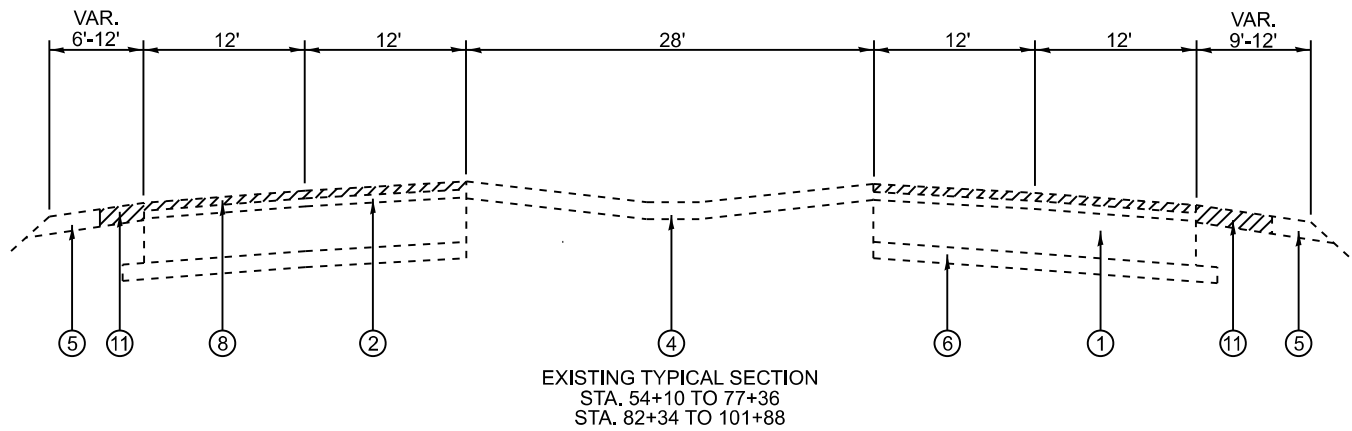

MODEL: Default
FILE NAME: c:\pwwork\pkw\oldsteed\pauld870428\Old Skokie Rd-eh-typical.dgn

	USER NAME = Phillip.Steed	DESIGNED -	REVISED -
		DRAWN -	REVISED -
		CHECKED -	REVISED -
	PLOT DATE = 1/23/2025	DATE -	REVISED -

STATE OF ILLINOIS
DEPARTMENT OF TRANSPORTATION

EXISTING AND PROPOSED TYPICAL SECTIONS
FAP 400 (OLD SKOKIE RD.)-US 41 TO WISCONSIN STATE LINE

SCALE: SHEET OF SHEETS STA. TO STA.

F.A.P. RTE.	SECTION	COUNTY	TOTAL SHEETS	SHEET NO.
400	FAP 400 23 OVERLAY	LAKE	24	7
CONTRACT NO. 62U91				
ILLINOIS FED. AID PROJECT				

MODEL: Old Skokie Rd - Rdwy/Pln01 (Sheet)
FILE NAME: c:\pwy_work\pwydot\std\pau0870428\Old Skokie Rd-sh-rplan.dgn

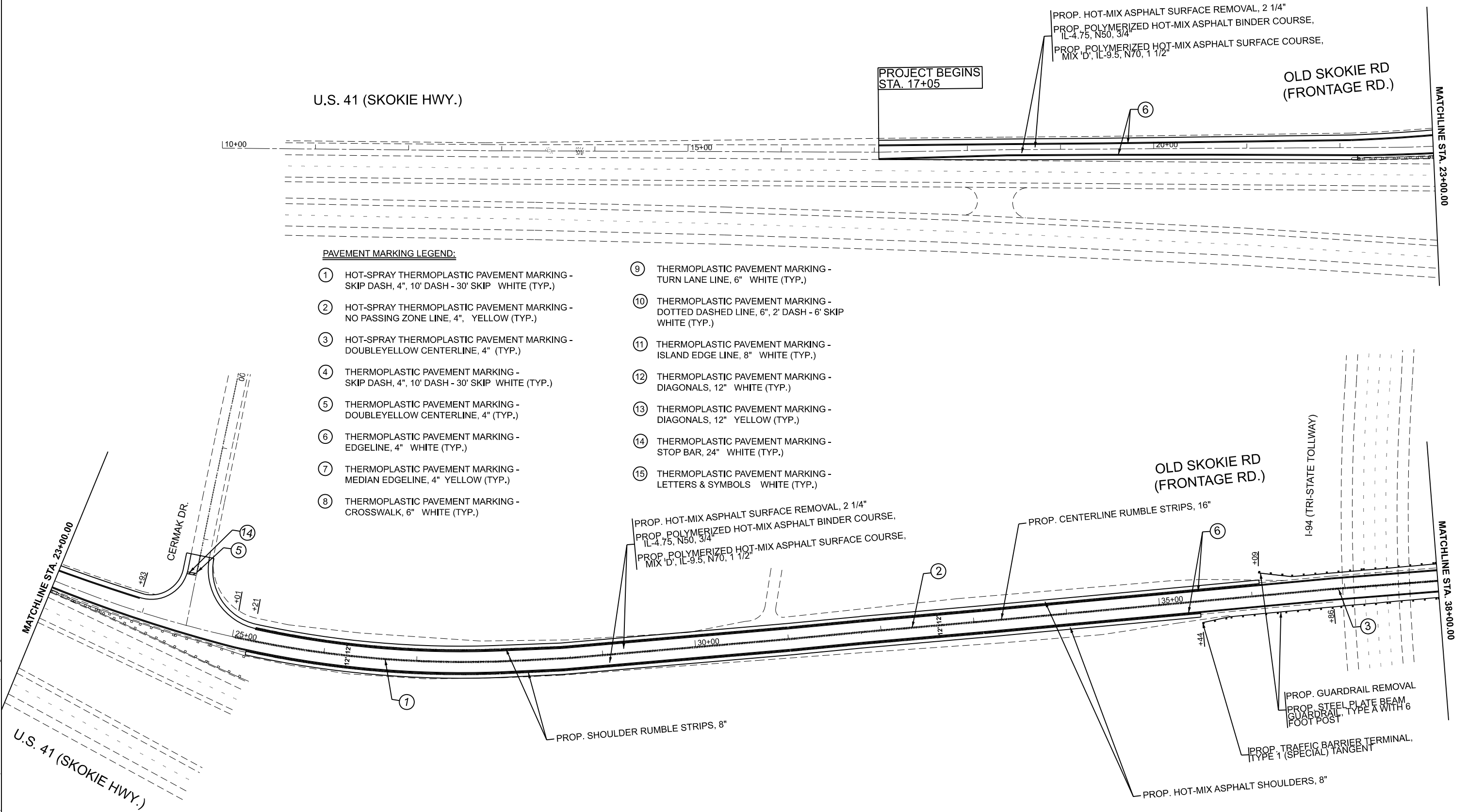

PAVEMENT MARKING LEGEND:

- | | | | |
|---|--|---|---|
| ① | HOT-SPRAY THERMOPLASTIC PAVEMENT MARKING - SKIP DASH, 4", 10' DASH - 30' SKIP WHITE (TYP.) | ⑨ | THERMOPLASTIC PAVEMENT MARKING - TURN LANE LINE, 6" WHITE (TYP.) |
| ② | HOT-SPRAY THERMOPLASTIC PAVEMENT MARKING - NO PASSING ZONE LINE, 4", YELLOW (TYP.) | ⑩ | THERMOPLASTIC PAVEMENT MARKING - DOTTED DASHED LINE, 6", 2' DASH - 6' SKIP WHITE (TYP.) |
| ③ | HOT-SPRAY THERMOPLASTIC PAVEMENT MARKING - DOUBLE YELLOW CENTERLINE, 4" (TYP.) | ⑪ | THERMOPLASTIC PAVEMENT MARKING - ISLAND EDGE LINE, 8" WHITE (TYP.) |
| ④ | THERMOPLASTIC PAVEMENT MARKING - SKIP DASH, 4", 10' DASH - 30' SKIP WHITE (TYP.) | ⑫ | THERMOPLASTIC PAVEMENT MARKING - DIAGONALS, 12" WHITE (TYP.) |
| ⑤ | THERMOPLASTIC PAVEMENT MARKING - DOUBLE YELLOW CENTERLINE, 4" (TYP.) | ⑬ | THERMOPLASTIC PAVEMENT MARKING - DIAGONALS, 12" YELLOW (TYP.) |
| ⑥ | THERMOPLASTIC PAVEMENT MARKING - EDGELINE, 4" WHITE (TYP.) | ⑭ | THERMOPLASTIC PAVEMENT MARKING - STOP BAR, 24" WHITE (TYP.) |
| ⑦ | THERMOPLASTIC PAVEMENT MARKING - MEDIAN EDGELINE, 4" YELLOW (TYP.) | ⑮ | THERMOPLASTIC PAVEMENT MARKING - LETTERS & SYMBOLS WHITE (TYP.) |
| ⑧ | THERMOPLASTIC PAVEMENT MARKING - CROSSWALK, 6" WHITE (TYP.) | | |

PROP. HOT-MIX ASPHALT SURFACE REMOVAL, 2 1/4"
PROP. POLYMERIZED HOT-MIX ASPHALT BINDER COURSE,
IL-4.75, N50, 3/4"
PROP. POLYMERIZED HOT-MIX ASPHALT SURFACE COURSE,
MIX 'D', IL-9.5, N70, 1 1/2"

PROP. HOT-MIX ASPHALT SURFACE REMOVAL, 2 1/4"
PROP. POLYMERIZED HOT-MIX ASPHALT BINDER COURSE,
IL-4.75, N50, 3/4"
PROP. POLYMERIZED HOT-MIX ASPHALT SURFACE COURSE,
MIX 'D', IL-9.5, N70, 1 1/2"

PROP. SHOULDER RUMBLE STRIPS, 8"

PROP. CENTERLINE RUMBLE STRIPS, 16"

PROP. GUARDRAIL REMOVAL
PROP. STEEL PLATE BEAM
GUARDRAIL, TYPE A WITH 6
FOOT POST

PROP. TRAFFIC BARRIER TERMINAL,
TYPE 1 (SPECIAL) TANGENT

PROP. HOT-MIX ASPHALT SHOULDERS, 8"

**STATE OF ILLINOIS
DEPARTMENT OF TRANSPORTATION**

**ROADWAY PLAN AND PAVEMENT MARKING PLANS
FAP 400 (OLD SKOKIE RD.)-US 41 TO WISCONSIN STATE LINE**

SCALE: SHEET 1 OF 4 SHEETS STA. TO STA.

F.A.P. RTE.	SECTION	COUNTY	TOTAL SHEETS	SHEET NO.
400	FAP 400 23 OVERLAY	LAKE	24	8
CONTRACT NO. 62U91				
ILLINOIS FED. AID PROJECT				

MODEL: Old Skokie Rd - Rdwy/Pln02 (Sheet)
FILE NAME: c:\pwy_work\pwydot\std\pauld870428\Old Skokie Rd-sh-std-plan.dgn

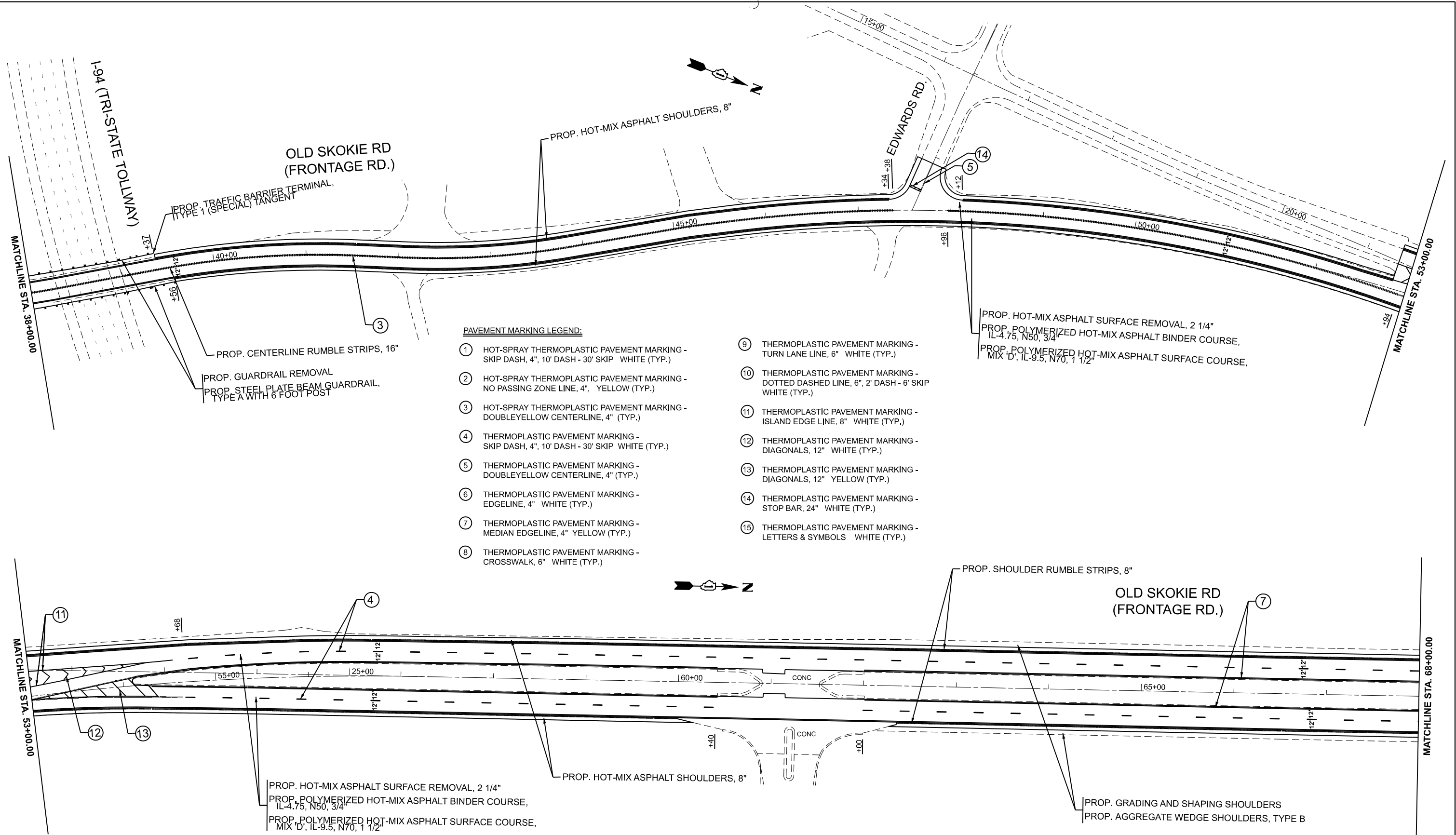

PLOT DATE	USER NAME	DESIGNED	REVISED
	= Phillip.Steed	-	-
		DRAWN	REVISED
		-	-
DATE		CHECKED	REVISED
		-	-
12/24/2024		DATE	REVISED
		-	-

STATE OF ILLINOIS
DEPARTMENT OF TRANSPORTATION

ROADWAY PLAN AND PAVEMENT MARKING PLANS
FAP 400 (OLD SKOKIE RD.)-US 41 TO WISCONSIN STATE LINE

SCALE: 1"=50' SHEET 2 OF 4 SHEETS STA. 38+00.00 TO STA. 68+00.00

F.A.P RTE.	SECTION	COUNTY	TOTAL SHEETS	SHEET NO.
400	FAP 400 23 OVERLAY	LAKE	24	9
CONTRACT NO. 62U91				
ILLINOIS FED. AID PROJECT				

MODEL: Old Skokie Rd - Rdwy/P/03 [Sheet]
FILE NAME: c:\pwy_work\pwy\old skokie\std\p03\0370428\Old Skokie Rd-sh-rplan.dgn

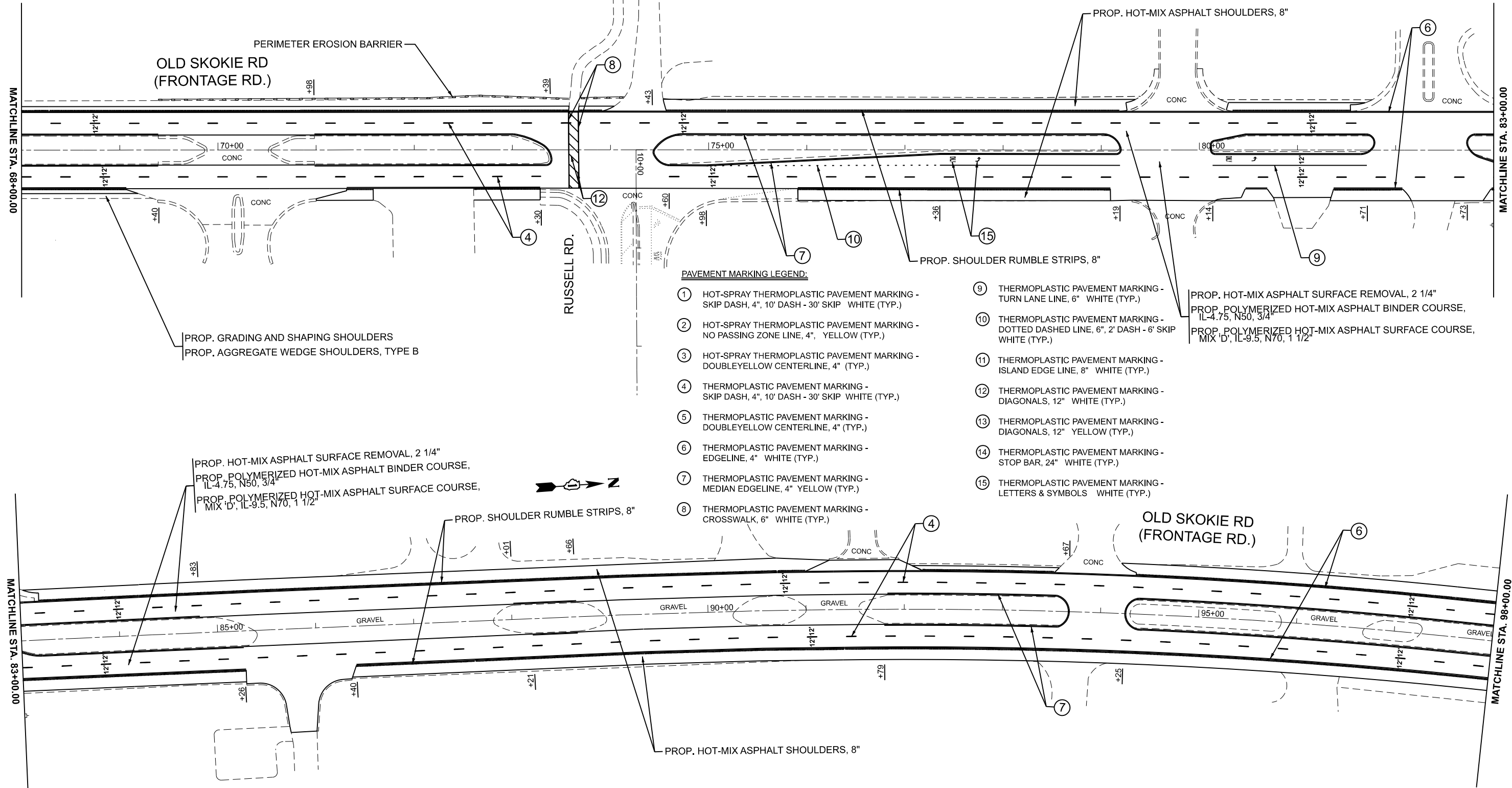

PLOT DATE	USER NAME	DESIGNED	REVISED
	= Phillip.Steed	-	-
		DRAWN	REVISED
		-	-
DATE	CHECKED	REVISED	
	-	-	
		REVISED	
		-	

STATE OF ILLINOIS
DEPARTMENT OF TRANSPORTATION

ROADWAY AND PAVEMENT MARKING PLAN
FAP 400 (OLD SKOKIE RD.)-US 41 TO WISCONSIN STATE LINE

SCALE: 1"=50' SHEET 3 OF 4 SHEETS STA. 68+00.00 TO STA. 98+00.00

F.A.P RTE.	SECTION	COUNTY	TOTAL SHEETS	SHEET NO.
400	FAP 400 23 OVERLAY	LAKE	24	10
CONTRACT NO. 62U91				
ILLINOIS FED. AID PROJECT				

MODEL: Old Skokie Rd - Rdwy/Pln04 (Sheet)
FILE NAME: c:\pwy_work\pwy\oldskokie\stead\pln04\Old Skokie Rd-sh-cplan.dgn

MATCHLINE STA. 113+00.00

MATCHLINE STA. 98+00.00

MATCHLINE STA. 113+00.00

128th ST.
(STATE LINE RD.)

OLD SKOKIE RD
(FRONTAGE RD.)

PROJECT ENDS
STA. 101+22

PROP. HOT-MIX ASPHALT
SHOULDERS, 8'

PROP. HOT-MIX ASPHALT SURFACE REMOVAL, 2 1/4"
PROP. POLYMERIZED HOT-MIX ASPHALT BINDER COURSE,
IL-4.75, N50, 3/4"
PROP. POLYMERIZED HOT-MIX ASPHALT SURFACE COURSE,
MIX 'D', IL-9.5, N70, 1 1/2"

PROP. SHOULDER RUMBLE STRIPS, 8"

ILLINOIS
WISCONSIN

PAVEMENT MARKING LEGEND:

- | | | | |
|---|---|---|---|
| ① | HOT-SPRAY THERMOPLASTIC PAVEMENT MARKING -
SKIP DASH, 4", 10' DASH - 30' SKIP WHITE (TYP.) | ⑨ | THERMOPLASTIC PAVEMENT MARKING -
TURN LANE LINE, 6" WHITE (TYP.) |
| ② | HOT-SPRAY THERMOPLASTIC PAVEMENT MARKING -
NO PASSING ZONE LINE, 4", YELLOW (TYP.) | ⑩ | THERMOPLASTIC PAVEMENT MARKING -
DOTTED DASHED LINE, 6", 2' DASH - 6' SKIP
WHITE (TYP.) |
| ③ | HOT-SPRAY THERMOPLASTIC PAVEMENT MARKING -
DOUBLEYELLOW CENTERLINE, 4" (TYP.) | ⑪ | THERMOPLASTIC PAVEMENT MARKING -
ISLAND EDGE LINE, 8" WHITE (TYP.) |
| ④ | THERMOPLASTIC PAVEMENT MARKING -
SKIP DASH, 4", 10' DASH - 30' SKIP WHITE (TYP.) | ⑫ | THERMOPLASTIC PAVEMENT MARKING -
DIAGONALS, 12" WHITE (TYP.) |
| ⑤ | THERMOPLASTIC PAVEMENT MARKING -
DOUBLEYELLOW CENTERLINE, 4" (TYP.) | ⑬ | THERMOPLASTIC PAVEMENT MARKING -
DIAGONALS, 12" YELLOW (TYP.) |
| ⑥ | THERMOPLASTIC PAVEMENT MARKING -
EDGE LINE, 4" WHITE (TYP.) | ⑭ | THERMOPLASTIC PAVEMENT MARKING -
STOP BAR, 24" WHITE (TYP.) |
| ⑦ | THERMOPLASTIC PAVEMENT MARKING -
MEDIAN EDGE LINE, 4" YELLOW (TYP.) | ⑮ | THERMOPLASTIC PAVEMENT MARKING -
LETTERS & SYMBOLS WHITE (TYP.) |
| ⑧ | THERMOPLASTIC PAVEMENT MARKING -
CROSSWALK, 6" WHITE (TYP.) | | |

STATE OF ILLINOIS
DEPARTMENT OF TRANSPORTATION

ROADWAY AND PAVEMENT MARKING PLAN
FAP 400 (OLD SKOKIE RD.)-US 41 TO WISCONSIN STATE LINE

SCALE: 1"=50' SHEET 4 OF 4 SHEETS STA. 98+00.00 TO STA. 128+00.00

F.A.P. RTE.	SECTION	COUNTY	TOTAL SHEETS	SHEET NO.
400	FAP 400 23 OVERLAY	LAKE	24	11
CONTRACT NO. 62U91				
ILLINOIS FED. AID PROJECT				

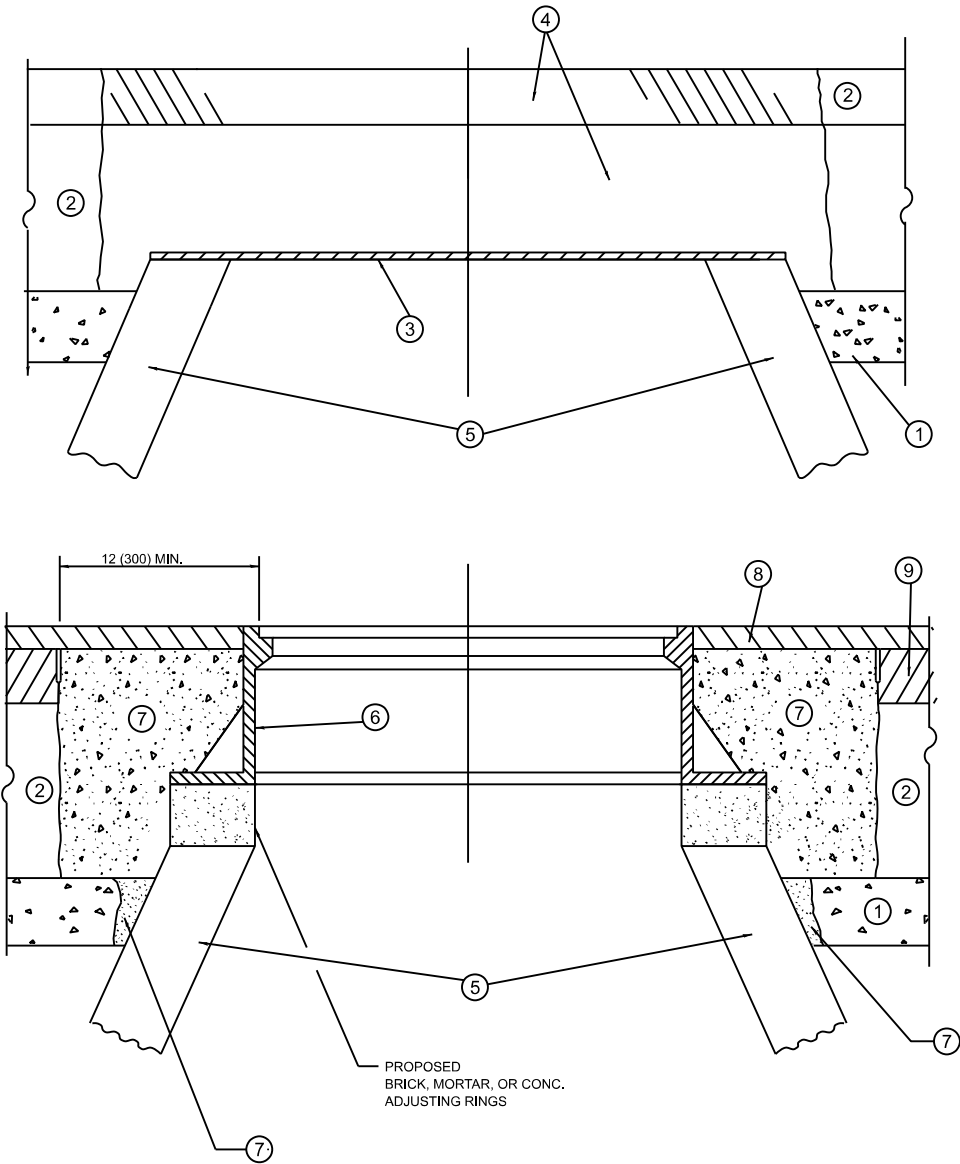

DETAILS FOR FRAMES AND LIDS ADJUSTMENT
WITH MILLING

NOTES

- EXISTING BROKEN FRAMES AND LIDS SHALL BE REMOVED AND DISPOSED OF BY THE CONTRACTOR AND SHALL BE REPLACED AS DIRECTED BY THE ENGINEER. REPLACEMENT FRAMES AND LIDS WILL BE PAID FOR IN ACCORDANCE WITH ARTICLE 109.04 OF THE STANDARD SPECIFICATIONS UNLESS A SEPARATE PAY ITEM HAS BEEN PROVIDED.
- IF THE EXISTING LIDS ARE OPEN, THE FRAME WILL BE ADJUSTED TO THE ELEVATION OF THE MILLED PAVEMENT SURFACE PRIOR TO THE MILLING OPERATION. THE FRAME WILL NOT BE REMOVED AND COVERED BY THE METAL PLATE.
- CITY OF CHICAGO CASTINGS ARE THE PROPERTY OF THE CITY AND THE CONTRACTOR SHALL NOTIFY THE CITY FOR REMOVAL AND DISPOSITION OF THE CASTINGS.
- THE METAL PLATE USED TO COVER THE STRUCTURE SHALL REMAIN THE PROPERTY OF THE CONTRACTOR.
- THE CONTRACTOR SHALL REMOVE ALL TRAFFIC CONTROL DEVICES BY THE END OF EACH WORK SHIFT.

CONSTRUCTION PROCEDURES

- STAGE 1 (BEFORE PAVEMENT MILLING)**
- REMOVE A MINIMUM OF 12 (300) OF THE PAVEMENT FROM AROUND THE STRUCTURE.
 - REMOVE THE EXISTING FRAME AND LID FROM THE STRUCTURE.
 - COVER THE STRUCTURE OPENING WITH A 36 (900) DIAMETER METAL PLATE.
 - BACKFILL WITH CRUSHED STONE AND HMA SURFACE MIX APPROVED BY THE ENGINEER. (MIN. 3 (80) HMA TO REMAIN AFTER MILLING).

- STAGE 2 (AFTER PAVEMENT MILLING)**
- REMOVE THE HMA SURFACE MIX AND CRUSHED STONE.
 - INSTALL THE FRAME AND LID; ADJUST THE FRAME TO ITS FINAL SURFACE ELEVATION.
 - THE SURROUNDING SPACE SHALL BE FILLED WITH CLASS PP-2* CONCRETE TO THE ELEVATION OF THE SURFACE OF THE EXISTING BASE COURSE OR THE BINDER COURSE.

*UNLESS OTHERWISE SPECIFIED IN THE PLANS.

THE PROCEDURE EXPLAINED ABOVE SHALL CONFORM TO THE APPLICABLE PORTIONS OF SECTIONS 353, 406, 602, AND 603 OF THE STANDARD SPECIFICATIONS EXCEPT THAT "THE CONTRACTOR SHALL ADJUST THE STRUCTURES TO THE FINISHED PAVEMENT ELEVATION NO MORE THAN 5 CALENDAR DAYS PRIOR TO PLACEMENT OF THE FINAL LIFT OF SURFACE UNLESS APPROVED BY THE ENGINEER."

LEGEND

- | | |
|--|-------------------------------|
| ① SUB-BASE GRANULAR MATERIAL | ⑥ FRAME AND LID (SEE NOTES) |
| ② EXISTING PAVEMENT | ⑦ CLASS PP-2* CONCRETE |
| ③ 36 (900) DIAMETER METAL PLATE | ⑧ PROPOSED HMA SURFACE COURSE |
| ④ PROPOSED CRUSHED STONE AND HMA SURFACE MIX | ⑨ PROPOSED HMA BINDER COURSE |
| ⑤ EXISTING STRUCTURE | |

LOCATION OF STRUCTURES

THE CONTRACTOR WILL BE REQUIRED TO KEEP A RECORD OF THE LOCATIONS OF THE BURIED STRUCTURES ACCORDING TO THE STATION AND DISTANCE LEFT OR RIGHT OF THE CENTERLINE OF PAVEMENT. UPON COMPLETION OF THE WORK, THE CONTRACTOR WILL DELIVER THE RECORD TO THE ENGINEER.

BASIS OF PAYMENT

- REMOVING FRAMES AND LIDS ON DRAINAGE AND UTILITY STRUCTURES IN THE PAVEMENT PRIOR TO MILLING, AND ADJUSTING TO FINAL GRADE PRIOR TO PLACING THE SURFACE COURSE, WILL BE PAID FOR AT THE CONTRACT UNIT PRICE EACH FOR "FRAMES AND LIDS TO BE ADJUSTED (SPECIAL)."
- THIS WORK WILL NOT BE PAID FOR WHEN DRAINAGE AND UTILITY STRUCTURES ARE SPECIFIED FOR PAYMENT AS STRUCTURE RECONSTRUCTION.
- NEW FRAMES AND LIDS, WHEN SPECIFIED, WILL BE PAID FOR SEPARATELY.
- WHEN STRUCTURES ARE TO BE ADJUSTED OR RECONSTRUCTED, THE LOWERING AND RAISING OF THE FRAMES AND LIDS WILL NOT BE PAID FOR SEPARATELY BUT WILL BE INCLUDED IN THE COST OF THE CORRESPONDING PAY ITEM.

ALL DIMENSIONS ARE IN INCHES (MILLIMETERS) UNLESS OTHERWISE SHOWN

STATE OF ILLINOIS
DEPARTMENT OF TRANSPORTATION

DETAIL FOR
FRAMES AND LIDS ADJUSTMENT WITH MILLING

SCALE: NONE SHEET 1 OF 1 SHEETS STA. TO STA.

F.A.P. RTE.	SECTION	COUNTY	TOTAL SHEETS	SHEET NO.
400	FAP 400 23 OVERLAY	LAKE	24	12
BD600-03 (BD-08)		CONTRACT NO. 62U91		
		ILLINOIS	FED. AID PROJECT	

METHOD OF MEASUREMENT

REFER TO SECTION 442 OF THE STANDARD SPECIFICATIONS FOR ROAD AND BRIDGE CONSTRUCTION AND THE RECURRING SPECIAL PROVISION "PATCHING WITH HOT-MIX ASPHALT OVERLAY REMOVAL."

BASIS OF PAYMENT

- 1. REFER TO SECTION 442 OF THE STANDARD SPECIFICATIONS FOR ROAD AND BRIDGE CONSTRUCTION AND THE RECURRING SPECIAL PROVISION "PATCHING WITH HOT-MIX ASPHALT OVERLAY REMOVAL."
- 2. SAW CUT/SCORING OF EXISTING HMA OVERLAY IS INCLUDED IN THE COST OF PAVEMENT PATCHING.
- 3. SAW CUT/SCORING OF EXISTING PAVEMENT IS INCLUDED IN THE COST OF PAVEMENT PATCHING.

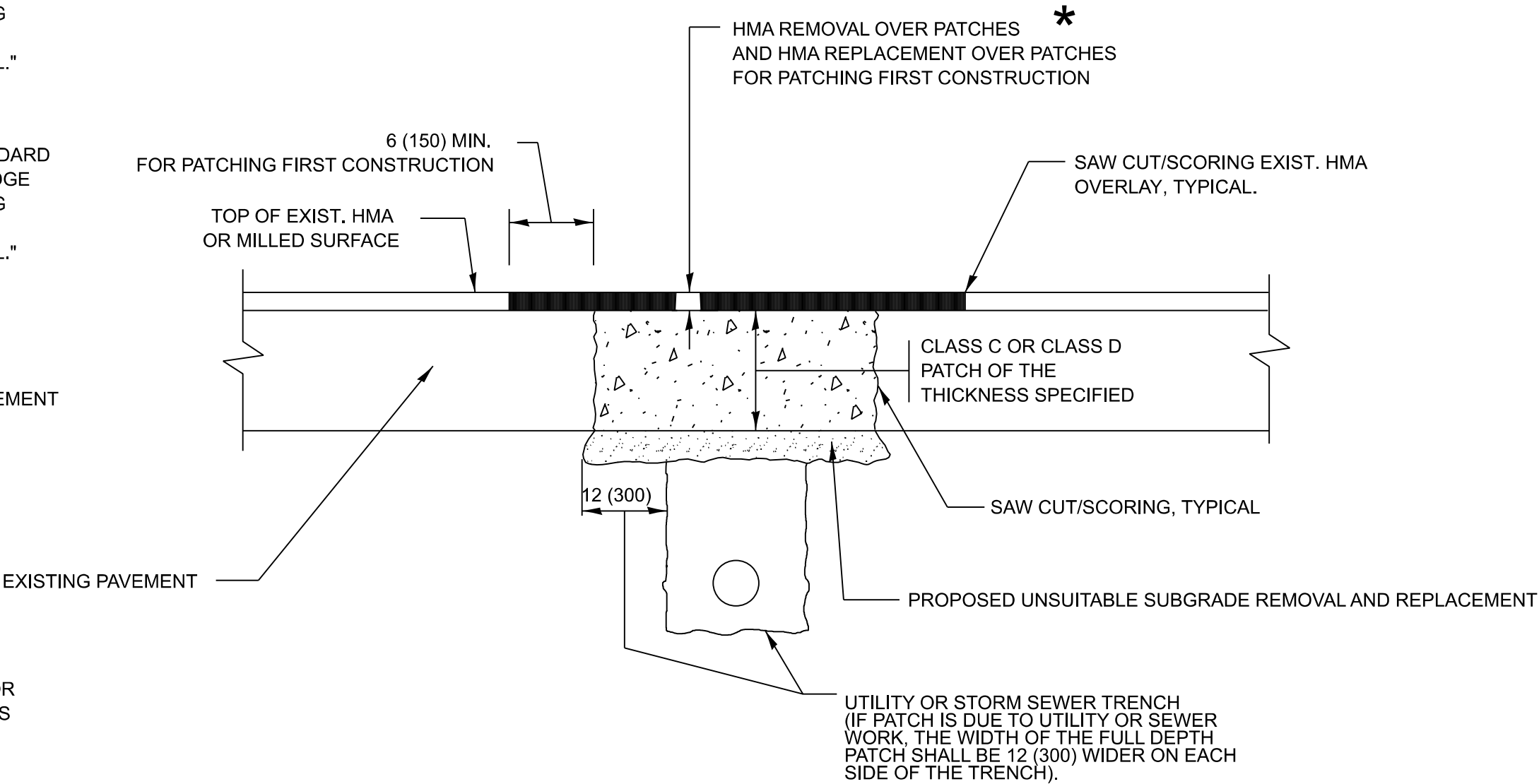

* SEE TYPICAL SECTIONS FOR THICKNESS AND MATERIALS

SEQUENCE OF CONSTRUCTION (PATCHING FIRST)

- 1. REMOVE THE EXISTING HMA MATERIAL OVER THE AREA TO BE PATCHED.
- 2. REMOVE AND REPLACE WITH CLASS C OR D PATCH.
- 3. REPLACE HMA MATERIAL OVER THE AREA TO BE PATCHED.

SEQUENCE OF CONSTRUCTION (MILLING FIRST)

- 1. MILL HMA FIRST IF THERE IS AT LEAST 4 1/2 INCHES OR MORE OF HMA MATERIAL ON TOP OF THE EXISTING PAVEMENT OR IF THE PAVEMENT IS FULL DEPTH HMA. A MINIMUM OF 2 INCHES OF HMA MATERIAL SHALL BE IN PLACE AFTER MILLING.
- 2. REMOVE AND REPLACE WITH FULL DEPTH CLASS D PATCHES TO TOP OF MILLED SURFACE.

ALL DIMENSIONS ARE IN INCHES (MILLIMETERS) UNLESS OTHERWISE SHOWN.

MODEL: Default
FILE NAME: p:\projects\sw_bentley.com\FW\DOT\Documents\DOT 0 cas\District 1\ORD Projects\Ord Skokie Rd\CADDData\CAD\Sheets\04 Skokie Rd-sh-04a50a.dgn

	USER NAME = Phillip,Steed	DESIGNED - R. SHAH	REVISED - R. BORO 01-01-07	STATE OF ILLINOIS DEPARTMENT OF TRANSPORTATION	PAVEMENT PATCHING FOR HMA SURFACED PAVEMENT	F.A.P. RTE.	SECTION	COUNTY	TOTAL SHEETS	SHEET NO.
		DRAWN -	REVISED - R. BORO 09-04-07			400	FAP 400 23 OVERLAY	LAKE	24	13
	PLOT SCALE = \$SCALE\$	CHECKED -	REVISED - K. ENG 10-27-08			BD400-04 (BD-22)		CONTRACT NO. 62U91		
	PLOT DATE = 12/4/2024	DATE - 10-25-94	REVISED - K. SMITH 11-18-22			ILLINOIS	FED. AID PROJECT			
					SCALE: NONE	SHEET 1 OF 1 SHEETS	STA.	TO STA.		

MODEL: Default
FILE NAME: p:\work\aw-bentley.com\FWIDOT\Documents\DOT 0 ces\DistHt 1\ORD Projects\Old Skokie Rd\CADDData\CAD\Sheets\Old Skokie Rd-sh-Hd-Stds.dgn

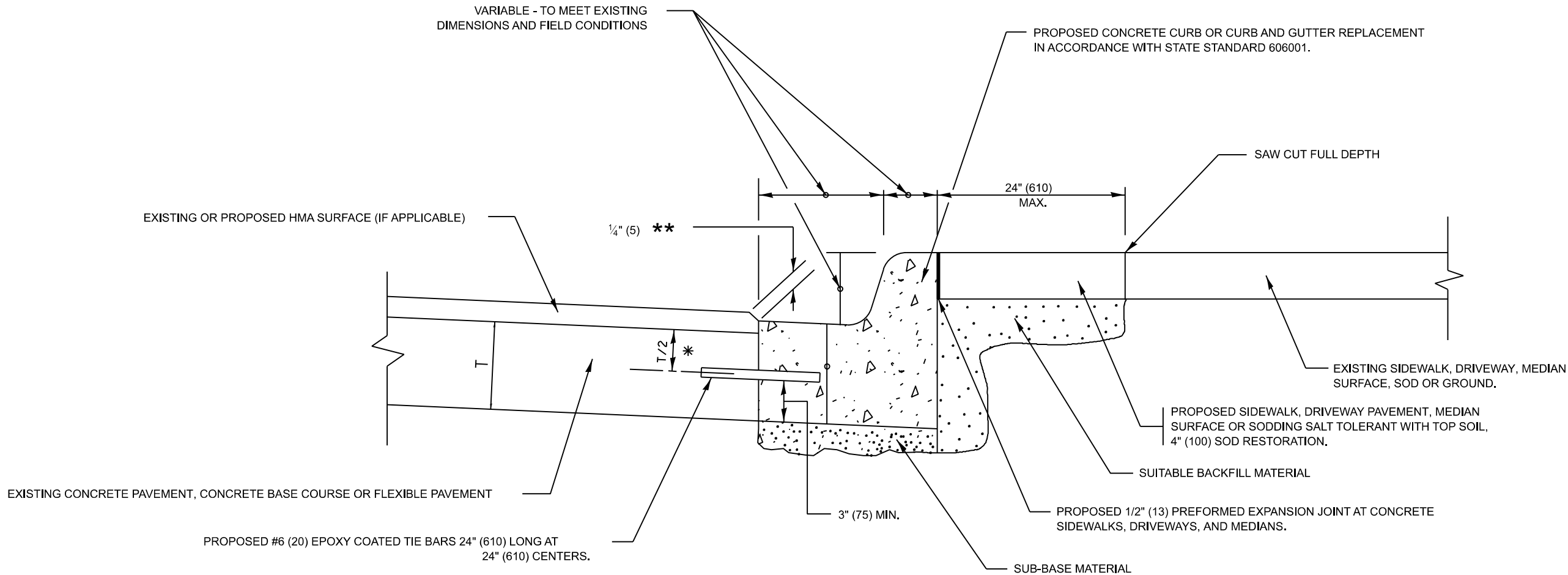

* 3" (75) MINIMUM FROM TOP AND BOTTOM OF THE CONCRETE PAVEMENT OR BASE COURSE.

** IF THE FINAL SURFACE OF THE PAVEMENT IS CONCRETE, THE GUTTER IS TO BE FLUSH WITH THE PAVEMENT.

CURB OR CURB AND GUTTER REMOVAL AND REPLACEMENT

ALL DIMENSIONS ARE IN INCHES (MILLIMETERS)
UNLESS OTHERWISE SHOWN.

	USER NAME = Phillip,Steed	DESIGNED - A. HOUSEH	REVISED - A. ABBAS 03-21-97	STATE OF ILLINOIS DEPARTMENT OF TRANSPORTATION	CURB OR CURB AND GUTTER REMOVAL AND REPLACEMENT	F.A.P. RTE.		SECTION	COUNTY	TOTAL SHEETS	SHEET NO.
		DRAWN -	REVISED - M. GOMEZ 01-22-01			400	FAP 400 23 OVERLAY	LAKE	24	14	
	PLOT SCALE = \$SCALE\$	CHECKED -	REVISED - R. BORO 12-15-09			BD600-06 (BD-24)		CONTRACT NO. 62U91			
	PLOT DATE = 12/4/2024	DATE - 03-11-94	REVISED - K. SMITH 07-11-19			SCALE: NONE	SHEET 1 OF 1 SHEETS	STA.	TO STA.	ILLINOIS	FED. AID PROJECT

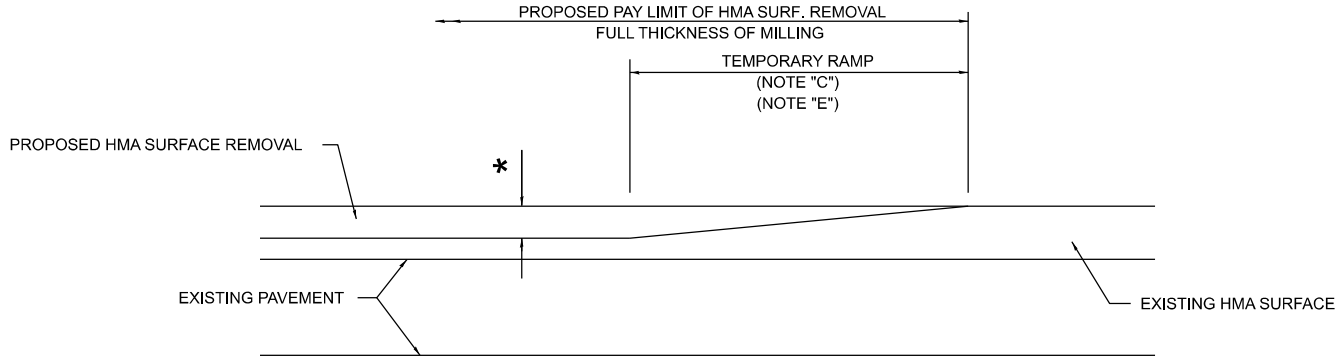

MILLED TEMPORARY RAMP

(FOR BUTT JOINT AND HMA TAPER SEE DETAIL BELOW)

OPTION 1

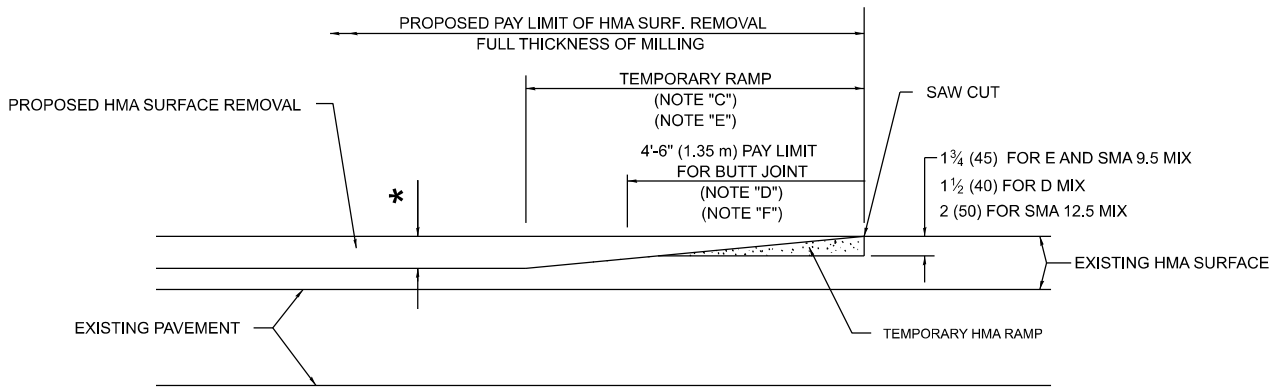

HMA CONSTRUCTED TEMPORARY RAMP

(FOR BUTT JOINT AND HMA TAPER SEE DETAIL BELOW)

OPTION 2

TYPICAL TEMPORARY RAMP

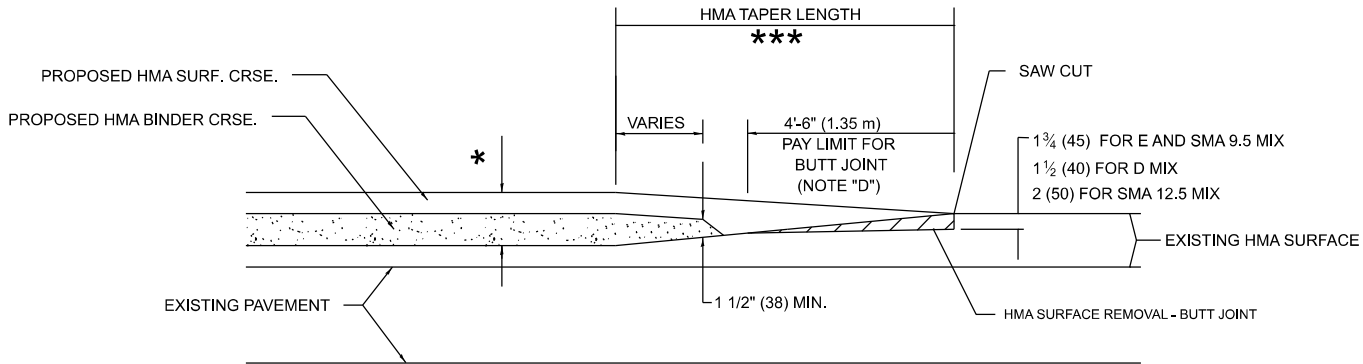

**BUTT JOINT AND
HMA TAPER**

**TYPICAL BUTT JOINT AND HMA TAPER
FOR MILLING AND RESURFACING**

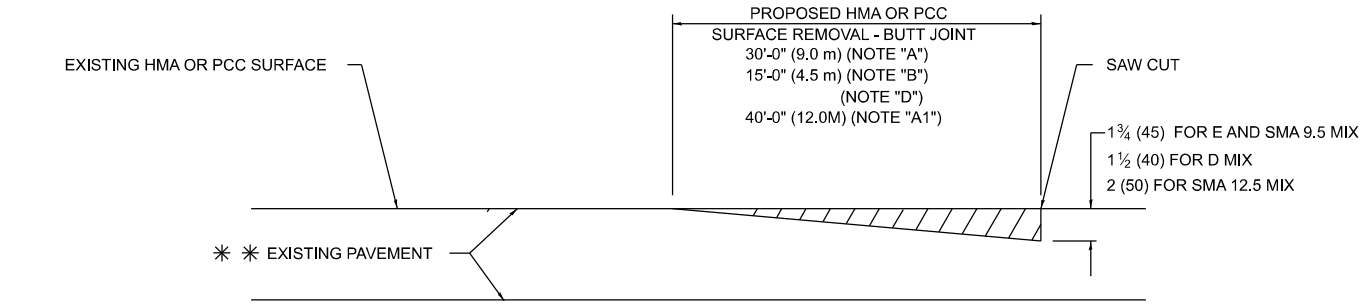

BUTT JOINT DETAIL

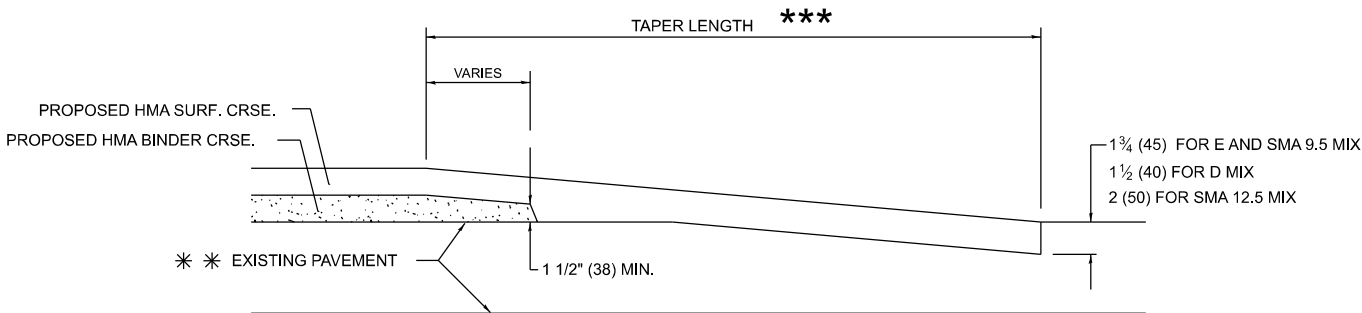

HMA TAPER DETAIL

**TYPICAL BUTT JOINT AND HMA TAPER
FOR RESURFACING ONLY**

PC CONCRETE, HMA OR HMA RESURFACED PAVEMENT.

GENERAL NOTES

- A. MAINLINE ARTERIAL ROADWAYS AND MAJOR SIDE ROADS.
- A1. INTERSTATES
- B. MINOR SIDE ROADS.
- C. THE TEMP. RAMP SHALL BE CONSTRUCTED IMMEDIATELY UPON REMOVAL OF THE EXISTING HMA SURFACE.
- D. THE BUTT JOINT SHALL BE CONSTRUCTED IMMEDIATELY PRIOR TO PLACING THE PROPOSED HMA COURSES.
- E. TAPER THE TEMP. RAMP AT A RATE OF 3' - 4" (1.02m) PER 1 INCH (25 mm) OF MILLING THICKNESS.
* SEE TYPICAL SECTIONS FOR MILLING THICKNESS.
- F. SEE ARTICLE 406.08 AND 406.14 OF THE STANDARD SPECIFICATIONS FOR "HMA AND/OR PCC SURFACE REMOVAL, BUTT JOINT".
*** 20'-0" (6.1 m) PER 1 (25) RESURFACING (NOTE "A")
10'-0" (3.0 m) PER 1 (25) RESURFACING (NOTE "B")

BASIS OF PAYMENT

1. THE BUTT JOINT WILL BE PAID FOR AT THE CONTRACT UNIT PRICE PER SQUARE YARD (SQUARE METER) FOR "HOT-MIX ASPHALT SURFACE REMOVAL - BUTT JOINT" OR FOR "PORTLAND CEMENT CONCRETE SURFACE REMOVAL- BUTT JOINT".
2. THE TEMPORARY RAMP AND SAW CUT SHALL BE INCLUDED IN THE UNIT COST FOR HMA OR PCC SURFACE REMOVAL-BUTT JOINT.

ALL DIMENSIONS ARE IN INCHES (MILLIMETERS) UNLESS OTHERWISE SHOWN.

**STATE OF ILLINOIS
DEPARTMENT OF TRANSPORTATION**

**BUTT JOINT AND
HMA TAPER DETAILS**

SCALE: NONE SHEET 1 OF 1 SHEETS STA. TO STA.

F.A.P. RTE.	SECTION	COUNTY	TOTAL SHEETS	SHEET NO.
400	FAP 400 23 OVERLAY	LAKE	24	15
BD400-05 BD-32		CONTRACT NO. 62U91		
		ILLINOIS	FED. AID PROJECT	

MODEL: Default
FILE NAME: p:\p\l\dot-s\w\entley.com\FW\DOT\Documents\DOT 0 ces\Distric1_1\ORD Projects\041 Skokie Rd\CADDData\CAD\Sheets\041 Skokie Rd-sh-041-Stds.dgn

Model: Default
File Name: p:\work\etw\entley.com\RWIDOT\Documents\DOT 0 cas\DistHt 1\ORO Projects\Old Skokie Rd\CADDData\CAD\heets\04 Skokie Rd-sh-04a55.dgn

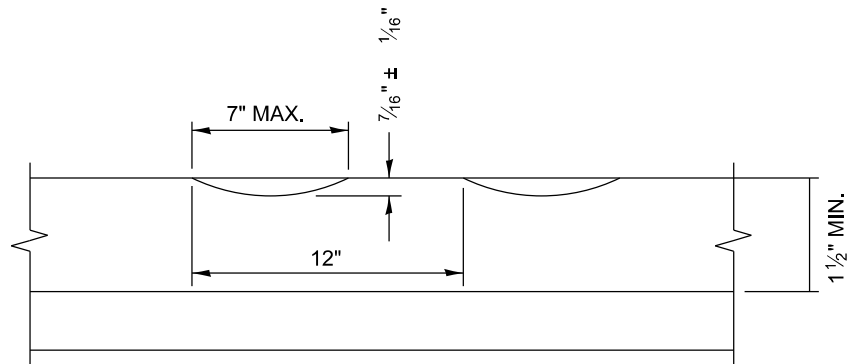

SECTION A-A

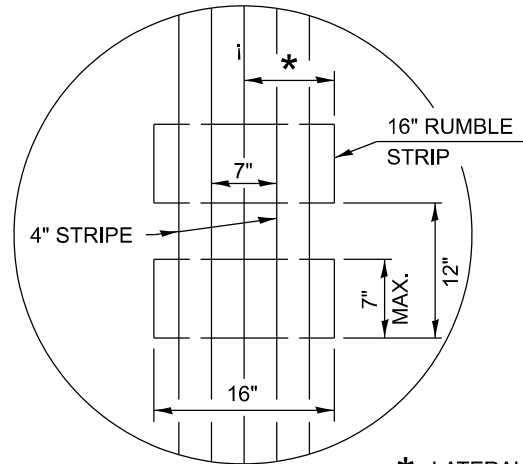

* LATERAL DEVIATION SHALL NOT EXCEED ONE INCH IN 100 FEET.

DETAIL B

GENERAL NOTES

- CENTERLINE RUMBLE STRIPS SHALL BE CONSTRUCTED ACCORDING TO SECTION 642 ALONG THE CENTERLINE OF PAVEMENT.
- SEE STANDARD 780001 FOR OTHER STRIPING LAYOUTS.
- RUMBLE STRIPS SHALL NOT BE PLACED ON BRIDGES.
- ALL RUMBLE STRIPS SHALL BE MILLED.
- CENTERLINE RUMBLE STRIPS SHALL BE CONTINUOUS THROUGH CONNECTIONS OF SIDEROADS WITH NO LEFT TURN LANES.
- DISCONTINUE CENTERLINE RUMBLE STRIPS THROUGH THE LIMITS OF ALL LEFT TURN LANES, INCLUDING ANY LANE TAPER SECTIONS.
- AFTER RUMBLE STRIPS ARE INSTALLED, THE PAVEMENT SURFACE SHALL BE SWEEPED CLEAN PRIOR TO THE PLACEMENT OF THE NEW PAVEMENT MARKINGS.
- WHERE USED, ADJUST SPACING OF RAISED REFLECTIVE PAVEMENT MARKERS TO FALL IN WIDER GAP BETWEEN RUMBLE STRIPS.

BASIS OF PAYMENT

- THIS WORK WILL BE PAID FOR AT THE CONTRACT UNIT PRICE PER FOOT FOR CENTERLINE-RUMBLE STRIP OF THE WIDTH SPECIFIED.
- HOT-SPRAY THERMOPLASTIC PAVEMENT MARKING WILL BE USED OVER THE RUMBLE STRIPS, AND WILL BE PAID FOR SEPARATELY.

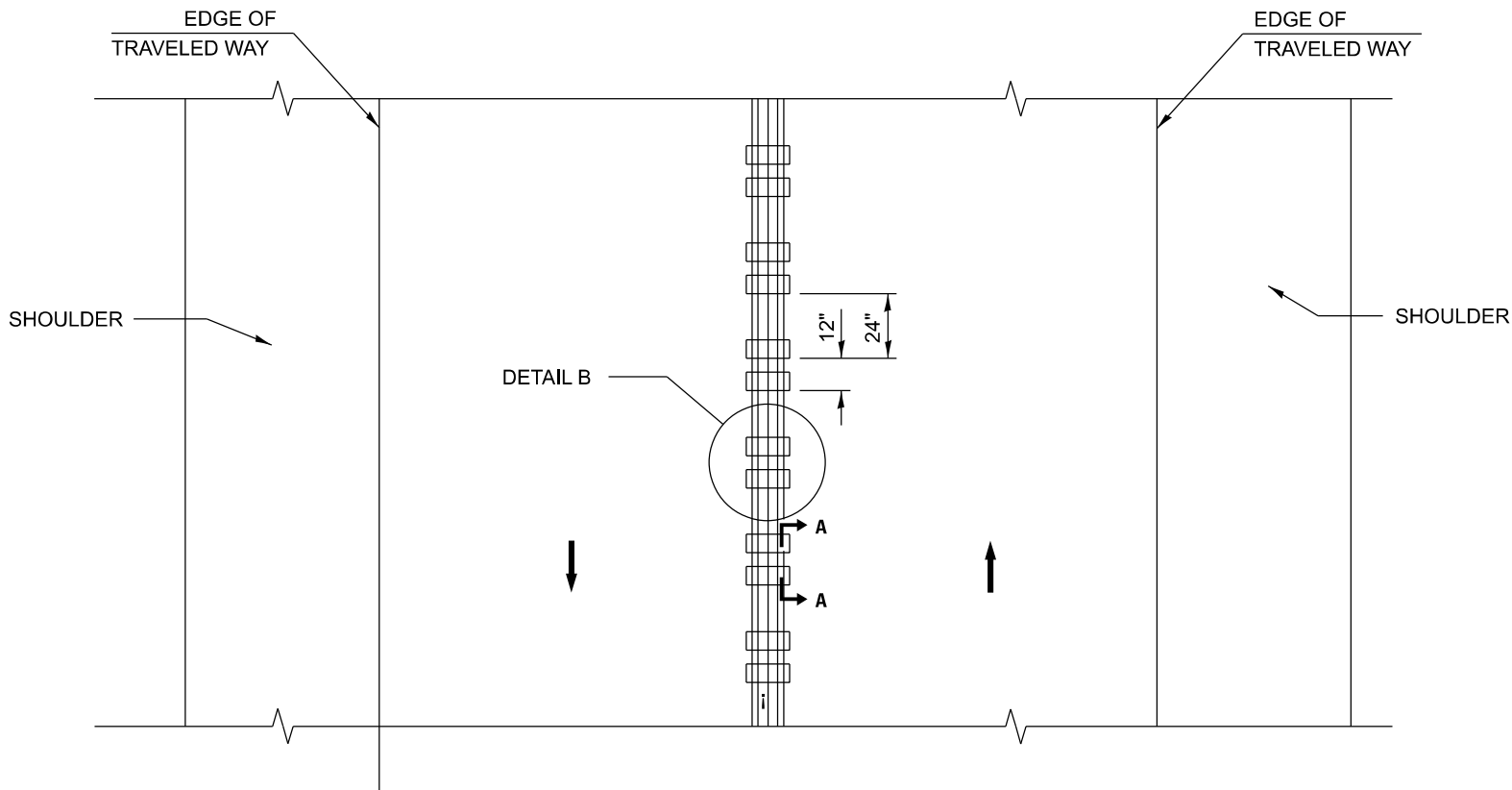

TWO-WAY ROAD

USER NAME = Phillip.Steed	DESIGNED - R. BORO	REVISED - K. SMITH 11-18-22
	DRAWN -	REVISED -
PLOT SCALE = \$SCALE\$	CHECKED -	REVISED -
PLOT DATE = 12/4/2024	DATE - 08-06-2012	REVISED -

STATE OF ILLINOIS
DEPARTMENT OF TRANSPORTATION

RUMBLE STRIPS FOR CENTERLINE, NON-FREEWAY

SCALE: NONE SHEET 1 OF 1 SHEETS STA. TO STA.

F.A.P. RTE.	SECTION	COUNTY	TOTAL SHEETS	SHEET NO.
400	FAP 400 23 OVERLAY	LAKE	24	16
BD-55		CONTRACT NO. 62U91		
ILLINOIS		FED. AID PROJECT		

Model: Default
File Name: p:\11dlet-aw.bentley.com\FW\DOT\Documents\DOT 0 cas\Dist41_1\ORD Projects\041 Skokie Rd\CADDData\CAD\Drawings\041 Skokie Rd-sh-041-Stds.dgn

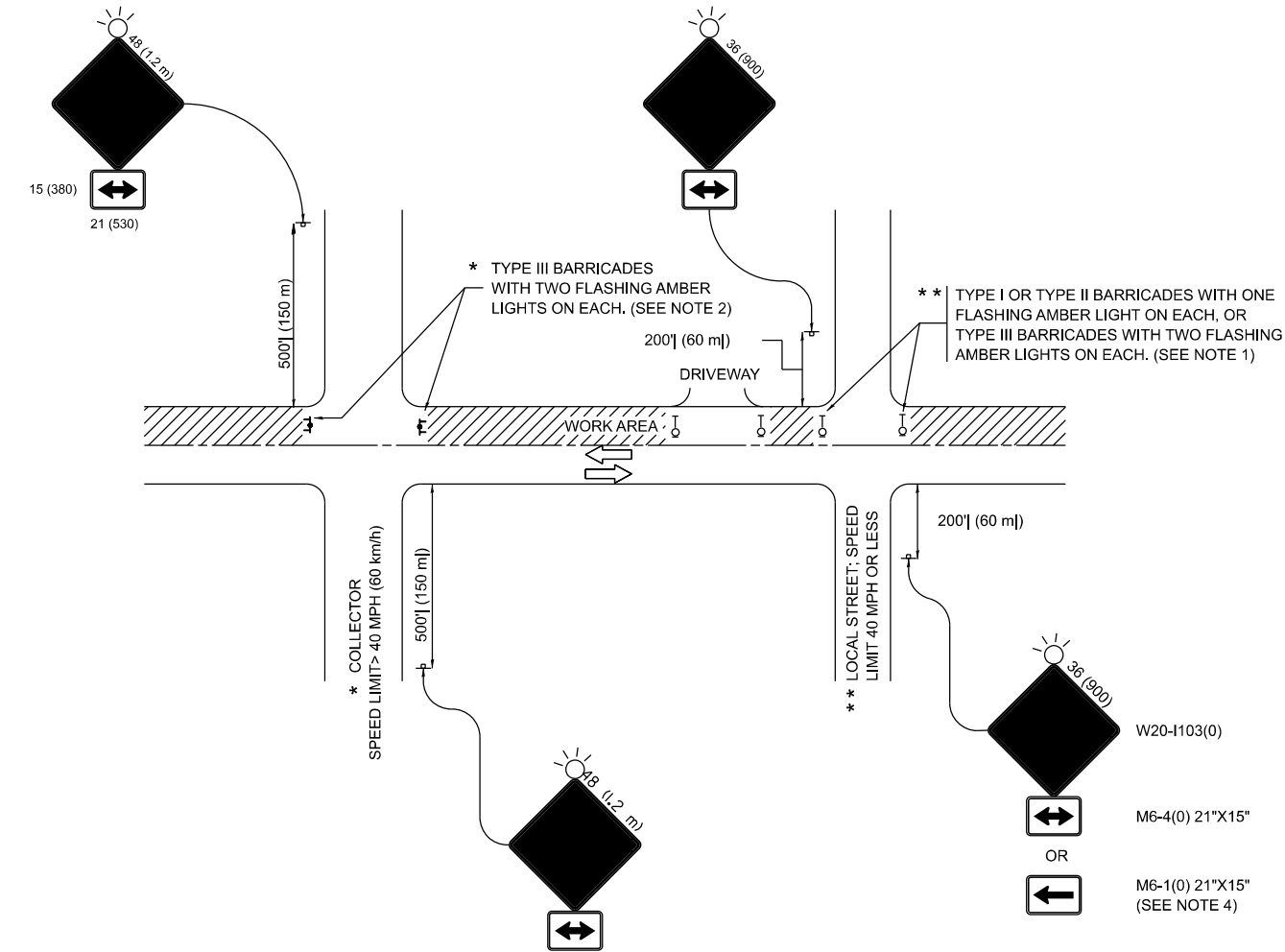

NOTES:

- SIDE ROAD WITH A SPEED LIMIT OF 40 MPH (60 km/h) OR LESS AS SHOWN ON THE DRAWING AND AS DIRECTED BY THE ENGINEER:
 - ONE "ROAD CONSTRUCTION AHEAD" SIGN 36 x 36 (900x900) WITH A FLASHER MOUNTED ON IT APPROXIMATELY 200' (60 m) IN ADVANCE OF THE MAIN ROUTE.
 - THE CLOSED PORTION OF THE MAIN ROUTE SHALL BE PROTECTED BY BLOCKING WITH TYPE I, TYPE II OR TYPE III BARRICADES, 1/3 OF THE CROSS SECTION OF THE CLOSED PORTION.
- SIDE ROAD WITH A SPEED LIMIT GREATER THAN 40 MPH (60 km/h) AS SHOWN ON THE DRAWING AND AS DIRECTED BY THE ENGINEER:
 - ONE "ROAD CONSTRUCTION AHEAD" SIGN 48 x 48 (1.2 m x 1.2 m) WITH A FLASHER MOUNTED ON IT APPROXIMATELY 500' (150 m) IN ADVANCE OF THE MAIN ROUTE.
 - THE CLOSED PORTION OF THE MAIN ROUTE SHALL BE PROTECTED BY BLOCKING WITH TYPE III BARRICADES, 1/2 OF THE CROSS SECTION OF THE CLOSED PORTION.
- CONES MAY BE SUBSTITUTED FOR BARRICADES OR DRUMS AT HALF THE SPACING DURING DAY OPERATIONS. CONES SHALL BE A MINIMUM OF 28 (710) IN HEIGHT.
- WHEN THE SIDE ROAD LIES BETWEEN THE BEGINNING OF THE MAINLINE SIGNING AND THE WORK ZONE, A SINGLE HEADED ARROW (M6-1) SHALL BE USED IN LIEU OF THE DOUBLE HEADED ARROW (M6-4).
- WHEN WORK IS BEING PERFORMED ON A SIDE ROAD OR DRIVEWAY, FOLLOW THE APPLICABLE STANDARD(S). THE DIRECTIONAL ARROW (M6-1 OR M6-4) SHALL BE COVERED OR REMOVED WHEN NO LONGER CONSISTENT WITH THE TRAFFIC CONTROL SET-UP.
- ADVANCE WARNING SIGNS ARE TO BE OMITTED ON DRIVEWAYS UNLESS OTHERWISE SPECIFIED IN THE PLANS OR BY THE ENGINEER.
- THE TRAFFIC CONTROL AND PROTECTION FOR SIDE ROADS, INTERSECTIONS, AND DRIVEWAYS SHALL BE INCLUDED IN THE COST OF SPECIFIED TRAFFIC CONTROL STANDARDS OR ITEMS.

All dimensions are in inches (millimeters)
unless otherwise shown.

	USER NAME = Phillip.Steed	DESIGNED - L.H.A.	REVISED - T. RAMMACHER 01-06-00	STATE OF ILLINOIS DEPARTMENT OF TRANSPORTATION	TRAFFIC CONTROL AND PROTECTION FOR SIDE ROADS, INTERSECTIONS, AND DRIVEWAYS	F.A.P. RTE.	SECTION	COUNTY	TOTAL SHEETS	SHEET NO.
		DRAWN -	REVISED - A. SCHUETZE 07-01-13			400	FAP 400 23 OVERLAY	LAKE	24	17
	PLOT SCALE = \$SCALE\$	CHECKED -	REVISED - A. SCHUETZE 09-15-16			TC-10		CONTRACT NO. 62U91		
	PLOT DATE = 12/4/2024	DATE - 06-89	REVISED - D. SENDERAK 05-03-24			SCALE: NONE	SHEET 1 OF 1 SHEETS	STA.	TO STA.	ILLINOIS FED. AID PROJECT

MODEL: Default
FILE NAME: p:\work\sw_bentley.com\FW\DOT\Documents\DOT 0 cas\Dist44_1\ORD Projects\044 Skokie Ref\CADDData\CAD\Insets\04 Skokie Rd-sh-04a-Stds.dgn

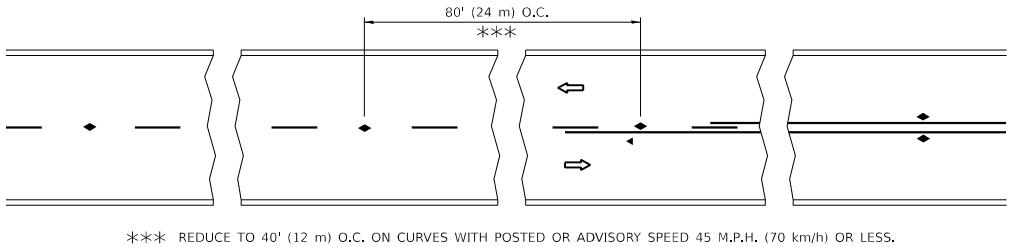

TWO-LANE/TWO-WAY

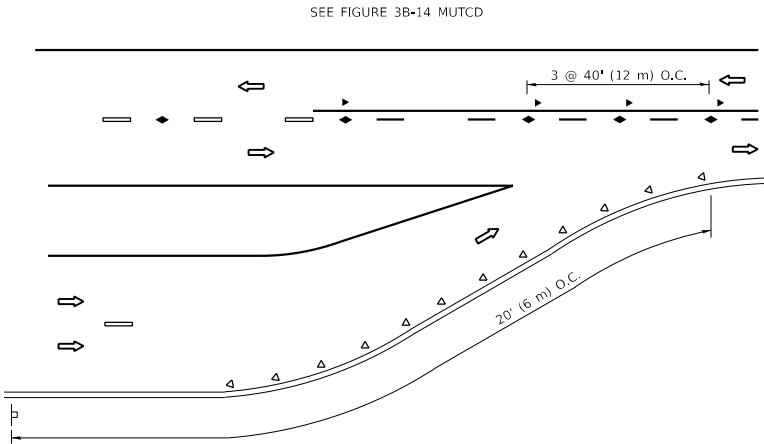

LANE REDUCTION TRANSITION

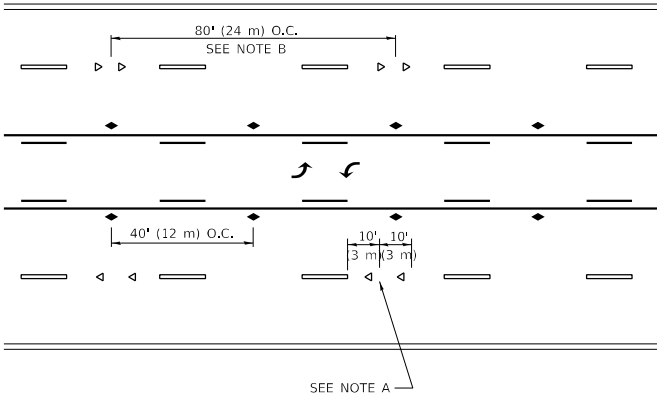

TWO-WAY LEFT TURN

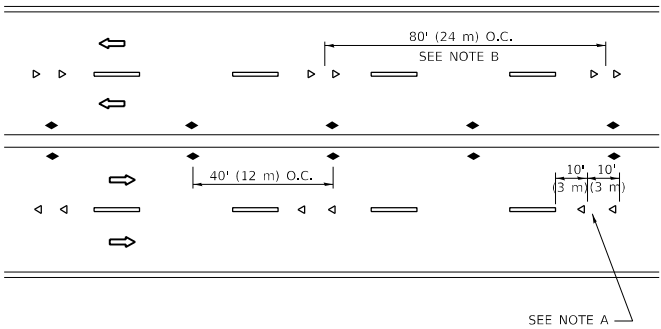

MULTI-LANE/UNDIVIDED

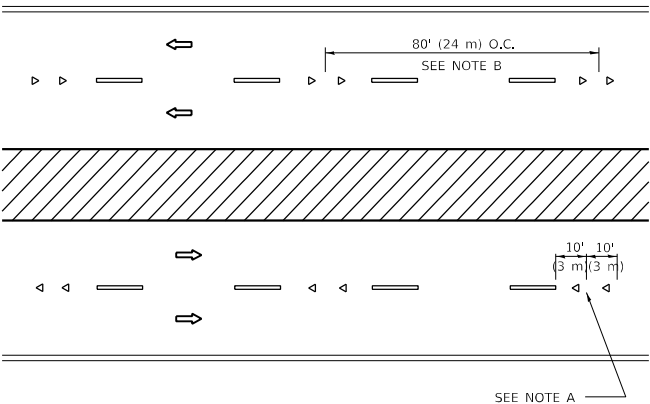

MULTI-LANE/DIVIDED

GENERAL NOTES

1. MARKERS USED WITH DASHED LINES SHALL BE CENTERED IN THE GAP BETWEEN SEGMENTS.
2. MARKERS USED ADJACENT TO SOLID LINES SHALL BE OFFSET 2 TO 3 (50 TO 75) TOWARD TRAFFIC AS SHOWN.
3. MARKERS THROUGH TANGENTS LESS THAN 500' (150 m) IN LENGTH BETWEEN CURVES SHALL BE INSTALLED AT THE LESSER OF THE TWO CURVE SPACINGS.
4. MARKERS ARE TO BE USED ADJACENT TO BOTH SOLID WHITE LINES IN DUAL LEFT TURN LANES

LANE MARKER NOTES

- A. USE DOUBLE LANE LINE MARKERS SPACED AS SHOWN.
- B. REDUCE TO 40' (12 m) O.C. ON CURVES WHERE ADVISORY SPEEDS ARE 10 M.P.H (20 km/h) LOWER THAN POSTED SPEEDS.

SYMBOLS

- YELLOW STRIPE
- WHITE STRIPE
- ◀ ONE-WAY AMBER MARKER
- ◀ ONE-WAY CRYSTAL MARKER (W/O)
- ◆ TWO-WAY AMBER MARKER

DESIGN NOTES

1. DOUBLE LANE LINE MARKERS SHALL BE USED UNLESS SPECIFIED OTHERWISE.
2. EXCEPT AS SHOWN ON THE LANE REDUCTION TRANSITION AND FREEWAY EXIT RAMP DETAIL, MARKERS ARE NOT TO BE SPECIFIED ON RIGHT EDGE LINES.
3. THE EXACT MARKER LIMITS, SPACING, AND COLOR SHALL BE INCLUDED IN THE PLANS WHEN STANDARD SPECIFICATIONS ARE NOT BEING USED.
4. MARKERS SHOULD NOT BE USED ALONGSIDE CURBS EXCEPT FOR EXTREMELY SHORT SECTIONS OF CURBS WHERE NOT MORE THAN TWO MARKERS WOULD BE INVOLVED.

All dimensions are in inches (millimeters) unless otherwise shown.

	USER NAME = Phillip.Steed	DESIGNED -	REVISED - T. RAMMACHER 03-12-99	STATE OF ILLINOIS DEPARTMENT OF TRANSPORTATION	TYPICAL APPLICATIONS RAISED REFLECTIVE PAVEMENT MARKERS (SNOW-PLOW RESISTANT)				F.A.P. RTE.	SECTION	COUNTY	TOTAL SHEETS	SHEET NO.
		DRAWN -	REVISED - T. RAMMACHER 01-06-00						400	FAP 400 23 OVERLAY	LAKE	24	18
	PLOT SCALE = \$SCALE\$	CHECKED -	REVISED - C. JUCIUS 09-09-09		TC-11		CONTRACT NO. 62U91						
	PLOT DATE = 12/4/2024	DATE -	REVISED - C. JUCIUS 07-01-13		SCALE: NONE	SHEET 1	OF 1	SHEETS	STA.	TO STA.			

MODEL: Default
FILE NAME: p:\w\dot\aw\benley.com\IN\DOT\Documents\DOT 0 cas\DistHt_1\ORD Projects\041 Skokie Rd\CADDData\CAD\Sheets\04 Skokie Rd-sh-04a5Std.dgn

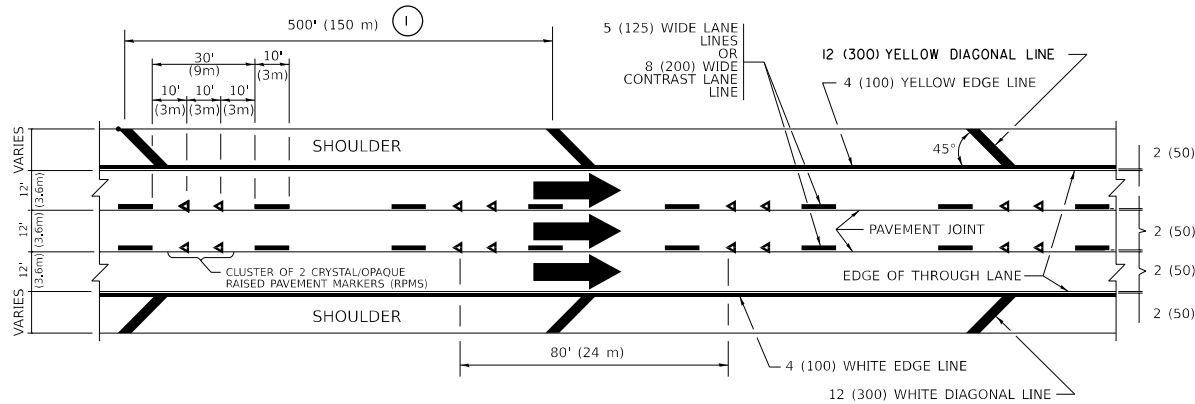

TYPICAL EDGE LINES & LANE LINES

PAVEMENT MARKING MATERIALS

1. THERMOPLASTIC PAVEMENT MARKING LINE SHALL BE USED FOR ALL EDGE LINES, GORE LINES, AND DIAGONAL LINES ON HMA PAVEMENTS.
2. POLYUREA OR MODIFIED URETHANE PAVEMENT MARKING LINE SHALL BE USED FOR ALL EDGE LINES, GORE LINES, AND DIAGONAL LINES ON PCC PAVEMENTS.
3. PREFORMED PLASTIC PAVEMENT MARKING LINE TYPE D, INLAID OR GROOVE IN, SHALL BE USED FOR ALL LANE LINES ON HMA PAVEMENTS.
4. CONTRAST PREFORMED PLASTIC PAVEMENT MARKING LINE TYPE B, GROOVE IN, SHALL BE USED FOR ALL LANE LINES ON PCC PAVEMENT.

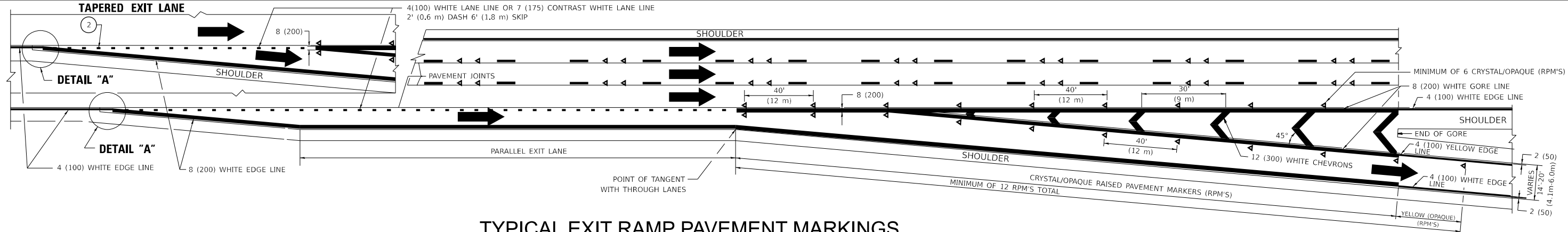

TYPICAL EXIT RAMP PAVEMENT MARKINGS

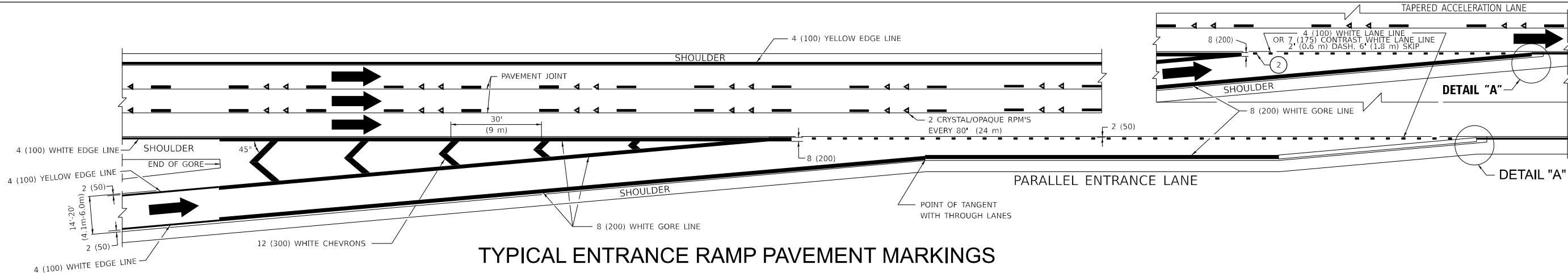

TYPICAL ENTRANCE RAMP PAVEMENT MARKINGS

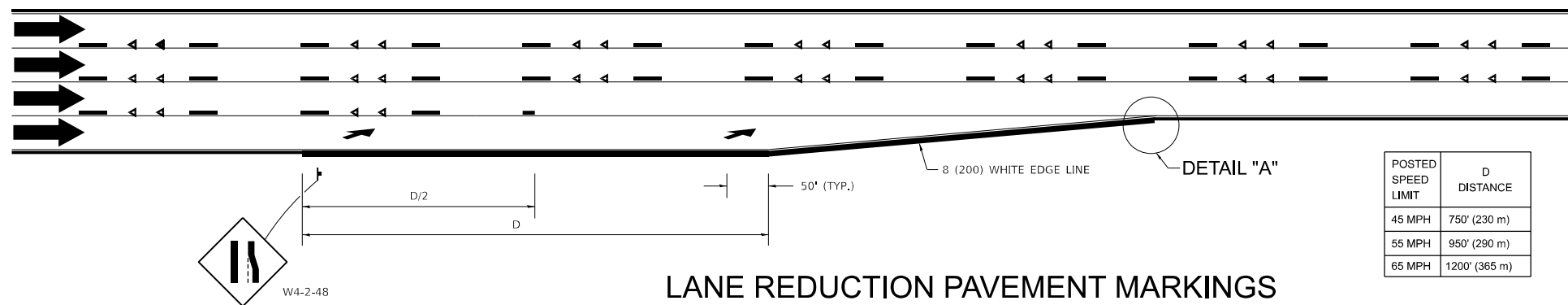

LANE REDUCTION PAVEMENT MARKINGS

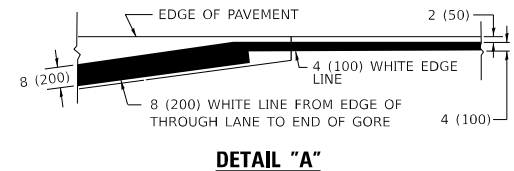

NOTES:

1. THE DIAGONAL LINES SHALL BE SPACED AT 40' (12 m) C-C ACROSS ALL STRUCTURES WHICH ARE 500' (150 m) OR LESS IN LENGTH. THE DIAGONAL LINES ARE NOT REQUIRED ON SHOULDERS WHICH ARE 6' (1.8 m) OR LESS IN WIDTH.
2. 4" (2' DASH, 6' SKIP) MARKING ON TAPERED ENTRANCE AND EXIT RAMP SHALL BE OMITTED ON TANGENT SECTIONS.

USER NAME	= Phillip.Steed	DESIGNED -	D.W.S.	REVISED -	S.P.B. 01-10
DRAWN	-	REVISD -	M.D. 05-13	REVISED -	M.D. 09-17
PLOT SCALE	= \$SCALE\$	CHECKED -		REVISED -	K. SMITH 11-18-22
PLOT DATE	= 12/4/2024	DATE	- 01-90		

STATE OF ILLINOIS
DEPARTMENT OF TRANSPORTATION

MULTI-LANE FREEWAY PAVEMENT MARKING DETAILS

SCALE: NONE SHEET 1 OF 2 SHEETS STA. TO STA.

F.A.P. RTE.	SECTION	COUNTY	TOTAL SHEETS	SHEET NO.
400	FAP 400 23 OVERLAY	LAKE	24	19
TC-12		CONTRACT NO. 62U91		
		ILLINOIS FED. AID PROJECT		

MODEL: Default
FILE NAME: p:\w\dot-s\w\benley.com\FW\DOT Documents\DOT 0 cas\Distric 11\ORD Projects\04d Skokie Rd\CADDData\CAD Sheets\04d Skokie Rd-sh-04d-Stds.dgn

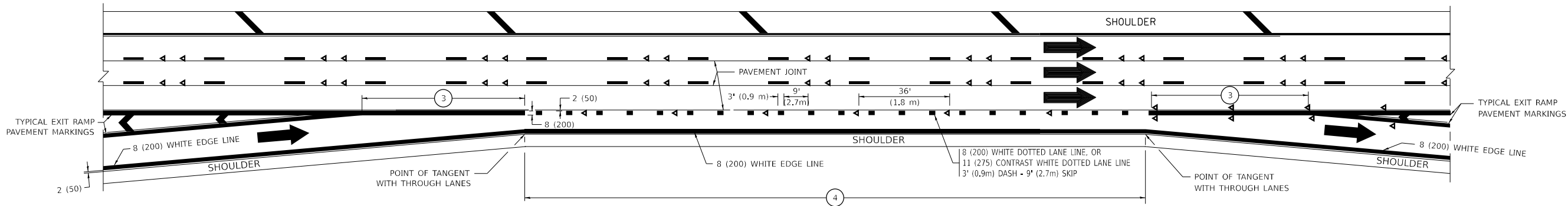

AUXILIARY LANE MARKINGS

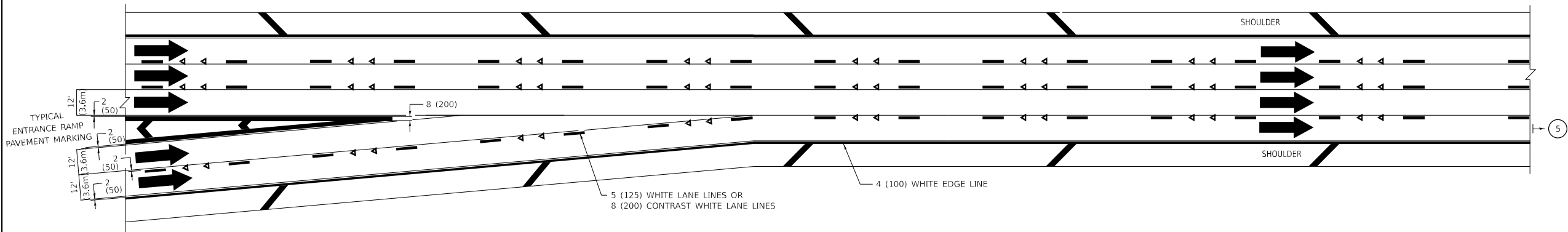

TWO LANE ENTRANCE RAMP WITH MERGE MARKINGS

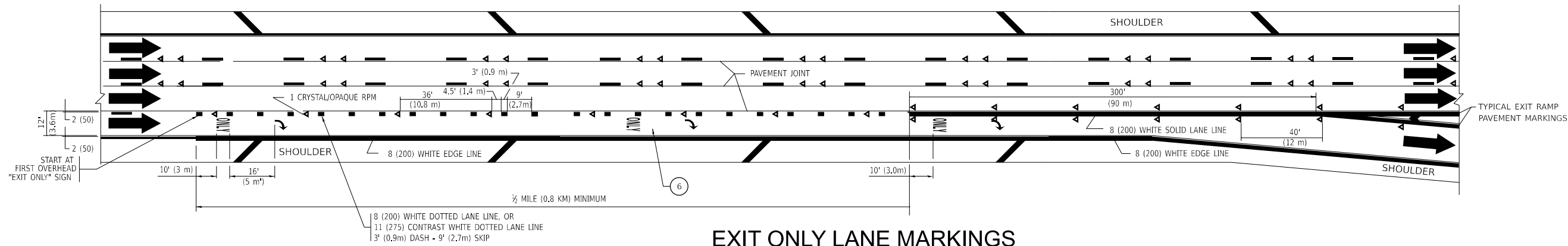

EXIT ONLY LANE MARKINGS

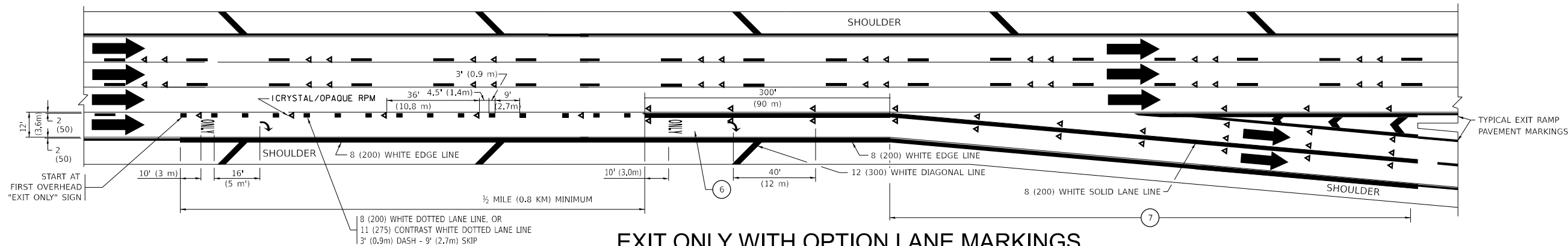

EXIT ONLY WITH OPTION LANE MARKINGS

NOTES:

- 3 OMIT WHEN LENGTH OF AUXILIARY LANE IS LESS THAN 500' (150 m).
- 4 8-INCH WIDE DOTTED LANE LINE MARKINGS SHALL BE USED WHEN THE LENGTH OF THE AUXILIARY LANE IS 2 MILES OR LESS.
- 5 FOR TWO-LANE ENTRANCE RAMP, IF RIGHT LANE ENDS, USE TYPICAL ENTRANCE RAMP PAVEMENT MARKINGS.
- 6 ONLY AND ARROWS EQUALLY SPACED, 500' (150 m) MAXIMUM SPACING. FULL SIZE LETTERS AND ARROW SHALL BE USED..
- 7 CONTINUE 8" SOLID LANE LINE THROUGH EXIT TO END OF PAVED GORE.

USER NAME = Phillip.Steed	DESIGNED - D.W.S.	REVISED - J.A.F. 02-06
	DRAWN -	REVISED - S.P.B. 01-07
PLOT SCALE = \$SCALE\$	CHECKED -	REVISED - S.P.B. 01-10
PLOT DATE = 12/4/2024	DATE - 01-90	REVISED - M.D. 09-17

STATE OF ILLINOIS
DEPARTMENT OF TRANSPORTATION

MULTI-LANE FREEWAY
PAVEMENT MARKING DETAILS

SCALE: NONE SHEET 2 OF 2 SHEETS STA. TO STA.

F.A.P. RTE.	SECTION	COUNTY	TOTAL SHEETS	SHEET NO.
400	FAP 400 23 OVERLAY	LAKE	24	20
TC-12		CONTRACT NO. 62U91		
		ILLINOIS	FED. AID PROJECT	

MODEL: Default
FILE NAME: p:\w\dot-cw-bentley.com\FWIDOT\Documents\DOT 0 cas\Dist414_10RD Projects\0414_Skokie_Rd\CADDData\CAD\ Sheets\0414_Skokie_Rd-sh-0414-Stds.dgn

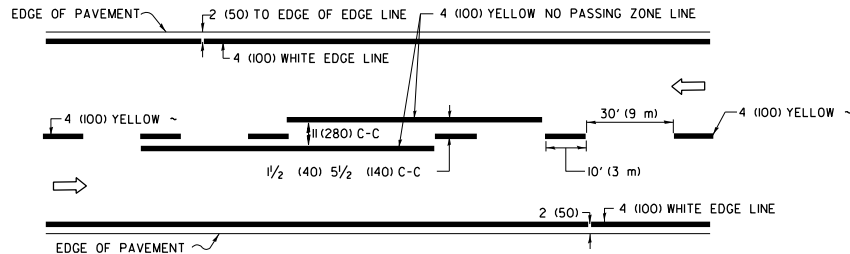

2-LANE ROADWAY

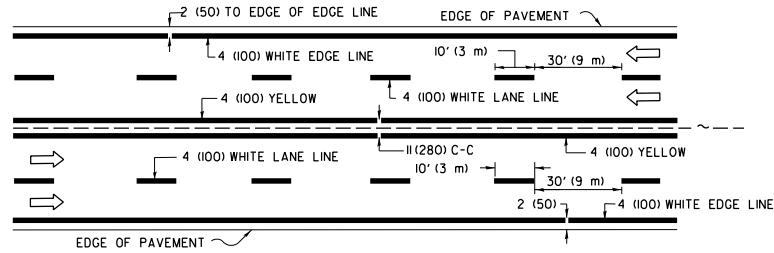

MULTI-LANE UNDIVIDED

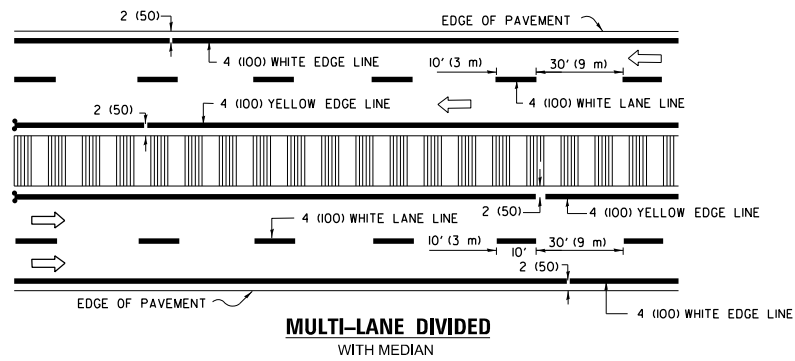

TYPICAL LANE AND EDGE LINE MARKING

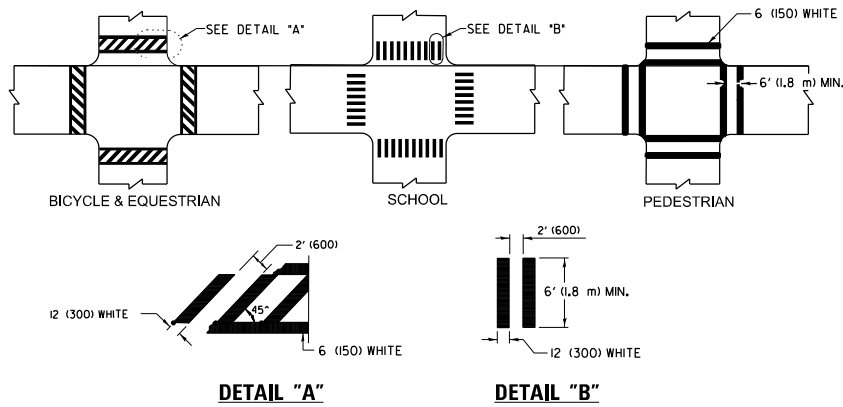

TYPICAL CROSSWALK MARKING

* MARKINGS SHALL BE INSTALLED PARALLEL TO THE CENTERLINE OF THE ROAD WHICH IT CROSSES

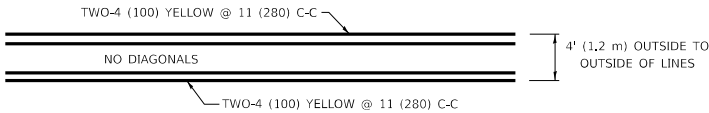

4' (1.2 m) WIDE MEDIANS ONLY

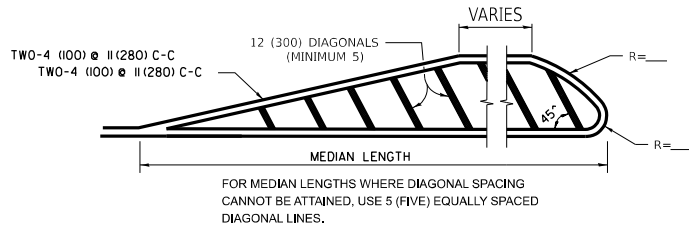

DIAGONAL LINE SPACING: 50' (15 m) C-C (LESS THAN 30MPH (50 km/h))
75' (25 m) C-C 30MPH (50 km/h) TO 45MPH (70 km/h)
150' (45 m) C-C (MORE THAN 45MPH (70 km/h))

MEDIANS OVER 4' (1.2 m) WIDE

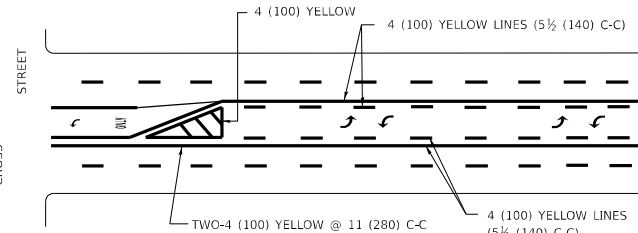

A MINIMUM OF TWO PAIRS OF TURN ARROWS SHALL BE USED, WHITE IN COLOR. ADDITIONAL PAIRS SHALL BE PLACED AT 200' (60 m) TO 300' (90 m) INTERVALS.

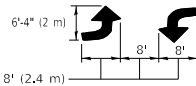

MEDIAN WITH TWO-WAY LEFT TURN LANE

TYPICAL PAINTED MEDIAN MARKING

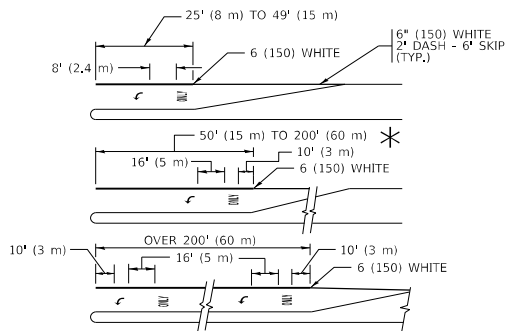

FULL SIZE LETTERS 8" (2.4 m) AND ARROWS SHALL BE USED.
AREA = 15.6 SQ. FT. (1.5 m²) ONLY AREA = 20.8 SQ. FT. (1.9 m²)

* TURN LANES IN EXCESS OF 400' (120 m) IN LENGTH MAY HAVE AN ADDITIONAL SET OF ARROW - "ONLY" INSTALLED MIDWAY BETWEEN THE OTHER TWO SETS OF ARROW - "ONLY".

TYPICAL LEFT (OR RIGHT) TURN LANE

TYPICAL TURN LANE MARKING

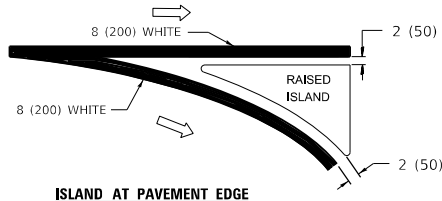
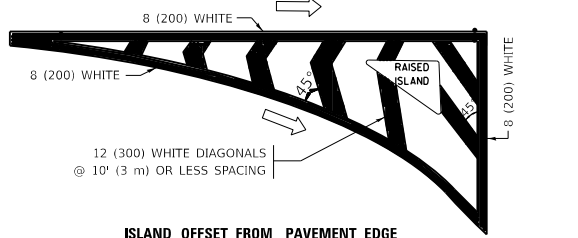

TYPICAL ISLAND MARKING

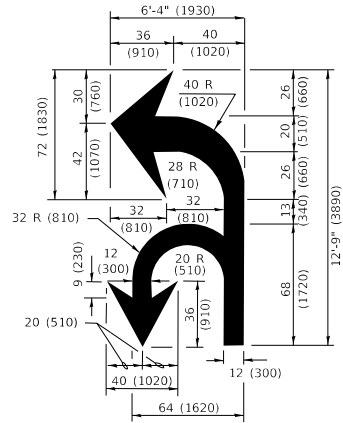

COMBINATION LEFT AND U-TURN

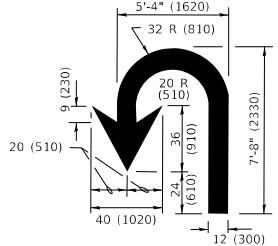

LANE REDUCTION TRANSITION

* LANE REDUCTION ARROWS REQUIRED AT SPEEDS OF 45 MPH OR GREATER OR WHEN SPECIFIED IN PLANS.

TYPE OF MARKING	WIDTH OF LINE	PATTERN	COLOR	SPACING / REMARKS
CENTERLINE ON 2 LANE PAVEMENT	4 (100)	SKIP-DASH	YELLOW	10' (3 m) LINE WITH 30' (9 m) SPACE
CENTERLINE ON MULTI-LANE UNDIVIDED PAVEMENT	2 @ 4 (100)	SOLID	YELLOW	11 (280) C-C
NO PASSING ZONE LINES: FOR ONE DIRECTION FOR BOTH DIRECTIONS	4 (100) 2 @ 4 (100)	SOLID SOLID	YELLOW YELLOW	5 1/2 (140) C-C FROM SKIP-DASH CENTERLINE 11 (280) C-C OMIT SKIP-DASH CENTERLINE BETWEEN
LANE LINES	4 (100) 5 (125) ON FREEWAYS	SKIP-DASH SKIP-DASH	WHITE WHITE	10' (3 m) LINE WITH 30' (9 m) SPACE
DOTTED LINES (EXTENSIONS OF CENTER, LANE OR TURN LANE MARKINGS)	SAME AS LINE BEING EXTENDED	SKIP-DASH	SAME AS LINE BEING EXTENDED	2' (600) LINE WITH 6' (1.8 m) SPACE
EDGE LINES	4 (100)	SOLID	YELLOW-LEFT WHITE-RIGHT	OUTLINE MEDIANS IN YELLOW
TURN LANE MARKINGS	6 (150) LINE: FULL SIZE LETTERS & SYMBOLS (8' (2.4m))	SOLID	WHITE	SEE TYPICAL TURN LANE MARKING DETAIL
TWO WAY LEFT TURN MARKING	2 @ 4 (100) EACH DIRECTION 8' (2.4m) LEFT ARROW	SKIP-DASH AND SOLID IN PAIRS	YELLOW WHITE	10' (3 m) LINE WITH 30' (9 m) SPACE FOR SKIP-DASH; 5 1/2 (140) C-C BETWEEN SOLID LINE AND SKIP-DASH LINE SEE TYPICAL TWO-WAY LEFT TURN MARKING DETAIL
CROSSWALK LINES (PEDESTRIAN) A. DIAGONALS (BIKE & EQUESTRIAN) B. LONGITUDINAL BARS (SCHOOL)	2 @ 6 (150) 12 (300) @ 45° 12 (300) @ 90°	SOLID SOLID SOLID	WHITE WHITE WHITE	NOT LESS THAN 6' (1.8 m) APART 2' (600) APART 2' (600) APART SEE TYPICAL CROSSWALK MARKING DETAILS.
STOP LINES	24 (600)	SOLID	WHITE	PLACE 4' (1.2 m) IN ADVANCE OF AND PARALLEL TO CROSSWALK, IF PRESENT. OTHERWISE, PLACE AT DESIRED STOPPING POINT, PARALLEL TO CROSSROAD CENTERLINE, WHERE POSSIBLE.
PAINTED MEDIANS	2 @ 4 (100) WITH 12 (300) DIAGONALS @ 45° NO DIAGONALS USED FOR 4' (1.2 m) WIDE MEDIANS	SOLID	YELLOW; TWO WAY TRAFFIC WHITE; ONE WAY TRAFFIC	11 (280) C-C FOR THE DOUBLE LINE SEE TYPICAL PAINTED MEDIAN MARKING.
GORE MARKING AND CHANNELIZING LINES	8 (200) WITH 12 (300) DIAGONALS @ 45°	SOLID	WHITE	DIAGONALS: 15' (4.5 m) C-C (LESS THAN 30MPH (50 km/h)) 20' (6 m) C-C 30MPH (50 km/h) TO 45MPH (70 km/h) 30' (9 m) C-C (OVER 45MPH (70 km/h))
RAILROAD CROSSING	24 (600) TRANSVERSE LINES: "RR" IS 6' (1.8 m) LETTERS: 16 (400) LINE FOR "X"	SOLID	WHITE	SEE STATE STANDARD 780001 AREA OF: "R"=3.6 SQ. FT. (0.33 m ²) EACH "X"=54.0 SQ. FT. (5.0 m ²)
SHOULDER DIAGONALS (REQUIRED FOR SHOULDERS ≥ 8')	12 (300) @ 45°	SOLID	WHITE - RIGHT YELLOW - LEFT	50' (15 m) C-C (LESS THAN 30MPH (50 km/h)) 75' (25 m) C-C (30 MPH (50 km/h) TO 45MPH (70 km/h)) 150' (45 m) C-C (OVER 45MPH (70 km/h))
U TURN ARROW	SEE DETAIL	SOLID	WHITE	16.3 SF
2 ARROW COMBINATION LEFT AND U TURN	SEE DETAIL	SOLID	WHITE	30.4 SF

FOR FURTHER DETAILS ON PAVEMENT MARKING REFER TO STANDARD SPECIFICATIONS FOR ROAD AND BRIDGE CONSTRUCTION AND STATE STANDARD 780001.

All dimensions are in inches (millimeters) unless otherwise shown.

USER NAME = Phillip.Steed	DESIGNED - EVERS	REVISED - C. JUCIUS 09-09-09
PLOT SCALE = \$SCALE\$	CHECKED -	REVISED - C. JUCIUS 07-01-13
PLOT DATE = 12/4/2024	DATE - 03-19-90	REVISED - C. JUCIUS 12-21-15
		REVISED - C. JUCIUS 04-12-16

STATE OF ILLINOIS DEPARTMENT OF TRANSPORTATION

DISTRICT ONE TYPICAL PAVEMENT MARKINGS

SCALE: NONE SHEET 1 OF 2 SHEETS STA. TO STA.

F.A.P. RTE.	SECTION	COUNTY	TOTAL SHEETS	SHEET NO.
400	FAP 400 23 OVERLAY	LAKE	24	21
TC-13		CONTRACT NO. 62U91		
		ILLINOIS	FED. AID PROJECT	

TURN BAY ENTRANCE AT START
OF LANE CLOSURE TAPER

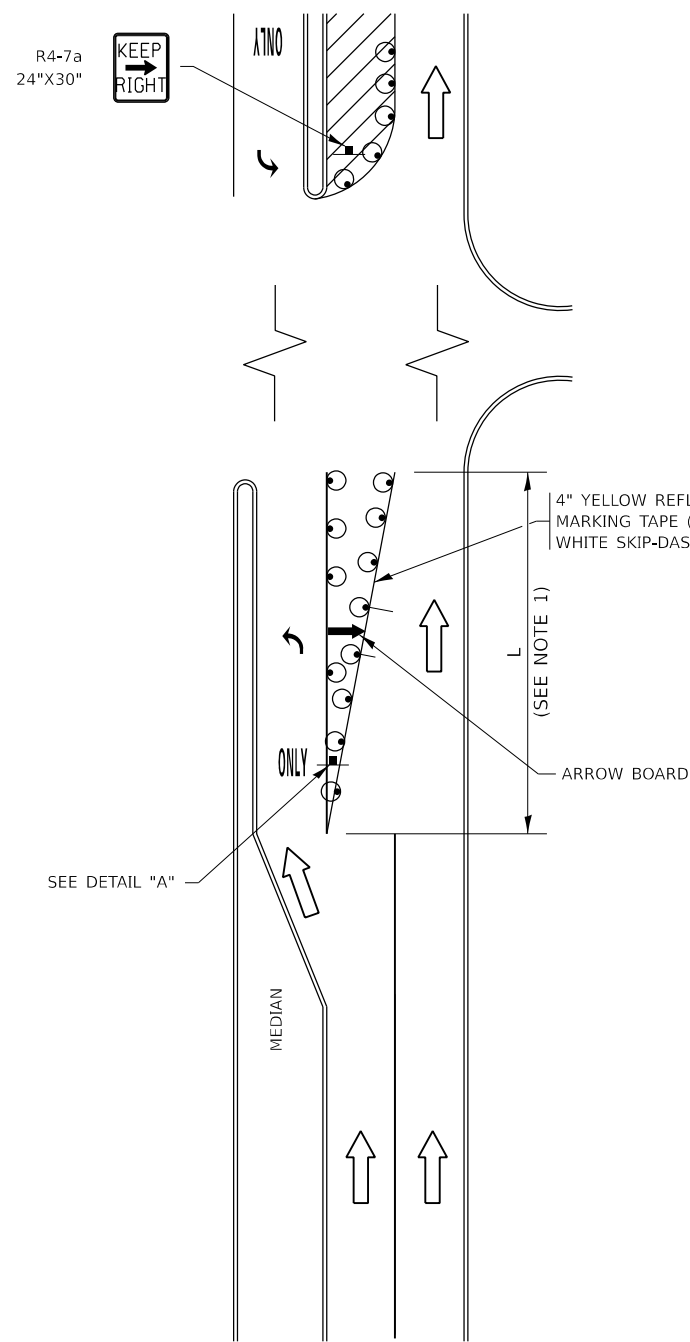

FIGURE 1

LEGEND

- WORK AREA
- LANE OPEN TO TRAFFIC
- ARROW BOARD
- TYPE I OR II BARRICADE OR DRUM WITH STEADY BURN LIGHT
- DRUM WITH STEADY BURN LIGHT
- SIGN ASSEMBLY
- TYPE I OR II CHECK BARRICADE WITH FLASHING LIGHT

NOTES:

- A) WHEN "L" IS \leq THE STORAGE LENGTH OF THE TURN LANE (AS SHOWN IN FIG. 1), USE FIGURE 1.
B) WHEN "L" IS $>$ THE STORAGE LENGTH OF THE TURN LANE OR THE TURN LANE IS WITHIN THE LANE CLOSURE, USE FIGURE 2.
- CONES MAY BE SUBSTITUTED FOR BARRICADES OR DRUMS AT HALF THE SPACING DURING DAY OPERATIONS. CONES SHALL BE A MINIMUM OF 28 (710) IN HEIGHT.
- LIGHTS WILL NOT BE REQUIRED ON BARRICADES OR DRUMS FOR DAY OPERATIONS. ALL LIGHTS SHALL BE MONODIRECTIONAL.
- REFLECTIVE TEMPORARY PAVEMENT MARKINGS SHALL BE PLACED THROUGHOUT THE BARRICADED AREAS OF EACH TURN BAY AS SHOWN WHERE THE CLOSURE TIME IS GREATER THAN FOURTEEN (14) DAYS.
- THIS APPLICATION ALSO APPLIES WHEN WORK IS BEING PERFORMED IN THE RIGHT LANE(S) AND THE RIGHT TURN BAY IS TO REMAIN OPEN. UNDER THIS CONDITION, "RIGHT TURN LANE" R3-I100R 24 x 24 (600 x 600) AND M6-2R 21 x 15 (530 x 380) SHALL BE USED.
- THESE CONTROLS SHALL SUPPLEMENT MAINLINE TRAFFIC CONTROL FOR LANE CLOSURES.
- THE SIGNS SHALL BE MOUNTED ABOVE THE BARRICADES/DRUMS ON SEPARATE SIGN SUPPORTS THAT MEET NCHRP 350 OR MASH REQUIREMENTS.
- TRAFFIC CONTROL AND PROTECTION AT TURN BAYS (TO REMAIN OPEN TO TRAFFIC) SHALL BE INCLUDED IN THE COST OF SPECIFIED TRAFFIC CONTROL STANDARDS OR ITEMS.

TURN BAY ENTRANCE
WITHIN A LANE CLOSURE

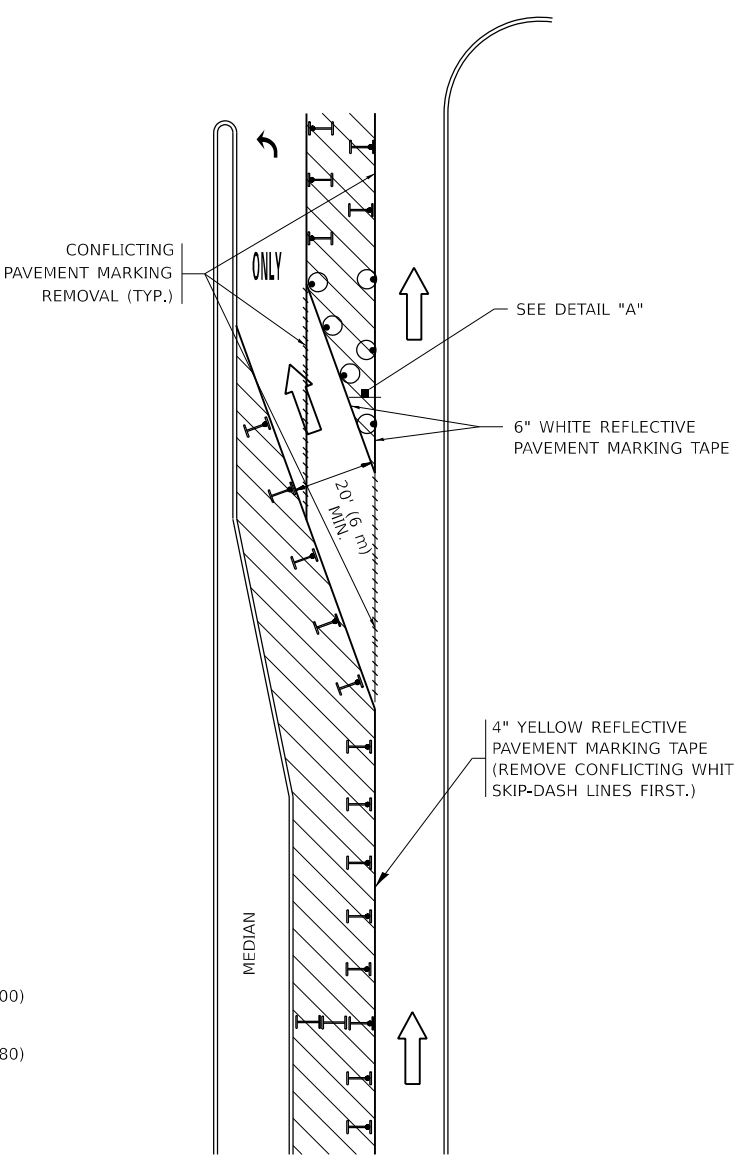
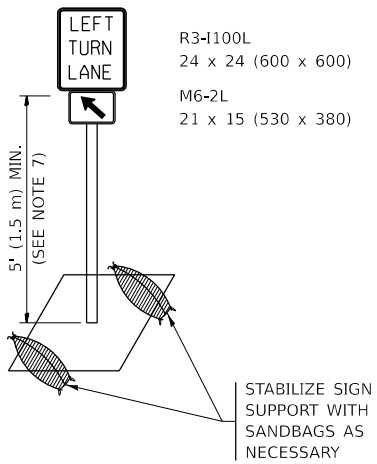

FIGURE 2



DETAIL A

All dimensions are in inches (millimeters) unless otherwise shown.

STATE OF ILLINOIS
DEPARTMENT OF TRANSPORTATION

TRAFFIC CONTROL AND PROTECTION AT TURN BAYS
(TO REMAIN OPEN TO TRAFFIC)

F.A.P. RTE.	SECTION	COUNTY	TOTAL SHEETS	SHEET NO.
400	FAP 400 23 OVERLAY	LAKE	24	22
TC-14		CONTRACT NO. 62U91		
		ILLINOIS	FED. AID PROJECT	

SCALE: NONE SHEET 1 OF 1 SHEETS STA. TO STA.

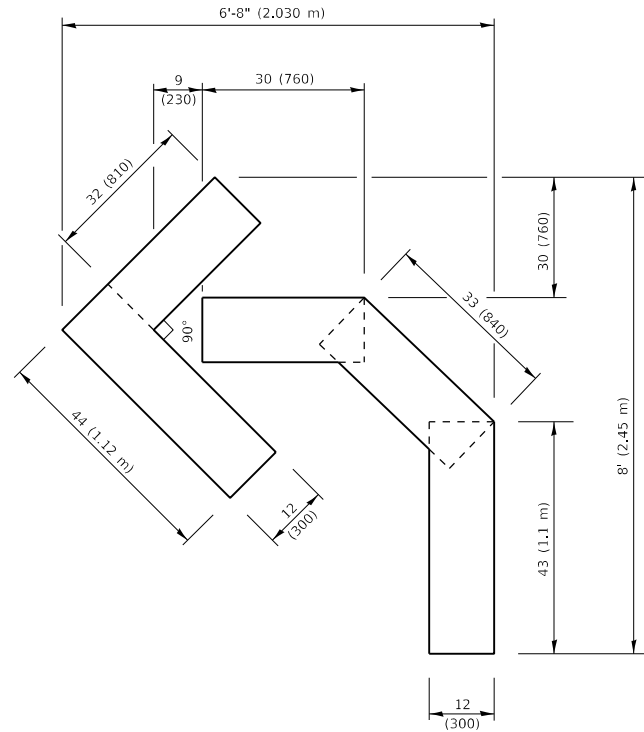

QUANTITY

4 (100) LINE = 45.5 ft. (13.9 m)
15.2 sq. ft. (1.41 sq. m)

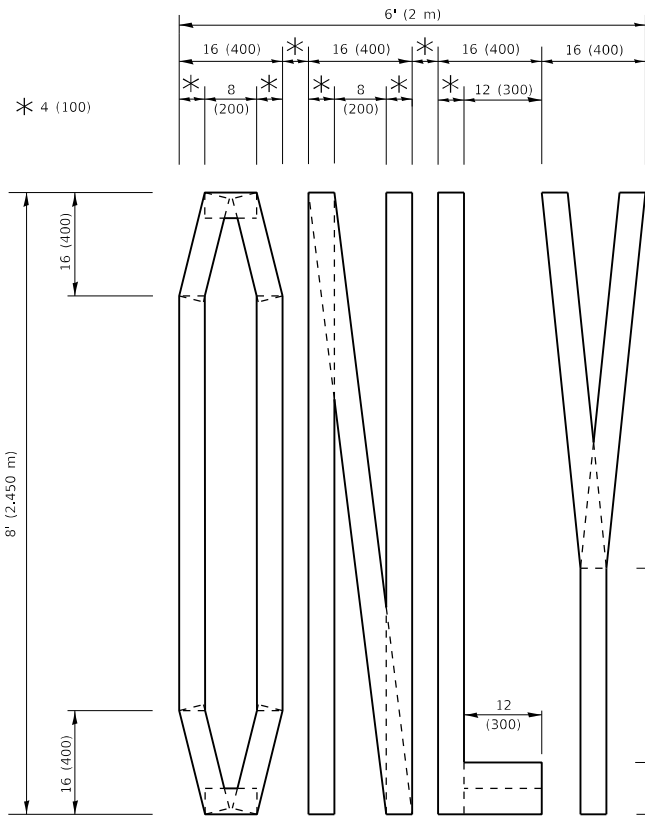

QUANTITY

4 (100) LINE = 64.1 ft. (19.5 m)
21.4 sq. ft. (1.99 sq. m)

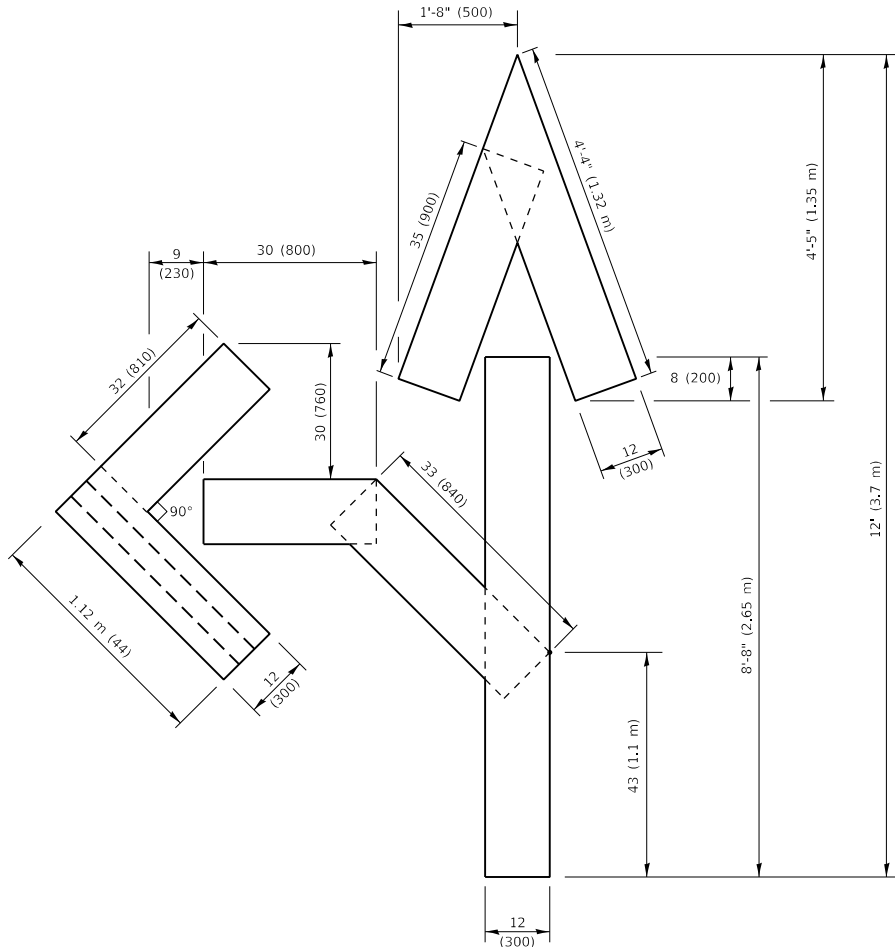

QUANTITY

4 (100) LINE = 82.5 ft. (25.1 m)
27.5 sq. ft. (2.53 sq. m)

NOTE:

ALL QUANTITIES OF PLACEMENT ARE REPRESENTED IN LINEAR FEET OF 4" LINES TO MATCH THE 4" TEMPORARY TAPE PAY ITEM AND REPRESENTS THE TOTAL QUANTITY OF 4" TAPE REQUIRED.

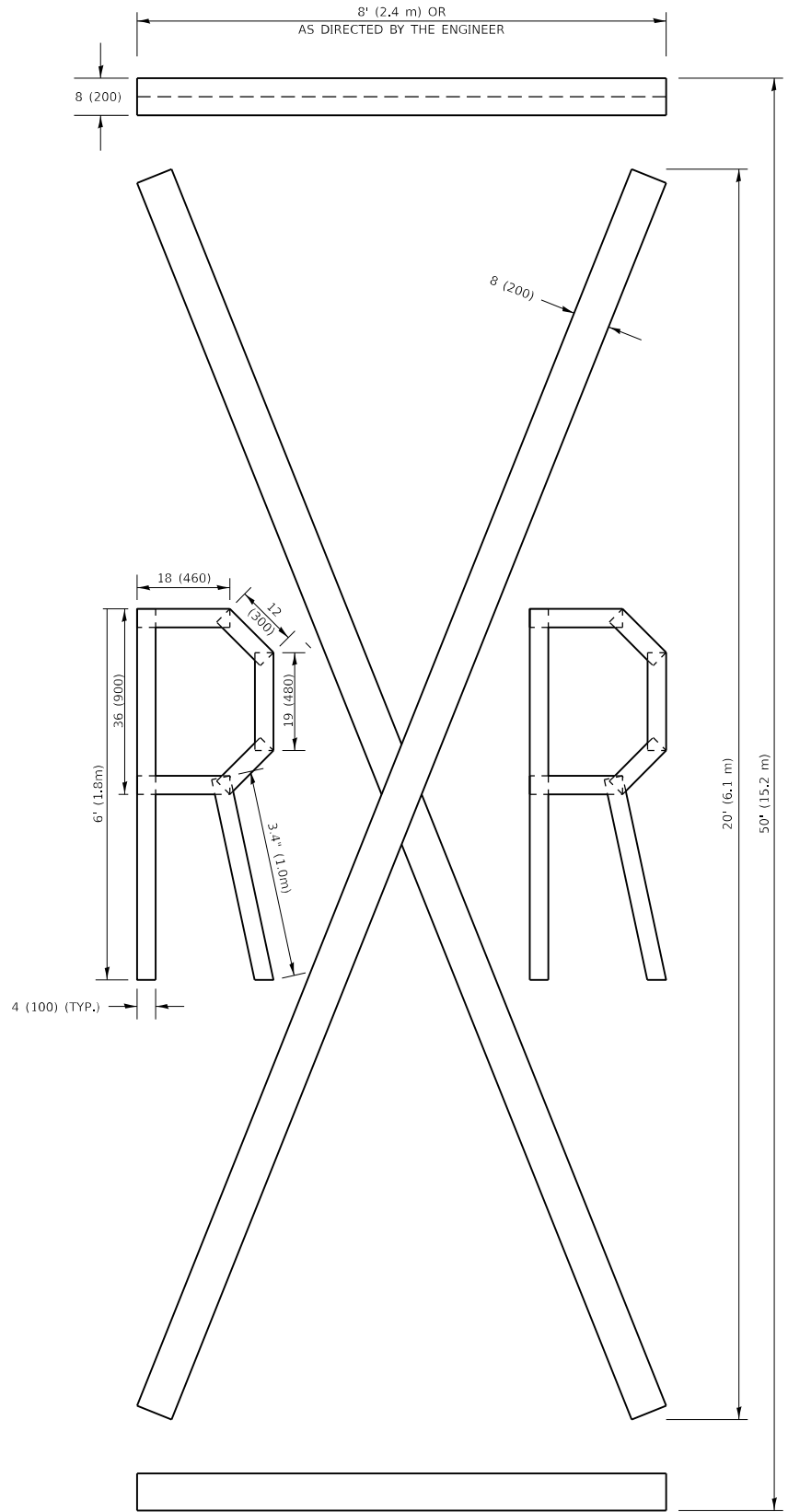

QUANTITY

4 (100) LINE = 225.9 ft. (68.9 m)
75.3 sq. ft. (6.99 sq. m)

All dimensions are in inches (millimeters) unless otherwise shown.

MODEL: Default
FILE NAME: p:\w\l\et-aw\entley.com\FW\DOT\Documents\DOT 0 ces\DistHt_1\ORD Projects\04d Skokie Rd\CADDData\CAD\Insets\04d Skokie Rd-sh-04a5Std.dgn

USER NAME = Phillip.Steed	DESIGNED -	REVISED - T. RAMMACHER 03-02-98
	DRAWN -	REVISED - E. GOMEZ 08-28-00
PLOT SCALE = \$SCALE\$	CHECKED -	REVISED - E. GOMEZ 08-28-00
PLOT DATE = 12/4/2024	DATE - 09-18-94	REVISED - A. SCHUETZE 09-15-16

**STATE OF ILLINOIS
DEPARTMENT OF TRANSPORTATION**

**SHORT TERM PAVEMENT MARKING --
LETTERS AND SYMBOLS**

SCALE: NONE SHEET 1 OF 1 SHEETS STA. TO STA.

F.A.P. RTE.	SECTION	COUNTY	TOTAL SHEETS	SHEET NO.
400	FAP 400 23 OVERLAY	LAKE	24	23
TC-16		CONTRACT NO. 62U91		
		ILLINOIS	FED. AID PROJECT	



- ALL DIMENSIONS ARE IN INCHES (MILLIMETERS)
UNLESS OTHERWISE SHOWN.

	USER NAME = Phillip,Speed	DESIGNED -	REVISED - R. MIRS 09-15-97	STATE OF ILLINOIS DEPARTMENT OF TRANSPORTATION	ARTERIAL ROAD INFORMATION SIGN				F.A.P. RTE.	SECTION	COUNTY	TOTAL SHEETS	SHEET NO.
		DRAWN -	REVISED - R. MIRS 12-11-97		400	FAP 400 23 OVERLAY	LAKE	24	24				
	PLOT SCALE = \$SCALE\$	CHECKED -	REVISED -T. RAMMACHER 02-02-99		TC-22				CONTRACT NO. 62U91				
	PLOT DATE = 12/4/2024	DATE -	REVISED - C. JUCIUS 01-31-07		SCALE: NONE	SHEET 1	OF 1 SHEETS	STA.	TO STA.				