

STATE OF ILLINOIS
DEPARTMENT OF TRANSPORTATION

F.A.U. RTE.	SECTION	COUNTY	TOTAL SHEETS	SHEET NO.
5789	(40BR-3)BDR	HENRY	19	1
		ILLINOIS	CONTRACT NO. 64T20	

FOR INDEX OF SHEETS, SEE SHEET NO. 2



HOWARD J. HAMILTON, P.E. DATE
LICENSE EXPIRES 11/30/2025
SHEET RANGE 1-9



SCOTT T. WYATT, S.E. DATE 12-17-24
LICENSE EXPIRES 11-30-26
SHEET RANGE 10-12

PROPOSED HIGHWAY PLANS

FAU 5789 (US 6)
SECTION (40BR-3)BDR
PROJECT HBIP-ENNC(140)
BRIDGE REPAIR
MAINTENANCE OF TRAFFIC
HENRY COUNTY

C-92-077-024

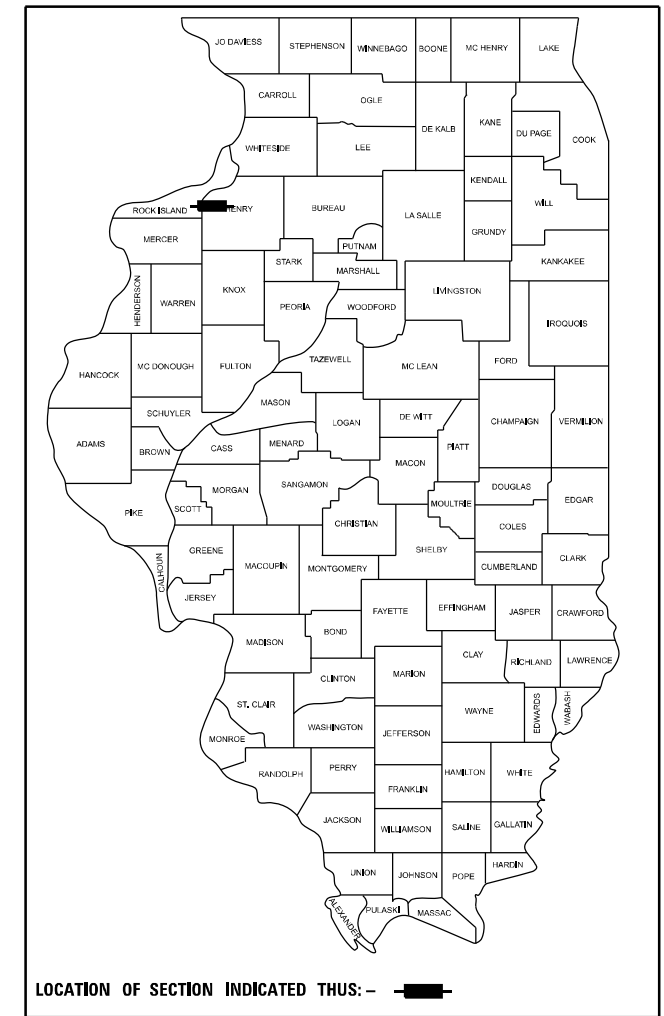

EXISTING STRUCTURE LOCATION
SN 037-0143 1-SPAN OVER MOSQUITO CREEK.
CONCRETE GIRDER SUPERSTRUCTURE
WITH SPILL-THROUGH ABUTMENTS.
BACK TO BACK LENGTH = 109'-0"
OUT TO OUT WIDTH = 39'-2"

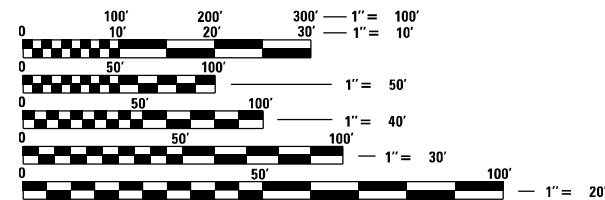
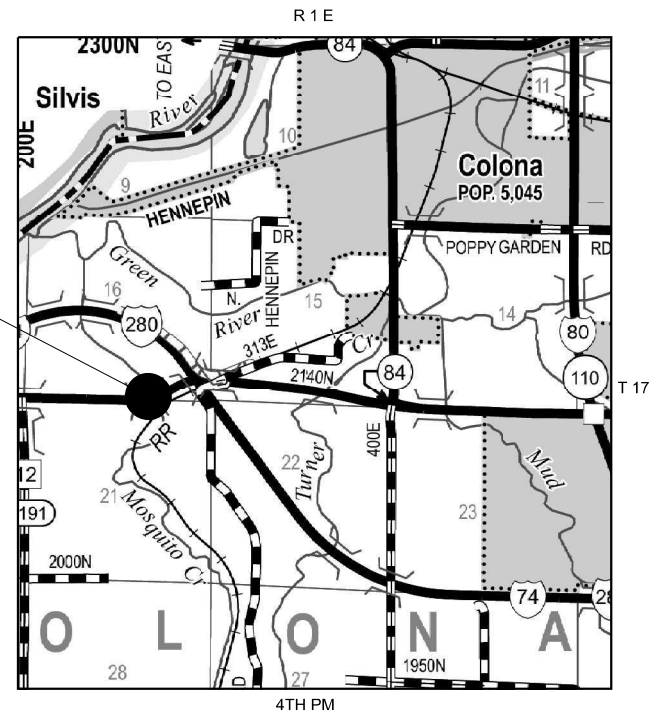

FULL SIZE PLANS HAVE BEEN PREPARED USING STANDARD ENGINEERING SCALES. REDUCED SIZED PLANS WILL NOT CONFORM TO STANDARD SCALES. IN MAKING MEASUREMENTS ON REDUCED PLANS, THE ABOVE SCALES MAY BE USED.

J.U.L.I.E.
JOINT UTILITY LOCATION INFORMATION FOR EXCAVATORS
1-800-892-0123
OR 811

PROJECT ENGINEER SCOTT WYATT, PE, SE
PROJECT MANAGER DERRICK LOPEZ, PE

GROSS LENGTH = 219.00 FT. = 0.042 MILE
NET LENGTH = 219.00 FT. = 0.042 MILE

CONTRACT NO. 64T20

STATE OF ILLINOIS
DEPARTMENT OF TRANSPORTATION

SUBMITTED December 19 20 24

Julia Thompson
REGIONAL ENGINEER

January 31 20 25
Scott Wyatt
ENGINEER OF DESIGN AND ENVIRONMENT

January 31 20 25
Derrick Lopez
DIRECTOR OF HIGHWAYS PROJECT IMPLEMENTATION

PRINTED BY THE AUTHORITY
OF THE STATE OF ILLINOIS

SHEET INDEX

1. COVER
2. GENERAL NOTES/ CONSTRUCTION SEQUENCE/GEN NOTES/MOT PLAN INDEX
- 3-4. SUMMARY OF QUANTITIES
5. STAGING TYPICAL SECTION
6. MAINTENANCE OF TRAFFIC PLAN STAGE 1
7. MAINTENANCE OF TRAFFIC PLAN STAGE 2
8. PLAN AND ELEVATION
9. TYPICAL SECTION
10. DECK PLAN SHEET
- 11-14. DISTRICT 2 STANDARD 34.1
- 15-18. DISTRICT 2 STANDARD 41.1
19. DISTRICT 2 STANDARD 55.1

STATE HIGHWAY STANDARDS

- 000001-08 STANDARD SYMBOLS, ABBREVIATIONS AND PATTERNS
- 701006-05 OFF-RD OPERATIONS, 2L, 2W, 15' TO 24" FROM PAVEMENT EDGE
- 701201-05 LANE CLOSURE 2L, 2W, DAY ONLY, FOR SPEEDS > 45 MPH
- 701301-04 LANE CLOSURE, 2L, 2W, SHORT TIME OPERATIONS
- 701311-03 LANE CLOSURE, 2L, 2W, MOVING OPERATIONS-DAY ONLY
- 701321-19 LANE CLOSURE, 2L, 2W, BRIDGE REPAIR WITH BARRIER
- 701501-06 URBAN LANE CLOSURE, 2L, 2W, UNDIVIDED
- 701901-10 TRAFFIC CONTROL DEVICES
- 704001-08 TEMPORARY CONCRETE BARRIER
- 780001-05 TYPICAL PAVEMENT MARKINGS
- 782006-01 GUARDRAIL AND BARRIER WALL REFLECTOR MOUNTING DETAILS

MAINTENANCE OF TRAFFIC GENERAL NOTES

1. THE MAINTENANCE OF TRAFFIC CONTROL (MOT) PLANS SHALL SERVE AS A GUIDE FOR SAFE DIVERSION OF TRAFFIC DURING EXECUTION OF THIS CONTRACT. HOWEVER, THE CONTRACTOR MAY MODIFY THE MOT PLANS TO MEET CONSTRUCTION NEEDS, BUT NOT AT THE EXPENSE OF PUBLIC SAFETY OR CONVENIENCE. ANY CHANGES TO THE MOT PLANS SHALL BE SUBMITTED TO THE ENGINEER FOR APPROVAL.
2. THE ENGINEER SHALL BE INFORMED 48 HOURS IN ADVANCE OF ANY PROPOSED CHANGE TO THE MOT PLANS.
3. A FULL DEPTH SAWCUT WILL BE REQUIRED BETWEEN PAVEMENT, CURB AND/OR GUTTER TO REMAIN AND PAVEMENT, CURB AND/OR GUTTER TO BE REMOVED PRIOR TO BEGINNING OF REMOVAL WORK. COST TO BE INCLUDED WITH APPLICABLE REMOVAL ITEMS.
4. ALIGNMENT IS BASED ON ILLINOIS DEPARTMENT OF TRANSPORTATION SURVEY COMPLETED AFTER THE ORIGINAL CONSTRUCTION SECTION. STATIONING IS EQUIVALENT TO THE ORIGINAL SECTION STATIONING TRANSCRIBED TO THE ABOVE ALIGNMENT.
5. AS AN ADDITIONAL SOURCE OF INFORMATION IF NEEDED, ORIGINAL CONSTRUCTION SECTION NUMBER FOR STRUCTURE NUMBER 0037-0143 IS 40BR-3.
6. THE CONTRACTOR SHALL CONTACT THE IDOT DISTRICT 2 ENGINEER AT (815)284-2271 A MINIMUM OF 72 HOURS IN ADVANCE OF BEGINNING WORK.

SUGGESTED MAINTENANCE OF TRAFFIC SEQUENCING

STAGE 1

INSTALL TEMPORARY ENTRANCE CLOSURES, ENTRANCE DETOUR, AND MAILBOX RELOCATION AS SHOWN IN THE PLANS.

INSTALL ALL STAGE 1 CONSTRUCTION TRAFFIC CONTROL SIGNALS, SIGNS, DRUMS, BARRICADES, TEMPORARY CONCRETE BARRIER, TEMPORARY IMPACT ATTENUATORS, AND TEMPORARY PAVEMENT MARKINGS AS DETAILED IN STAGE 1 PLANS AND APPROPRIATE STANDARD DRAWINGS. LOCATIONS FOR ADVANCE WARNING SIGNS, TEMPORARY BRIDGE SIGNALS, AND STOP LINES DO NOT CHANGE FROM STAGE 1 TO STAGE 2 UNLESS DIRECTED OTHERWISE BY THE ENGINEER.

MERGE ALL TRAFFIC IN BOTH DIRECTIONS TO THE EXISTING WESTBOUND LANE AND SHOULDER OF SN 037-0143 CROSSING MOSQUITO CREEK.

COORDINATE WORK TO BE COMPLETED IN THIS STAGE WITH DETAILS IN THE BRIDGE PLANS.

STAGE 2

MAINTAIN TEMPORARY ENTRANCE CLOSURES, ENTRANCE DETOUR, AND MAILBOX RELOCATION FROM STAGE 1 AND AS SHOWN IN THE PLANS.

INSTALL ALL STAGE 1 CONSTRUCTION TRAFFIC CONTROL SIGNALS, SIGNS, DRUMS, BARRICADES, TEMPORARY CONCRETE BARRIER, TEMPORARY IMPACT ATTENUATORS, AND TEMPORARY PAVEMENT MARKINGS AS NEEDED TO REFLECT STAGE 2 PLANS AND APPROPRIATE STANDARD DRAWINGS.

MERGE ALL TRAFFIC IN BOTH DIRECTIONS TO THE EXISTING EASTBOUND LANE AND SHOULDER OF SN 037-0143 CROSSING MOSQUITO CREEK.

COORDINATE WORK TO BE COMPLETED IN THIS STAGE WITH DETAILS IN THE BRIDGE PLANS.

POST STAGE

REMOVE TEMPORARY ENTRANCE CLOSURES AND ENTRANCE DETOUR. RESTORE RELOCATED MAILBOXES AS THEY WERE PRIOR TO BEGINNING OF CONSTRUCTION.

REMOVE ALL CONSTRUCTION TRAFFIC CONTROL AND TEMPORARY CONSTRUCTION ITEMS.

REMOVE ANY REMAINING EXISTING TEMPORARY PAVEMENT MARKINGS WITHIN THE PERMANENT PAVEMENT MARKING LIMITS.

INSTALL PERMANENT PAVEMENT MARKINGS TO THE LIMITS SHOWN IN THE PLANS.

STATE OF ILLINOIS
DEPARTMENT OF TRANSPORTATION

US 6 CROSSING MOSQUITO CREEK
SHEET INDEX, MOT GENERAL NOTES, CONSTRUCTION SEQUENCING

F.A.U. RTE.	SECTION	COUNTY	TOTAL SHEETS	SHEET NO.
5789	(40BR-3)BDR	HENRY	19	2
CONTRACT NO. 64R26			ILLINOIS FED. AID PROJECT	

SCALE: SHEET 1 OF 1 SHEETS STA. TO STA.

USER NAME = scottw	DESIGNED - MGB	REVISED -
	DRAWN - MGB	REVISED -
	CHECKED - HJH	REVISED -
PLOT DATE = 11/22/2024	DATE -	REVISED -

CODE NO.	ITEM	UNIT	TOTAL QUANTITY	CONSTRUCTION CODE	
				80% FEDERAL	20% STATE
				BRIDGE	ROADWAY
				0059 SN 037-0143	URBAN
50300300	PROTECTIVE COAT	SQ YD	528	528	
67100100	MOBILIZATION	L SUM	1	1	
70100405	TRAFFIC CONTROL AND PROTECTION, STANDARD 701321	EACH	2	2	
70100450	TRAFFIC CONTROL AND PROTECTION, STANDARD 701201	L SUM	1	1	
70106500	TEMPORARY BRIDGE TRAFFIC SIGNALS	EACH	1	1	
70107025	CHANGEABLE MESSAGE SIGN	CAL DA	60	60	
70307120	TEMPORARY PAVEMENT MARKING - LINE 4" - TYPE IV TAPE	FOOT	2400	2400	
70307210	TEMPORARY PAVEMENT MARKING - LINE 24" - TYPE IV TAPE	FOOT	24	24	
70300150	SHORT TERM PAVEMENT MARKING REMOVAL	SQ FT	1381	1381	
70400100	TEMPORARY CONCRETE BARRIER	FOOT	563	563	
70400200	RELOCATE TEMPORARY CONCRETE BARRIER	FOOT	563	563	
70600250	IMPACT ATTENUATORS, TEMPORARY (NON- REDIRECTIVE), TEST LEVEL 3	EACH	2	2	
70600350	IMPACT ATTENUATORS, RELOCATE (NON- REDIRECTIVE), TEST LEVEL 3	EACH	2	2	
* 78009004	MODIFIED URETHANE PAVEMENT MARKING, TYPE D - LINE 4"	FOOT	3300	3300	

*= SPECIALTY ITEM

MODEL: ###
FILE NAME: C:\Users\scottw\Desktop\WO 9 US 6 Mosquito Creek\Submittals\10-25-24\2024\20-Ph-S001.dgn

Environmental Design International Inc.
Civil, Survey, Environmental and Construction Inspection Services
33 W. MONROE STREET, SUITE 1805, CHICAGO, IL 60603
Ph: (312) 345-1400 Fax (312)345-0529 www.envdesign.com

USER NAME = scottw
DESIGNED - MGB
DRAWN - MGB
CHECKED - HJH
DATE - 11/22/2024

REVISED -
REVISED -
REVISED -
REVISED -

STATE OF ILLINOIS
DEPARTMENT OF TRANSPORTATION

US 6 CROSSING MOSQUITO CREEK
SUMMARY OF QUANTITIES

SCALE: N.A. SHEET 1 OF 3 SHEETS STA. TO STA.

F.A.U. RTE.	SECTION	COUNTY	TOTAL SHEETS	SHEET NO.
5789	(40BR-3)BDR	HENRY	19	3
CONTRACT NO. 64T20			ILLINOIS FED. AID PROJECT	

CODE NO.	ITEM	UNIT	TOTAL QUANTITY	CONSTRUCTION CODE	
				80% FEDERAL 20% STATE	
				BRIDGE	ROADWAY
				0059 SN 037-0143	URBAN
78300202	PAVEMENT MARKING REMOVAL-WATER BLASTING	SQ FT	744	744	
X0327301	RELOCATE EXISTING MAILBOX	EACH	2	2	
X5030250	BRIDGE DECK GROOVING (LONGITUDINAL)	SQ YD	291	291	
* X7820007	GUARDRAIL REFLECTORS, TYPE C (SPECIAL)	EACH	38	38	
40200500	AGGREGATE SURFACE COURSE, TYPE A 6"	SQ YD	76	76	
Z0012164	BRIDGE DECK MICROSILICA CONCRETE OVERLAY, 2½"	SQ YD	528	528	
Z0012142	BRIDGE DECK SCARIFICATION 2¼"	SQ YD	528	528	
Z0016001	DECK SLAB REPAIR (FULL DEPTH, TYPE I)	SQ YD	35	35	
Z0016002	DECK SLAB REPAIR (FULL DEPTH, TYPE II)	SQ YD	15	15	
Z0029090	DIAMOND GRINDING (BRIDGE SECTION)	SQ YD	442	442	
* = SPECIALTY ITEM					

MODEL: ###
FILE NAME: C:\Users\scottw\Drawings\WO 9 US 6 Mosquito Creek\Submittals\10-25-24\10241720-shr-SOC2.dgn

Environmental
Civil, Survey, Environ
and Construction Inspection Services
33 W. MONROE ST
SUITE 1025, CHICAGO, IL 60603
PH: (312) 345-1400
www.envirodesign.com

USER NAME = scottw	DESIGNED - MGB	REVISED -
	DRAWN - MGB	REVISED -
	CHECKED - HJH	REVISED -
PLOT DATE = 11/22/2024	DATE -	REVISED -

STATE OF ILLINOIS
DEPARTMENT OF TRANSPORTATION

US 6 CROSSING MOSQUITO CREEK
SUMMARY OF QUANTITIES

SCALE: N.A. SHEET 2 OF 3 SHEETS STA. TO STA.

F.A.U. RTE. 5789	SECTION (40BR-3)BDR	COUNTY HENRY	TOTAL SHEETS 19	SHEET NO. 4
CONTRACT NO. 64T20			ILLINOIS FED. AID PROJECT	

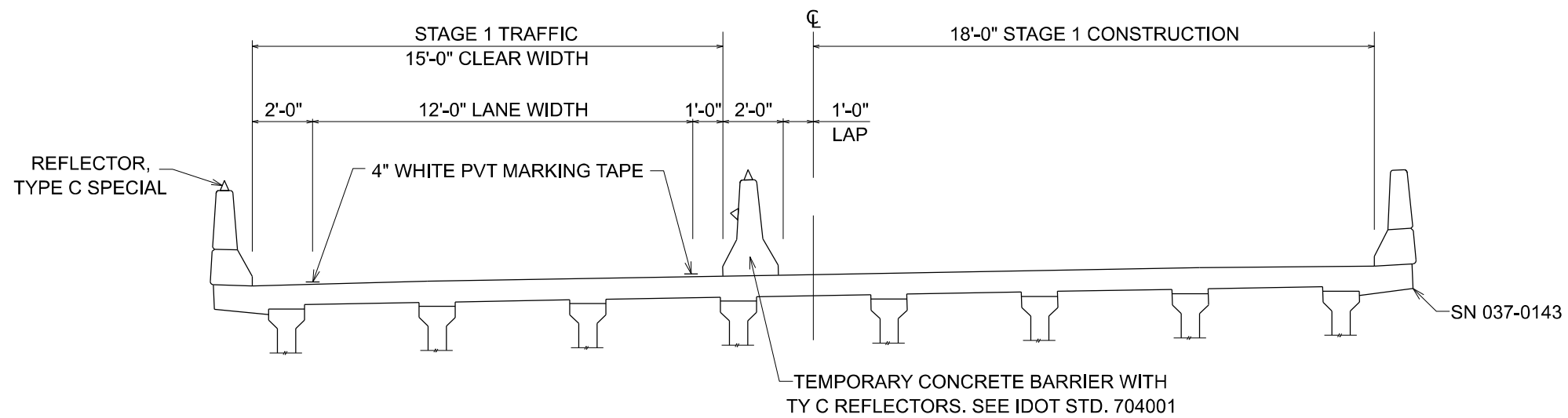

STAGE 1

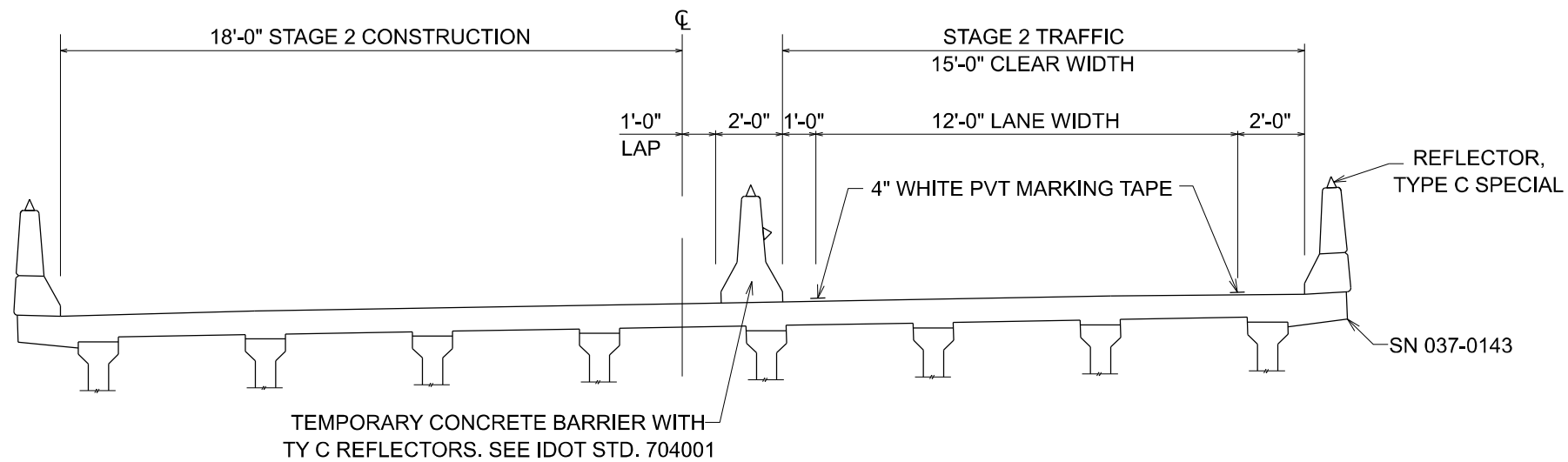

STAGE 2

MODEL: D264R26-TYPEC-MOT (Sheet)
 FILE NAME: L:\8008.KPFF\8008.001\PTB 206.023 Bridge Rehab (23903)\WO 8 - US-6 over Mosquito Creek\Civil\03 CAD\01 Model\264R26-TYPEC-MOT.dgn

EDI Excellence. Dedication. Innovation.
 Environmental Design International Inc.
 Civil, Survey, Environmental and Construction Inspection Services
 33 W. MONROE STREET, SUITE 1025, CHICAGO, IL 60603
 PH: (312) 345-1400 FAX: (312) 345-5529 www.ediintl.com

USER NAME = mbulting	DESIGNED - MGB	REVISED -
	DRAWN - MGB	REVISED -
	CHECKED - HJH	REVISED -
PLOT DATE = 9/6/2024	DATE -	REVISED -

STATE OF ILLINOIS
DEPARTMENT OF TRANSPORTATION

US 6 CROSSING MOSQUITO CREEK
MAINTENANCE OF TRAFFIC TYPICAL SECTION

SCALE: NTS SHEET 1 OF 1 SHEETS STA. TO STA.

F.A.U. RTE.	SECTION	COUNTY	TOTAL SHEETS	SHEET NO.
5789	(40BR-3)BDR	HENRY	19	5
CONTRACT NO. 64T20				
ILLINOIS FED. AID PROJECT				

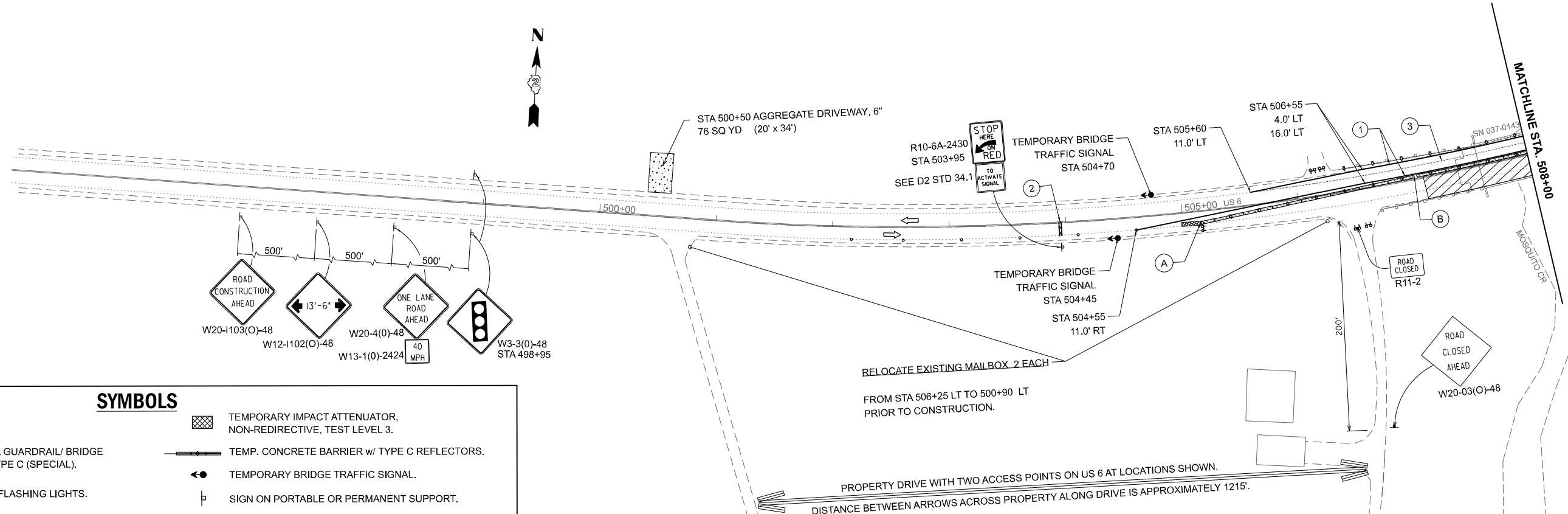

SYMBOLS

	WORK AREA.		TEMPORARY IMPACT ATTENUATOR, NON-REDIRECTIVE, TEST LEVEL 3.
	DRUM.		TEMP. CONCRETE BARRIER w/ TYPE C REFLECTORS.
	CRYSTAL, BIDIRECTIONAL GUARDRAIL/ BRIDGE PARAPET REFLECTOR, TYPE C (SPECIAL).		TEMPORARY BRIDGE TRAFFIC SIGNAL.
	TYPE III BARRICADE WITH FLASHING LIGHTS.		SIGN ON PORTABLE OR PERMANENT SUPPORT.

RELOCATE EXISTING MAILBOX - 2 EACH
 FROM STA 506+25 LT TO 500+90 LT PRIOR TO CONSTRUCTION.

PROPERTY DRIVE WITH TWO ACCESS POINTS ON US 6 AT LOCATIONS SHOWN.
 DISTANCE BETWEEN ARROWS ACROSS PROPERTY ALONG DRIVE IS APPROXIMATELY 1215'.

CALLOUT INDEX

- PAVEMENT MARKING TAPE, TYPE IV, 4" WHITE
- PAVEMENT MARKING TAPE, TYPE IV, 24" WHITE
- PAVEMENT MARKING REMOVAL-WATER BLASTING
- DRUMS 10' C-C INCLUDED IN ITEM TRAFFIC CONTROL & PROTECTION 701321

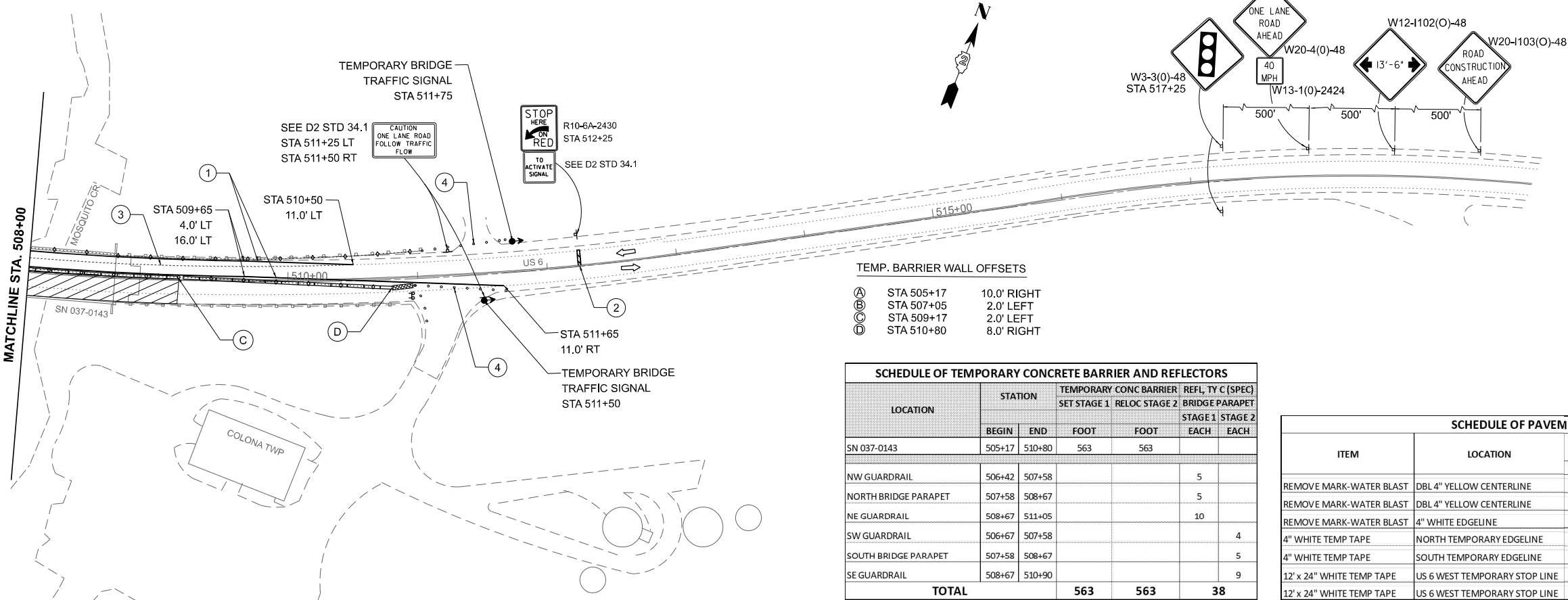

TEMP. BARRIER WALL OFFSETS

A	STA 505+17	10.0' RIGHT
B	STA 507+05	2.0' LEFT
C	STA 509+17	2.0' LEFT
D	STA 510+80	8.0' RIGHT

SCHEDULE OF TEMPORARY CONCRETE BARRIER AND REFLECTORS

LOCATION	STATION		TEMPORARY CONC BARRIER		REFL, TY C (SPEC)	
	BEGIN	END	FOOT	FOOT	BRIDGE PARAPET	
					STAGE 1	STAGE 2
SN 037-0143	505+17	510+80	563	563		
NW GUARDRAIL	506+42	507+58			5	
NORTH BRIDGE PARAPET	507+58	508+67			5	
NE GUARDRAIL	508+67	511+05			10	
SW GUARDRAIL	506+67	507+58			4	
SOUTH BRIDGE PARAPET	507+58	508+67			5	
SE GUARDRAIL	508+67	510+90			9	
TOTAL			563	563	38	

SCHEDULE OF PAVEMENT MARKING AND REMOVAL - STAGE 1

ITEM	LOCATION	STATION		O-FSET		PAVEMENT MK TEMPORARY		PMK REMOVAL PERMANENT
		BEGIN	END	MIN	MAX	FOOT (4")	FOOT (24")	SQ FT
REMOVE MARK-WATER BLAST	DBL 4" YELLOW CENTERLINE	504+00	507+10	0' RT	0' LT			207
REMOVE MARK-WATER BLAST	DBL 4" YELLOW CENTERLINE	509+10	512+25	0' RT	0' LT			210
REMOVE MARK-WATER BLAST	4" WHITE EDGELINE	505+60	510+50	11' LT	11' LT			327
4" WHITE TEMP TAPE	NORTH TEMPORARY EDGELINE	505+60	510+50	11' LT	16' LT	490		
4" WHITE TEMP TAPE	SOUTH TEMPORARY EDGELINE	504+55	511+65	11' RT	0' LT	710		
12' x 24" WHITE TEMP TAPE	US 6 WEST TEMPORARY STOP LINE	503+95 RT						12
12' x 24" WHITE TEMP TAPE	US 6 WEST TEMPORARY STOP LINE	512+25 LT						12

MODEL: US6-7 (Sheet)
 FILE NAME: L:\8008 KPF\8008.001\PTB 206.023 Bridge_Rehab (23903)\WO 8 - US-6 over Mosquito Creek\Civil\03 CAD\01 Model\264T20-staging1.dgn

USER NAME = mbuiling	DESIGNED -	REVISED -
	DRAWN -	REVISED -
	CHECKED -	REVISED -
PLOT DATE = 9/4/2024	DATE -	REVISED -

**STATE OF ILLINOIS
 DEPARTMENT OF TRANSPORTATION**

**US 6 CROSSING MOSQUITO CREEK
 MAINTENANCE OF TRAFFIC PLAN STAGE 1**

SCALE: SHEET 1 OF 2 SHEETS STA. 498+95.00 TO STA. 517+25.00

F.A.U. RTE. 5789	SECTION (40BR-3)BDR	COUNTY HENRY	TOTAL SHEETS 19	SHEET NO. 6
CONTRACT NO. 64T20				
ILLINOIS FED. AID PROJECT				

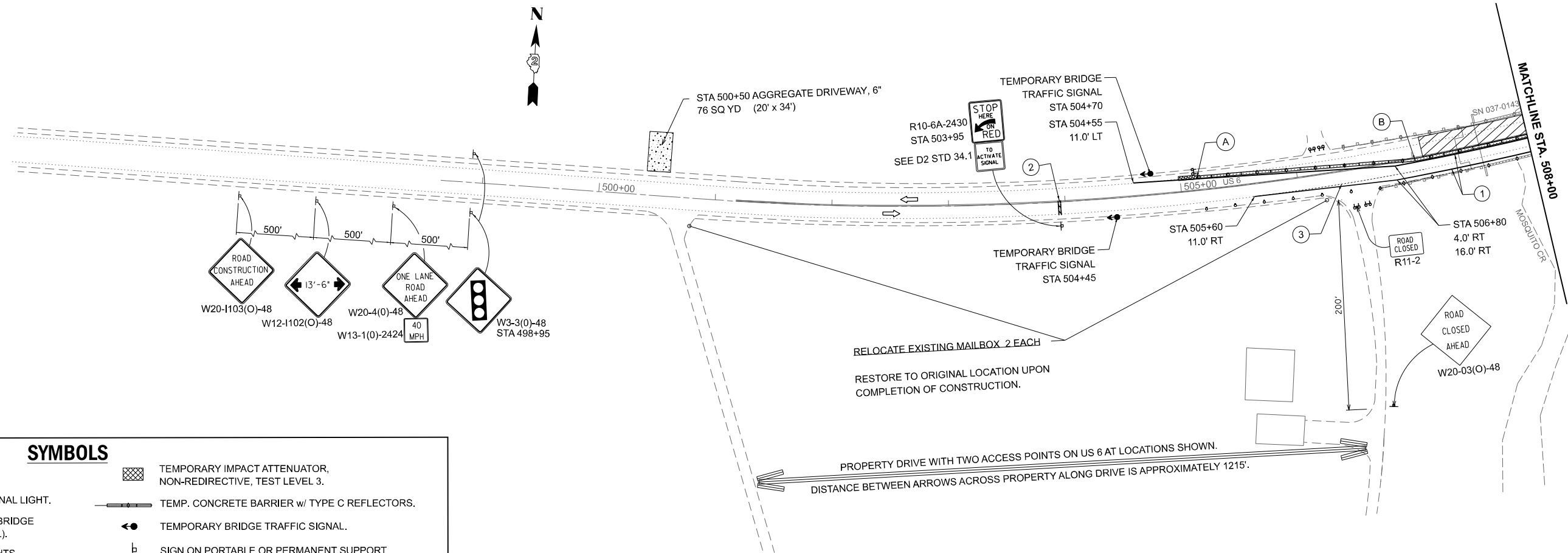

SYMBOLS

	WORK AREA.		TEMPORARY IMPACT ATTENUATOR, NON-REDIRECTIVE, TEST LEVEL 3.
	DRUM.		TEMP. CONCRETE BARRIER w/ TYPE C REFLECTORS.
	DRUM WITH STEADY BURN BI-DIRECTIONAL LIGHT.		TEMPORARY BRIDGE TRAFFIC SIGNAL.
	CRYSTAL, BIDIRECTIONAL GUARDRAIL/ BRIDGE PARAPET REFLECTOR, TYPE C (SPECIAL).		SIGN ON PORTABLE OR PERMANENT SUPPORT.
	TYPE III BARRICADE WITH FLASHING LIGHTS.		

CALLOUT INDEX

- ① PAVEMENT MARKING TAPE, TYPE IV, 4" WHITE
- ② PAVEMENT MARKING TAPE, TYPE IV, 24" WHITE
- ③ PAVEMENT MARKING REMOVAL-WATER BLASTING
- ④ DRUMS 10' C-C INCLUDED IN ITEM TRAFFIC CONTROL & PROTECTION 701321

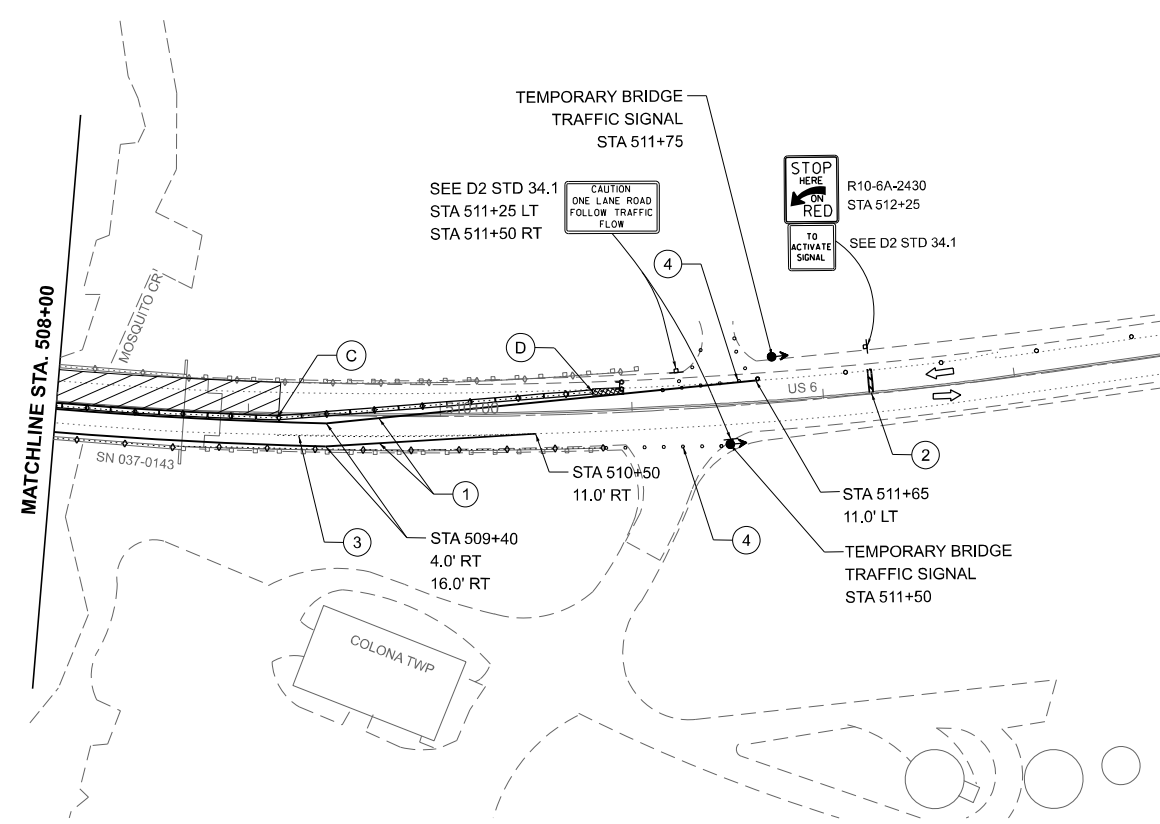

TEMP. BARRIER WALL OFFSETS

Ⓐ	STA 505+17	10.0' LEFT
Ⓑ	STA 507+05	2.0' RIGHT
Ⓒ	STA 509+17	2.0' RIGHT
Ⓓ	STA 510+80	8.0' LEFT

SCHEDULE OF TEMPORARY CONCRETE BARRIER AND REFLECTORS

LOCATION	STATION		TEMPORARY CONC BARRIER		REFL, TY C (SPEC)	
	BEGIN	END	SET STAGE 1	RELOC STAGE 2	BRIDGE	PARAPET
SN 037-0143	505+17	510+80	563	563		
NW GUARDRAIL	506+42	507+58			5	
NORTH BRIDGE PARAPET	507+58	508+67			5	
NE GUARDRAIL	508+67	511+05			10	
SW GUARDRAIL	506+67	507+58			4	
SOUTH BRIDGE PARAPET	507+58	508+67			5	
SE GUARDRAIL	508+67	510+90			9	
TOTAL			563	563	38	

SCHEDULE OF PAVEMENT MARKING AND REMOVAL - STAGE 2

ITEM	LOCATION	STATION		O-FSET		PAVEMENT MK TEMPORARY FOOT (4")	PMK REMOVAL TEMPORARY SQ FT
		BEGIN	END	MIN	MAX		
TEMP MARKING REMOVAL	NORTH EDGELINE STAGE 1	505+60	507+10	11' LT	16' LT		100
TEMP MARKING REMOVAL	NORTH EDGELINE STAGE 1	509+10	510+50	11' LT	16' LT		93
TEMP MARKING REMOVAL	SOUTH EDGELINE STAGE 1	504+55	507+10	11' RT	0' LT		170
TEMP MARKING REMOVAL	SOUTH EDGELINE STAGE 1	509+10	511+65	11' RT	0' LT		170
4" WHITE TEMP TAPE	NORTH EDGELINE	504+55	511+65	11' LT	0' RT	710	
4" WHITE TEMP TAPE	SOUTH EDGELINE	505+60	510+50	11' RT	16' RT	490	

SCHEDULE OF PAVEMENT MARKING REMOVAL AND PERMANENT PAVEMENT MARKING - POST STAGE

ITEM	LOCATION	STATION		O-FSET		PAVEMENT MK PERMANENT FOOT (4")	PMK REMOVAL TEMPORARY SQ FT
		BEGIN	END	MIN	MAX		
TEMP MARKING REMOVAL	N EDGELINE STAGE 2	504+55	511+65	11' LT	0' RT		473
TEMP MARKING REMOVAL	S EDGELINE STAGE 2	505+60	510+50	11' RT	16' RT		327
TEMP MARKING REMOVAL	US 6 WEST TEMPORARY STOP LINE	503+95 RT					24
TEMP MARKING REMOVAL	US 6 WEST TEMPORARY STOP LINE	512+25 LT					24
PERMANENT 4" DBL YELLOW	CENTERLINE	504+00	512+25	0' RT	0' LT	1650	
PERMANENT 4" DBL YELLOW	SOUTH EDGELINE	504+00	512+25	11' RT	11' RT	825	
PERMANENT 4" DBL YELLOW	NORTH EDGELINE	504+00	512+25	11' LT	11' LT	825	

MODEL: US6-8 (Sheet) FILE NAME: L:\8008 KPF\8008.001\PTB 2006.023 Bridge_Rehab (23903)\WO 8 - US-6 over Mosquito Creek\Civil\03 CAD\01 Model\DWG\T20-staging2.dgn

USER NAME = mbuiting	DESIGNED -	REVISED -
	DRAWN -	REVISED -
	CHECKED -	REVISED -
PLOT DATE = 9/4/2024	DATE -	REVISED -

**STATE OF ILLINOIS
DEPARTMENT OF TRANSPORTATION**

**US 6 CROSSING MOSQUITO CREEK
MAINTENANCE OF TRAFFIC PLAN STAGE 2**

SCALE: SHEET 2 OF 2 SHEETS STA. 498+95.00 TO STA. 517+25.00

F.A.U. RTE.	SECTION	COUNTY	TOTAL SHEETS	SHEET NO.
5789	(40BR-3)BDR	HENRY	19	7
CONTRACT NO.				
ILLINOIS FED. AID PROJECT				

SCOPE OF WORK

- Ⓐ Scarify existing deck and west approach pavement 2 1/4", install new 2 1/2" microsilica concrete overlay, diamond grinding 1/4"
- Ⓑ Deck Slab Repairs

GENERAL NOTES

The structure number will remain the same SN 037-0143.
 Plan dimensions and details relative to the existing plans are subject to nominal construction variations. The Contractor shall field verify existing dimensions and details affecting new construction and make necessary approved adjustments prior to construction or ordering materials. Such variations shall not be cause for additional compensation for a change in scope of the work, however, the Contractor will be paid for the quantity actually furnished at the unit price bid for the work. Traffic will be staged during construction.
 The Contractor shall contact IDOT District 2 Engineer at 815-284-2271 a minimum of 72 hours before beginning work.
 Protective coat shall be applied to superstructure concrete areas and all new concrete overlays on the deck surface.

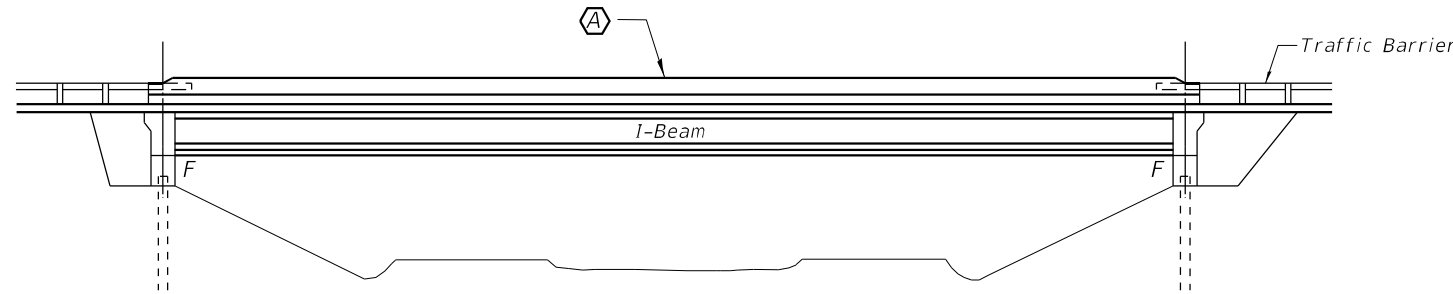

ELEVATION

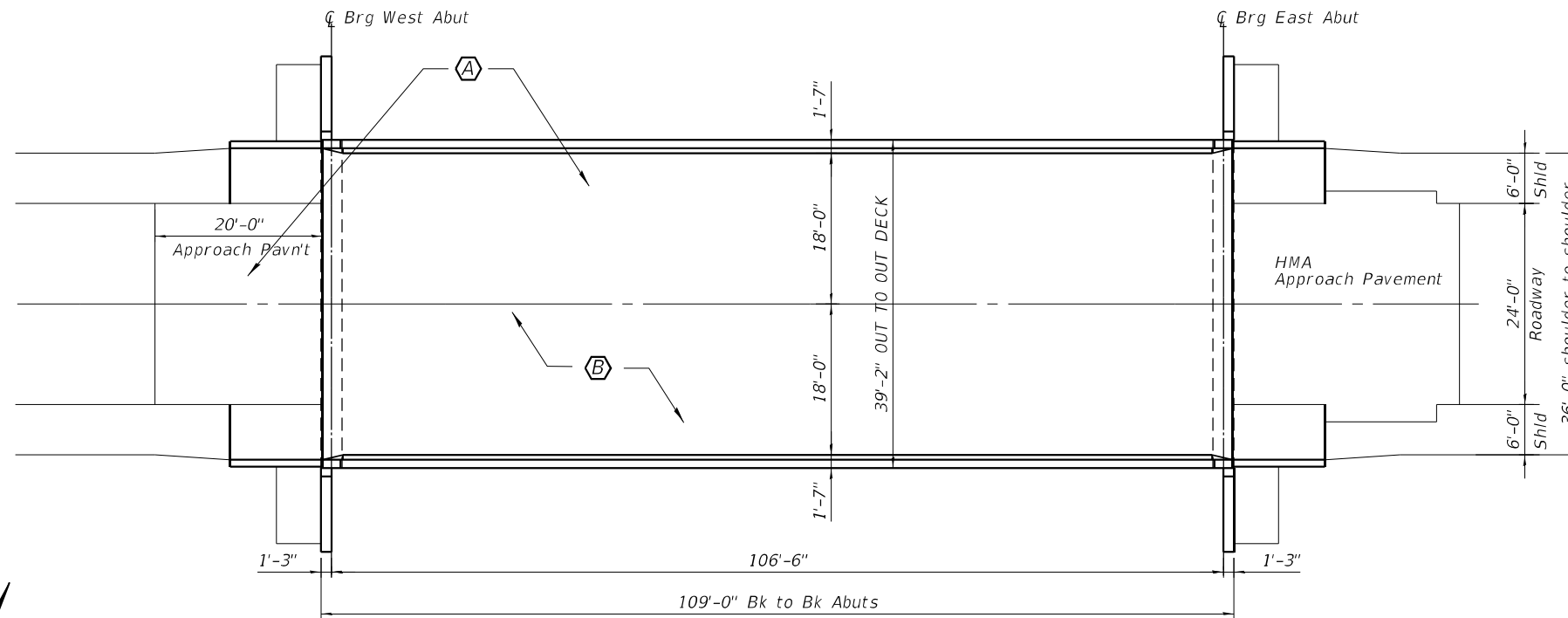

PLAN

TOTAL BILL OF MATERIAL

(SN 037-0143)

ITEM	UNIT	TOTAL
Protective Coat	Sq. Yd.	528
Diamond Grinding	Sq. Yd.	442
Bridge Deck Scarification, 2 1/4"	Sq. Yd.	528
Microsilica Concrete Overlay, 2 1/2"	Sq. Yd.	528
Bridge Deck Grooving (Longitudinal)	Sq. Yd.	291
Deck Slab Repair (Full Depth Type I)	Sq. Yd.	35
Deck Slab Repair (Full Depth Type II)	Sq. Yd.	15

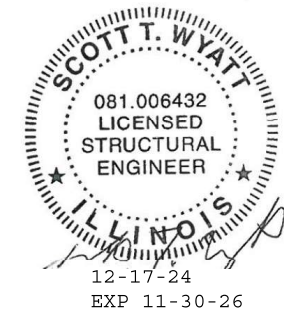

MODEL: Default
 FILE NAME: \\kpff.com\dfs\Bridges\2400328 (WCO #9 - SN 037-0143)\02_Design (MS)\8 - Plan & Elev.dgn
 3139 N. Lincoln Ave, Suite 210B
 Chicago, IL 60657
 847-859-7790
 www.kpff.com

USER NAME =	DESIGNED -	REVISED -
PLOT SCALE =	CHECKED -	REVISED -
PLOT DATE =	DRAWN -	REVISED -
	CHECKED -	REVISED -

**STATE OF ILLINOIS
 DEPARTMENT OF TRANSPORTATION**

**U.S. ROUTE 6 OVER MOSQUITO CREEK
 PLAN AND ELEVATION**

F.A.U. RTE.	SECTION	COUNTY	TOTAL SHEETS	SHEET NO.
5789	(40BR-3)BDR	HENRY	19	8
CONTRACT NO. 64T20				
ILLINOIS FED. AID PROJECT				

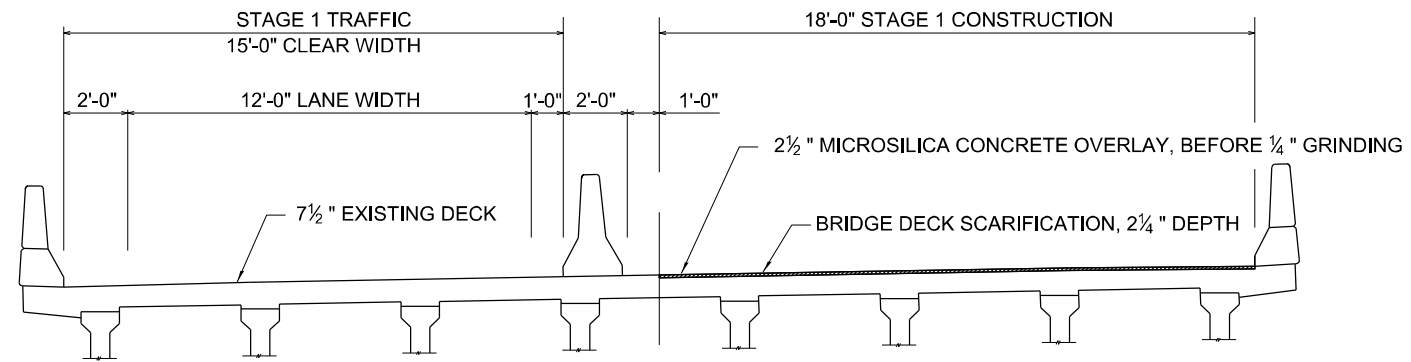

Typical Section Stage I

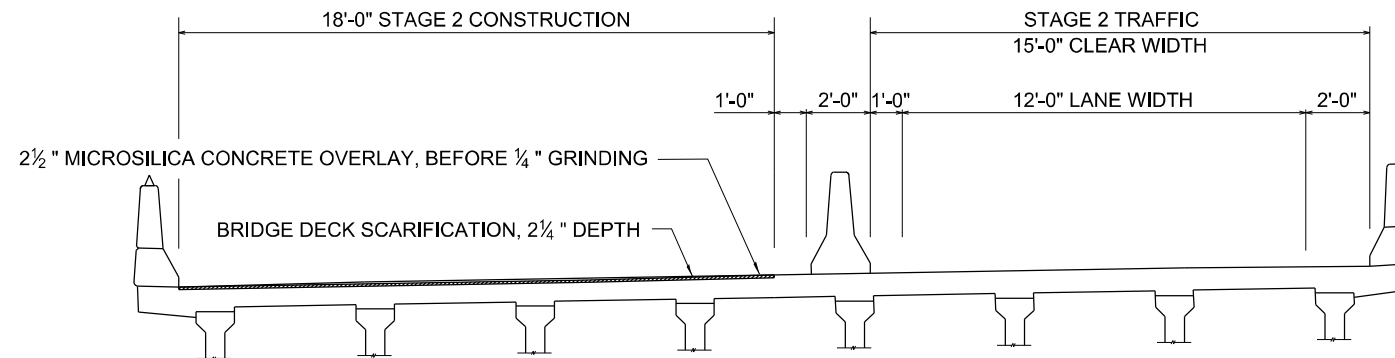

Typical Section Stage II

MODEL: Default
 FILE NAME: \\kpff.com\dfs\Brdge\2400328 (WC #9 - SN 037-0143)\02_Design (MS)\10 - Typical Section.dgn



kpff
 3139 N. Lincoln Ave, Suite 210B
 Chicago, IL 60657
 847-859-7790
 www.kpff.com

USER NAME =	DESIGNED -	REVISED -
PLOT SCALE =	CHECKED -	REVISED -
PLOT DATE =	DRAWN -	REVISED -
	CHECKED -	REVISED -

STATE OF ILLINOIS
 DEPARTMENT OF TRANSPORTATION

U.S. ROUTE 6 OVER MOSQUITO CREEK
 TYPICAL SECTION

F.A.U. RTE.	SECTION	COUNTY	TOTAL SHEETS	SHEET NO.
5789	(40BR-3)BDR	HENRY	19	9
CONTRACT NO. 64T20				
ILLINOIS FED. AID PROJECT				

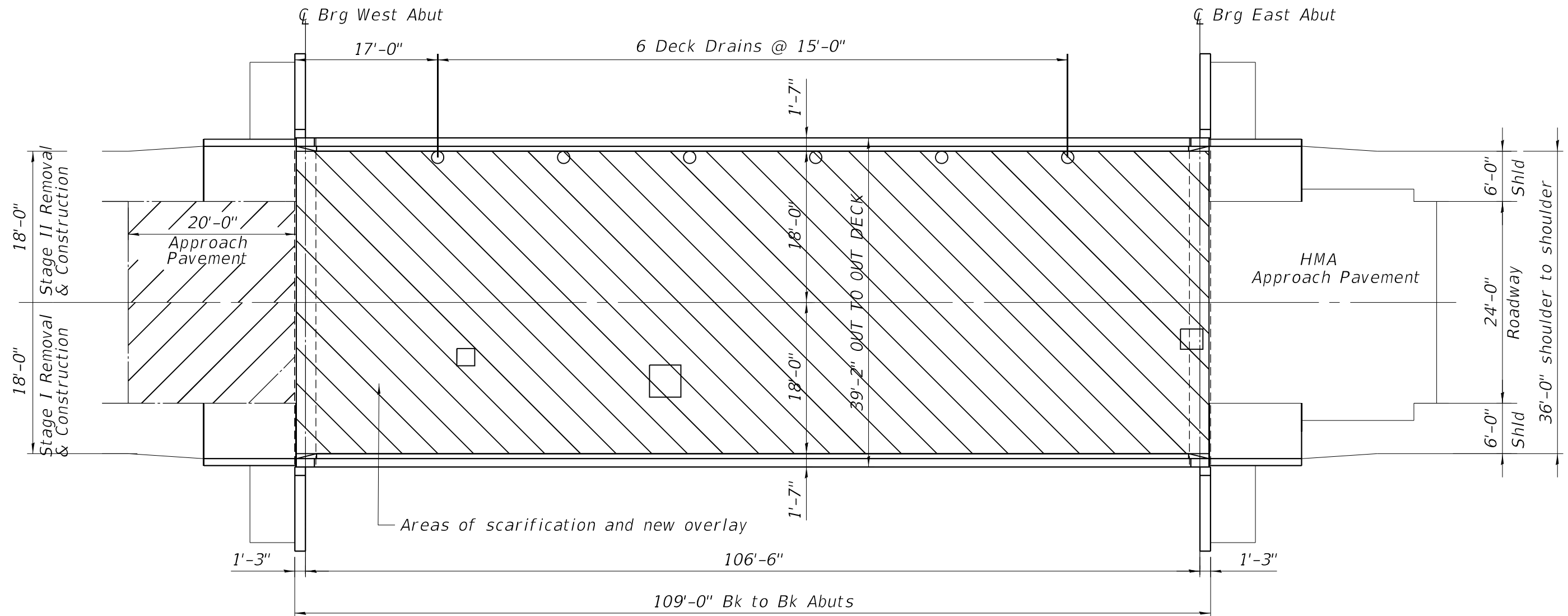

□ Areas of potential deck slab repair, date of survey 9-2-24.
Deck to be evaluated by the Engineer after scarification for areas of repairs.

PLAN

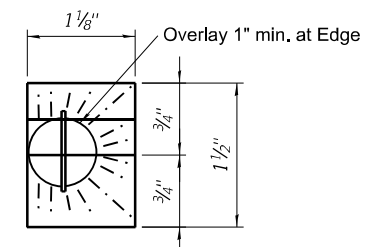

Top Plan @ Floor Drains

MODEL: Default
FILE NAME: \\kpf.com\dfs\Brdge\240328 (WC #9 - SN 037-0143)\02_Design (MS)\10 - Deck Overlay.dgn



USER NAME =	DESIGNED -	REVISED -
PLOT SCALE =	CHECKED -	REVISED -
PLOT DATE =	DRAWN -	REVISED -
	CHECKED -	REVISED -

STATE OF ILLINOIS
DEPARTMENT OF TRANSPORTATION

U.S. ROUTE 6 OVER MOSQUITO CREEK
SN 037-0143 DECK REPAIRS

F.A.U. RTE.	SECTION	COUNTY	TOTAL SHEETS	SHEET NO.
5789	(40BR-3)BDR	HENRY	19	10
CONTRACT NO. 64T20				

ILLINOIS FED. AID PROJECT

WORK ZONE SIGN DETAILS

ILLINOIS STANDARD G20-I100

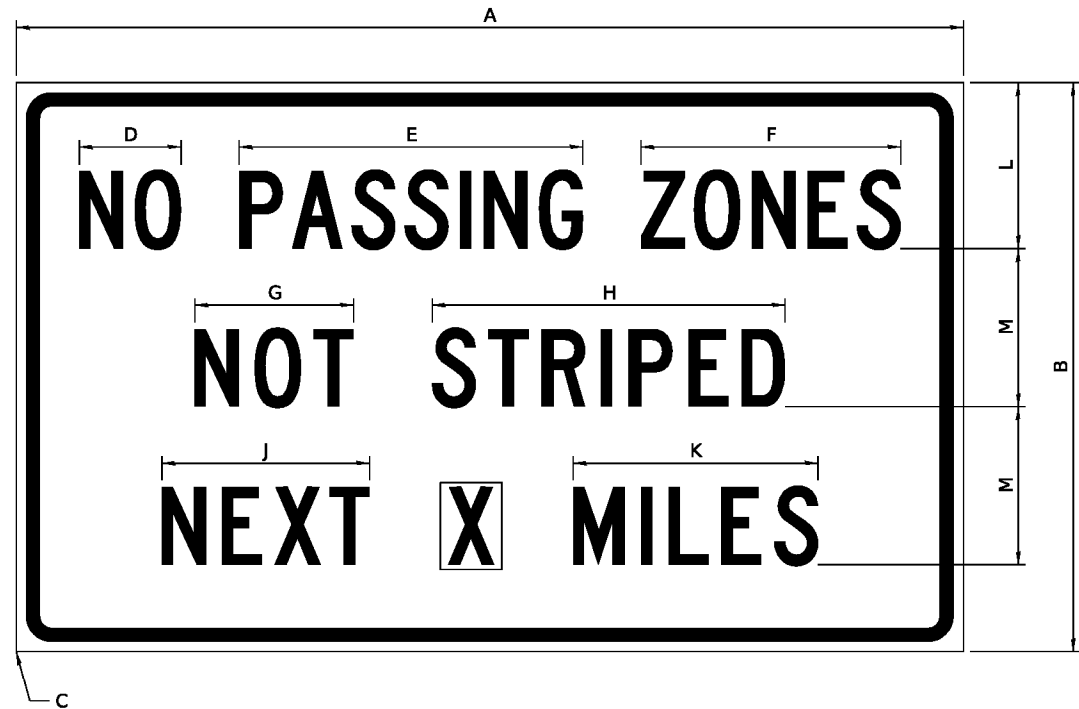

COLOR LEGEND AND BORDER BACKGROUND BLACK ORANGE NON-REFLECTORIZED REFLECTORIZED

SIGN SIZE	DIMENSIONS											
	A	B	C	D	E	F	G	H	J	K	L	M
60 x 36	60.00	36.00	2.25	6.4	21.80	16.40	10.00	22.40	13.20	15.50	10.50	10.00

SIGN SIZE	SERIES BY LINE			MARGIN	BORDER
	1	2	3		
60 x 36	5C	5C	5C	0.625	0.875

Sign not to scale

GENERAL NOTES

All work to furnish and install these signs shall be included in the cost of the specified traffic control standards and shall not be paid separately.

All Illinois Standard signs shall conform to the latest edition of the "Illinois Standard Highway Signs Book" in effect on the date of invitation for bids.

Signs shall meet the applicable portions of Sections 701 and 720 of the Standard Specifications.

All dimensions are in inches unless otherwise noted.

ILLINOIS STANDARD W8-I107

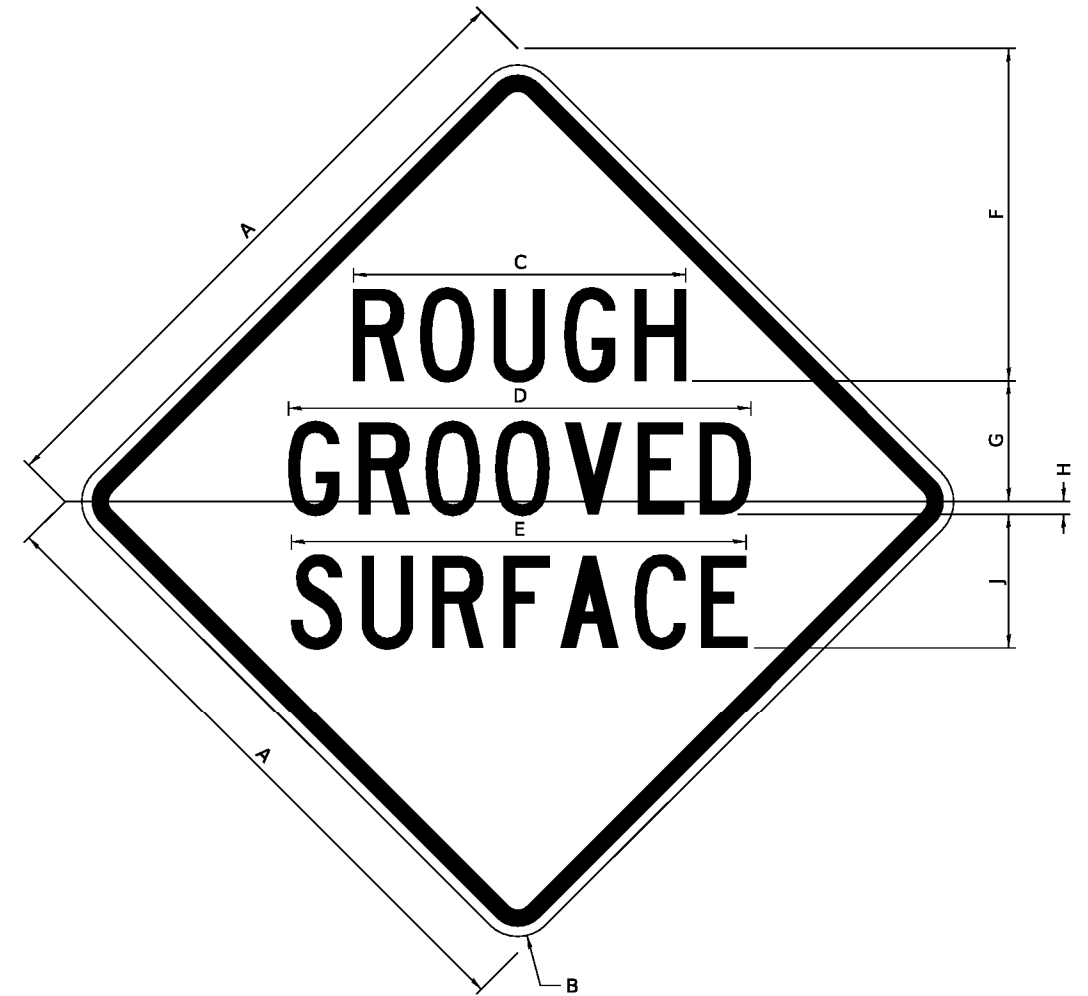

COLOR LEGEND AND BORDER BACKGROUND BLACK ORANGE NON-REFLECTORIZED REFLECTORIZED

SIGN SIZE	DIMENSIONS									
	A	B	C	D	E	F	G	H	J	
48 x 48	48.00	3.00	25.00	34.80	34.20	24.94	9.00	1.00	10.00	

SIGN SIZE	SERIES BY LINE			MARGIN	BORDER
	1	2	3		
48 x 48	7C	7C	7C	1.250	0.750

Sign not to scale

MODEL: Default FILE NAME: L:\81008 KPF\8008.001\PTB 206.023 Bridge Rehab (2300)\WC 8 - US-6 over Mosquito Creek\CAD\01 Model\ID-2 Specific Standards\ID264720-std 34_1.sht1.dgn

USER NAME = mbuting	DESIGNED - MGB	REVISED - 3-02-16
	DRAWN - MGB	REVISED -
	CHECKED - HJH	REVISED -
PLOT DATE = 9/4/2024	DATE -	REVISED -

**STATE OF ILLINOIS
DEPARTMENT OF TRANSPORTATION**

**US 6 CROSSING MOSQUITO CREEK
REGION 2 / DISTRICT 2 STANDARD**

FAU. RTE.	SECTION	COUNTY	TOTAL SHEETS	SHEET NO.
5789	(40BR-3)BDR	HENRY	19	11
CONTRACT NO. 64T20				
ILLINOIS FED. AID PROJECT				

SCALE: N.A. SHEET 1 OF 4 SHEETS STA. TO STA.

ILLINOIS STANDARD W12-I102 WORK ZONE SIGN DETAILS

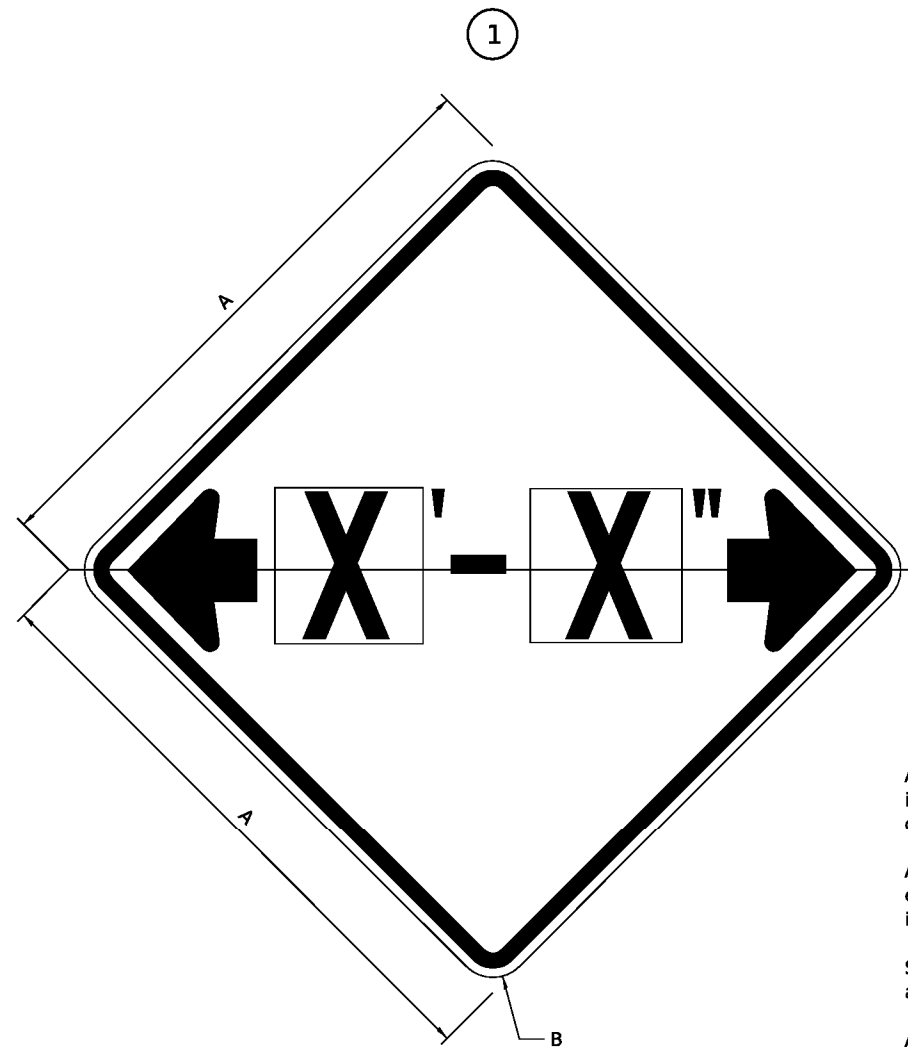

GENERAL NOTES

All work to furnish and install these signs shall be included in the cost of the specified traffic control standards and shall not be paid separately.

All Illinois Standard signs shall conform to the latest edition of the "Illinois Standard Highway Signs Book" in effect on the date of invitation for bids.

Signs shall meet the applicable portions of Sections 701 and 720 of the Standard Specifications.

All dimensions are in inches unless otherwise noted.

COLOR LEGEND AND BORDER BACKGROUND BLACK FL ORANGE NON-REFLECTORIZED REFLECTORIZED

SIGN SIZE	DIMENSIONS	
	A	B
48 x 48	48.00	3.00

① Illinois Standard signs W12-I102 and W12-I103 shall be used as described in the special provisions.

SIGN SIZE	SERIES BY LINE	MARGIN	BORDER
	1		
48 x 48	12C	0.750	1.250

Sign not to scale

ILLINOIS STANDARD W12-I103

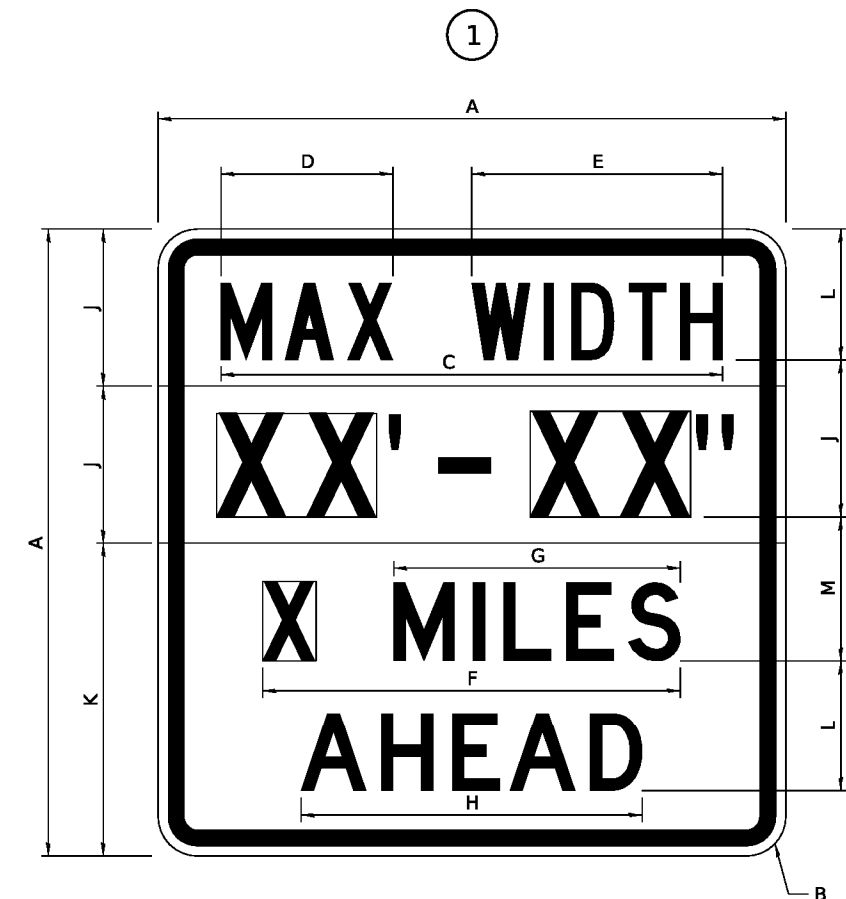

COLOR LEGEND AND BORDER BACKGROUND BLACK FL ORANGE NON-REFLECTORIZED REFLECTORIZED

SIGN SIZE	DIMENSIONS											
	A	B	C	D	E	F	G	H	J	K	L	M
48 x 48	48.00	3.00	38.40	13.20	19.20	32.00	22.00	26.20	12.00	24.00	10.00	11.00

SIGN SIZE	SERIES BY LINE				MARGIN	BORDER
	1	2	3	4		
48 x 48	6C	8D	6D	6D	0.750	1.250

Sign not to scale

XX'-XX" WIDTH AND X MILES ARE VARIABLE TOP AND BOTTOM OF BACKGROUND WHITE

MODEL: Default
FILE NAME: L:\8008 KPF08008.001\PTB 206.023 Bridge Rehab (23909)\WO 8 - US-6 over Mosquito Creek\I103 CAD\01 Model\2 Specific Standards\2641720-std 34.1-sh2.dgn

USER NAME = mbuting	DESIGNED - MGB	REVISED - 3-02-16
	DRAWN - MGB	REVISED -
	CHECKED - HJH	REVISED -
PLOT DATE = 8/23/2024	DATE -	REVISED -

STATE OF ILLINOIS
DEPARTMENT OF TRANSPORTATION

US 6 CROSSING MOSQUITO CREEK
REGION 2 / DISTRICT 2 STANDARD

F.A.U. RTE. 5789	SECTION (40BR-3)BDR	COUNTY HENRY	TOTAL SHEETS 19	SHEET NO. 12
CONTRACT NO. 64T20				ILLINOIS FED. AID PROJECT

SCALE: N.A. SHEET 2 OF 4 SHEETS STA. TO STA.

WORK ZONE SIGN DETAILS

STOP LINE SIGN FOR TEMPORARY SIGNALS

ROAD CLOSED TO OVERSIZED LOADS

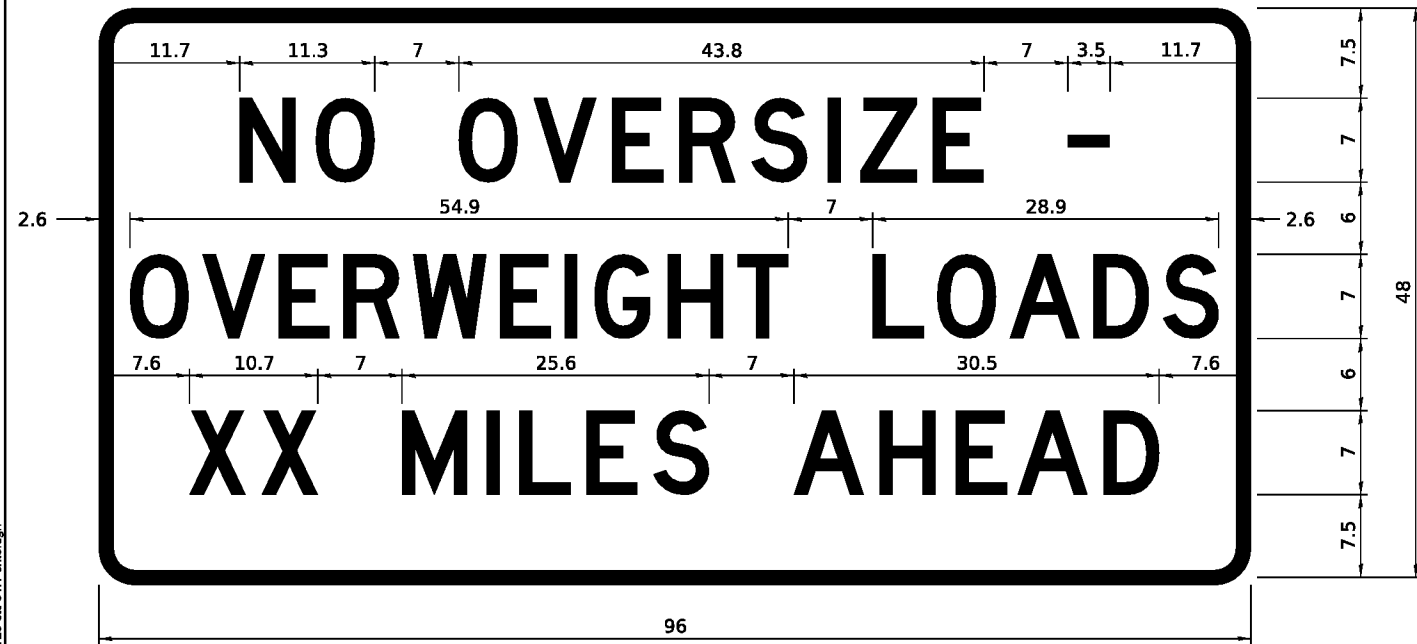

COLOR LEGEND AND BORDER BACKGROUND BLACK ORANGE NON-REFLECTORIZED REFLECTORIZED

Permit Loads - Loads Over 13 Feet; 3.0" Radius, 1.3" Border;
 [NO OVERSIZE -] D; [OVERWEIGHT LOADS] D 85% spacing; [XX MILES AHEAD] D;
 Table of letter and object lefts.

N	O	O	V	E	R	S	I	Z	E	-
11.7	18.1	30.0	36.2	42.8	48.4	54.4	60.7	63.5	69.5	80.8

O	V	E	R	W	E	I	G	H	T	L	O	A	D	S
2.6	8.6	15.0	20.4	26.2	33.4	38.8	41.3	47.4	53.2	64.5	69.9	75.9	82.9	88.7

X	X	M	I	L	E	S	A	H	E	A	D
7.6	13.6	25.3	32.3	35.1	40.6	46.2	57.9	65.1	71.4	76.6	83.7

Sign not to scale

COLOR LEGEND AND BORDER BACKGROUND BLACK WHITE NON-REFLECTORIZED REFLECTORIZED

SIGN SIZE	SERIES BY LINE		
	1	2	3
24 x 24	4C	4C	4C

Sign not to scale

GENERAL NOTES

All work to furnish and install these signs shall be included in the cost of the specified traffic control standards and shall not be paid separately.

All Illinois Standard signs shall conform to the latest edition of the "Illinois Standard Highway Signs Book" in effect on the date of invitation for bids.

Signs shall meet the applicable portions of Sections 701 and 720 of the Standard Specifications.

All dimensions are in inches unless otherwise noted.

MODEL: Default FILE NAME: L:\8008 KFFB\8008.001\PTB 206.023 Bridge Rehab (23903)\WO 8 - US-4 over Mosquito Creek\Civil\03 CAD\01 Model\D-2 Specific Standards\264T20-std 34_1-std13.dgn

USER NAME = mbulting	DESIGNED - MGB	REVISED - 3-02-16
	DRAWN - MGB	REVISED -
	CHECKED - HJH	REVISED -
PLOT DATE = 9/4/2024	DATE -	REVISED -

STATE OF ILLINOIS
DEPARTMENT OF TRANSPORTATION

US 6 CROSSING MOSQUITO CREEK
REGION 2 / DISTRICT 2 STANDARD

SCALE: N.A. SHEET 3 OF 4 SHEETS STA. TO STA.

F.A.U. RTE.	SECTION	COUNTY	TOTAL SHEETS	SHEET NO.
6789	(40BR-3)BDR	HENRY	19	13
CONTRACT NO. 64T20				
ILLINOIS FED. AID PROJECT				

**ENTRANCE SIGN FOR USE
WITH TEMPORARY SIGNALS**

WORK ZONE SIGN DETAILS

STAY IN YOUR LANE

2

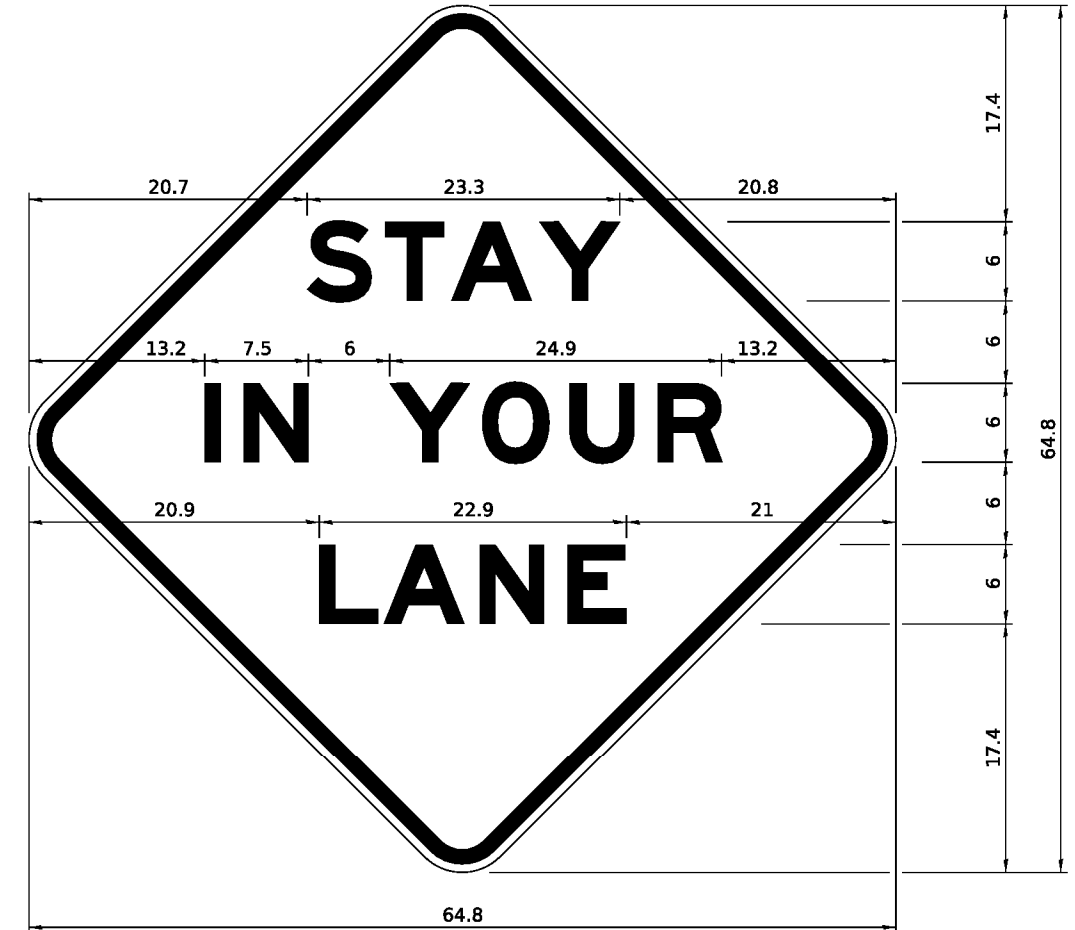
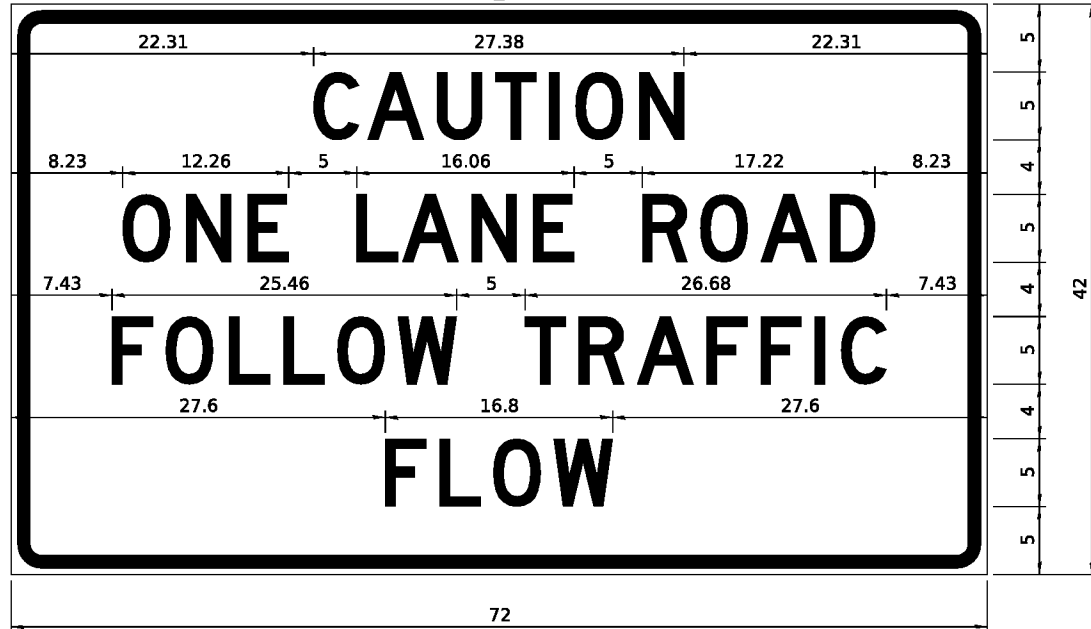

COLOR LEGEND AND BORDER BACKGROUND BLACK ORANGE NON-REFLECTORIZED REFLECTORIZED

2.25" Radius, 0.88" Border, 0.50" Indent;
[CAUTION] D; [ONE LANE ROAD] D;
[FOLLOW TRAFFIC] D; [FLOW] D

2 This sign shall be installed at entrances located between the temporary signals as shown in the staging plans.

Table Of Widths And Spaces

22.31	C	3.36	0.62	A	4.18	0.94	U	3.36	0.94	T	3.04	0.94	I	0.78	1.17	O	3.52	1.17	N	3.36	22.31
-------	---	------	------	---	------	------	---	------	------	---	------	------	---	------	------	---	------	------	---	------	-------

8.23	O	3.51	1.17	N	3.36	1.18	E	3.04
------	---	------	------	---	------	------	---	------

5.00	L	3.05	0.31	A	4.18	0.94	N	3.36	1.17	E	3.05
------	---	------	------	---	------	------	---	------	------	---	------

5.00	R	3.36	0.93	O	3.52	0.94	A	4.18	0.93	D	3.36	8.23
------	---	------	------	---	------	------	---	------	------	---	------	------

7.43	F	3.04	0.94	O	3.52	1.17	L	3.04	0.94	L	3.05	0.94	O	3.51	0.94	W	4.37
------	---	------	------	---	------	------	---	------	------	---	------	------	---	------	------	---	------

5.00	T	3.05	0.94	R	3.36	0.94	A	4.18	0.93	F	3.05	0.94	F	3.04	0.94	I	0.78	1.18	C	3.35	7.43
------	---	------	------	---	------	------	---	------	------	---	------	------	---	------	------	---	------	------	---	------	------

27.60	F	3.05	0.94	L	3.04	0.94	O	3.52	0.93	W	4.38	27.60
-------	---	------	------	---	------	------	---	------	------	---	------	-------

Sign not to scale

GENERAL NOTES

All work to furnish and install these signs shall be included in the cost of the specified traffic control standards and shall not be paid separately.

All Illinois Standard signs shall conform to the latest edition of the "Illinois Standard Highway Signs Book" in effect on the date of invitation for bids.

Signs shall meet the applicable portions of Sections 701 and 720 of the Standard Specifications.

All dimensions are in inches unless otherwise noted.

COLOR LEGEND AND BORDER BACKGROUND BLACK ORANGE NON-REFLECTORIZED REFLECTORIZED

48.0" across sides 3.8" Radius, 1.0" Border, 0.6" Indent;
"STAY" E Mod; "IN YOUR" E Mod; "LANE" E Mod;

Table of Letter and Object Lefts

S	T	A	Y
20.7	26.8	31.6	38.0

I	N	Y	O	U	R
13.2	15.9	26.7	33.9	40.5	46.8

L	A	N	E
20.9	25.8	33.1	39.4

Sign not to scale

MODEL: Default L:\81008 KPF08008.001\PTB 206.023 Bridge Rehab (23903)\WO 8 - US-6 over Mosquito Creek\03 CAD\01 Model\2 Specific Standards\264T20-std 34_1-shk.dgn

USER NAME = mbutting	DESIGNED - MGB	REVISED - 3-02-16
	DRAWN - MGB	REVISED -
	CHECKED - HJH	REVISED -
PLOT DATE = 9/4/2024	DATE -	REVISED -

STATE OF ILLINOIS
DEPARTMENT OF TRANSPORTATION

US 6 CROSSING MOSQUITO CREEK
REGION 2 / DISTRICT 2 STANDARD

F.A.U. RTE.	SECTION	COUNTY	TOTAL SHEETS	SHEET NO.
6789	(40BR-3)BDR	HENRY	19	14
CONTRACT NO. 64T20				
ILLINOIS FED. AID PROJECT				

SCALE: N.A. SHEET 4 OF 4 SHEETS STA. TO STA.

TYPICAL PAVEMENT MARKINGS

TYPICAL PAVEMENT MARKING FOR FLUSH MEDIAN AT LEFT TURN LANE

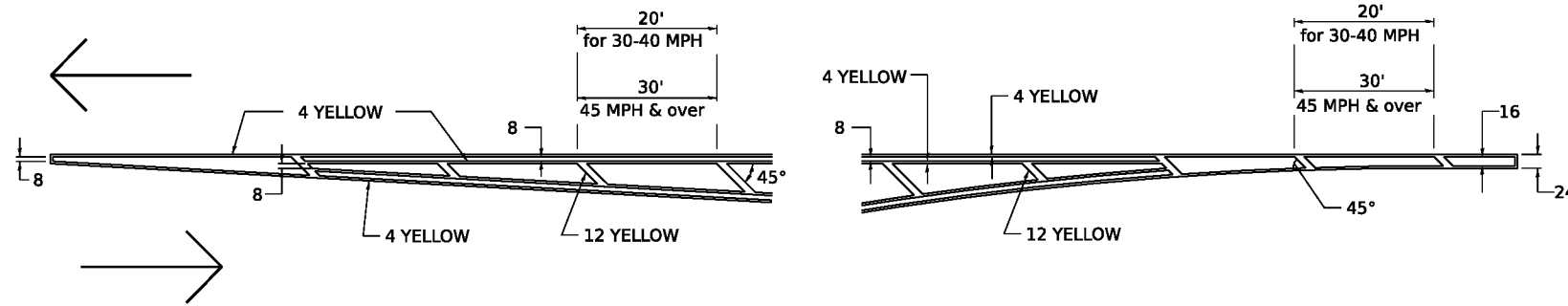

MEDIAN PAVEMENT MARKING

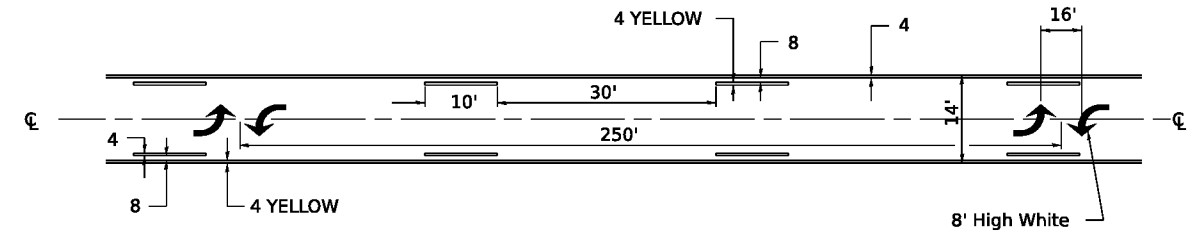

** ALL DIMENSIONS ARE IN INCHES UNLESS OTHERWISE NOTED.

TYPICAL ISLAND OFFSET SHOULDER WIDTH

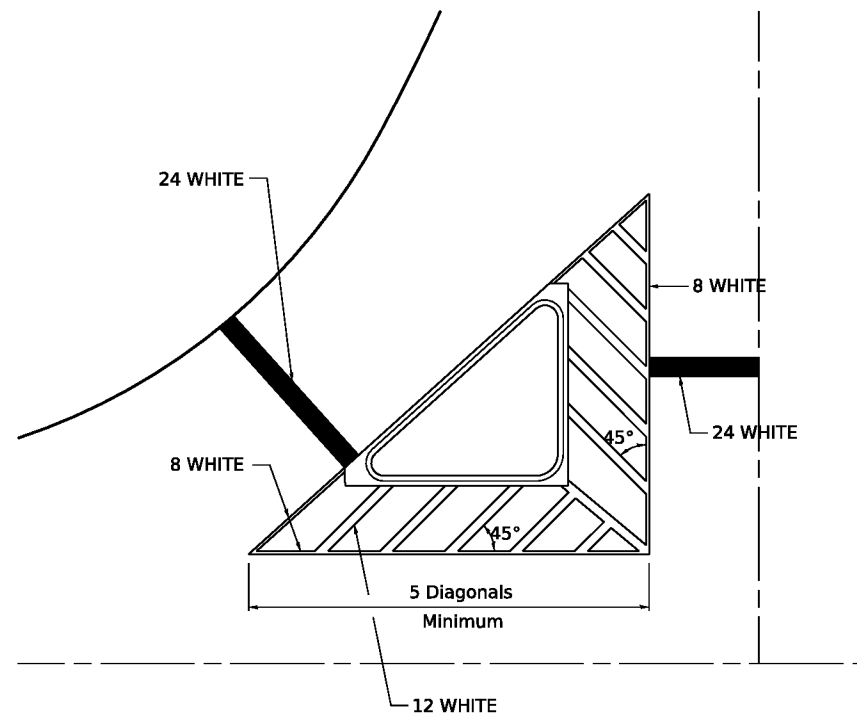

Sign not to scale

TYPICAL MARKING FOR PAINTED ISLANDS

NOTE:
* 45° TO LOCAL TAN.

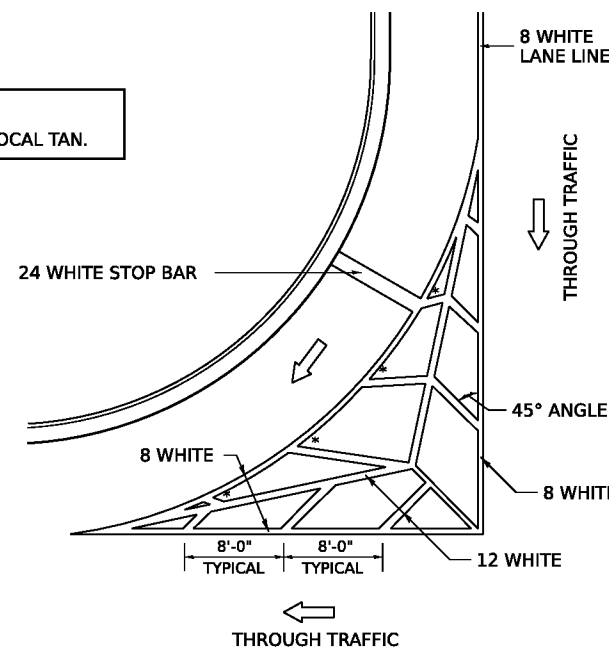

STANDARD CROSSWALK MARKING

See Schedules for Locations

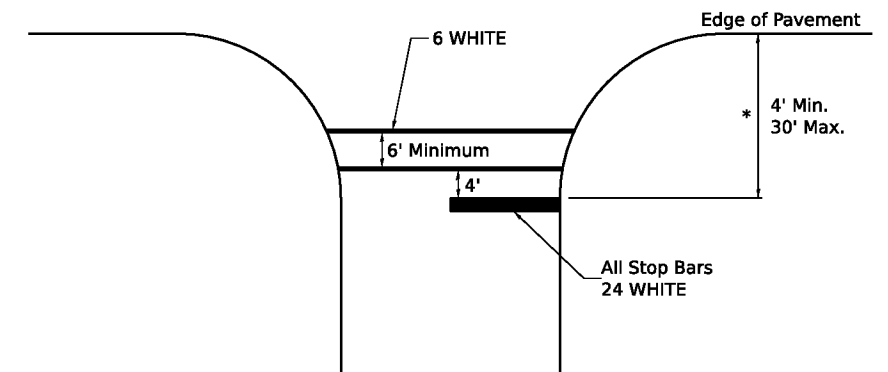

* Distance to the nearest edge of the intersecting roadway in the absence of a marked crosswalk.

MODEL: Default
FILE NAME: L:\8008 KPF\8008.00\PTB 206.023 Bridge Rehab (23803)\WO 8 - US-6 over Mosquito Creek\Civil\03 CAD\01 Model\2 Specific Standards\264T20-sic 41.1-sht1.dgn

USER NAME = mbuilding	DESIGNED - MGB	REVISED - 6-27-14
	DRAWN - MGB	REVISED - 3-05-12
	CHECKED - HJH	REVISED -
PLOT DATE = 9/4/2024	DATE -	REVISED -

STATE OF ILLINOIS
DEPARTMENT OF TRANSPORTATION

US 6 CROSSING MOSQUITO CREEK
REGION 2 / DISTRICT 2 STANDARD

SCALE: N.A. SHEET 1 OF 4 SHEETS STA. TO STA.

F.A.U. RTE. 5789	SECTION (40BR-3)BDR	COUNTY HENRY	TOTAL SHEETS 19	SHEET NO. 15
				CONTRACT NO. 64T20

ILLINOIS FED. AID PROJECT

TYPICAL PAVEMENT MARKINGS

ARROW LAYOUT

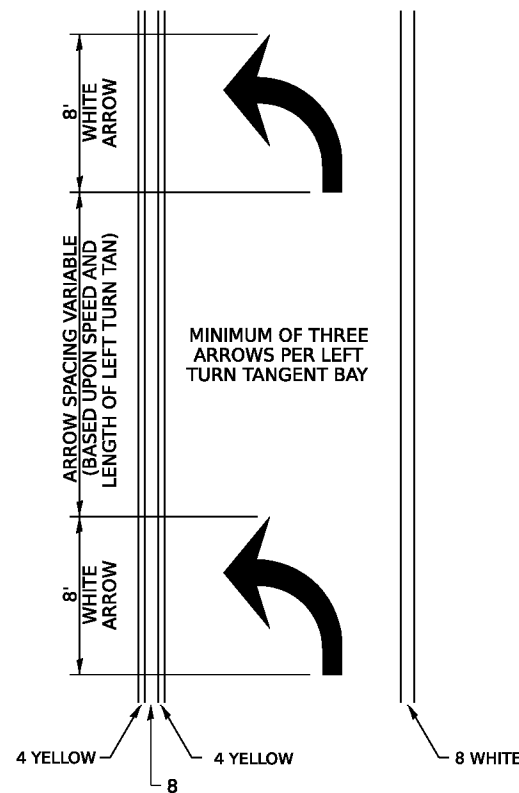

SYMBOLS

- ▲ ONE-WAY AMBER MARKER
- △ ONE-WAY CRYSTAL MARKER
- ◆ TWO-WAY AMBER MARKER

ALL DIMENSIONS ARE IN INCHES UNLESS OTHERWISE NOTED.

TYPICAL PAVEMENT MARKING FOR FLUSH MEDIAN

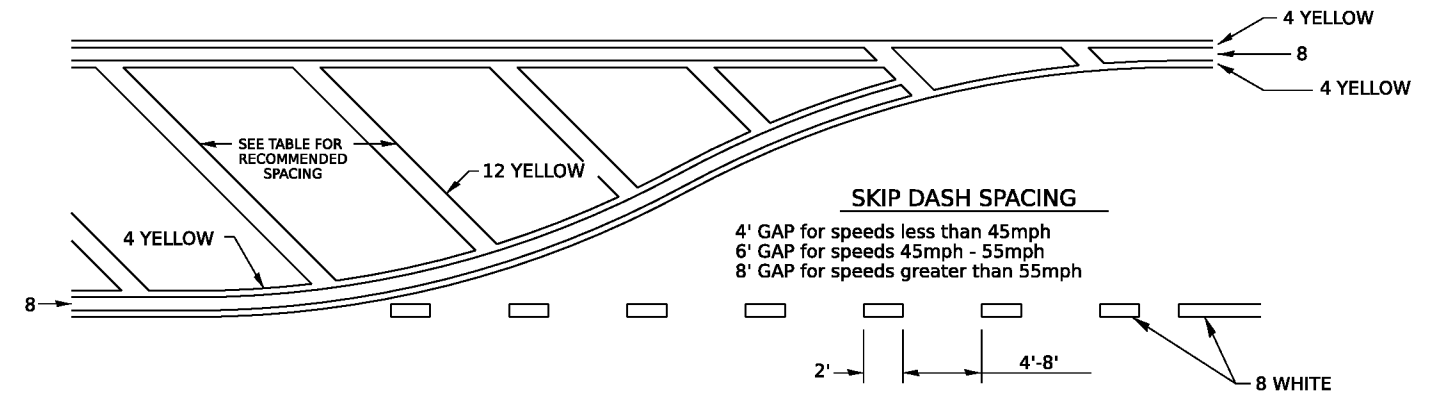

RECOMMENDED SPACING BETWEEN DIAGONALS (IN FEET)

Speed Limit Range	Continuous Median Area	Intersection Channelization	Objects (Islands)
less than 30MPH	50'	15'	10'
30-40MPH	75'	20'	15'
45MPH & over	75'	30'	20'

NOTE: if the spacing recommended in the Table does not permit at least five diagonal lines in the area being marked, the spacing from the next lowest speed range should be used. The recommended spacing is measured parallel to the pavement center line.

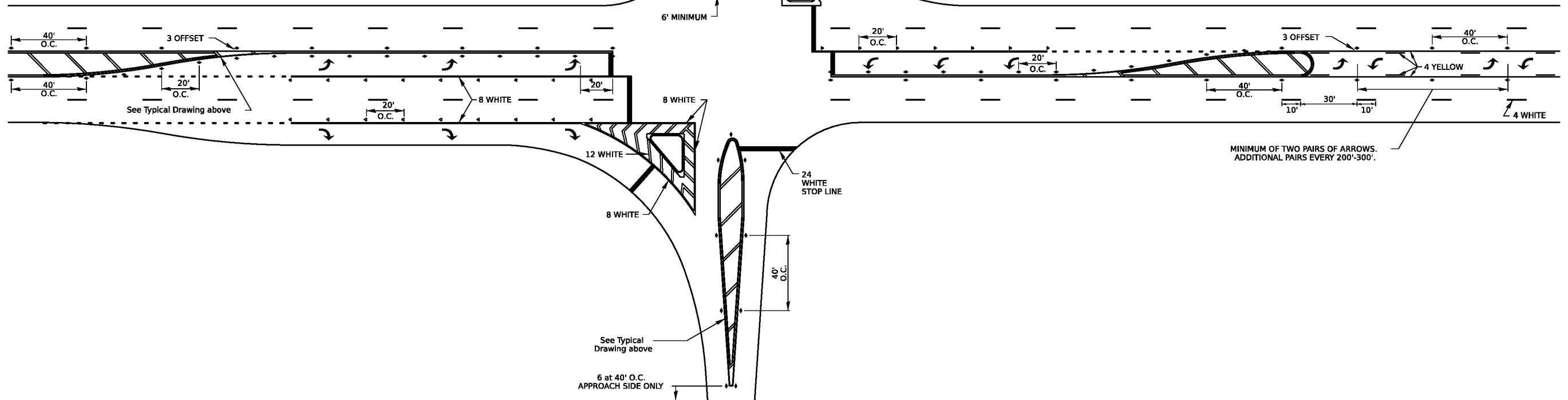

MODEL: Default
FILE NAME: L:\8008 KPF\8008_001\PTB 208.023 Bridge Rehab (23803)\WO 8 - US-6 over Mosquito Creek\Civil\03 CAD\01 Model\2 Specific Standards\264T20-std 41.1-sh2.dgn

USER NAME = mbutling	DESIGNED - MGB	REVISED - 6-27-14
	DRAWN - MGB	REVISED - 3-05-12
	CHECKED - HJH	REVISED -
PLOT DATE = 9/4/2024	DATE -	REVISED -

STATE OF ILLINOIS
DEPARTMENT OF TRANSPORTATION

US 6 CROSSING MOSQUITO CREEK
REGION 2 / DISTRICT 2 STANDARD

F.A.U. RTE. 5789	SECTION (40BR-3)BDR	COUNTY HENRY	TOTAL SHEETS 19	SHEET NO. 16
CONTRACT NO. 64T20				ILLINOIS FED. AID PROJECT

SCALE: N.A. SHEET 2 OF 4 SHEETS STA. TO STA.

TYPICAL PAVEMENT MARKINGS

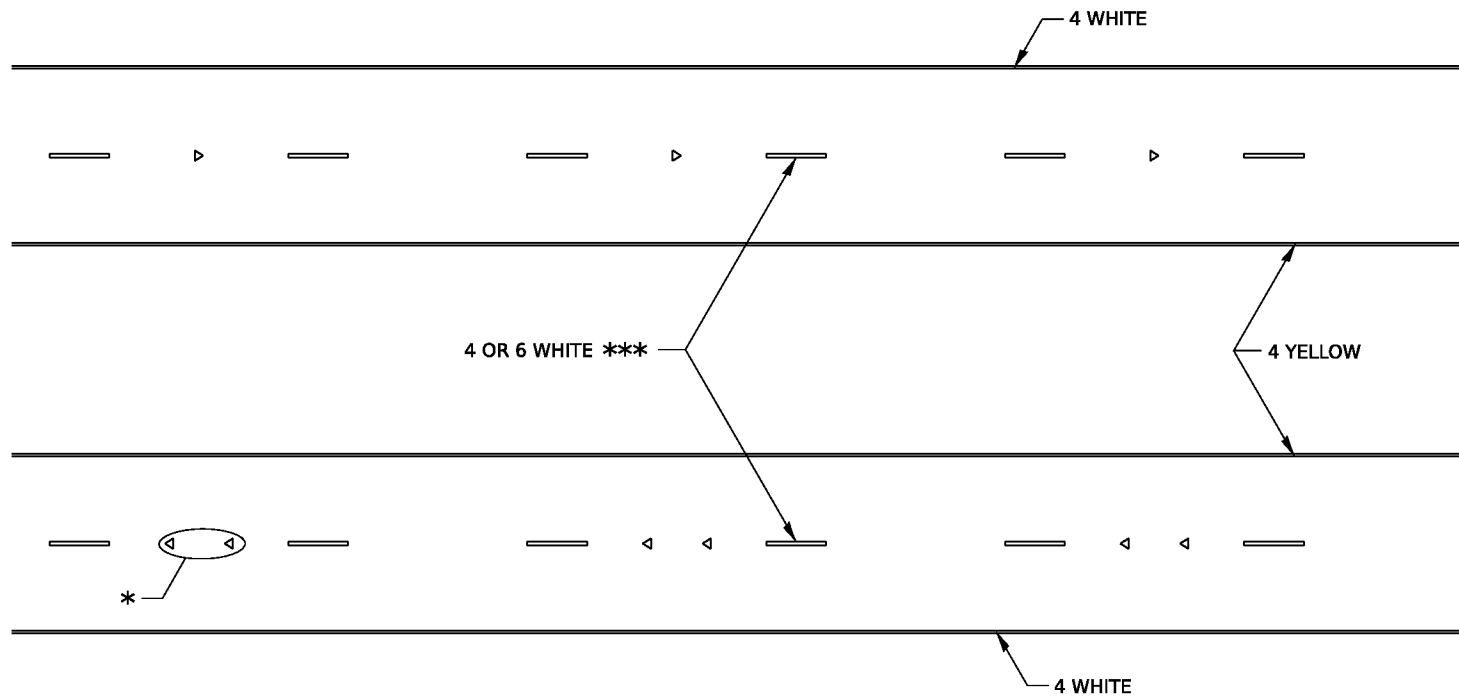

MULTI-LANE / DIVIDED

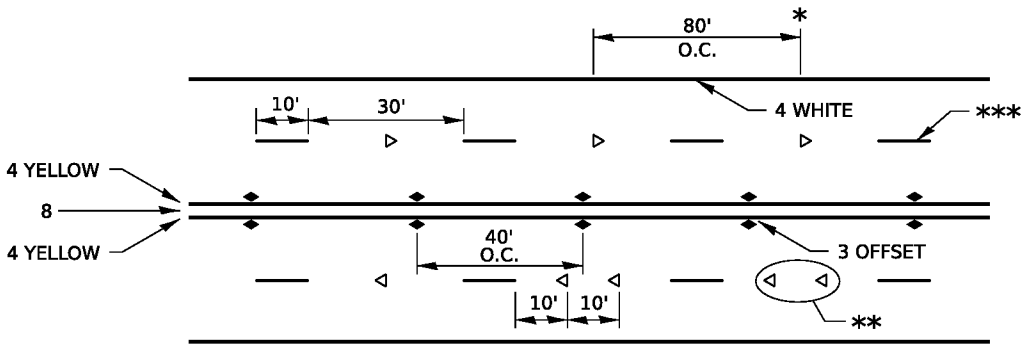

MULTI-LANE / UNDIVIDED & ONE WAY

(FOR MULTI-LANE UNDIVIDED HIGHWAYS USE THIS DETAIL NOT HIGHWAY STANDARD 781001)

TYPICAL PARKING SPACING

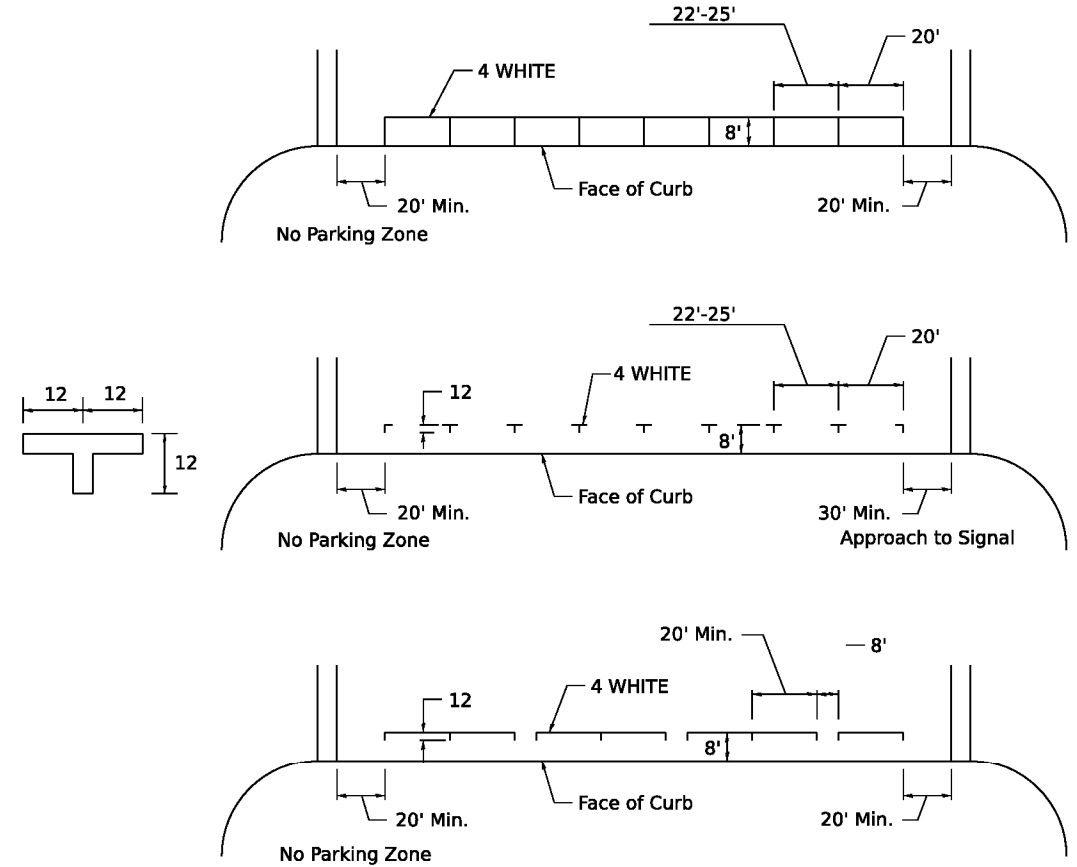

TYPICAL PAVEMENT MARKING FOR TWO LANE SECTION - NO PASSING ZONES

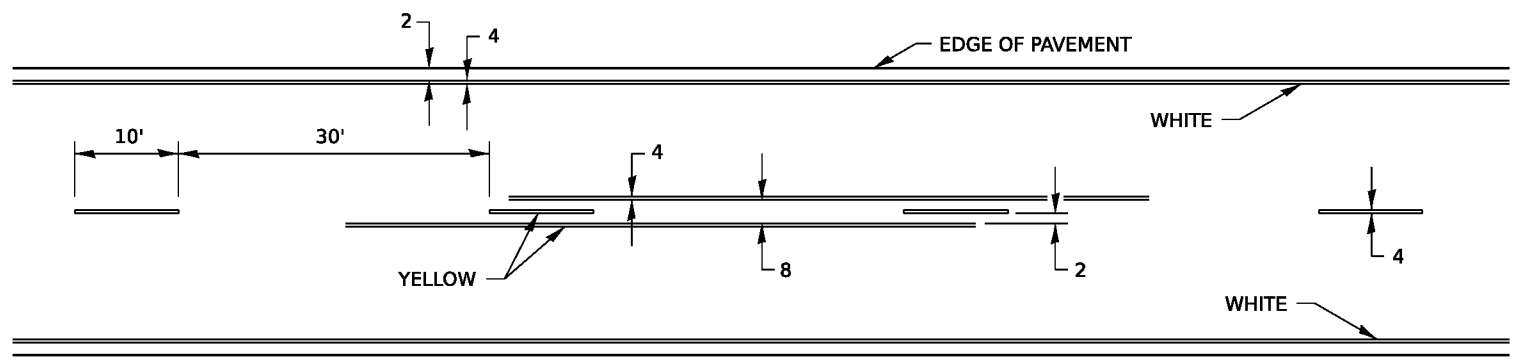

MODEL: Default
FILE NAME: L:\8008 KPF\8008.001\FBI.206.023 Bridge Rehab (23903)\WO 8 - US 6 over Mosquito Creek\CV\03 CAD\01 Model\02 Specific Standards\0264T20-std 41.1-ahd3.dgn

USER NAME = mbuting DESIGNED - MGB DRAWN - MGB CHECKED - HJH PLOT DATE = 8/23/2024	DESIGNED - MGB REVISOR - 6-27-14	STATE OF ILLINOIS DEPARTMENT OF TRANSPORTATION	US 6 CROSSING MOSQUITO CREEK REGION 2 / DISTRICT 2 STANDARD		F.A.U. RTE. 5789	SECTION (40BR-3)BDR	COUNTY HENRY	TOTAL SHEETS 19	SHEET NO. 17	
	REVISOR - 8-27-13		SCALE: N.A.	SHEET 3 OF 4 SHEETS	STA. TO STA.	CONTRACT NO. 64T20				
	REVISOR - 11-28-12		ILLINOIS FED. AID PROJECT							
	REVISOR -		TYPICAL PAVEMENT MARKINGS SHEET 3 OF 4 41.1							

TYPICAL PAVEMENT MARKINGS

** 6" WHITE ON INTERSTATES, WHERE THE SPEED LIMIT IS 65 MPH, OR WHEN DIRECTED BY THE ENGINEER.
4" WIDE AT ALL OTHER LOCATIONS.

NOTE: GORE HATCHING PLACED ONLY WHEN SCHEDULED IN THE PLANS

EXIT RAMP

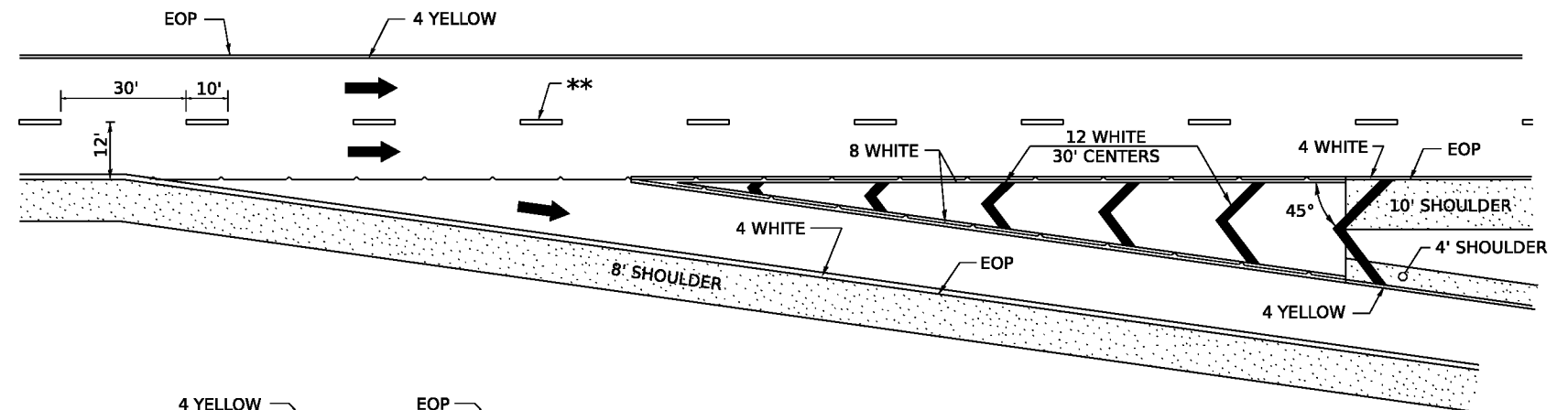

ENTRANCE RAMP

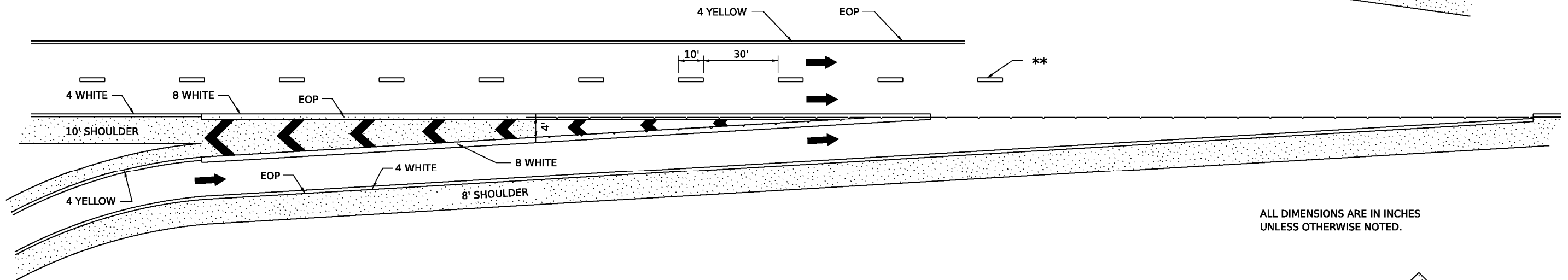

ALL DIMENSIONS ARE IN INCHES UNLESS OTHERWISE NOTED.

CLOVERLEAF

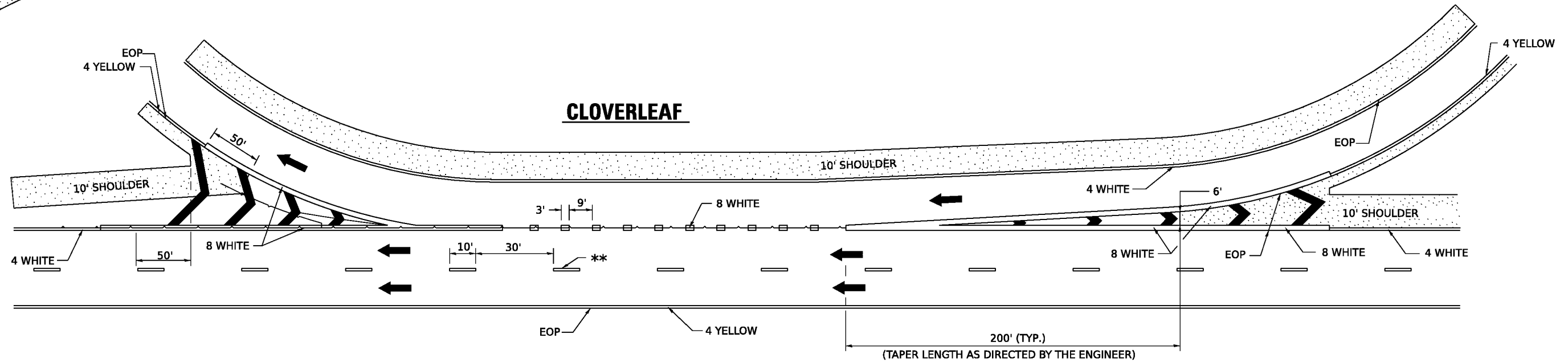

MODEL: Default
FILE NAME: L:\8008 KPF\8008.001\PTB 206.023 Bridge Rehab (23903)\WO 8 - US-6 over Mosquito Creek\Civil\03 CAD\01 Model\2 Specific Standards\264T20-std 41.1.ssh4.dgn

USER NAME = mbuting	DESIGNED - MGB	REVISED - 9-15-23
	DRAWN - MGB	REVISED - 8-27-13
	CHECKED - HJH	REVISED - 10-18-11
PLOT DATE = 8/23/2024	DATE -	REVISED -

STATE OF ILLINOIS
DEPARTMENT OF TRANSPORTATION

US 6 CROSSING MOSQUITO CREEK
REGION 2 / DISTRICT 2 STANDARD

F.A.U. RTE. 5789	SECTION (40BR-3)BDR	COUNTY HENRY	TOTAL SHEETS 19	SHEET NO. 18
CONTRACT NO. 64T20				
ILLINOIS FED. AID PROJECT				

SCALE: N.A. SHEET 4 OF 4 SHEETS STA. TO STA.

GUARDRAIL REFLECTORS, TYPE C (SPECIAL)

REFLECTORS FOR GUARDRAIL BLOCK OUT OR DELINEATOR POST

ADDITIONAL SHEETING MAY BE ADDED AS NEEDED FOR TURN AROUNDS AS SHOWN IN THE PLANS

STRAIGHT REFLECTOR / DELINEATOR

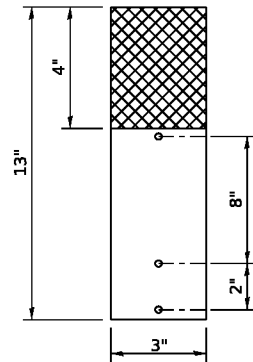

SIDE VIEW

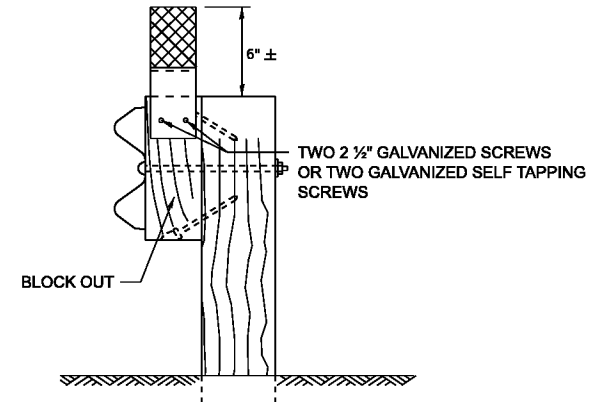
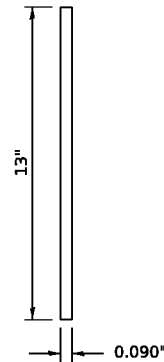

MOUNTED ON A GUARDRAIL BLOCK OUT

REFLECTORS SHALL BE MOUNTED DIRECTLY TO BLOCK OUTS.

REFLECTORS MOUNTED ON WOODEN OR PLASTIC OR METAL BLOCK OUT SHALL BE MOUNTED USING TWO 2 1/2" GALVANIZED SCREWS WITH WASHERS OR TWO SELF TAPPING GALVANIZED SCREWS WITH WASHERS.

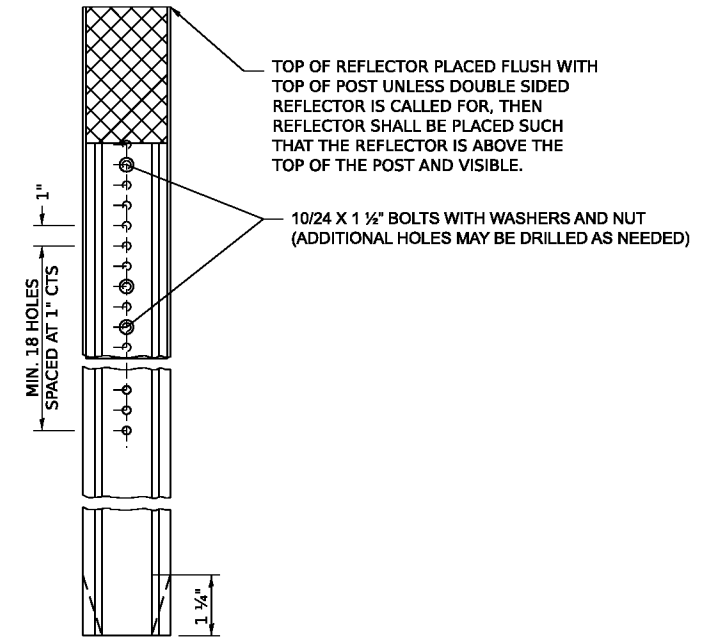

MOUNTED ON A DELINEATOR POST

REPLACING 3 BUTTON DELINEATOR

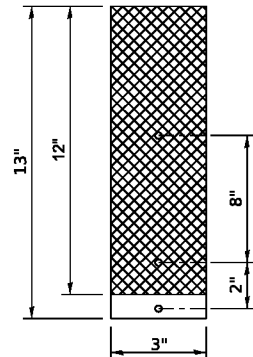

REPLACING 2 BUTTON DELINEATOR

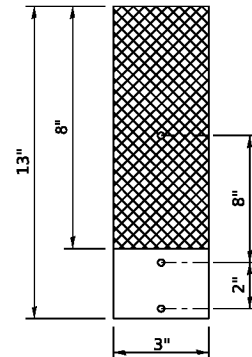

ADDITIONAL HOLES SHALL BE DRILLED IN THE REFLECTORS AS SHOWN ABOVE.

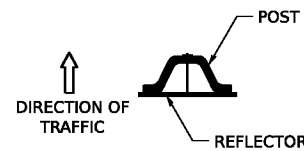

DELINEATORS SHALL BE INSTALLED ACCORDING TO STANDARD 635001 EXCEPT THAT THE POST SHALL BE ROTATED 180°. THE POST WILL HAVE THE WIDE SIDE FACING TRAFFIC AND THE REFLECTOR ATTACHED AS SHOWN ABOVE.

NOTE:

REFLECTORS SHALL BE PAID FOR AT THE CONTRACT UNIT PRICE PER EACH FOR GUARDRAIL REFLECTORS, TYPE C (SPECIAL), WHICH PRICE SHALL ALSO INCLUDE SCREWS, WASHERS OR AN APPROVED BONDING AGENT.

REFLECTORS INSTALLED ON TWO LANE ROADS SHALL BE DOUBLE SIDED AND BOTH SIDES SHALL BE CRYSTAL.

REFLECTORS INSTALLED ON CENTER BARRIER OR IN THE MEDIAN SHALL BE DOUBLE SIDED AND BOTH SIDES SHALL BE AMBER.

REFLECTORS INSTALLED ON DIVIDED HIGHWAYS ON THE OUTSIDE OF THE ROADWAY SHALL BE DOUBLE SIDED CRYSTAL.

SPACING FOR REFLECTORS SHALL BE ACCORDING TO STANDARD 782006 UNLESS OTHERWISE NOTED IN THE PLANS.

NOTE:

REFLECTORS SHALL BE PAID FOR AT THE CONTRACT UNIT PRICE PER EACH FOR GUARDRAIL REFLECTORS, TYPE C (SPECIAL), WHICH PRICE SHALL ALSO INCLUDE SCREWS, WASHERS OR AN APPROVED BONDING AGENT.

REFLECTORS INSTALLED ON TWO LANE ROADS SHALL BE DOUBLE SIDED AND BOTH SIDES SHALL BE CRYSTAL.

REFLECTORS INSTALLED ON CENTER BARRIER SHALL BE DOUBLE SIDE AND BOTH SIDES SHALL BE AMBER.

REFLECTORS INSTALLED ON DIVIDED HIGHWAYS ALONG THE OUTSIDE OF THE HIGHWAY SHALL BE DOUBLE SIDED CRYSTAL.

SPACING FOR REFLECTORS SHALL BE ACCORDING TO STANDARD 782006 UNLESS OTHERWISE NOTED IN THE PLANS.

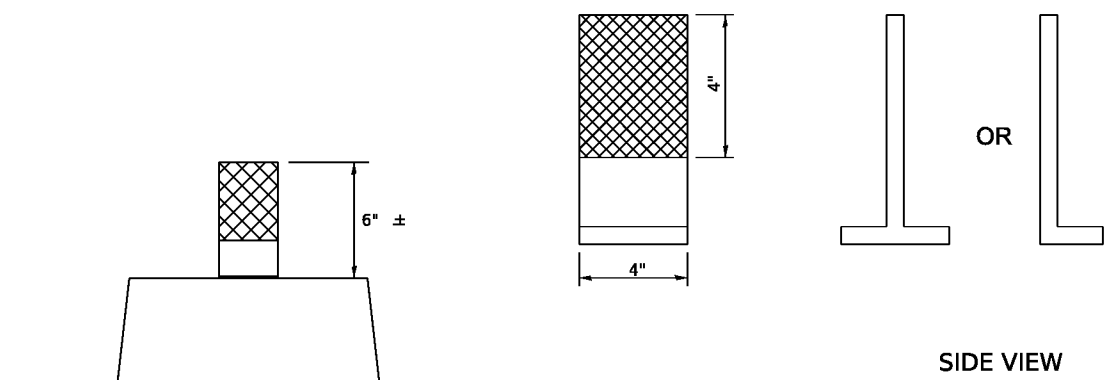

SIDE VIEW

REFLECTORS MOUNTED ON BARRIER WALL

MODEL: Default
FILE NAME: L:\81008 KPF08008.001\PTB 206.023 Bridge Rehab (23903)\WO 8 - US-6 over Mosquito Creek\Civil\03 CAD\01 Model\2 Specific Standards\2641720-stf 55.1-sh1.dgn

USER NAME = mbuting	DESIGNED - MGB	REVISED - 3-07-24
	DRAWN - MGB	REVISED - 4-27-23
	CHECKED - HJH	REVISED - 6-21-21
PLOT DATE = 8/23/2024	DATE -	REVISED -

STATE OF ILLINOIS
DEPARTMENT OF TRANSPORTATION

US 6 CROSSING MOSQUITO CREEK
REGION 2 / DISTRICT 2 STANDARD

SCALE: N.A. SHEET 1 OF 1 SHEETS STA. TO STA.

F.A.U. RTE.	SECTION	COUNTY	TOTAL SHEETS	SHEET NO.
6789	(40BR-3)BDR	HENRY	19	19
CONTRACT NO. 64T20				
ILLINOIS FED. AID PROJECT				