

STATE OF ILLINOIS
DEPARTMENT OF TRANSPORTATION

S.B.I. RTE.	SECTION	COUNTY	TOTAL SHEETS	SHEET NO.
88	(103A)RS	BUREAU	15	1
		ILLINOIS	CONTRACT NO. 66R30	

INDEX OF SHEETS

- 1 COVER SHEET
- 2 GENERAL NOTES
- 3 LINE DIAGRAM
- 4-6 SUMMARY OF QUANTITIES
- 7 TYPICAL SECTIONS
- 8-9 SCHEDULES
- 10-15 DETAILS

LIST OF ILLINOIS DOT HIGHWAY STANDARDS

- 000001-08 STANDARD SYMBOLS, ABBREVIATIONS AND PATTERNS
- 001006 DECIMAL OF AN INCH AND OF A FOOT
- 442101-09 CLASS B PATCHES
- 635001-02 DELINEATORS
- 701006-05 OFF-ROAD OPERATIONS 2L, 2W, 15' TO 24" FROM PAVEMENT EDGE
- 701011-04 OFF-ROAD MOVING OPERATIONS 2L, 2W, DAY ONLY
- 701201-05 LANE CLOSURE, 2L, 2W, DAY ONLY, FOR SPEEDS ≥ 45 MPH
- 701206-05 LANE CLOSURE, 2L, 2W, NIGHT ONLY, FOR SPEEDS ≥ 45 MPH
- 701301-04 LANE CLOSURE, 2L, 2W, SHORT TIME OPERATIONS
- 701306-04 LANE CLOSURE, 2L, 2W, SLOW MOVING OPERATIONS DAY ONLY, FOR SPEEDS ≥ 45 MPH
- 701311-03 LANE CLOSURE, 2L, 2W, MOVING OPERATIONS - DAY ONLY
- 701336-07 LANE CLOSURE, 2L, 2W, WORK AREAS IN SERIES, FOR SPEEDS ≥ 45 MPH
- 701901-10 TRAFFIC CONTROL DEVICES
- 781001-04 TYPICAL APPLICATIONS RAISED REFLECTIVE PAVEMENT MARKERS

PROPOSED
HIGHWAY PLANS

SBI ROUTE 88 (NEW BEDFORD RD)
SECTION (103A)RS
PROJECT STP-HAHU(010)
MILLING & RESURFACING
(DESIGNED OVERLAY)
BUREAU COUNTY

C-93-074-25



LOCATION OF SECTION INDICATED THUS: - [Symbol] -

FUNCTIONAL CLASSIFICATION
NEW BEDFORD RD
MINOR COLLECTOR
2020 ADT = 50
PV = 95% , SU = 1% , MU = 4%

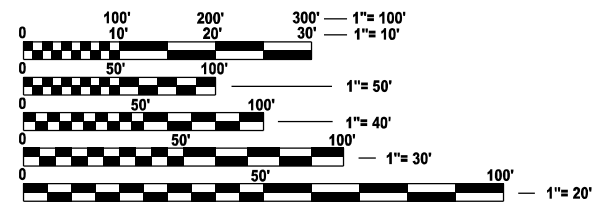

FULL SIZE PLANS HAVE BEEN PREPARED USING STANDARD ENGINEERING SCALES. REDUCED SIZED PLANS WILL NOT CONFORM TO STANDARD SCALES. IN MAKING MEASUREMENTS ON REDUCED PLANS, THE ABOVE SCALES MAY BE USED.

J.U.L.I.E.
JOINT UTILITY LOCATION INFORMATION FOR EXCAVATION
1-800-892-0123
OR 811

PROJECT ENGINEER: JOE KANNEL, P.E.
UNIT CHIEF: MOHAMED YOUSIF
DISTRICT 3 NO. (815) 434-6131
CONTRACT NO. 66R30

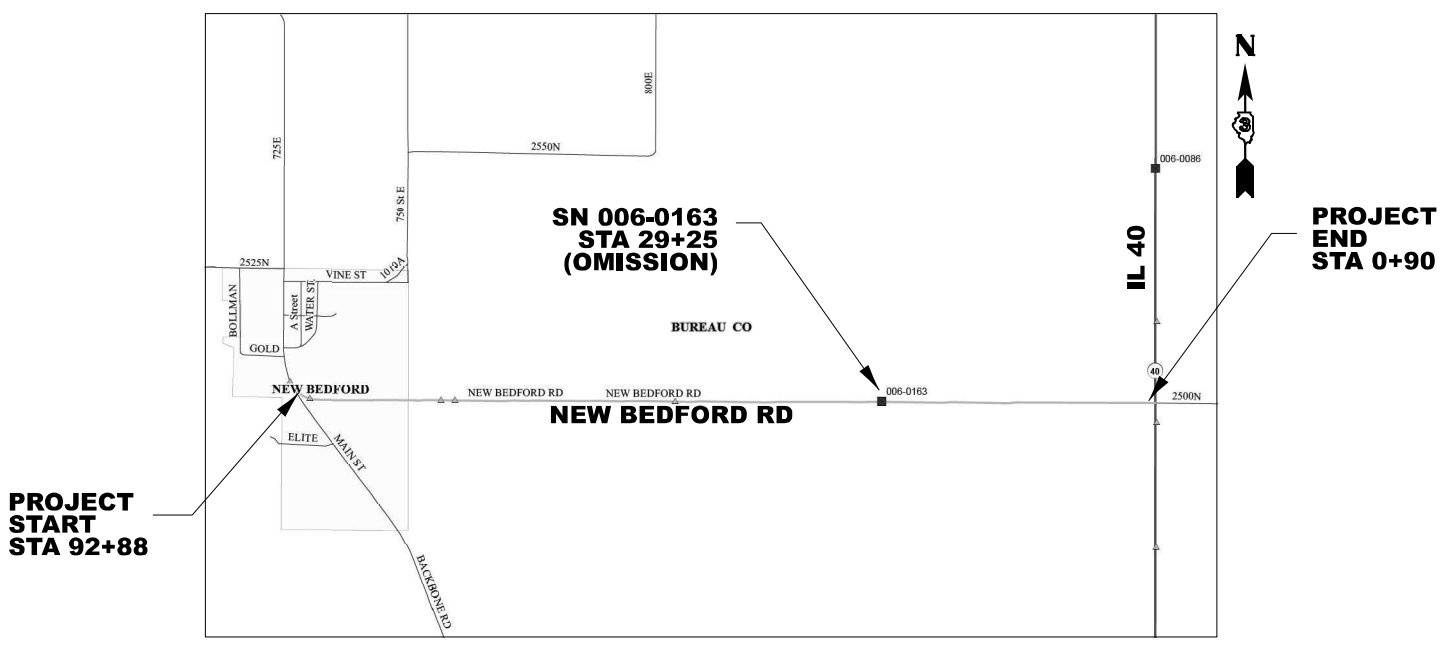

GROSS LENGTH = 9,198 FT. = 1.74 MILE
NET LENGTH = 8,973 FT. = 1.7 MILE

STATE OF ILLINOIS
DEPARTMENT OF TRANSPORTATION

SUBMITTED December 11, 2024
Tasha Thompson
REGIONAL ENGINEER

January 31, 2025
Scott A. [Signature]
ENGINEER OF DESIGN AND ENVIRONMENT

January 31, 2025
[Signature]
DIRECTOR OF HIGHWAYS PROJECT IMPLEMENTATION

PRINTED BY THE AUTHORITY
OF THE STATE OF ILLINOIS

GENERAL NOTES

THE HMA SURFACE OF ALL MAILBOX TURNOUTS, PRIVATE ENTRANCES, COMMERCIAL ENTRANCES, AND SIDE ROADS SHALL BE MADE NEATLY, IN A WORKMANLIKE MANNER, AND SHALL ACCURATELY CONFORM TO THE SHAPES AND DIMENSIONS SHOWN ON THE PLAN DETAILS. IF REQUIRED BY THE ENGINEER, THE CONTRACTOR SHALL SAW CUT THE HMA SURFACE TO CONFORM TO THE SHAPES AND DIMENSIONS SHOWN ON THE PLAN DETAILS. THIS WORK WILL BE INCLUDED IN THE COST OF THE HMA SURFACE.

EXCEPT AS NOTED ON THE PLANS, PAVEMENT GRADES SHOWN ARE AT THE TOP OF PAVEMENT SURFACES.

THE ENGINEER WILL BE THE SOLE JUDGE CONCERNING CURING TIME FOR THE VARIOUS HMA LIFTS.

ON EXISTING PAVEMENT WHICH MAY BE SUPERELEVATED, THE NEW HMA PAVEMENT SHALL BE BUILT WITH THE SAME SUPERELEVATION UNLESS NEW SUPERELEVATION RATES ARE GIVEN ON THE PLANS.

ALL ELEVATIONS REFERRING TO U.S.G.S. MEAN SEA LEVEL DATUM.

ALL EXCAVATED MATERIAL, WHICH INCLUDES DIGGING OR GRADING OF ANY SOIL OR FILL MATERIAL, WITH THE EXCEPTION OF AGGREGATE FILLS, MUST BE INCORPORATED WITHIN THE IDOT RIGHT OF WAY.

THE FOLLOWING RATES OF APPLICATION HAVE BEEN USED IN CALCULATING PLAN QUANTITIES:

GRANULAR MATERIALS	2.05	TONS / CU YD
HMA RESURFACING	112	LBS / SQ YD / IN
SHORT TERM PAVEMENT MARKING	10	FT /100 FT OF APPLICATION
MIX FOR CRACKS, JTS & FLGWYS	0.0003	TONS / SQ YD
BINDER (HAND METHOD)	0.0005	TONS / SQ YD

ALL DAMAGE TO DEPARTMENT OWNED UNDERGROUND FACILITIES, CAUSED BY THE CONTRACTOR SHALL BE REPAIRED TO THE SATISFACTION OF THE ENGINEER AND AT NO EXPENSE TO THE DEPARTMENT. THIS SHALL INCLUDE ALL TEMPORARY REPAIRS REQUIRED TO KEEP THE FACILITY OPERATIONAL WHILE MATERIAL IS BEING OBTAINED TO MAKE PERMANENT REPAIRS. SPLICING OF ELECTRIC CABLE WILL NOT BE ALLOWED. ELECTRIC CABLE SHALL BE REPLACED FROM POLE TO POLE OR CONTROLLER.

THE CONTRACTOR SHALL CONTACT JULIE AT LEAST 48 HOURS PRIOR TO EXCAVATION TO DETERMINE WHICH UTILITIES ARE IN THE AREA.

COMMITMENTS

NONE

HMA MIXTURE REQUIREMENT TABLE

LOCATIONS:	ENTIRE PROJECT	ENTIRE PROJECT	ENTIRE PROJECT
MIXTURE USE(S):	HMA BINDER	HMA SURFACE	INCIDENTAL HMA
BINDER GRADE (PG):	PG 64-22	PG 64-22	PG 64-22
DESIGN AIR VOIDS:	4.0% @ N50	4.0% @ N50	4.0% @ N50
MIXTURE COMPOSITION: (MIXTURE GRADATION)	IL 19.0	IL 9.5	IL 9.5
FRICTION AGGREGATE:		MIXTURE C	MIXTURE C
MIXTURE WEIGHT:	112.0 LB/SY/IN	112.0 LB/SY/IN	112.0 LB/SY/IN
QUALITY MANAGEMENT PROGRAM:	QCQA	QCQA	QCQA
SUBLOT SIZE:	N/A	N/A	N/A
DENSITY TEST METHOD:	CORES/NUCLEAR	CORES/NUCLEAR	SATISFACTION OF ENGINEER
MATERIAL TRANSFER DEVICE (REQUIRED):	YES	YES	YES

STATE OF ILLINOIS
DEPARTMENT OF TRANSPORTATION
DISTRICT THREE
AS BUILT INFORMATION

SUPERVISING CONSTRUCTION FIELD ENGINEER

RESIDENT ENGINEER / TECHNICIAN

START & END DATES
OF CONSTRUCTION:

INSPECTORS:

**STATE OF ILLINOIS
DEPARTMENT OF TRANSPORTATION**

GENERAL NOTES

SCALE: SHEET OF SHEETS STA. TO STA.

S.B.I. RTE.	SECTION	COUNTY	TOTAL SHEETS	SHEET NO.
88	(103A)RS	BUREAU	15	2
CONTRACT NO. 66R30				
ILLINOIS FED. AID PROJECT				

MODEL: Default
FILE NAME: c:\p\work\pww\in\inalasco\01045908\0366R30-sh-cvwr.dgn

USER NAME = Cassandra.Nolasco	DESIGNED -	REVISED -
	DRAWN -	REVISED -
	CHECKED -	REVISED -
PLOT DATE = 12/7/2024	DATE -	REVISED -

NEW BEDFORD

BUREAU COUNTY

IL 40

**PROJECT START
STA 92+88
SEE BELOW DETAIL**

NEW BEDFORD RD

**SN 006-0163
STA 29+25
(OMISSION)**

**PROJECT END
AT JOINT
STA 0+90**

2500N RD

MAIN ST

LIMITS OF RESURFACING SIDE ROADS

**PROJECT START
STA 92+88**



**~12 FT FROM THE
NEW BEDFORD INTERSECTION
(AT THE END OF THE GUARDRAIL)**

MODEL: Default
FILE NAME: c:\p\work\pww\ed\inalasco\01045908\0366630-sh-cv-cover.dgn

USER NAME = Cassandra.Nolasco	DESIGNED -	REVISED -
	DRAWN -	REVISED -
	CHECKED -	REVISED -
PLOT DATE = 12/6/2024	DATE -	REVISED -

**STATE OF ILLINOIS
DEPARTMENT OF TRANSPORTATION**

LINE DIAGRAM

SCALE: SHEET OF SHEETS STA. TO STA.

S.B.I. RTE.	SECTION	COUNTY	TOTAL SHEETS	SHEET NO.
88	(103A)RS	BUREAU	15	3
CONTRACT NO. 66R30				
ILLINOIS FED. AID PROJECT				

MODEL: Default
 FILE NAME: c:\p\work\pww\ed\h\alascocj\01045908\0366R30-shr-SQC.dgn

CONSTR. CODE
STP-RUR

CODE NO.	ITEM	UNIT	TOTAL QUANTITY	ROADWAY
				0005 RURAL
				80% FED 20% STATE
40600290	BITUMINOUS MATERIALS (TACK COAT)	POUND	14339	14339
40600370	LONGITUDINAL JOINT SEALANT	FOOT	8973	8973
40600400	MIXTURE FOR CRACKS, JOINTS, AND FLANGEWAYS	TON	6	6
40600405	MATERIAL TRANSFER DEVICE	TON	4403	4403
40600900	HOT-MIX ASPHALT BINDER COURSE (HAND METHOD), N50	TON	11	11
40600990	TEMPORARY RAMP	SQ YD	154	154
40603080	HOT-MIX ASPHALT BINDER COURSE, IL-19.0, N50	TON	2642	2642
40604050	HOT-MIX ASPHALT SURFACE COURSE, IL-9.5, MIX "C", N50	TON	1761	1761
40800050	INCIDENTAL HOT-MIX ASPHALT SURFACING	TON	64	64
44000164	HOT-MIX ASPHALT SURFACE REMOVAL, 3 3/4"	SQ YD	20908	20908
44201043	CLASS B PATCHES, TYPE II, 16 INCH	SQ YD	126	126
44201299	DOWEL BARS 1 1/2"	EACH	324	324
44213200	SAW CUTS	FOOT	792	792
48102100	AGGREGATE WEDGE SHOULDER, TYPE B	TON	695	695

USER NAME = Cassandra.Nolasco	DESIGNED -	REVISED -
	DRAWN -	REVISED -
	CHECKED -	REVISED -
PLOT DATE = 12/16/2024	DATE -	REVISED -

**STATE OF ILLINOIS
 DEPARTMENT OF TRANSPORTATION**

SUMMARY OF QUANTITIES

SCALE: SHEET OF SHEETS STA. TO STA.

S.B.I. RTE.	SECTION	COUNTY	TOTAL SHEETS	SHEET NO.
88	(103A)RS	BUREAU	15	4
			CONTRACT NO. 66R30	
ILLINOIS FED. AID PROJECT				

CODE NO.	ITEM	UNIT	TOTAL QUANTITY	CONSTR. CODE
				STP-RUR
				ROADWAY 0005 RURAL
				80% FED 20% STATE
63500105	DELINEATORS	EACH	8	8
67000400	ENGINEER'S FIELD OFFICE, TYPE A	CAL MO	3	3
67100100	MOBILIZATION	L SUM	1	1
70100450	TRAFFIC CONTROL AND PROTECTION, STANDARD 701201	L SUM	1	1
70100460	TRAFFIC CONTROL AND PROTECTION, STANDARD 701306	L SUM	1	1
70100600	TRAFFIC CONTROL AND PROTECTION, STANDARD 701336	L SUM	1	1
70300100	SHORT TERM PAVEMENT MARKING	FOOT	922	922
70300150	SHORT TERM PAVEMENT MARKING REMOVAL	SQ FT	307	307
78004720	PREFORMED PLASTIC PAVEMENT MARKING, TYPE D - STANDARD - LINE 24"	FOOT	12	12
* 78009004	MODIFIED URETHANE PAVEMENT MARKING - LINE 4"	FOOT	43514	43514
* 78009006	MODIFIED URETHANE PAVEMENT MARKING - LINE 6"	FOOT	4286	4286
* 78011125	GROOVING FOR RECESSED PAVEMENT MARKING 25"	FOOT	12	12
* 78100100	RAISED REFLECTIVE PAVEMENT MARKER	EACH	116	116
78300200	RAISED REFLECTIVE PAVEMENT MARKER REMOVAL	EACH	116	116

*= SPECIALTY ITEM

MODEL: Default
FILE NAME: c:\p\work\pav\illinois\mohamed.yousif\illinois.gov\1045908\03666R30-sth-SOC.dgn

USER NAME = Mohamed.Yousif	DESIGNED -	REVISED -	STATE OF ILLINOIS DEPARTMENT OF TRANSPORTATION	SUMMARY OF QUANTITIES			S.B.I. RTE.	SECTION	COUNTY	TOTAL SHEETS	SHEET NO.
	DRAWN -	REVISED -					88	(103A)RS	BUREAU	15	5
	CHECKED -	REVISED -		CONTRACT NO. 66R30							
PLOT DATE = 1/2/2025	DATE -	REVISED -		SCALE:	SHEET	OF	SHEETS	STA.	TO STA.	ILLINOIS FED. AID PROJECT	

CODE NO.	ITEM	UNIT	TOTAL QUANTITY	CONSTR. CODE
				STP-RUR
				ROADWAY
				0005
				RURAL
				80% FED 20% STATE
X2040805	FURNISHED EXCAVATION (SPECIAL)	CU YD	15	15
X4401198	HOT-MIX ASPHALT SURFACE REMOVAL, VARIABLE DEPTH	SQ YD	474	474
X6350204	LINEAR DELINEATOR PANELS, 4 INCH	EACH	8	8
X6350206	LINEAR DELINEATOR PANELS, 6 INCH	EACH	6	6
Z0030850	TEMPORARY INFORMATION SIGNING	SQ FT	42	42

MODEL: Default
 FILE NAME: c:\p\work\pwork\mohamed.yousif@illinois.gov\1045908\0366R30-sh-SOO.dgn

USER NAME = Mohamed.Yousif	DESIGNED -	REVISED -
	DRAWN -	REVISED -
	CHECKED -	REVISED -
PLOT DATE = 1/2/2025	DATE -	REVISED -

**STATE OF ILLINOIS
DEPARTMENT OF TRANSPORTATION**

SUMMARY OF QUANTITIES

SCALE: SHEET OF SHEETS STA. TO STA.

S.B.I. RTE.	SECTION	COUNTY	TOTAL SHEETS	SHEET NO.
88	(103A)RS	BUREAU	15	6
CONTRACT NO. 66R30			ILLINOIS FED. AID PROJECT	

***LONGITUDINAL JOINT SEALANT**
LONGITUDINAL JOINT SEALANT IS PLACED
ON THE TOP OF THE BINDER COURSE
JOINTS/UNDERNEATH THE SURFACE COURSE,
FINAL LOCATION OF LONGITUDINAL JOINT
SEALANT TO BE DETERMINED BY THE ENGINEER.

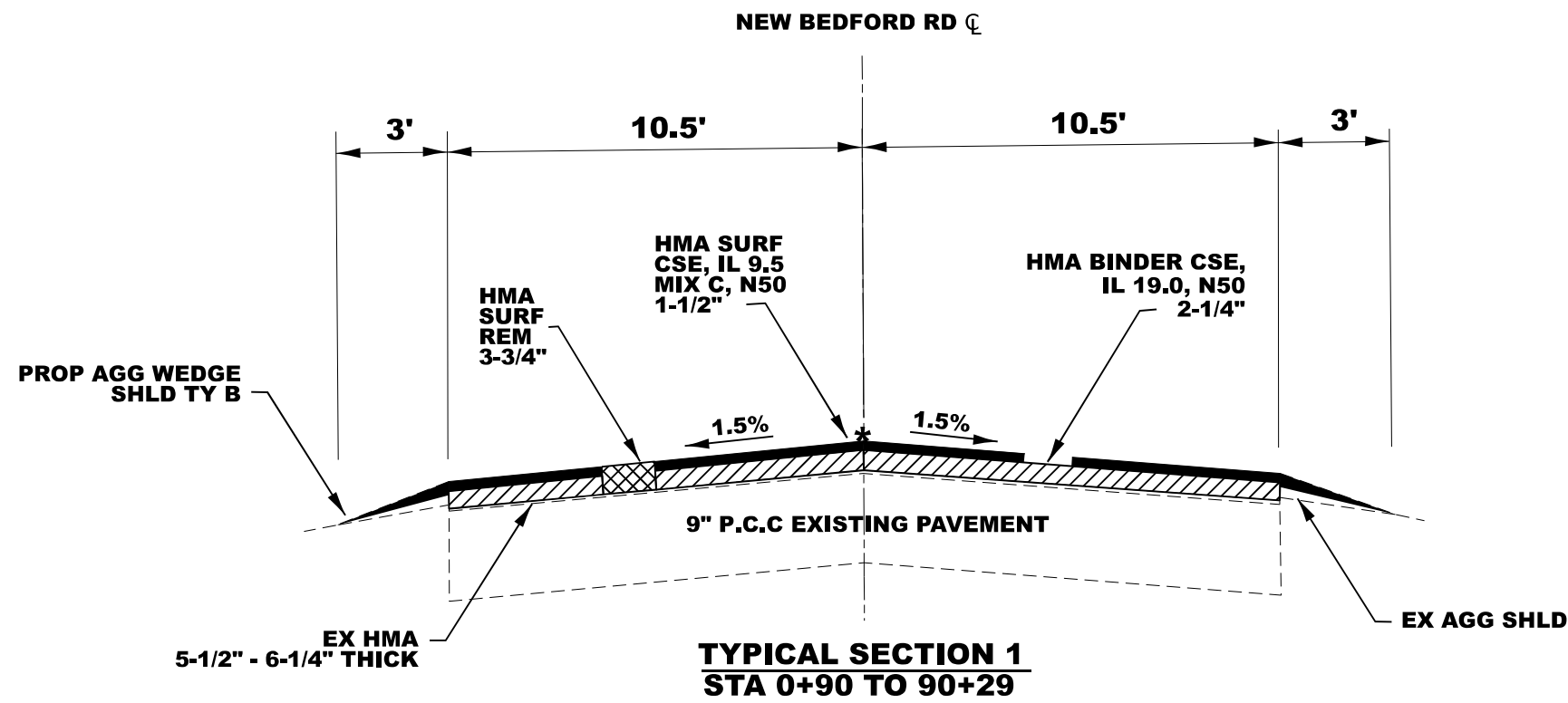

OMISSION: STA 28+15 TO 30+40

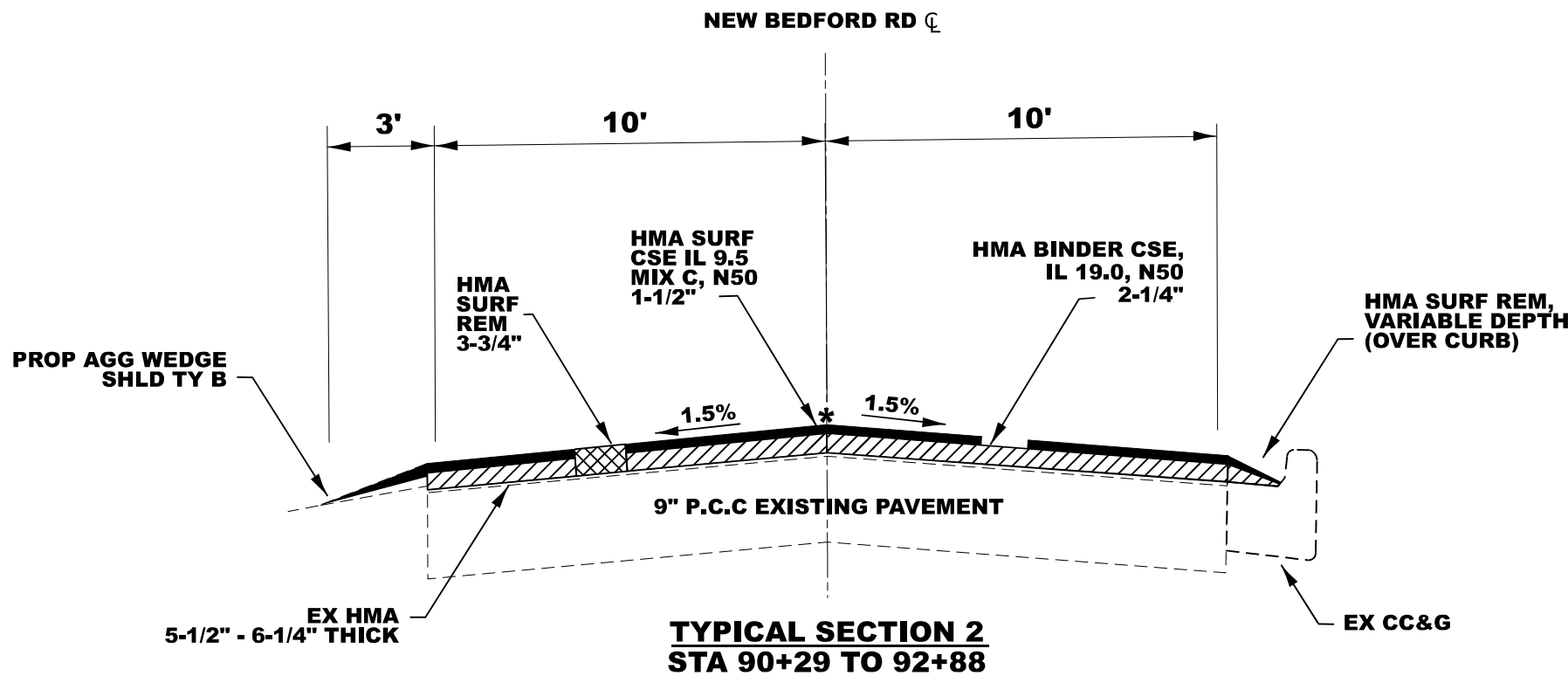

MODEL: Default
 FILE NAME: c:\pw_work\pwwork\alascocj\10459081\0366R30-shld-typical sections.dgn

USER NAME = Cassandra.Nolasco	DESIGNED -	REVISED -
	DRAWN -	REVISED -
	CHECKED -	REVISED -
PLOT DATE = 12/6/2024	DATE -	REVISED -

STATE OF ILLINOIS
DEPARTMENT OF TRANSPORTATION

TYPICAL SECTIONS

SCALE: SHEET OF SHEETS STA. TO STA.

S.B.I. RTE.	SECTION	COUNTY	TOTAL SHEETS	SHEET NO.
88	(103A)RS	BUREAU	15	7
ILLINOIS FED. AID PROJECT			CONTRACT NO. 66R30	

MAINLINE SCHEDULE														
LOCATION	LENGTH	HMA MAIN LINE	HMA SHLD (OVER CURB)	HMA SURF REM 3-3/4"	HMA SURF REM VARIABLE DEPTH	HMA BIND CSE IL-19.0, N50 (2-1/4")	HMA SURF CSE IL 9.5 MIX C, N50 (1-1/2")	HMA BINDER CSE (HM) N50	LONG JOINT SEAL	AGG WEDGE SHLD TY B	BIT MATL (TACK COAT)	MIXTURE CRACKS JTS & FLANGEWYS	MATL TRANS DEVICE	TEMP RAMP
STATION	FOOT	WIDTH	WIDTH	SQ YD	SQ YD	TON	TON	TON	FOOT	TON	POUND	TON	TON	SQ YD
STP RUR														
0+90 TO 28+15	2725	21		6358		801	534	3.2	2725	211.0	4292	1.9	1335	29
28+15 TO 30+40	225	21							OMISSION SN 006-0163					58
30+40 TO 90+29	5989	21		13974		1761	1174	7.0	5989	463.8	9432	4.2	2935	
90+29 TO 92+88	259	20	2	576	58	80	53	0.3	259	10.0	427	0.2	133	31
TOTAL	8973			20908	58	2642	1761	11	8973	685	14151	6	4403	118

SIDEROAD & ENTRANCE SCHEDULE												
LOCATION	SIDE	TYPE	MAT'L	WIDTH	AREA	AGG WEDGE SHLD, TYPE B	BITUMINOUS MATERIALS (TACK COAT)	INCIDENTAL HMA SURFACING	HMA SURF REMOVAL VARIABLE DEPTH	FURNISHED EXCAVATION (SPECIAL)	TEMP RAMP	
				FT	SQ FT	TON	POUND	TON	SQ YD	CU YD	SQ YD	
STP-RUR												
STA 3+75	RT	FE	AGG	30	90	1.1						
STA 5+75	LT	FE	AGG	20	60	0.8						
STA 26+80	RT	FE	AGG	48	144	1.8						
STA 26+80	LT	FE	AGG	42	126	1.6						
STA 31+65	RT	FE	AGG	30	90	1.1						
STA 36+50	LT	FE	AGG	15	45	0.6						
STA 46+90	LT	PE	AGG	35	105	1.3						
STA 49+25	RT	PE	HMA	40	400		20	/	44			
STA 49+25	LT	FE	AGG	30	90	1.1						
STA 70+55	RT	FE	AGG	20	60	0.8						
STA 90+95	LT	SIDEROAD	HMA	45	1350		68	23	150	7.7	25	
STA 92+30	LT	MAIN ST	HMA	20	2000		100	34	222	3.2	11	
TOTAL						10	188	64	416	15	36	

PLACE FURNISHED EXCAVATION (SPECIAL) AROUND SIDE ROAD RADII.
THIS AREA TO BE SEEDED, FERTILIZED AND MULCHED - NOT PAID FOR SEPARATELY BUT INCLUDED IN THE COST OF FURN EX (SPECIAL).

PERMANENT SURVEY MARKER SCHEDULE						
MONUMENT NUMBER	DESCRIPTION	APPROXIMATE LOCATION	EXISTING MONUMENT TYPE	PROPOSED MONUMENT TYPE	MONUMENT RECORD TO BE RECORDED	RESPONSIBILITY
NBRD02	N QTR CORNER SECTION 33, T18N, R7E, 4TH PM	1/2 MI W OF ILL RTE 40	MISSING	TYPE 1	YES	2
NBRD03	NW CORNER SECTION 33, T18N, R7E, 4TH PM	1 MI W OF ILL RTE 40	NO 5 REBAR	TYPE 1	YES	2
NBRD04	N QTR CORNER SECTION 32, T18N, R7E, 4TH PM	1 1/2 MI W OF ILL RTE 40	PIN W / CAP	TYPE 1	YES	2

R.E. WILL INFORM PLATS AND PLANS WHEN SURFACE IS TO BE MILLED FOR THE PURPOSE OF SEARCHING FOR ADDITIONAL BURIED SURVEY MONUMENTS.

UNKNOWN MONUMENTS MAY EXIST. IF AN UNLISTED MONUMENT IS FOUND, R.E. IS REQUIRED TO PROTECT THE MONUMENT FROM DAMAGE UNTIL A PLATS AND PLANS LAND SURVEYOR CAN DOCUMENT THE MONUMENT. PLATS AND PLANS WILL RESET SUCH MONUMENTS IN KIND FOLLOWING CONSTRUCTION.

NOTE: FOR BIDDING PURPOSES, NO CONTRACTED LAND SURVEYING SERVICES WILL BE REQUIRED.
PLATS AND PLANS WILL PREPARE AND RECORD THE REQUIRED MONUMENT RECORDS.

RESPONSIBILITY:

1) RESIDENT TO RE-ESTABLISH MONUMENT (PAY ITEM REQUIRED. PERMANENT SURVEY MARKER, TYPE 1)
2) PLATS AND PLANS TO RE-ESTABLISH MONUMENT

MODEL: Default
FILE NAME: c:\pwworking\hinalasco\1045908\0366630-sh-schedules.dgn

USER NAME = Cassandra.Nolasco	DESIGNED -	REVISED -	STATE OF ILLINOIS DEPARTMENT OF TRANSPORTATION	SCHEDULE OF QUANTITIES				S.B.I. RTE.	SECTION	COUNTY	TOTAL SHEETS	SHEET NO.
	DRAWN -	REVISED -						88	(103A)RS	BUREAU	15	8
	CHECKED -	REVISED -						CONTRACT NO. 66R30				
PLOT DATE = 12/6/2024	DATE -	REVISED -		SCALE:	SHEET	OF	SHEETS	STA.	TO STA.	ILLINOIS	FED. AID PROJECT	

PAVEMENT MARKING SCHEDULE												
LOCATION		COMMENT	LENGTH	MODIFIED URETHANE PM (2 APPLICATIONS)			PREFORMED PLASTIC PM, TYPE D, STD, LINE 24"	GROOVING FOR REC PM 25"	RAISED REF PM	RAISED REF PM		
				LINE 4"		LINE 6"						
STATION			FOOT	WHITE FOOT	YELLOW FOOT	YELLOW FOOT	WHITE FOOT	FOOT	EACH	EACH		
STP-RUR												
STA	0+70	TO STA	20+70	Passing	2030	8000		1000	12	12	25	25
STA	20+70	TO STA	26+35	No WB Pass	565	2260	1130	282			7	7
STA	26+35	TO STA	32+45	Passing	610	2440		306			8	8
STA	32+45	TO STA	37+70	No EB Pass	525	2100	1050	262			7	7
STA	37+70	TO STA	77+05	Passing	3935	15740		1968			49	49
STA	77+05	TO STA	86+40	No WB Pass	935	3740	1870	468			12	12
STA	86+40	TO STA	92+88	No Pass	648	2592	2592				8	8
TOTALS					9218	43514		4286	12	12	116	116

SHORT TERM PAVEMENT MARKINGS						
LOCATION		LENGTH	SHORT TERM PM	SHORT TERM PM REM		
STATION		FOOT	FT	SQ FT		
STP-RUR						
STA	0+70	TO STA	92+88	9218	922	307
TOTALS			9218	922	307	

DELINEATOR SCHEDULE					
STA	STR NO.	DELINEATORS	LINEAR DELINEATOR PANELS 4 IN	LINEAR DELINEATOR PANELS 6 IN	
		EA	EA	EA	
STP-RUR					
29+25	006-0163		8	6	
51+50	4563	2			
75+30	4564	2			
76+75	4565	2			
90+75	4566	2			
TOTAL		8	8	6	

PATCHING SCHEDULE						
LOCATION	LANE	PATCH LENGTH	PATCH WIDTH	CLASS B PATCHES TYPE II 16 INCH	DOWEL BARS 1.5"	SAW CUTS
STATION		FOOT	FOOT	SQ YD	EACH	FOOT
7+40	WB	6	10.5	7	18	44
	EB	6	10.5	7	18	44
14+75	WB	6	10.5	7	18	44
	EB	6	10.5	7	18	44
22+50	WB	6	10.5	7	18	44
	EB	6	10.5	7	18	44
42+25	WB	6	10.5	7	18	44
	EB	6	10.5	7	18	44
46+85	WB	6	10.5	7	18	44
	EB	6	10.5	7	18	44
49+85	WB	6	10.5	7	18	44
	EB	6	10.5	7	18	44
52+90	WB	6	10.5	7	18	44
	EB	6	10.5	7	18	44
62+30	WB	6	10.5	7	18	44
	EB	6	10.5	7	18	44
65+05	WB	6	10.5	7	18	44
	EB	6	10.5	7	18	44
TOTAL				126	324	792

MODEL: Default
 FILE NAME: c:\p\work\pavement\mascoc\01045908\0366630-shr-schedule.dgn

USER NAME = Cassandra.Nolasco	DESIGNED -	REVISED -
	DRAWN -	REVISED -
	CHECKED -	REVISED -
PLOT DATE = 12/9/2024	DATE -	REVISED -

STATE OF ILLINOIS
DEPARTMENT OF TRANSPORTATION

SCHEDULE OF QUANTITIES

SCALE: SHEET OF SHEETS STA. TO STA.

S.B.I. RTE.	SECTION	COUNTY	TOTAL SHEETS	SHEET NO.
88	(103A)RS	BUREAU	15	9
CONTRACT NO. 66R30				
ILLINOIS FED. AID PROJECT				

IDENTIFICATION OF ROADSIDE HAZARDS FOR TWO-LANE ROADWAYS

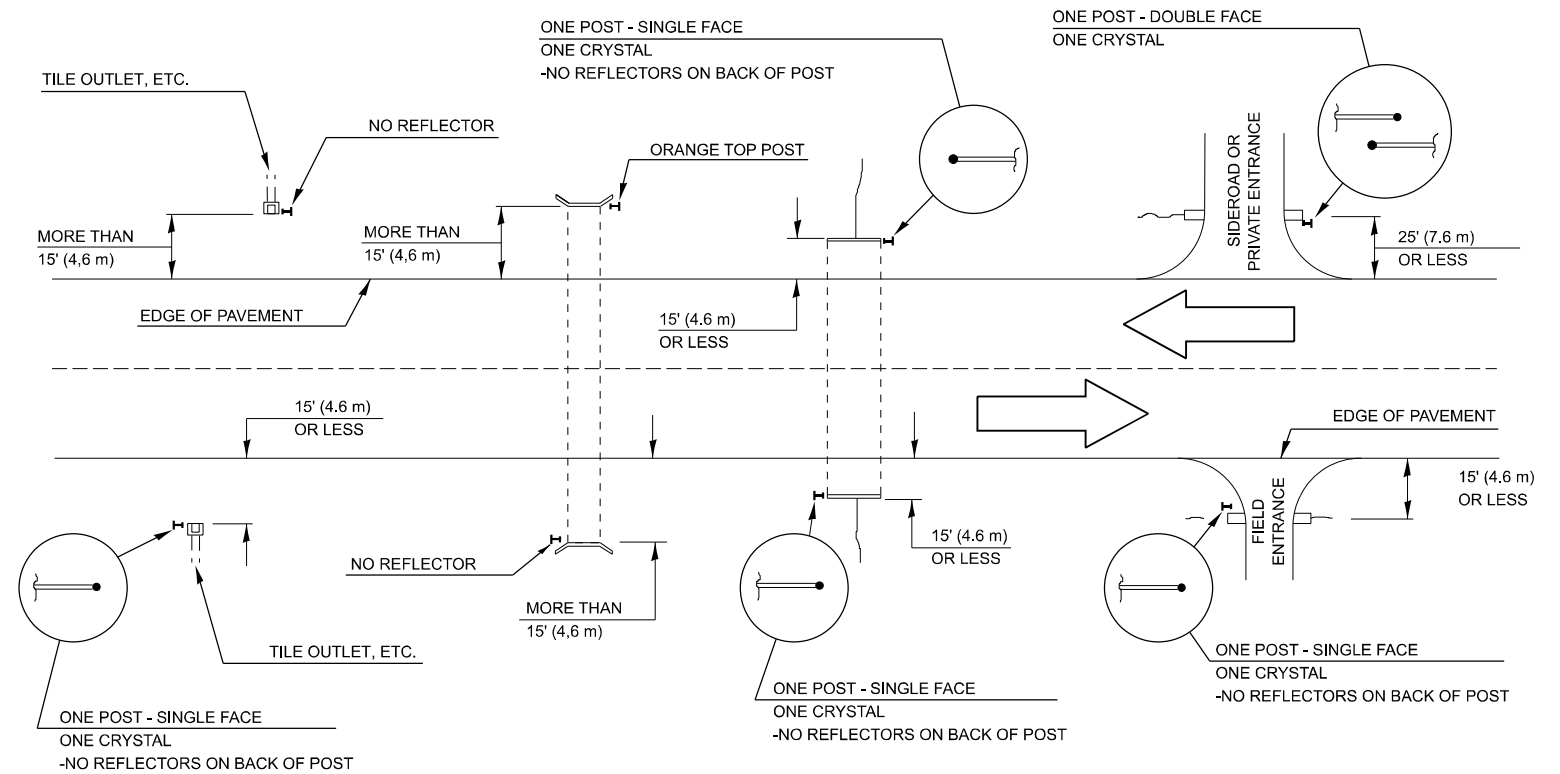

BILL OF MATERIALS

DELINEATOR TYPE	SINGLE FACE	DOUBLE FACE	NO REFLECTOR	TOTAL DELINEATORS
SINGLE CRYSTAL			N/A	8
NO REFLECTOR			TOTAL	8

NOTE:

DELINEATORS FOR ROADSIDE HAZARDS SHALL ONLY BE PLACED AT LOCATIONS WHERE THERE IS NO GUARDRAIL, OR OTHER PERMANENT BARRIER, ON THE SAME SIDE OF THE ROAD AS THE HAZZARD.

DELINEATORS FOR ROADSIDE HAZARDS SHALL ONLY BE PLACED AT LOCATIONS WHERE DELINEATORS ARE NOT IN PLACE ALONG THE EDGE OF SHOULDER.

EACH POST SHALL BE CONSIDERED AS ONE DELINEATOR FOR PAYMENT, REGARDLESS OF THE NUMBER OF DELINEATORS ATTACHED TO IT.

FOR ONE-WAY AND INTERSTATE ROADWAYS THE APPLICATION SHALL BE SIMILAR WITH DELINEATORS PLACED ON THE TRAFFIC APPROACH SIDE OF HAZARDS AND OBJECTS, ONLY SINGLE FACE DELINEATORS WILL BE REQUIRED ON ONE-WAY ROADWAYS, CRYSTAL ON THE RIGHT SIDE AND AMBER ON THE LEFT SIDE.

FOR OTHER DELINEATOR APPLICATIONS, REFER TO HIGHWAY STANDARD 635001.

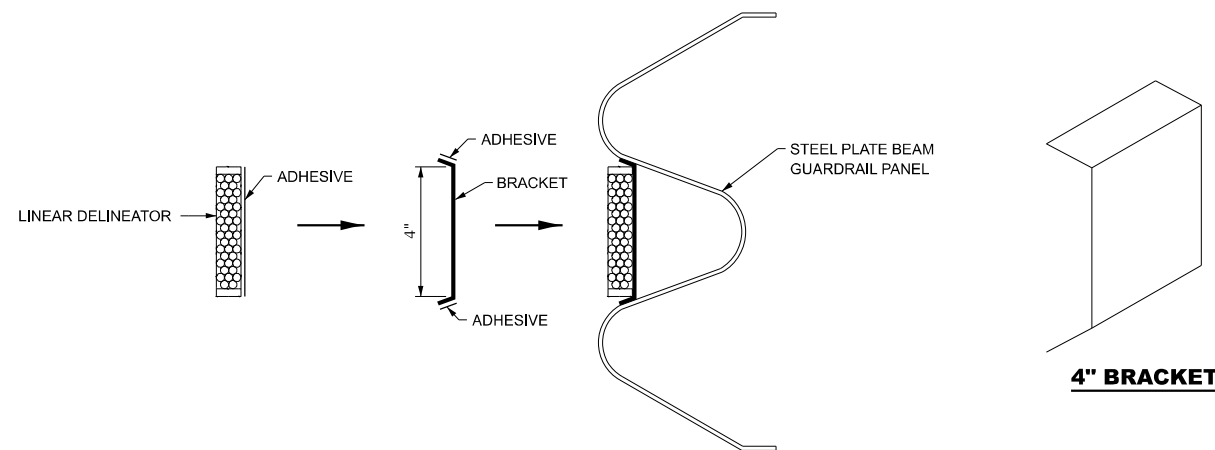

LINEAR DELINEATOR APPLICATION TO STANDARD GALVANIZED GUARDRAIL

LINEATOR DELINEATOR SHALL BE APLLIED ACCORDING TO THE MANUFACTURER'S RECOMMENDATIONS

MODEL: Default
FILE NAME: c:\pwwork\pwwork\hinalasco\1045908\0366630-sh1-details.dgn

USER NAME = Cassandra.Nolasco	DESIGNED -	REVISED -
	DRAWN -	REVISED -
	CHECKED -	REVISED -
PLOT DATE = 12/5/2024	DATE -	REVISED -

**STATE OF ILLINOIS
DEPARTMENT OF TRANSPORTATION**

SCALE: SHEET OF SHEETS STA. TO STA.

DETAILS

S.B.I. RTE.	SECTION	COUNTY	TOTAL SHEETS	SHEET NO.
88	(103A)RS	BUREAU	15	10
CONTRACT NO. 66R30				
ILLINOIS FED. AID PROJECT				

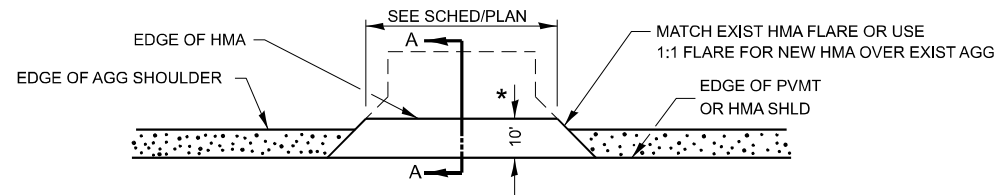

PLAN AT PRIVATE & COMMERCIAL ENTRANCES

(DO NOT RESURFACE FIELD ENTRANCES)

* PROPOSED HMA RESURFACING AT PUBLIC EDUCATIONAL FACILITY ENTRANCES SHALL BE EXTENDED TO THE RIGHT-OF-WAY LIMITS.

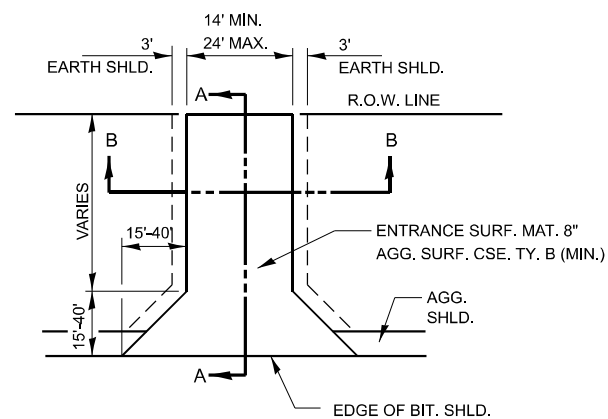

TYPICAL NONCOMMERCIAL - RURAL (FIELD ENTRANCE)

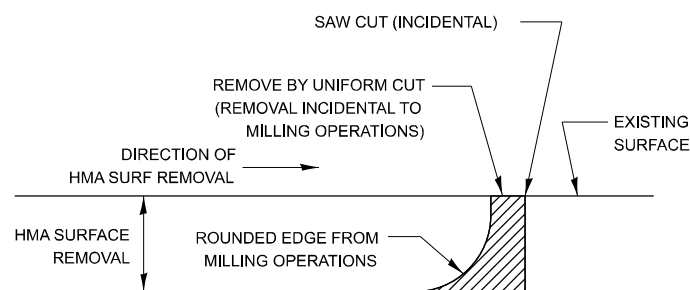

NOTE:

WHEN MILLING OPERATIONS PRODUCE A ROUNDED EDGE, THEN A SAW CUT SHALL BE USED TO MANUFACTURE A PERPENDICULAR EDGE AS SHOWN IN THE DETAIL. THE ENGINEER SHALL BE THE SOLE JUDGE CONCERNING THE USE OF THIS DETAIL.

HMA BUTT JOINT SAW CUTS

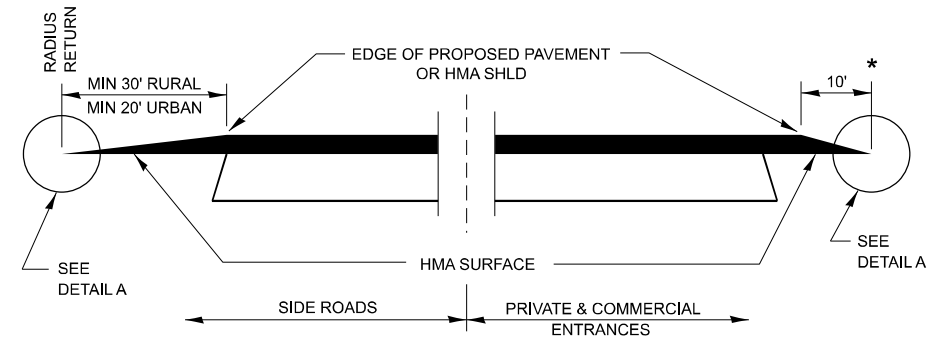

**SECTION A-A
DETAILS AT ENTRANCES & SIDE ROADS**

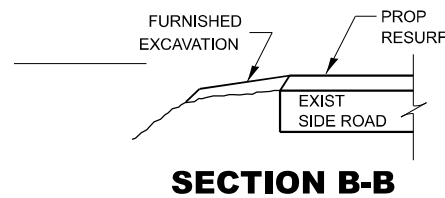

THE COST OF REMOVAL AT EXISTING HMA OR PCC LOCATIONS SHALL BE PAID FOR PER SQ YD BY THE APPROPRIATE PAY ITEM. REMOVAL AT THE EXISTING AGG LOCATIONS SHALL BE INCIDENTAL TO THE HMA. A-3 LOCATIONS SHALL BE FEATHER TAPERED.

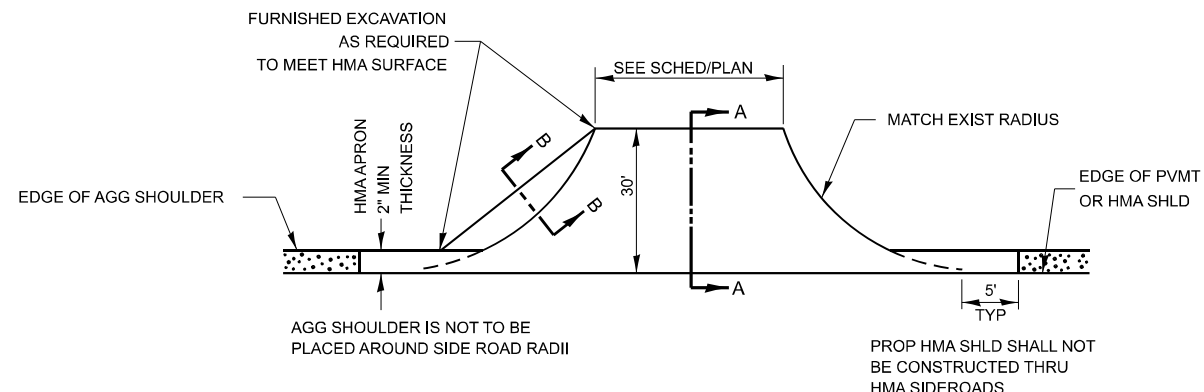
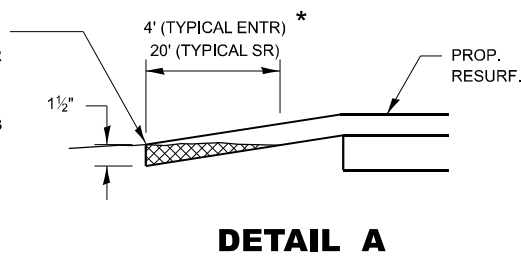

PLAN AT SIDE ROADS

MODEL: Default
FILE NAME: c:\pwworking\hinalasco\1045908\0366630-shr-details.dgn

USER NAME = Cassandra.Nolasco	DESIGNED -	REVISED -
	DRAWN -	REVISED -
	CHECKED -	REVISED -
PLOT DATE = 12/5/2024	DATE -	REVISED -

STATE OF ILLINOIS
DEPARTMENT OF TRANSPORTATION

SCALE: SHEET OF SHEETS STA. TO STA.

DETAILS

S.B.I. RTE.	SECTION	COUNTY	TOTAL SHEETS	SHEET NO.
88	(103A)RS	BUREAU	15	11
CONTRACT NO. 66R30				
ILLINOIS FED. AID PROJECT				

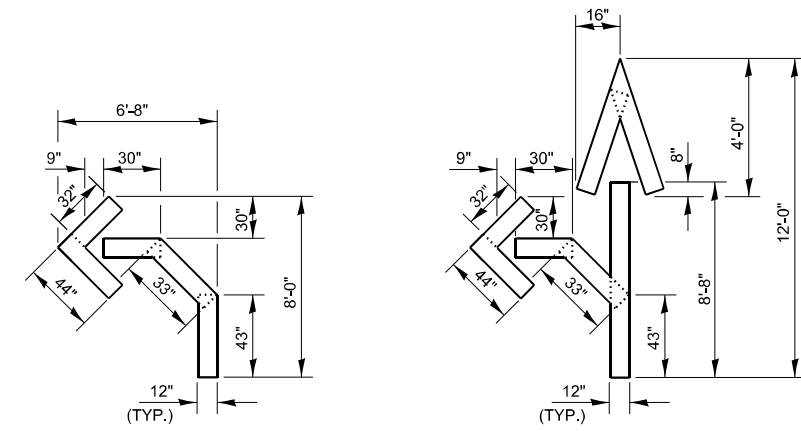

QUANTITY
 12" LINE = 16 LIN FT
 OR 4" LINE = 48 LIN FT

QUANTITY
 12" LINE = 29 LIN FT
 OR 4" LINE = 87 LIN FT

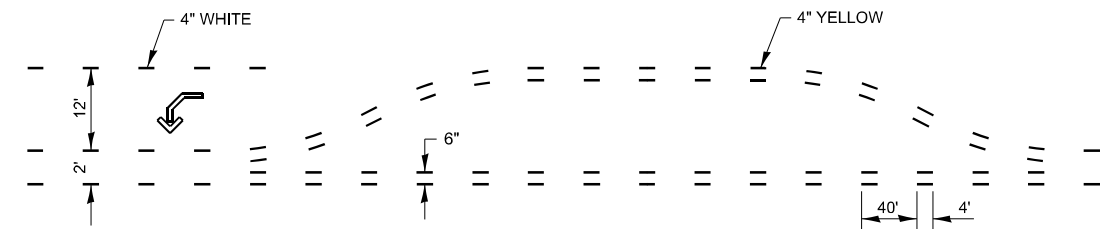

SHORT-TERM PAVEMENT MARKING FOR MEDIANS AND ARROWS

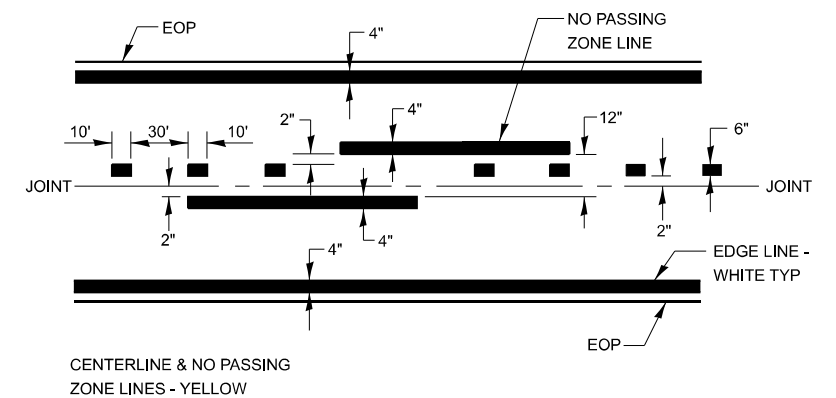

PAVEMENT MARKING

STATE OF ILLINOIS
 DEPARTMENT OF TRANSPORTATION

DETAILS

SCALE: SHEET OF SHEETS STA. TO STA.

S.B.I. RTE.	SECTION	COUNTY	TOTAL SHEETS	SHEET NO.
88	(103A)RS	BUREAU	15	12
ILLINOIS FED. AID PROJECT			CONTRACT NO. 66R30	

MODEL: Default
 FILE NAME: c:\p\work\pav\detail\detail.dgn

USER NAME = Cassandra.Nolasco	DESIGNED -	REVISED -
	DRAWN -	REVISED -
	CHECKED -	REVISED -
PLOT DATE = 12/5/2024	DATE -	REVISED -

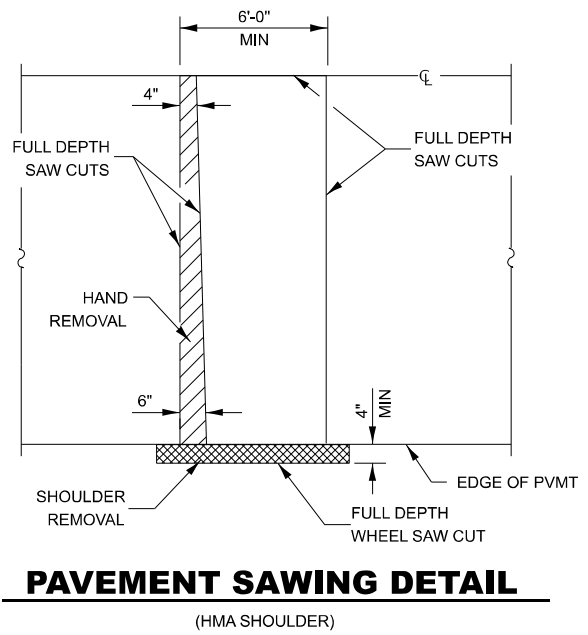

PAVEMENT SAWING DETAIL
(HMA SHOULDER)

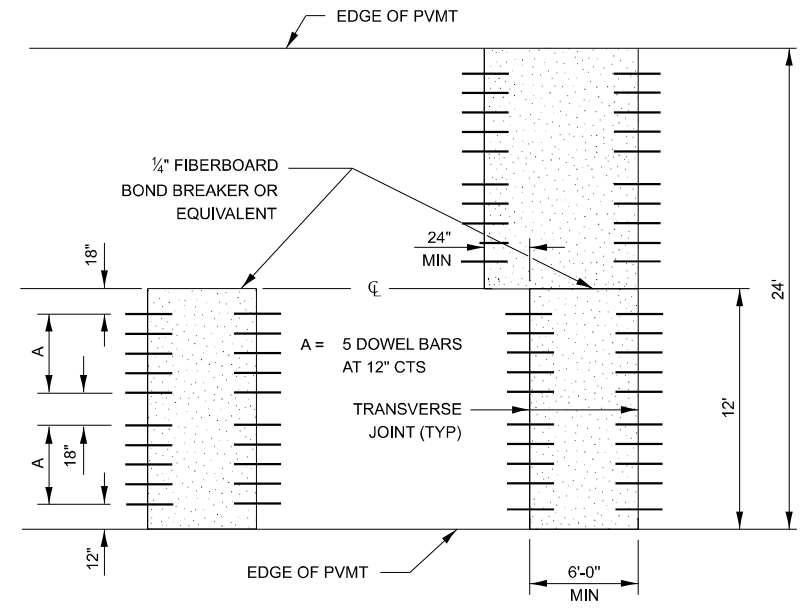

12' WIDE LANES

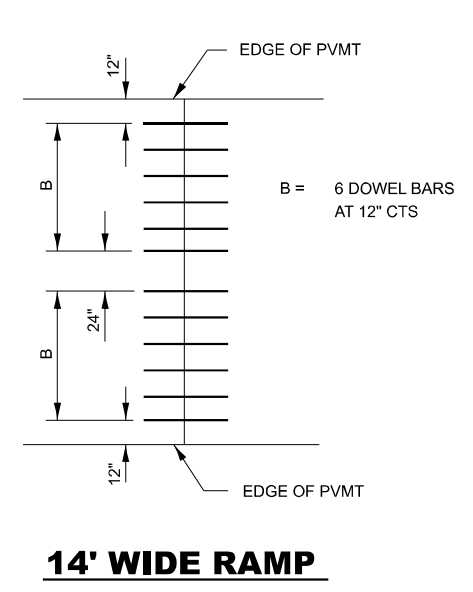

14' WIDE RAMP

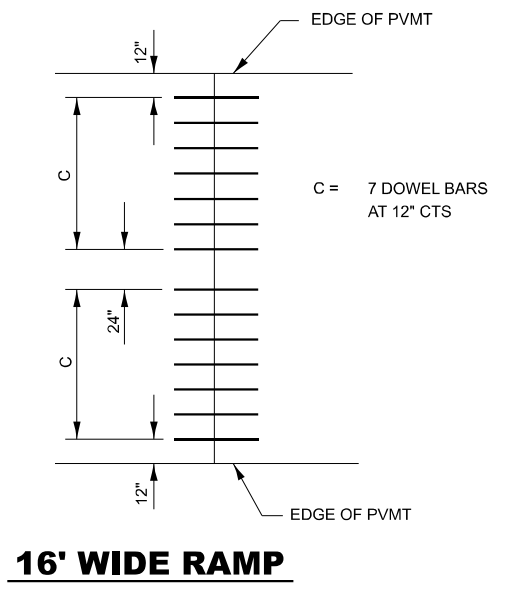

16' WIDE RAMP

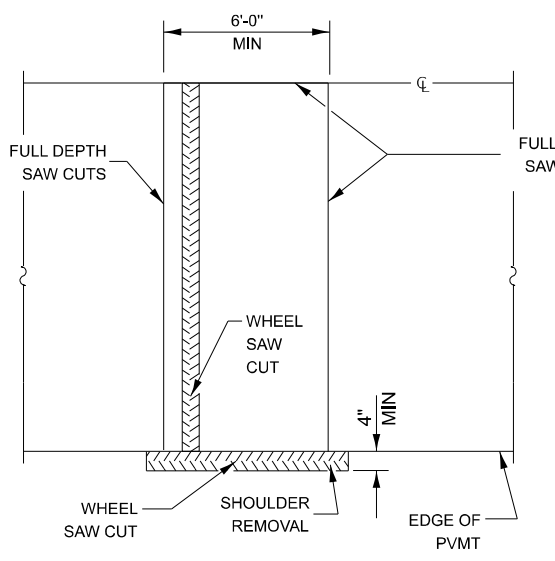

ALTERNATE SAWING DETAIL
(HMA SHOULDER)

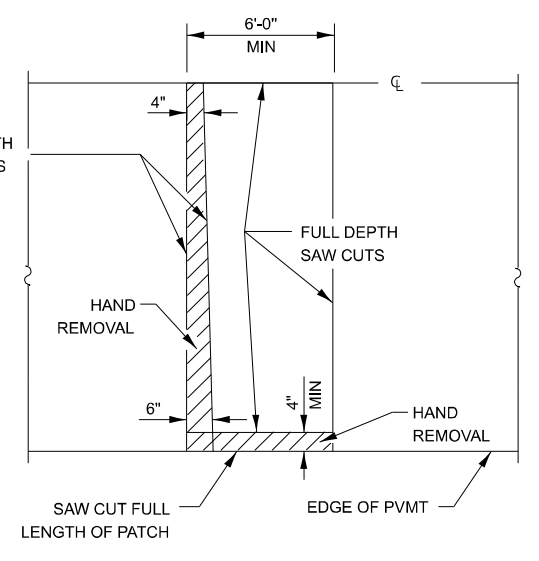

PAVEMENT SAWING DETAIL
(PCC SHOULDER)

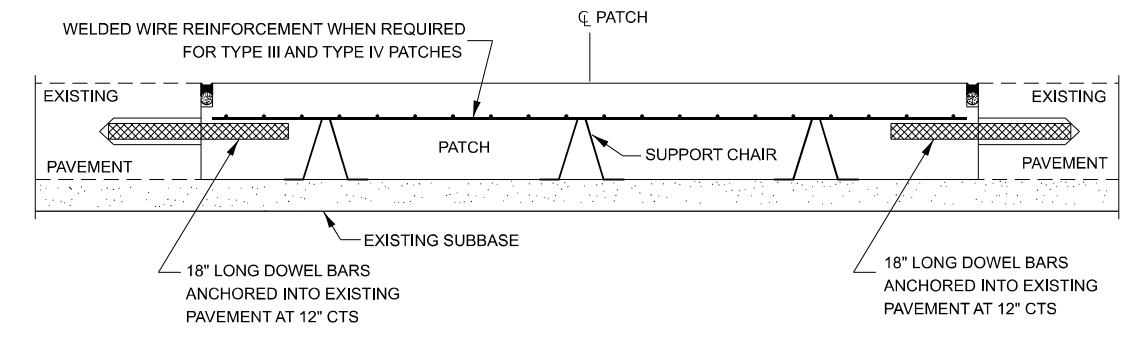

PATCHING WITHOUT HMA OVERLAY

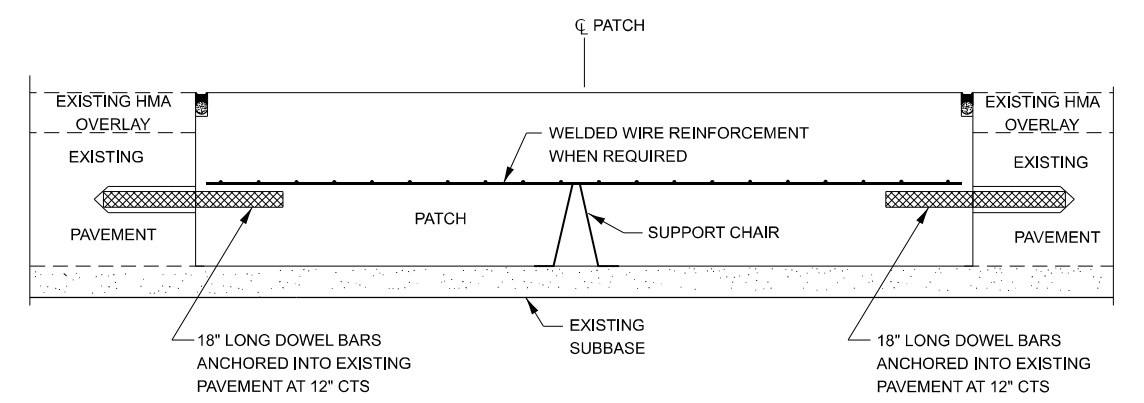

PATCHING WITH HMA OVERLAY

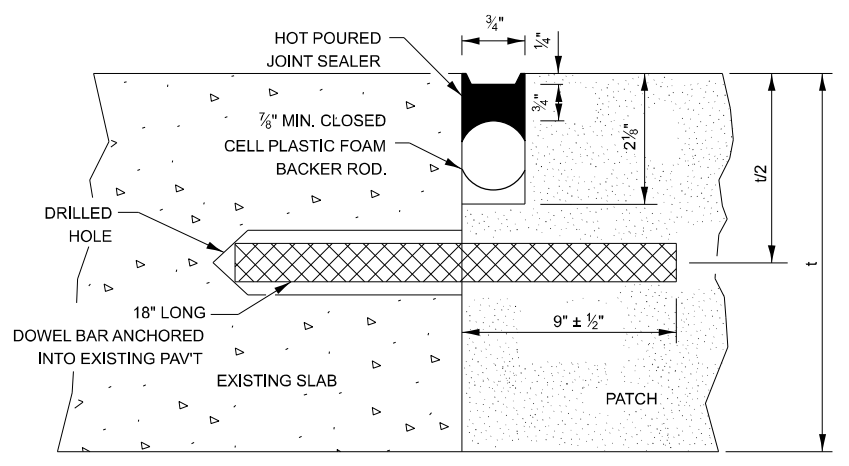

TRANSVERSE JOINT

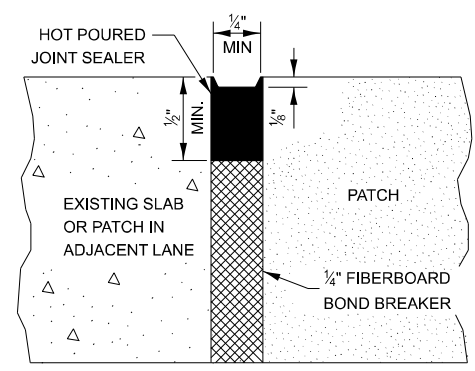

CENTERLINE JOINT

DOWEL BAR TABLE		
PAVEMENT THICKNESS	DOWEL BAR DIAMETER	HOLE DIAMETER
8" OR GREATER	1 1/2"	1 5/8"
7" THRU 7.99"	1 1/4"	1 3/8"
LESS THAN 7"	1"	1 1/8"

GENERAL NOTES

THE TRANSVERSE JOINTS FOR CLASS B PATCHES SHALL ALIGN WITH JOINTS OR CRACKS IN THE ADJACENT LANE WHENEVER POSSIBLE.
SEE STANDARD 420701 FOR DETAILS OF PAVEMENT WELDED WIRE REINFORCEMENT.

MODEL: Default
FILE NAME: c:\p\work\pav\hmalasoc\01045908\03666530-sh-1-details.dgn

USER NAME = Cassandra.Nolasco	DESIGNED -	REVISED -	STATE OF ILLINOIS DEPARTMENT OF TRANSPORTATION	CLASS B PATCHING DETAILS				S.B.I. RTE.	SECTION	COUNTY	TOTAL SHEETS	SHEET NO.			
PLOT DATE = 12/5/2024	DRAWN -	REVISED -						SCALE:	SHEET	OF	SHEETS	STA.	TO	STA.	88
	CHECKED -	REVISED -						CONTRACT NO. 66R30							
	DATE -	REVISED -						ILLINOIS FED. AID PROJECT							

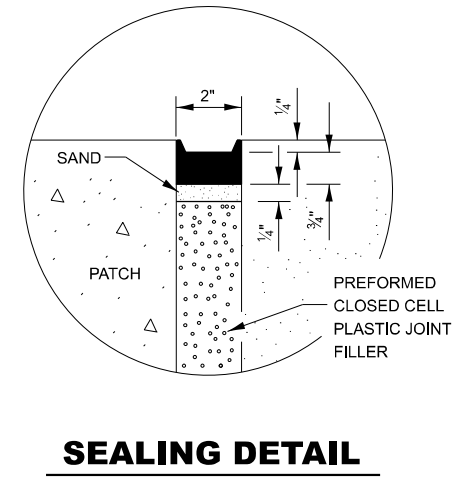
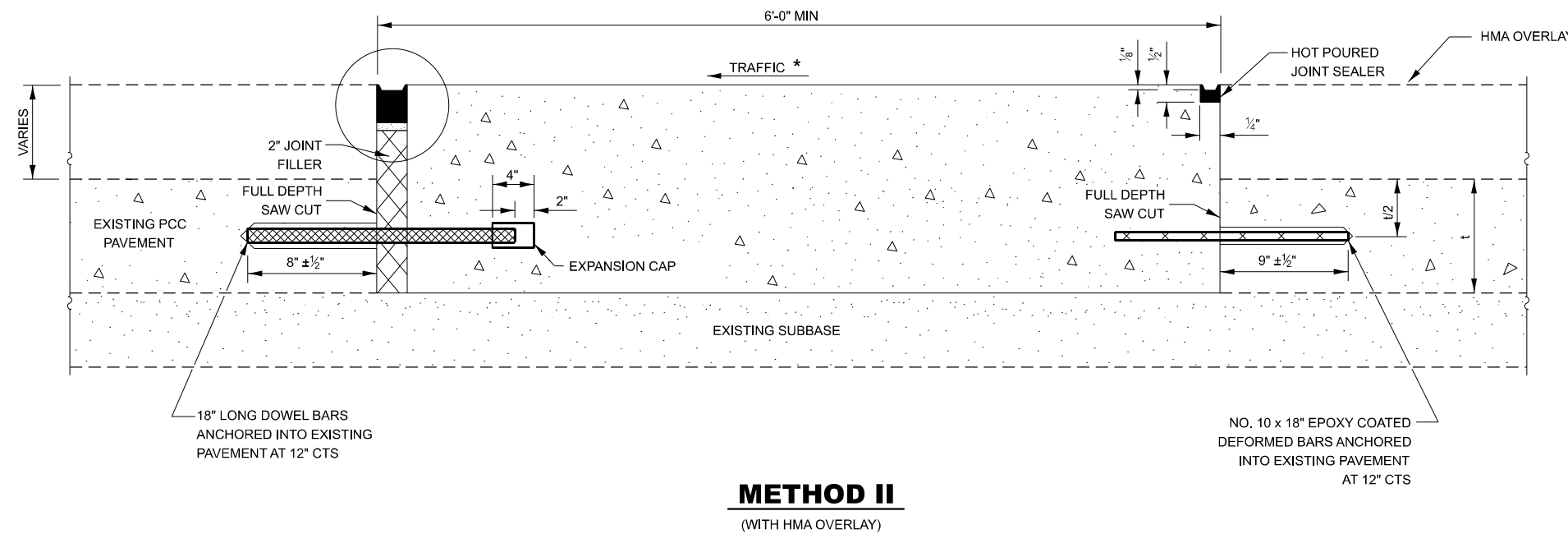
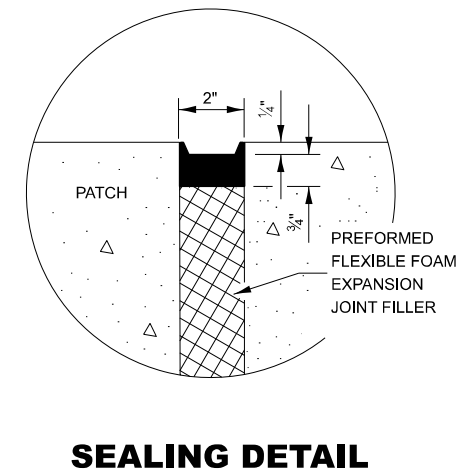
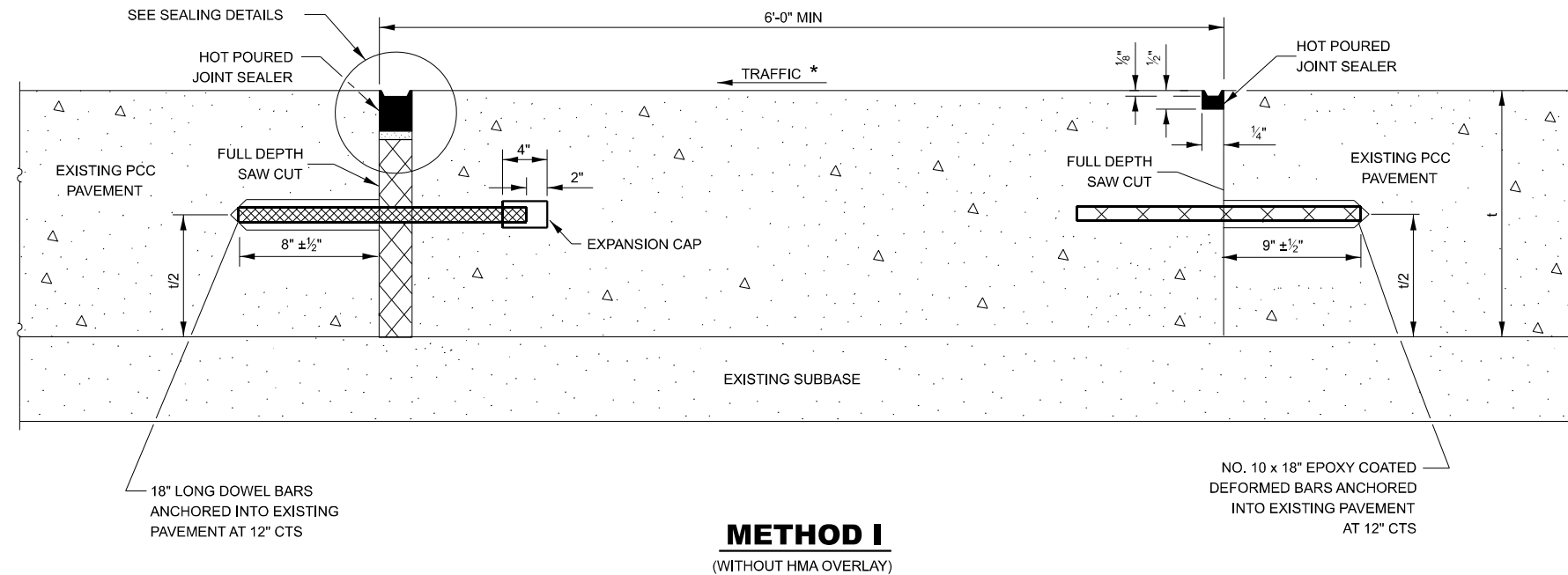

NOTE

* WHEN RE-ESTABLISHING A TRANSVERSE EXPANSION JOINT ON A TWO-WAY ROAD, REVERSE THE ORIENTATION OF THE DOWEL BARS WITH RESPECT TO TRAFFIC FOR ONE OF THE PATCHES SUCH THAT THE JOINT WILL BE CONTINUOUS ACROSS BOTH LANES.

MODEL: Default
FILE NAME: c:\pwworking\hinalasco\1045908\0366630-sh-1-details.dgn

USER NAME = Cassandra.Nolasco	DESIGNED -	REVISED -	STATE OF ILLINOIS DEPARTMENT OF TRANSPORTATION	CLASS B PATCHING DETAILS			S.B.I. RTE.	SECTION	COUNTY	TOTAL SHEETS	SHEET NO.
	DRAWN -	REVISED -					88	(103A)RS		15	14
PLOT DATE = 12/5/2024	CHECKED -	REVISED -		SCALE:	SHEET	OF	SHEETS	STA.	TO	STA.	CONTRACT NO. 66R30
	DATE -	REVISED -									ILLINOIS FED. AID PROJECT

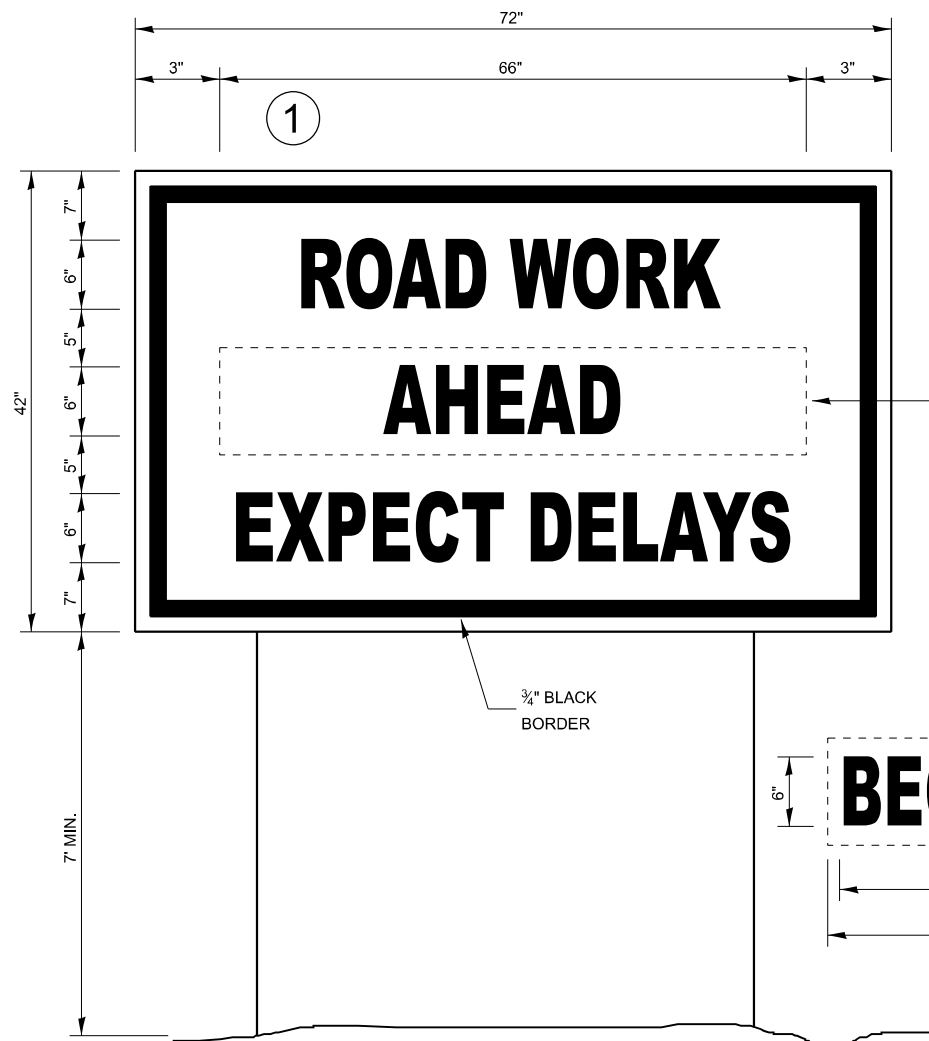

TEMPORARY INFORMATION SIGNING

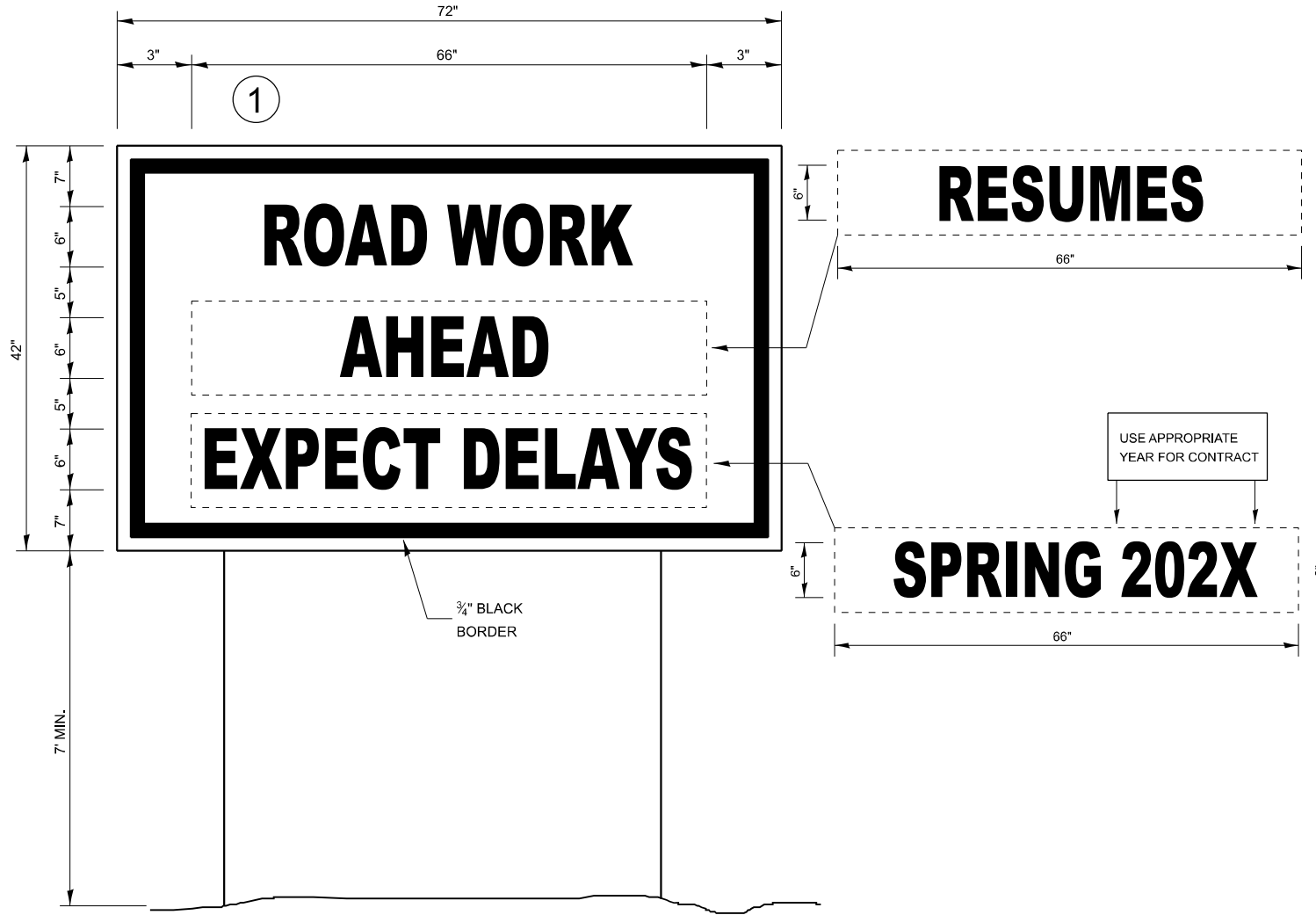

WINTER SHUT DOWN SIGNING

NOTES:

1. USE 6" D BLACK LETTERING ON FLOURESENT ORANGE BACKGROUND.
2. ERECT SIGNS AT LOCATIONS IN ADVANCE OF THE "ROAD CONSTRUCTION AHEAD" SIGNS AS DIRECTED BY THE ENGINEER.
3. ERECT SIGN 1 WITH INSTALLED PANEL 2 A MINIMUM OF ONE WEEK PRIOR TO THE START OF THE LANE CLOSURE.
4. REMOVE PANEL 2 ON THAT DATE.
5. SEE SPECIAL PROVISION "TEMPORARY INFORMATION SIGNING" FOR ADDITIONAL INFORMATION.
6. WILL BE PAID FOR PER SQ FT AS "TEMPORARY INFORMATION SIGNING". EACH SIGN = 21 SQ FT

MODEL: Default
FILE NAME: c:\p\work\pww\detail\alasco\01045908\0366630-shi-details.dgn

USER NAME = Cassandra.Nolasco	DESIGNED -	REVISED -
	DRAWN -	REVISED -
	CHECKED -	REVISED -
PLOT DATE = 12/5/2024	DATE -	REVISED -

**STATE OF ILLINOIS
DEPARTMENT OF TRANSPORTATION**

DETAILS

SCALE: SHEET OF SHEETS STA. TO STA.

S.B.I. RTE.	SECTION	COUNTY	TOTAL SHEETS	SHEET NO.
88	(103A)RS	BUREAU	15	15
			CONTRACT NO. 66R30	
		ILLINOIS FED. AID PROJECT		