

STATE OF ILLINOIS
DEPARTMENT OF TRANSPORTATION

F.A.P. RTE.	SECTION	COUNTY	TOTAL SHEETS	SHEET NO.
71	(2BR)BDR	LOGAN	7	1
		ILLINOIS	CONTRACT NO.	

FOR INDEX OF SHEETS, SEE SHEET NO. 2

**PROPOSED
HIGHWAY PLANS**

**FAP ROUTE 71 (IL 54)
SECTION (2BR)BDR
PROJECT STATE ONLY
BRIDGE DECK PATCHING
LOGAN COUNTY**

C-96-079-24



PROJECT LOCATION
SN 054-0031
AT LAKE FORK CREEK 2 MI NE
OF SANGAMON CO LINE

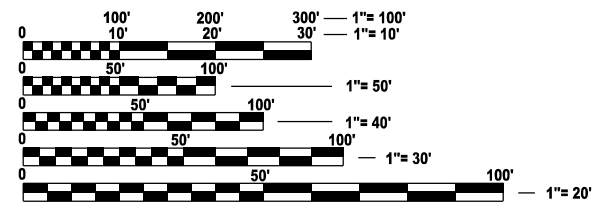

FULL SIZE PLANS HAVE BEEN PREPARED USING STANDARD ENGINEERING SCALES. REDUCED SIZED PLANS WILL NOT CONFORM TO STANDARD SCALES. IN MAKING MEASUREMENTS ON REDUCED PLANS, THE ABOVE SCALES MAY BE USED.

J.U.L.I.E.
JOINT UTILITY LOCATION INFORMATION FOR EXCAVATION
1-800-892-0123
OR 811

PROJECT ENGINEER: BRANDON DUDLEY (217) 785-9290
PROJECT MANAGER: DAVID MUDRA (217) 970-0651

CONTRACT NO. 72748

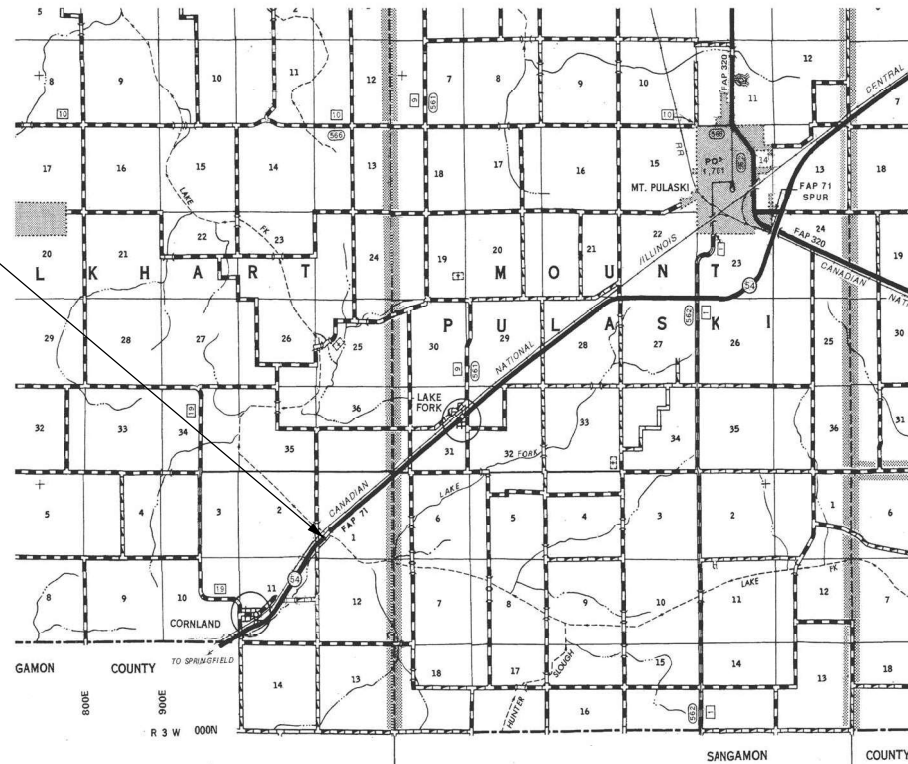

GROSS LENGTH = 454.5 FT. = 0.086 MILE
NET LENGTH = 454.5 FT. = 0.086 MILE

D-96-057-24

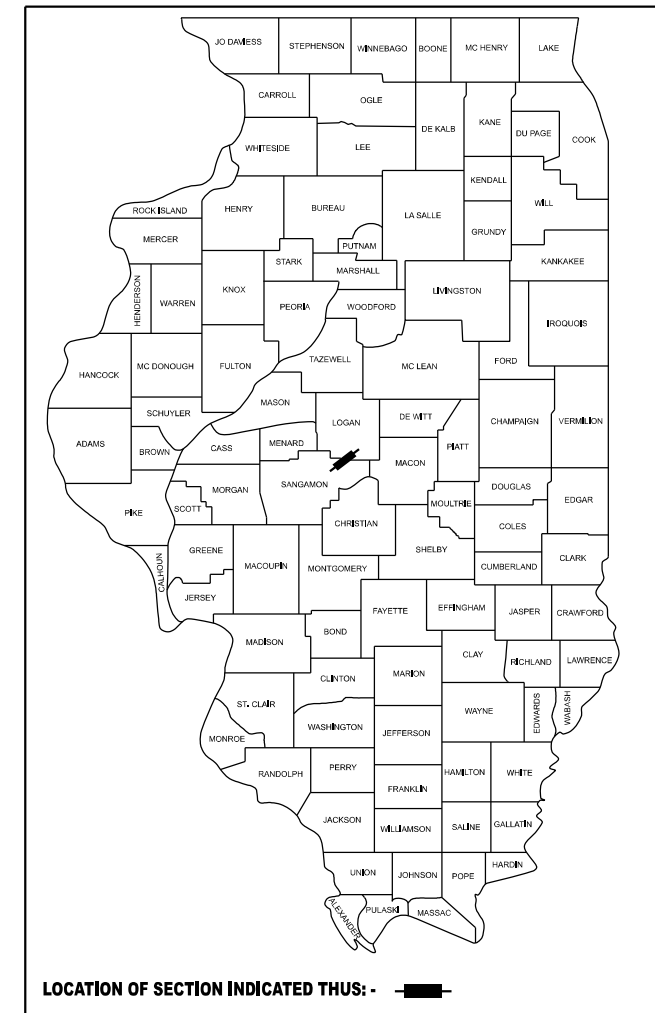

STATE OF ILLINOIS
DEPARTMENT OF TRANSPORTATION

SUBMITTED December 10 20 24
[Signature] REGIONAL ENGINEER
January 31 20 25
[Signature] ENGINEER OF DESIGN AND ENVIRONMENT
January 31 20 25
[Signature] 5
DIRECTOR OF HIGHWAYS PROJECT IMPLEMENTATION

**PRINTED BY THE AUTHORITY
OF THE STATE OF ILLINOIS**



INDEX OF SHEETS

- 1 COVER SHEET
- 2 INDEX, STANDARDS, GENERAL NOTES, SIGNATURES
- 3 SUMMARY OF QUANTITIES
- 4-5 TRAFFIC CONTROL PLAN
- 6 BRIDGE PLAN & ELEVATION
- 7 SLAB REPAIR DETAIL

HIGHWAY STANDARDS

- 000001-08
- 001001-02
- 001006
- 701001-02
- 701006-05
- 701301-04
- 701311-03
- 701316-14
- 701901-10

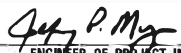
GENERAL NOTES:

STATE OF ILLINOIS DEPARTMENT OF TRANSPORTATION DIVISION OF HIGHWAYS DISTRICT 6	
EXAMINED	December 10, 20 24
 ENGINEER OF OPERATIONS	
EXAMINED	December 9, 20 24
 ENGINEER OF PROJECT IMPLEMENTATION	
EXAMINED	December 11, 20 24
 ENGINEER OF PROGRAM DEVELOPMENT	

REV - MS

MODEL: index [Sheet]
FILE NAME: c:\p\work\pwr\std\dudley\mtd1007000\72748 plansheet.dgn

	USER NAME = brandon.dudley	DESIGNED -	REVISED -	STATE OF ILLINOIS DEPARTMENT OF TRANSPORTATION	INDEX OF SHEETS, HIGHWAY STANDARDS GENERAL NOTES, & SIGNATURES	F.A.P. RTE.	SECTION	COUNTY	TOTAL SHEETS	SHEET NO.	
		DRAWN -	REVISED -			71	(2BR)BDR	LOGAN	7	2	
		CHECKED -	REVISED -			CONTRACT NO. 72748					
	PLOT DATE = 10/25/2024	DATE -	REVISED -			SCALE:	SHEET 2	OF 1	SHEETS	STA.	TO STA.

0-02179-6018
 SN 054-0031
 100% STATE

CODE NO.	ITEM	UNIT	TOTAL QUANTITY	BRIDGE
				0047 RURAL
50300300	PROTECTIVE COAT	SQ YD	200	200
67100100	MOBILIZATION	L SUM	1	1
70100100	TRAFFIC CONTROL AND PROTECTION, STANDARD 701316	EACH	1	1
70106500	TEMPORARY BRIDGE TRAFFIC SIGNALS	EACH	1	1
70106700	TEMPORARY RUMBLE STRIPS	EACH	6	6
70107025	CHANGABLE MESSAGE SIGN	CAL DAY	74	74
* 78009005	MODIFIED URETHANE PAVEMENT MARKING - LINE 5"	FOOT	4200	4200
78300201	PAVEMENT MARKING REMOVAL - GRINDING	SQ FT	1100	1100
X7200201	WIDTH RESTRICTION SIGNING	L SUM	1	1
Z0001800	APPROACH SLAB REPAIR (PARTIAL DEPTH)	SQ YD	28	28
Z0016001	DECK SLAB REPAIR (FULL DEPTH, TYPE I)	SQ YD	22	22
Z0016200	DECK SLAB REPAIR (PARTIAL)	SQ YD	145	145
Z0032500	JOINT SEALING (PATCHES)	FOOT	2050	2050

* SPECIALTY ITEM

REV - MS

MODEL: SQO (Sheet)
 FILE NAME: c:\p\work\pwr\stod\duley\mtd1007000\72748.plansheet.dgn

USER NAME = brandon.dudley	DESIGNED -	REVISED -
	DRAWN -	REVISED -
	CHECKED -	REVISED -
PLOT DATE = 10/25/2024	DATE -	REVISED -

STATE OF ILLINOIS
 DEPARTMENT OF TRANSPORTATION

SUMMARY OF QUANTITIES

SCALE: SHEET 3 OF 1 SHEETS STA. TO STA.

F.A.P. RTE.	SECTION	COUNTY	TOTAL SHEETS	SHEET NO.
71	(2BR)BDR	LOGAN	7	3
ILLINOIS FED. AID PROJECT			CONTRACT NO. 72748	

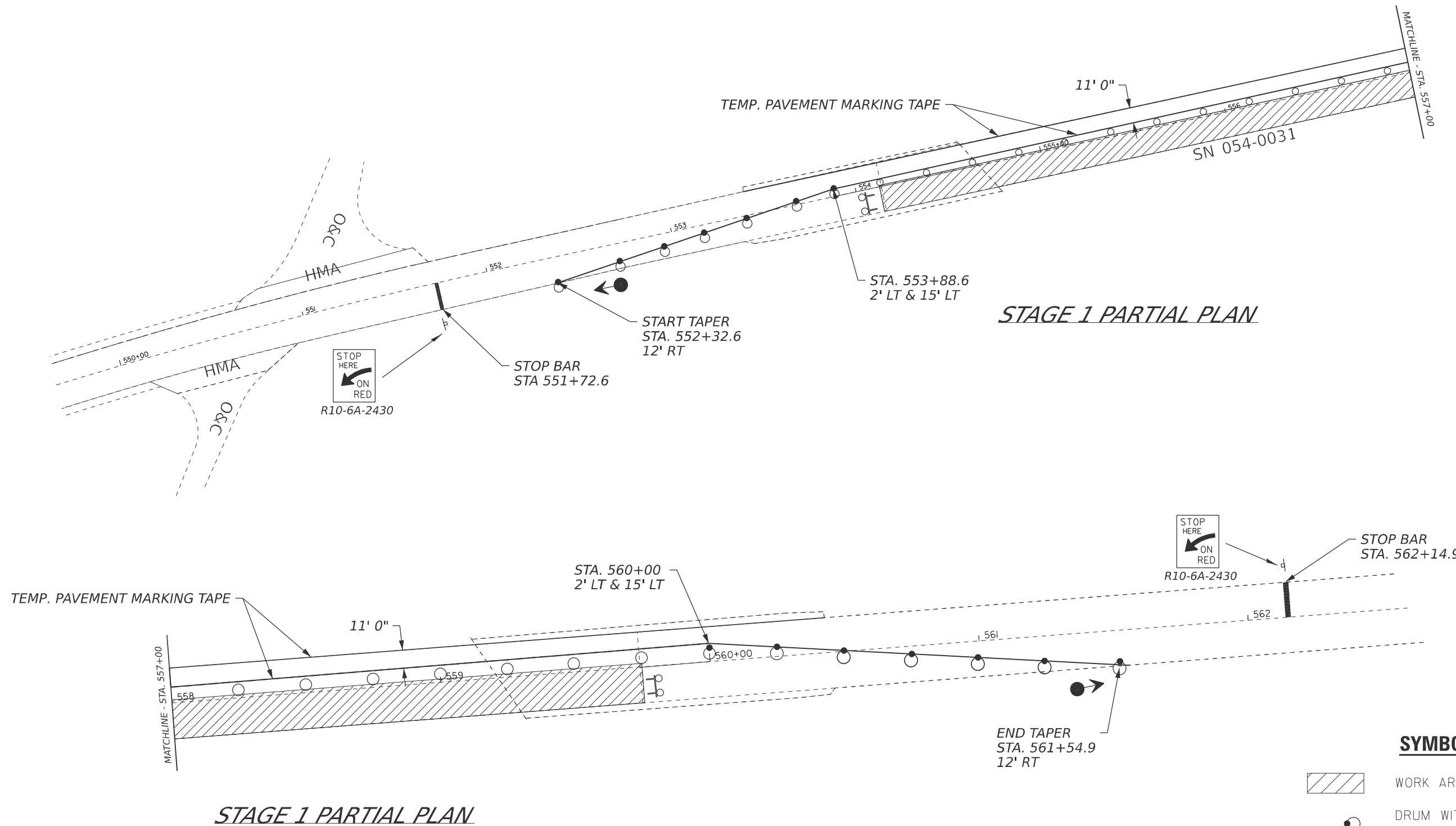





STAGE 1 PARTIAL PLAN

STAGE 1 PARTIAL PLAN

TRAFFIC CONTROL NOTES:

1. Traffic control devices not shown in this detail shall be per standard 701316. Devices and temporary pavement markings shown in this detail shall be included in the cost of TRAFFIC CONTROL AND PROTECTION, STANDARD 701316. Temporary rumble strips and temporary traffic signals shall be paid separately.

SYMBOLS

-  WORK AREA
-  DRUM WITH STEADY BURN BI-DIRECTIONAL LIGHT
-  DRUM
-  TRAFFIC SIGNAL
-  TYPE III BARRICADE WITH FLASHING LIGHTS

MODEL: traffic-1 (Sheet)
FILE NAME: c:\p\work\pav\traffic\brandondudley\mtd1007000\072748 plan sheet.dgn

USER NAME = brandon.dudley	DESIGNED -	REVISED -
	DRAWN -	REVISED -
	CHECKED -	REVISED -
PLOT DATE = 10/25/2024	DATE -	REVISED -

**STATE OF ILLINOIS
DEPARTMENT OF TRANSPORTATION**

STAGE I TRAFFIC CONTROL PLAN			
SCALE:	SHEET 4	OF 2	SHEETS
STA.		TO STA.	



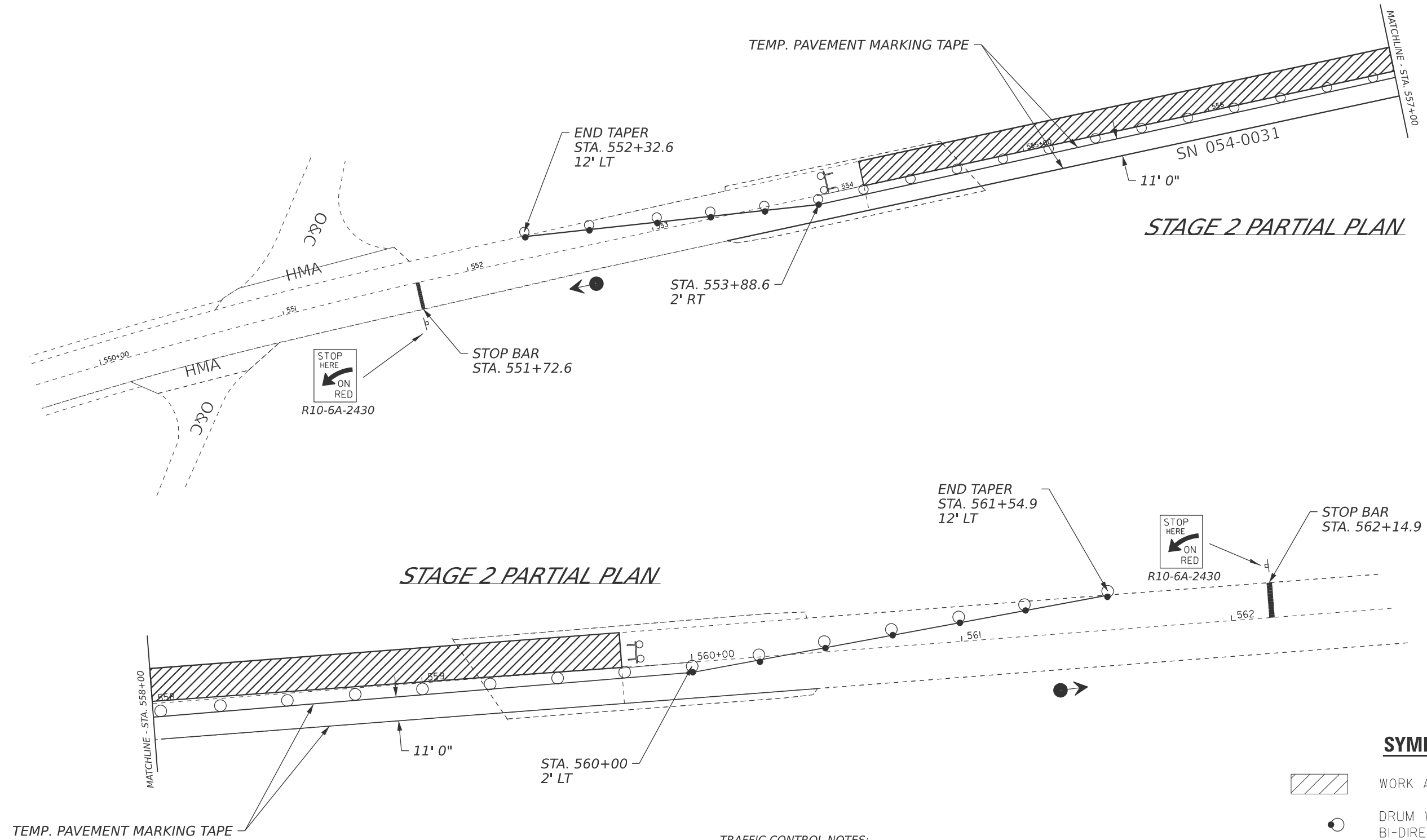

F.A.P. RTE.	SECTION	COUNTY	TOTAL SHEETS	SHEET NO.
71	(2BR)BDR	LOGAN	7	4
CONTRACT NO. 72748				
ILLINOIS FED. AID PROJECT				



STAGE 2 PARTIAL PLAN

STAGE 2 PARTIAL PLAN

SYMBOLS

-  WORK AREA
-  DRUM WITH STEADY BURN BI-DIRECTIONAL LIGHT
-  DRUM
-  TRAFFIC SIGNAL
-  TYPE III BARRICADE WITH FLASHING LIGHTS

TRAFFIC CONTROL NOTES:
 1. Traffic control devices not shown in this detail shall be per standard 701316. Devices and temporary pavement markings shown in this detail shall be included in the cost of TRAFFIC CONTROL AND PROTECTION, STANDARD 701316. Temporary rumble strips and temporary traffic signals shall be paid separately.

MODEL: traffic-2 (Sheet)
 FILE NAME: c:\p\work\project\dudley\mtd1007000\72748 plan sheet.dgn

USER NAME = brandon.dudley	DESIGNED -	REVISED -
	DRAWN -	REVISED -
	CHECKED -	REVISED -
PLOT DATE = 10/25/2024	DATE -	REVISED -

**STATE OF ILLINOIS
 DEPARTMENT OF TRANSPORTATION**

STAGE II TRAFFIC CONTROL PLAN			
SCALE:	SHEET 5	OF 2 SHEETS	STA. TO STA.

F.A.P. RTE.	SECTION	COUNTY	TOTAL SHEETS	SHEET NO.
71	(2BR)BDR	LOGAN	7	5
CONTRACT NO. 72748				
ILLINOIS FED. AID PROJECT				

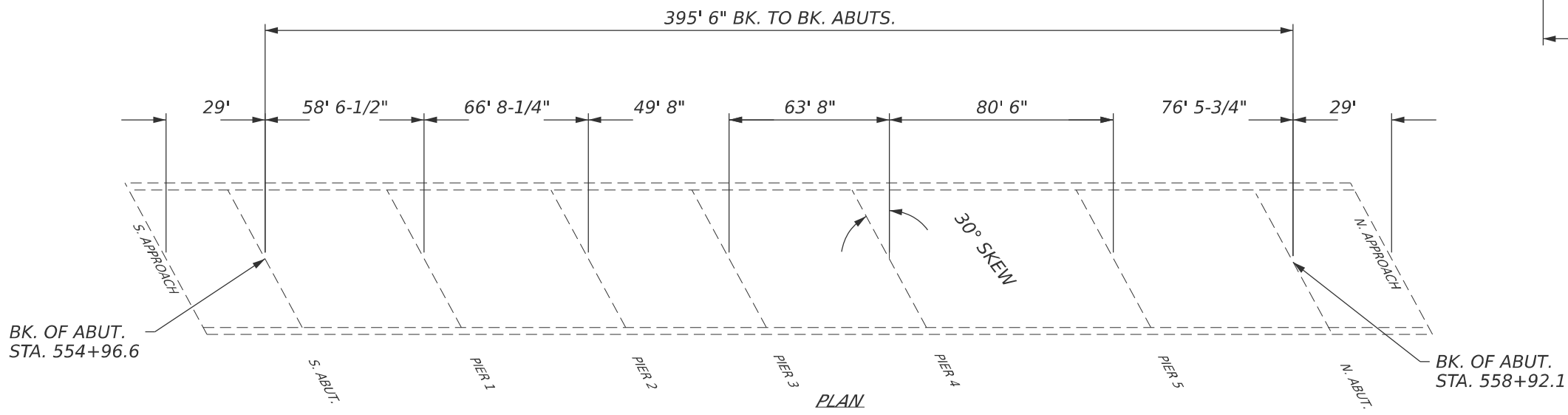
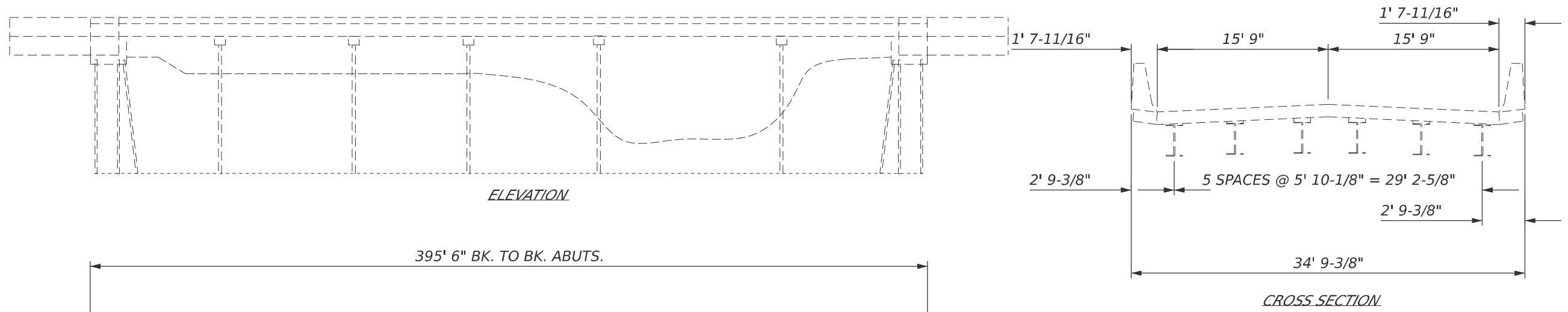
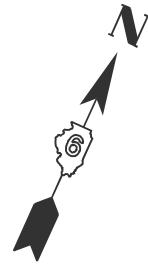

GENERAL NOTES

Prior to pouring the new concrete deck, all heavy or loose rust, loose mill scale, and other loose or potentially detrimental foreign material shall be removed from the surfaces in contact with concrete. Tightly adhered paint may remain unless otherwise noted. Removal shall be accomplished by methods that will not damage the steel and the cost will be included in the pay item covering removal of the existing concrete.

Plan dimensions and details relative to the existing structure have been taken from existing plans and are subject to nominal construction variations. The Contractor shall field verify existing dimensions and details affecting new construction and make necessary approved adjustments prior to construction or ordering of materials. Such variations shall not be cause for additional compensation for a change in scope of the work, however, the Contractor will be paid for the quantity actually furnished at the unit price bid for the work.

Areas of deck repairs shown are estimated. The Engineer shall show actual locations of deck repairs on As-built Plans.

Protective coat shall be applied to new concrete only.

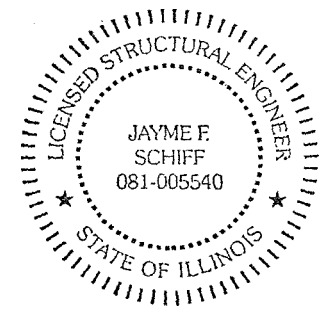

EXPIRES 11-30-2026

Jayme F. Schiff

TOTAL BILL OF MATERIAL

ITEM	UNIT	QUANTITY
Deck Slab Repair (Partial)	Sq. Yd.	145
Deck Slab Repair (Full Depth, Type I)	Sq. Yd.	22
Approach Slab Repair (Partial Depth)	Sq. Yd.	28
Joint Sealing (Patches)	Foot	2050
Protective Coat	Sq. Yd.	200

MODEL: bridge-1 (Sheet)
FILE NAME: c:\p\work\bridge\duffy\mtd\007000\072748 plan sheet.dgn

USER NAME = brandon.dudley	DESIGNED -	REVISED -
	DRAWN -	REVISED -
	CHECKED -	REVISED -
PLOT DATE = 10/25/2024	DATE -	REVISED -

**STATE OF ILLINOIS
DEPARTMENT OF TRANSPORTATION**

**BRIDGE PLAN & ELEVATION
SN 054-0031**

SCALE: SHEET 6 OF 2 SHEETS STA. TO STA.

F.A.P. RTE.	SECTION	COUNTY	TOTAL SHEETS	SHEET NO.
71	(2BR)BDR	LOGAN	7	6
CONTRACT NO. 72748				
ILLINOIS FED. AID PROJECT				

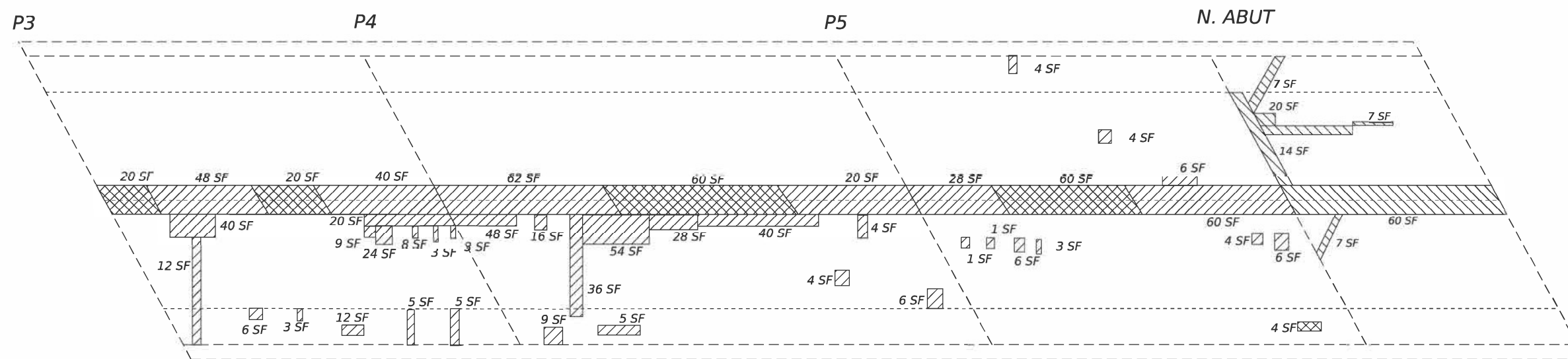
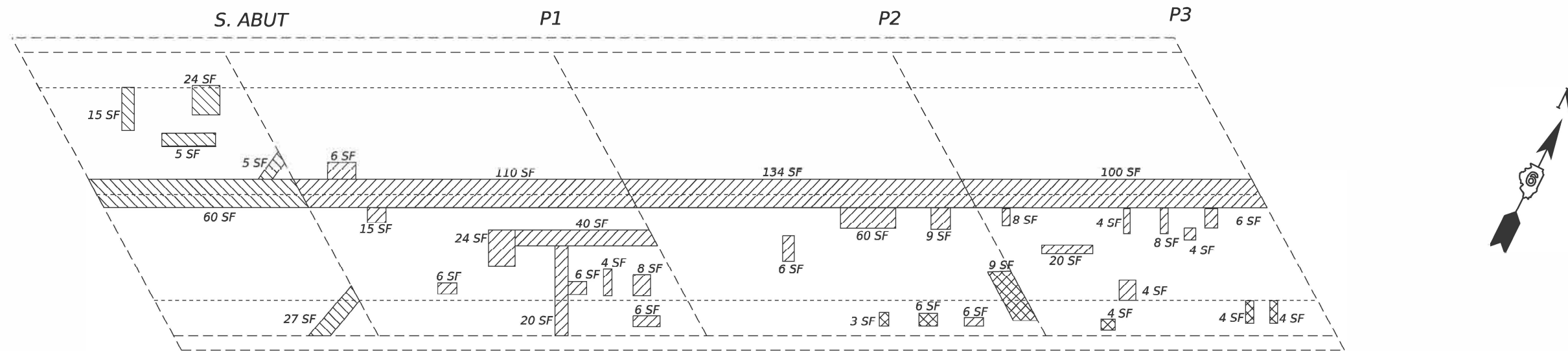

APPROACH SLAB REPAIR (PARTIAL DEPTH)
 DECK SLAB REPAIR (PARTIAL DEPTH)
 DECK SLAB REPAIR (FULL DEPTH)

BILL OF MATERIAL

ITEM	UNIT	QUANTITY
Deck Slab Repair (Partial)	Sq. Yd.	145
Deck Slab Repair (Full Depth, Type I)	Sq. Yd.	22
Approach Slab Repair (Partial Depth)	Sq. Yd.	28
Joint Sealing (Patches)	Foot	2050
Protective Coat	Sq. Yd.	200

Identified patching locations are estimated from a deck survey performed on 5/19/2022. The patching survey is included for information only. The engineer shall lay out actual patch locations in the field.

The engineer shall show actual loactions of deck repairs on as-built plans.

Full depth patches shall be covered with steel plates during non-work hours.

JOINT SEALING (PATCHES) shall be applied in locations as directed in the special provisions, along the entire length of any existing stage construction joints, and along the construction joints between the abutment and approaches.

MODEL: bridge-2 (Sheet)
 FILE NAME: c:\paw\work\paw\bridge\bridge\mtd1007000\72748\plansheet.dgn

USER NAME = brandon.dudley	DESIGNED -	REVISED -
	DRAWN -	REVISED -
	CHECKED -	REVISED -
PLOT DATE = 10/25/2024	DATE -	REVISED -

**STATE OF ILLINOIS
DEPARTMENT OF TRANSPORTATION**

**SLAB REPAIR DETAIL
SN 054-0031**

SCALE: SHEET 7 OF 2 SHEETS STA. TO STA.

F.A.P. RTE.	SECTION	COUNTY	TOTAL SHEETS	SHEET NO.
71	(2BR)BDR	LOGAN	7	7
CONTRACT NO. 72748				
ILLINOIS FED. AID PROJECT				