

- 1 COVER SHEET
- 2 GENERAL NOTES
- 3-6 SUMMARY OF QUANTITIES
- 7-10 TYPICAL SECTIONS
- 11-15 LINE DIAGRAM
- 16-23 SCHEDULES
- 24-30 DETAILS

LIST OF ILLINOIS DOT HIGHWAY STANDARDS

- 000001-08 STANDARD SYMBOLS, ABBREVIATIONS AND PATTERNS
- 001006 DECIMAL OF AN INCH AND OF A FOOT
- 406201-01 MAILBOX TURNOUT
- 442201-03 CLASS C AND D PATCHES
- 542301-03 PRECAST REINFORCED CONCRETE FLARED END SECTION
- 635001-02 DELINEATORS
- 642006-01 SHOULDER RUMBLE STRIPS, 8 INCH
- 667101-02 PERMANENT SURVEY MARKERS
- 701001-02 OFF-ROAD OPERATIONS 2L, 2W, MORE THAN 15' AWAY
- 701006-05 OFF-ROAD OPERATIONS 2L, 2W, 15' TO 24" FROM PAVEMENT EDGE
- 701011-04 OFF-ROAD MOVING OPERATIONS 2L, 2W, DAY ONLY
- 701201-05 LANE CLOSURE, 2L, 2W, DAY ONLY, FOR SPEEDS \geq 45 MPH
- 701206-05 LANE CLOSURE, 2L, 2W, NIGHT ONLY, FOR SPEEDS \geq 45 MPH
- 701301-04 LANE CLOSURE, 2L, 2W, SHORT TIME OPERATIONS
- 701306-04 LANE CLOSURE, 2L, 2W, SLOW MOVING OPERATIONS DAY ONLY, FOR SPEEDS \geq 45 MPH
- 701311-03 LANE CLOSURE, 2L, 2W, MOVING OPERATIONS - DAY ONLY
- 701901-10 TRAFFIC CONTROL DEVICES
- 780001-05 TYPICAL PAVEMENT MARKINGS
- 781001-04 TYPICAL APPLICATIONS RAISED REFLECTIVE PAVEMENT MARKERS
- 782006-01 GUARDRAIL AND BARRIER WALL REFLECTOR MOUNTING DETAILS

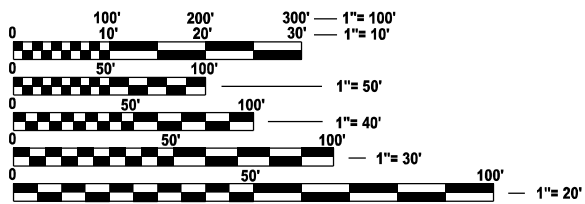

FULL SIZE PLANS HAVE BEEN PREPARED USING STANDARD ENGINEERING SCALES. REDUCED SIZED PLANS WILL NOT CONFORM TO STANDARD SCALES. IN MAKING MEASUREMENTS ON REDUCED PLANS, THE ABOVE SCALES MAY BE USED.

J.U.L.I.E.
JOINT UTILITY LOCATION INFORMATION FOR EXCAVATION
 1-800-892-0123
 OR 811

PROJECT ENGINEER: JOE KANNEL, P.E.
UNIT CHIEF: DARCY MITCHELL
DISTRICT 3 NO. (815) 434-6131
CONTRACT NO. 66M57

STATE OF ILLINOIS
DEPARTMENT OF TRANSPORTATION

PROPOSED
HIGHWAY PLANS

FAP 557 (IL 72) & FAP 324 (IL 23)
SECTION (128)RS-5 & (25)RS-5
PROJECT NHPP-PI20(511)
MILLING AND RESURFACING
DEKALB COUNTY

C-93-080-22

R 5 E

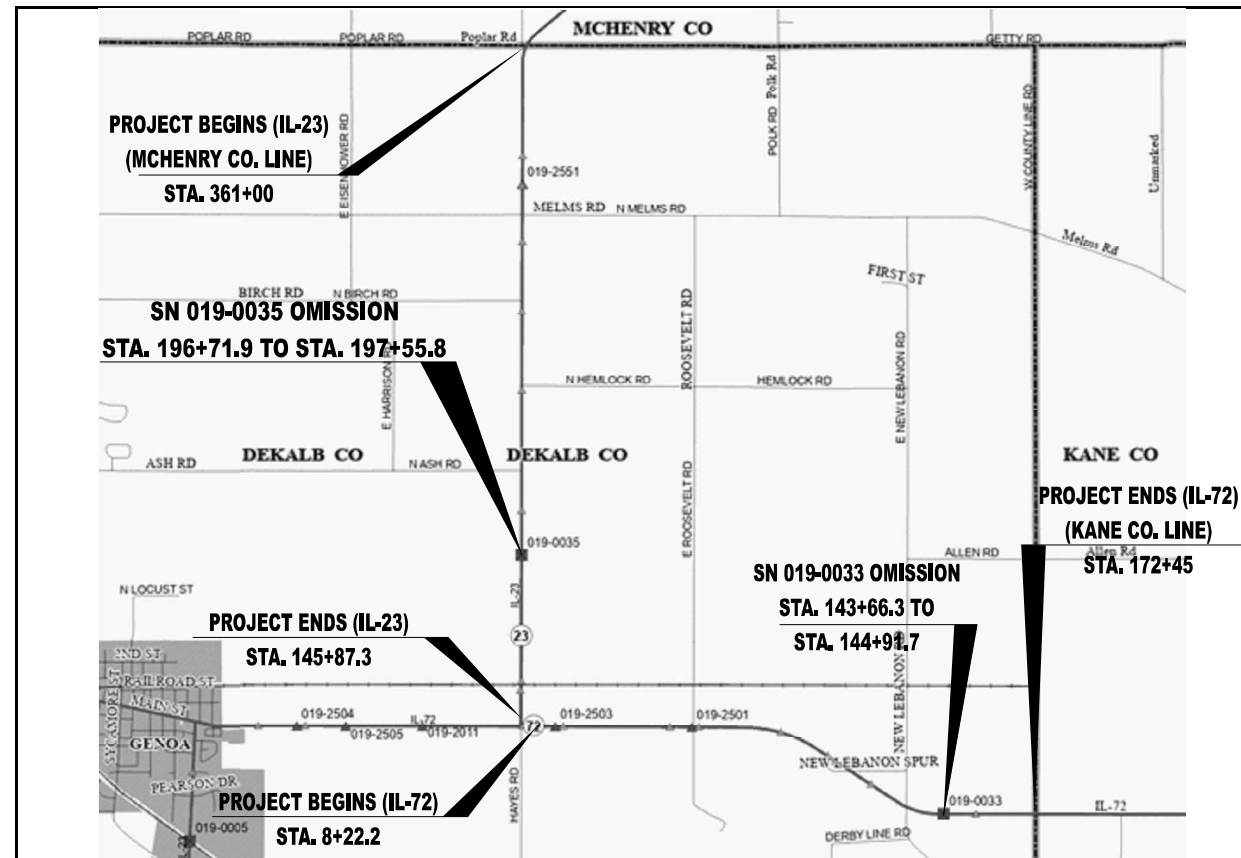

GROSS LENGTH = 37927.88 FT. = 7.183 MILE
 NET LENGTH = 37718.59 FT. = 7.144 MILE

F.A.P. RTE.	SECTION	COUNTY	TOTAL SHEETS	SHEET NO.
-	(128)RS-5 & (25)RS-5	DEKALB	30	1
		ILLINOIS	CONTRACT NO. 66M57	

* FAP 557 (IL 72), FAP 324 (IL 23)

D-93-058-22

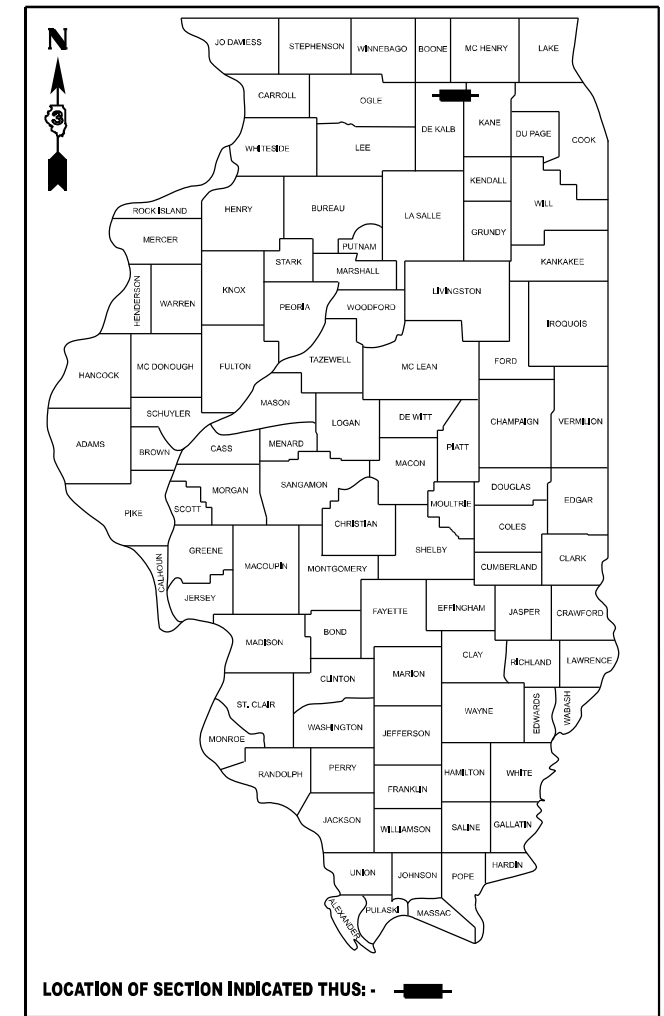

LOCATION OF SECTION INDICATED THUS: - [Symbol] -

IL 72 OTHER PRINCIPAL ARTERIAL
 ADT (2023) = 5150
 P.V. = 88.8% M.U. = 8.7% S.U. = 2.5%

IL 23 OTHER PRINCIPAL ARTERIAL
 ADT (2023) = 3600
 P.V. = 88.1% M.U. = 8.3% S.U. = 3.6%

T 42 N

STATE OF ILLINOIS
 DEPARTMENT OF TRANSPORTATION

SUBMITTED December 13, 2024
Trisha Thompson
 REGIONAL ENGINEER

January 31, 2025
Scott A. [Signature]
 ENGINEER OF DESIGN AND ENVIRONMENT

January 31, 2025
[Signature]
 DIRECTOR OF HIGHWAYS PROJECT IMPLEMENTATION

PRINTED BY THE AUTHORITY
OF THE STATE OF ILLINOIS

GENERAL NOTES

THE HMA SURFACE OF ALL MAILBOX TURNOUTS, PRIVATE ENTRANCES, COMMERCIAL ENTRANCES, AND SIDE ROADS SHALL BE MADE NEATLY, IN A WORKMANLIKE MANNER, AND SHALL ACCURATELY CONFORM TO THE SHAPES AND DIMENSIONS SHOWN ON THE PLAN DETAILS. IF REQUIRED BY THE ENGINEER, THE CONTRACTOR SHALL SAW CUT THE HMA SURFACE TO CONFORM TO THE SHAPES AND DIMENSIONS SHOWN ON THE PLAN DETAILS. THIS WORK WILL BE INCLUDED IN THE COST OF THE HMA SURFACE.

EXCEPT AS NOTED ON THE PLANS, PAVEMENT GRADES SHOWN ARE AT THE TOP OF PAVEMENT SURFACES.

BEFORE ORDERING PIPE CULVERTS OR PIPE DRAINS, THE CONTRACTOR SHALL CONSULT THE ENGINEER FOR EXACT LENGTHS.

THE ENGINEER WILL BE THE SOLE JUDGE CONCERNING CURING TIME FOR THE VARIOUS HMA LIFTS.

THE FINISHED EARTHWORK SHALL HAVE A VEGETATION SUSTAINING SOIL COVERING THE TOP FOUR INCHES (100 MILLIMETERS) IN AREAS TO BE SEEDED OR SODDED. THE VEGETATION SUSTAINING SOIL REQUIRED WILL NOT BE PAID FOR SEPARATELY BUT WILL BE INCLUDED IN THE COST OF FURNISHED EXCAVATION.

ALL EXCAVATED MATERIAL ON IL-23, WHICH INCLUDES DIGGING OR GRADING OF ANY SOIL OR FILL MATERIAL, WITH THE EXCEPTION OF AGGREGATE FILLS, MUST BE INCORPORATED WITHIN THE IDOT RIGHT OF WAY FOR IL-23 SECTION.

ON EXISTING PAVEMENT WHICH MAY BE SUPERELEVATED, THE NEW HMA PAVEMENT SHALL BE BUILT WITH THE SAME SUPERELEVATION UNLESS NEW SUPERELEVATION RATES ARE GIVEN ON THE PLANS.

ALL ELEVATIONS REFERRING TO U.S.G.S. MEAN SEA LEVEL DATUM.

THE FOLLOWING RATES OF APPLICATION HAVE BEEN USED IN CALCULATING PLAN QUANTITIES:

GRANULAR MATERIALS	2.05	TONS / CU YD
HMA RESURFACING	112	LBS / SQ YD / IN
SHORT TERM PAVEMENT MARKING	10	FT /100 FT OF APPLICATION
MIX FOR CRACKS, JTS & FLGWYS	0.0003	TONS / SQ YD

THE WORK REQUIRED TO CONNECT ANY SEWER TO AN EXISTING DRAINAGE STRUCTURE OR PIPE WILL NOT BE PAID FOR SEPARATELY, BUT WILL BE CONSIDERED AS INCLUDED IN THE CONTRACT UNIT PRICE BID FOR THE SEWER ITEMS.

MEMBERS OF JULIE KNOWN TO BE WITHIN THE LIMITS OF THE IMPROVEMENT ARE: ATT DISTRIBUTION, COM ED, FRONTIER, GUARDIAN PIPELINE CITY OF GENOA, METRO FIBERNET, NICOR, SPECTRUM COMMUNICATION

NON-MEMBERS OF JULIE KNOWN TO BE WITHIN THE LIMITS OF THE IMPROVEMENT ARE: IDOT

COMMITMENTS:

NONE

HMA MIXTURE REQUIREMENT TABLE

LOCATIONS:	IL 72 & IL 23	IL 72	IL 23	ENTIRE PROJECT
MIXTURE USE(S):	HMA SURFACE	HMA BINDER	HMA BINDER	HMA INCIDENTAL
BINDER GRADE (PG):	PG 64-22	PG 64-22	PG 64-22	PG 64-22
DESIGN AIR VOIDS:	4.0% @ N70	4.0% @ N70	4.0% @ N70	4.0% @ N50
MIXTURE COMPOSITION: (MIXTURE GRADATION)	IL 9.5	IL 19.0	IL 9.5 FG	IL 9.5
FRICTION AGGREGATE:	MIXTURE D			MIXTURE C
MIXTURE WEIGHT:	112.0 LB/SY/IN	112.0 LB/SY/IN	112.0 LB/SY/IN	112.0 LB/SY/IN
QUALITY MANAGEMENT PROGRAM:	QCP	QCP	QCP	QCQA
SUBLOT SIZE:	1000 TONS	1000 TONS	1000 TONS	NA
DENSITY TEST METHOD:	CORES	CORES	CORES	SATISFACTION OF ENGINEER
MATERIAL TRANSFER DEVICE (REQUIRED)	YES	YES	YES	NO

STATE OF ILLINOIS
DEPARTMENT OF TRANSPORTATION
DISTRICT THREE
AS BUILT INFORMATION

SUPERVISING CONSTRUCTION FIELD ENGINEER

RESIDENT ENGINEER / TECHNICIAN

START & END DATES
OF CONSTRUCTION: _____

INSPECTORS: _____

MODEL: Default
FILE NAME: c:\p\work\pww\ch\pl\p\sch\rd\0941461\66M57-shi\Cover.dgn

* FAP 557 (IL 72), FAP 324 (IL 23)

USER NAME = timothy.platsch	DESIGNED -	REVISED -	STATE OF ILLINOIS DEPARTMENT OF TRANSPORTATION	GENERAL NOTES			F.A.P. RTE.	SECTION	COUNTY	TOTAL SHEETS	SHEET NO.
	DRAWN -	REVISED -					(128)RS-5 & (25)RS-5	DEKALB	30	2	
	CHECKED -	REVISED -		CONTRACT NO. 66M57							
PLOT DATE = 12/13/2024	DATE -	REVISED -		SCALE:	SHEET	OF	SHEETS	STA.	TO	STA.	ILLINOIS

CODE NO.	ITEM	UNIT	TOTAL QUANTITY	CONSTRUCTION CODE	
				80% FED 20% STATE FAP 557 (IL 72)	80% FED 20% STATE FAP 324 (IL 23)
				ROADWAY	ROADWAY
				0005 RURAL	0005 RURAL
20101400	NITROGEN FERTILIZER NUTRIENT	POUND	33	33	
20101500	PHOSPHORUS FERTILIZER NUTRIENT	POUND	33	33	
20101600	POTASSIUM FERTILIZER NUTRIENT	POUND	33	33	
20200100	EARTH EXCAVATION	CU YD	300	300	
20800150	TRENCH BACKFILL	CU YD	18	18	
21400100	GRADING AND SHAPING DITCHES	FOOT	2630	2630	
25000210	SEEDING, CLASS 2A	ACRE	0.4	0.4	
25100630	EROSION CONTROL BLANKET	SQ YD	1753	1753	
28100707	STONE DUMPED RIPRAP, CLASS A4	SQ YD	6	6	
28200200	FILTER FABRIC	SQ YD	6	6	
31100100	SUBBASE GRANULAR MATERIAL, TYPE A	TON	9	9	
40200800	AGGREGATE SURFACE COURSE, TYPE B	TON	148	54	94
40600290	BITUMINOUS MATERIALS (TACK COAT)	POUND	86504	37355	49149
40600370	LONGITUDINAL JOINT SEALANT	FOOT	37709	16297	21412

MODEL: Default
FILE NAME: c:\p\work\pwwork\pl\p\sch\rd\0941461166M57-sh1.SOO.dgn

USER NAME = Anthony.Grunstad	DESIGNED -	REVISED -
	DRAWN -	REVISED -
	CHECKED -	REVISED -
PLOT DATE = 12/13/2024	DATE -	REVISED -

**STATE OF ILLINOIS
DEPARTMENT OF TRANSPORTATION**

SUMMARY OF QUANTITIES

SCALE: SHEET OF SHEETS STA. TO STA.

* FAP 557 (IL 72), FAP 324 (IL 23)

F.A.P. RTE.	SECTION	COUNTY	TOTAL SHEETS	SHEET NO.
	(12)RS-5 & (25)RS-5	DEKALB	30	3
CONTRACT NO. 66M57				
		ILLINOIS	FED. AID PROJECT	

CODE NO.	ITEM	UNIT	TOTAL QUANTITY	CONSTRUCTION CODE	
				80% FED 20% STATE FAP 557 (IL 72)	80% FED 20% STATE FAP 324 (IL 23)
				ROADWAY	ROADWAY
				0005 RURAL	0005 RURAL
40600400	MIXTURE FOR CRACKS, JOINTS, AND FLANGEWAYS	TON	37	16	21
40600405	MATERIAL TRANSFER DEVICE	TON	21368	11408	9960
40600990	TEMPORARY RAMP	SQ YD	988	462	526
40603085	HOT-MIX ASPHALT BINDER COURSE, IL-19.0, N70	TON	6845	6845	
40603200	POLYMERIZED HOT-MIX ASPHALT BINDER COURSE, IL-4.75, N50	TON	3965		3965
40604062	HOT-MIX ASPHALT SURFACE COURSE, IL-9.5, MIX "D", N70	TON	10558	4563	5995
40800050	INCIDENTAL HOT-MIX ASPHALT SURFACING	TON	468	227	241
44000155	HOT-MIX ASPHALT SURFACE REMOVAL, 1 1/2"	SQ YD	308		308
44000159	HOT-MIX ASPHALT SURFACE REMOVAL, 2 1/2"	SQ YD	70534		70534
44000164	HOT-MIX ASPHALT SURFACE REMOVAL, 3 3/4"	SQ YD	54324	54324	
44201794	CLASS D PATCHES, TYPE III, 12 INCH	SQ YD	32	32	
48102100	AGGREGATE WEDGE SHOULDER, TYPE B	TON	2933	1272	1661
542A5473	PIPE CULVERTS, CLASS A, TYPE 1 EQUIVALENT ROUND-SIZE 18"	FOOT	72	72	
54214713	PRECAST REINFORCED CONCRETE FLARED END SECTIONS - ELLIPTICAL, EQUIVALENT ROUND-SIZE 18"	EACH	4	4	

MODEL: Default
 FILE NAME: c:\p\work\pwwd\illinois.gov_richard.yoo@d0941461686M57-shi_SQO.dgn

* FAP 557 (IL 72), FAP 324 (IL 23)

USER NAME = Richard.Yoo	DESIGNED -	REVISED -	STATE OF ILLINOIS DEPARTMENT OF TRANSPORTATION	SUMMARY OF QUANTITIES				F.A.P. RTE.	SECTION	COUNTY	TOTAL SHEETS	SHEET NO.
	DRAWN -	REVISED -						(128)RS-5 & (25)RS-5	DEKALB	30	4	
	CHECKED -	REVISED -		CONTRACT NO. 66M57				ILLINOIS FED. AID PROJECT				
PLOT DATE = 9/30/2024	DATE -	REVISED -		SCALE:	SHEET	OF	SHEETS	STA.	TO STA.			

CODE NO.	ITEM	UNIT	TOTAL QUANTITY	CONSTRUCTION CODE	
				80% FED 20% STATE FAP 557 (IL 72)	80% FED 20% STATE FAP 324 (IL 23)
				ROADWAY	ROADWAY
				0005 RURAL	0005 RURAL
59300100	CONTROLLED LOW-STRENGTH MATERIAL	CU YD	1.2	1.2	
60905305	BOX CULVERTS TO BE CLEANED	FOOT	156	156	
63500105	DELINEATORS	EACH	34	18	16
64200108	SHOULDER RUMBLE STRIPS, 8 INCH	FOOT	32594	32594	
* 66900200	NON-SPECIAL WASTE DISPOSAL	CU YD	126	126	
67000400	ENGINEER'S FIELD OFFICE, TYPE A	CAL MO	5	2.5	2.5
* 66901001	REGULATED SUBSTANCES PRE-CONSTRUCTION PLAN	L SUM	1	1	
67100100	MOBILIZATION	L SUM	1	0.5	0.5
* 66901006	REGULATED SUBSTANCES MONITORING	CA DAY	3	3	
70100450	TRAFFIC CONTROL AND PROTECTION, STANDARD 701201	L SUM	1	1	
* 66901003	REGULATED SUBSTANCES FINAL CONSTRUCTION REPORT	L SUM	1	1	
70100460	TRAFFIC CONTROL AND PROTECTION, STANDARD 701306	L SUM	1	0.5	0.5
70300100	SHORT TERM PAVEMENT MARKING	FOOT	11143	4926	6217
* 66900530	SOIL DISPOSAL ANALYSIS	EACH	3	3	
70300150	SHORT TERM PAVEMENT MARKING REMOVAL	SQ FT	1240	548	692
* 78004600	PREFORMED PLASTIC PAVEMENT MARKING, TYPE D - STANDARD - LETTERS AND SYMBOLS	SQ FT	122		122
* 78004640	PREFORMED PLASTIC PAVEMENT MARKING, TYPE D - STANDARD - LINE 8"	FOOT	194		194
* 78004720	PREFORMED PLASTIC PAVEMENT MARKING, TYPE D - STANDARD - LINE 24"	FOOT	146		146
* 78005150	EPOXY PAVEMENT MARKING - LINE 12"	FOOT	148		148

* SPECIALTY ITEM

MODEL: Default
FILE NAME: c:\p\work\paved\illinois.gov_richard.yoo@d094146168M57-shi_SQO.dgn

* FAP 557 (IL 72), FAP 324 (IL 23)

USER NAME = Richard.Yoo	DESIGNED -	REVISED -	STATE OF ILLINOIS DEPARTMENT OF TRANSPORTATION	SUMMARY OF QUANTITIES				F.A.P. RTE.	SECTION	COUNTY	TOTAL SHEETS	SHEET NO.
	DRAWN -	REVISED -						(128)RS-5 & (25)RS-6	DEKALB	30	5	
	CHECKED -	REVISED -		CONTRACT NO. 66M57				ILLINOIS FED. AID PROJECT				
PLOT DATE = 9/30/2024	DATE -	REVISED -		SCALE:	SHEET	OF	SHEETS	STA.	TO STA.			

CODE NO.	ITEM	UNIT	TOTAL QUANTITY	CONSTRUCTION CODE	
				80% FED 20% STATE FAP 557 (IL 72)	80% FED 20% STATE FAP 324 (IL 23)
				ROADWAY	ROADWAY
				0005 RURAL	0005 RURAL
* 78009004	MODIFIED URETHANE PAVEMENT MARKING - LINE 4"	FOOT	202473	101431	101042
* 78009006	MODIFIED URETHANE PAVEMENT MARKING - LINE 6"	FOOT	19186	8210	10976
* 78011000	GROOVING FOR RECESSED PAVEMENT MARKING, LETTERS AND SYMBOLS	SQ FT	122		122
* 78011040	GROOVING FOR RECESSED PAVEMENT MARKING 8"	FOOT	194		194
* 78011125	GROOVING FOR RECESSED PAVEMENT MARKING 25"	FOOT	146		146
* 78100100	RAISED REFLECTIVE PAVEMENT MARKER	EACH	470	205	265
78300200	RAISED REFLECTIVE PAVEMENT MARKER REMOVAL	EACH	470	205	265
X1200050	BOX CULVERT REMOVAL	FOOT	53	53	
X2040805	FURNISHED EXCAVATION (SPECIAL)	CU YD	5	2	3
X4401198	HOT-MIX ASPHALT SURFACE REMOVAL, VARIABLE DEPTH	SQ YD	4216	1526	2690
X6350204	LINEAR DELINEATOR PANELS, 4 INCH	EACH	29	19	10
X6350206	LINEAR DELINEATOR PANELS, 6 INCH	EACH	4	4	
X7200061	TEMPORARY INFORMATION SIGNING	SQ FT	84	42	42
Ø Z0076600	TRAINEES	hour	1,000	1,000	
Z0048665	RAILROAD PROTECTIVE LIABILITY INSURANCE	L SUM	1		1
Ø Z0076604	TRAINEES - TRAINING PROGRAM GRADUATE	hour	1,000	1,000	

* SPECIALTY ITEM Ø 0042

MODEL: Default
FILE NAME: c:\p\work\pwwork\illinois.gov_richard.yoo\d094146166M57-shi_SQO.dgn

USER NAME = Richard.Yoo	DESIGNED -	REVISED -	STATE OF ILLINOIS DEPARTMENT OF TRANSPORTATION	SUMMARY OF QUANTITIES				F.A.P. RTE.	SECTION	COUNTY	TOTAL SHEETS	SHEET NO.
	DRAWN -	REVISED -										
	CHECKED -	REVISED -										
PLOT DATE = 9/30/2024	DATE -	REVISED -		SCALE:	SHEET	OF	SHEETS	STA.	TO	STA.	ILLINOIS FED. AID PROJECT	

* FAP 557 (IL 72) FAP 324 (IL 23)

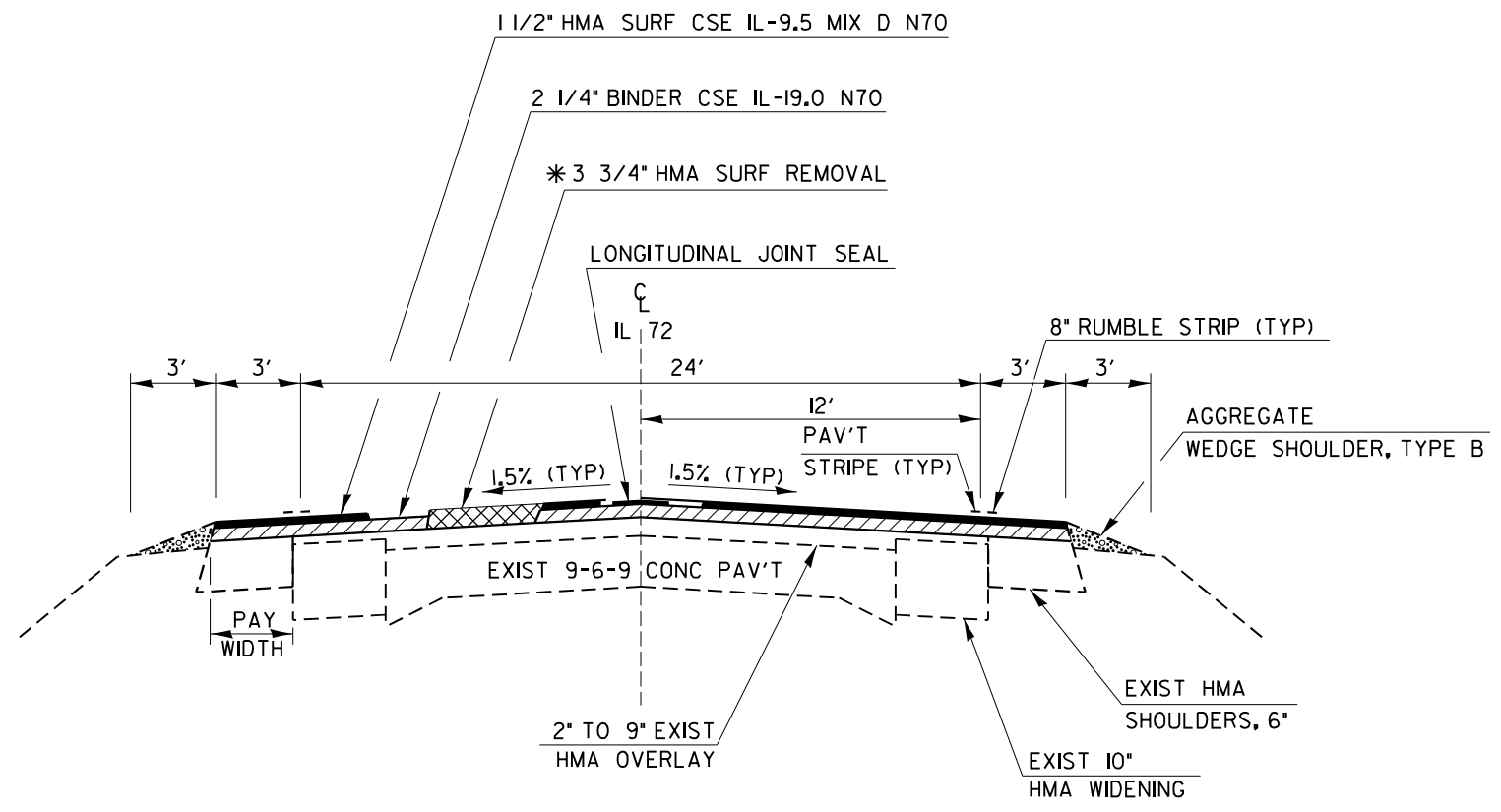

TYPICAL SECTION I

STA. 8+22.2 TO STA. 44+71.4
 STA. 44+71.4 BK = STA. 44+71.8 AH
 STA. 44+71.8 TO STA. 76+74.6
 STA. 98+64.6 TO STA. 129+14.8
 STA. 142+36.1 TO STA. 172+45

BRIDGE OMISSION

STA. 143+66.3 TO STA. 144+91.7

* REDUCE MILLING DEPTH IF NECESSARY TO PREVENT MILLING EXISTING CONCRETE PAVEMENT

MODEL: Default
 FILE NAME: c:\p\work\pav\typical\pavtypical.dgn

* FAP 557 (IL 72), FAP 524 (IL 23)

USER NAME = Anthony.Grunstad	DESIGNED -	REVISED -
	DRAWN -	REVISED -
	CHECKED -	REVISED -
PLOT DATE = 12/13/2024	DATE -	REVISED -

**STATE OF ILLINOIS
 DEPARTMENT OF TRANSPORTATION**

IL-72 TYPICAL SECTIONS			
SCALE:	SHEET	OF	SHEETS
	STA.	TO	STA.

F.A.P. RTE.	SECTION	COUNTY	TOTAL SHEETS	SHEET NO.
	(128)RS-5 & (25)RS-5	DEKALB	30	7
CONTRACT NO. 66M57			ILLINOIS FED. AID PROJECT	

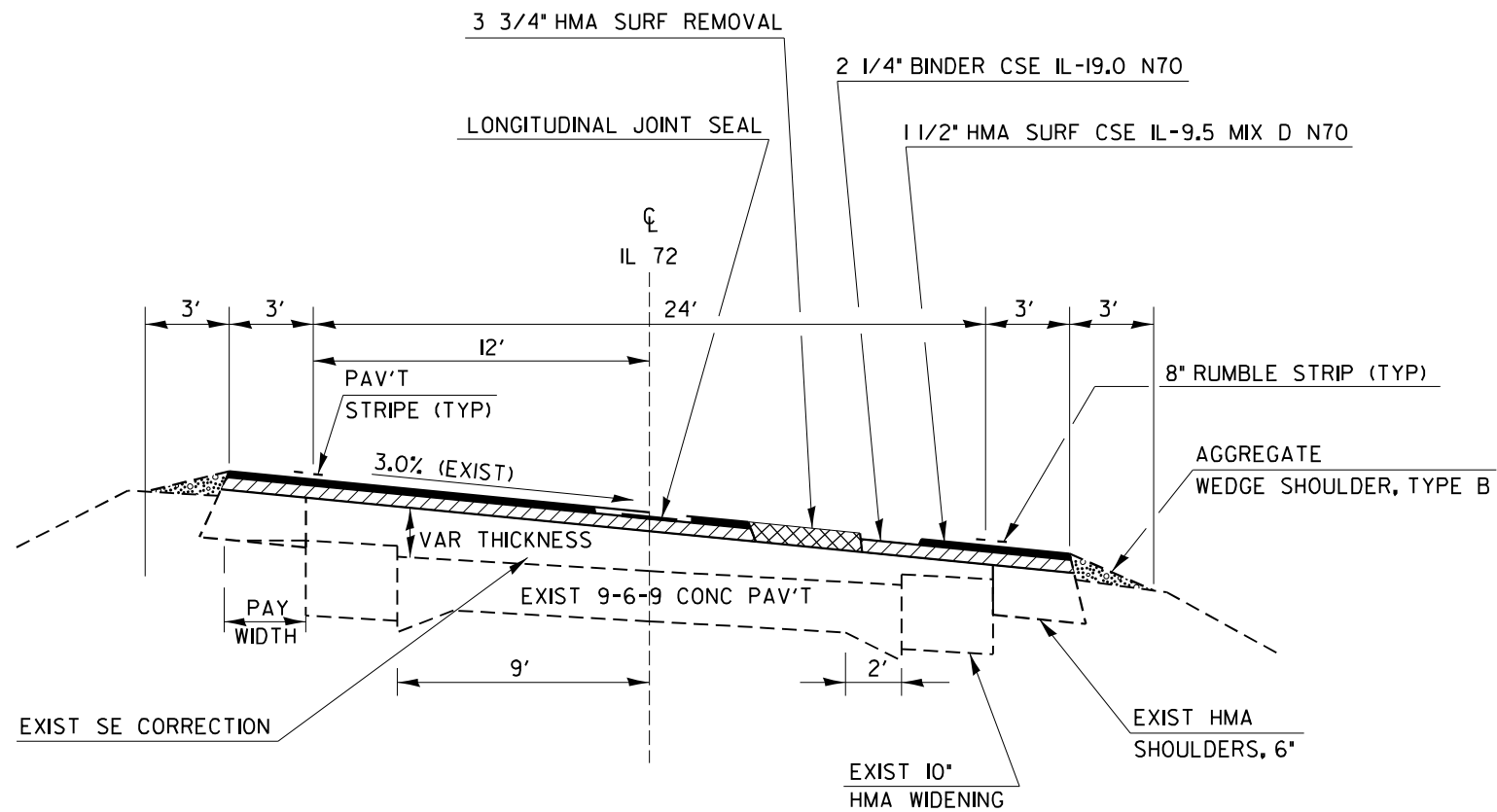

TYPICAL SECTION II

STA. 76+74.6 TO STA. 98+64.7
 STA. 98+64.7 BK = STA. 98+64.6 AH

MODEL: Default
 FILE NAME: c:\pwworkspace\plascshrd\094168166M57-sh1 Typical.dgn

* FAP 557 (IL 72), FAP 324 (IL 23)

USER NAME = Anthony.Grunstad	DESIGNED -	REVISED -
	DRAWN -	REVISED -
	CHECKED -	REVISED -
PLOT DATE = 12/13/2024	DATE -	REVISED -

**STATE OF ILLINOIS
 DEPARTMENT OF TRANSPORTATION**

IL-72 TYPICAL SECTIONS

SCALE: SHEET OF SHEETS STA. TO STA.

F.A.P. RTE.	SECTION	COUNTY	TOTAL SHEETS	SHEET NO.
(128)RS-5 & (25)RS-5		DEKALB	30	8
CONTRACT NO. 66M57				
		ILLINOIS	FED. AID PROJECT	

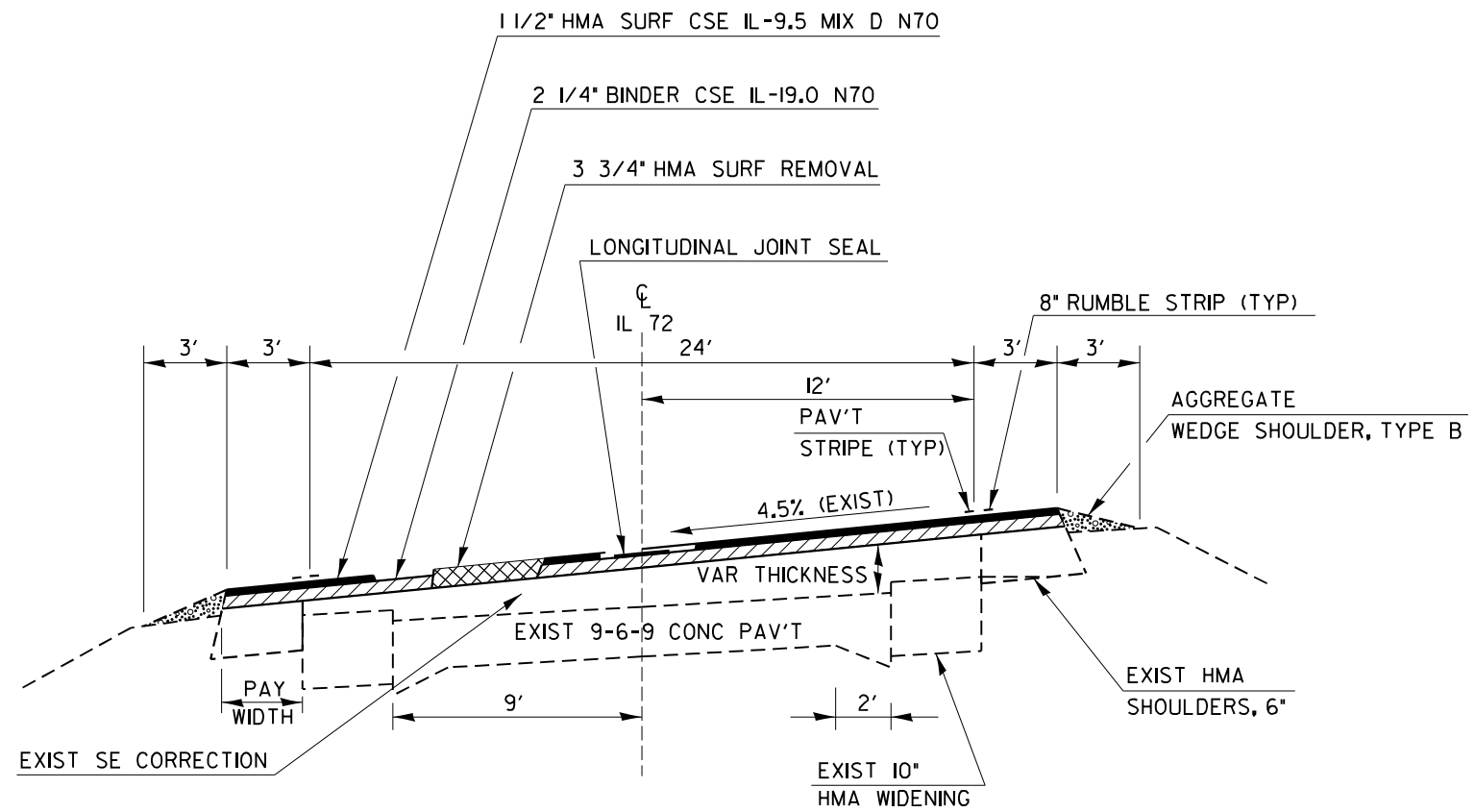

TYPICAL SECTION III

STA. 129+14.8 TO STA. 142+36.1

MODEL: Default
 FILE NAME: c:\p\work\pav\illinois.gov_rchard.yoo@illinois.gov\d094146168M57-sh1_Typical3.dgn

* FAP 557 (IL 72), FAP 324 (IL 23)

USER NAME = timothy.pletsch	DESIGNED -	REVISED -
	DRAWN -	REVISED -
	CHECKED -	REVISED -
PLOT DATE = 10/17/2024	DATE -	REVISED -

**STATE OF ILLINOIS
DEPARTMENT OF TRANSPORTATION**

IL-72 TYPICAL SECTIONS

SCALE: SHEET OF SHEETS STA. TO STA.

F.A.P. RTE.	SECTION	COUNTY	TOTAL SHEETS	SHEET NO.
-	(128)RS-5 & (25)RS-5	DEKALB	30	9
CONTRACT NO. 66M57				
ILLINOIS		FED. AID PROJECT		

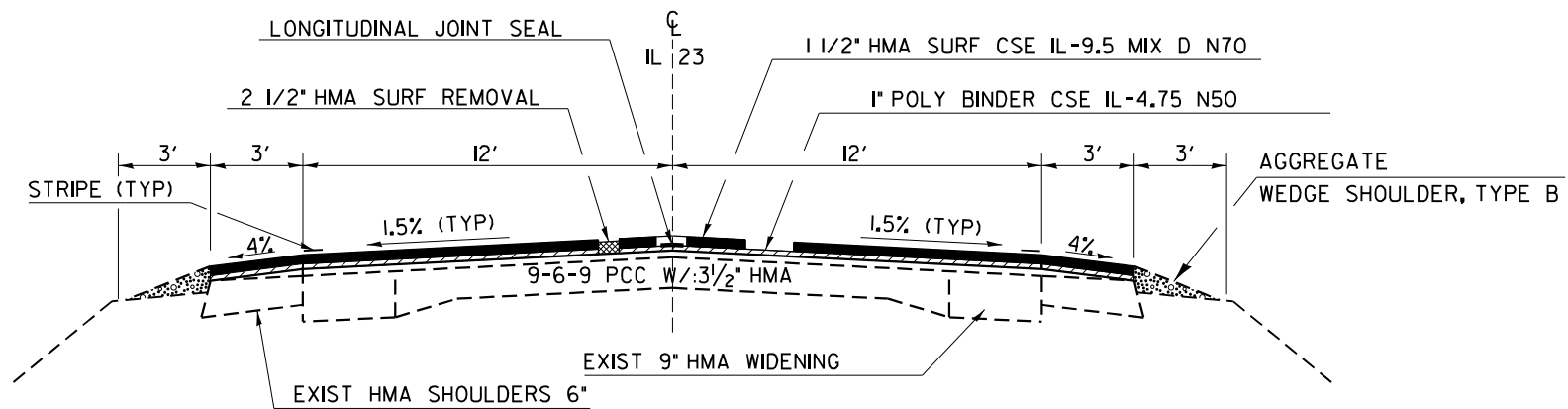

TYPICAL SECTION I

STA. 145+87 TO STA. 170+00.0
 STA. 170+00.0 BK = STA. 170+04.6 AH
 STA. 170+04.6 TO STA. 196+71.9
 STA. 197+55.8 TO STA. 235+00.0
 STA. 235+00.0 BK = STA. 234+99.4 AH
 STA. 234+99.4 TO STA. 268+00.0
 STA. 268+00.0 BK = STA. 268+05.7 AH
 STA. 268+05.7 TO STA. 298+00.0
 STA. 298+00.0 BK = STA. 298+02.2 AH
 STA. 298+02.2 TO STA. 317+00.0
 STA. 317+00.0 BK = STA. 316+95.5 AH
 STA. 316+95.5 TO STA. 349+73.6

BRIDGE OMISSION

STA. 196+71.9 TO STA. 197+55.79

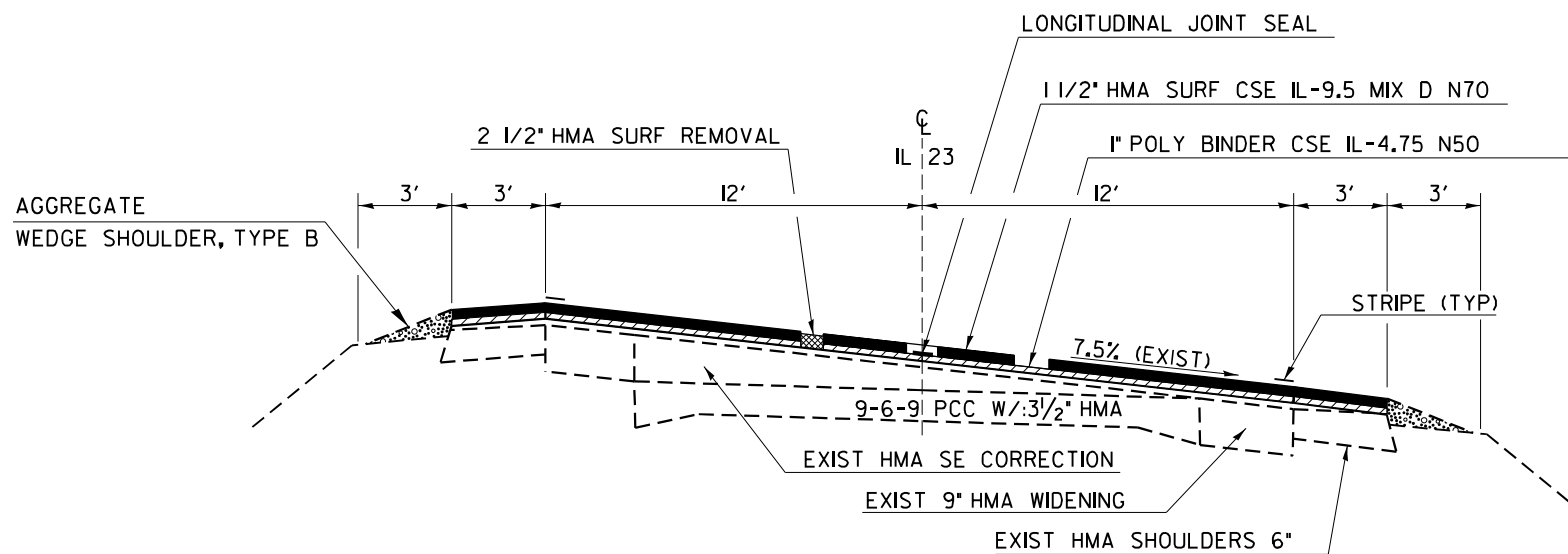

TYPICAL SECTION II

STA. 349+73.6 TO STA. 361+00.0

MODEL: Default
 FILE NAME: c:\p\work\pav\illinois.gov_rchard.yoo@illinois.gov\d094146168M57-sh1_Typical.dgn

USER NAME = timothy.platsch	DESIGNED -	REVISED -
	DRAWN -	REVISED -
	CHECKED -	REVISED -
PLOT DATE = 10/17/2024	DATE -	REVISED -

STATE OF ILLINOIS
 DEPARTMENT OF TRANSPORTATION

IL-23 TYPICAL SECTIONS

SCALE: SHEET OF SHEETS STA. TO STA.

* FAP 557 (IL 72), FAP 324 (IL 23)

F.A.P. RTE.	SECTION	COUNTY	TOTAL SHEETS	SHEET NO.
(128)RS-5 & (25)RS-5		DEKALB	30	10
CONTRACT NO. 66M57				
ILLINOIS		FED. AID PROJECT		



#996
CONCRETE BOX 2'x1.5'
STA. 7+03

SN 019-2503
STA. 19+74

#761
CONCRETE BOX 2'x2'
STA. 52+69

SN 019-2501
STA. 61+37

IL RTE. 23 &
IL RTE. 72
STA. 6+72.2

BEGIN
IMPROVEMENT
STA. 8+22.2

STA. 6+72.2 HAYES RD

10+57 F.E.

25+77 F.E.

35+10 F.E.

40+80 MB

42+98 P.E.
43+55 M.B.

EON: STA. 44+71.4 BK =
STA. 44+71.81 AH

55+45 F.E.

56+76 F.E.

ROOSEVELT RD.
60+00

MATCH LINE STA. 62+00

NOT TO SCALE

MATCH LINE STA. 62+00

65+88 F.E.

71+39 P.E.

76+42 C.E.
PC Sta 76+74.59

81+52 F.E.

#755
CONCRETE BOX 3'x2'
STA. 87+35

EXIST. CURVE EXIST-1
PISTA. = 88+00.00
I = 32° 50' 00" (RT)
D = 1° 30' 00"
R = 3,819.70'
T = 1,125.41'
L = 2,188.88'
E = 162.34'
e = -----
T.R. = -----
S.E. RUN = -----
P.C. STA. = 76+74.59
P.T. STA. = 98+63.47

EDW: STA. 98+64.67 BK =
STA. 98+64.56 AH

#995
CONCRETE BOX 2'x2'
STA. 103+33

#754
CONCRETE BOX 3'x1.5'
STA. 106+45

111+23 P.E.

111+23 P.E.

112+09 NEW LEBANON SPUR

#753
CONCRETE BOX 3.5'x1.5'
STA. 119+40

MATCH LINE STA. 124+00

NOT TO SCALE



MODEL: Default
FILE NAME: c:\pwworkspace\plascshrd\09414611666M57-shil Line Diagram.dgn

USER NAME = Anthony.Grunstad	DESIGNED -	REVISED -
	DRAWN -	REVISED -
	CHECKED -	REVISED -
PLOT DATE = 12/13/2024	DATE -	REVISED -

STATE OF ILLINOIS
DEPARTMENT OF TRANSPORTATION

IL-72 LINE DIAGRAM

SCALE: SHEET OF SHEETS STA. TO STA.

* FAP 557 (IL 72), FAP 324 (IL 23)

F.A.P. RTE.	SECTION	COUNTY	TOTAL SHEETS	SHEET NO.
(128)RS-5 & (25)RS-5		DEKALB	30	11
CONTRACT NO. 66M57				
		ILLINOIS	FED. AID PROJECT	

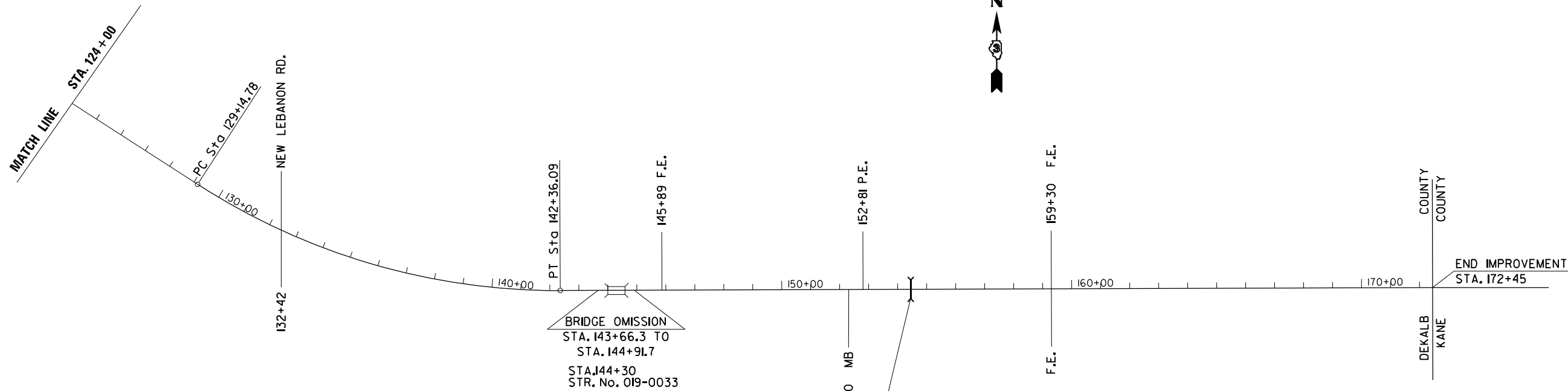

EXIST. CURVE EXIST-2
 P.I.S.T.A. = 135+94.37
 I = 33° 02' 00" (LT)
 D = 2° 30' 00"
 R = 2,291.80'
 T = 679.59'
 L = 1,321.32'
 E = 98.64'
 e = -----
 T.R. = -----
 S.E. RUN = -----
 P.C. STA. = 129+14.78
 P.T. STA. = 142+36.09

#752
 CONCRETE BOX 3'x1.5'
 STA. 154+46

NOT TO SCALE

MODEL: Default
 FILE NAME: c:\p\work\p\w\sch\p\sch\rd\0941461166M57-shil_Line_Diagram.dgn

* FAP 557 (IL 72), FAP 324 (IL 23)

USER NAME = Anthony.Grunstad	DESIGNED -	REVISED -
	DRAWN -	REVISED -
	CHECKED -	REVISED -
PLOT DATE = 12/13/2024	DATE -	REVISED -

**STATE OF ILLINOIS
 DEPARTMENT OF TRANSPORTATION**

IL-72 LINE DIAGRAM

SCALE: SHEET OF SHEETS STA. TO STA.

F.A.P. RTE.	SECTION	COUNTY	TOTAL SHEETS	SHEET NO.
-	(128)RS-5 & (25)RS-5	DEKALB	30	12
CONTRACT NO. 66M57				
		ILLINOIS	FED. AID PROJECT	

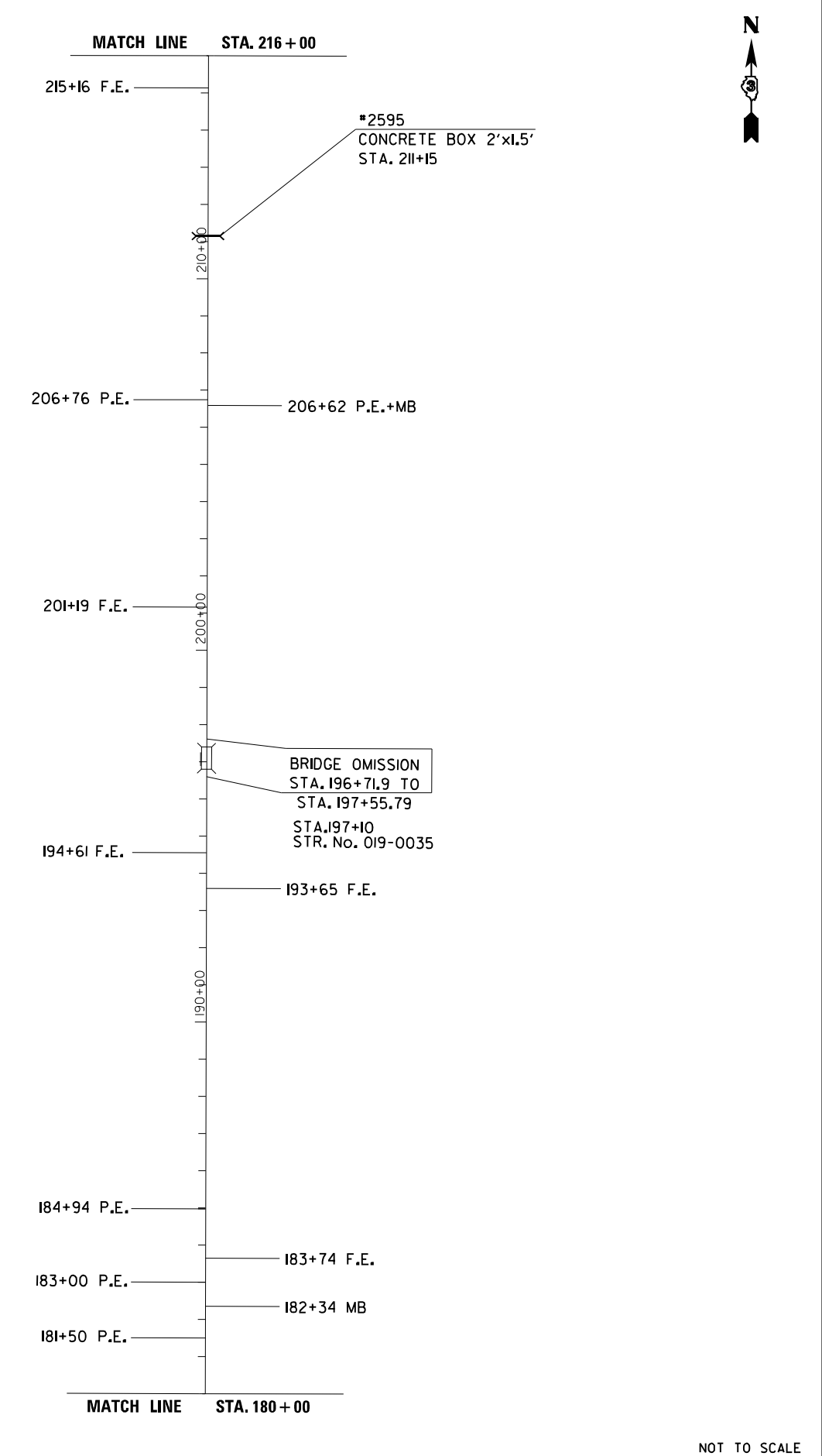
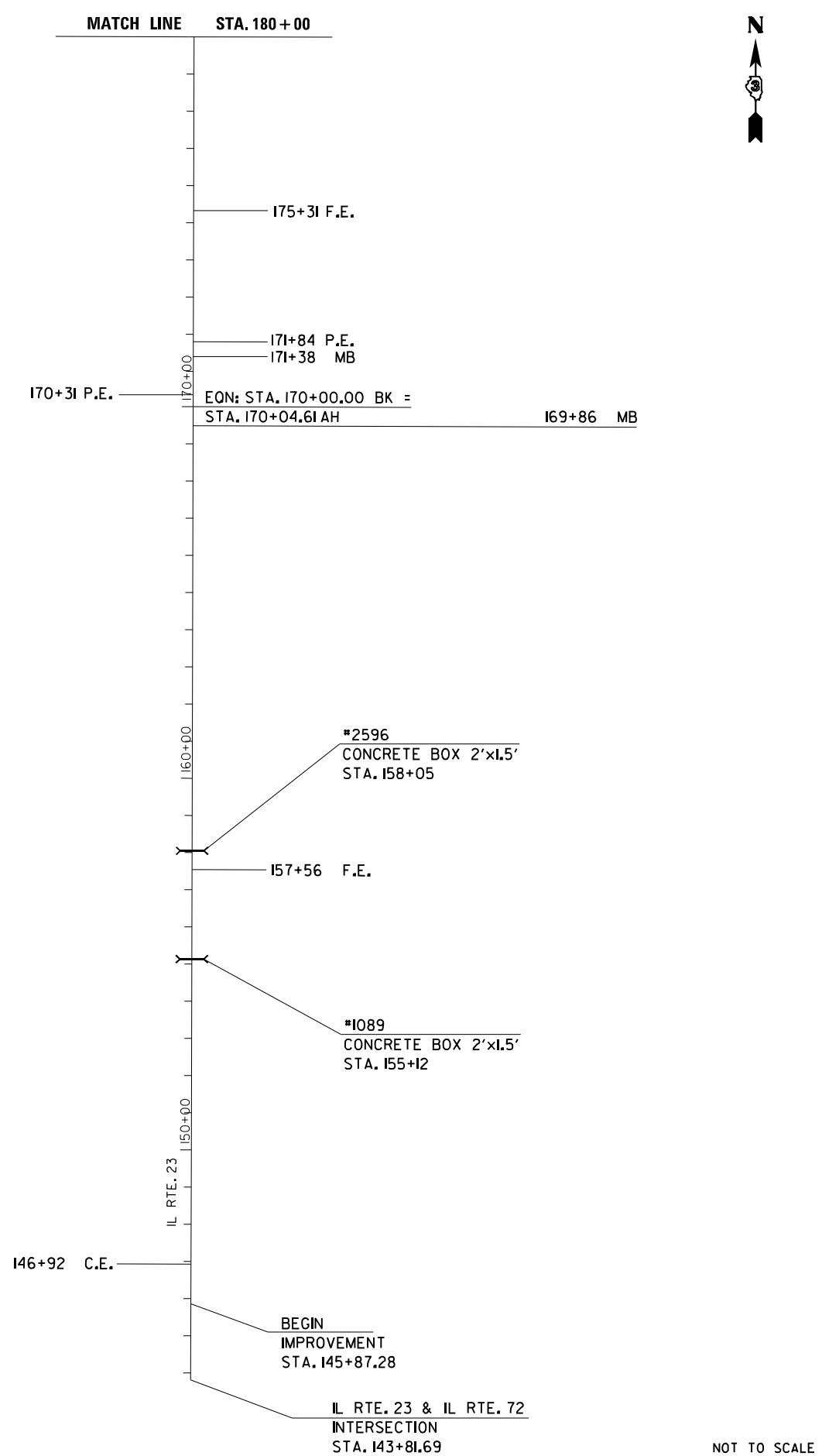

MODEL: Default
FILE NAME: c:\pwworking\plascsh\rd0941461166M57-shil Line Diagram.dgn

USER NAME = Anthony.Grunstad	DESIGNED -	REVISED -
	DRAWN -	REVISED -
	CHECKED -	REVISED -
PLOT DATE = 12/13/2024	DATE -	REVISED -

STATE OF ILLINOIS
DEPARTMENT OF TRANSPORTATION

IL-23 LINE DIAGRAM

SCALE:	SHEET	OF	SHEETS	STA.	TO STA.
--------	-------	----	--------	------	---------

* FAP 557 (IL 72), FAP 324 (IL 23)

F.A.P. RTE.	SECTION	COUNTY	TOTAL SHEETS	SHEET NO.
-	(128)RS-5 & (25)RS-5	DEKALB	30	13
CONTRACT NO. 66M57				
ILLINOIS		FED. AID PROJECT		

MODEL: Default
 FILE NAME: c:\pwworking\illinois.gov_richard.yoo@d0941461686\57-sht Line Diagram.dgn

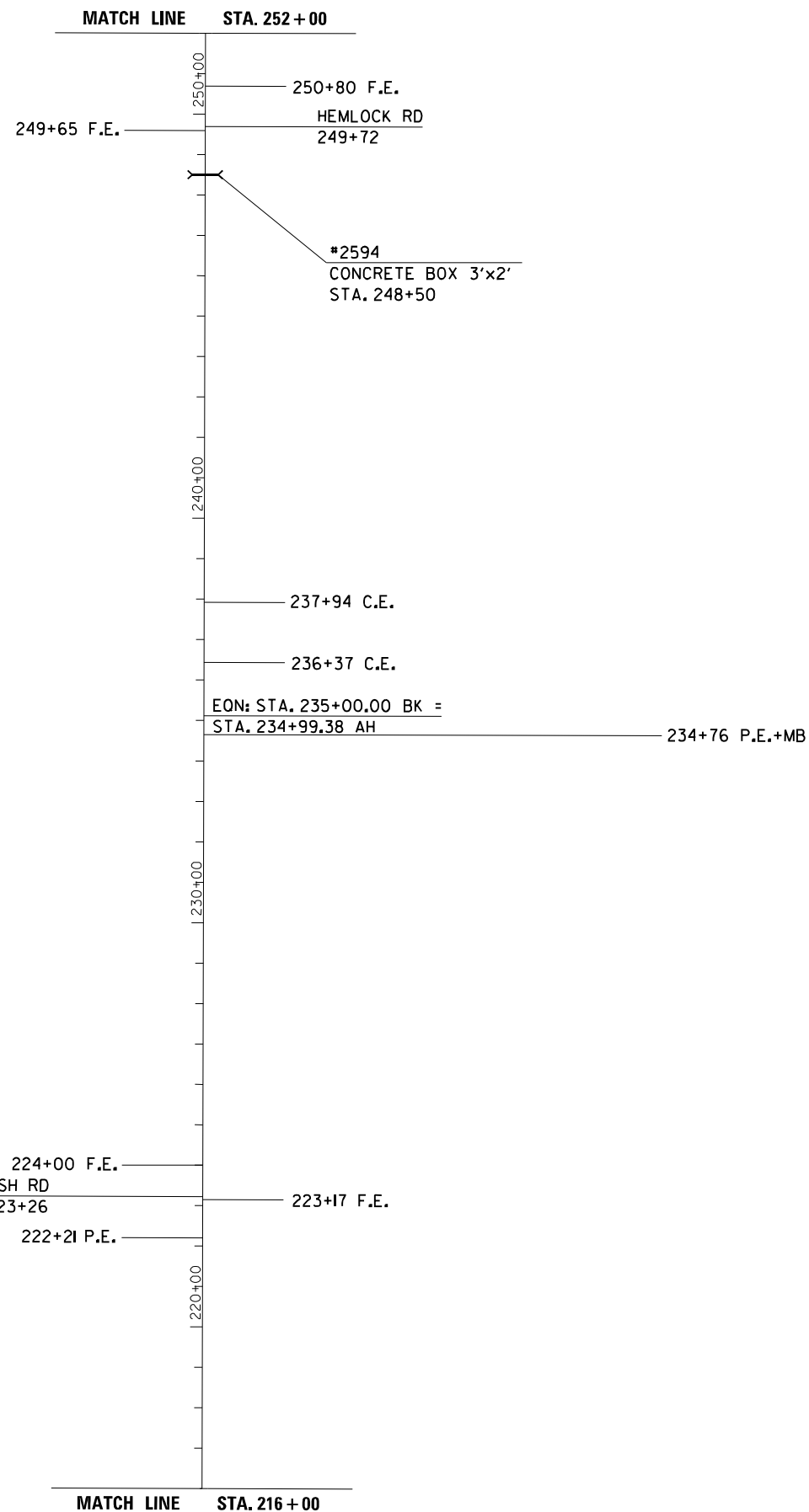

NOT TO SCALE

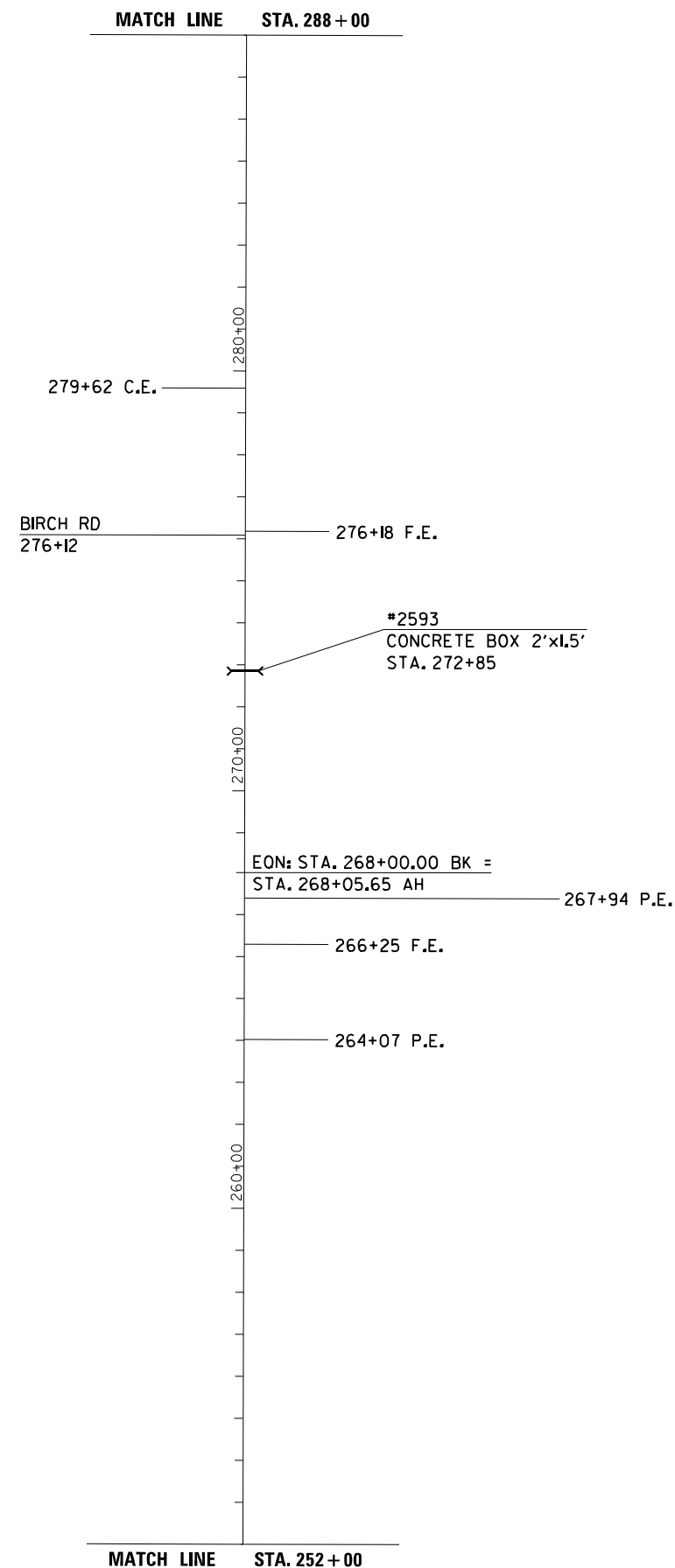

NOT TO SCALE

* FAP 557 (IL 72), FAP 324 (IL 23)

USER NAME = Richard.Yoo	DESIGNED -	REVISED -
	DRAWN -	REVISED -
	CHECKED -	REVISED -
PLOT DATE = 10/15/2024	DATE -	REVISED -

**STATE OF ILLINOIS
 DEPARTMENT OF TRANSPORTATION**

IL-23 LINE DIAGRAM

SCALE: SHEET OF SHEETS STA. TO STA.

F.A.P. RTE.	SECTION	COUNTY	TOTAL SHEETS	SHEET NO.
-	(12)RS-5 & (25)RS-5	DEKALB	30	14
CONTRACT NO. 66M57				
		ILLINOIS	FED. AID PROJECT	

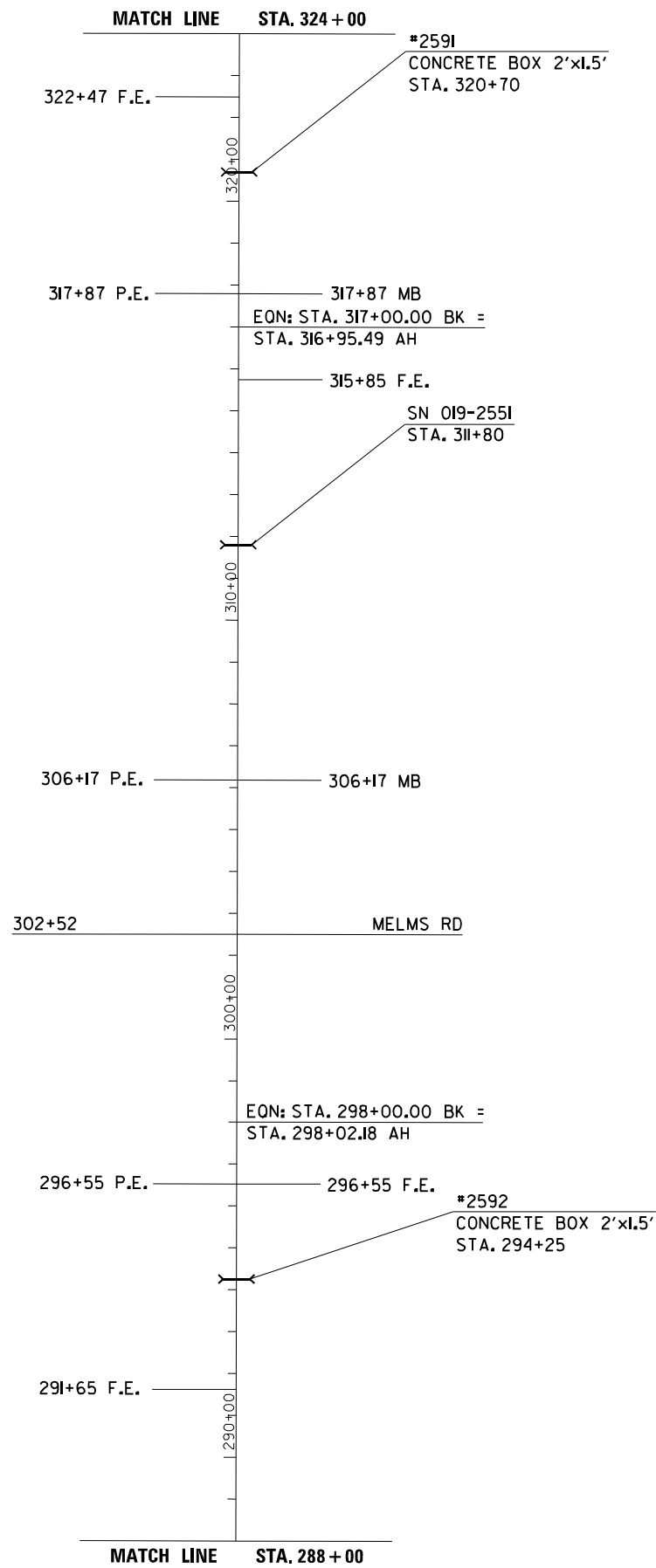

NOT TO SCALE

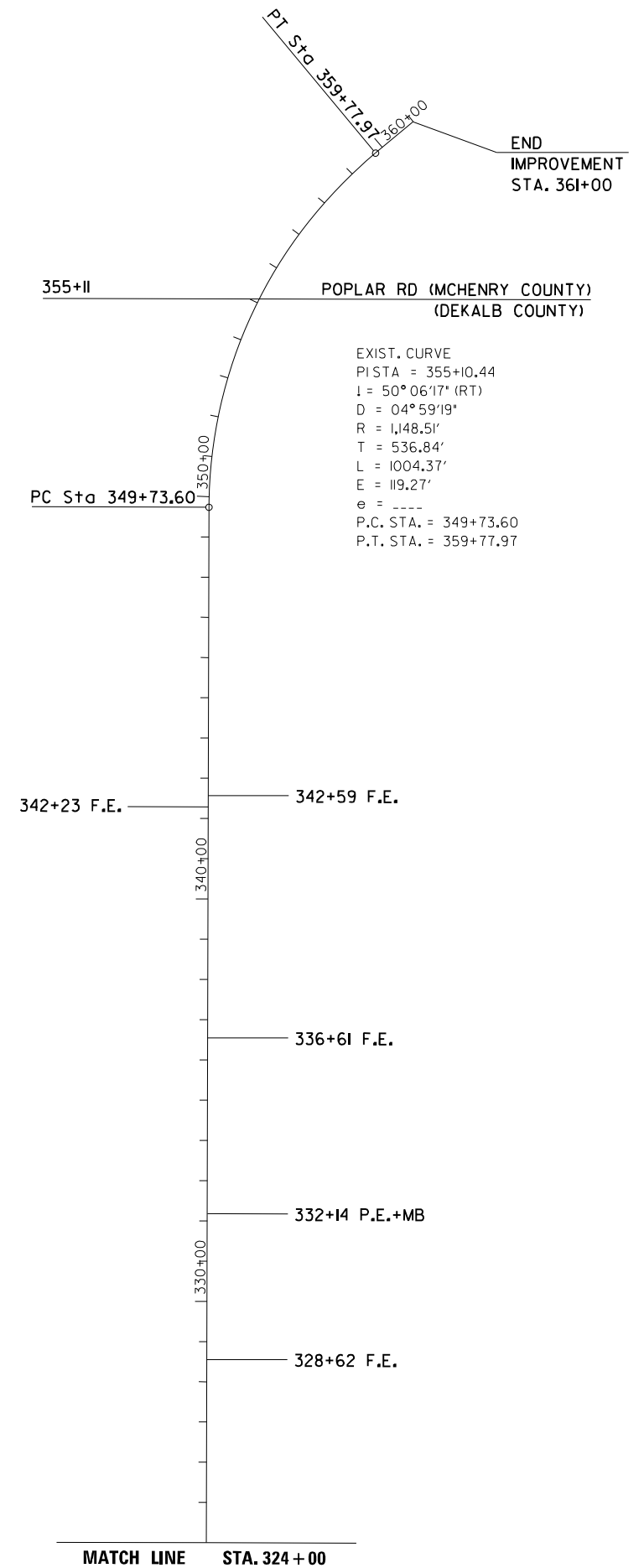

NOT TO SCALE

MODEL: Default
 FILE NAME: c:\pwworking\illinois.gov_richard.yoo\illinois.gov_richard.yoo\d094146166M57-sht Line Diagram.dgn

USER NAME = Richard.Yoo	DESIGNED -	REVISED -
	DRAWN -	REVISED -
	CHECKED -	REVISED -
PLOT DATE = 10/15/2024	DATE -	REVISED -

**STATE OF ILLINOIS
DEPARTMENT OF TRANSPORTATION**

IL-23 LINE DIAGRAM

SCALE: SHEET OF SHEETS STA. TO STA.

* FAP 557 (IL 72), FAP 324 (IL 23)

F.A.P. RTE.	SECTION	COUNTY	TOTAL SHEETS	SHEET NO.
(12)RS-5 & (25)RS-5		DEKALB	30	15
CONTRACT NO. 66M57				
		ILLINOIS	FED. AID PROJECT	

IL-72 MAINLINE SCHEDULE												
STA. TO STA.	LENGTH	HMA SURFACE REMOVAL	HMA SURF.CSE MIX.D	BINDER COURSE	MATERIAL TRANSFER DEVICE	MIX FOR JTS, CRACKS & FLGWYS	RUMBLE STRIP 8"	BIT. MAT'L (TACK COAT)	LONG JOINT SEAL	AGG WEDGE TY B	TEMP RAMP	
		3 3/4"	IL-9.5,N70 1 1/2"	IL-19.0 N70 2 1/4"								
		FT	SQ YD	TONS	TONS	TON	TONS	FT	POUND	FOOT	TONS	SQ YD
8+22.2	44+71.4	3649	12164	1021.8	1533	2554.4	3.6	7298	8211	3649	277.1	41.7
STA EQ 44+71.4BK=44+71.81AH		STATION EQUATION										
44+71.81	98+64.67	5393	17976	1510.0	2265	3775.0	5.4	10786	12134	5393	409.5	
STA EQ 98+64.67BK=98+64.56AH		STATION EQUATION										
98+64.56	143+66.3	4502	15006	1260.5	1891	3151.2	4.5	9003	10129	4502	341.8	41.7
143+66.3	144+91.7	BRIDGE OMISSION (SN 019-0033)										
144+91.7	172+45.	2753	9177.7	770.9	1156	1927.3	2.8	5507	6195	2753	209.0	83.3
TOTALS			54324	4563	6845	11408	16	32594	36668	16297	1237	167

IL-72 ENTRANCE SCHEDULE							
STATION	TYPE	SIDE	MATERIAL	VARIABLE DEPTH SURF REM	INCIDENTAL HMA SURF	BIT MATL (TACK COAT)	AGG SURF CSE TY B
				SQ YD	TON	POUND	TON
10+57	FE	RT	AGG				3.2
10+57	FE	LT	AGG				3.2
25+77	FE	LT	AGG				3.2
35+10	FE	LT	AGG				3.2
40+80	PE	RT	HMA/AGG	38.9	5.8	17.5	
40+80	MBTO	LT	HMA	53.9	8.0	24.3	
42+98	PE	LT	HMA	25.6	3.8	11.5	
43+55	MBTO	LT	HMA	37.8	5.6	17.0	
54+48	PE	RT	AGG				4.6
55+45	FE	LT	AGG				2.6
56+76	FE	LT	AGG				2.2
56+92	PE	RT	AGG				3.5
65+88	FE	LT	AGG				2.2
71+39	PE	LT	HMA	38.3	5.7	17.3	
76+42	FE	RT	AGG				6.0
76+42	CE	LT	AGG				4.9
81+52	FE	LT	AGG				3.2
101+05	PE/MBTO	LT	HMA	33.9	5.0	15.3	
101+05	FE	RT	AGG				2.2
111+23	PE	RT	HMA	107.8	16.0	48.5	
145+89	FE	LT	AGG				3.2
152+30	MBTO	RT	HMA	33.3	4.9	15.0	
152+81	PE	RT	HMA	38.3	5.7	17.3	
159+30	FE	LT	AGG				3.2
159+30	FE	RT	AGG				3.2
RURAL SUBTOTALS				408	61	184	54
TOTALS				408	61	184	54

MODEL: Default
 FILE NAME: c:\p\work\p\w\sch\p\sch\sch\0941461166M57-sht\Schedule.dgn

* FAP 557 (IL 72), FAP 324 (IL 23)

USER NAME = Anthony.Grunstad	DESIGNED -	REVISED -	STATE OF ILLINOIS DEPARTMENT OF TRANSPORTATION	IL-72 SCHEDULES		F.A. RTE.	SECTION	COUNTY	TOTAL SHEETS	SHEET NO.
	DRAWN -	REVISED -				(128)RS-5 & (25)RS-5	DEKALB	30	16	
	CHECKED -	REVISED -				CONTRACT NO. 66M57				
PLOT DATE = 12/13/2024	DATE -	REVISED -				SCALE:	SHEET	OF	SHEETS	STA.

IL-72 SIDEROAD SCHEDULE													
STATION	NAME	SIDE	MATERIAL	VARIABLE DEPTH SURF REM	INCIDENTAL HMA SURF	BIT MATL (TACK COAT)	TEMP RAMP	FURNISH EX (SPECIAL)	SEEDING, CL 2A *	NITROGEN FERTILIZER NUTRIENT *	PHOSPHORUS FERTILIZER NUTRIENT *	POTASSIUM FERTILIZER NUTRIENT *	EROSION CONTROL BLANKET *
				SQ YD	TON	POUND	SQ YD	CU YD	ACRE	POUND	POUND	POUND	SQ YD
59+91	ROOSEVELT ROAD	LT	HMA	220.0	32.6	99.0	61.1	0.4	0.002	0.2	0.2	0.2	20.0
59+91	ROOSEVELT ROAD	RT	HMA	230.0	34.1	103.5	65.6	0.4	0.002	0.2	0.2	0.2	20.0
112+09	NEW LEBANON SPUR	LT	HMA	255.0	37.8	114.8	62.2	0.4	0.002	0.2	0.2	0.2	20.0
132+30	NEW LEBANON ROAD	LT	HMA	180.0	26.7	81.0	45.0	0.4	0.002	0.2	0.2	0.2	20.0
132+61	NEW LEBANON ROAD	RT	HMA	233.3	34.6	105.0	61.1	0.4	0.002	0.2	0.2	0.2	20.0
TOTALS				1118	166	503	295	2	0.01	1	1	1	100

* SEEDING PAY ITEMS WILL NOT BE PAID FOR SEPARATELY, BUT WILL BE INCLUDED IN THE COST OF FURNISHED EXCAVATION.

IL-72 PAVEMENT MARKING SCHEDULE						
LOCATION	LENGTH	MODIFIED URETHANE (2 APPLICATIONS)		RAISED REFLECT PVMT MARK	RAISED REFLECT PVMT MARK REMOVAL	
		LINE 4"	LINE 6"			
		WHITE	YELLOW			
STATION	FOOT	FOOT	FOOT	EACH	EACH	
08+22 TO 44+71.40	3649.2	14596.8	1824.6	46	46	
STA EQ 44+71.4BK = 44+71.81AH		STATION EQUATION				
44+71.81 TO 98+64.67	5392.86	21571.44	2696.43	67	67	
STA EQ 98+64.67BK = 98+64.56AH		STATION EQUATION				
98+64.56 TO 172+43.00	7378.44	29513.76	3689.22	92	92	
TOTAL		65682	8210	205	205	

PAVEMENT MARKING INCLUDES BRIDGE OMISSION

IL-72 SHORT TERM PAVEMENT MARKINGS				
LOCATION	LENGTH	SHORT TERM PVMT	SHORT TERM PVMT REM	
STATION	FOOT	FOOT	SQ FT	
08+22 TO 44+71.40	3649	1095	122	
STA EQ 47+71.4BK = 44+71.81AH		STATION EQUATION		
44+71.81 TO 98+64.67	5393	1618	180	
STA EQ 98+64.67BK = 98+64.56AH		STATION EQUATION		
98+64.56 TO 172+43.00	7378	2214	246	
TOTAL		16421	4926	548

*THIS QUANTITY IS FOR 3 APPLICATIONS IF NEEDED.

MODEL: Default
FILE NAME: c:\pwworkspace\illinois.gov_richard.yoo\091416166M57-sht Schedules.dgn

USER NAME = Richard.Yoo	DESIGNED -	REVISED -	STATE OF ILLINOIS DEPARTMENT OF TRANSPORTATION	IL-72 SCHEDULES				F.A. RTE.	SECTION	COUNTY	TOTAL SHEETS	SHEET NO.
PLOT DATE = 10/17/2024	DRAWN -	REVISED -						(128)RS-5 & (25)RS-5	DEKALB	30	17	
	CHECKED -	REVISED -		SCALE: SHEET OF SHEETS STA. TO STA.				CONTRACT NO. 66M57				
	DATE -	REVISED -		ILLINOIS FED. AID PROJECT								

IL-72 PAVEMENT MARKING SCHEDULE (NO PASSING ZONES)				
LOCATION			LOCATION	MODIFIED URETHANE (2 APPLICATIONS)
				LINE 4"
				YELLOW
STATION			EB / WB	FOOT
08+22	TO	13+28.44	WB	1012.5
08+22	TO	13+28.44	EB	1012.5
13+28	TO	20+04.50	WB	1352.1
34+32	TO	43+85.50	EB	1907.2
43+85.50	TO	60+65.46	WB	3359.9
65+67.01	TO	77+34.93	EB	2335.8
77+34.93	TO	87+58.84	WB	2047.8
87+58.84	TO	98+42.84	EB	2168.0
98+42.84	TO	112+30.84	WB	2776.0
98+42.84	TO	112+30.84	EB	2776.0
112+30.84	TO	121+43.84	WB	1826.0
124+89.84	TO	130+14.84	EB	1050.0
130+14.84	TO	148+49.13	EB	3668.6
130+14.84	TO	148+49.13	WB	3668.6
148+49.13	TO	172+43.00	EB	4787.7
RURAL SUBTOTALS				35749
TOTAL				35749

THE RESIDENT ENGINEER SHALL VERIFY THE LOCATIONS OF THE NO PASSING ZONES.

PAVEMENT MARKING INCLUDES BRIDGE OMISSION

IL-72 LINEAR DELINEATOR PANEL SCHEDULE						
STRUCTURE NUMBER	SIDE	STRUCTURE CENTERLINE	GUARDRAIL LENGTH	PARAPET LENGTH	LINEAR DELINEATOR PANELS, 4"	LINEAR DELINEATOR PANELS, 6"
		STATION	FT	FT	EACH	EACH
019-2503	LEFT	19+74.00	275.0		5	
019-2503	RIGHT	19+74.00	275.0		5	
019-0033	RIGHT	144+29.00	375.0	82.38	5	2
019-0033	LEFT	144+29.00	350.0	82.38	4	2
TOTAL			1275	165	19	4

MODEL: Default
FILE NAME: c:\pwworkspace\illinois.gov_richard.yoo\091416166M57-sht Schedules.dgn

USER NAME = Richard.Yoo	DESIGNED -	REVISED -
	DRAWN -	REVISED -
	CHECKED -	REVISED -
PLOT DATE = 10/17/2024	DATE -	REVISED -

STATE OF ILLINOIS
DEPARTMENT OF TRANSPORTATION

IL-72 SCHEDULES

SCALE: SHEET OF SHEETS STA. TO STA.

* FAP 557 (IL 72), FAP 324 (IL 23)

F.A. RTE.	SECTION	COUNTY	TOTAL SHEETS	SHEET NO.
*	(128)RS-5 & (25)RS-5	DEKALB	30	18
CONTRACT NO. 66M57				
ILLINOIS FED. AID PROJECT				

IL 72 GRADING AND SHAPING DITCHES

STATION	LOCATION	REC SITE	LENGTH	WIDTH	DEPTH	DIRECTION OF FLOW	GRADING AND SHAPING DITCHES	EARTH EX	SEEDING CL 2A	NITRO FERT NUT	PHOSP FERT NUT	POT FERT NUT	EROSION CONTROL BLANKET	
STA. TO STA.	N/S/E/W		FOOT	FOOT	FOOT		FOOT	CU YD	ACRE	LB	LB	LB	SQ YD	
07+00	07+50	LT	#4307-3	50	6	0.5	WEST	50	5.56	0.01	0.6	0.6	0.6	33
07+50	10+50	RT		300	6	0.5	WEST	300	33.33	0.04	3.7	3.7	3.7	200
10+80	13+30	RT		250	6	0.5	EAST	250	27.78	0.03	3.1	3.1	3.1	167
32+00	33+50	RT		150	6	0.5	WEST	150	16.67	0.02	1.9	1.9	1.9	100
33+10	35+10	LT		200	6	0.5	WEST	200	22.22	0.03	2.5	2.5	2.5	133
35+20	38+70	LT		350	6	0.5	WEST	350	38.89	0.05	4.3	4.3	4.3	233
60+00	61+30	RT		130	6	0.5	EAST	130	14.44	0.02	1.6	1.6	1.6	87
68+70	71+20	LT		250	6	0.5	WEST	250	27.78	0.03	3.1	3.1	3.1	167
71+60	72+60	LT		100	6	0.5	WEST	100	11.11	0.01	1.2	1.2	1.2	67
103+20	103+70	LT		50	6	0.5	SE	50	5.56	0.01	0.6	0.6	0.6	33
119+50	120+00	LT		50	6	0.5	SE	50	5.56	0.01	0.6	0.6	0.6	33
133+00	134+50	LT	#4307-16	150	6	0.5	EAST	150	16.67	0.02	1.9	1.9	1.9	100
152+00	154+50	RI	#4307-16	250	6	0.5	WEST	250	27.78	0.03	3.1	3.1	3.1	167
158+10	159+10	RT	#4307-16	100	6	0.5	WEST	100	11.11	0.01	1.2	1.2	1.2	67
159+50	161+00	RT	#4307-16	150	6	0.5	WEST	150	16.67	0.02	1.9	1.9	1.9	100
166+00	167+00	RT	#4307-16	100	6	0.5	WEST	100	11.11	0.01	1.2	1.2	1.2	67
TOTALS								2630	292	0.4	33	33	33	1753

* REC SITE # 4307-3. ANY EXCESS MATERIAL AT THIS LOCATION SHALL REMAIN ON SITE.

IL 72 DRAINAGE STRUCTURE REPAIR

S.N.	STA.	LOC.	BOX OR PIPE SIZE	STONE DUMPED RIP RAP, CL. A4	FILTER FAB	EARTH EX	TRENCH BACK FILL	BOX CULV TO BE CLEANED	PIPE CULV, CL A, TY 1 EQV R-S 18"	CLSM	PRCF END S EL EQRS 18"	AGG SUB BASE 3"	BOX CULV REM	DESCRIPTION OF WORK
				SQ YD	SQ YD	CU YD	CU YD	FOOT	FOOT	CU YD	EACH	TON	FOOT	
#996	7+03	LT & RT	2' X 1.5'			7.3		66						CLEAN BARREL - APPROXIMATELY 6-9" INCHES SILT
019-2501	61+37	LT & RT	5' X 3.5'	6	6									PLACE 6 SQ YD OF RR4 AND FILTER FABRIC BETWEEN TILE OUTLET AND LEFT END SECTION
#995	103+33	LT & RT	2' X 2'					52						CLEAN BARREL - APPROXIMATELY 6-9" INCHES SILT
#754	106+45	LT & RT	3' X 1.5'				18		72		4	9	53	REPLACE CULVERT #754 WITH TWIN 18" ELLIPTICAL CONCRETE PIPES, 36' LONG, WITH PRECAST FLARED END SECTIONS
#753	119+40	LT & RT	3.5' X 1.5'					38						CLEAN BARREL - APPROXIMATELY 6-9" INCHES SILT
019-0033	144+30	LT & RT								1.2				PROTECTING THE EAST ABUTMENT EMBANKMENT AT SN 019-0033 BY FILLING IN THE ABUTMENT SUBSIDENCE WITH 1.2 CY OF CLSM
				6	6	7.3	18	156	72	1.2	4	9	53	
				6	6	7.3	18	156	72	1.2	4	9	53	

* REC SITE # 4307-3. ANY EXCESS MATERIAL AT THIS LOCATION SHALL REMAIN ON SITE.

MODEL: Default
FILE NAME: c:\pwworking\illinois.gov_richard.yoo\0941461686\57-shi_Schedules.dgn

USER NAME = Richard.Yoo	DESIGNED -	REVISED -
	DRAWN -	REVISED -
	CHECKED -	REVISED -
PLOT DATE = 10/17/2024	DATE -	REVISED -

**STATE OF ILLINOIS
DEPARTMENT OF TRANSPORTATION**

IL-72 SCHEDULES

SCALE: SHEET OF SHEETS STA. TO STA.

* FAP 557 (IL 72), FAP 324 (IL 23)

F.A. RTE.	SECTION	COUNTY	TOTAL SHEETS	SHEET NO.
-	(12)RS-5 & (25)RS-5	DEKALB	30	19
CONTRACT NO. 66M57				
ILLINOIS		FED. AID PROJECT		

IL-23 MAINLINE SCHEDULE													
STA. TO STA.		LENGTH	HMA SURFACE REMOVAL	HMA SURFACE REMOVAL VARIABLE DEPTH	HMA SURFACE REMOVAL	HMA SURF CSE MIX D	POLY BINDER COURSE	MATERIAL TRANSFER DEVICE	MIX FOR JTS, CRACKS & FLGWYS	BIT MAT'L (TACK COAT)	LONG JOINT SEAL	AGG WEDGE TY B	TEMP RAMP
		FT	2 1/2" SQ YD	SQ YD	1 1/2" SQ YD	IL-9.5,N70 1 1/2" TONS	IL-4.75 N50 1" TONS	TON	TONS	POUND	FOOT	TONS	SQ YD
145+87.28	155+60.3	973	3243			272.4	182	454.1	1.0	2189	973	73.9	41.7
155+60.3	156+40.3	80		267		22.4	15	37.3	0.1	180	80	6.1	
156+40.3	156+60.3	20			67	5.6		5.6	0.0	45	20	1.5	
156+60.3	156+85.59	25			84	7.1		7.1	0.0	57	25	1.9	
156+85.59	156+94.59	IOWA, CHICAGO & EASTERN (ICE) RAILROAD											
156+94.59	157+21.57	27			90	7.6		7.6	0.0	61	27	2.0	
157+21.57	157+41.57	20			67	5.6		5.6	0.0	45	20	1.5	
157+41.57	158+21.57	80		267		22.4		22.4	0.1	180	80	6.1	
158+21.57	170+00.	1178	3928			330.0	220	549.9	1.2	2651	1178	89.5	
STA EQ 170+00.00BK=170+04.64AH		STATION EQUATION											
170+04.64	196+71.9	2667	8891			746.8	498	1244.7	2.7	6001	2667	202.5	41.7
196+71.9	197+55.79	BRIDGE OMISSION (SN 019-0035)											
197+55.79	235+00.	3744	12481			1048.4	699	1747.3	3.7	8424	3744	284.3	41.7
STA EQ 235+00.00BK=234+99.38AH		STATION EQUATION											
234+99.38	268+00.	3301	11002			924.2	616	1540.3	3.3	7426	3301	250.6	
STA EQ 268+00.00BK=268+05.65AH		STATION EQUATION											
268+05.65	298+00.	2994	9981			838.4	559	1397.4	3.0	6737	2994	227.3	
STA EQ 298+00.00BK=298+02.18AH		STATION EQUATION											
298+02.18	317+00.	1898	6326			531.4	354	885.6	1.9	4270	1898	144.1	
STA EQ 317+00.00BK=316+95.49AH		STATION EQUATION											
316+95.49	355+11.	3816	12718			1068.3	712	1780.6	3.8	8585	3816	289.7	
355+11.	356+15.	104	347			29.1	19	48.5	0.1	234	104	7.9	
356+15.	361+00.	485	1617			135.8	91	226.3	0.5	1091	485	36.8	41.7
TOTALS			70534	533	308	5995	3965	9960	21	48178	21412	1626	167

IL-23 SIDEROAD SCHEDULE													
STATION	NAME	SIDE	MATERIAL	VARIABLE DEPTH SURF REM	INCIDENTAL HMA SURF	BIT MATL (TACK COAT)	TEMP RAMP	FURNISH EX (SPECIAL)	SEEDING, CL 2A	NITROGEN FERTILIZER NUTRIENT	PHOSPHORUS FERTILIZER NUTRIENT	POTASSIUM FERTILIZER NUTRIENT	EROSION CONTROL BLANKET
				SQ YD	TON	POUND	SQ YD	CU YD	ACRE	POUND	POUND	POUND	SQ YD
223+26	ASH ROAD	LT	HMA	185.0	20.7	83.3	45.6	0.4	0.002	0.2	0.2	0.2	20.0
249+72	HEMLOCK ROAD	RT	HMA	171.7	19.2	77.3	42.2	0.4	0.002	0.2	0.2	0.2	20.0
276+12	BIRCH ROAD	LT	HMA	128.3	14.4	57.8	31.1	0.4	0.002	0.2	0.2	0.2	20.0
302+52	MELMS ROAD	RT	HMA	196.7	22.0	88.5	50.0	0.4	0.002	0.2	0.2	0.2	20.0
302+52	MELMS ROAD	LT	HMA	251.7	28.2	113.3	66.1	0.4	0.002	0.2	0.2	0.2	20.0
355+11	POPLAR ROAD	RT	HMA	246.7	27.6	111.0	63.3	0.4	0.002	0.2	0.2	0.2	20.0
355+11	POPLAR ROAD	LT	HMA	233.3	26.1	105.0	61.1	0.4	0.002	0.2	0.2	0.2	20.0
TOTALS				1413	158	636	359	3	0.01	1	1	1	140

* SEEDING PAY ITEMS WILL NOT BE PAID FOR SEPARATELY, BUT WILL BE INCLUDED IN THE COST OF FURNISHED EXCAVATION.

MODEL: Default
FILE NAME: c:\p\work\pww\illinois.gov_richard.yoo\illinois.gov\094146168\57-shi_Schedule.dgn

USER NAME = Richard.Yoo	DESIGNED -	REVISED -	STATE OF ILLINOIS DEPARTMENT OF TRANSPORTATION	IL-23 SCHEDULES	F.A. RTE.	SECTION	COUNTY	TOTAL SHEETS	SHEET NO.	
	DRAWN -	REVISED -			*	(12)RS-5 & (25)RS-5	DEKALB	30	20	
	CHECKED -	REVISED -			CONTRACT NO. 66M57					
PLOT DATE = 10/17/2024	DATE -	REVISED -			SCALE:	SHEET	OF	SHEETS	STA.	TO STA.

IL-23 ENTRANCE SCHEDULE							
STATION	TYPE	SIDE	MATERIAL	VARIABLE DEPTH SURF REM	INCIDENTAL HMA SURF	BIT MATL (TACK COAT)	AGG SURF CSE TY B
				SQ YD	TON	POUND	TON
146+92	CE	LT	HMA	46.7	5.2	21.0	
157+56	FE	RT	AGG				3.7
169+86	MBTO	RT	HMA	18.2	2.0	8.2	
170+31	PE	LT	HMA	36.7	4.1	16.5	
171+38	MBTO	RT	HMA	8.9	1.0	4.0	
171+84	PE	RT	HMA	36.7	4.1	16.5	
175+31	FE	RT	AGG				4.8
181+50	PE	LT	HMA	26.1	2.9	11.8	
182+34	MBTO	RT	HMA	13.8	1.5	6.2	
183+00	PE	LT	HMA/AGG	36.7	4.1	16.5	
183+74	FE	RT	AGG				3.2
184+94	PE	LT	HMA/AGG	46.1	5.2	20.8	
193+65	FE	RT	AGG				5.1
194+61	FE	LT	AGG				4.7
201+19	FE	LT	AGG				1.9
206+62	PE/MBTO	RT	HMA/AGG	38.3	4.3	17.3	
206+76	PE	LT	HMA	35.6	4.0	16.0	
215+16	FE	LT	AGG				3.2
222+21	PE	LT	HMA	40.6	4.5	18.3	
223+17	FE	RT	AGG				2.2
224+00	FE	LT	AGG				3.2
234+76	PE/MBTO	RT	HMA	10.4	1.2	4.7	
236+37	CE	RT	HMA	68.3	7.7	30.8	
237+94	CE	RT	AGG				5.1
249+65	FE	LT	AGG				3.2
250+80	FE	RT	AGG				3.2
264+07	PE	RT	AGG				4.9
266+25	FE	RT	AGG				2.2
267+94	PE	RT	HMA	37.8	4.2	17.0	
276+18	FE	RT	AGG				9.2
279+62	CE	LT	AGG				5.2
291+65	FE	LT	AGG				2.2
296+55	FE	RT	AGG				1.9
296+55	PE	LT	HMA	60.0	6.7	27.0	
306+17	PE	LT	HMA	43.3	4.9	19.5	
306+17	MBTO	RT	HMA	12.4	1.4	5.6	
315+85	FE	RT	AGG				3.2
317+87	MBTO	RT	HMA	15.1	1.7	6.8	
317+87	PE	LT	HMA	57.2	6.4	25.8	
322+47	FE	LT	AGG				5.4
328+62	FE	RT	AGG				2.5
332+14	PE/MBTO	RT	HMA	55.0	6.2	24.8	
336+61	FE	RT	AGG				3.2
342+23	FE	LT	AGG				3.2
342+59	FE	RT	AGG				7.5
TOTALS				744	83	335	94

IL-23 LINEAR DELINEATOR PANEL SCHEDULE				
STRUCTURE NUMBER	SIDE	STRUCTURE CENTERLINE STATION	GUARDRAIL LENGTH FT	LINEAR DELINEATOR PANELS, 4" EACH
		019 0035	RIGHT	197+13.85
019-0035	LEFT	197+13.85	400.0	5
TOTAL			813	10

MODEL: Default
FILE NAME: c:\pwworkspace\illinois.gov_richard.yoo\461686157-shi_Schedule.dgn

USER NAME = Richard.Yoo	DESIGNED -	REVISED -
	DRAWN -	REVISED -
	CHECKED -	REVISED -
PLOT DATE = 10/17/2024	DATE -	REVISED -

STATE OF ILLINOIS
DEPARTMENT OF TRANSPORTATION

SCALE:		SHEET	OF	SHEETS	STA.	TO STA.
--------	--	-------	----	--------	------	---------

IL-23 SCHEDULES

* FAP 557 (IL 72), FAP 324 (IL 23)

F.A. RTE.	SECTION	COUNTY	TOTAL SHEETS	SHEET NO.
(120)RS-5 & (25)RS-5		DEKALB	30	21
CONTRACT NO. 66M57				
ILLINOIS FED. AID PROJECT				

IL-23 PAVEMENT MARKING SCHEDULE

LOCATION	LENGTH	MODIFIED URETHANE (2 APPLICATIONS)		PREFORMED PLASTIC TYPE D			EPOXY PAVT MKG	GROOVING FOR RECESSED PAVT MKG			RAISED REFLECT PVMT MARK	RAISED REFLECT PVMT MARK REMOVAL
		LINE 4"	LINE 6"	LET & SYM	LINE 8"	LINE 24"	LINE 12"	LET & SYM	LINE 8"	LINE 25"	EACH	EACH
		WHITE FOOT	YELLOW FOOT	WHITE SQ FT	WHITE FOOT	WHITE FOOT	WHITE FOOT	SQ FT	FOOT	FOOT		
STATION	FOOT	FOOT	FOOT	SQ FT	FOOT	FOOT	FOOT	SQ FT	FOOT	FOOT	EACH	EACH
143+82 TO 148+87	506	3278	373		194	74	148		194	74		
148+87 TO 151+18.08	231	923	115			12				12	3	3
151+18.08 TO 151+68.08	50	200	25	61		12		61		12	1	1
151+68.08 TO 156+68.28	500	2001	250			12				12	6	6
156+68.28 TO 157+10.60	42	169	21			12				12	1	1
157+10.60 TO 162+10.60	500	2000	250			12				12	6	6
162+10.60 TO 162+60.60	50	200	25	61		12		61		12	1	1
162+60.60 TO 170+00.00	739	2958	370								9	9
STA EQ 170+00.00BK = 170+04.64AH		STATION EQUATION										
170+04.64 TO 235+00.00	6495	25981	3248								81	81
STA EQ 235+00.00BK = 234+99.38AH		STATION EQUATION										
234+99 TO 268+00.00	3300.62	13202.48	1650								41	41
STA EQ 268+00.00BK = 268+05.65AH		STATION EQUATION										
268+05.65 TO 298+00.00	2994.35	11977.4	1497								37	37
STA EQ 298+00.00BK = 298+02.18AH		STATION EQUATION										
298+02 TO 317+00	1897.82	7591.28	949								24	24
STA EQ 317+00.00BK = 316+95.49AH		STATION EQUATION										
316+95 TO 361+00	4404.51	17618.04	2202								55	55
TOTAL		88099	10976	122	194	146	148	122	194	146	265	265

PAVEMENT MARKING INCLUDES BRIDGE OMISSION

IL-23 SHORT TERM PAVEMENT MARKINGS

LOCATION	LENGTH	SHORT TERM PVMT	SHORT TERM PVMT REM
STATION	FOOT	FOOT	SQ FT
148+87 TO 151+48.47	261	78	9
151+48.47 TO 151+98.08	50	15	2
151+98.08 TO 156+68.28	470	141	16
156+68.28 TO 157+10.60	42	13	1
157+10.60 TO 161+92.68		STATION EQUATION	
161+92.68 TO 162+42.43	50	15	2
162+42.43 TO 170+00.00	758	227	25
STA EQ 170+00.00BK = 170+04.64AH		STATION EQUATION	
170+04.64 TO 235+00.00	6495	1949	217
STA EQ 235+00.00BK = 234+99.38AH		STATION EQUATION	
234+99 TO 268+00.00	3301	990	110
STA EQ 268+00.00BK = 268+05.65AH		STATION EQUATION	
268+05.65 TO 298+00.00	2994	898	100
STA EQ 298+00.00BK = 298+02.18AH		STATION EQUATION	
298+02 TO 317+00	1898	569	63
STA EQ 317+00.00BK = 316+95.49AH		STATION EQUATION	
316+95 TO 361+00	4405	1321	147
TOTAL		6217	692

*THIS QUANTITY IS FOR 3 APPLICATIONS IF NEEDED.

IL-23 PAVEMENT MARKING SCHEDULE (NO PASSING ZONES)

LOCATION	LOCATION	MODIFIED URETHANE (2 APPLICATIONS) LINE 4" YELLOW
STATION	NB / SB	FOOT
150+22.58 TO 162+43.64	NB	2442.1
150+22.58 TO 162+43.64	SB	2442.1
STA EQ 170+00.00BK = 170+04.64AH		STATION EQUATION
STA EQ 235+00.00BK = 234+99.38AH		STATION EQUATION
STA EQ 268+00.00BK = 268+05.65AH		STATION EQUATION
STA EQ 298+00.00BK = 298+02.18AH		STATION EQUATION
323+84 TO 331+02	NB	1434.4
333+17 TO 342+29	SB	1824.6
342+29 TO 352+33	NB	2008.1
352+33 TO 357+62	SB	1058.3
352+33 TO 357+62	NB	1058.3
357+62 TO 361+00.00	SB	675.1
TOTAL		12943

THE RESIDENT ENGINEER SHALL VERIFY THE LOCATIONS OF THE NO PASSING ZONES.

PAVEMENT MARKING INCLUDES BRIDGE OMISSION

MODEL: Default
FILE NAME: c:\pwworkspace\illinois.gov_richard.yoo\il23\il23_schedules.dgn

USER NAME = Richard.Yoo	DESIGNED -	REVISED -
	DRAWN -	REVISED -
	CHECKED -	REVISED -
PLOT DATE = 10/17/2024	DATE -	REVISED -

**STATE OF ILLINOIS
DEPARTMENT OF TRANSPORTATION**

IL-23 SCHEDULES

SCALE: SHEET OF SHEETS STA. TO STA.

*FAP 557 (IL 72), FAP 324 (IL 23)

F.A. RTE.	SECTION	COUNTY	TOTAL SHEETS	SHEET NO.
-	(128)RS-5 & (25)RS-5	DEKALB	30	22
CONTRACT NO. 66M57				
ILLINOIS FED. AID PROJECT				

PERMANENT SURVEY MARKER SCHEDULE

MONUMENT NUMBER	DESCRIPTION	APPROXIMATE LOCATION	EXISTING MONUMENT TYPE	PROPOSED MONUMENT TYPE	MONUMENT RECORD TO BE RECORDED	RESPONSIBILITY
023001	W QTR CORNER SECTION 3, T42N, R5E, 3RD PM	1/2 MI S OF MCHENRY CO LINE	BRASS PLAQUE	TYPE 1	YES	2
023002	SW CORNER SECTION 3, T42N, R5E, 3RD PM	MELMS RD INTESECTION	MISSING	TYPE 1	YES	2
A023003	W QTR CORNER SECTION 10, T42N, R5E, 3RD PM	BIRCH RD INTERSECTION	MAG NAIL	TYPE 1	YES	2
A023004	SW CORNER SECTION 10, T42N, R5E, 3RD PM	HEMLOCK RD INTERSECTION	MAG NAIL	TYPE 1	YES	2
A023005	E QTR CORNER SECTION 16, T42N,R5E, 3RD PM	ASH RD INTERSECTION	BURIED IRON PIPE	TYPE 1	YES	2
023005	ALTERNATE OPINION E QTR CORNER SECTION 16, T42N,R5E, 3RD PM	"	BRASS PLAQUE	MAG NAIL	REFERENCE ON NEW MR	"
023007	W QTR CORNER SECTION 22, T42N, R5E, 3RD PM	1/2 MI N OF RTE 72	BRASS PLAQUE	TYPE 1	YES	2
720101	N QTR CORNER SECTION 27, T42N, R5E, 3RD PM	1/2 MI E OF 23(N)	BRASS PLAQUE	TYPE 1	YES	2
720102	NE CORNER SECTION 27, T42N, R5E, 3RD PM	ROOSEVELT RD INTERSECTION	BRASS PLAQUE	TYPE 1	YES	2
A720102	NE CORNER SECTION 27, T42N, R5E, 3RD PM, ORIGINAL LOCATION	"	MISSING		REFERENCE ON 720102	2
720104	E QTR CORNER SECTION 25, T42N, R5E, 3RD PM	KANE COUNTY LINE	MAG NAIL	TYPE 1	YES	2
720103	W QTR CORNER SECTION 30, T42N, R6E, 3RD PM (KANE CO)	KANE COUNTY LINE	MAG NAIL	TYPE 1	YES	2
				IF NAIL DESTROYED		
				IF NAIL DESTROYED		

ONLY THE ORIGINAL SCOPE OF THIS JOB HAS BEEN SEARCHED FOR MONUMENTS. R.E. MUST INFORM PLATS AND PLANS TO SEARCH FOR ADDITIONAL MONUMENTS PRIOR TO MILLING IF ADDENDUMS HAVE BEEN ADDED TO THIS JOB.

R.E. WILL INFORM PLATS AND PLANS WHEN SURFACE IS TO BE MILLED FOR THE PURPOSE OF SEARCHING FOR BURIED SURVEY MONUMENTS.

UNKNOWN MONUMENTS MAY EXIST. IF AN UNLISTED MONUMENT IS FOUND, R.E. IS REQUIRED TO PROTECT THE MONUMENT FROM DAMAGE UNTIL A PLATS AND PLANS LAND SURVEYOR CAN DOCUMENT THE MONUMENT. PLATS AND PLANS WILL RESET SUCH MONUMENTS IN KIND FOLLOWING CONSTRUCTION.

NOTE: FOR BIDDING PURPOSES, NO CONTRACTED LAND SURVEYING SERVICES WILL BE REQUIRED.
PLATS AND PLANS WILL PREPARE AND RECORD THE REQUIRED MONUMENT RECORDS.

RESPONSIBILITY:

- 1) RESIDENT TO RE-ESTABLISH MONUMENT (PAY ITEM REQUIRED. PERMANENT SURVEY MARKER, TYPE 1)
- 2) PLATS AND PLANS TO RE-ESTABLISH MONUMENT

MODEL: Default
FILE NAME: c:\pwworkspace\platschrd\094168166M57-shh\Schedule.dgn

USER NAME = Anthony.Grunstad	DESIGNED -	REVISED -
	DRAWN -	REVISED -
	CHECKED -	REVISED -
PLOT DATE = 12/13/2024	DATE -	REVISED -

**STATE OF ILLINOIS
DEPARTMENT OF TRANSPORTATION**

SCALE: SHEET OF SHEETS STA. TO STA.

SCHEDULES

* FAP 557 (IL 72), FAP 324 (IL 23)

F.A. RTE.	SECTION	COUNTY	TOTAL SHEETS	SHEET NO.
*	(128)RS-5 & (25)RS-5	DEKALB	30	23
CONTRACT NO. 66M57				
ILLINOIS FED. AID PROJECT				

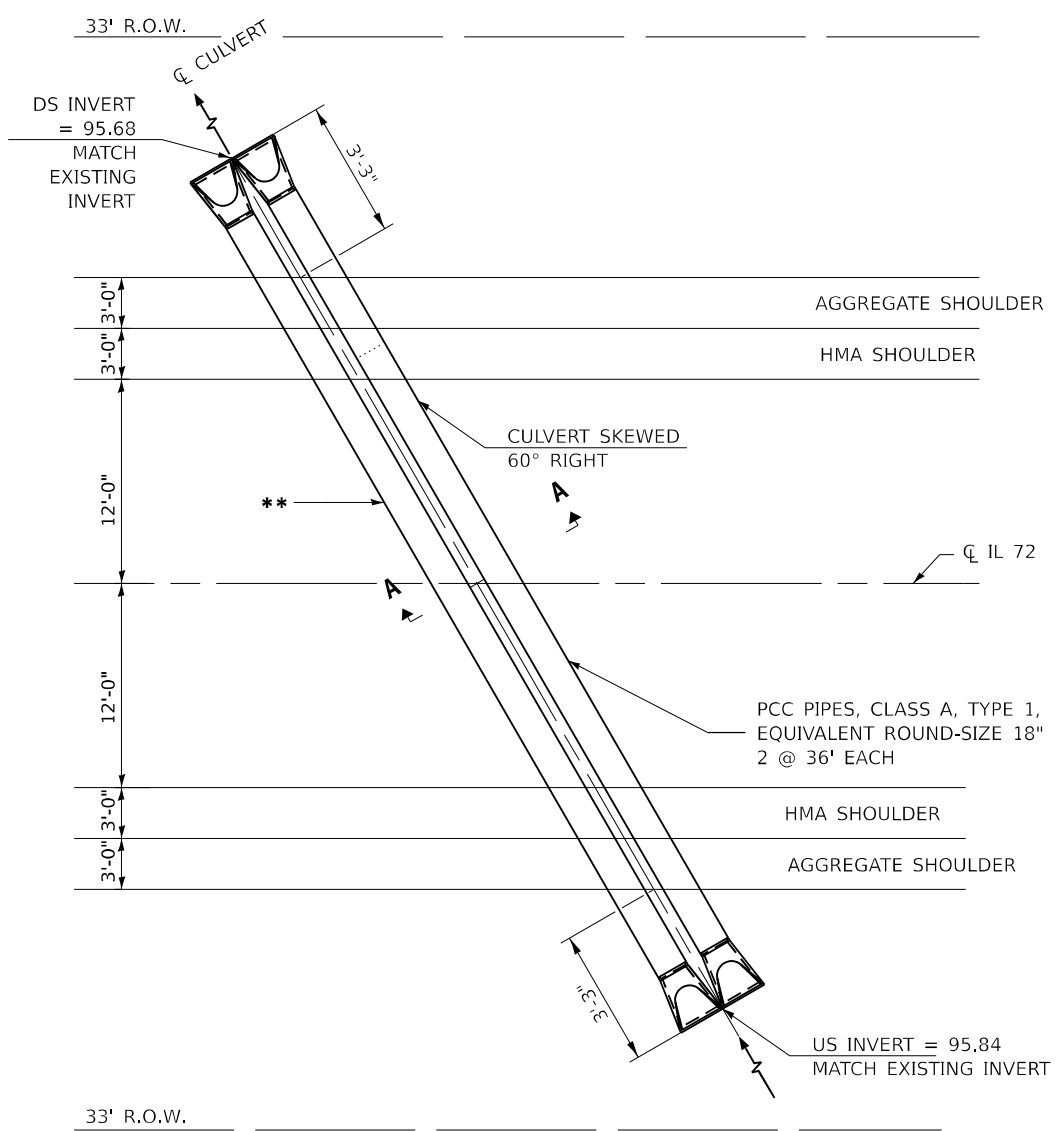
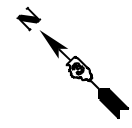

PLAN
STA 106+45
 NOT TO SCALE

- NOTES:
1. REMOVE THE EXISTING 3'X1.5' BOX CULVERT.
 2. INSTALL PCC PIPES, CLASS A, TYPE 1, EQUIVALENT ROUND-SIZE 18" 2 @ 36' EACH

- * - PROPOSED PCC ELLIPTICAL PIPE CULVERT, CLASS A, TYP 1, 18" 2 @ 36' EACH
- ** - PROPOSED FLARED CONCRETE END SECTION 542306, 18", 4

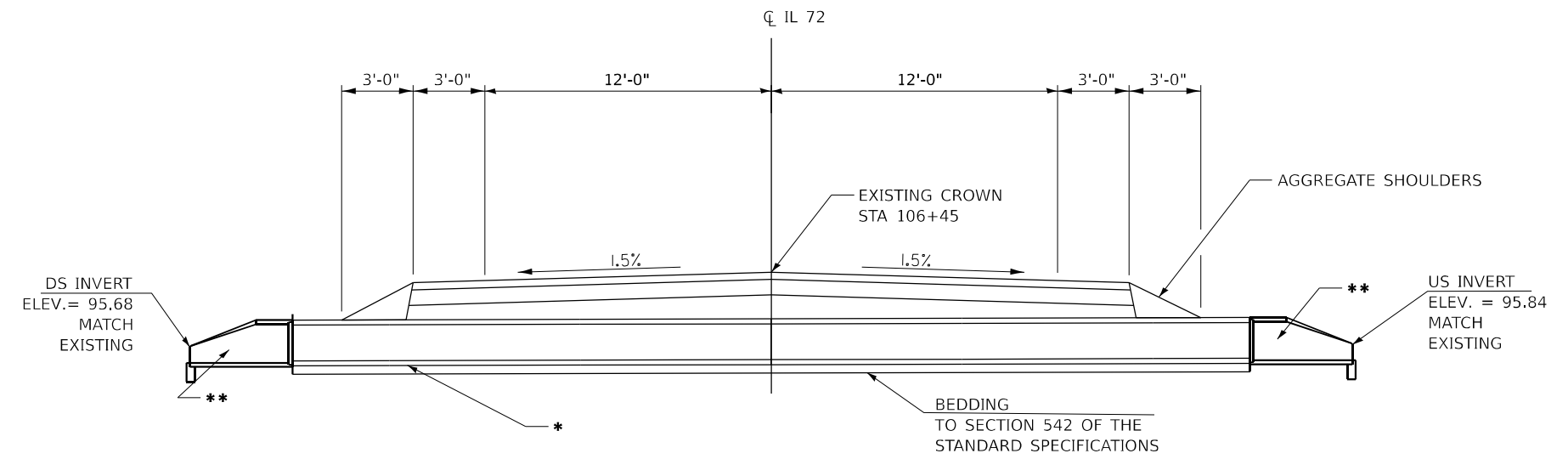

CROSS SECTION
CULVERT # 754
STA. 106+45

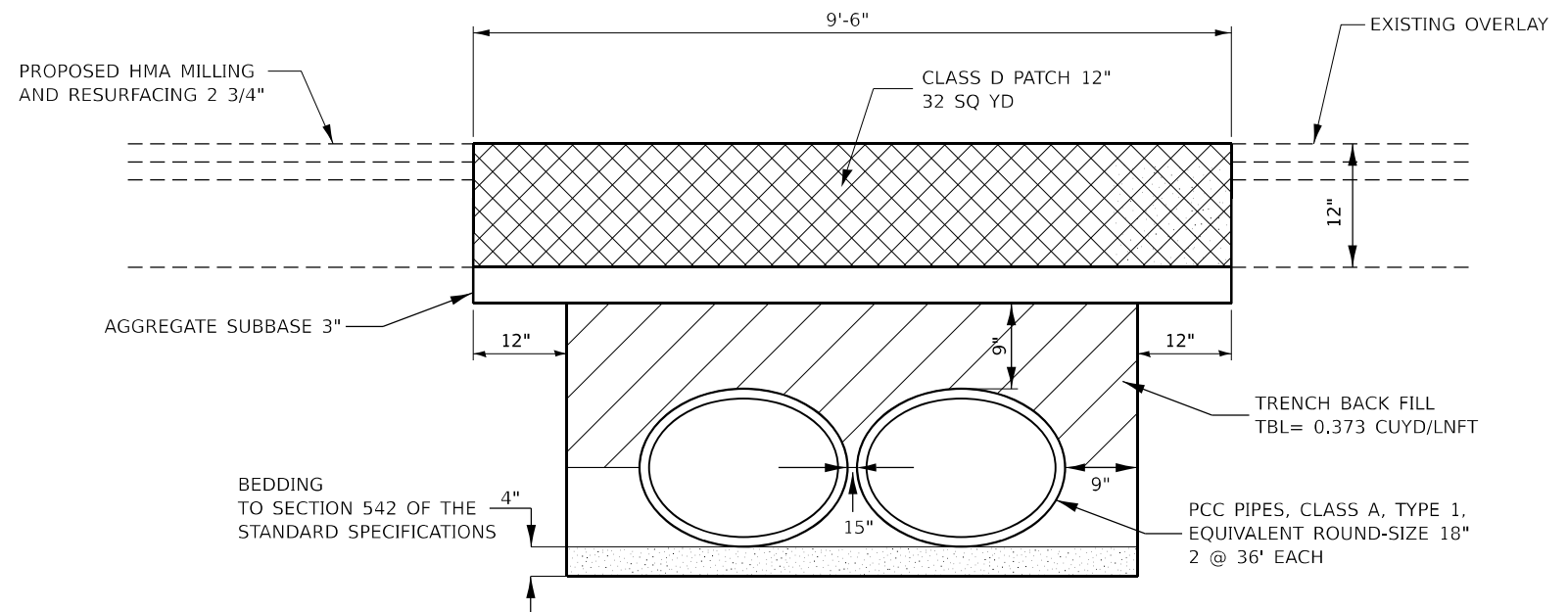

SECTION A-A
 NOT TO SCALE

- HMA (CLASS D PATCH)
- TRENCH BACKFILL

MODEL: Default
 FILE NAME: p:\ilidoc\paw\benefit\com\p\ilidoc\paw\benefit\DOT_0_ces\Btfrict_308RD_projects\366M57\CADD\366M57\CAD\sheet\66M57.dwg
 DATE: 12/13/2024

USER NAME = tlmthy,pletsch	DESIGNED -	REVISED -
PLOT SCALE = \$SCALE\$	DRAWN -	REVISED -
PLOT DATE = 12/13/2024	CHECKED -	REVISED -
	DATE -	REVISED -

STATE OF ILLINOIS
DEPARTMENT OF TRANSPORTATION

CULVERT #754 DETAILS STA 106 + 45			
SCALE:	SHEET	OF SHEETS	STA. TO STA.

* FAP 557 (IL 72), FAP 324 (IL 23)				
F.A.P. RTE.	SECTION	COUNTY	TOTAL SHEETS	SHEET NO.
*	(128)RS-5 & (25)RS-5	DEKALB	30	24
			CONTRACT NO. 66M57	
ILLINOIS FED. AID PROJECT				

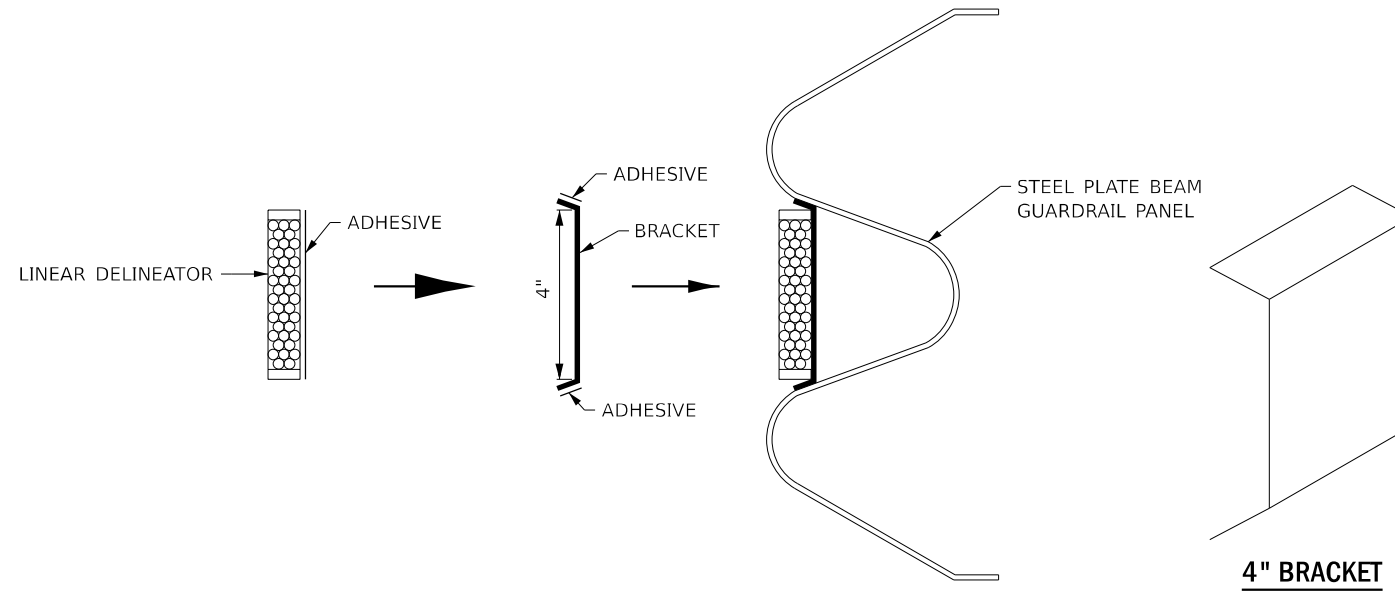

LINEAR DELINEATOR APPLICATION TO STANDARD GALVANIZED GUARDRAIL

LINEATOR DELINEATOR SHALL BE APLLIED ACCORDING TO THE MANUFACTURER'S RECOMMENDATIONS

MODEL: Default
 FILE NAME: c:\pwworkspace\dwg\p1\p1\121324\121324.dwg

* FAP 557 (IL 72), FAP 324 (IL 23)

USER NAME = Anthony.Grunstad PLOT DATE = 12/13/2024	DESIGNED -	REVISED -	STATE OF ILLINOIS DEPARTMENT OF TRANSPORTATION	DETAILS			F.A.P. RTE.	SECTION	COUNTY	TOTAL SHEETS	SHEET NO.
	DRAWN -	REVISED -					*(128)RS-5 & (25)RS-5	DEKALB	30	25	
	CHECKED -	REVISED -		SCALE: SHEET OF SHEETS STA. TO STA.			CONTRACT NO. 66M57				
	DATE -	REVISED -					ILLINOIS FED. AID PROJECT				

IDENTIFICATION OF ROADSIDE HAZARDS FOR TWO-LANE ROADWAYS

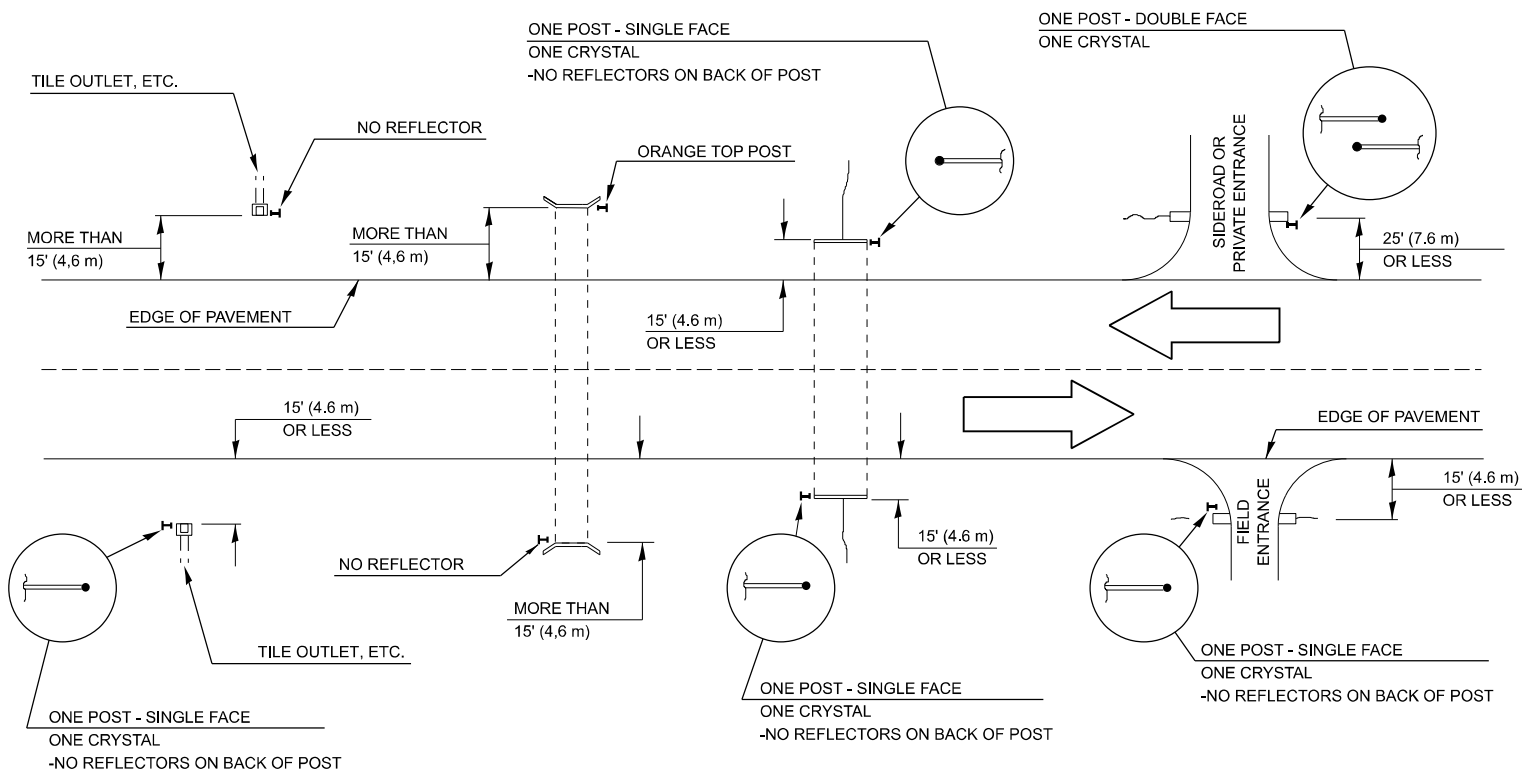

BILL OF MATERIALS

IL-72 ROADSIDE HAZARDS DELINEATOR SCHEDULE				
STRUCTURE NUMBER	SIDE	STRUCTURE CENTERLINE STATION	SINGLE FACE	DELINEATORS
			EACH	EACH
019-2503	LT, RT	17+55	2	2
761	LT, RT	52+69	2	2
019-2501	LT, RT	59+49	2	2
762	LT, RT	61+37	2	2
755	LT, RT	87+35	2	2
995	LT, RT	103+33	2	2
754	LT, RT	106+45	2	2
753	LT, RT	119+40	2	2
752	LT, RT	154+46	2	2
TOTAL				18
TOTAL				18

IL-23 ROADSIDE HAZARDS DELINEATOR SCHEDULE				
STRUCTURE NUMBER	SIDE	STRUCTURE CENTERLINE STATION	SINGLE FACE	DELINEATORS
			EACH	EACH
1089	LT, RT	155+12	2	2
2596	LT, RT	158+05	2	2
2595	LT, RT	211+15	2	2
2594	LT, RT	248+50	2	2
2593	LT, RT	272+85	2	2
2592	LT, RT	294+25	2	2
019-2551	LT, RT	311+80	2	2
2591	LT, RT	320+70	2	2
TOTAL				16
TOTAL				16

NOTE:

DELINEATORS FOR ROADSIDE HAZARDS SHALL ONLY BE PLACED AT LOCATIONS WHERE THERE IS NO GUARDRAIL, OR OTHER PERMANENT BARRIER, ON THE SAME SIDE OF THE ROAD AS THE HAZZARD.

DELINEATORS FOR ROADSIDE HAZARDS SHALL ONLY BE PLACED AT LOCATIONS WHERE DELINEATORS ARE NOT IN PLACE ALONG THE EDGE OF SHOULDER.

EACH POST SHALL BE CONSIDERED AS ONE DELINEATOR FOR PAYMENT, REGARDLESS OF THE NUMBER OF DELINEATORS ATTACHED TO IT.

FOR ONE-WAY AND INTERSTATE ROADWAYS THE APPLICATION SHALL BE SIMILAR WITH DELINEATORS PLACED ON THE TRAFFIC APPROACH SIDE OF HAZARDS AND OBJECTS, ONLY SINGLE FACE DELINEATORS WILL BE REQUIRED ON ONE-WAY ROADWAYS, CRYSTAL ON THE RIGHT SIDE AND AMBER ON THE LEFT SIDE.

FOR OTHER DELINEATOR APPLICATIONS, REFER TO HIGHWAY STANDARD 635001.

MODEL: Default
FILE NAME: c:\pwworkspace\dwg\plotsch\ind094146168M57-ah1_Details.dgn

USER NAME = Anthony.Grunstad	DESIGNED -	REVISED -
	DRAWN -	REVISED -
	CHECKED -	REVISED -
PLOT DATE = 12/13/2024	DATE -	REVISED -

**STATE OF ILLINOIS
DEPARTMENT OF TRANSPORTATION**

DETAILS	
SCALE:	SHEET OF SHEETS STA. TO STA.

* FAP 557 (IL 72), FAP 324 (IL 23)				
F.A.P. RTE.	SECTION	COUNTY	TOTAL SHEETS	SHEET NO.
*	(128)RS-5 & (25)RS-5	DEKALB	30	26
CONTRACT NO. 66M57				
ILLINOIS FED. AID PROJECT				

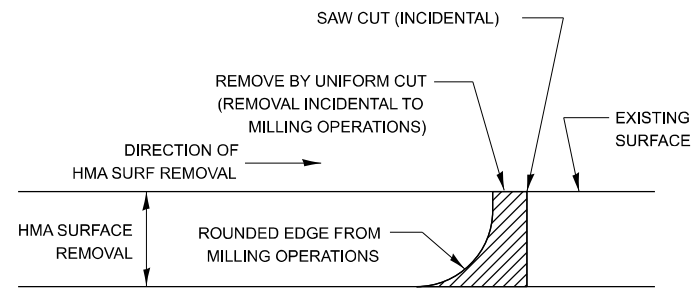

NOTE:
 WHEN MILLING OPERATIONS PRODUCE A ROUNDED EDGE, THEN A SAW CUT SHALL BE USED TO MANUFACTURE A PERPENDICULAR EDGE AS SHOWN IN THE DETAIL. THE ENGINEER SHALL BE THE SOLE JUDGE CONCERNING THE USE OF THIS DETAIL

HMA BUTT JOINT SAW CUTS

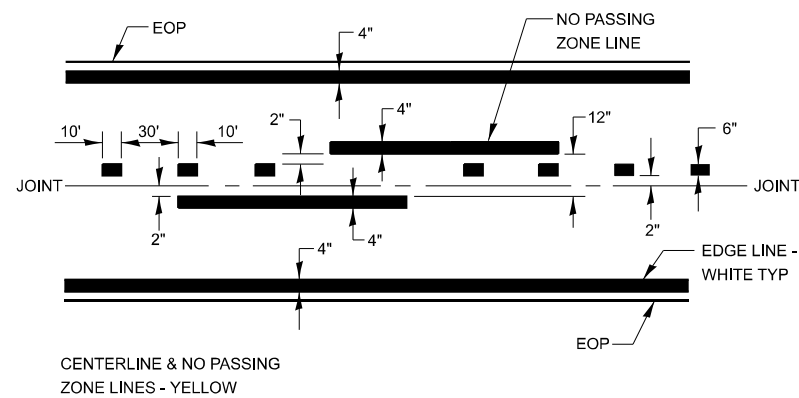

PAVEMENT MARKING

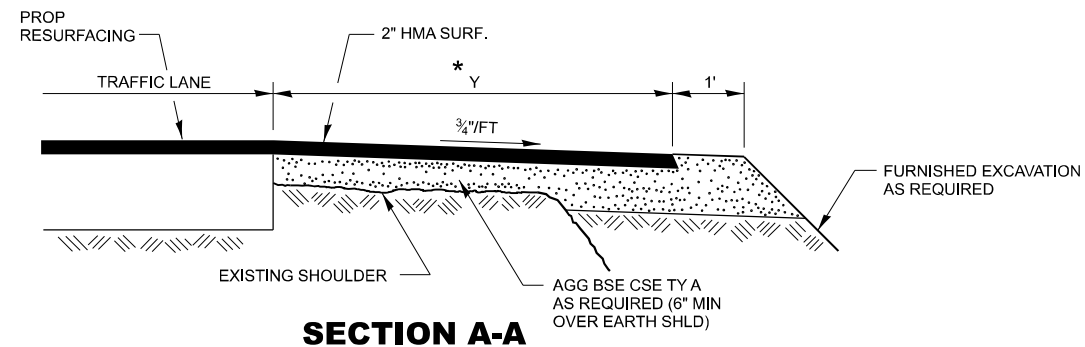
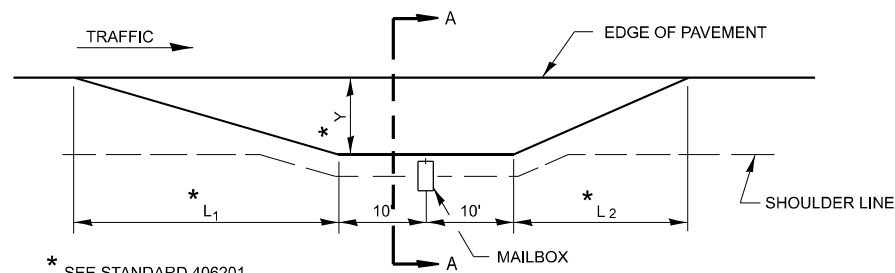

SECTION A-A

RURAL MAILBOX TURNOUT DETAILS

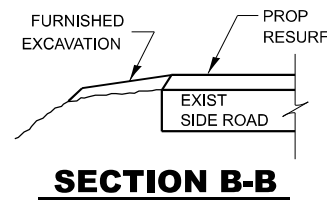

SECTION B-B

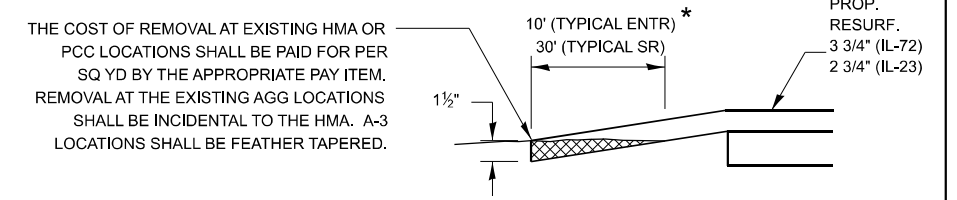

DETAIL A

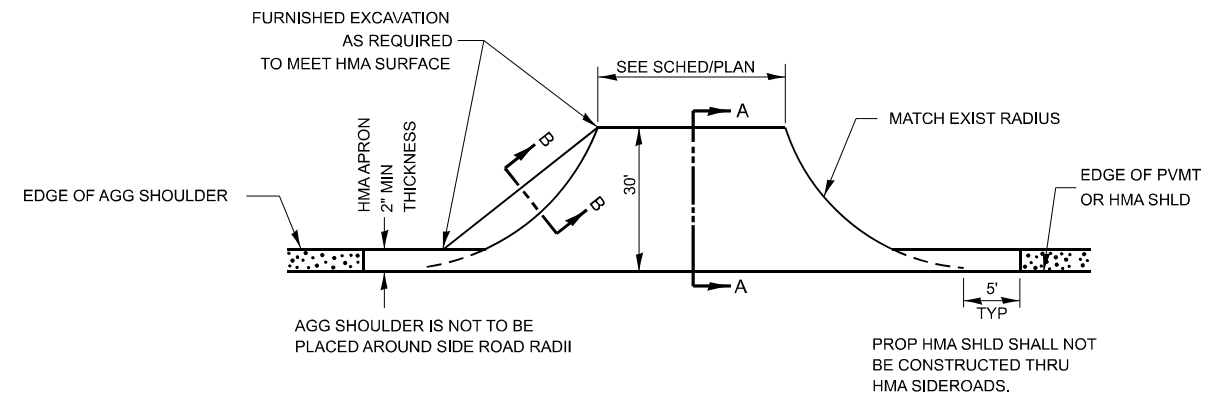

PLAN AT SIDE ROADS

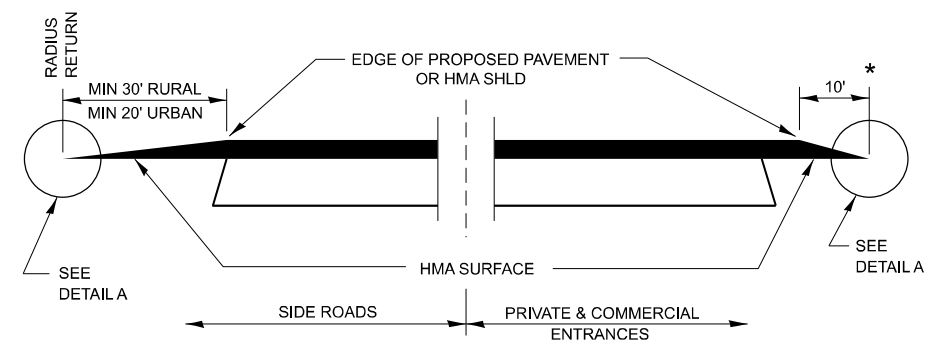

SECTION A-A DETAILS AT ENTRANCES & SIDE ROADS

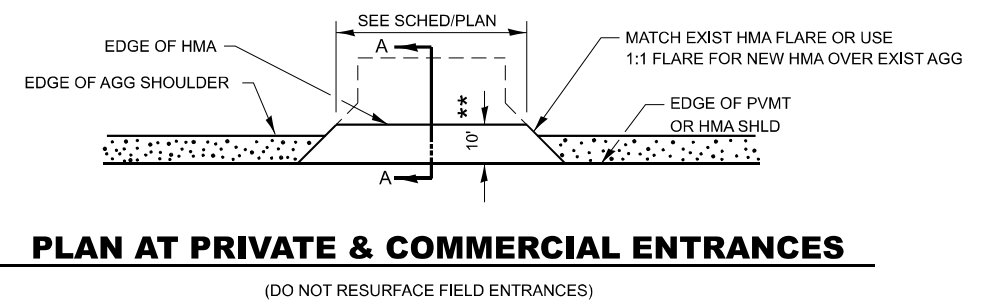

PLAN AT PRIVATE & COMMERCIAL ENTRANCES

(DO NOT RESURFACE FIELD ENTRANCES)

MODEL: Default
 FILE NAME: c:\paw_work\lwd\cd\illinois.gov_richard.yoo\941461166M57-ash Details.dgn
 USER: richard.yoo

USER NAME = Richard.Yoo	DESIGNED -	REVISED -
	DRAWN -	REVISED -
	CHECKED -	REVISED -
PLOT DATE = 4/4/2024	DATE -	REVISED -

STATE OF ILLINOIS
 DEPARTMENT OF TRANSPORTATION

SCALE: SHEET OF SHEETS STA. TO STA.

DETAILS

F.A.P R.T.E.	SECTION	COUNTY	TOTAL SHEETS	SHEET NO.
(128)RS-5 & (25)RS-5		DEKALB	30	27
CONTRACT NO. 66M57				
ILLINOIS FED. AID PROJECT				

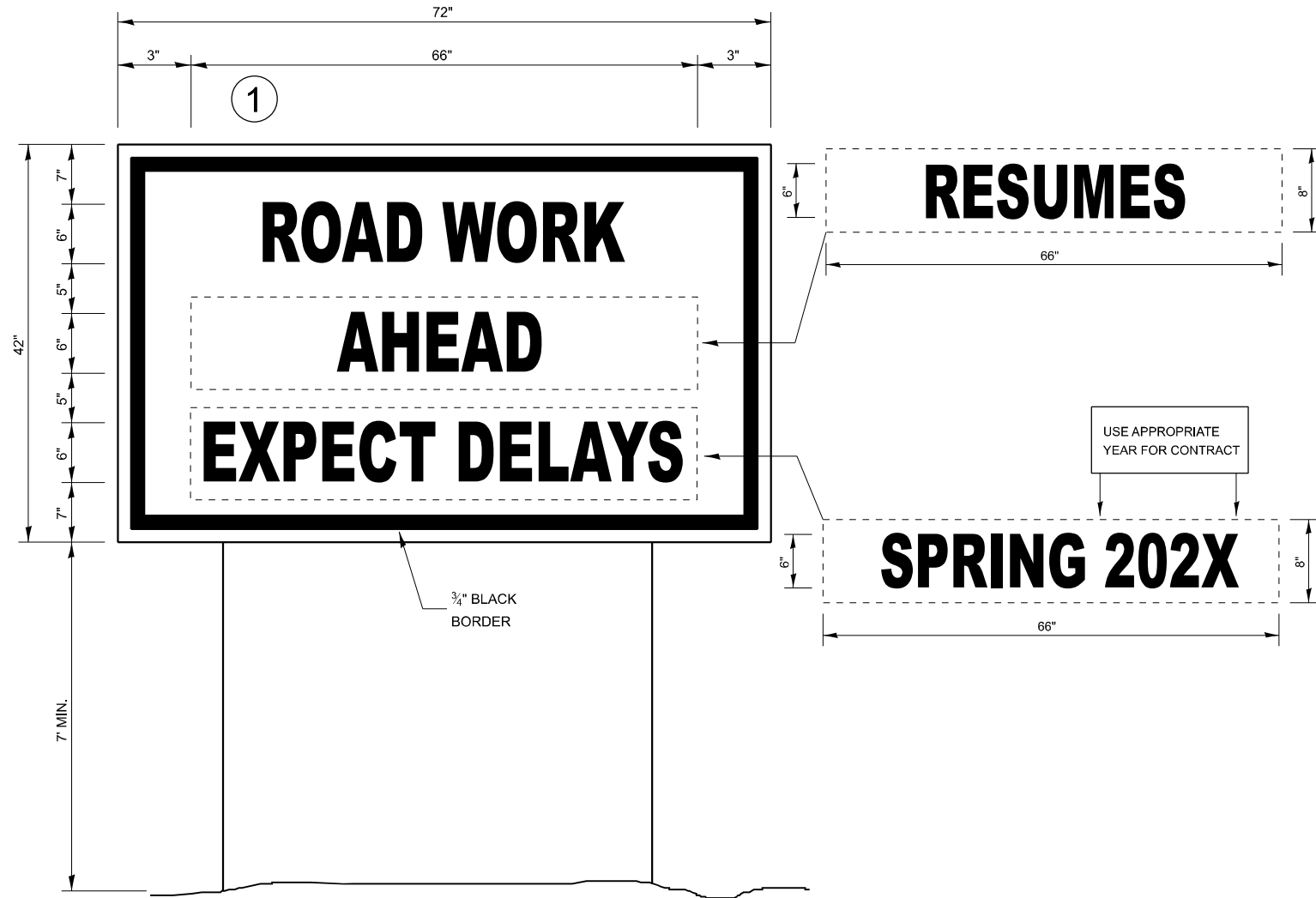
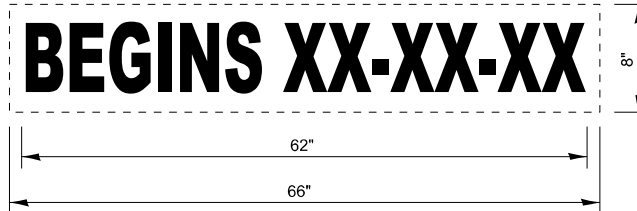
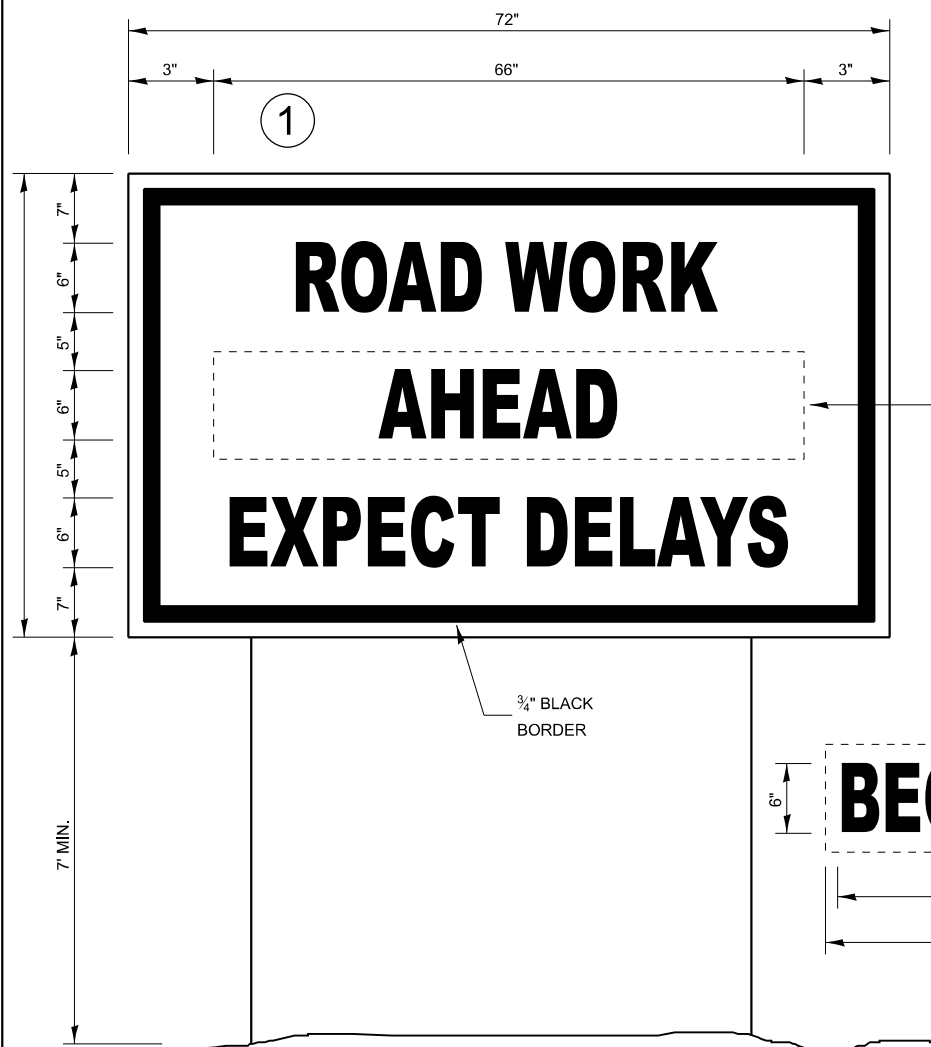

TEMPORARY INFORMATION SIGNING

WINTER SHUT DOWN SIGNING

NOTES:

1. USE 6" D BLACK LETTERING ON FLOURESENT ORANGE BACKGROUND.
2. ERECT SIGNS AT LOCATIONS IN ADVANCE OF THE "ROAD CONSTRUCTION AHEAD" SIGNS AS DIRECTED BY THE ENGINEER.
3. ERECT SIGN ① WITH INSTALLED PANEL ② A MINIMUM OF ONE WEEK PRIOR TO THE START OF THE LANE CLOSURE.
4. REMOVE PANEL ② ON THAT DATE.
5. SEE SPECIAL PROVISION "TEMPORARY INFORMATION SIGNING" FOR ADDITIONAL INFORMATION.
6. WILL BE PAID FOR PER SQ FT AS "TEMPORARY INFORMATION SIGNING". EACH SIGN = 21 SQ FT

MODEL: Default
 FILE NAME: c:\pwwork\work\bwshd\illinois.gov_richard.yoo\illinois.gov\941461166M57-shd_Details.dgn

	USER NAME = Richard.Yoo	DESIGNED -	REVISED -	STATE OF ILLINOIS DEPARTMENT OF TRANSPORTATION	DETAILS												
		DRAWN -	REVISED -														
		CHECKED -	REVISED -														
	PLOT DATE = 4/4/2024	DATE -	REVISED -		SCALE:	SHEET OF SHEETS	STA. TO STA.										
						<small>* FAP 557 (IL 72) FAP 324 (IL 23)</small> <table border="1" style="font-size: 8px;"> <tr> <th>F.A.P. RTE.</th> <th>SECTION</th> <th>COUNTY</th> <th>TOTAL SHEETS</th> <th>SHEET NO.</th> </tr> <tr> <td>(128)RS-5 & (25)RS-5</td> <td></td> <td>DEKALB</td> <td>30</td> <td>28</td> </tr> </table>		F.A.P. RTE.	SECTION	COUNTY	TOTAL SHEETS	SHEET NO.	(128)RS-5 & (25)RS-5		DEKALB	30	28
F.A.P. RTE.	SECTION	COUNTY	TOTAL SHEETS	SHEET NO.													
(128)RS-5 & (25)RS-5		DEKALB	30	28													
						CONTRACT NO. 66M57 <small>ILLINOIS FED. AID PROJECT</small>											

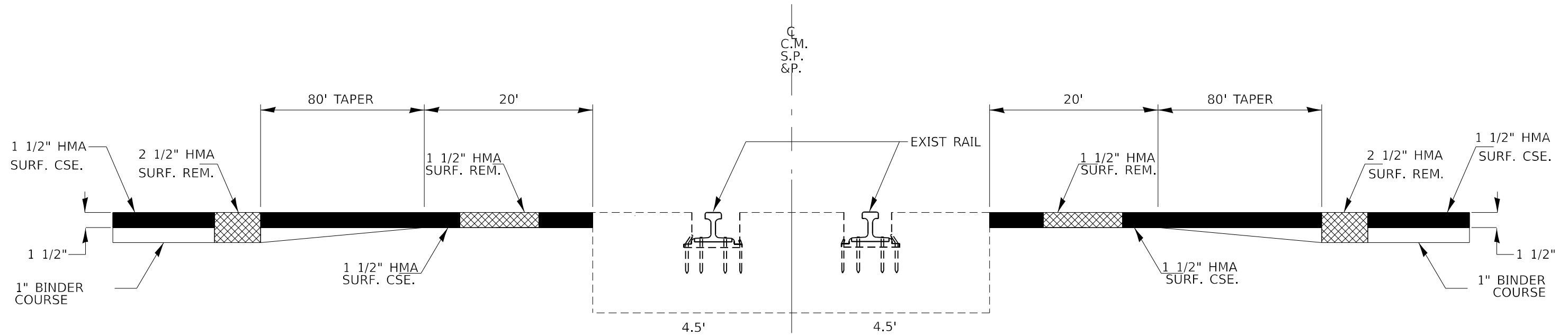

HMA SURFACE REMOVAL REPLACEMENT AT THE IL 23 - IOWA, CHICAGO & EASTERN (ICE) RAILROAD GRADE CROSSING

DRAWING NOT TO SCALE

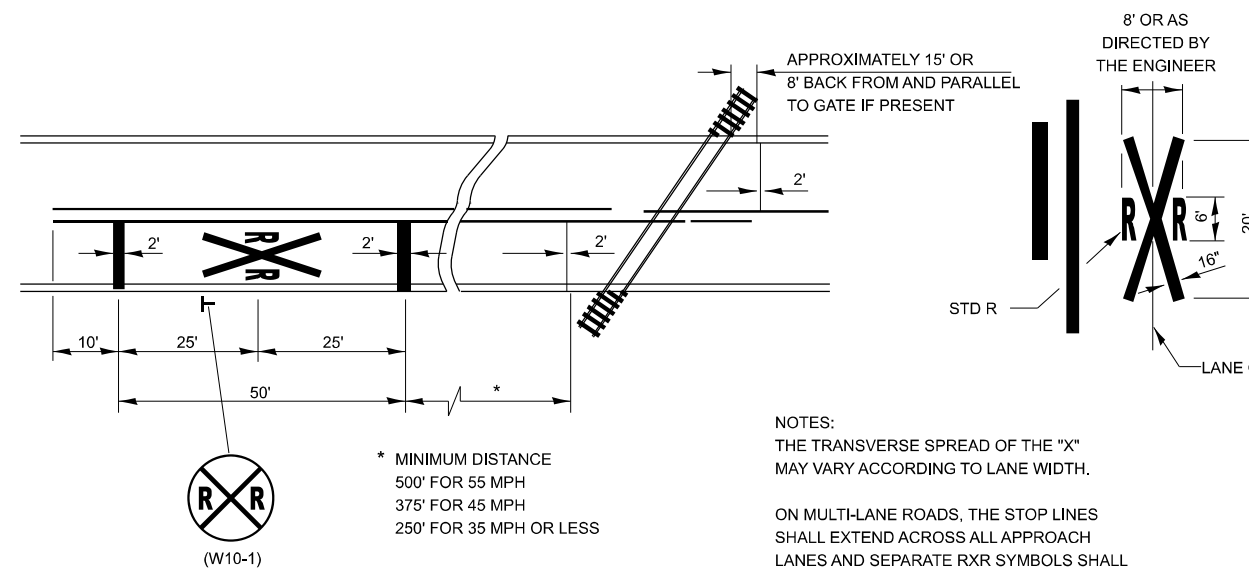

PAVEMENT MARKINGS AT RAILROAD-HIGHWAY GRADE CROSSING

NOTES:
THE TRANSVERSE SPREAD OF THE "X"
MAY VARY ACCORDING TO LANE WIDTH.

ON MULTI-LANE ROADS, THE STOP LINES
SHALL EXTEND ACROSS ALL APPROACH
LANES AND SEPARATE RXR SYMBOLS SHALL
BE PLACED ADJACENT TO EACH OTHER
IN EACH LANE.

WHEN THE PAVEMENT MARKING SYMBOL
IS USED, A PORTION OF THE SYMBOL
SHOULD BE LOCATED DIRECTLY ADJACENT
TO THE ADVANCE WARNING SIGN (W10-1).

MODEL: Default
 FILE NAME: c:\pwwork\pwwork\illinois.gov_richard.yoo\166M57-sht_Details.dgn

USER NAME = Richard.Yoo	DESIGNED -	REVISED -
	DRAWN -	REVISED -
	CHECKED -	REVISED -
PLOT DATE = 4/4/2024	DATE -	REVISED -

**STATE OF ILLINOIS
DEPARTMENT OF TRANSPORTATION**

DETAILS	
SCALE:	SHEET OF SHEETS STA. TO STA.

F.A.P. RTE.	SECTION	COUNTY	TOTAL SHEETS	SHEET NO.
(128)RS-5 & (25)RS-5		DEKALB	30	29
CONTRACT NO. 66M57				
ILLINOIS FED. AID PROJECT				

