

EX CURVE EAST RD-11  
 PI STA. = 98+63.30  
 $\Delta = 18^\circ 53' 32''$  (LT)  
 D = 9° 32' 57"  
 R = 600.00'  
 T = 99.82'  
 L = 197.84'  
 E = 8.25'  
 e = NC  
 T.R. = N/A  
 S.E. RUN = N/A  
 P.C. STA. = 97+63.47  
 P.T. STA. = 99+61.31

EX CURVE EAST RD-12  
 PI STA. = 99+95.12  
 $\Delta = 19^\circ 11' 26''$  (LT)  
 D = 28° 38' 52"  
 R = 200.00'  
 T = 33.81'  
 L = 66.99'  
 E = 2.84'  
 e = NC  
 T.R. = N/A  
 S.E. RUN = N/A  
 P.C. STA. = 99+61.31  
 P.T. STA. = 100+28.30

EX CURVE EAST RD-10  
 PI STA. = 95+11.48  
 $\Delta = 21^\circ 07' 02''$  (RT)  
 D = 8° 11' 06"  
 R = 700.00'  
 T = 130.48'  
 L = 257.99'  
 E = 12.06'  
 e = NC  
 T.R. = N/A  
 S.E. RUN = N/A  
 P.C. STA. = 93+81.00  
 P.T. STA. = 96+39.00

EX CURVE CLUB PARKING ACCESS RD-1  
 PI STA. = 504+59.31  
 $\Delta = 5^\circ 40' 03''$  (LT)  
 D = 1° 31' 40"  
 R = 3,750.00'  
 T = 185.62'  
 L = 370.94'  
 E = 4.59'  
 e = NC  
 T.R. = N/A  
 S.E. RUN = N/A  
 P.C. STA. = 502+73.69  
 P.T. STA. = 506+44.63

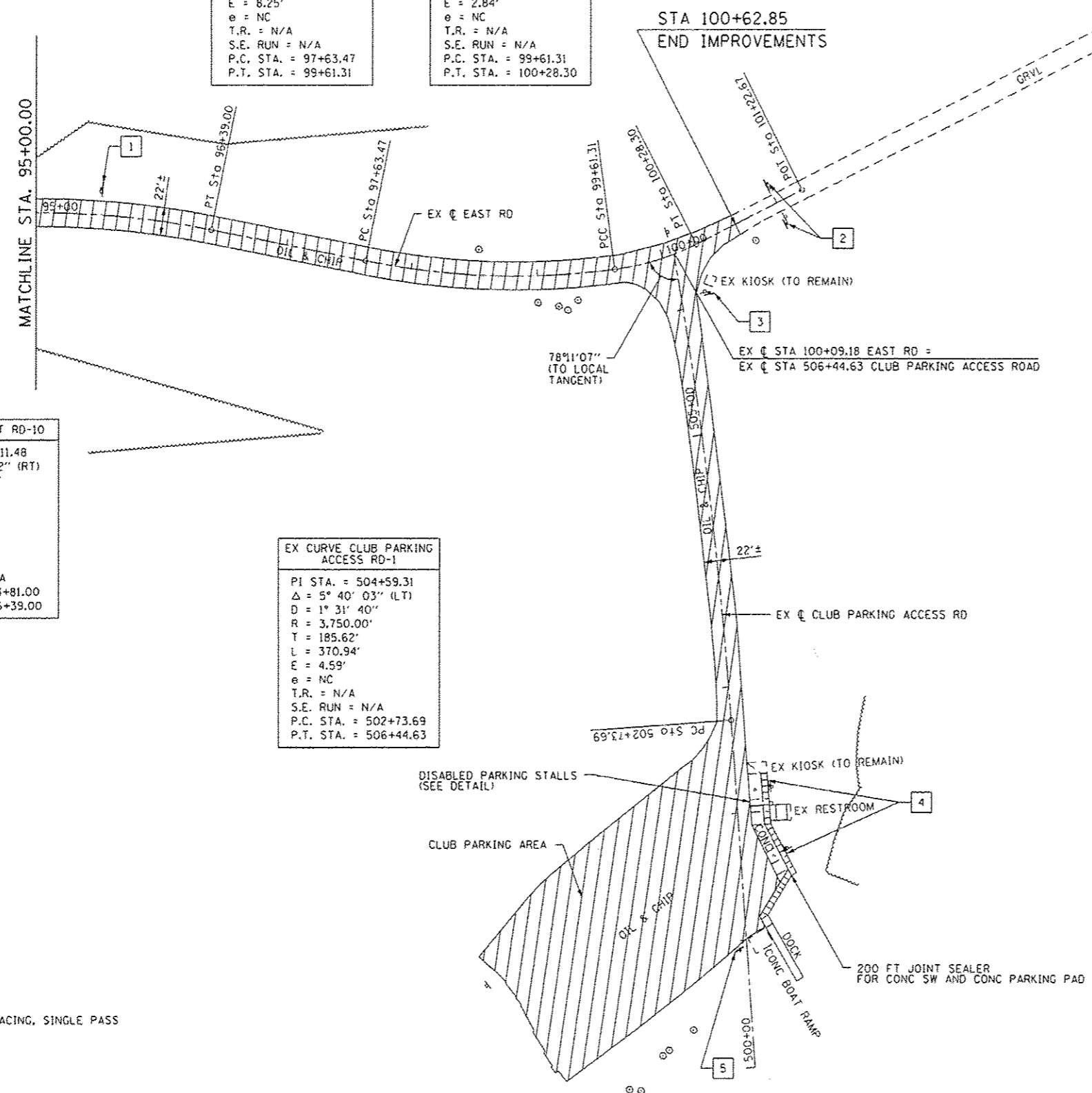

SPEED LIMIT 25  
 1  
 R2-1 (24"x30")  
 STA 95+50.00 LT

DO NOT ENTER  
 2  
 R5-1 (30"x30")  
 STA 101+00.00 RT & LT

STOP  
 3  
 R1-1 (30"x30")  
 STA 506+10.00

RESERVED PARKING  
 4  
 #250 FINE  
 R7-8 (12"x18")  
 R7-10 (12"x6")  
 STA 501+70.00 RT  
 STA 502+20.00 RT

ROAD ENDS IN WATER  
 5  
 WARNING SIGN (36"x36")  
 STA 500+92.50 LT

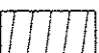
LEGEND:  
 MICRO-SURFACING, SINGLE PASS

FILE NAME * L:\1001\11866-18-11\10-CAOD_Sheets\018	USER NAME * Jack Blakemore PLAN 4.dgn	DESIGNED - JWB DRAWN - AJK	REVISED - REVISED -	<b>STATE OF ILLINOIS DEPARTMENT OF TRANSPORTATION</b>	<b>ROADWAY PLAN MERMET LAKE STATE FISH AND WILDLIFE AREA</b>	F.A. RTE.	SECTION	COUNTY	TOTAL SHEETS	SHEET NO.
PLOT SCALE * 1/8"=1'-0"	CHECKED - SPH	REVISED -				PARK ROADS	MASSAC	16	10	
PLOT DATE * 12/21/2012	DATE - 12/21/2012	REVISED -				CONTRACT NO. 46253		ILLINOIS FED. AID PROJECT		
SCALE: 1"=50'		SHEET NO. 4 OF 5 SHEETS				STA. 95+00.00 TO STA. 100+62.85				