

PLAN	SURVEYED	DATE
	PLOTTED	
	ALIGNED	
	CHECKED	
	FILED	
	NO.	

PROFILE	SURVEYED	DATE
	PLOTTED	
	GRADES	
	CHECKED	
	STRUCTURE	
	NOT AT THIS OFFICE	
	NO.	

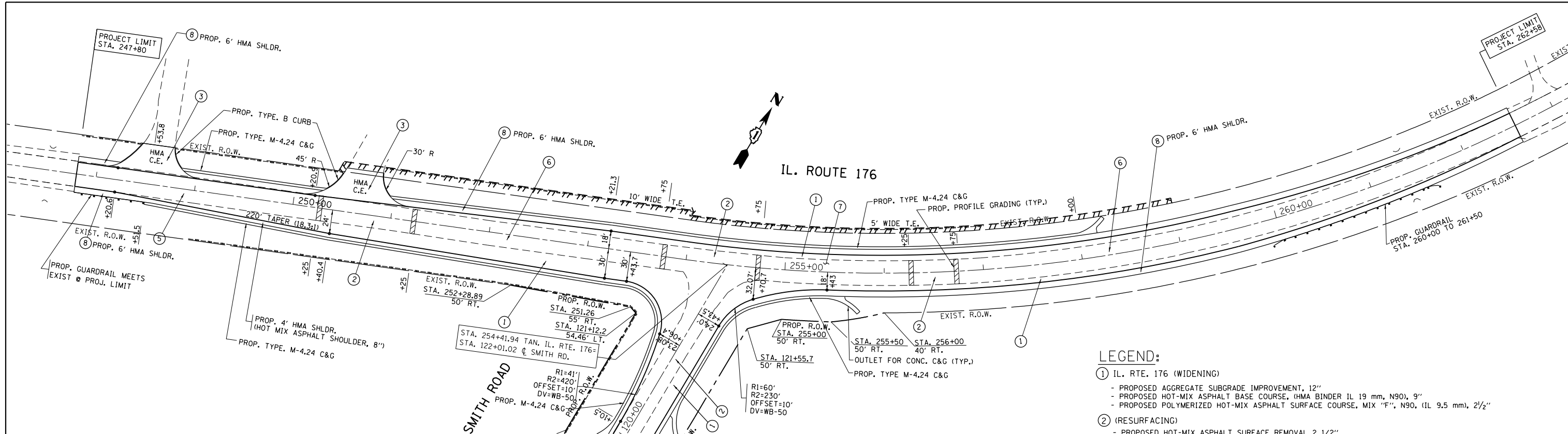

**LEGEND:**

- ① IL. RTE. 176 (WIDENING)
  - PROPOSED AGGREGATE SUBGRADE IMPROVEMENT, 12"
  - PROPOSED HOT-MIX ASPHALT BASE COURSE, (HMA BINDER IL 19 mm, N90), 9"
  - PROPOSED POLYMERIZED HOT-MIX ASPHALT SURFACE COURSE, MIX "F", N90, (IL 9.5 mm), 2 1/2"
- ② (RESURFACING)
  - PROPOSED HOT-MIX ASPHALT SURFACE REMOVAL 2 1/2"
  - PROPOSED POLYMERIZED HOT-MIX ASPHALT SURFACE COURSE, MIX "F", N90, (IL 9.5 mm), 2 1/2"
- ③ (HMA CE)
  - PROPOSED HOT-MIX ASPHALT BASE COURSE, (HMA BINDER, IL 19 mm), 8"
  - PROPOSED HOT-MIX ASPHALT SURFACE COURSE, MIX "D", N50, (IL 9.5 mm), 2"
- ④ SMITH ROAD (WIDENING)
  - PROPOSED AGGREGATE SUBGRADE IMPROVEMENT, 12"
  - PROPOSED HOT-MIX ASPHALT BASE COURSE, (HMA BINDER IL 19 mm, N90), 4 1/2 "
  - PROPOSED POLYMERIZED HOT-MIX ASPHALT SURFACE COURSE, MIX "F", N90, (IL 9.5 mm), 2 1/2"
- ⑤ (RESURFACING)
  - PROPOSED HOT-MIX ASPHALT SURFACE REMOVAL, 4"
  - PROPOSED POLYMERIZED HOT-MIX ASPHALT SURFACE COURSE, MIX "F", N90, (IL 9.5 mm), 2 1/2"
- ⑥ - PROPOSED HOT-MIX ASPHALT SURFACE REMOVAL 2 1/2"
- PROPOSED POLYMERIZED HOT-MIX ASPHALT SURFACE COURSE, MIX "F", N90, (IL 9.5 mm), 2 1/2"
- PROPOSED HOT-MIX ASPHALT BINDER COURSE, IL-19.0, N90, 4"
- ⑦ - PROPOSED HOT-MIX ASPHALT SURFACE REMOVAL 2 3/4"
- PROPOSED POLYMERIZED HOT-MIX ASPHALT SURFACE COURSE, MIX "F", N90, (IL 9.5 mm), 2 1/2"
- PROPOSED HOT-MIX ASPHALT BINDER COURSE, IL-19.0, N90, 2 1/4"
- ⑧ - (SHOULDER ALONG IL 176)
  - PROPOSED HOT-MIX ASPHALT SHOULDER (HMA BINDER IL 19 mm), 5 1/2 "
  - PROPOSED POLYMERIZED HOT-MIX ASPHALT SURFACE COURSE, MIX "F", N90, IL 9.5 mm), 2 1/2 "
- ⑨ - (SHOULDER ALONG SMITH RD.)
  - PROPOSED HOT-MIX ASPHALT SHOULDER (HMA BINDER IL 19 mm), 4 1/2 "
  - PROPOSED POLYMERIZED HOT-MIX ASPHALT SURFACE COURSE, MIX "F", N90, IL 9.5 mm), 2 1/2 "

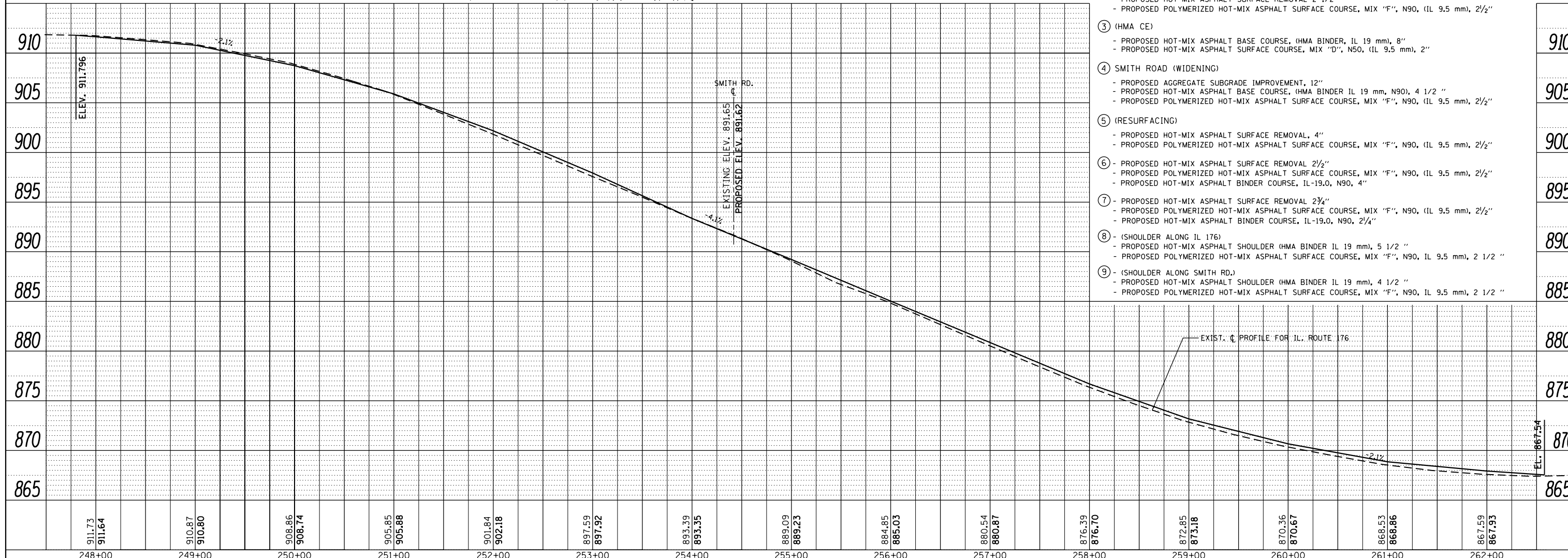

FILE NAME =	USER NAME = obreuh	DESIGNED -	REVISED -	<b>STATE OF ILLINOIS DEPARTMENT OF TRANSPORTATION</b>	<b>PROPOSED ROADWAY PLAN &amp; PROFILE IL. RTE. 176 AT SMITH RD.</b>				F.A.P. RTE. 335	SECTION 146N-2	COUNTY MCHENRY	TOTAL SHEETS 65	SHEET NO. 21
c:\pwork\pwork\obreuh\dms99205\p114205\shp\p1npr.f.dgn	PLOT SCALE = 100.0000' / 1"	DRAWN -	REVISED -		SCALE:	SHEET NO.	OF SHEETS	STA.	TO STA.	CONTRACT NO. 60K20			
	PLOT DATE = 12/12/2012	CHECKED -	REVISED -		ILLINOIS FED. AID PROJECT								
		DATE -	REVISED -										